



## Tell EX8300 Series Exit Device Instruction Manual

[Home](#) » [Tell](#) » Tell EX8300 Series Exit Device Instruction Manual 



### Contents

- [1 EX8300 Series Exit Device](#)
- [2 Type of Installation](#)
- [3 Apply Hardware](#)
- [4 Apply Rail Assembly](#)
- [5 Apply Covers and Strike](#)
- [6 Documents / Resources](#)

### EX8300 Series Exit Device

**DIAGRAMS ARE NOT TO SCALE.**



**READ AND FOLLOW INSTRUCTIONS CAREFULLY.**

Incorrect installation or adjustment could cause damage or injury.

**Before Installation, Please Check:**

1. If Door is Fitted And Properly Hung.
2. Size Of Exit Device, Function And Design
  - 36" Doors, Can Be Cut To Fit Doors Down To 30" Wide.
  - 48" Doors, Can Be Cut To Fit Doors Down To 36" Wide.
  - Hand Of Device Against Application.

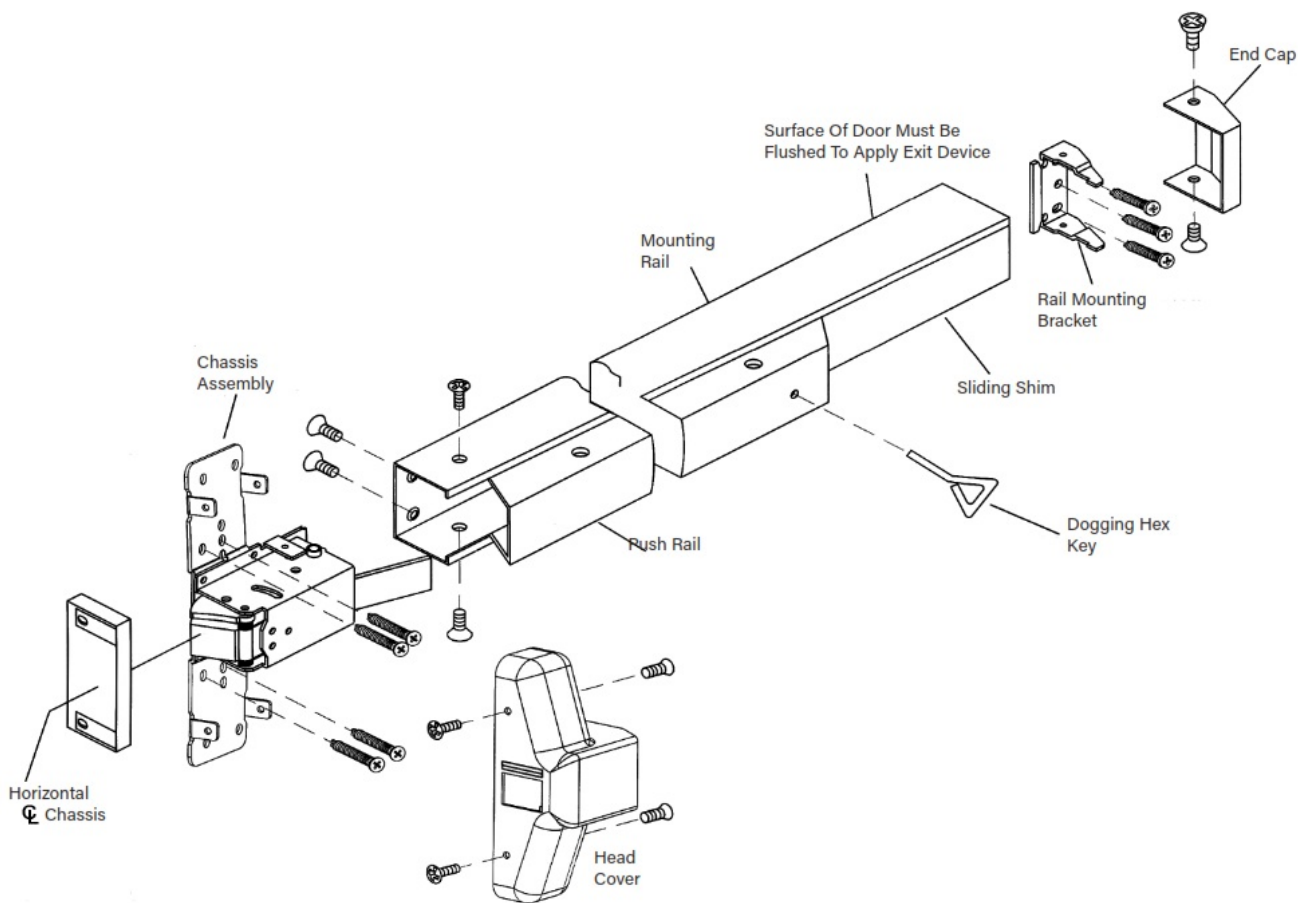

## Type of Installation

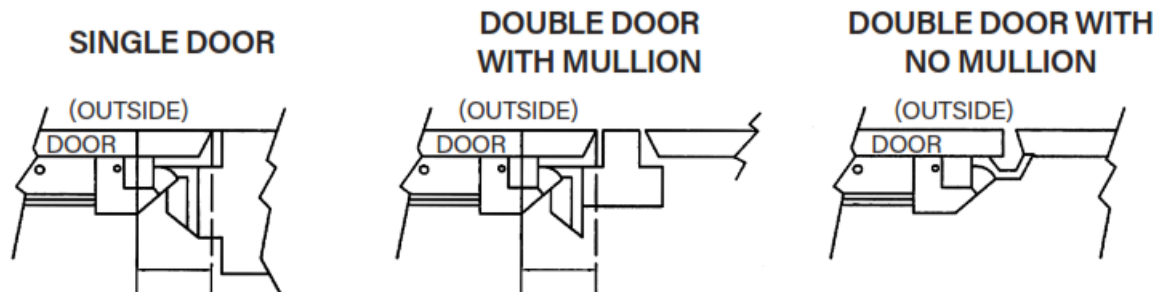

## Apply Hardware

### 2.1 Drill Holes

Mark door face and drill holes in accordance with the diameters suggested. See attached template.

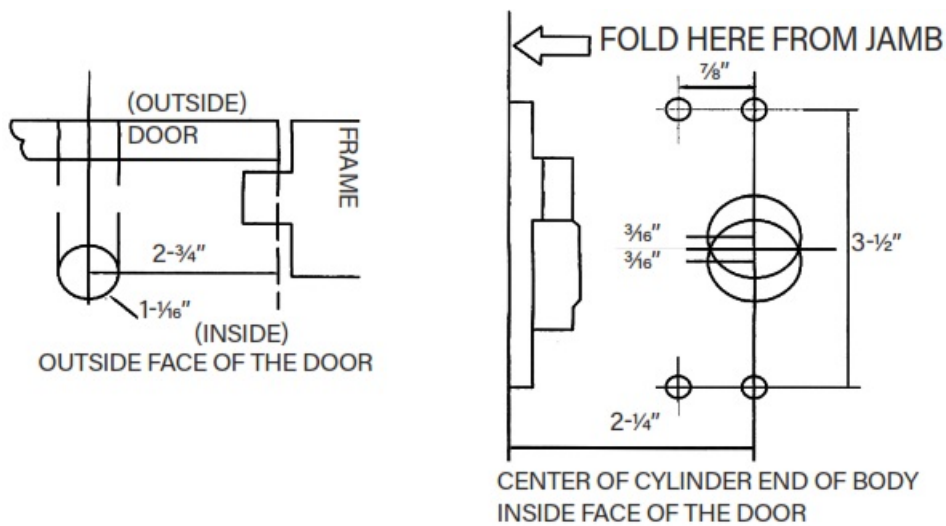

## 2.2 Install Cylinder

1. Insert the cylinder through Cyl Ring and hole in the door.
2. Keep the tail piece horizontal.
3. Mount liner on inside of door and
4. Tailpiece projection over inside of Door is suggested in the range  $\frac{9}{32}$ " –  $\frac{15}{32}$ ". If necessary, use a pliers to bend and cut to desired length.

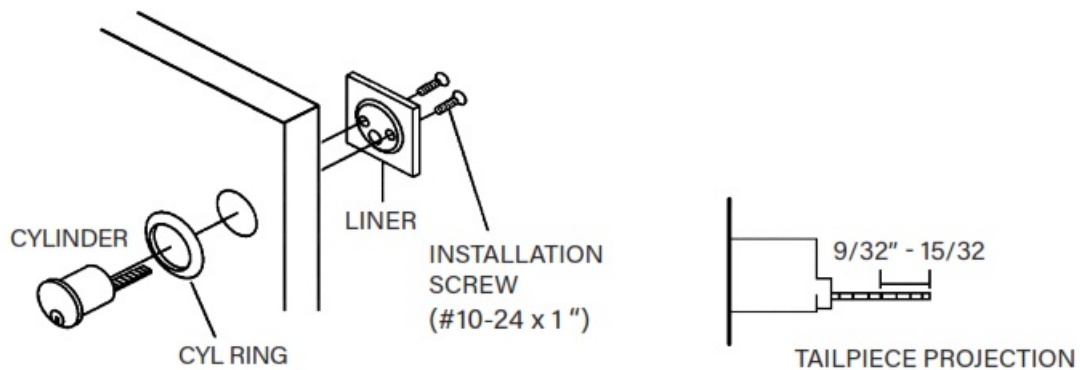

## 2.3 Install Lever, Knob, or Pull Trim

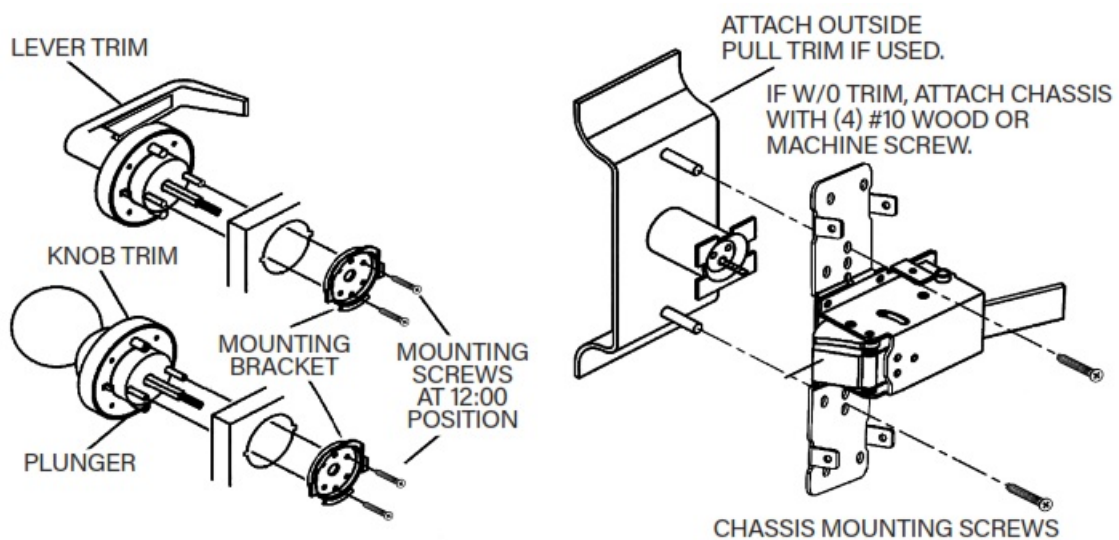

## Apply Rail Assembly

1. Check the size of device, if cutting to length is required.
2. Determine cut off length "x" by subtracting 1-3/4" From "y". Mark cut off point on mounting rail.

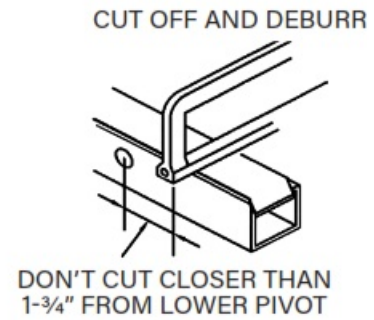
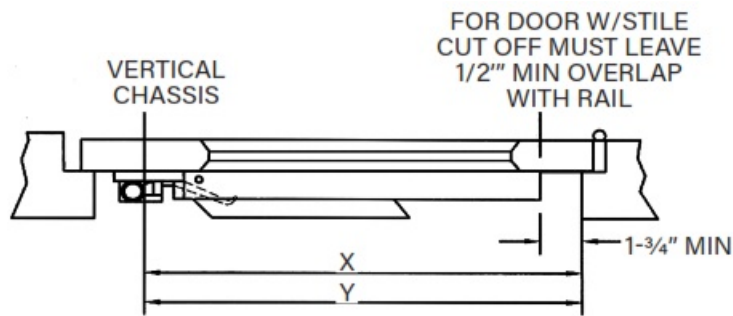

3. Depress arm into rail opening and slide rail onto chassis. Level rail and fasten chassis and mounting plate.

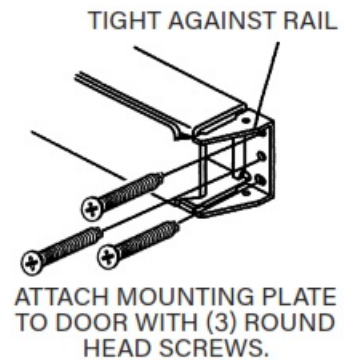
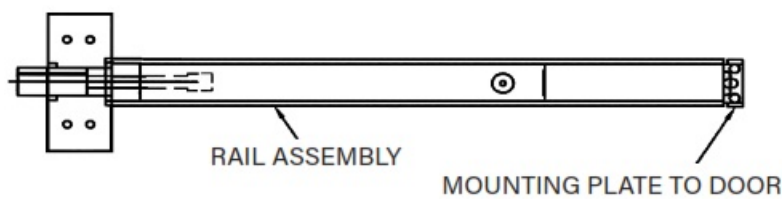

## Apply Covers and Strike

<p>ATTACH COVER TO CHASSIS WITH (4) #8 TRUSS HEAD MAC HINE SCREW</p>	<p>ATTACH END CAP TO MOUNTIN G PLATE WITH (2) COVER SCREWS.</p>	<p>ATTACH STRIKE TO DOOR STOP WI TH (2), STRIKE SCREW AND LOCK WASHER</p>

**ACTUAL SIZE TEMPLATE.**

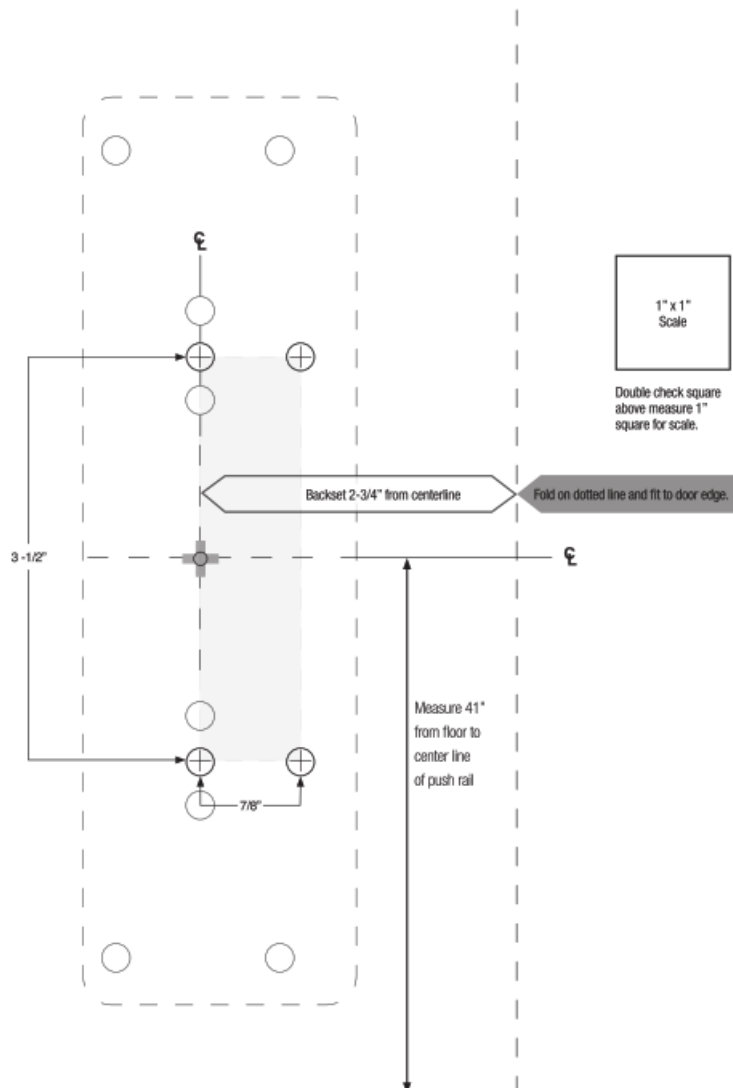

Tell Manufacturing

A Division of Spectrum Brands Inc.

1-800-433-4047

EX8300-2016

## Documents / Resources

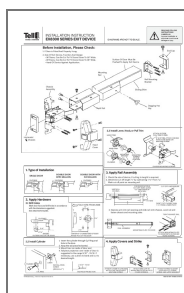

[Tell EX8300 Series Exit Device](#) [pdf] Instruction Manual  
EX8300 Series Exit Device, EX8300 Series, Exit Device, Device