



TELEPORT GLT/GLR User Guide

[Home](#) » [TELEPORT](#) » TELEPORT GLT/GLR User Guide 

tc electronic

Quick Start Guide

TELEPORT GLT/GLR

High-Performance Active Guitar Signal Transmitter for Long Cable Run Systems

Contents

- [1 Connection](#)
- [2 Getting Started](#)
- [3 Puesta en Marcha](#)
- [4 Specifications](#)
- [5 LEGAL DISCLAIMER](#)
- [6 LIMITED WARRANTY](#)
- [7 TELEPORT GLT/GLR](#)
- [8 TELEPORT GLT/GLR](#)
- [9 Documents / Resources](#)
 - [9.1 References](#)
- [10 Related Posts](#)

Connection

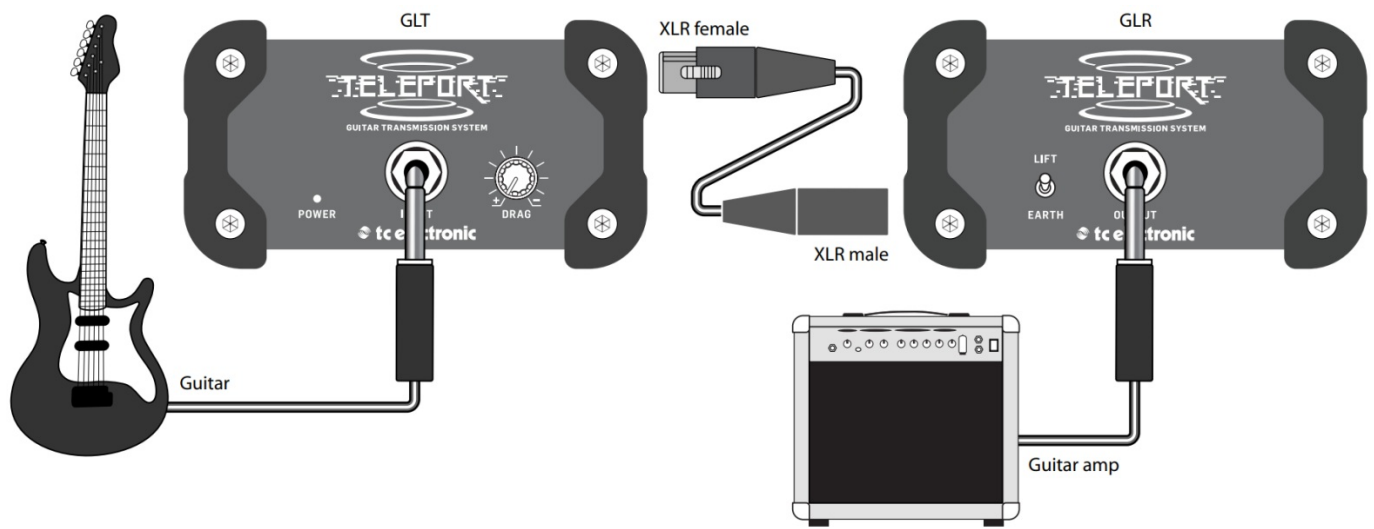

Getting Started

1. Connect the included power adaptor to the GLT power socket.
2. Connect your guitar to the GLT 1/4" input via a standard instrument cable.
3. Connect a balanced XLR cable from the GLT output to the GLR input.
4. With the amplifier turned off or in standby mode, connect a standard instrument cable from the GLR output to your amp's input.
5. Power on your amplifier.
6. Move the ground switch on the GLR to the LIFT position if the grounding noise is audible.
7. Adjust the DRAG control to simulate the loading that occurs when you connect directly into an amp at a close distance. More drag will simulate a longer cable.

Puesta en Marcha

1. Conecte el adaptador de corriente incluido a la toma de corriente GLT.
2. Conecte su guitarra a la entrada GLT de 1/4 "mediante un cable de instrumento estándar.
3. Conecte un cable XLR balanceado desde la salida GLT a la entrada GLR.
4. Con el amplificador apagado o en modo de espera, conecte un cable de instrumento estándar desde la salida GLR a la entrada de su amplificador.
5. Encienda su amplificador.
6. Mueva el interruptor de tierra en el GLR a la posición de ELEVACIÓN si el ruido de conexión a tierra es audible.
7. Ajuste el control DRAG para simular la carga que se produce cuando se conecta directamente a un amplificador a corta distancia. Más arrastre simulará un cable más largo.

Specifications

	GLR	GLT
Input		
Connector	XLR female, balanced	¼" TS, unbalanced
Impedance	180 kΩ	Adjustable 22 kΩ to >1 MΩ
Max. input level	—	+10 dBu @ 1 kHz
Output		
Connector	¼" TRS, unbalanced	XLR male, balanced
Impedance	200 kΩ	2 kΩ
Max. output level	—	+10 dBu @ 1 kHz
System		
Frequency response	10 Hz to 35 kHz (±3 dB)	10 Hz to 26 kHz (± 3 dB)
THD + N (distortion)	0.0015% @ 1 kHz, 0 dBu	0.05% @ 1 kHz, 0 dBu
Signal-to-noise ratio	110 dB @ 1 kHz, 0 dBu	90 dB @ 1 kHz, 0 dBu
CMRR	62 dB typical	—
Power requirement	Passive	12 V DC, 150 mA
Physical		
Dimensions (H x W x D)	64 x 118 x 112 mm (2.5 x 4.6 x 4.4")	
Weight	0.43 kg (0.9 lbs)	0.5 kg (1.1 lbs)

LEGAL DISCLAIMER

Music Tribe accepts no liability for any loss which may be suffered by any person who relies either wholly on or in part upon any description, photograph, or statement contained herein. Technical specifications, appearances, and other information are subject to change without notice. All trademarks are the property of their respective owners. Midas, Klark Teknik, Lab Gruppen, Lake, Tannoy, Turbosound, TC Electronic, TC Helicon, Behringer, Bugera, Oberheim, Auratone, Aston Microphones, and Coolaudio are trademarks or registered trademarks of Music Tribe Global Brands Ltd. © Music Tribe Global Brands Ltd. 2021 All rights reserved.

LIMITED WARRANTY

For the applicable warranty terms and conditions and additional information regarding Music Tribe's Limited Warranty, please see complete details online at musictribe.com/warranty.

FEDERAL COMMUNICATIONS COMMISSION COMPLIANCE INFORMATION

TC Electronic

TELEPORT GLT/GLR

Responsible Party Name:	Music Tribe Commercial NV Inc.
Address:	5270 Procyon Street, Las Vegas NV 89118, United States
Phone Number:	+1 702 800 8290

TELEPORT GLT/GLR

This equipment has been tested and found to comply with the limits for a Class B digital device, pursuant to part 15 of the FCC Rules. These limits are designed to provide reasonable protection against harmful interference in a residential installation. This equipment generates, uses, and can radiate radio frequency energy and, if not installed and used in accordance with the instructions, may cause harmful interference to radio communications. However, there is no guarantee that interference will not occur in a particular installation. If this equipment does cause harmful interference to radio or television reception, which can be determined by turning the equipment off and on, the user is encouraged to try to correct the interference by one or more of the following measures:

- Reorient or relocate the receiving antenna.
- Increase the separation between the equipment and receiver.
- Connect the equipment into an outlet on a circuit different from that to which the receiver is connected.
- Consult the dealer or an experienced radio/TV technician for help.

This device complies with Part 15 of the FCC rules. Operation is subject to the following two conditions:

1. this device may not cause harmful interference, and
2. this device must accept any interference received, including interference that may cause undesired operation.

Operation Ambient Temperature up to 45°C

Important information:

Changes or modifications to the equipment not expressly approved by Music Tribe can void the user's authority to use the equipment.



Hereby, Music Tribe declares that this product is in compliance with Directive 2014/35/EU, Directive 2014/30/EU, Directive 2011/65/EU, and Amendment 2015/863/

EU, Directive 2012/19/EU, Regulation 519/2012 REACH SVHC and Directive 1907/2006/EC.

Full text of EU DoC is available at <https://community.musictribe.com/>

EU Representative: Music Tribe Brands DK A/S

Address: Ib Spang Olsens Gade 17, DK – 8200 Aarhus N, Denmark

tc electronic

Documents / Resources



[TELEPORT TELEPORT GLT/GLR \[pdf\] User Guide](#)
TELEPORT, GLT, GLR, High-Performance, Active, Guitar Signal Transmitter, Long Cable Run Systems

References

-  [Music Tribe](#)