



# TEKONSHA 118871 T-One T-Connector Harness 4-Way Flat with Circuit Protected ModuLite HD Module Instruction Manual

[Home](#) » [TEKONSHA](#) » TEKONSHA 118871 T-One T-Connector Harness 4-Way Flat with Circuit Protected ModuLite HD Module Instruction Manual 

## Contents

- [1 TEKONSHA 118871 T-One T-Connector Harness 4-Way Flat with Circuit Protected ModuLite HD Module](#)
- [2 Installation Instructions](#)
- [3 Documents / Resources](#)
- [4 Related Posts](#)



## TEKONSHA 118871 T-One T-Connector Harness 4-Way Flat with Circuit Protected ModuLite HD Module



### WARNING

- ALWAYS read and follow all warnings and instructions included with the purchase before beginning installation. Keep for future reference.
- DO NOT exceed lower of towing manufacturing rating (including in your vehicle owner's manual) or specific amperage ratings stated on product.
- ALWAYS read, understand and follow all warnings and instructions printed on tow vehicle's battery.
- ALWAYS wear safety glasses and use all safety precautions during installation.

### TOOLS REQUIRED:

Trim Panel Remover, 10mm Socket or Wrench, Drill (3/32" Drill Bit), Wire Crimpers, Wire Cutters, Philips Head Screwdriver, Test-probe

## Installation Instructions

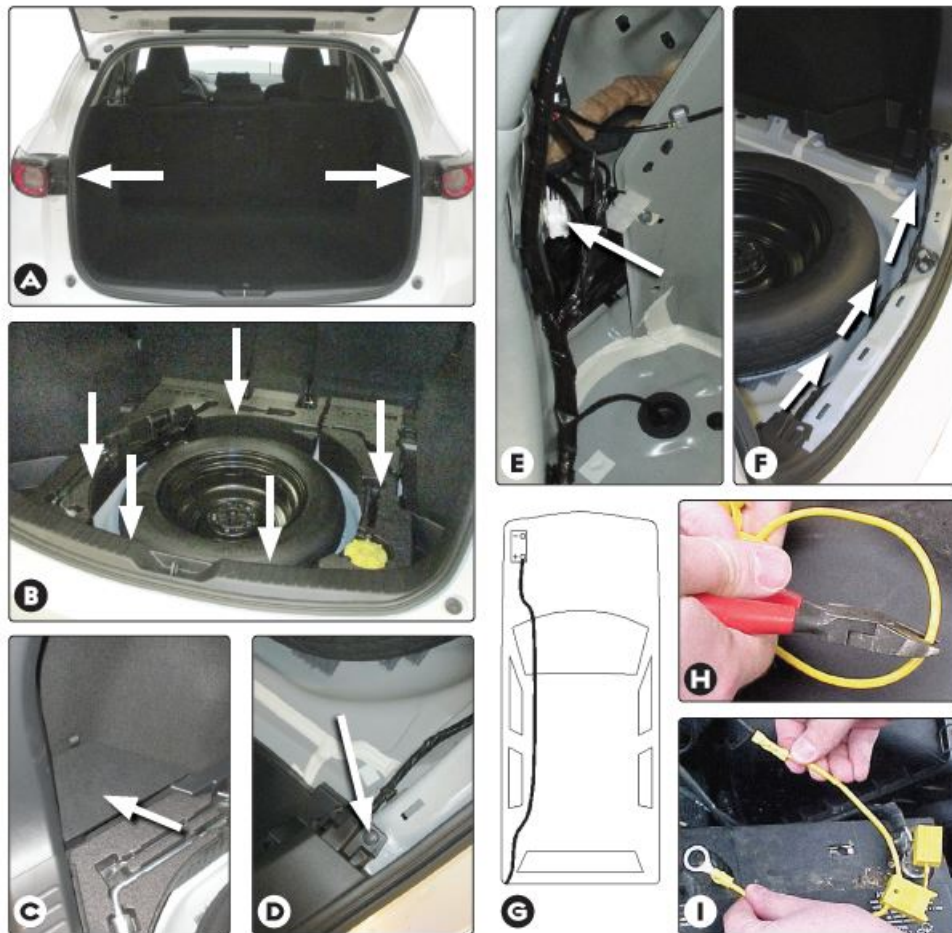

1. Open the rear hatch. Temporarily remove the rear threshold plate, privacy screen, storage covers and floor covering. Open rear door and fold rear seat forward. On the driver and passenger side, partially pull back the felt side panels to expose the vehicle wiring connectors. **Abcd**
2. On the driver and passenger sides of the vehicle, locate the mating vehicle's taillight wiring harness connectors to the T-One® T-Connector ends. Separate this connector, being careful not to break the locking tabs. **E**
3. On the driver's side, insert the T-One® T-Connector end with the yellow wire between the vehicle wiring connectors and lock into place. Be careful not to damage the locking tabs and insure that connectors are fully inserted with locking tabs in place.
4. On the Driver's Side, mount the T-One® Connector black box using the double-sided tape provided. Secure the remainder of the T-One® Connector harness with the cable ties provided, to prevent damage or rattling and being careful to avoid any areas that would cut or pinch the wire.
5. Locate a suitable grounding point near the black box such as an existing ground stud or drill a 3/32" hole and secure the white wire using the eyelet and screw provided. Clean dirt and rustproofing from area.

### CAUTION

Verify what is behind any surface prior to drilling to avoid damage to the vehicle and/or personal injury. Do not drill into any exposed surfaces.

6. Route the connector containing the green wire across the threshold and behind the passenger's side felt panel to the taillight pocket. **F**
7. On the passenger's side, insert the T-One®

T- The connector end with the green wire, between the vehicle wiring connectors and lock into place. Be careful not to damage the locking tabs and insure that connectors are fully inserted with locking tabs in place.

**E**

8. Disconnect the vehicle's Negative (-) battery cable. If not removed, remove the fuse from the yellow fuse holder (provided). After cutting the fuse holder wire, attach the ring terminal and secure to the vehicle's Positive (+) battery cable. Connect the other end of the fuse holder to the black 12 ga. wire, using the yellow butt connector (provided). **HI**
9. Beginning from the front of the vehicle, route the black 12 ga. wire rearward along the frame rail avoiding any hot pipes, heat shields, the fuel tank or any other points that may pinch or break the wire.
10. Connect the other end of the black 12 ga. wire to the black power wire located on the T-One® T-Connector's black box, using the yellow butt connector (provided).
11. Reconnect the vehicle's Negative (-) battery cable and install the 15 amp fuse into the fuse holder from step 8.

#### **WARNING**

Read and follow all warnings and cautions printed on the tow vehicle's battery. All connections must be complete for the T-One® Connector to function properly. Test and verify the installation with a test light or trailer once installed. For the initial test, reset the vehicle's electrical system by temporarily removing the key from the ignition.

12. Reinstall the plastic trim panels, threshold, floor covering and other items that may have been removed during installation, being careful not to pinch or cut the wires.

#### **NOTE**

Store 4-Flat connector in rear cargo area when not in use.

#### **WARNING**

When a 4-Flat connector in use, be careful not to pinch the harness in door latch.

#### **WARNING**

Overloading circuits can cause fires. DO NOT exceed stated product ratings. Read the vehicle's owner's manual & instruction sheet for additional information.

## **Documents / Resources**

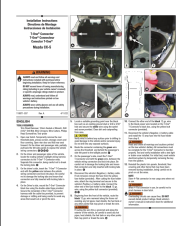
	<p><a href="#">TEKONSHA 118871 T-One T-Connector Harness 4-Way Flat with Circuit Protected ModuLite HD Module</a> [pdf] Instruction Manual</p> <p>118871, T-One T-Connector Harness 4-Way Flat with Circuit Protected ModuLite HD Module, 118871 T-One T-Connector Harness 4-Way Flat with Circuit Protected ModuLite HD Module</p>
---	---