

**TEHOME
GC00103 Mounting
Template**



TEHOME GC00103 Mounting Template Instructions

[Home](#) » [TEHOME](#) » TEHOME GC00103 Mounting Template Instructions 

Contents

- [1 TEHOME GC00103 Mounting Template](#)
- [2 Product Usage Instructions](#)
- [3 FAQ](#)
- [4 Contents](#)
- [5 Installation Instructions](#)
- [6 Cleaning](#)
- [7 CONTACT](#)
- [8 Documents / Resources](#)
 - [8.1 References](#)

TEHOME

TEHOME GC00103 Mounting Template



Product Usage Instructions

- Paste the position map horizontally on the desired position for installation and mark it with a pencil.
- Drill two 1/8 pilot holes in the wall for each plate.
- Screw the plastic anchors into the holes until flush.
- Screw the screws into anchors until 1/4 inch from the wall.
- Avoid using commercial or abrasive cleaners. Use only a soft damp cloth to preserve the finish of the mirror.

FAQ

• Missing Parts

- If you are missing hardware, please check the red bag carefully packed within the styrofoam. If the parts are still missing, contact us for a replacement.

• Other Wall Types

- If you have a wall other than drywall, please consult your local hardware store for suitable mounting hardware.

Contents

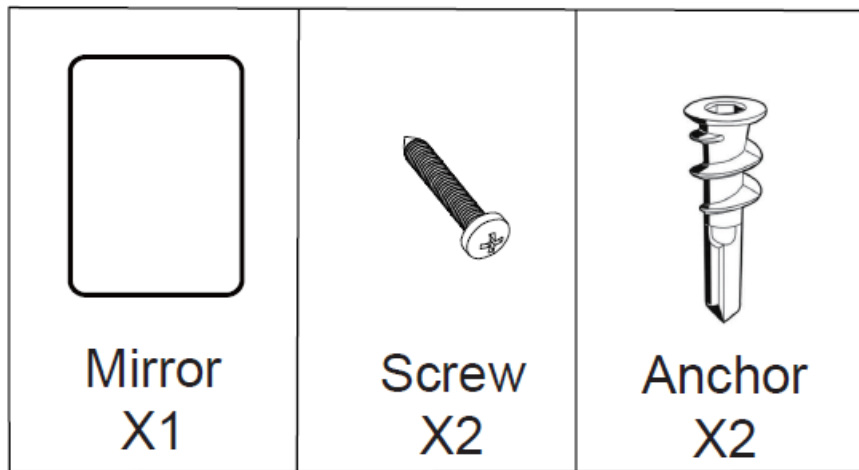

Missing Hardware

- The parts are been carefully packed within a red bag and inserted in the styrofoam.
- Please check again in case you do not find the parts.
- If your order indeed arrives with missing hardware, please do not worry, and feel free to reach out to us for help, we will ship you the replacement ASAP.

Questions, problems, missing parts?

Installation Instructions

The hardware included with this item is meant for drywall mounting only. If other wall types, please consult your local hardware store for assistance

- Paste the position map horizontally on the position to be installed and mark it with a pencil.

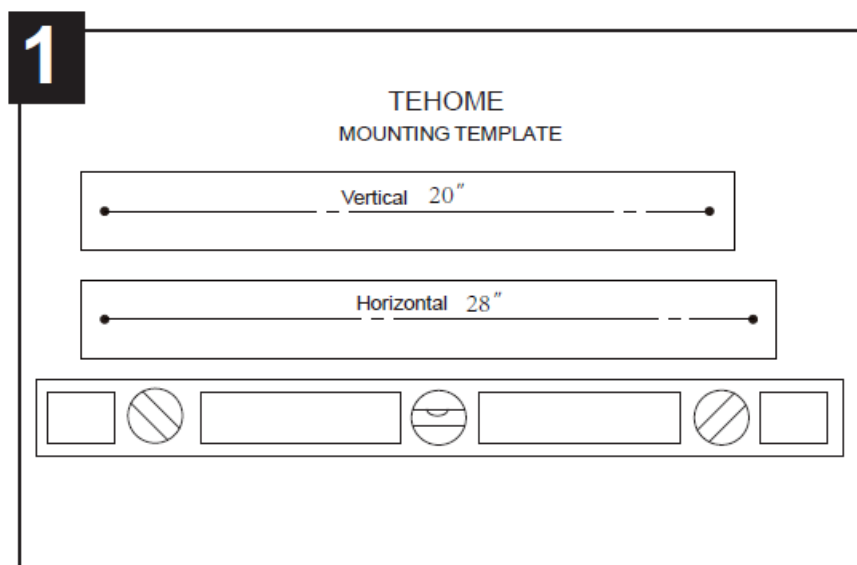

- Drill two 1/8" pilot holes in wthe all for each Plate.
- Screw the plastic Anchors into the holes until flush.
- Screw the screws into the Anchors until 1/4" from the wall.

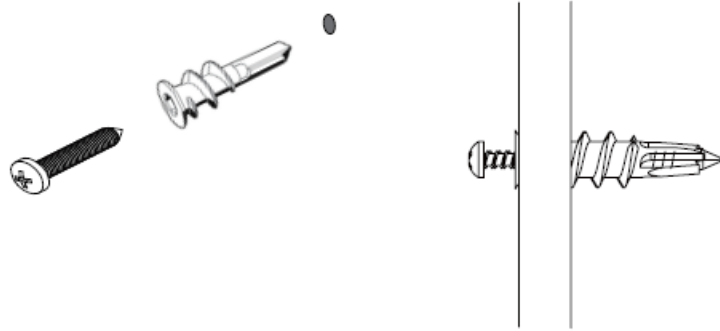
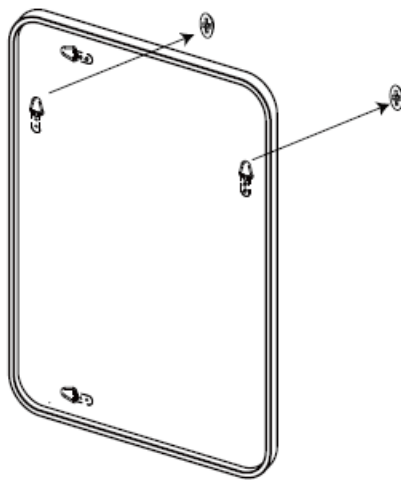
2**3**

Cleaning

- Avoid using commercial or abrasive cleaners.
- Using only a soft damp cloth will preserve the finish.

CONTACT

- <https://www.tehomemirrors.com>
- service@tehomemirrors.com

Documents / Resources

	<p>TEHOME GC00103 Mounting Template [pdf] Instructions GC00103 Mounting Template, GC00103, Mounting Template, Template</p>
--	---

References

- [User Manual](#)

[Manuals+](#), [Privacy Policy](#)

This website is an independent publication and is neither affiliated with nor endorsed by any of the trademark owners. The "Bluetooth®" word mark and logos are registered trademarks owned by Bluetooth SIG, Inc. The "Wi-Fi®" word mark and logos are registered trademarks owned by the Wi-Fi Alliance. Any use of these marks on this website does not imply any affiliation with or endorsement.