

TECWARE
Flex RGB
Extension
Cables



TECWARE Flex RGB Extension Cables User Guide

[Home](#) » [TECWARE](#) » TECWARE Flex RGB Extension Cables User Guide 

Contents

- [1 TECWARE Flex RGB Extension Cables](#)
- [2 Product Display and Accessories](#)
- [3 INSTRUCTIONS](#)
- [4 Documents / Resources](#)
 - [4.1 References](#)



TECWARE Flex RGB Extension Cables



Product Display and Accessories

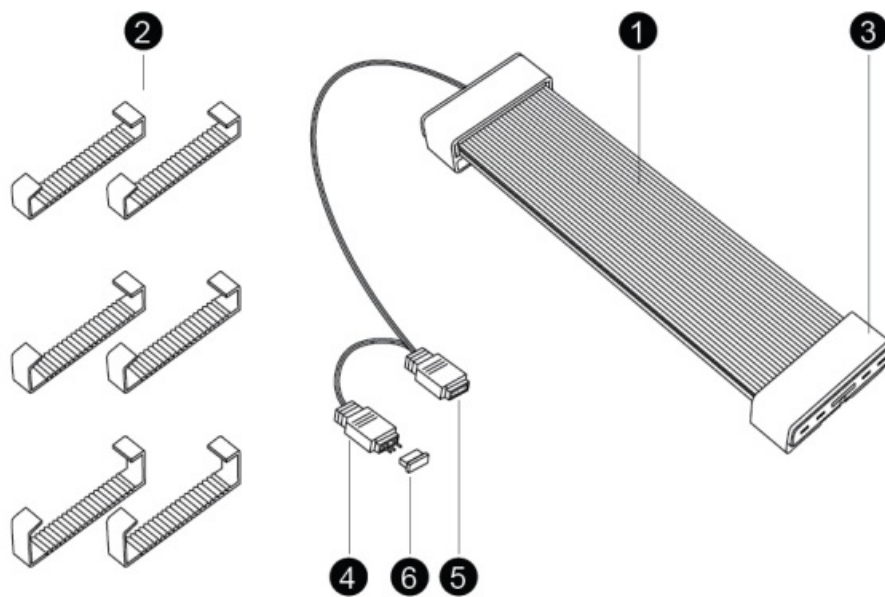

- Silicone Light Board
- 2 Cable Brace: Model A, B, C
- 3 Fixed Plastic Shell
- 5V ARGB 3-pin Connector (Male)

- 5 5V ARGB 3-pin Connector (Female)
- 6 3pin Connector Protection Car

How to Select Cable Brace:

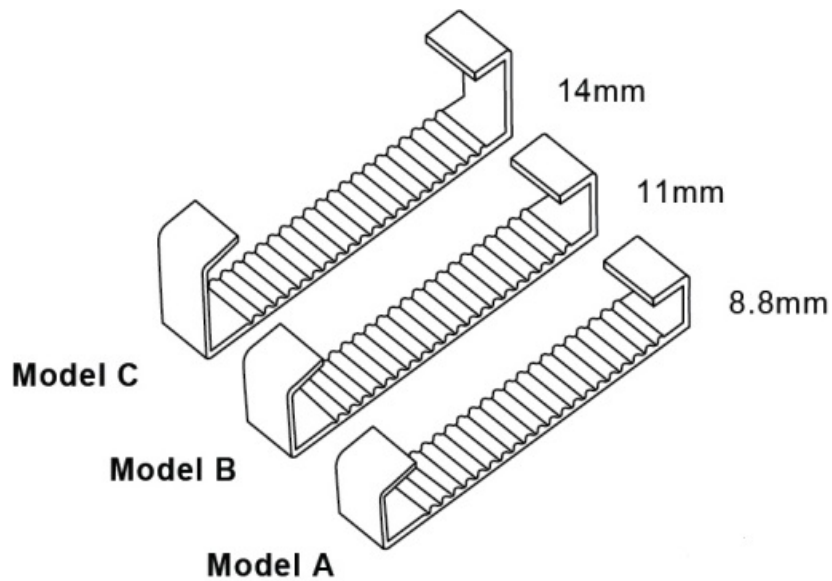

- **Model A:** Suitable for cable diameter within 2mm
- **Model B:** Suitable for cable diameter of 2mm – 3.4mm
- **Model C:** Suitable for cable diameter of 3.4mm – 6mm

INSTRUCTIONS

STEP 1: How to Use

- Follow the arrows. Install the wire to both ends of the silicone fastener in an orderly manner.

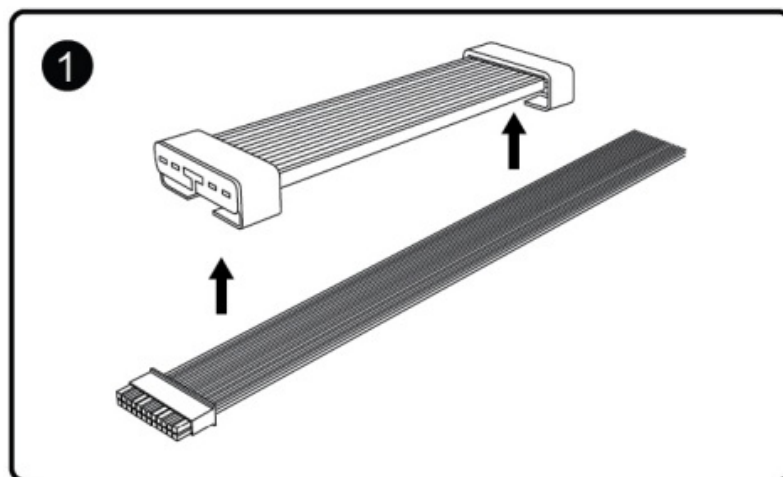

STEP 2: Install the cable management clip

- Choose two or more suitable cable management clips and buckle them from the back of the wire to the appropriate position of the ARGB light board.

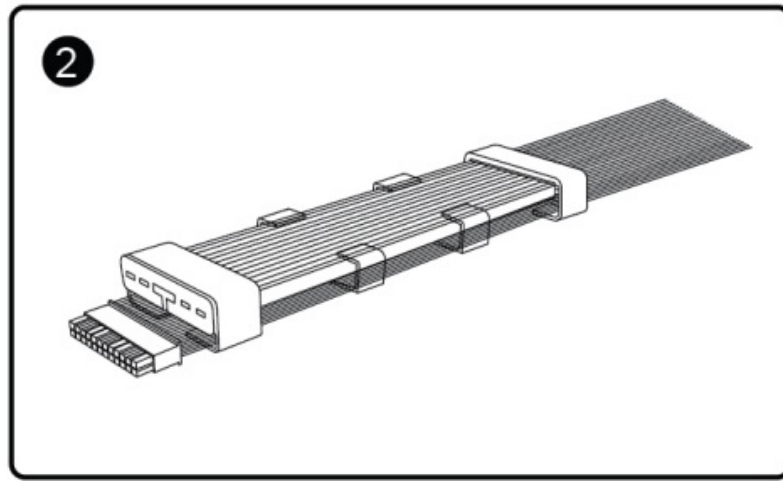

STEP 3: Connect to the motherboard or graphics card

- Connect the wire to the corresponding motherboard interface. After plugging it in, adjust the bending shape. Install other cables for the graphic card in the same way.

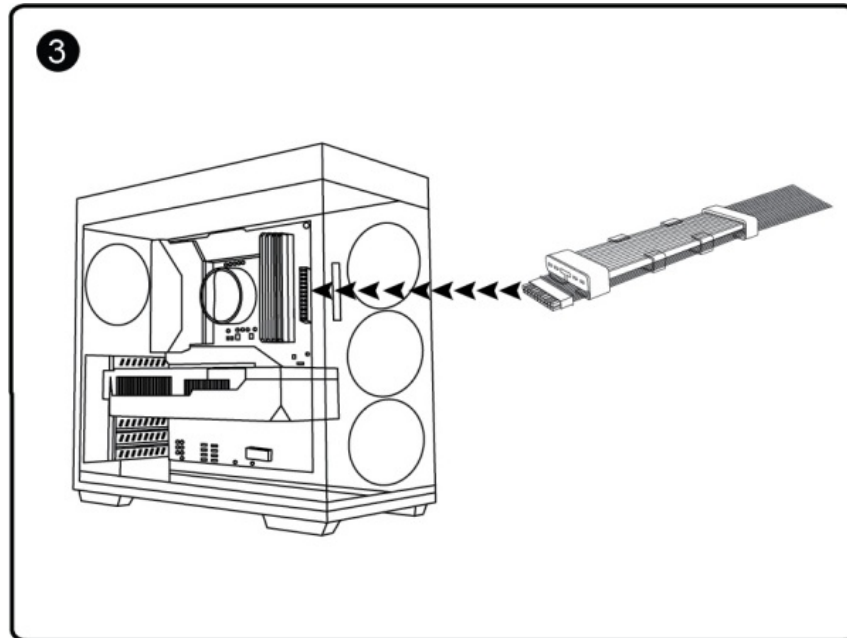

Installation Effect Display

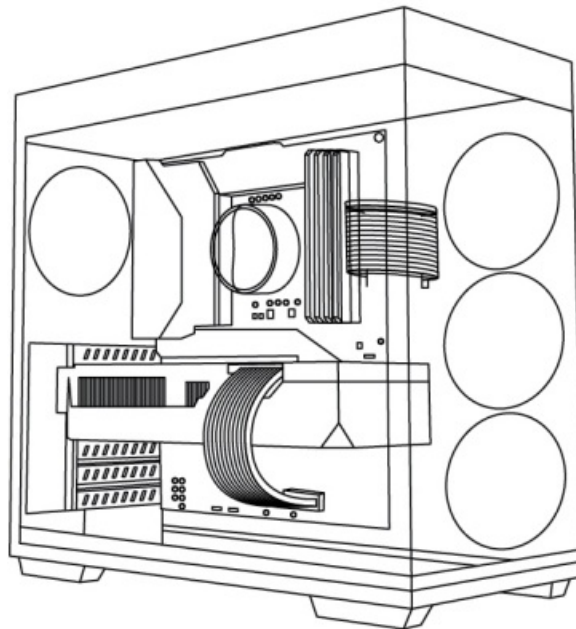

- With the above method, you can install it to the extension cable or module cable to make the chassis neater and enjoy the perfect lighting effect!

How to supply power?

MODE 1:

- Connect the 5V 3pin ARGB interface of the light board to the 5V 3pin port on the motherboard. (Power off operation)
- It can be connected in series with other ARGB illuminated products via 5V 3pin male or female connector to illuminate together.
- When the pin connector is not used, it must be covered with an insulating cap to prevent short circuit

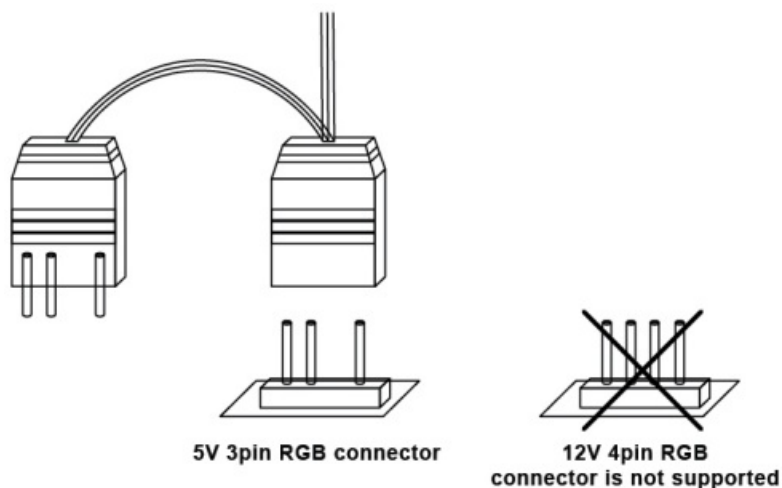

MODE 2:

- If the motherboard does not have a 5V 3pin ARGB connector you can connect the 5V 3pin ARGB female connector to 2 controllers with a 5V 2pin ARGB male connector to light up and control the light

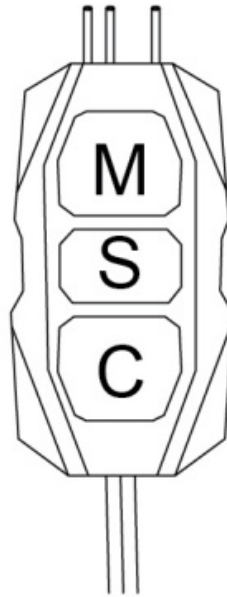

SATA ARGB controller 5V 3pin male

Package Contents

- 1 x TECWARE FLEX RGB Motherboard Cable (24-pin) 80 LED
- 1 x TECWARE FLEX RGB GPU Cable (8-pin/16-pin) 81 LED
- 6 x Cable Brace for Motherboard (24-pin)
- 6 x Cable Brace for GPU (8-pin / Dual 8-pin / 16-pin)

Warranty

- 1 Year. Please contact your local distributor for support.

Contact

- www.tecware.co

Documents / Resources



[TECWARE Flex RGB Extension Cables](#) [pdf] User Guide
Flex RGB Extension Cables, RGB Extension Cables, Extension Cables, Cables

References

- [User Manual](#)

[Manuals+](#), [Privacy Policy](#)

This website is an independent publication and is neither affiliated with nor endorsed by any of the trademark owners. The "Bluetooth®" word mark and logos are registered trademarks owned by Bluetooth SIG, Inc. The "Wi-Fi®" word mark and logos are registered trademarks owned by the Wi-Fi Alliance. Any use of these marks on this website does not imply any affiliation with or endorsement.