



# TechToy E27 Smart Wi-Fi LED Bulb Instruction Manual

[Home](#) » [TechToy](#) » TechToy E27 Smart Wi-Fi LED Bulb Instruction Manual 

## Contents

- [1 TechToy E27 Smart Wi-Fi LED Bulb](#)
- [2 Technical Specifications](#)
- [3 Usage Instructions](#)
- [4 OPERATING INSTRUCTIONS](#)
- [5 FAQ](#)
- [6 Technical Specification](#)
- [7 INFORMATION ABOUT DISPOSAL AND RECYCLING](#)
- [8 EU DECLARATION OF CONFORMITY](#)
- [9 Documents / Resources](#)
  - [9.1 References](#)
- [10 Related Posts](#)

# TechToy

**TechToy E27 Smart Wi-Fi LED Bulb**



The Smart Wi-Fi LED is a smart bulb or strip that can be controlled through a mobile app and voice assistants like Amazon Alexa and Google Assistant.

### Technical Specifications

- **Power/Lumen Output:** E27: 11W/1050lm, E14: 4.5W/350lm, GU10: 4.5W/350lm
- **Colour Temperature:** 2700K – 6500K + RGB
- **Mains:** 220-240 VAC / 50Hz
- **Radio Wi-Fi/BLE:** 2.405 – 2.483 GHz

### Usage Instructions

1. Create a new account or log in to your existing account on the mobile app.
2. Make sure Bluetooth is turned on in your smart device before connecting to the Smart Wi-Fi LED.
3. Screw in the lamp in a socket and turn on the power. If the light does not flash, turn the power off-on-off-on-off-on until it flashes.
4. Add the Smart Wi-Fi LED by clicking on the '+' button in the app.
5. Confirm your Wi-Fi network and password to connect the Smart Wi-Fi LED to your home network.
6. Name the unit, which will be used when addressing the device through voice assistants.
7. Configure and share your system with family and friends using the mobile app.
8. Connect voice assistants like Amazon Alexa and Google Assistant to control your lighting by choosing a unit to connect and selecting the voice assistant in the app.

## OPERATING INSTRUCTIONS

### Techtoy Wi-Fi LED bulb

Bulb can be controlled through an App „Tesla Smart“. In the App, you can setup your device and create scenarios and schedules for your lighting.

#### App Tesla Smart Information

Search and download the free app “Tesla Smart” on Android or iOS. System requirement for use of the

- **App:** iOS 8.0 or higher
- **Android:** 4.4 or higher

### Usage and connection

Download and install the app „Tesla Smart“ from the „Apple App Store or Google Play“ on your smart device. Scan the QR code below for a direct link to the App.

**Launch the „Tesla Smart“ app.**

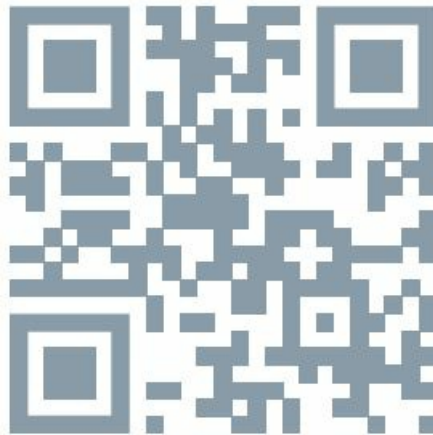

Create a new account or log in to your existing account. Make sure Bluetooth is turned on in your smart device, as its necessary for the connection. Screw in the lamp in a socket, turn on the power. If the light does not flash: Turn the power off – on – off – on – off – on. When the light flashes, smart bulb or strip will appear in the app. If smart bulb or strip does not show up, press „+“ in the upper right corner.



Add smart bulb or strip by clicking on „+“

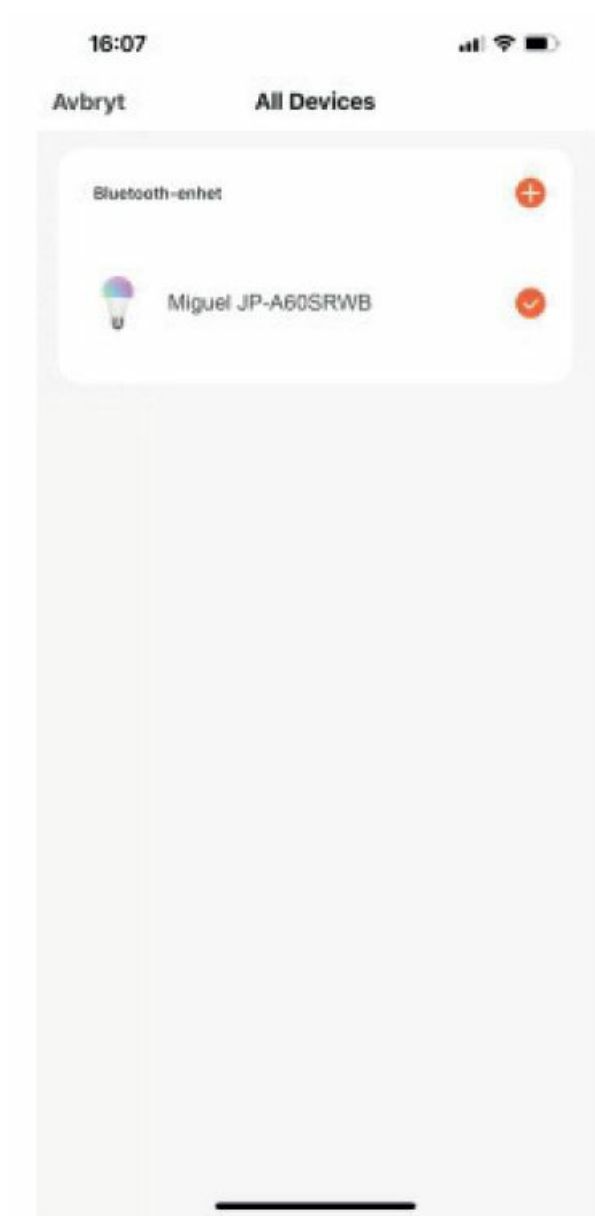

Confirm Wi-Fi network and password.

13:29



Cancel

All devices

Bluetooth device



DGB 182

### Enter Wi-Fi Password

Only 2.4 GHz Wi-Fi networks  
are supported



WittyWLAN



\*\*\*\*\*



Cancel

Confirm

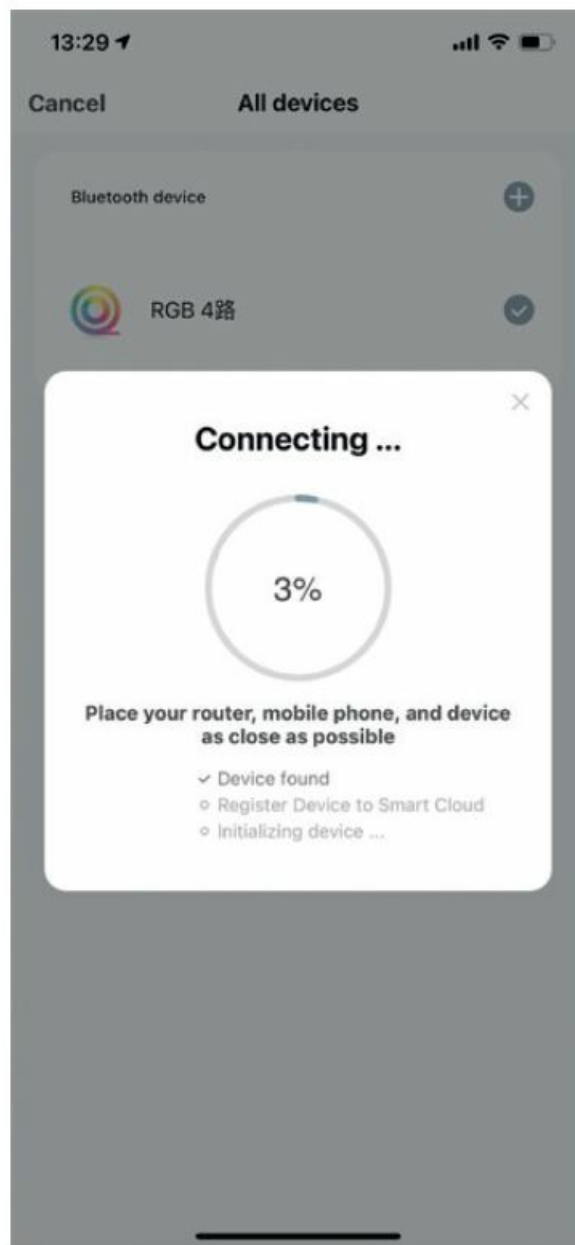

Name the unit, please observe that this will be the same name used when addressing the device from your voice assistants.

16:09



Klart

Added.



Miguel JP-A60SRWB

Tillägg av enheten lyckades.

Living Room

Now you can configure and share your system with family and friends. You can also connect voice assistants like amazon alexa and google assistant to control your Lighting.

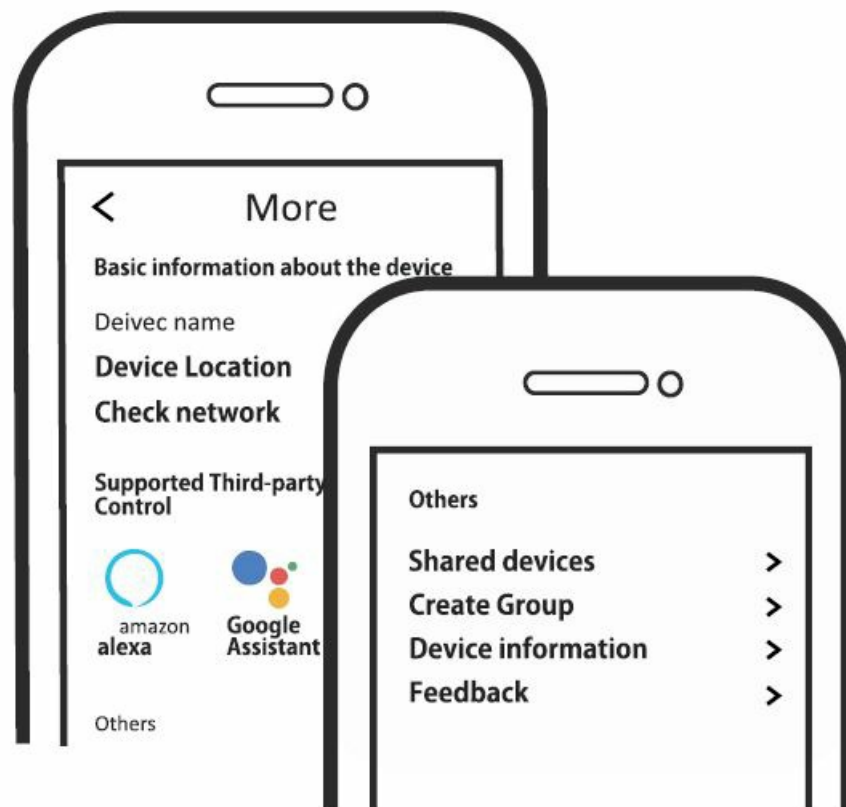

### Connecting Voice Assistants

Choose a unit to connect to a voice Assistant. Press the pencil to see the unit information.

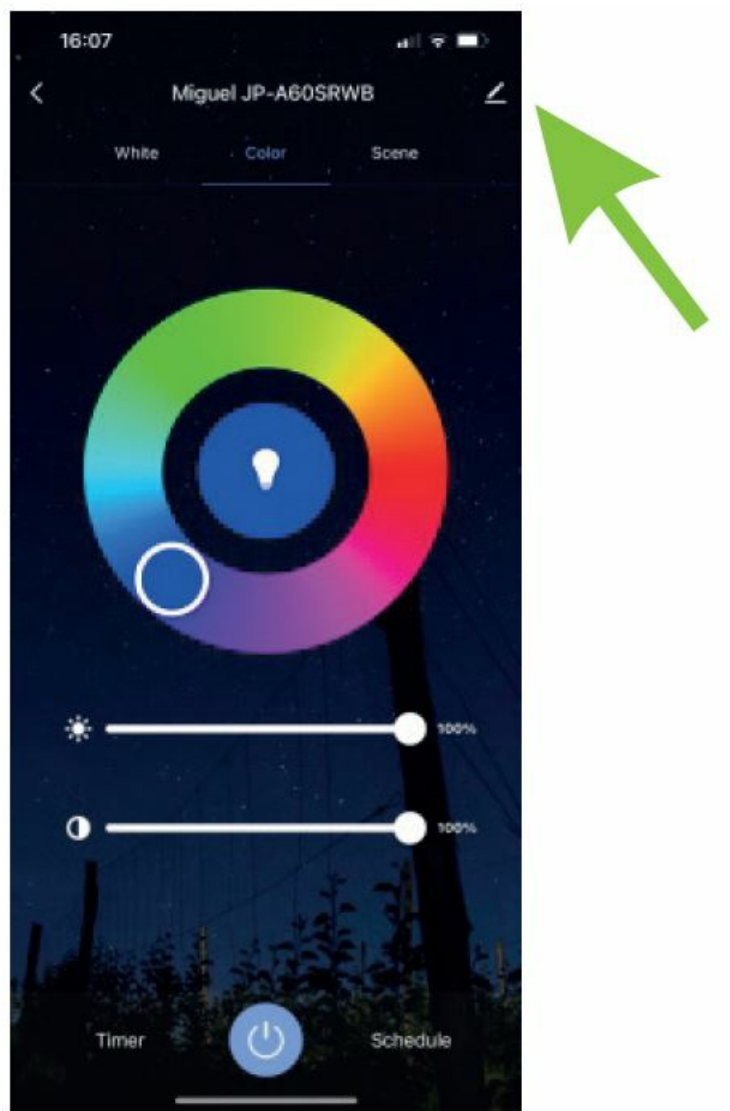

Choose which Voice Assistants to connect to.



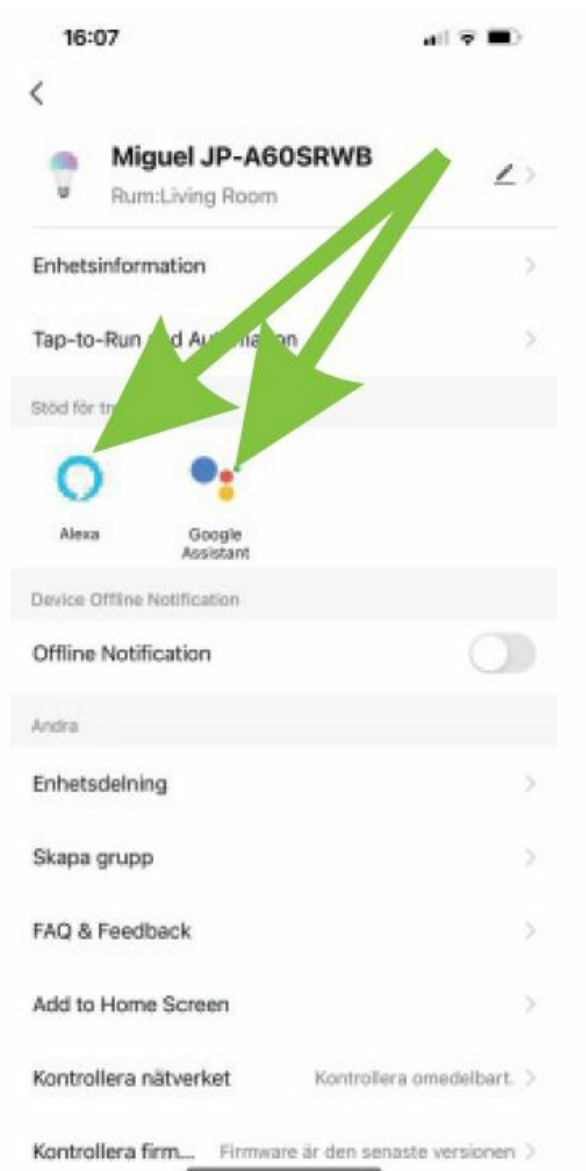

## CAUTION

RISK OF ELECTRIC SHOCK DO NOT OPEN

To reduce the risk of electric shock this product should only be opened by an authorized person. Unplug the power cord from the wall outlet, if any problems arise. Read the operating instructions carefully before use. Keep the instructions for use for future needs. Use the device only for its intended purpose. Do not use the device if any part is damaged or incorrect. If the device is damaged or incorrectly, it must be replaced immediately. The device is for indoor use only. Do not use the device outdoors. Do not expose the product to water or moisture. Do not touch the device with wet hands. Make sure the base of the bulb matches the lamp holder.

## FAQ

- **Q1:** What do you do if a smart bulb does not connect to your Wi-Fi?
- Check that the smart bulb or strip is properly connected and has power.
- Make sure Bluetooth is enabled on your mobile / tablet.
- Make sure that the smart bulb or strip and mobile / tablet are connected to the same network.
- Are the devices connected to the internet?
- Check that the password for your Wi-Fi is entered correctly.
- Check that any firewall is not blocking traffic.
- What happens if my Wi-Fi connection is lost?

- The smart bulb/strip must be connected to Wi-Fi to be controlled via the App.
- How to change the Wi-Fi network or password for Wi-Fi? Repeat the pairing process from step 5.
- How do you reset the smart bulb/strip?
- Switch the power to the luminaire on/off 3 times in quick succession (OFF-ON-OFF-ON-OFF-ON), then wait 1-3 seconds until smart bulb / strip starts flashing.

## Technical Specification

- **Power / Lumen Output:** (: 11W/1050lm) / (E14: 4,5W/350lm) / (GU10: 4,5W/350lm)
- **Colour temperature:** 2700K – 6500K + RGB
- **Mains:** 220-240 VAC / 50Hz
- **Radio Wi-Fi/BLE:** 2.405 – 2.483 GHz <20dBm
- **Operating temperature:** -10C to +40C
- **Radio Range (max):** 100m outdoor, 20m indoor

## Radio Standard

- ETSI EN 300 328 V2.2.2 (2019-07)

## EMC Standard

- EN 301489-1 V2.1.1 (2017-02),
- EN 301489-17 V3.1.1 (2017-02)
- **EN 55015:**2013 + A1:2015,
- **EN 61547:**2009

## Safety Standard (LVD)

- **IEC 60669-2-1:**2002/AMD1:2008/AMD2:2015
- **IEC 60669-1:**1998/AMD1:1999/AMD2:2006
- **EN 60669-2-1:**2004+A1:2009+A12:2010,
- **EN 60669-1:**2018,EN 62311:2008

## RoHS Standard

- 2011/65/EU,(EU) 2015/863

## Radio Equipment (RED)

- Complies with 2014/53/EU Directive

## INFORMATION ABOUT DISPOSAL AND RECYCLING

This product is marked with the symbol for a separate collection. The product must be disposed of in accordance with the regulations for disposal of electrical and electronic equipment (Directive 2012/19/ EU on waste electrical

and electronic equipment). Disposal together with regular municipal waste is prohibited. Dispose of all electrical and electronic products in accordance with all local and European regulations at the designated collection points which hold the appropriate authorization and certification in line with the local and legislative regulations. Correct disposal and recycling help to minimise impacts on the environment and human health. Further information regarding disposal can be obtained from the vendor, authorized service center, or local authorities.

## EU DECLARATION OF CONFORMITY

Witty, s.r.o declares that the radio equipment type E3W401, E3W403, LZW33, SHW83, BAW542 is in compliance with EU directives. The full text of the EU declaration of conformity is available at the following internet address: [teslasmart.com/declaration](http://teslasmart.com/declaration)

- **Connectivity:** Bluetooth, Wi-Fi 2.4 GHz
- **Frequency band Wi-Fi:** 2.412 – 2.484 GHz
- **Frequency band Bluetooth:** 2.400 GHz – 2,4835 GHz
- **Max. radio-frequency power (EIRP):** < 20 dBm



## Manufacturer

- Witty, s.r.o.
- Průmyslová 1472/11,
- 102 00 Praha 15
- [www.wittytrade.cz](http://www.wittytrade.cz).

## Documents / Resources

	<p><a href="#">TechToy E27 Smart Wi-Fi LED Bulb</a> [pdf] Instruction Manual E27 Smart Wi-Fi LED Bulb, E27, Smart Wi-Fi LED Bulb, Wi-Fi LED Bulb, LED Bulb, Bulb</p>
---	--

## References

-  [TESLA | Smart home in your hands](#)
-  [Sign in to your account](#)
-  [Vyhledání servisního střediska | Witty s.r.o.](#)