



tecnoswitch TE315 Recessed Touch Thermostat User Guide

[Home](#) » [tecnoswitch](#) » technoswitch TE315 Recessed Touch Thermostat User Guide

Contents [[hide](#)]

- 1 [tecnoswitch TE315 Recessed Touch Thermostat](#)
- 2 [COMMAND AND INDICATIONS](#)
- 3 [WARNINGS BEFORE INSTALLATION](#)
- 4 [INSTALLATION](#)
- 5 [FRONT PANEL REPLACEMENT](#)
- 6 [ELECTRICAL CONNECTIONS](#)
- 7 [FACTORY SETTINGS](#)
 - 7.1 [DAY AND TIME SETTING](#)
 - 7.2 [SETTING COMFORT*/REDUCTION TEMPERATURE](#)
 - 7.3 [SETTING HEATINGA/COOLING MODE](#)
 - 7.4 [THERMAL DIFFERENTIAL REGULATION](#)
 - 7.5 [LOCK SETING](#)
- 8 [Documents / Resources](#)
- 9 [Related Posts](#)

tecnoswitch

tecnoswitch TE315 Recessed Touch Thermostat



COMMAND AND INDICATIONS

KEYS/DISPLAY LEGEND Fig. A

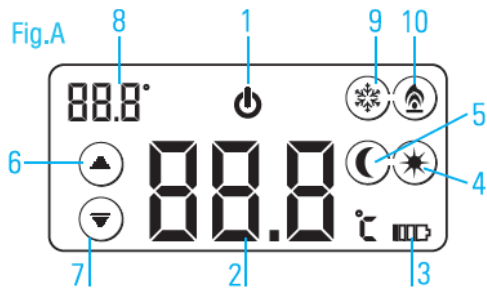
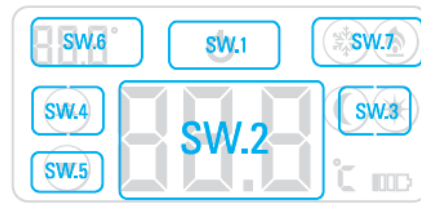
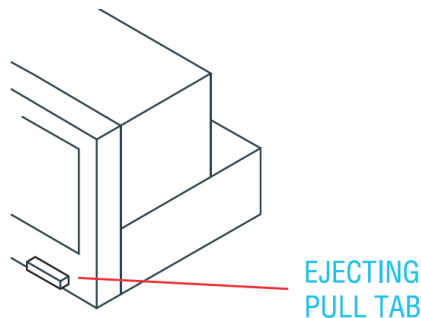

Fig.B



TOUCH KEYS MAP

1. ON/O F (W.1)
2. Ambient temperature detected (SW.2)
3. Low batteries
4. Comfort mode active (SW.3)
5. Reduction mode active (SW.3)
6. Increase value (SW.4)
7. Decrease value (SW.5)
8. Set temperature (SW.6)
 - Cooling mode (SW.7)
 - Heating mode (SW.7)



WARNINGS BEFORE INSTALLATION

- The device must be installed by qualified personnel.
- The device must be positioned about 1.5 meters above the floor, avoiding heat sources, windows and doors.
- The device must be installed in three modules recessed boxes type 503E.
- Two interchangeable faceplates are supplied, white and charcoal gray. The white front panel is pre-installed. If you want to change the color, follow the procedure described in the paragraph "FRONT PANEL REPLACEMENT".
- Inserting the batteries incorrectly could damage the device.
- Before making any changes to the settings, you must activate the device by pressing on the display. The backlight will light up and icons will appear. If you do not eternal command within 10 seconds the device will return to standby.

INSTALLATION

1. Choose faceplates to use.

2. Remove the device from its casing using the ejecting pull tab and remove the battery cover at the bottom of the appliance with a flat head screwdriver.
3. Insert 2 batteries AA alkaline 1.5 V, respecting the polarity indicated on the bottom and reassemble the battery cover.
4. Choose among the 4 universal supports supplied the one compatible with the plate in possession (SEE SUPPORT INSTRUCTIONS) and install the thermostat following the order indicated in Fig.1

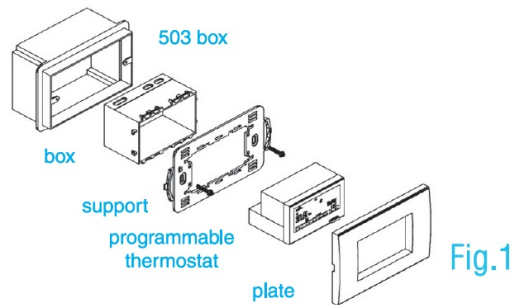

FRONT PANEL REPLACEMENT

The device comes with a factory-installed white faceplate. To replace it with a different color, proceed as follows.

1. Remove the faceplate from the device by lever with a flat head screwdriver into the two side slots and remove it from the device.

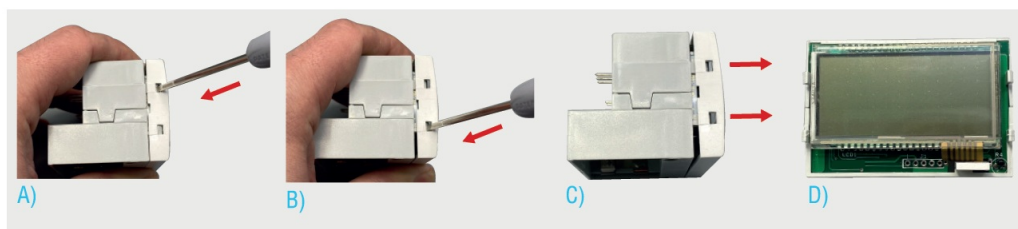

2. Remove the ejecting pull tab (down to the right) by pulling it out first, then turn it down to pull it out of its housing.

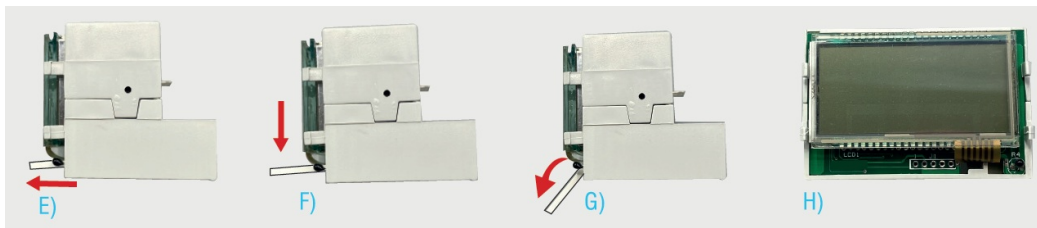

3. Assemble the different colored faceplate and ejecting pull tab, following the reverse procedure of the replacement procedure.

ELECTRICAL CONNECTIONS

Connect the two wires of the heating / cooling system to the screw terminals on the back of the device following the diagrams in Fig. 2A e Fig. 2B

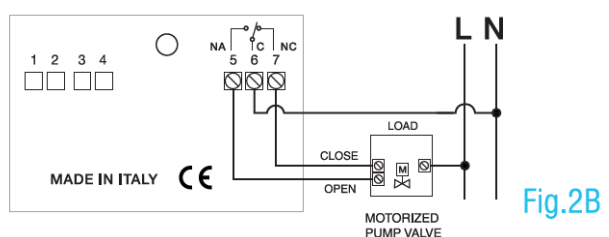
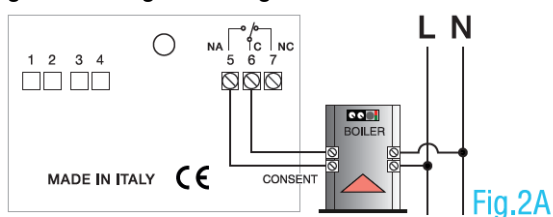

FACTORY SETTINGS

For quick and easy use, the thermostat is factory pre-configured in heating mode, with optimized settings for the user. Preset temperature levels:

	HEATING MODE	Cooling Mode *
Default	22°C	26°C
Reduction	1°C	26°C
Lock	cover for start conjunction 5°C	

ON/OFF

Press the key (SW.1) for 3 seconds to turn the device on/off. When the device is turned off it will appear DFF top left.

DAY AND TIME SETTING

To change the desired temperature, use the touch keys(SW.4) or (SW.5). The adjustment range is from 2 to 35°C with steps of 0.1°C.

SETTING COMFORT*/REDUCTION TEMPERATURE

1. Press and hold on ambient temperature measured (SW.2) for 3 seconds
2. Icons CO will appear
3. Press the key O⊙ (SW.3) to select the comfort *or reduction temperature
4. Use the keys(SW.4) or(SW.5) to adjust the comfort/reduction temperature
5. Press the key (SW.1) to exit programming

SETTING HEATING/COOLING MODE

1. Press and hold on ambient temperature measured (SW.2) for 3 seconds
2. Icons will appear
3. Press the key C(SW.7) to select the heating or cooling mode
4. Press the key) (SW.1) to exit programming

THERMAL DIFFERENTIAL REGULATION

1. Press simultaneously for 3 seconds on the set temperature (Sw.6) and ambient temperature measured (SW.2)
2. tappers
3. Press the keys (SW.4) or (SW.5) to adjust the thermal differential
4. Wait 10 seconds to return to the main screen

LOCK SETING

1. Press simultaneously for 3 seconds on the set temperature (SW.6) and O9(Sw.3)
2. bid appears

3. To unlock the device press for 3 seconds bid RESET Press the keys at the same time (SW.1) and (SW.5) for 3 seconds. The device will restart to factory settings.

RESET

Press the keys at the same time (SW.1) and (SW.5) for 3 seconds. The device will restart to factory settings.

Techno Switch reserves the right to make changes to its products in each moment and without further notice. Techno Switch declines all responsibility for damage to things or persons derived from an incorrect or improper use of its products.

For more information consult the installer manual on our website (tecnoswitch.com)



techno switch { Pursuant to Legislative Decree NO 49 of March 14, 2014 Implementation of Directive 2012/19EU on waste electrical and electronic equipment (WEEE) Ten crossed out wheeled Din ewe Symbol on the appliance snow tan the product at ten era of its useful lie must be collected separately Tromp other waste here fore, the user must provide the equipment written essential components at there cycling contractor electronic and electrotechnical devices or return It to the dealer when you purchase an equivalent appliance in one to one reason, or i to zero Tor equipment with a side lower than 25cm. The correct recycling helps to avoid possible negative effects on the environment and on health favoring the recycling or the materials tan make up the equipment. The illegal disposal or the product by the user invoice's administrative sanctions as per Legislative Decree No. 49 of March 14, 2014.

Documents / Resources

	tecnoswitch TE315 Recessed Touch Thermostat [pdf] User Guide TE315, Recessed Touch Thermostat, Touch Thermostat, Recessed Thermostat, Thermostat
-------------------------------------------------------------------------------------	---------------------------------------------------------------------------------------------------------------------------------------------------------------------