



technicolor UIW4060TVO Set Top Box User Guide

[Home](#) » [Technicolor](#) » technicolor UIW4060TVO Set Top Box User Guide 

Contents

- [1 technicolor UIW4060TVO Set Top Box](#)
- [2 Product Information](#)
- [3 Product Usage Instructions](#)
- [4 Contents of the Gift Box](#)
- [5 How to start](#)
- [6 Buttons and Physical Connections](#)
- [7 Documents / Resources](#)
- [8 Related Posts](#)



technicolor UIW4060TVO Set Top Box



Product Information

- 1 DC Jack with 2 pins female standard jack plug (2.5mm-6.3mm) for 12V/1A power input
- 2 HDMI outputs with HDMI standard
- 1 Ethernet port with RJ-45/IEEE 802.3 – Unshielded standard
- 1 Audio Out port with SPDIF optical standard

- 1 Reset Button
- 1 Standby Button
- 1 Pairing Button for Bluetooth connection
- 1 USB 2.0 (Type A) port
- 1 Micro SD card slot with the product code: 6313909A

The gift box comes with a set-top box, a quick start guide, an HDMI cable (*), a remote control (*), and a power supply unit. (*) may not be supplied.

Product Usage Instructions

1. Connect the set-top box to your TV using the provided HDMI cable or your own HDMI cable.
2. If you want to connect to the internet, use your own Ethernet cable to connect the set-top box to your router or connect it to your Wi-Fi network during on-screen set up.
3. Connect the power supply unit to the DC Jack on the set-top box.
4. Turn on the set-top box by pressing the standby button. The light on the front of the set-top box will turn on.
5. Insert batteries into the remote control compartment and use it to complete the on-screen setup by following the screen instructions.

Note: The product also has a pairing button for Bluetooth connection, a reset button, an audio out port, a USB 2.0 (Type A) port, and a Micro SD card slot with the product code: 6313909A.

Contents of the Gift Box

Set top box

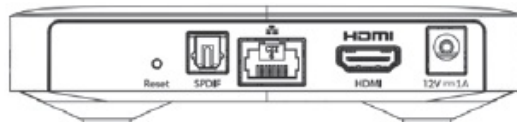

HDMI cable



Remote control



Power supply unit

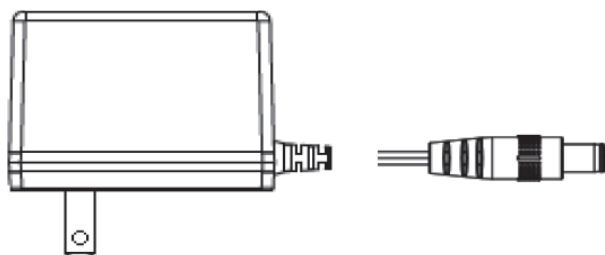

may not be supplied

How to start

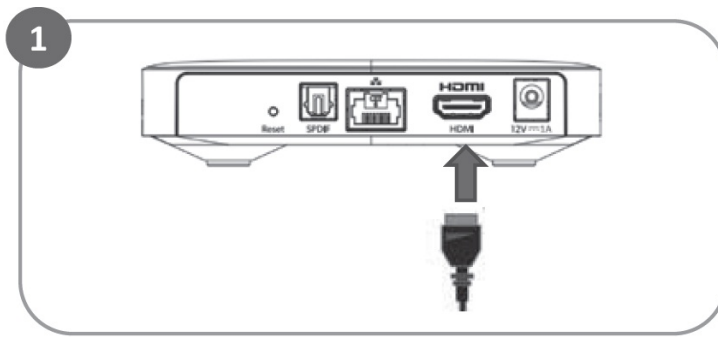

- Connect Set top box to your TV using HDMI Cable

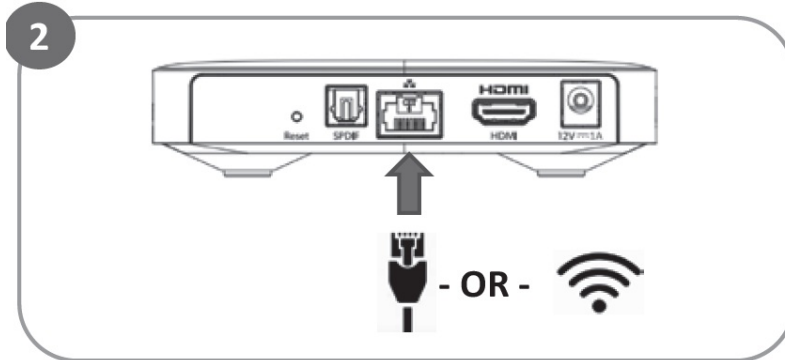

- Connect to Internet using your own Ethernet cable from your router or connect to your Wi-Fi network during on-screen set up

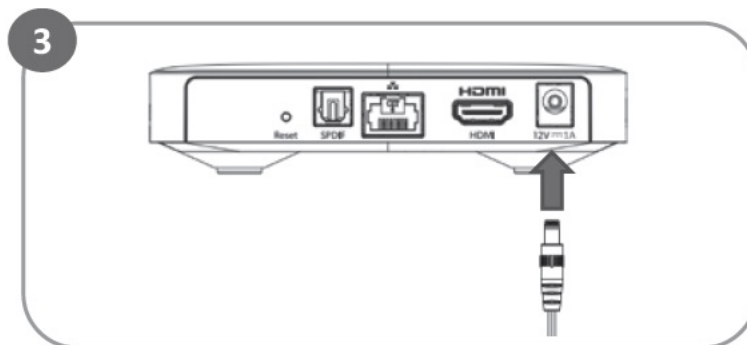

- Connect to power and the light on the front of Set top box will turn On.



- Get the remote control ready.... Ensure batteries are well inserted into compartment



- Complete your set up.... by following screen instructions

Buttons and Physical Connections

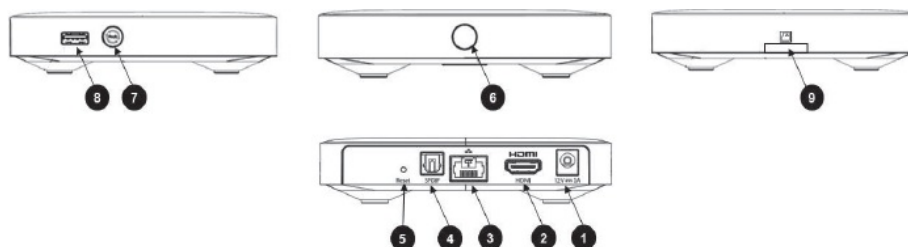

1	DC Jack	2 Pins female standard Jack plug 2.5mm-6.3mm 12V /1A
2	HDMI	HDMI OUT
3	Ethernet	RJ-45 /IEEE 802.3 – Unshielded
4	Audio Out	SPDIF optical
5	Reset Button	
6	Standby Button	
7	Pairing Button	Bluetooth
8	USB side	USB 2.0 (Type A)
9	Micro SD card slot	

Documents / Resources

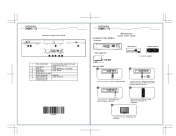
	technicolor UIW4060TVO Set Top Box [pdf] User Guide UIW4060, G95-UIW4060, G95UIW4060, UIW4060TVO, UIW4060TVO Set Top Box, Set Top Bo x
---	--