



TECHNET DS-2862 Wireless Mouse User Manual

[Home](#) » [TECHNET](#) » **TECHNET DS-2862 Wireless Mouse User Manual** 

TECHNET DS-2862 Wireless Mouse User Manual



Contents

- [1 Package Contents](#)
- [2 Product layout](#)
- [3 Product Specification](#)
- [4 Directions for Use](#)
- [5 USB Nano Receiver](#)
- [6 DPI Switch](#)
- [7 Reconnection](#)
- [8 Note on handling batteries](#)
- [9 Safety Measures](#)
- [10 Troubleshooting](#)
- [11 IMPORTANT SAFETY INSTRUCTIONS-CAREFULLY FOLLOW THESE INSTRUCTIONS.](#)
- [12 FCC Warning Statement](#)
- [13 Documents / Resources](#)
- [14 Related Posts](#)

Package Contents

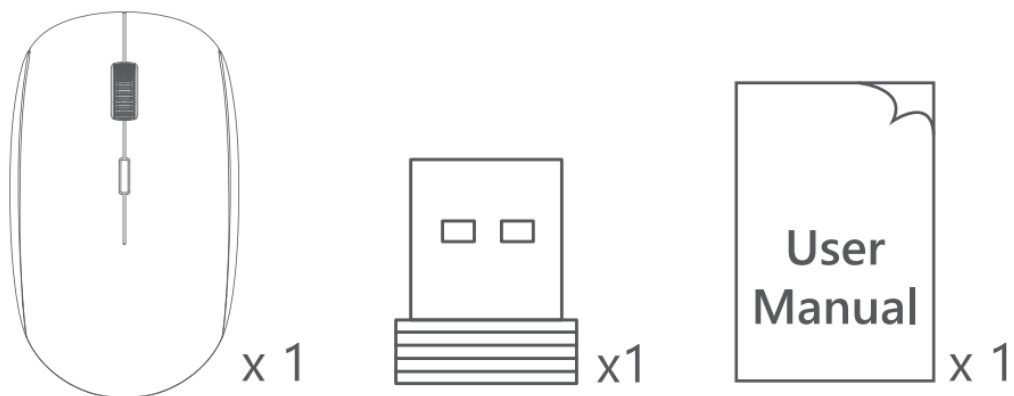

Product layout

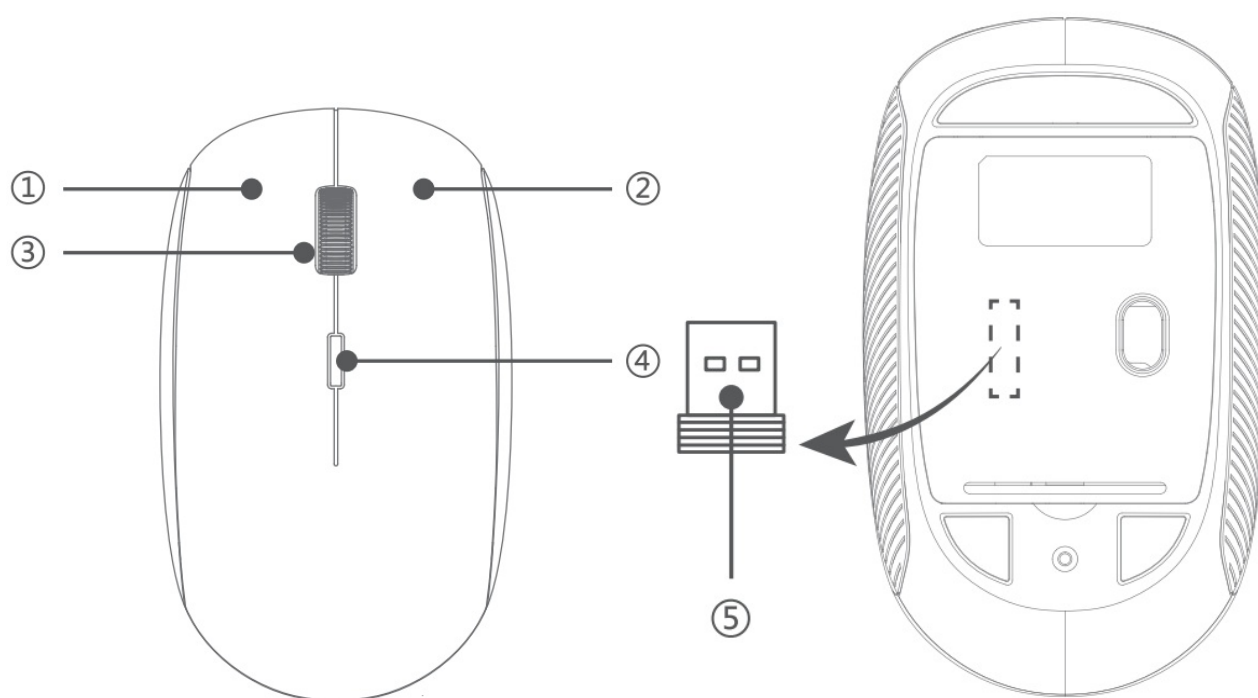

1. Left Click button
2. Right click button
3. Scroll wheel
4. DPI Switch button
5. Nano receiver

Product Specification

Button count: 4 buttons
OPERATING FREQUENCY: 2.4 GHz
RESOLUTION: 800/1200/1600 DPI
RECEIVER INTERFACE: USB VERSION 2.0
INPUT: DC1.5V 9mA

Directions for Use

1. Connecting the Receiver Take out USB Nano receiver and plug it into an available USB port in your computer. The Plug & Play function works automatically.
2. The RF 2.4GHZ optical mouse uses one AA battery (battery is not included). Open the battery cover. Insert the batteries into the compartment, ensuring they correspond with the polarity marking.
3. Replace the battery cover.
4. TeckNet Mouse will pair automatically, the LED indicator will flash for 5-10 seconds, when the LED indicator stops flashing, the mouse is ready for use.

Note:

1. Pairing process will stop if inserting the battery first and then plugging the Nano receiver beyond 5-10 seconds.
2. Make sure that the polarity of the batteries is correct. The positive (+) and negative (-) ends of each battery must match the positive (+) and negative (-) markings in the battery housing.

USB Nano Receiver

The receiver can be removed and stored next to the battery compartment while not in use.

DPI Switch

The mouse supports 800 -1200- 1600 DPI. To switch to either setting, press the DPI button. (Default is 1200DPI)

Reconnection

There is a wireless signal connection code for this mouse. High temperatures, electro-magnetic fields or vibration may influence the code signal and occasionally the mouse may need to be reconnected. Both the mouse and Nano Receiver have a built-in code and one mouse can be connected to one receiver, or several mice to one Nano Receiver.

1. Unplug the Nano receiver from USB port, and plug it back in and remove the AA battery from the mouse, and then re-insert.
2. Move the mouse to within 50cm of the Nano receiver or re-insert the battery or press any key to reconnect; the above process must be completed in 15 seconds.
3. Mouse will ready for use after reconnection.

Attention:

1. To maximize battery life, it is recommended you use the mouse on a white or light colour surface.
2. If not used, the mouse will drop into auto-sleeping mode within 3 seconds. Press any key or scroll wheel to activate the mouse.
3. Do not use the mouse on a glass or mirrored surface, as these surfaces will cause the mouse to fail temporarily.
4. The mouse might not work smoothly on some special surfaces, such as smooth, dark or black, reflecting and 3D mouse pads surfaces.
5. Avoid using the mouse on a metal surface. Metals, such as iron, aluminium or copper, shield the radio frequency transmission and may slow down the mouse presenter's response time or cause the mouse to fail

temporarily.

6. If your PC has a metal case that contains aluminium or magnesium, use the mouse to the side. The display panel may interfere with the radio frequency signal if you use the mouse directly in front of the PC.
7. Please remove the batteries if you are not going to use it for a prolonged period of time (several weeks or months).

Note on handling batteries

1. Keep batteries out of the reach of children.
2. Replace old or weak batteries promptly.
3. Remove the batteries if the mouse is not going to be used.

Safety Measures

1. Keep the mouse away from young children.
2. Any attempt to disassemble, adjust or repair the mouse may result in exposure and other safety hazards.

Troubleshooting

1. What do I do if the mouse does not work?

- Make sure that the polarity of the batteries is correct. The positive (+) and negative (-) ends of each battery must match the positive (+) and negative (-) markings in the battery housing.
- Make sure the batteries are not discharged.
- Try to remove the batteries, and reinstall the batteries again.
- Verify that your computer's power management features are turned off.
- Check that the Nano receivers USB connector is firmly attached to the USB port of your computer.
- Still not working? Please try "Reconnec-tion".

2. The USB Nano receiver is recognised by Windows (XP, Vista, Win 7, 2000, 2003, 2007, Win8, Win10) but the cursor does not move.

- Check whether the low power indicator on the top of the mouse lights up. If the sensor lights up, it is likely that the batteries are discharged. Please replace them.
- If replacing the batteries does not help, it is likely that the mouse is not connected to the Receiver, please try "Reconnection".

3. When I use the mouse, other 2.4G Cordless devices work more slowly or fail temporarily — what should I do?

- The mouse has 34 channels to prevent interference. However, the mouse may cause interference with any cordless, radio-based device that operates at 2402MHz – 2480MHz, such as a 2.4G telephone, 2.4G baby monitors, 2.4G cordless routers and toys. To reduce interference, move the mouse's receiver and the base unit of the affected device as far away from each other as possible; alternatively try to change the 2.4G frequency of the affected devices

4. What do I do if the response time of the mouse is slow or the mouse intermit-tently stops working?

- Ensure that the mouse is within the operational working distance (1.5m) from the USB Nano receiver and restart your PC.
- Increase the distance between the Nano receiver and the base units of other cordless devices.

- Turn off any cordless device and their base units that are near the mouse Nano receiver.
- If you are using the mouse on a metal surface, move the mouse and the receiver to a non-metallic surface. Metals, such as iron, aluminium or copper, shield the radio frequency transmission and may slow down the mouse presenter's response time or cause the mouse to fail temporarily.

5. I cannot use the mouse while another cordless mouse is in use — what should I do?

- Please try "Reconnecting".

IMPORTANT SAFETY INSTRUCTIONS-CAREFULLY FOLLOW THESE INSTRUCTIONS.

1. SAVE THESE INSTRUCTIONS – This sheet contains important safety and operating instructions.



2. Before using the product, read all instructions and caution markings on the product, accessories and device using our product.



3. This appliance is not intended for use by persons (including children) with reduced physical, sensory or mental capabilities, or lack of experience and knowledge, unless they have been given supervision or instruction concerning use of the appliance by a person responsible for their safety.



4. Children should be supervised to ensure that they do not play with the appliance.
5. Keep the product away from fire or explosion may occur.



6. For proper insertion, please observe polarity indicators (+/ -)



FCC Warning Statement

Changes or modifications not expressly approved by the party responsible for compliance could void the user's authority to operate the equipment.

This equipment has been tested and found to comply with the limits for a Class B digital device, pursuant to Part 15 of the FCC Rules. These limits are designed to provide reasonable protection against harmful interference in a residential installation. This equipment generates uses and can radiate radio frequency energy and, if not installed and used in accordance with the instructions, may cause harmful interference to radio communications.

However, there is no guarantee that interference will not occur in a particular installation. If this equipment does cause harmful interference to radio or television reception, which can be determined by turning the equipment off and on, the user is encouraged to try to correct the interference by one or more of the following measures:

- Reorient or relocate the receiving antenna.
- Increase the separation between the equipment and receiver.
- Connect the equipment into an outlet on a circuit different from that to which the receiver is connected.

- Consult the dealer or an experienced radio/TV technician for help.

This device complies with part 15 of the FCC rules. Operation is subject to the following two conditions

1. this device may not cause harmful interference, and
2. this device must accept any interference received, including interference that may cause undesired operation.

TECKNET

Documents / Resources

	TECKNET DS-2862 Wireless Mouse [pdf] User Manual EWM01862, 2AK8Q-EWM01862, 2AK8QEWM01862, DS-2862 Wireless Mouse, DS-2862, Wireless Mouse
---	--

[Manuals+.](#)