



TECHMADE SPK-BT-08 E-Cube Speaker User Manual

[Home](#) » [TECHMADE](#) » TECHMADE SPK-BT-08 E-Cube Speaker User Manual 



SPK-BT-08
PORTABLE BT SPEAKER WITH MICROPHONE



USER MANUAL
BT PORTABLE SPEAKER

Contents

[1 Features](#)

[2 Specifications](#)

[3 GENERAL INFORMATION](#)

[4 SAFETY](#)

[5 DECLARATION OF CONFORMITY](#)

[6 Documents / Resources](#)

[6.1 References](#)

[7 Related Posts](#)

Features

- Portable BT speaker with microphone
- Signal reach up to 10 m
- Works on built-in rechargeable battery
- Up to 400 hours standby, 12 hours handsfree talking time or 3 hours of music streaming on a single charge
- Non-BT devices can also be connected via 3.5 mm audio cable
- Plays music files directly from an inserted microSD-card

Specifications

- Interface: BT v.2.1 + EDR, Class II, Handsfree profile
- BT frequency range: 2.402 GHz – 2.480 GHz
- Speaker: 40 mm magnet-free, 4 Ohm
- RMS power output: 3 W
- Frequency response: 100Hz – 10KHz
- S/N ratio: 80 dB
- DC input: MicroUSB 5 VDC up to 1.5 A
- Battery: rechargeable 400 mAh Li-Polymer
- USB / audio cable length: 0.2 m
- Dimensions: D61 x H50 mm
- Net weight: 240 g



1

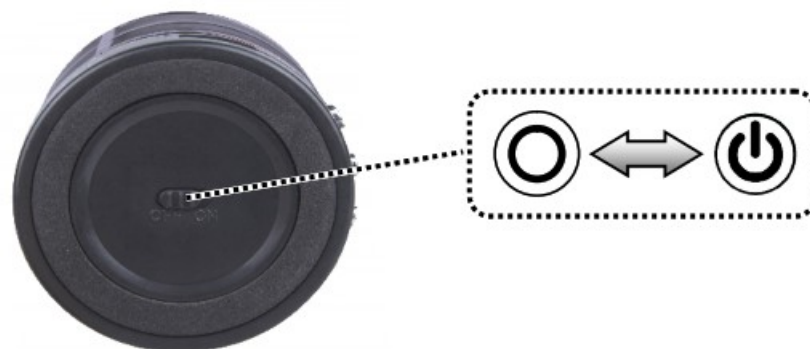

2



3

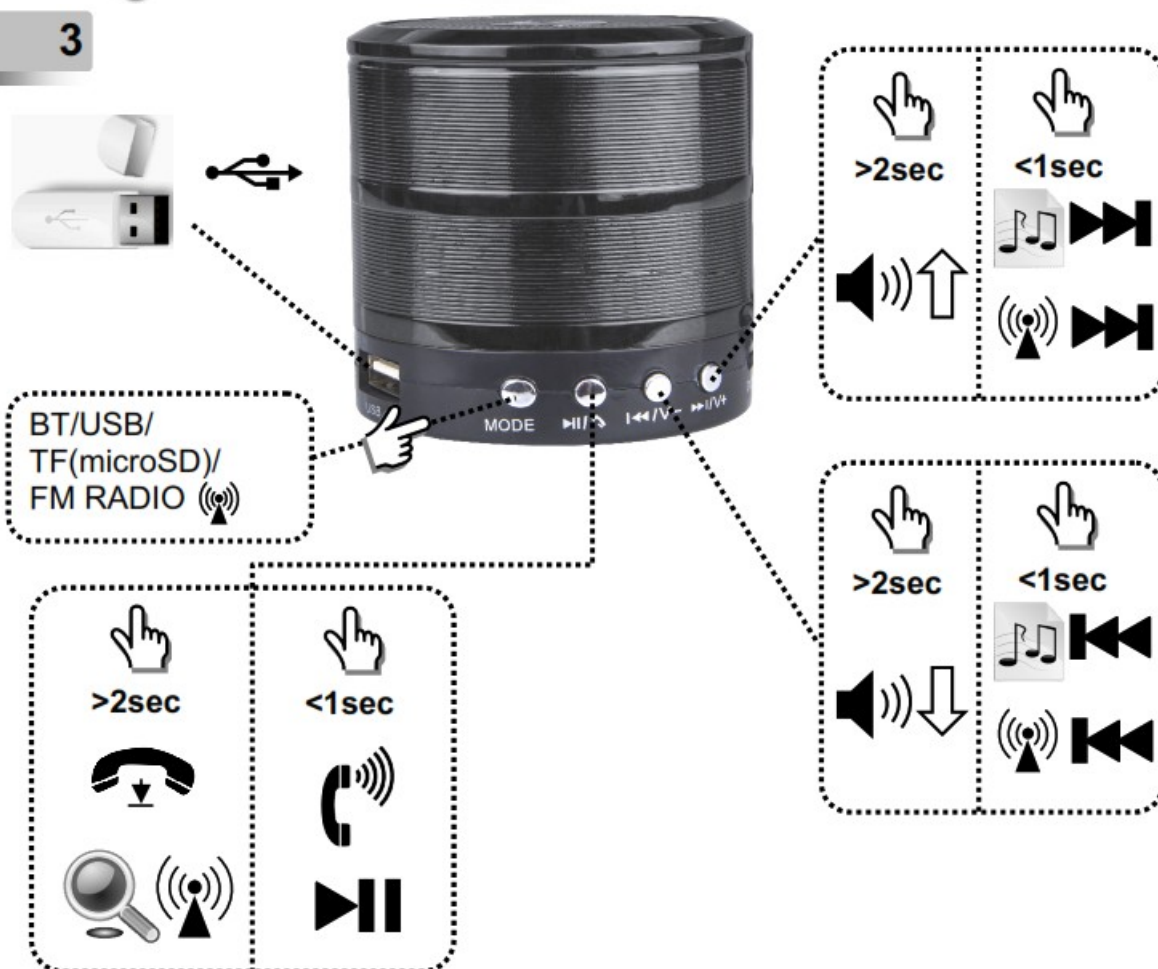

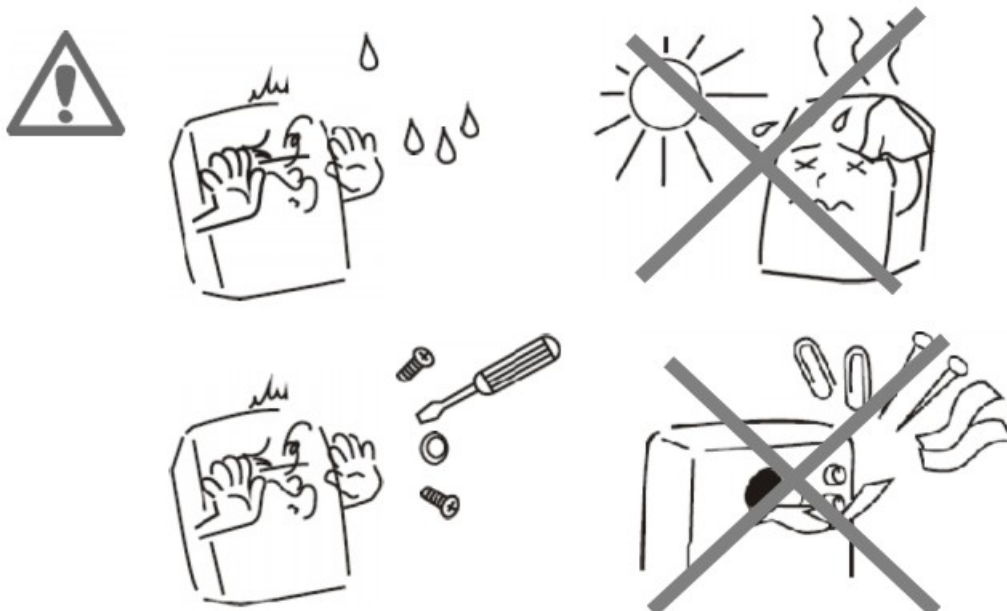

GENERAL INFORMATION

This product has been manufactured by or on behalf of Gembird Europe B.V.. Inquiries to the EU Importer or related to product compliance in Europe should be sent to: Gembird Europe B.V.,

Wittevrouwen 56, 1358 CD, Almere, The Netherlands. www.gmb.nl

Warranty conditions: www.gmb.nl/warranty

Product support: www.gmb.nl/service and/or helpdesk@gembird.nl

SAFETY

To ensure safe handling of the product, follow the safety advice on:

DECLARATION OF CONFORMITY

Hereby, Gembird Europe B.V., declares that this equipment is in compliance with Directive 2014/53/EU (RED).

The full text of the EU declaration of conformity is available at the following internet address:

www.gmb.nl/certificates



Waste disposal: The symbol of the crossed-out wheeled bin means that this appliance must not be disposed of with household waste at the end of its useful life. The appliance must be disposed of in specially set-up collection points, recycling yards or disposal companies. Retailers of electrical appliances with a sales area of at least 400 m² for electrical appliances and grocers with an area of 800 m², which offer electrical equipment several times a year, are obliged to take back electrical equipment. Return and disposal are free of charge for you. When you purchase a new device, you have the right to return a corresponding old device free of charge. Please delete all personal data before returning the appliance. Before returning, please remove the batteries or rechargeable batteries that are not enclosed by the old device, as well as lamps that can be removed without destruction, and dispose them to a separate collection.

Documents / Resources



[TECHMADE SPK-BT-08 E-Cube Speaker](#) [pdf] User Manual
SPK-BT-08 E-Cube Speaker, SPK-BT-08, E-Cube Speaker, Speaker

References

- [↗ Gembird - world leader in the production of computer hardware](#)
- [↗ Service](#)
- [↗ Safety information](#)
- [↗ Service](#)
- [↗ Warranty conditions](#)