

TECH Sinum WS-02m Drivers System User Manual

[Home](#) » [TECH](#) » TECH Sinum WS-02m Drivers System User Manual 

Contents

- 1 [TECH Sinum WS-02m Drivers System](#)
- 2 [Product Information](#)
- 3 [FAQ](#)
- 4 [INTRODUCTION](#)
- 5 [Description](#)
- 6 [How to register the device in the sinum system](#)
- 7 [How to identify the device in the Sinum system](#)
- 8 [Technical data](#)
- 9 [DISPOSAL](#)
- 10 [EU Declaration of conformity](#)
- 11 [Service](#)
- 12 [Documents / Resources](#)
 - 12.1 [References](#)

TECH

TECH Sinum WS-02m Drivers System

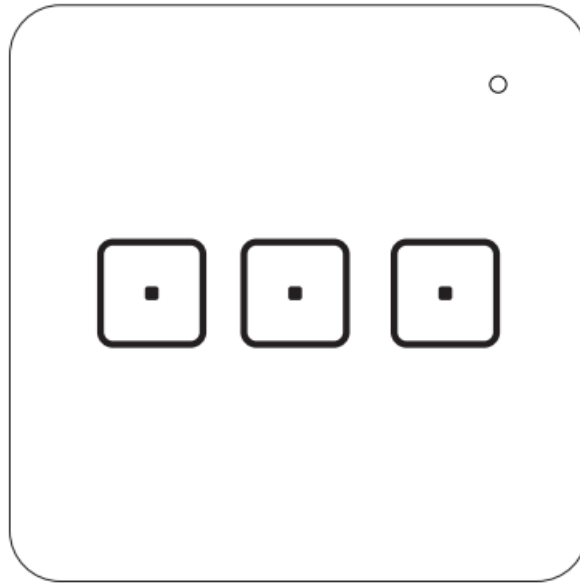

Product Information

Specifications

- **Power supply:** 24V
- **Max. power consumption:** 0.6W (WS-01m), 1.1W (WS-02m), 1.4W (WS-03m)
- **Output load:** 2W to 100W
- **Operation temperature:** Not specified

Description

The light switch is a device that can be registered and used in the Sinum system. It has the following components:

- Registration button
- Light sensor
- Main buttons
- Function button
- SBUS communication connector

How to Register the Device in the Sinum System

To register the device in the Sinum system, follow these steps:

1. Connect the device to the Sinum central device using the SBUS connector.
2. Enter the address of the Sinum central device in a browser.
3. Log in to the device.
4. In the main panel, click on Settings > Devices > SBUS devices > + > Add device.
5. Briefly press the registration button on the device (button 1).

After completing the registration process, an appropriate message will appear on the screen. You can also name the device and assign it to a specific room.

How to Identify the Device in the Sinum System

To identify the device in the Sinum system, follow these steps:

1. Activate the Identification Mode in the Settings > Devices > SBUS Devices > + > Identification Mode tab.
2. Hold the registration button on the device for 3-4 seconds.

The device used will be highlighted on the screen.

FAQ

- **What is the power supply for the device?**

The device requires a 24V power supply.

- **What is the maximum power consumption of the device?**

The maximum power consumption is 0.6W (WS-01m), 1.1W (WS-02m), and 1.4W (WS-03m).

- **What is the output load of the device?**

The device can handle an output load ranging from 2W to 100W.

- **What is the operation temperature range for the device?**

The operation temperature range is not specified.

INTRODUCTION

- The WS-01m / WS-02m / WS-03m light switch is a device which enables you to control the light directly from the switch or with the use of a Sinum central device, where the user may program the light to switch on and off in certain conditions. The switch communicates with the Sinum central device by wire and the whole system allows the user to control the smart home with the use of mobile devices.
- The WS-01m / WS-02m / WS-03m switch has a built-in light sensor which is used to adjust the button backlight brightness to ambient light level.

WS-03m

The outermost buttons are used to control the lighting whereas the middle button serves as a programmable button. Using this button the user may activate the automation which has been previously programmed in the Sinum central device.

NOTE!

- The drawings are for illustrative purposes only. The number of buttons may be different depending on the version you have.
- The permissible load of a single output for LED lighting should be in the range from 2W to 100W.

Description

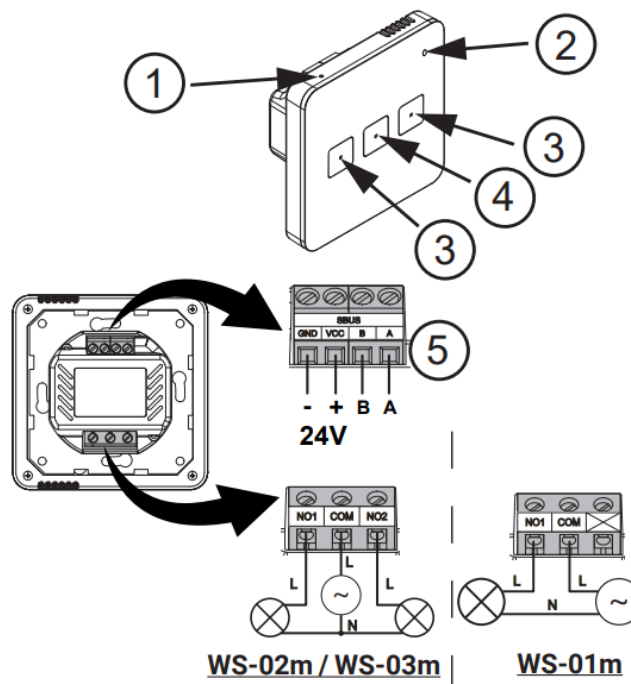

1. Registration button
2. Light sensor
3. Main buttons
4. Function button
5. SBUS communication connector

How to register the device in the sinum system

The device should be connected to the Sinum central device using the SBUS connector 5 and then enter the address of the Sinum central device in the browser and log in to the device. In the main panel, click the Settings > Devices > SBUS devices > + > Add device. Then briefly press the registration button 1 on the device. After a properly completed registration process, an appropriate message will appear on the screen. Additionally, the user can name the device and assign it to a specific room.

How to identify the device in the Sinum system

To identify the device in the Sinum Central, activate the Identification Mode in the Settings > Devices > SBUS Devices > + > Identification Mode tab and hold the registration button on the device for 3-4 seconds. The device used will be highlighted on the screen.

Technical data

- **Power supply** 24V DC $\pm 10\%$
- **Max. power consumption**
 - 0,6W (WS-01m)
 - 1,1W (WS-02m)
 - 1,4W (WS-03m)
- **Output load** 2 ÷ 100W (LED)
- **Operation temperature** 5°C ÷ 50°C

Notes

- TECH Controllers is not responsible for any damages resulting from improper use of the system. The manufacturer reserves the right to improve devices, update software and related documentation. The graphics are provided for illustration purposes only and may differ slightly from the actual look. The diagrams serve as examples. All changes are updated on an ongoing basis on the manufacturer's website.
- Before using the device for the first time, read the following regulations carefully. Not obeying these instructions may lead to personal injuries or controller damage. The device should be installed by a qualified person. It is not intended to be operated by children. It is a live electrical device. Make sure the device is disconnected from the mains before performing any activities involving the power supply (plugging cables, installing the device etc.). The device is not water resistant.

DISPOSAL

The product may not be disposed of to household waste containers. The user is obliged to transfer their used equipment to a collection point where all electric and electronic components will be recycled.

EU Declaration of conformity

Tech Sterowniki II Sp. z o.o. , ul. Biała Droga 34, Wieprz (34-122)

Hereby, we declare under our sole responsibility that the light switch:

WS-01m, WS-02m, WS-03m is compliant with Directive :

- 2014/35/UE
- 2014/30/UE
- 2009/125/WE
- 2017/2102/UE

For compliance assessment, harmonized standards were used:

- PN-EN 60669-1:2018-04
- PN-EN 60669-1:2018-04/AC:2020-04E
- PN-EN 60669-2-5:2016-12
- EN IEC 63000:2018 RoHS

Wieprz, 01.12.2023

Paweł Jura

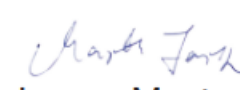
Janusz Master
Prezesa firmy

The full text of the EU declaration of conformity and the user manual are available after scanning the QR code or at www.tech-controllers.com/manuals

Service

- tel: +48 33 875 93 80
- serwis.sinum@techsterowniki.pl
- tel: +48 33 875 93 80
- www.tech-controllers.com
- support.sinum@techsterowniki.pl
- tel: +420 733 180 378
- www.tech-controllers.cz
- cs.servis@tech-reg.com
- tel: +421 918 943 556
- www.tech-reg.sk
- sk.servis@tech-reg.com

- tel. +48 33 875 93 80
- www.tech-controllers.com
- support.sinum@techsterowniki.pl
- tel. +31 341 371 030
- www.tech-controllers.com
- e-mail: info@eplucon.nl
- tel. +40 785 467 825
- www.techsterowniki.pl/ro
- contact@tech-controllers.ro
- tel. +36-300 919 818
- +36 30 321 70 88
- www.tech-controllers.hu
- szerviz@tech-controllers.com
- tel. +48 33 875 93 80
- www.tech-controllers.com
- support.sinum@techsterowniki.pl
- tel. +38 096 875 93 80
- www.tech-controllers.com
- servis.ua@tech-controllers.com
- +375 3333 000 38 (WhatsApp, Viber, Telegram)
- service.eac@tech-reg.com (RU)

Documents / Resources



[TECH Sinum WS-02m Drivers System](#) [pdf] User Manual
Sinum WS-02m Drivers System, Sinum WS-02m, Drivers System, System

References

- [🌐 controllers.com](http://www.tech-controllers.com)
- [🇵🇱 Intelligens fűtés-hűtés, fűtési-hűtési megoldások - TECH vezérlők gyártója | TECH vezérlők](#)
- [🇳🇱 Sinum - Energy-saving solution at home - manufacturer of controllers | Tech-controllers](#)
- [🇷🇴 Intelligent heating, smart heating solutions - manufacturer of controllers | TECH Controllers](#)
- [🇮🇹 Manuals - TECH Controllers](#)
- [🇮🇹 TECH Controllers - Teplo ve Vašem domě](#)
- [🇷🇺 TECH Controllers - Teplo vo Vašom dome](#)

-  [Instrukcje - TECH Sterowniki](#)
-  [Soluția de acasă de economisire a energiei - producător de controlere I Tech-Controllers](#)
- [User Manual](#)