

TECH C-S1p Wired mini Sinum Temperature Sensor



TECH C-S1p Wired mini Sinum Temperature Sensor Instruction Manual

[Home](#) » [TECH](#) » **TECH C-S1p Wired mini Sinum Temperature Sensor Instruction Manual** 

Contents

- [1 TECH C-S1p Wired mini Sinum Temperature Sensor](#)
- [2 Product Information](#)
- [3 Technical data](#)
- [4 NOTE](#)
- [5 Dimensions And Installation](#)
- [6 Service](#)
- [7 Documents / Resources](#)
 - [7.1 References](#)

TECH

TECH C-S1p Wired mini Sinum Temperature Sensor



Product Information

Product Specifications

- **Model:** C-S1p
- **Temperature Sensor Type:** NTC 10K

Frequently Asked Questions

- **Q:** What is the temperature measurement range of the C-S1p sensor?
 - **A:** The temperature measurement range is specified to be within certain limits. Please refer to the technical data for exact details.
- **Q:** Can the C-S1p sensor be disposed of in household waste containers?
 - **A:** No, the product should not be disposed of in household waste containers. It should be taken to a designated collection point for proper recycling of electronic components.
- **Q:** How do I contact customer service for technical support or inquiries?
 - **A:** You can find the contact information for customer service in multiple languages listed in the user manual. Choose the appropriate contact based on your location and preferred language.

The C-S1p sensor is an NTC 10K Ω temperature sensor designed to work with Sinum system devices. It is mounted directly in the wall.

Technical data

- **Temperature measurement range** $-30 \div 50^{\circ}\text{C}$
- **Measurement error** $\pm 0,5^{\circ}\text{C}$

- **Dimensions [mm]** 36 x 36 x 5,5

NOTE

Notes

TECH Controllers is not responsible for any damages resulting from improper use of the system. The manufacturer reserves the right to improve devices, update software and related documentation. The graphics are provided for illustration purposes only and may differ slightly from the actual look. The diagrams serve as examples. All changes are updated on an ongoing basis on the manufacturer's website.

Before using the device for the first time, read the following regulations carefully. Not obeying these instructions may lead to personal injuries or controller damage. The device should be installed by a qualified person. It is not intended to be operated by children. Make sure the device is disconnected from the mains before performing any activities involving the power supply (plugging cables, installing the device etc.). The device is not water resistant.



The product may not be disposed of to household waste containers. The user is obliged to transfer their used equipment to a collection point where all electric and electronic components will be recycled.

Dimensions And Installation

Dimensions

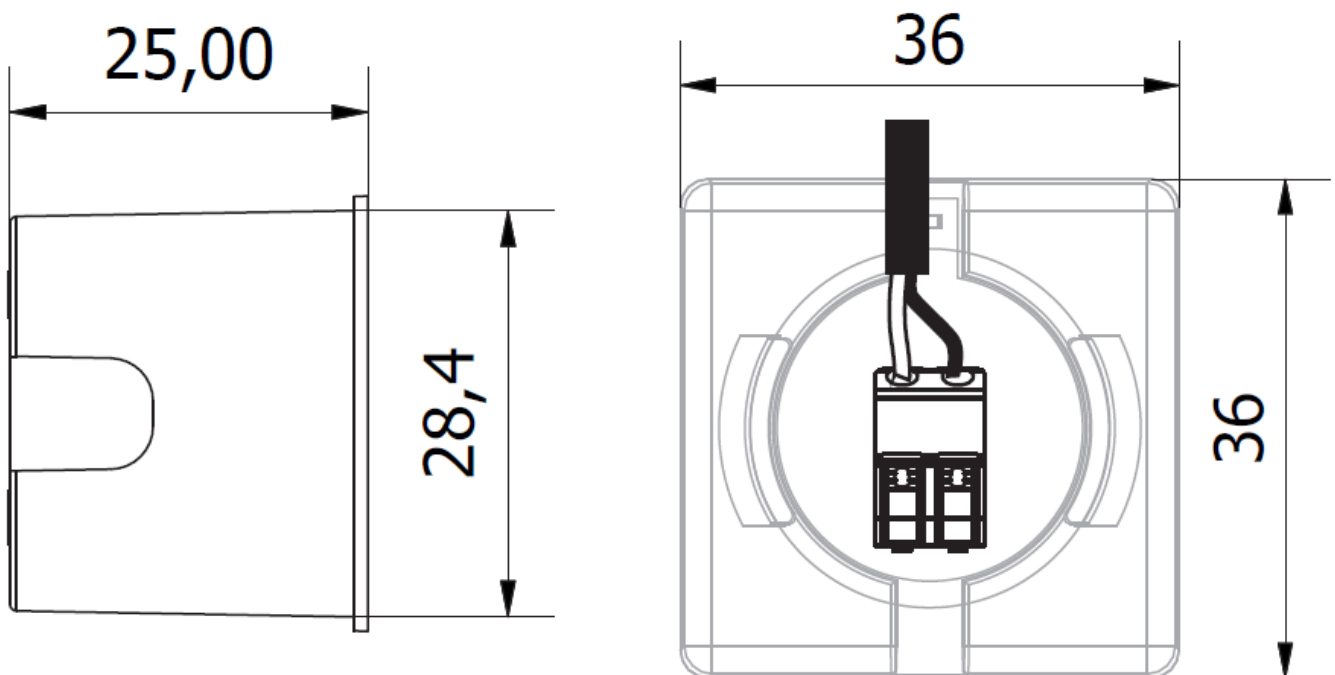

Installation

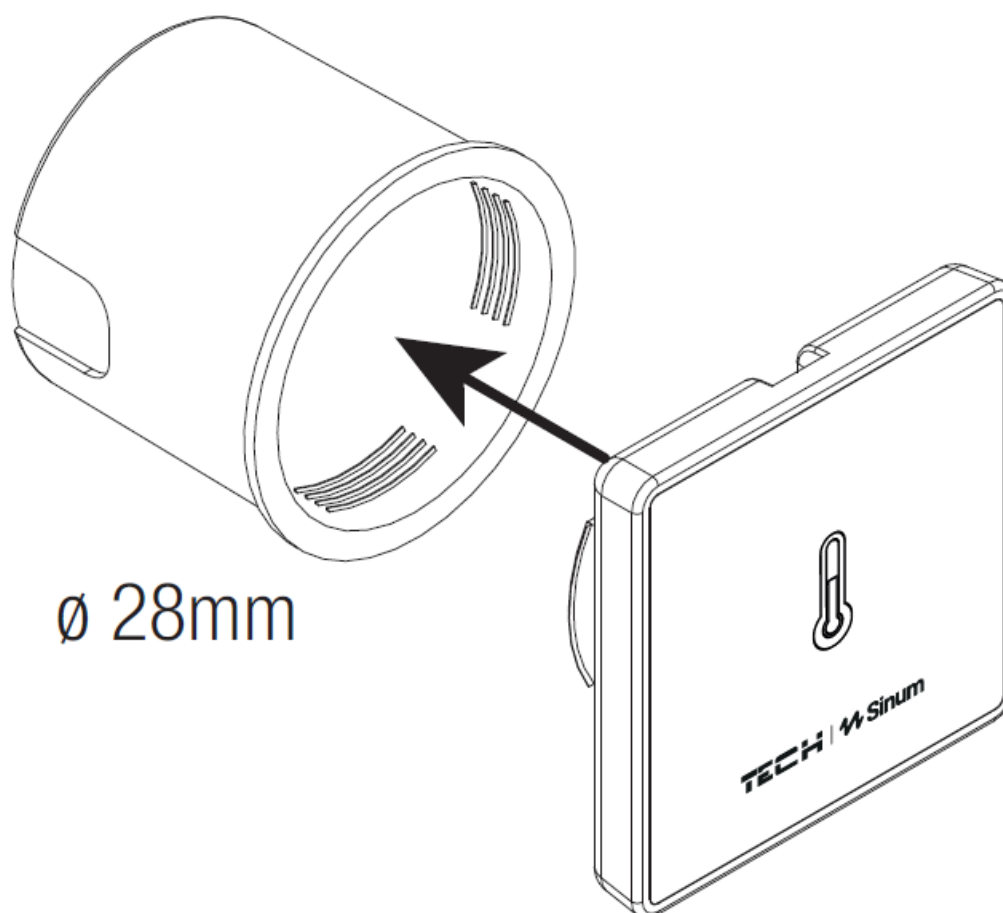

Service

TECH STEROWNIKI II Sp. z o.o.

- ul. Biała Droga 31 34-122 Wieprz

Service

- tel: +48 33 875 93 80
- www.tech-controllers.com
- support.sinum@techsterowniki.pl
- www.sinum.eu

Documents / Resources

	<p>TECH C-S1p Wired mini Sinum Temperature Sensor [pdf] Instruction Manual</p> <p>C-S1p Wired mini Sinum Temperature Sensor, C-S1p, Wired mini Sinum Temperature Sensor, Sinum Temperature Sensor, Temperature Sensor, Sensor</p>
--	--

References

- [controllers.com](https://www.controllers.com)
- [Intelligens fűtés-hűtés, fűtési-hűtési megoldások - TECH vezérlők gyártója | TECH vezérlők](#)
- [Sinum - TECH Controllers](#)
- [Intelligent heating, smart heating solutions - manufacturer of controllers | TECH Controllers](#)
- [TECH Controllers - Teplo ve Vašem domě](#)
- [TECH Controllers - Teplo vo Vašom dome](#)
- [Soluția de acasă de economisire a energiei - producător de controlere I Tech-Controllers](#)
- [User Manual](#)

[Manuals+](#), [Privacy Policy](#)

This website is an independent publication and is neither affiliated with nor endorsed by any of the trademark owners. The "Bluetooth®" word mark and logos are registered trademarks owned by Bluetooth SIG, Inc. The "Wi-Fi®" word mark and logos are registered trademarks owned by the Wi-Fi Alliance. Any use of these marks on this website does not imply any affiliation with or endorsement.