



Tech Gear R/C Clipper Bot Instructions

[Home](#) » [Tech Gear](#) » Tech Gear R/C Clipper Bot Instructions 

Tech Gear R/C Clipper Bot Instructions



WARNING:

BATTERIES ARE TO BE INSERTED WITH THE CORRECT POLARITY (+ and -). DO NOT MIX DIFFERENT TYPES OF BATTERIES OR NEW AND USED BATTERIES. NON-RECHARGEABLE BATTERIES ARE NOT TO BE RECHARGED. RECHARGEABLE BATTERIES ARE ONLY TO BE CHARGED UNDER ADULT SUPERVISION. RECHARGEABLE BATTERIES ARE TO BE REMOVED FROM THE TOY BEFORE BEING CHARGED. THE SUPPLY TERMINALS ARE NOT TO BE SHORT-CIRCUITED. REMOVE BATTERIES FROM THE TOY WHEN NOT IN USE FOR EXTENDED TIME OR WHEN BATTERIES BECOME EXHAUSTED. BATTERY INSTALLATION BY AN ADULT IS REQUIRED. DISPOSE OF BATTERIES RESPONSIBLY. DO NOT DISPOSE OF IN FIRE. THIS TOY PRODUCES FLASHES THAT MAY TRIGGER EPILEPSY IN SENSITISED INDIVIDUALS.

Battery diagram for boat.

1. Unscrew and unbuckle slowly

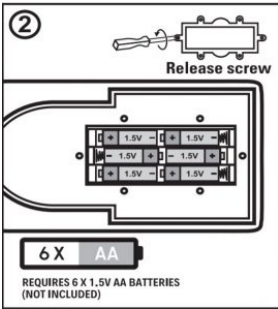
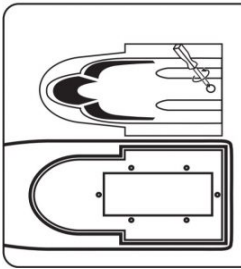

- 2.
3. To put back the cover: insert the back first and then the front.

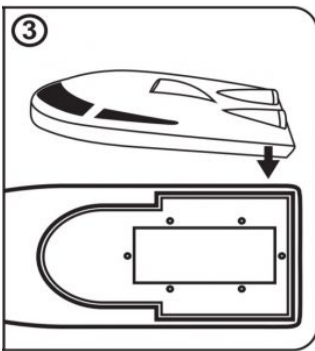

Contents

- [1 How to play](#)
- [2 Documents / Resources](#)
- [3 Related Posts](#)

How to play



Put the boat onto water



Turn on the remote control to pair up with the boat.



Start playing.

Battery diagram for remote control

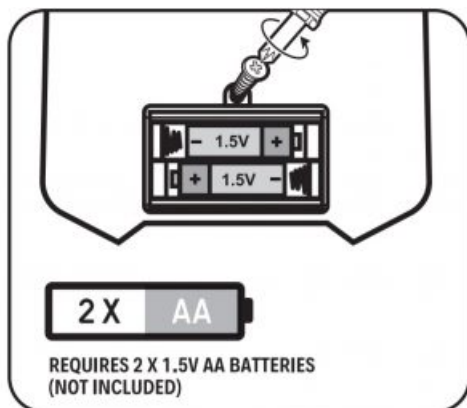

CAUTIONS: Adult supervision is required when playing. Children are at high risk of drowning. Do not play in salty ocean water. Do not play during thunderstorms, rain or other bad weather. Always keep fingers, hair and clothing away from the spinning propellers. Never submerge remote control in water. Do not leave boat or remote control near sources of heat for extended periods. Disconnect battery when not in use. Radio control distance is subject to play environment.

Documents / Resources

	Tech Gear R/C Clipper Bot [pdf] Instructions RC Clipper Bot
---	--