



TCP Smart LED Strip Light App User Guide

[Home](#) » [TCP](#) » TCP Smart LED Strip Light App User Guide 

Contents

- [1 Smart LED Strip Light App](#)
- [2 Product Information](#)
- [3 Product Usage Instructions](#)
- [4 INSTRUCTIONS](#)
- [5 Specifications](#)
- [6 Functions](#)
- [7 USING THE SMART TAPE LIGHT FUNCTIONS IN THE TCP SMART APP](#)
- [8 Documents / Resources](#)
 - [8.1 References](#)
- [9 Related Posts](#)



Smart LED Strip Light App



Product Information

Specifications

- Wattage
 - 14W Strip light only
 - 17W full product
- **Kelvin:** 4000K (Cool White) + RGB colours
- Voltage
 - Transformer: 220-240V
 - LED Strip light & Driver: 12V
- **IP Rating:** IP20
- TCP Smart App Required
- Functions
 - RGB 16 Million Colours
 - Pre-set light shows
 - Music Sync via app
 - On/Off & Dimming
 - Scheduling

Product Usage Instructions

Important Notes

1. This product is an integrated product which does not allow the removal of lighting control parts to minimise power consumption.
2. Ensure the power supply to the product is turned off and has cooled before removing from fitting.
3. Do not use if any of the Strip Light parts are broken or damaged.
4. Old appliances may not be disposed of with household waste. Should the product no longer be capable of being used it should be disposed of in accordance with the regulations in force in your city or county. This ensures that old appliances are recycled in a professional manner and rules out negative consequences for the environment.
5. Upon installation, the Strip Light factory setting is 4000K white light and red color light. Re-installation of the tape light will reset to these initial configurations and any scheduling and timer set up will be lost.

Connecting to TCP Smart App

Use the QR code below to download the TCP Smart App for control of the product on the TCP Smart App or through Voice Control via Alexa or Google Home.

QR code for both Android and iOS

To control the product using the TCP Smart App, the unit must be turned on. Before you get started, you will need the following

- A smartphone or tablet
- An internet connection
- The TCP Smart App downloaded and installed on your device

Please note: Our products do NOT work on 5GHz – only 2.4GHz. For instructions on how to connect to Amazon Alexa or Google Nest, please visit <https://www.tcpsmart.eu/how-to-alexa-google-nest>

Step 1: Plug in the tape light

The lights will start to rapidly flash (pairing mode). If this does not happen, please follow the instructions below.

- **Step 2:** Press the blue + sign in the top right-hand corner of the screen
- **Step 3:** The tape light will connect automatically. If not, follow the instructions below.
- **Step 4:** Press the < top left-hand corner
- **Step 5:** The Tape Light is now added to your product screen

Using the Smart Tape Light Functions in the TCP Smart App

Main Screen has a choice of White / Colour / Scene / Music modes.

- **White mode:** The white color is set to cool white. The brightness of the white can be increased/decreased using the slider.
- **Colour mode:** Select your color by using the color wheel. The top slider will increase/decrease the brightness. The bottom slider will increase/decrease the color.

FAQ

- **Q: Can I use this light strip outdoors?**

A: No, this light strip is intended for indoor use only.

- **Q: Can I use a different control gear with this light strip?**

A: No, the supplied control gear should not be used with any other lighting application.

- **Q: Can I dispose of the product with household waste?**

A: No, old appliances should be disposed of in accordance with the regulations in force in your city or county to ensure proper recycling.

- **Q: Can I change the factory settings of the light strip?**

A: Re-installation of the tape light will reset it to the initial factory settings.

INSTRUCTIONS

Product Description

TCP Smart LED strip light is a flexible light strip that is populated with LEDs that you can stick almost anywhere you want to add powerful lighting in a variety of brightness and colours.

NOTE: This light is intended for indoor use only and for the purposes of accent lighting or illumination only. The supplied control gear should not be used with any other lighting application.

Specifications

- **Wattage:** 14W Strip light only
- 17W full product
- Kelvin 4000K (Cool White)
- + RGB colours
- **Voltage:** Transformer 220-240V
- LED Strip light & Driver 12V
- **IP Rating:** IP20

Functions

- RGB 16 Million Colours
- Pre-set light shows
- Music Sync via app
- On/Off & Dimming

The TCP Smart Strip Light works by downloading and using in the TCP Smart App.

IMPORTANT: An internet connection is required for setting up the App.

IMPORTANT NOTES

- This product is an integrated product which does not allow the removal of lighting control parts to minimise power consumption.
- Ensure the power supply to the product is turned off and has cooled before removing from fitting.
- Do not use if any of the Strip Light parts are broken or damaged.
- Old appliances may not be disposed of with household waste. Should the product no longer be capable of

being used it should be disposed of in accordance with the regulations in force in your city or county. This ensure that old appliances are recycled in a professional manner and rules out negative consequences for the environment.

- Upon installation the Strip Light factory setting is 4000K white light and red colour light. Re-installation of the tape light will reset to these initial configurations and any scheduling and timer set up will be lost.

TCP hereby declares that the device is in compliance with the essential requirements and other relevant provisions of directives 2014/53/EU and 2011/65/EU. Full declaration can be viewed at topi.eu.

We are social, check us out for more products, updates and giveaways. @

[YouTube.com/c/TCPSmart@tcpsmart](https://www.youtube.com/c/TCPSmart@tcpsmart)

CONNECTING TO TCP SMART APP

Use the QR code below to download the TCP Smart App for control of the heater on the TCP Smart App or Voice Control via Alexa or Google Home..



QR code for both Andriod and IOS.

To control the fan using the TCP Smart App the unit must be turned on. Before you get started you will need the following:

- Smart device such as a mobile phone or tablet
- Access to the Google or Apple App store, log on and passwords
- The name of your Wi-Fi network and password to your Wi-Fi network
- Confirm your home Wi-Fi router is running on 2.4Ghz and not 5Ghz. If you are unsure, please consult your broadband provider for details on how to change the settings.
- Turn off any Wi-Fi extenders during set up
- Check you do not have any limitations on the number of devices with your broadband provider

Please note: Our products do NOT work on 5Ghz – only 2.4Ghz.

For instructions on how to connect to Amazon Alexa or Google Nest please visit <https://www.tcpsmart.eu/how-to-alexa-google-nest>

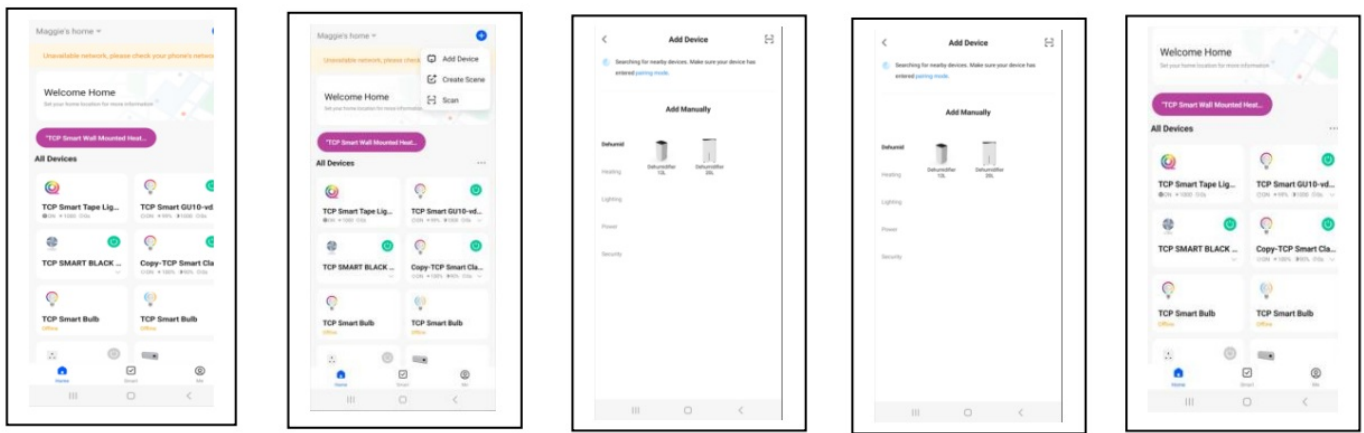

1. **Step 1** Plug in the tape light. The lights will start to rapidly flash (pairing mode). If this does not happen please follow instructions below.
2. **Step 2** Press the blue + sign in the top right hand corner of the screen.
3. **Step 3** The tape light will connect automatically. If not follow instructions below.
4. **Step 4** Press the < top left hand corner.
5. **Step 5** The Tape Light is now added to your product screen.

If the lights fail to flash, turn the lights of/on at the plug – ON/OFF 3 times. This will force the strip light into pairing mode.

If the product fails to connect go back to the Add Device screen and select Lighting. Select tape light and follow the on-screen prompts.

USING THE SMART TAPE LIGHT FUNCTIONS IN THE TCP SMART APP



Main Screen has a choice of White / Colour / Scene / Music modes.

- **White mode**

The white colour is set to cool white.

The brightness of the white can be increased/decreased using the slider.

- **Colour mode**

Select your colour by using the colour wheel. The top slider will increase /decrease the brightness. The bottom slider will increase/decrease the colour.

- **Scene Mode**

Choose from 8 pre-set lighting shows.

• Music Scene

The lights will react to music

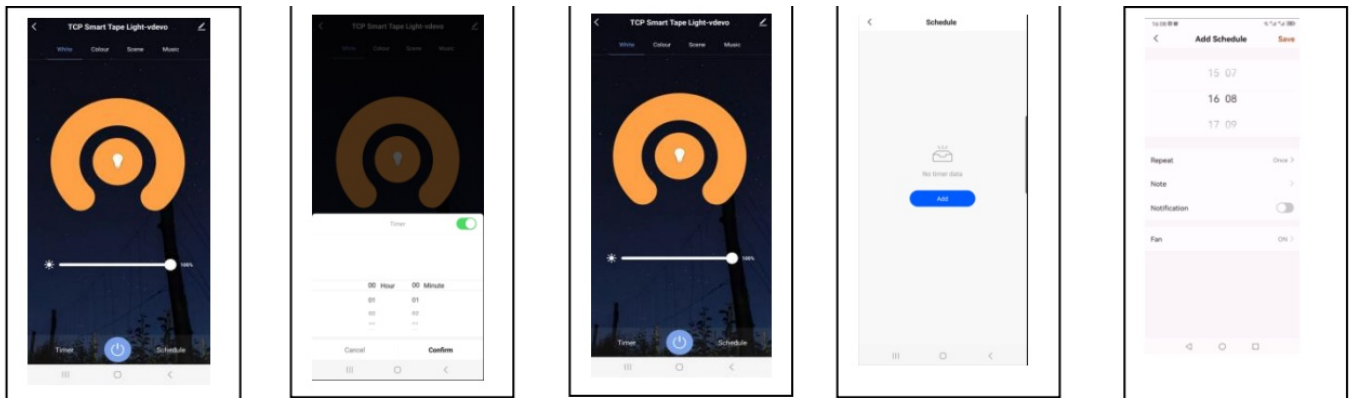

Countdown

From the main screen press Timer to show a list of times.

Select the number of hours and minutes you want the tape light to stay on for and press Confirm. The tape light will turn off after the countdown has completed.

Schedule

- To set a specific date and time for the tape light to turn On/Off. Press the schedule button.
- Press the Add button To add just one occurrence. The Repeat button should say Once.
- Select the time you want to start the lights, press Switch.
-

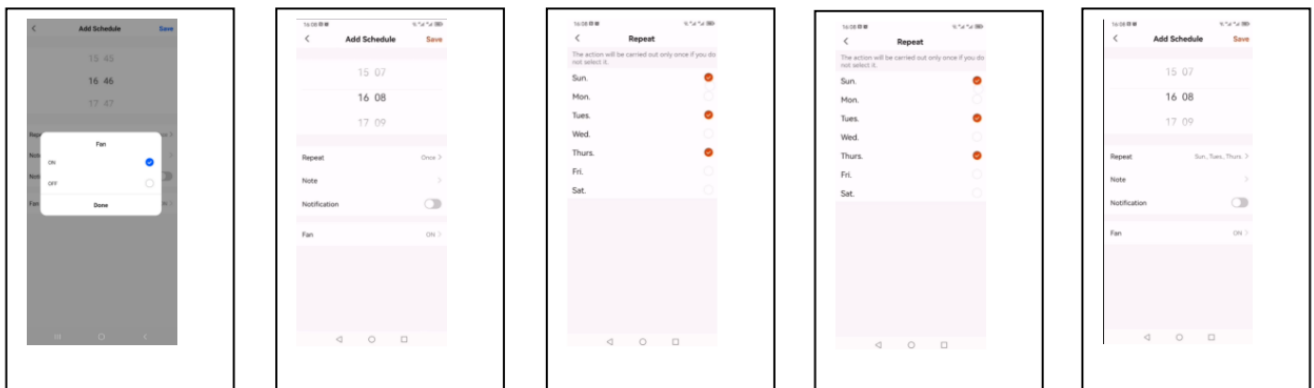

In the above screen Press ON. Press

- Done, followed by Save. Repeat this process to input a time to turn the lights off. Select the time you want the lights to turn off, press Switch and select OFF. The Repeat button should say Once. Press Done followed by Save. Weekly Schedule To turn the lights on for specific time(s) and date(s), select the time you want the lights to turn on. Press Switch. Press ON followed by Done.
- Weekly Schedule To turn the lights on for specific time(s) and date(s), select the time you want the lights to turn on. Press Switch. Press ON followed by Done.
- Press Repeat to show the list of days. Tick the day(s) of the week you want the lights to start. Press the < on top left hand of the screen. Press Save to save your time and day(s).
- To receive a notification to your phone to alert when the schedule has activated, before saving press notification.
- To turn the lights off for specific time(s) and date(s), select the time you want the lights to turn off. Press Switch. Press OFF followed by Done.

- Press Repeat button to show the list of days.
- Tick the day(s) of the week you want the lights to turn off. Press the < on top left hand of the screen.
- Press Save to save your time and day(s). To receive a notification to your phone to alert when the schedule has activated, before saving press notification.

Documents / Resources

	<p>TCP Smart LED Strip Light App [pdf] User Guide</p> <p>Smart LED Strip Light App, LED Strip Light App, Strip Light App, Light App, App</p>
---	--

References

-  [FAQ – TCP Smart](#)
- [User Manual](#)