



TCP IP65 Bulkhead Ceiling Lamp Instruction Manual

[Home](#) » [TCP](#) » TCP IP65 Bulkhead Ceiling Lamp Instruction Manual 

Contents

- [1 TCP IP65 Bulkhead Ceiling Lamp](#)
- [2 PRODUCT FEATURES](#)
- [3 SPECIFICATION](#)
- [4 Installation](#)
- [5 Cleaning The Product](#)
- [6 Maintenance and Storage](#)
- [7 Guarantee](#)
- [8 Documents / Resources](#)
 - [8.1 References](#)
- [9 Related Posts](#)



TCP IP65 Bulkhead Ceiling Lamp



IMPORTANT: PLEASE READ THESE INSTRUCTION
BEFORE USING THE PRODUCT AND RETAIN FOR FUTURE USE.

PRODUCT FEATURES

Upgrade your lighting with our Bulkhead Light – a perfect blend of quality, convenience, and sustainability! Engineered for durability and easy installation with the LED hinge, it offers reliable performance in any environment. Crafted with 15% recycled materials, it's an eco-friendly choice with great quality.

SPECIFICATION

| MODEL | Sensor Type | Power (W) | Current (mA) | Lumens |
|--|-----------------------|----------------|--------------|--|
| TCP IP65 bulkhead light | N/A | 11-15-19 | 87-114-140 | 1995lm @ 4000 K & 6000K 1900lm @ 3000 K |
| TCP IP65 microwave sensor bulkhead light | Microwave | 11.5-15.5-19.5 | 90-117-142 | |
| TCP IP65 emergency bulkhead light | Emergency | 13.5-17.5-21.5 | 97-122-147 | |
| TCP IP65 emergency bulkhead light with microwave sensor | Microwave & Emergency | 14-18-22 | 100-125-150 | |
| The above products contain a light source of energy rating <D> | | | | |

The above products contain a light source of energy rating <D>

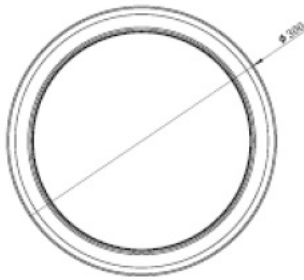

Life Hours : 50,000 Hours
 Operating Voltage : 220~240V AC 50/60Hz
 CRI : ≥ 80
 Beam Angle : 150°
 Dimensions : $\Phi 300 \times 75$
 Ingress protection : IP65
 Color Temperature : 3000K/4000K/6000K

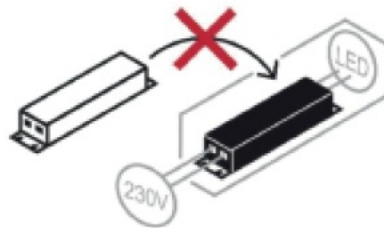

IMPORTANT SAFETY INSTRUCTIONS

The following should always be observed for safety.
Install and use product strictly according to the instructions.

1. Installation should be performed by a competent person. If you are unsure how to install this wall light use a qualified electrician.
2. Ensure all the necessary parts are present, and check for any damage prior to installation.
3. Do not install in a high temperature (above 40°C) or high humidity area.
4. Do not attempt to repair, disassemble or modify the appliance. This unit contains no user-serviceable parts.
5. Do not use chemicals and/or other materials that may harm the product. When cleaning, use a dry-damp cloth.
6. Do not use near flammable and/or explosive materials.
7. Do not look directly at the light source for a long period of time to avoid eye strain.
8. Any issues with the installation should always be checked by a qualified electrician.
9. Any service other than regular cleaning should be performed by a qualified electrician.

| | |
|--|--|
| | <p>Warning</p> <ul style="list-style-type: none"> * Power should be cut off before installation, maintenance or inspection * Please install and use the light strictly according to the instruction * Do not disassemble or remold the product by own to avoid accident of electric shock or fixture falling * Working out of temp. range $-20^{\circ}\text{C} \sim +40^{\circ}\text{C}$ will shorten the lifetime of luminaires |
|--|--|

Installation

TCP IP65 bulkhead light

TCP IP65 microwave sensor bulkhead light

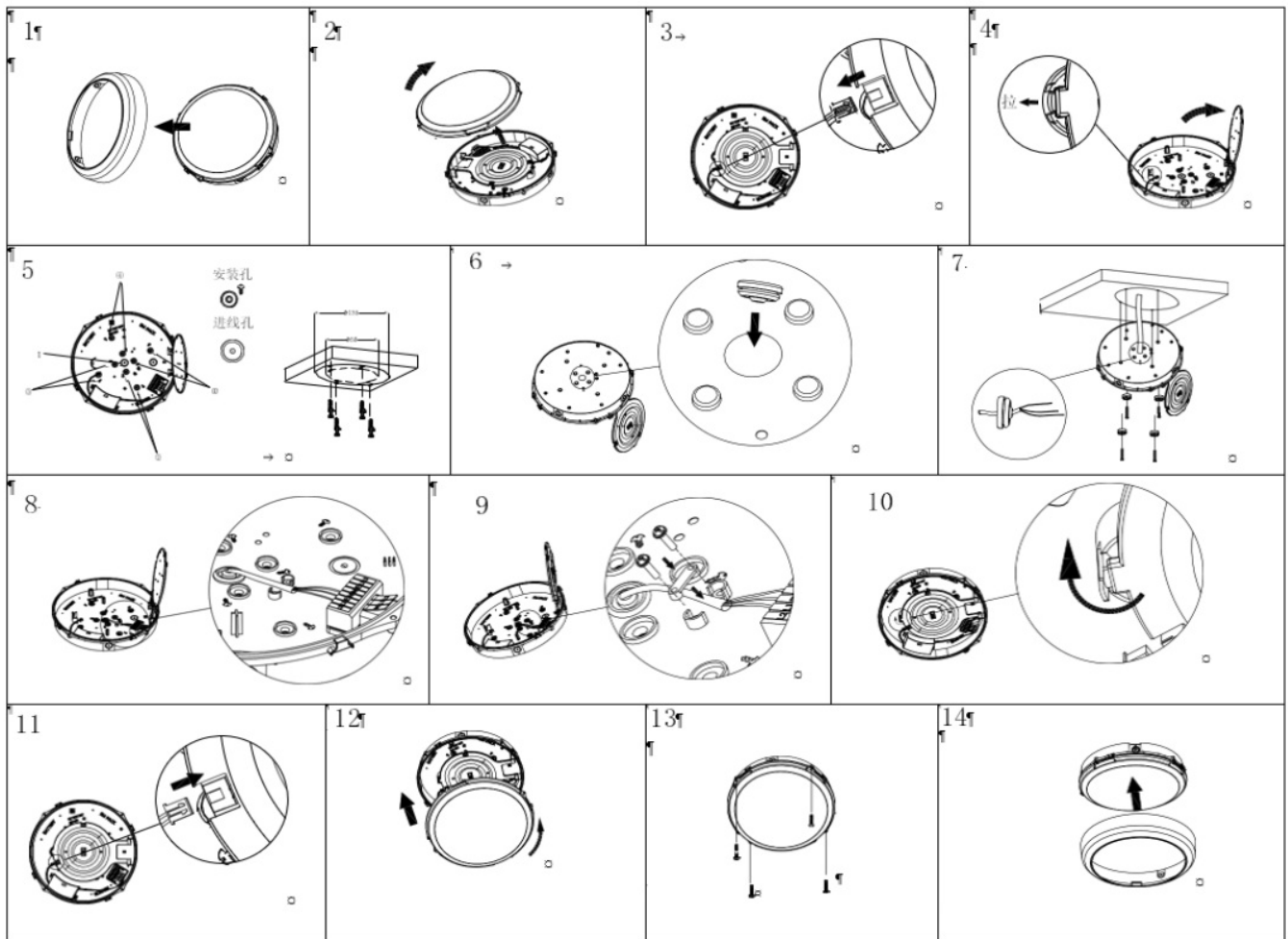

1. Remove decorative ring from the base by holding and squeezing the ring, and pulling upwards.
2. Turn the lamp cover clockwise
3. Remove the male end of the driver
4. Flip the retaining buckle at the left end of the lens to turn the lens over
5. Drill holes in the base installation holes (4 x $\Phi 4$), and drill corresponding holes in the ceiling or wall. Remove the supplied expansion bolts and place them in the ceiling or wall. At the same time, drill cable holes at the side or bottom of the base
6. Remove the waterproof rubber plug from the kit and insert it into the wire entry hole
7. Run the wire through the waterproof rubber plug, remove the supplied silicone gasket and screws (4* $\Phi 4$) and secure the base to the ceiling or wall
8. Connect the connected wire to the terminal: live wire to L1, neutral wire to N, and ground wire to E
9. Remove the cable press plate and using the supplied screws (2* $\Phi 3$) fix the wire to prevent the wire from warping
10. Flip the lens retaining buckle at the left end to snap the lens back
11. Insert the driver's male connector
12. Turn the lampshade back in a counterclockwise direction
13. Lock the lampshade using the supplied screws (4* $\Phi 3.9$)
14. Put the decorative ring back into the lamp body and press it hard to buckle the decorative ring.

TCP IP65 emergency bulkhead light

TCP IP65 emergency bulkhead light with microwave sensor

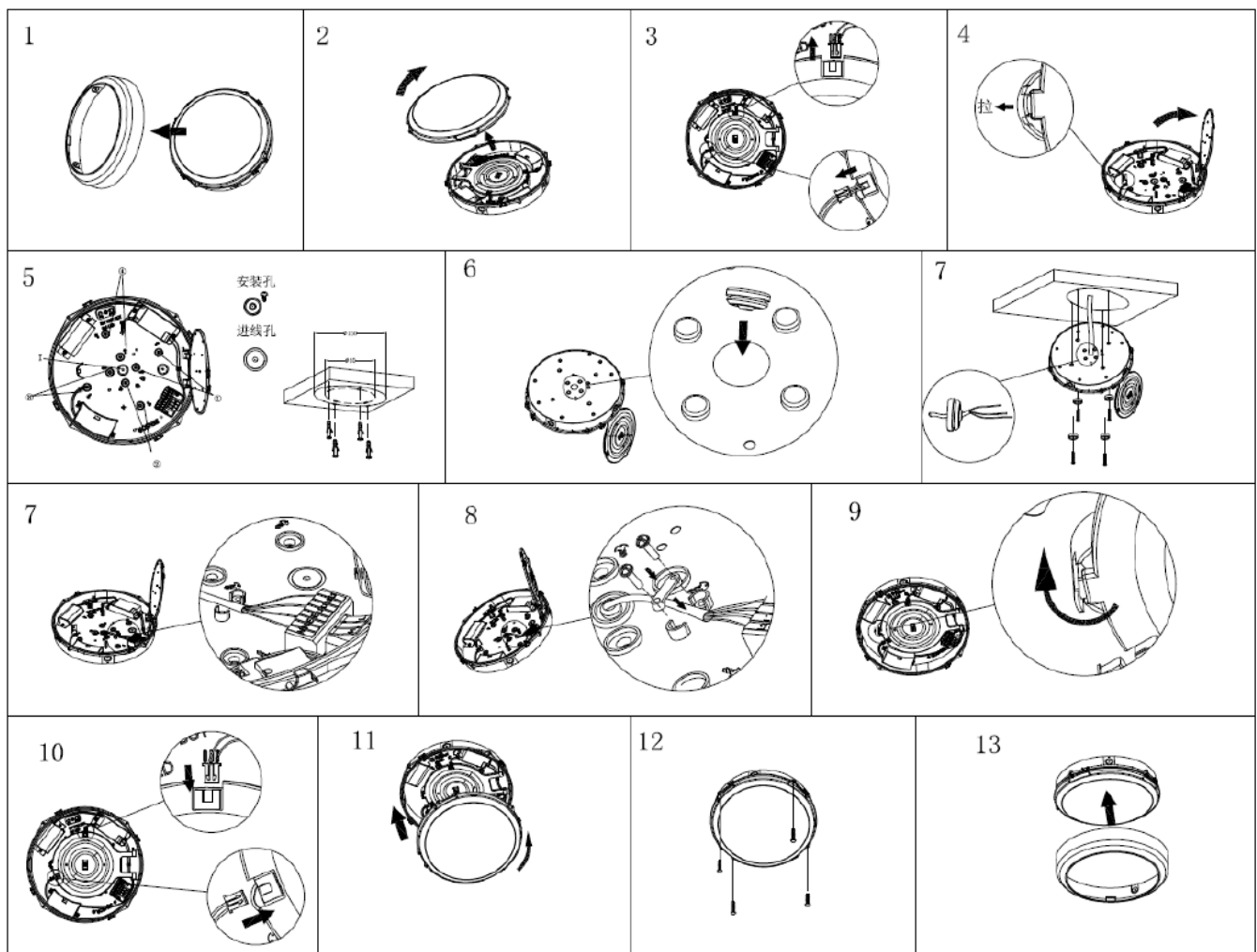

1. Remove decorative ring from the base by holding and squeezing the ring, and pulling upwards.
2. Turn the lamp cover clockwise
3. Remove the male end of the driver
4. Flip the retaining buckle at the left end of the lens to turn the lens over
5. Drill holes in the base installation holes (4 x $\Phi 4$), and drill corresponding holes in the ceiling or wall. Remove the supplied expansion bolts and place them in the ceiling or wall. At the same time, drill cable holes at the side or bottom of the base
6. Remove the waterproof rubber plug from the kit and insert it into the wire entry hole
7. Run the wire through the waterproof rubber plug, remove the supplied silicone gasket and screws (4* $\Phi 4$) and secure the base to the ceiling or wall
8. Connect the connected wire to the terminal. Connect the live wire to L1 and L2 (L2 connects to the emergency live wire), the neutral wire to N, and the ground wire to E
9. Remove the cable press plate and using the supplied screws (2* $\Phi 3$) fix the wire to prevent the wire from warping
10. Flip the lens retaining buckle at the left end to snap the lens back
11. Insert the male cables of the drive and emergency power supplies
12. Turn the lampshade back in a counterclockwise direction
13. Lock the lampshade using the supplied screws (4* $\Phi 3.9$)
14. Put the decorative ring back into the lamp body and press it hard to buckle the decorative ring

Additional Information – Please read before use

TCP IP65 emergency bulkhead light

TCP IP65 emergency bulkhead light with microwave sensor

1. The LiFePO4 rechargeable battery should be replaced when it reaches the end of its lifetime. To avoid damage to the luminaire and ensure its performance, the battery should be replaced with same type.
2. Manual test function: Press the test button, the LED indicator will turn off and the luminaire will be powered by the battery pack.
3. Press test button once for upto 1s.

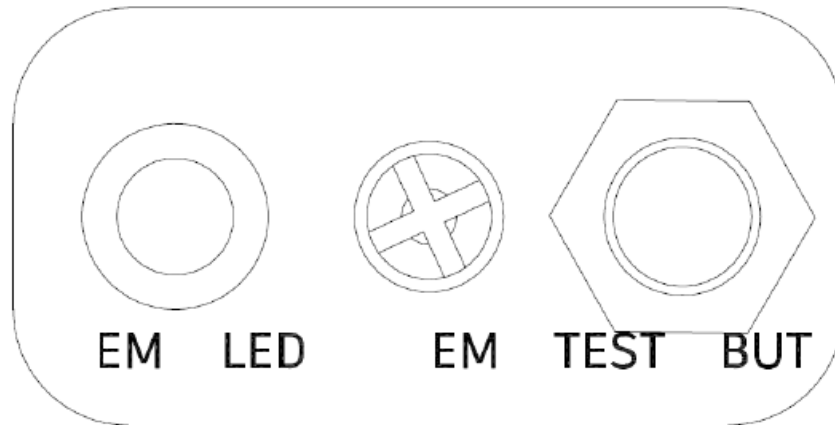

This will run a 5s duration test and the LED light will turn green indicating the emergency bulkhead is operating correctly. If the LED indicator light is flashing yellow quickly this indicates an error. To clear the error, press the red test button for more than 2s.

Press the red test button again and the yellow flashing indicator will turn green indicating the emergency bulkhead is operating correctly.

Automatic test function: Once the unit is powered up, a self-diagnostics test will be automatically initiated: battery, lamp, charge board and transfer fault.

Run 2H duration test every six months.

Note: All test functions are preset and there is no need for field adjustment.

Additional Information – Please read before use

Microwave sensor settings

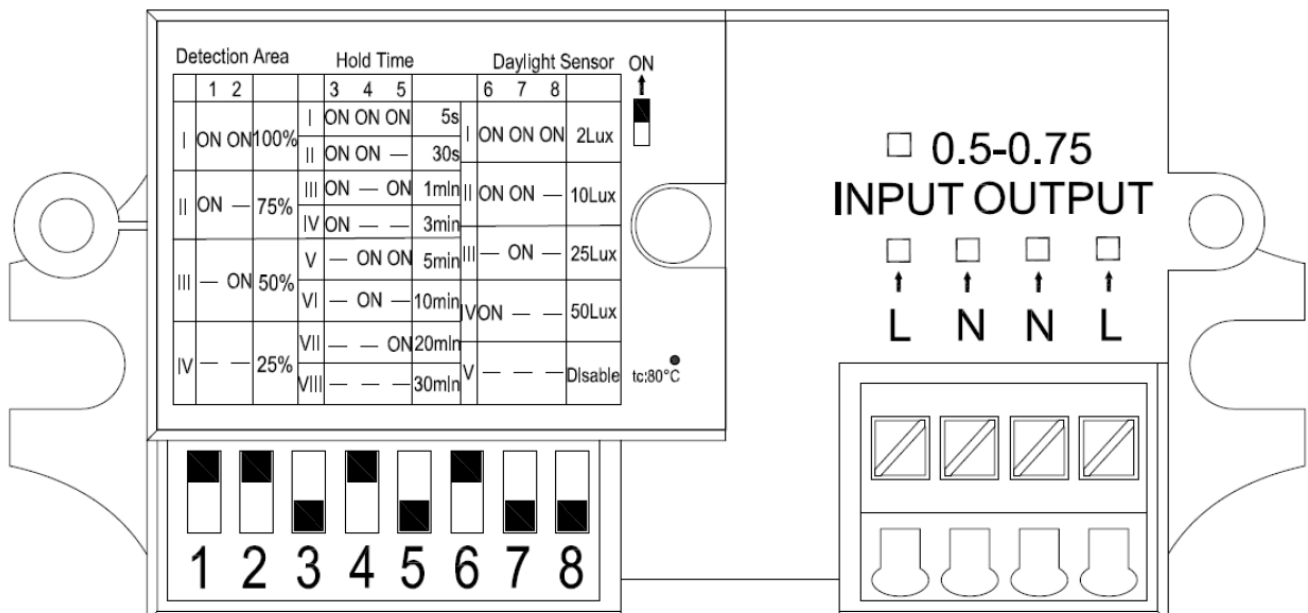

Detection Area Setting

| | 1 | 2 | |
|-----|----|----|------|
| I | ON | ON | 100% |
| II | ON | — | 75% |
| III | — | ON | 50% |
| IV | — | — | 25% |

Duration

| | 3 | 4 | 5 | |
|------|----|----|----|--------|
| I | ON | ON | ON | 5S |
| II | ON | ON | — | 30S |
| III | ON | — | ON | 1 MIN |
| IV | ON | — | | 3 MIN |
| V | — | ON | ON | 5 MIN |
| VI | — | ON | — | 10 MIN |
| VII | — | — | ON | 20 MIN |
| VIII | — | — | — | 30 MIN |

Sensor

| | 6 | 7 | 8 | |
|-----|----|----|----|---------|
| I | ON | ON | ON | 2 Lux |
| II | ON | ON | — | 10 Lux |
| III | — | ON | — | 25 Lux |
| IV | ON | — | — | 50 Lux |
| V | — | — | — | Disable |

Cleaning The Product

Turn the product off. Allow the product to cool down. Clean using a dry-damp cloth. Avoid using the damp cloth near to or inside the internal of the casing. Do not use any detergents or abrasives. Always allow it to dry thoroughly before turning the power on. It is recommended to clean the product every 2 months.

Maintenance and Storage

Installation, maintenance, checks or removal of this product should only be performed by a qualified electrician.

Disposal

Only dispose of electrical appliances as designated municipal waste facilities. Contact your local government for information regarding the collection systems available. If electrical appliances are disposed of in landfills or dumps may prove hazardous to health.

Guarantee



The manufacturer provides the guarantee in accordance with the legislation of the customer's own country of residence, with a minimum of 1 year, starting from the date on which the appliance is sold to the end user. The guarantee only covers defects in material or workmanship. The repairs under guarantee may only be carried out by an authorized service centre. When making a claim under guarantee, the original bill of purchase (with purchase date) must be submitted. The guarantee will apply only in cases of normal wear.

Registered Offices

TCP UK Ltd, 1 Exchange Court, Cottingham Road, Corby, Northants NN17 1TY.

TCP France, Quai Gabriel P'ri, 1, Joinville Le Point, France. 94340

Documents / Resources

| | |
|--|---|
|   <small>IP65 BULKHEAD CEILING LAMP IMPORTANT: PLEASE READ THESE INSTRUCTIONS BEFORE USING THE PRODUCT AND RETURN FOR FUTURE USE.</small> | <p>TCP IP65 Bulkhead Ceiling Lamp [pdf] Instruction Manual</p> <p>TCP IP65 bulkhead light, TCP IP65 microwave sensor bulkhead light, TCP IP65 emergency bulk head light, TCP IP65 emergency bulkhead light with microwave sensor, IP65 Bulkhead Ceiling Lamp, IP65, Bulkhead Ceiling Lamp, Ceiling Lamp, Lamp</p> |
|--|---|

References

- [User Manual](#)

Manuals+, Privacy Policy

This website is an independent publication and is neither affiliated with nor endorsed by any of the trademark owners. The "Bluetooth®" word mark and logos are registered trademarks owned by Bluetooth SIG, Inc. The "Wi-Fi®" word mark and logos are registered trademarks owned by the Wi-Fi Alliance. Any use of these marks on this website does not imply any affiliation with or endorsement.