



# TCP Smart SMAWISSINWMONITOR Smart Energy Monitoring Plug User Guide

[Home](#) » [TCP Smart](#) » TCP Smart SMAWISSINWMONITOR Smart Energy Monitoring Plug User Guide 

TCP Smart SMAWISSINWMONITOR Smart Energy  
Monitoring Plug User Guide



## Contents

- [1 Specifications:](#)
- [2 Cautions & Warnings:](#)
- [3 Functions:](#)
- [4 App Install](#)
- [Instructions:](#)
- [5 Smart Home Assistant](#)
- [6 Documents / Resources](#)
- [6.1 References](#)

## Specifications:

Dimensions: 55 x 55 x 58 mm  
Rated Power: AC 185-250V

Fuse: 13 Amp  
IP Rating: IP20. Indoor use only  
WiFi: 2.4 GHz  
Warranty: 2 Year Warranty

## Cautions & Warnings:

The manufacturer provides warranty in accordance with the legislation of the customer's own country of residence, with a minimum of 1 year, starting from the date on which the appliance is sold to the end user.

The warranty only covers defects in material or workmanship.

The repairs under warranty may only be carried out by an authorized service centre. When making a claim under the warranty, the original bill of purchase (with purchase date) must be submitted. The warranty will not apply in cases of:

Normal wear and tear. Use of force, damage caused by external influences. Misuse e.g. connection to an unsuitable mains supply. Partially or completely dismantled appliances.

### CORRECT DISPOSAL OF THIS PRODUCT

(Waste Electrical & Electronic Equipment) This marking shown on the product indicates that it should not be disposed with other household wastes at the end of its working life.

Please separate from other types of waste and recycle responsibly. If in doubt, please contact your local recycling centre for details of where and how this item can be safely recycled.



## Functions:

Monitoring your device's energy usage can help with making cost-effective decisions on how and when to use your appliance, or even if there is a need to replace with more energy-efficient models.

To start monitoring the Kilowatt usage and cost of an electrical device please read the below instructions, set up the necessary information into the Smart Energy Monitoring Plug App and plug your electrical device into the Smart plug.

TCP hereby declares that the device is in compliance with the essential requirements and other relevant provisions of directives 2014/53/EU and 2011/65/EU. Full declaration can be viewed at [tcp.eu](http://tcp.eu).

## App Install Instructions:

01. Download the TCP Smart App from the App Store or Google Play.  
Log in or set up an account using the on screen prompts.



<http://l.ead.me/bawWnR>

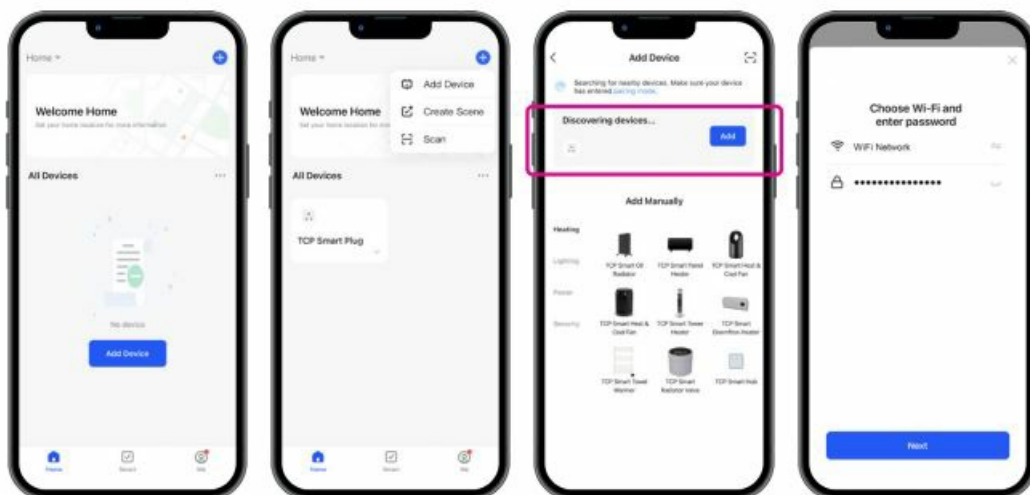

02. Use the add device button in the top right corner.

03. Choose add device from the menu.

04. The energy monitor plug should automatically be discovered. If not, choose plug

from the power tab.

05. Enter your network details.



If the Plug is not automatically detected or if the installation fails the Plug can be put into set-up mode by holding down the power button on the side for 5 seconds or until you hear the click. The blue light should now flash rapidly and the steps above should be followed.

## Smart Home Assistant

TCP Smart products work with Amazon Alexa, Google Nest & Siri Shortcuts.

For further information on connecting to smart home assistants visit <https://www.tcpsmart.eu/faq/>



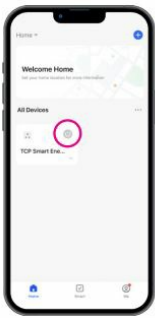

01. Smart Plug can be quickly turned On/Off from the home screen.



02. Other quick tasks can be accessed by tapping on the down arrow.

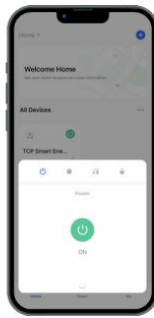

03. Power - Turn the Plug On/Off.

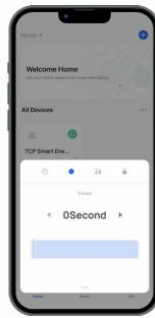

04. Timer - Set a one time only time for the Plug to change its current state. On > Off / Off > On.



05. Relay Status - Choices on how the Plug will operate when disconnected from the mains.



06. Child Lock - xx



01. On/Off - Press the Plug icon to turn On/Off the Plug.



02. Daily Costs - Summary of the daily costs is displayed here. Press it to access more detail.



03. Set up the costs using the COST SETTINGS button.

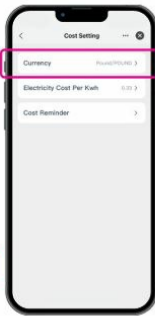

04. Set the currency for your area.



05. Choose the correct currency from the list.

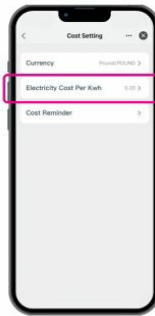

06. Set the cost you pay for electricity.

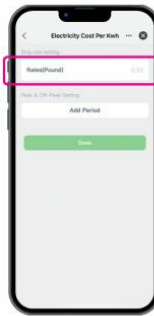

07. Enter the cost you pay in the rates section.



08. Cheaper rates for specific times can be added by tapping ADD PERIOD.

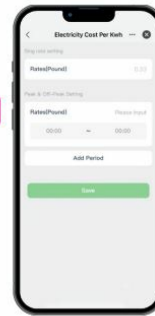

09. Enter the additional costs and times. To finish tap SAVE.



10. You can set reminders to receive alerts when you hit Daily, Weekly or Monthly costs.

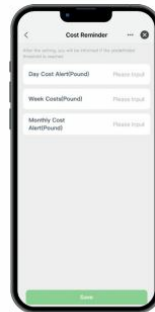

11. Enter the reminder costs for Day, Week and Months. SAVE to finish.



12. The costs tab will now update as energy is used, showing you the costs spent that day.



13. The graph can show Days, Weeks, Months and Years.



14. Usage data can be shared to an email address for future reference.

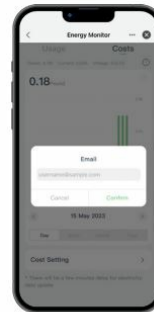

15. Enter the email address for the data to be sent to.

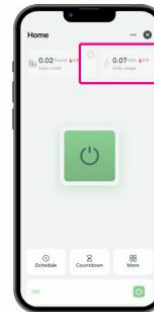

16. Energy Usage - Summary of the daily usage is displayed here. Press it to access more detail.



17. The usage tab will show the energy used on that day.



18. The graph can show Days, Weeks, Months and Years.



19. You can set reminders to receive alerts when you hit Daily, Weekly or Monthly usage.



20. Enter the reminder costs for Day, Week and Months. SAVE to finish.

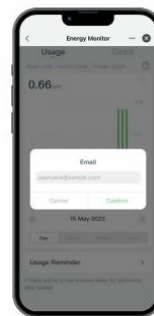

21. Enter the email address for the data to be sent to.



22. Schedules - Schedules can be set to automate the Smart Plug.



23. Saved Schedules can be accessed here. Tap ADD to add your first schedule.



24. From the list chose which type of schedule to use.

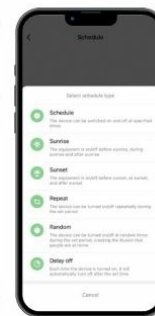

25. Schedule - Choose the specific days and time to turn the Plug On / Off.



26. Select the time for the schedule to start.



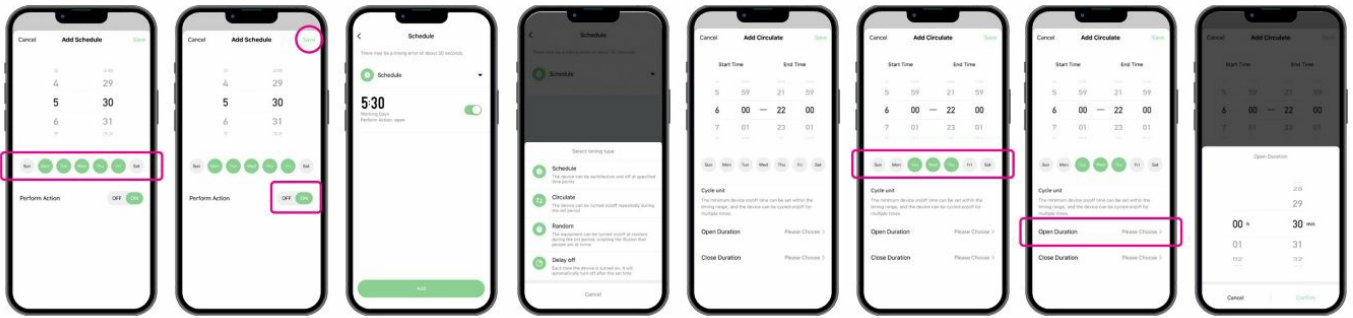

27. Select the days the schedule should run on.

28. Set the action for the schedule. On / Off. Save the schedule (Top right).

29. The saved schedule is now visible. Toggle the switch to activate or deactivate.

30. **Circulate** - The Plug can be turned On / Off In / For a selected period of time.

31. Choose the Start and End time the Plug can be turned On / Off in.

32. Select the days the Circulate schedule can run on.

33. Open duration is the minimum amount of time the Plug can be On for.

34. Choose the minimum amount of time the Plug can be On for.

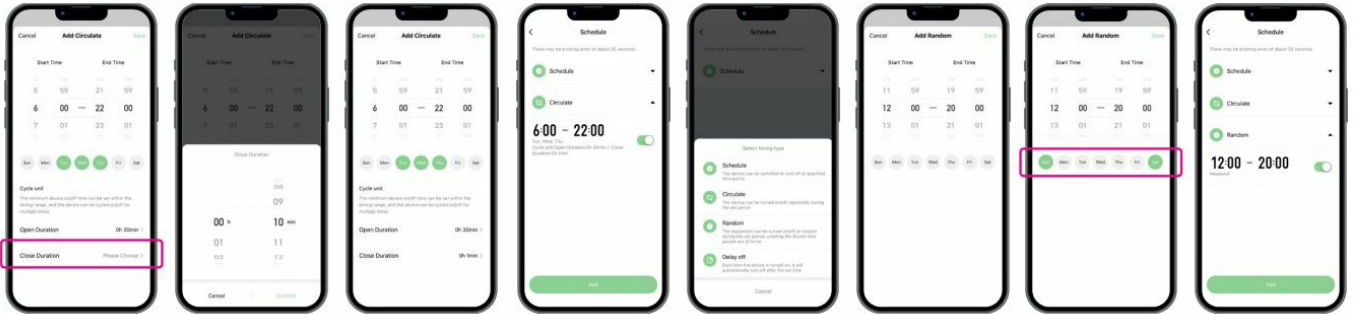

35. Close duration is the minimum amount of time the Plug can be Off for.

36. Choose the minimum amount of time the Plug can be Off for.

37. Save to finalise the schedule.

38. The saved schedule is now visible. Toggle the switch to activate or deactivate.

39. **Random** - The Plug will randomly turn On / Off in the selected time period, creating the illusion people are at home.

40. Select the time period for the schedule.

41. Select the days the schedule should run on.

42. The saved schedule is now visible. Toggle the switch to activate or deactivate.



43. **Delay Off** - Delay Off will turn the Plug off at a set time once it is turned on.

44. Set the time to automatically turn off when the Plug is turned on.

45. The saved schedule is now visible. Toggle the switch to activate or deactivate.

46. **Timer** - Set a one time only time for the Plug to change its current state. On > Off / Off > On.

47. Set the time for the Plug to change state.

48. When set a countdown timer is visible on the Plug home screen.

49. To amend or cancel the Timer click on TIMER then RESET or the CANCEL button.

50. **Options** - Tap the MORE button to access further options.

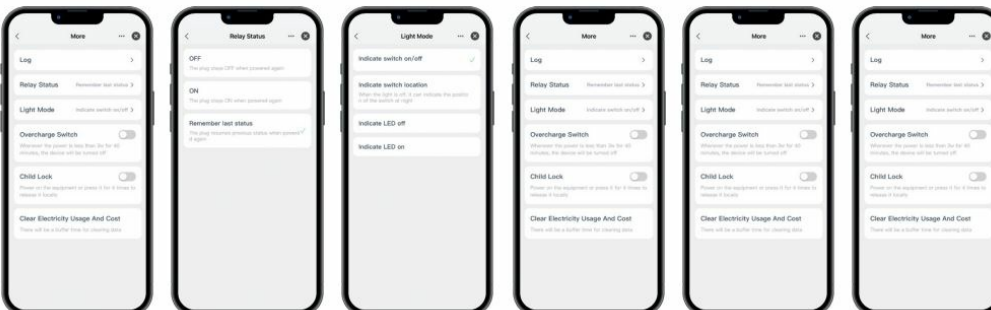

51. **Log** - A log of all times the Plug has been On / Off.

52. **Relay Status** - Choices on how the Plug will operate when disconnected from the mains.

53. **Light Mode** - Options for how the light on the Plug will operate.

54. **Overcharge Switch** - Any device drawing less than 3w for 40+ mins should be turned off.

55. **Child Lock** - Stops the switch being used.

56. **Clear Data** - Clear all device cost and usage data.

Documents / Resources

	<p><a href="#">TCP Smart SMAWISSINWMONITOR Smart Energy Monitoring Plug</a> [pdf] User Guide SMAWISSINWMONITOR, SMAWISSINWMONITOR Smart Energy Monitoring Plug, Smart Energy Monitoring Plug, Monitoring Plug, Plug</p>
---	---

References

- [Homepage | TCP](#)
- [FAQ – TCP Smart](#)