



TCL Electronics Holdings Ltd.

## PRODUCT FORM

(Brand/Region): TCL/NA

(BOM No.):

(Version): V1.0

(Part No.):

(Part No.): QSG

(Model No.): Z100-SW NA

(Date): 2025-04-14

(Scale) : 1:1

(Size) :

(Material) :

(Colour) :

PREPARED BY:  CHECKED BY:  CHECKED BY:  
 APPROVED BY:

## Contents [ [hide](#) ]

### 1 Z100-SW

#### 1.1 Wireless Subwoofer Quick Start Guide

##### 1.1.1 Important safety instructions

##### 1.1.2 Compliance notice

### 2 Documents / Resources

#### 2.1 References

## Z100-SW

### Wireless Subwoofer Quick Start Guide



1

Make sure you read all the safety information before you use this product.

User Manual can be found at [www.tcl.com](http://www.tcl.com) on the specific product page in the “Download” section.

 **Warning:**

To avoid the danger of suffocation, keep plastic packaging away from pets, babies, and children. Do not use packaging bags in cribs, beds, carriages, or playpens.



**Wireless Subwoofer**



**AC Power Cord**



**Quick Start Guide**

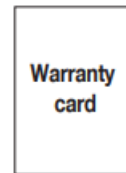

**Warranty card**

**2**

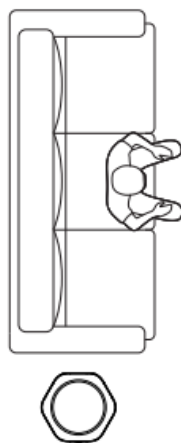

**(1)**

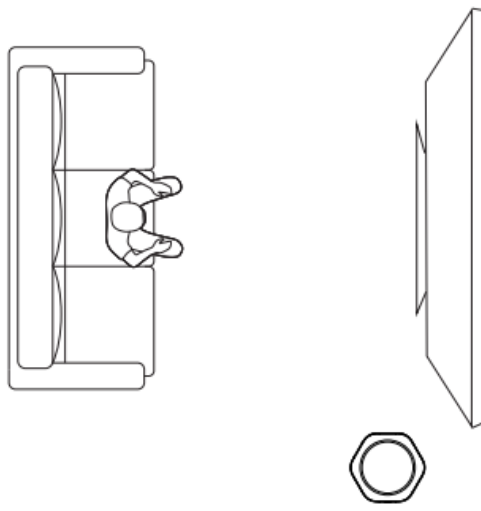

(2)

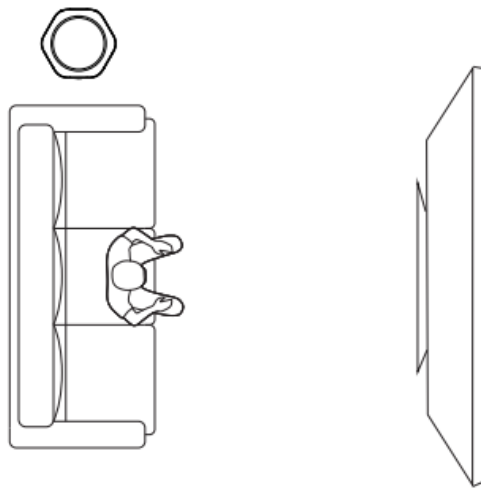

(3)

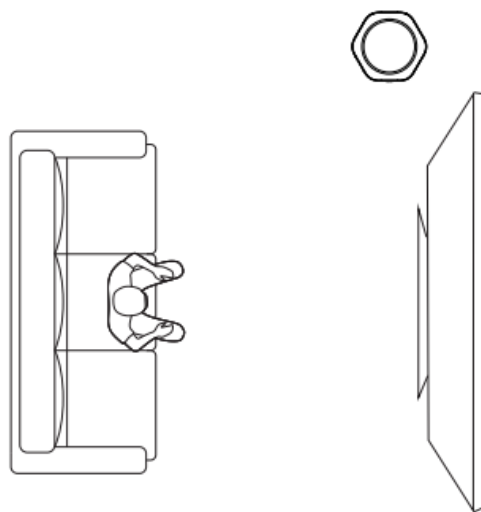

(4)

Method 1: When the product is started for the first time, it will automatically enter the pairing mode. The TV terminal needs to open the specified page to discover the list of speakers.

The path of the specified page: All Settings > Display and Sound > Audio Output Settings > Speaker Management (Z100) (> Pair and Manage > Add New Device)  
(The path may vary depending on the specific model of the television.)

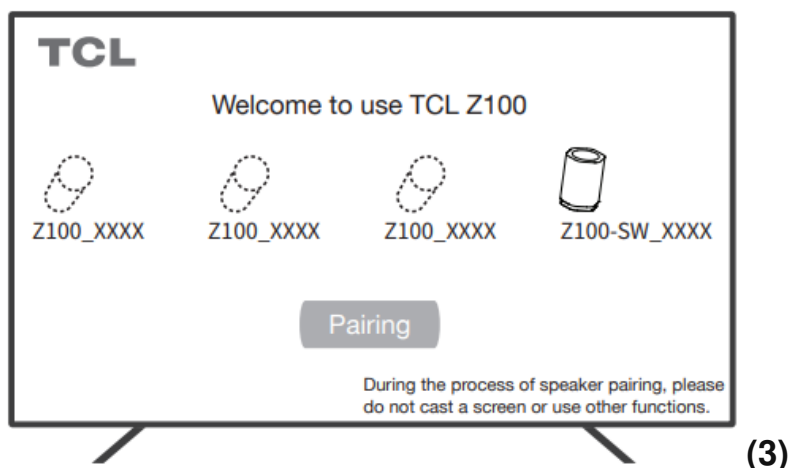
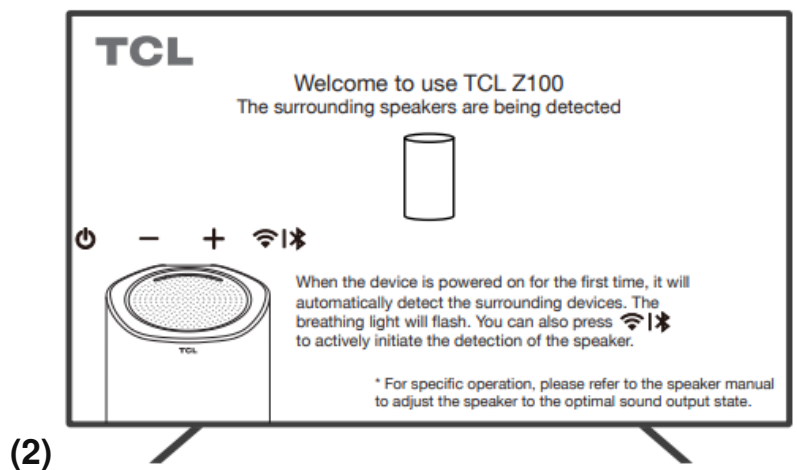
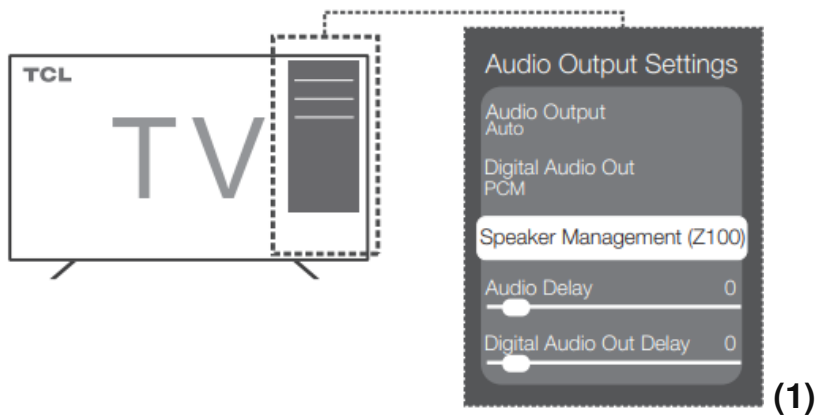

3b



Method 2: Press and hold  for 3 seconds to enter pairing mode with the TV.

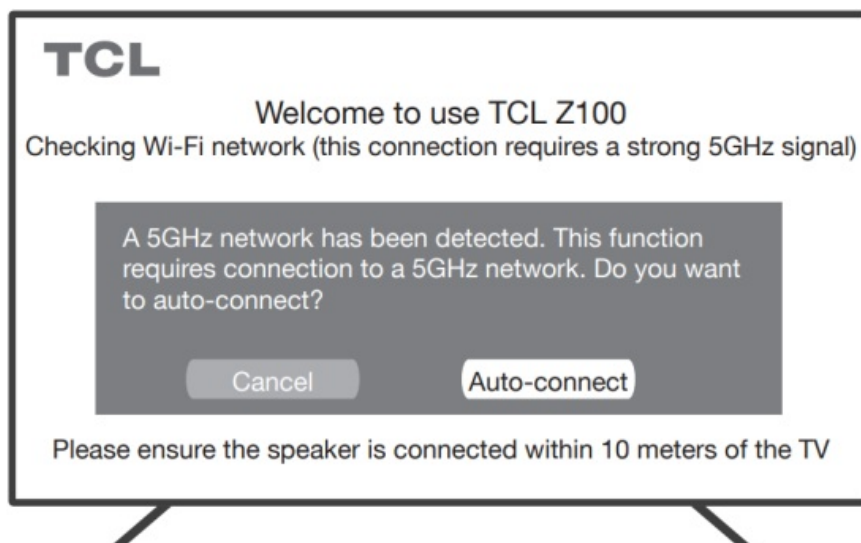

4



Click “Sound” -> “Speaker Management”.

\* TV related schematic diagram. The actual TV interface display shall prevail.

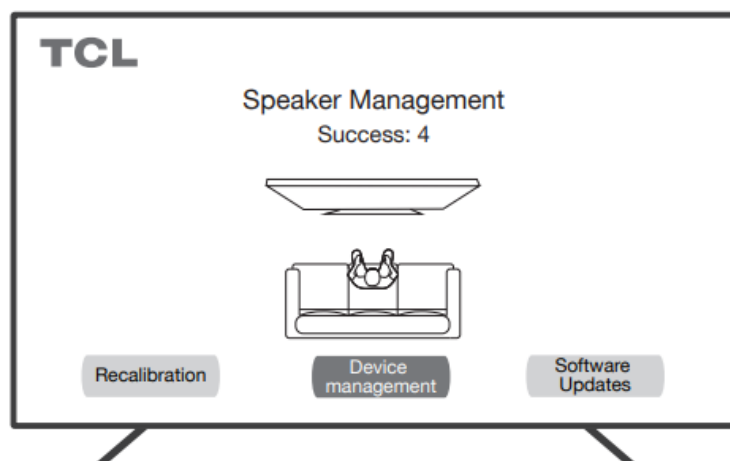

(1)

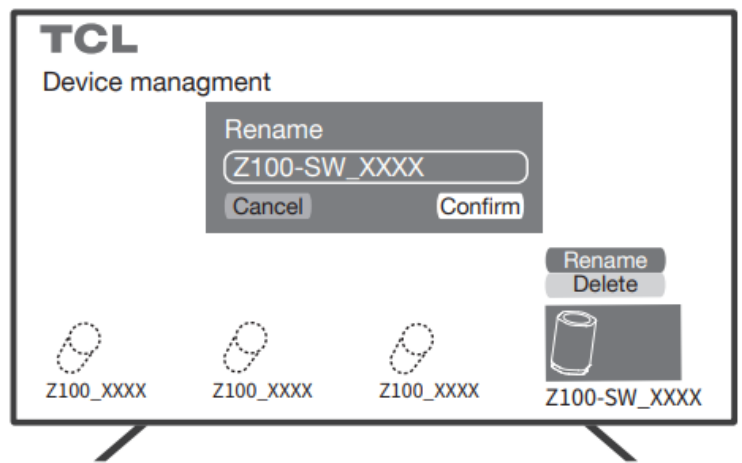

(2)

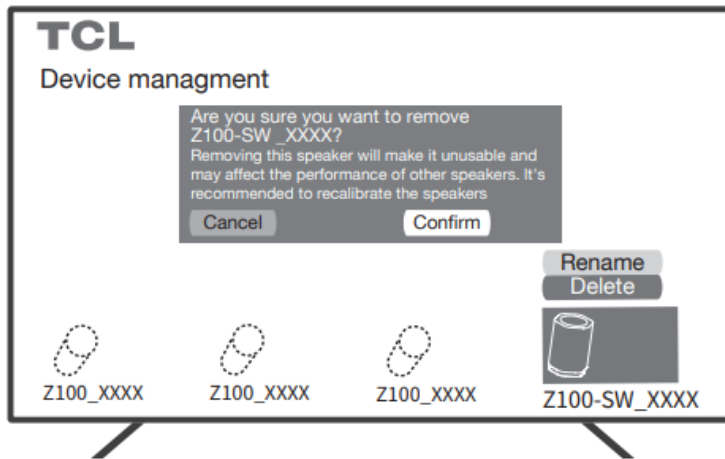

(3)



When the subwoofer is powered on for the first time and has no previous pairing record, it will automatically enter pairing mode. A pairing prompt will appear on the TV. Select "Connect" to complete the setup. Once connected and calibrated, the subwoofer is ready to use. If pairing fails or needs to be redone, follow the steps below:

1. Press and hold the  button on the subwoofer for 3 seconds until the orange indicator starts flashing rapidly. This indicates that the subwoofer has entered pairing mode. (If no device is connected within 180 seconds, the light will turn off and pairing mode will end automatically.)
2. When the orange LED stays on for 2.5 seconds and then fades out for 0.5 seconds, the subwoofer is successfully connected to the TV.
3. When the orange LED fades in and out 5 times over 5 seconds, the subwoofer will be disconnected from the TV.

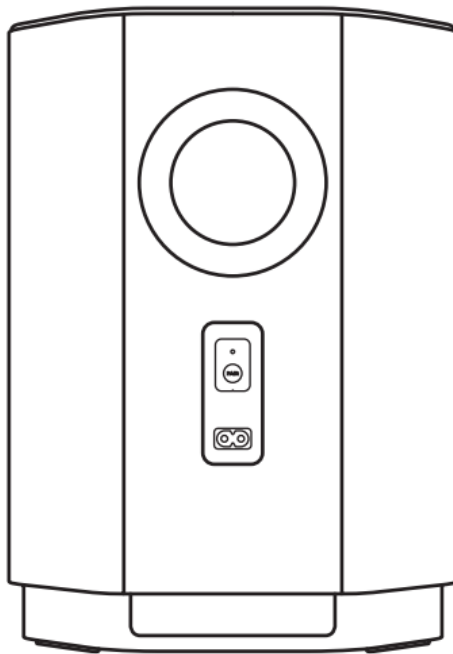



### Important safety instructions

Make sure you read all the safety information before you use this product.

TCL North America bears no responsibility for accidents or damages caused by unauthorized changes, modifications or improper use of the product.

User Manual can be found at [www.tcl.com](http://www.tcl.com) on the specific product page in the “Download” section.

	<b>CAUTION</b>	
	RISK OF ELECTRIC SHOCK DO NOT OPEN	
CAUTION: TO REDUCE THE RISK OF ELECTRIC SHOCK, DO NOT REMOVE COVER (OR BACK). NO USER-SERVICEABLE PARTS INSIDE. REFER SERVICING TO QUALIFIED SERVICE PERSONNEL.		

 The lightning flash with arrowhead symbol, within an equilateral triangle is intended to alert the user to the presence of uninsulated dangerous voltage within the product’s enclosure that may be of sufficient magnitude to constitute a risk of electric shock.





The exclamation point within an equilateral triangle is intended to alert the user to the presence of important operating and maintenance (servicing) instructions in the literature accompanying the product.



This symbol indicates that this product incorporates double insulation between hazardous main voltage and user accessible parts. When servicing, use only identical replacement parts.

## Warnings

- To reduce the risk of fire or electric shock, do not expose this product to rain or moisture. This product should not be exposed to dripping or splashing. No objects filled with liquids, such as vases, should be placed on or near the product.
- To avoid danger of suffocation, keep this plastic bag away from babies and children. Do not use this bag in cribs, beds, carriages or playpens. This bag is not a toy.

## Safety

- **Read these instructions** – Read all the safety and operating instructions before operating the product.
- **Retain these instructions** – Retain the safety and operating instructions for future reference.
- **Heed all warnings** – Adhere to all warnings on the product and in the operating instructions.
- **Follow all instructions** – Follow all operating and use instructions.
- **Do not use this apparatus near water** – The appliance should not be used near water or moisture – for example, in a wet basement or near a swimming pool and the like.
- **Clean only with a dry cloth.**
- **Do not block any ventilation openings.** Install in accordance with the manufacturer's instructions.
- **Do not install near any heat sources** such as radiators, heat registers, stoves, or other apparatus (including amplifiers) that produce heat.

- **Do not defeat the safety purpose** of the polarized or grounding-type plug. A polarized plug has two blades with one wider than the other. A grounding type plug has two blades and a third grounding prong. The wide blade or the third prong are provided for your safety. If the provided plug does not fit into your outlet, consult an electrician for replacement of the obsolete outlet.
- **Protect the power cord** from being walked on or pinched particularly at plugs, convenience receptacles, and the point where it exits from the product. If the cord set is damaged, it must be replaced by a special cord set available from the manufacturer or its service agent.
- **Use only attachments/accessories** specified by the manufacturer.
- **Use only with the cart**, stand, tripod, bracket, or table specified by the manufacturer, or sold with the apparatus. When a cart is used, use caution when moving the cart/apparatus combination to avoid injury from tip-over.



- **Unplug this apparatus** during lightning storms or when unused for long periods of time.
- **Refer all servicing** to qualified service personnel. Servicing is required when the apparatus has been damaged in any way, such as power-supply cord or plug damaged, liquid has been spilled or objects have fallen into the apparatus, the apparatus has been exposed to rain or moisture, does not operate normally, or has been dropped.
- **The user must maintain** a minimum distance of 20CM from the device at all time.
- **This appliance is not intended** for use by young children or infirm persons without supervision. Young children should be supervised to ensure that they do not play with the appliance.

## Cautions

- To prevent electric shock, match wide blade of plug to wide slot, fully insert.
- Do not place any sources of danger on the product (for example: liquid filled objects, lighted candles).

- Disconnect the power cord to shut off when find trouble or not in use. The power cord shall be readily operable.
- Use of controls or adjustments or performance of procedures other than those described herein, may result in hazardous radiation exposure or other unsafe operation.
- The power cord/appliance coupler is used as the disconnect device, the disconnect device must remain readily operable.
- The rating label is located at the bottom or back of the product.
- The use of apparatus in tropical and moderate climates.

## **Disposal of your old product**

Your product is designed and manufactured with high quality materials and components, which can be recycled and reused.

This product may contain lead and mercury. Disposal of these materials may be regulated due to environmental considerations. For disposal or recycling information, please contact your local authorities.

## **Compliance notice**

### **Notice for US**

FCC Information

### **Warning**

Changes or modifications to this unit not expressly approved by the party responsible for compliance could void the user's authority to operate the equipment.

### **Note**

This equipment has been tested and found to comply with the limits for a Class B digital device, pursuant to Part 15 of the FCC Rules. These limits are designed to provide reasonable protection against harmful interference in a residential installation. This equipment generates, uses and can radiate radio frequency energy and, if not installed

and used in accordance with the instructions, may cause harmful interference to radio communications. However, there is no guarantee that interference will not occur in a particular installation.

If this equipment does cause harmful interference to radio or television reception, which can be determined by turning the equipment off and on, the user is encouraged to try to correct the interference by one or more of the following measures:

- Reorient or relocate the receiving antenna.
- Increase the separation between the equipment and receiver.
- Connect the equipment into an outlet on a circuit different from that to which the receiver is connected.
- Consult the dealer or an experienced radio / TV technician for help.

This device complies with Part 15 of the FCC Rules. Operation is subject to the following two conditions:

- (1) this device may not cause harmful interference, and
- (2) this device must accept any interference received, including interference that may cause undesired operation.

**FCC Radiation Exposure Statement:** This equipment complies with FCC radiation exposure limits set forth for an uncontrolled environment. This equipment should be installed and operated with a minimum distance of 20cm between the radiator and your body. This transmitter must not be co-located or operated in conjunction with any other antenna or transmitter

## **Notice for Canada**

### **Class B Clause**

This Class B digital apparatus complies with Canadian ICES-003

This device contains licence-exempt transmitter(s)/receiver(s) that comply with Innovation, Science and Economic Development Canada's licence-exempt RSS(s). Operation is subject to the following two conditions:

1. This device may not cause interference.
2. This device must accept any interference, including interference that may cause undesired operation of the device.

## **Radiation Exposure Statement**

This equipment complies with IC radiation exposure limits set forth for an uncontrolled environment. This equipment should be installed and operated with minimum distance 20cm between the radiator & your body.

**Warning:** The user is cautioned that changes or modifications not expressly approved by the party responsible for compliance could void the user's authority to operate the equipment.

The device for operation in the band 5150-5250 MHz is only for indoor use to reduce the potential for harmful interference to co-channel mobile satellite systems.

## **DO NOT RETURN TO STORE**

## **WE ARE READY TO HELP**

**contact us first with any questions**

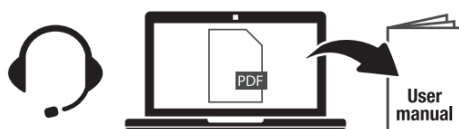

### **TCL SUPPORT:**

US: [support.tcl.com](https://support.tcl.com)

CA: [www.tcl.com/ca/en](https://www.tcl.com/ca/en)

[www.tcl.com/ca/fr](https://www.tcl.com/ca/fr)

1-[877-300-9223](tel:877-300-9223)

MX: [www.tcl.com/mx/es](https://www.tcl.com/mx/es)

55 7005 5159



**TAKE CARE WHEN REMOVING THE WIRELESS SUBWOOFER**



The Bluetooth® word mark and logos are registered trademarks owned by Bluetooth SIG, Inc. and any use of such marks by TTE Corporation is under license. Other trademarks and trade names are those of their respective owners.



Dolby, Dolby Atmos, and the double-D symbol are registered trademarks of Dolby Laboratories Licensing Corporation. Manufactured under license from Dolby Laboratories. Confidential unpublished works. Copyright © 2012-2025 Dolby Laboratories. All rights reserved.

Copyright © 2025 TCL.  
All rights reserved.

## Documents / Resources

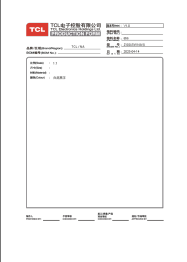

[TCL Z100-SW Wireless Subwoofer \[pdf\]](#) User Guide  
Z100SW, 2BEHEZ100SW, Z100-SW Wireless Subwoofer, Z100-SW, Wire  
less Subwoofer, Subwoofer

## References

- [User Manual](#)

🔍 2BEHEZ100SW, Subwoofer, TCL, Wireless Subwoofer, Z100-SW, Z100-SW Wireless Subwoofer,  
📁 TCL Z100SW

---

## Leave a comment

Your email address will not be published. Required fields are marked \*

Comment \*

Name

Email

Website

☐ Save my name, email, and website in this browser for the next time I comment.

Post Comment

Search:

e.g. whirlpool wrf535swhz

Search

[Manuals+](#) | [Upload](#) | [Deep Search](#) | [Privacy Policy](#) | [@manuals.plus](#) | [YouTube](#)

This website is an independent publication and is neither affiliated with nor endorsed by any of the trademark owners. The "Bluetooth®" word mark and logos are registered trademarks owned by Bluetooth SIG, Inc. The "Wi-Fi®" word mark and logos are registered trademarks owned by the Wi-Fi Alliance. Any use of these marks on this website does not imply any affiliation with or endorsement.