



TCL30 Plus Smartphone User Guide

[Home](#) » [TCL](#) » TCL30 Plus Smartphone User Guide 

Contents

- [1 TCL30 Plus Smartphone](#)
- [2 Keys and connectors](#)
- [3 Getting started](#)
- [4 Home screen](#)
- [5 Phone call](#)
- [6 Contacts](#)
- [7 Messaging](#)
- [8 Gmail](#)
- [9 Help](#)
- [10 General Information](#)
- [11 Documents / Resources](#)
 - [11.1 References](#)
- [12 Related Posts](#)

TCL

TCL30 Plus Smartphone



Keys and connectors

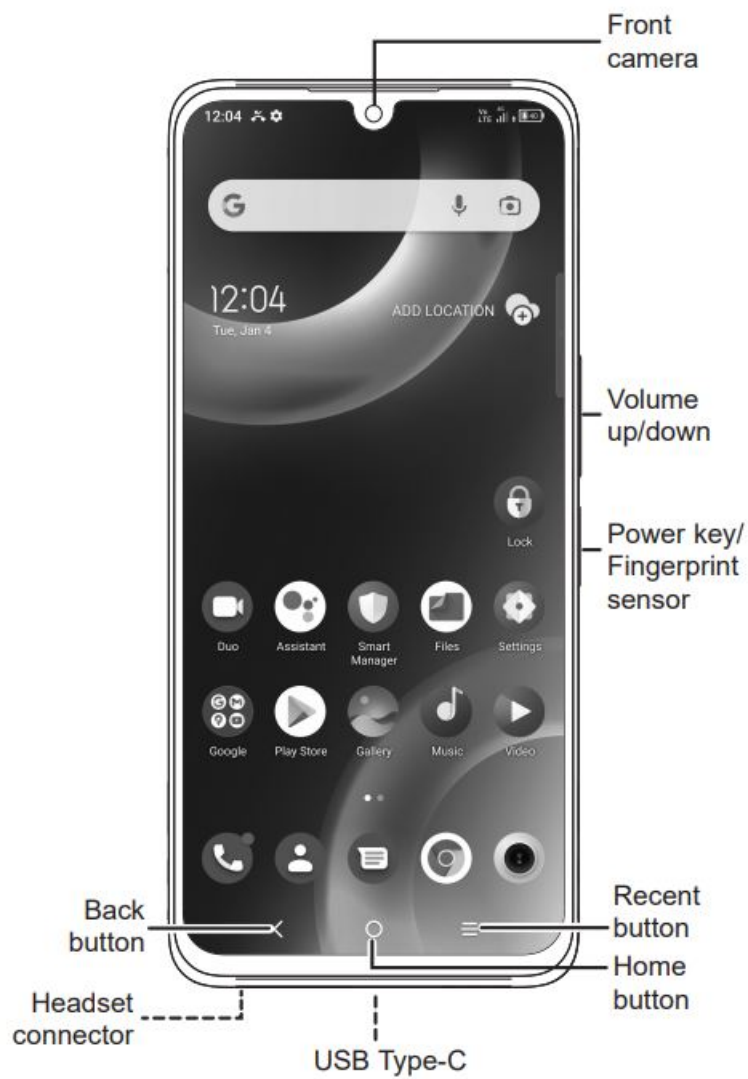

Right-hand mode:



Left-hand mode:

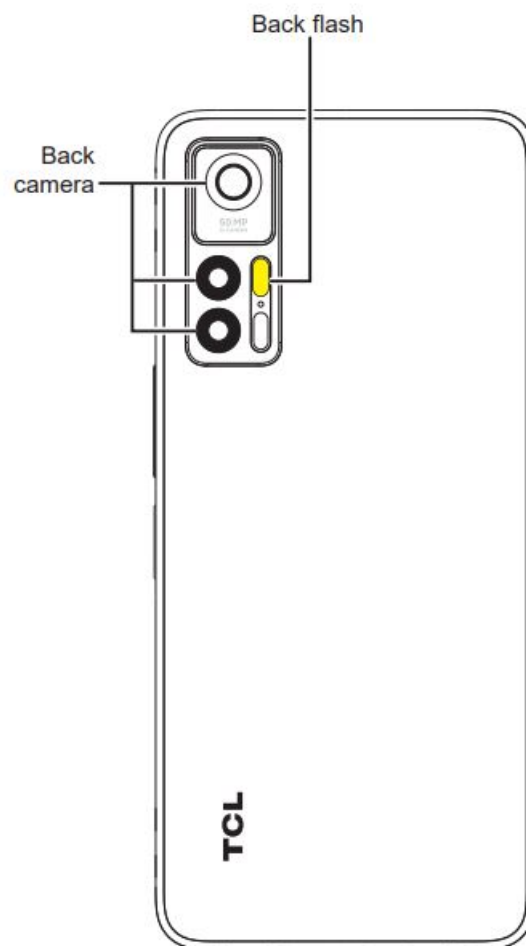

Getting started

1. Charge the battery

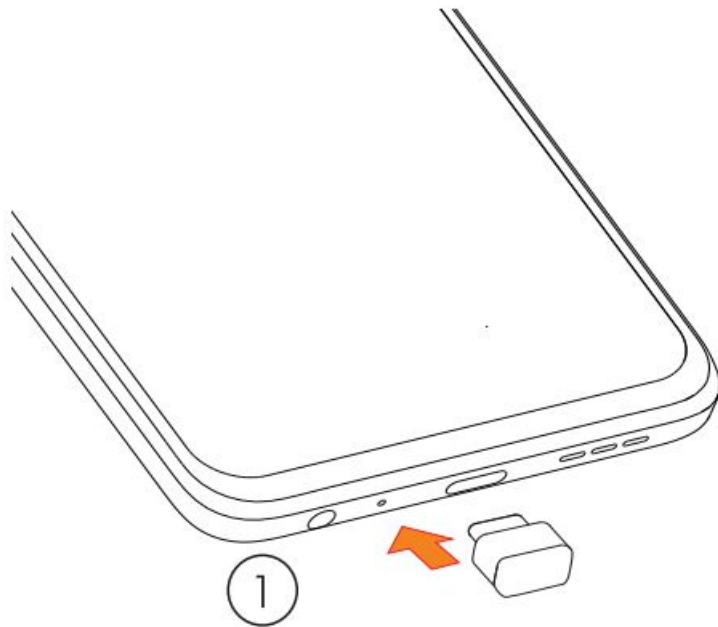

2. Insert or remove the SIM card or microSD card.
3. Insert or remove the SIM card.

Single-SIM devices only

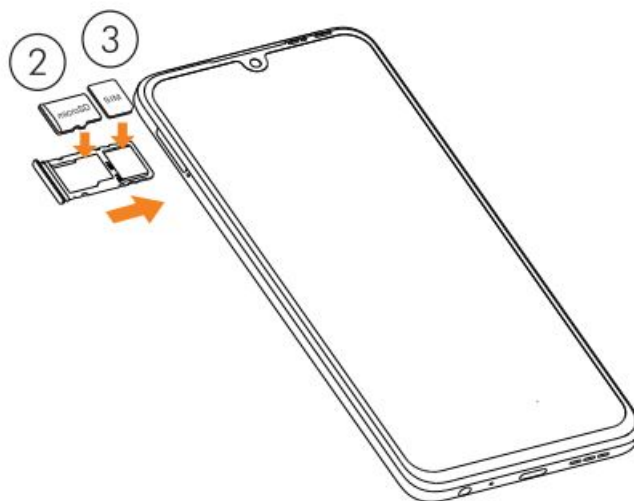

Dual-SIM devices only

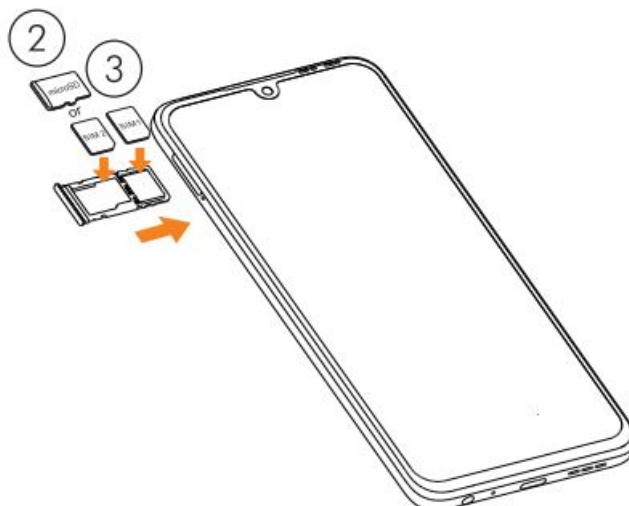

Home screen

You can bring all of the items (applications, shortcuts, folders) that you use most frequently to your Home screen for quick access. Touching the Home button always takes you back to the main Home screen.

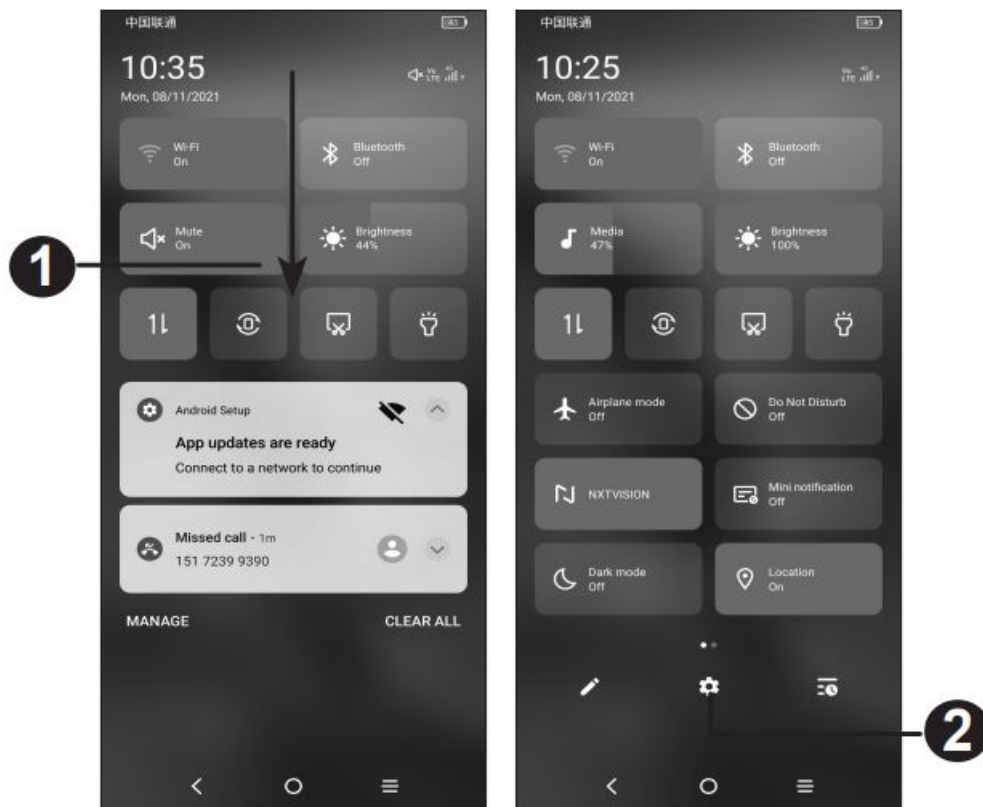

1. Touch and drag down to open the Notification panel.
2. Open Settings, to view the full list of settings.

Phone call

Making a call

Enter the desired number from the keyboard and touch to make a call.

Answering a call

When you receive a call:

- Tap ANSWER, or swipe up to answer;
- Tap DECLINE, or swipe down to reject;
- Tap to reject the call by sending a preset message

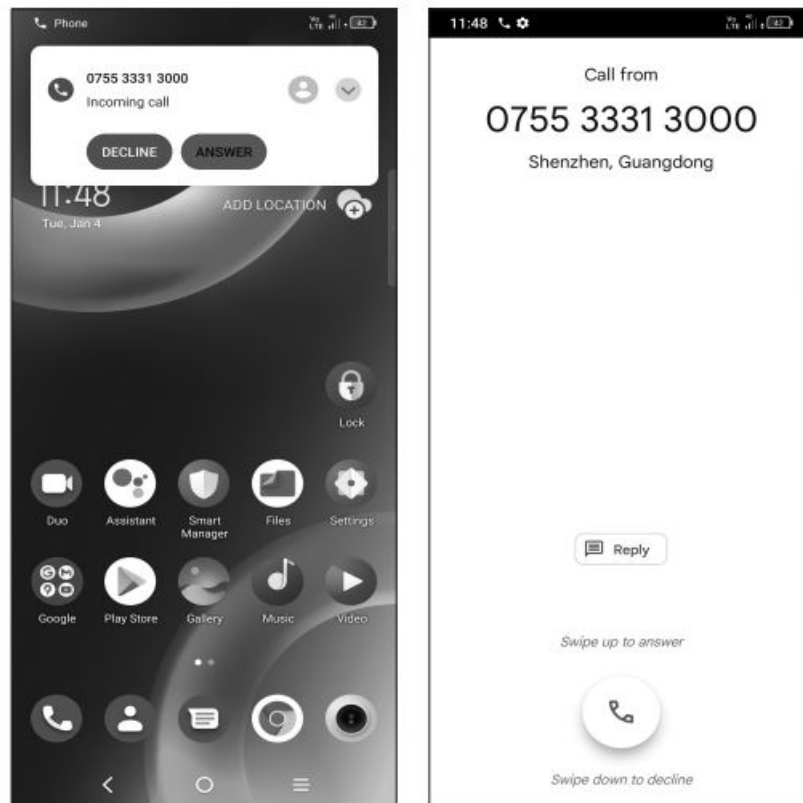

Contacts

You can view and create contacts on your phone and synchronize these with your Gmail contacts or other applications on the web or on your phone.

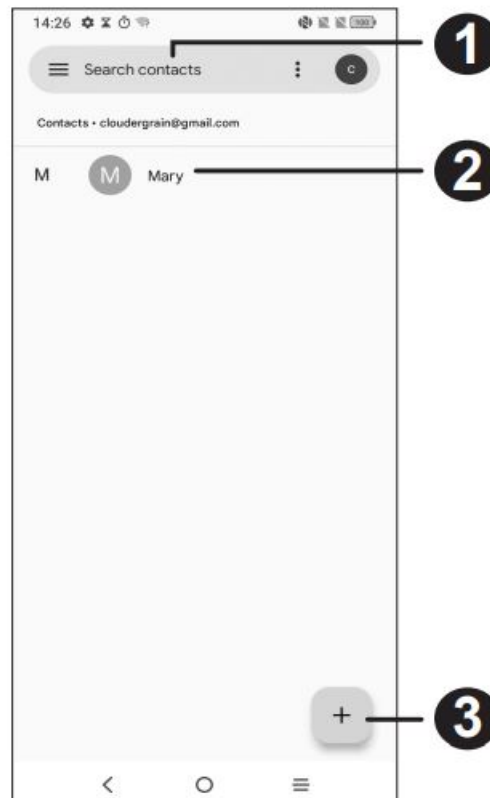

1. Search in Contacts
2. Open the Quick contact panel Touch and hold to share or delete the selected contact
3. Add new contact

Messaging

You can create, edit, and receive SMS and MMS. An SMS will be converted to MMS automatically when media files (image, video, audio, slides, etc.) are attached or subject or email addresses are added.

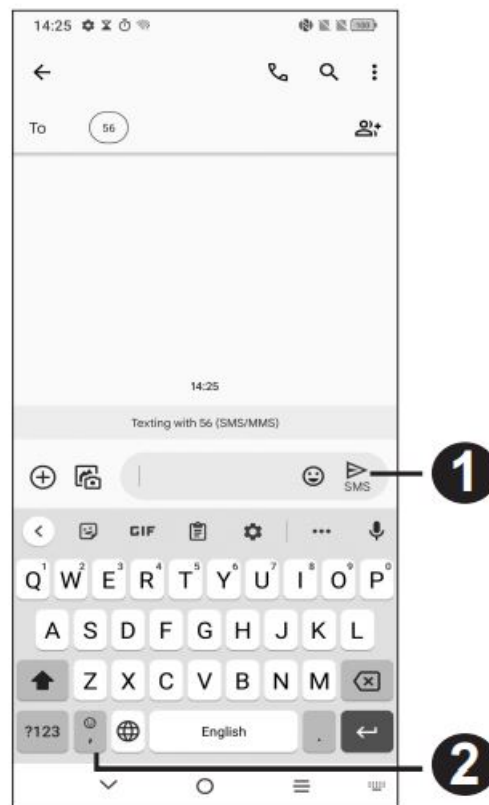

1. Send the text message
2. Insert emoticons

Gmail

The first time you set up your phone, you can select to use an existing Gmail account or to create a new one.

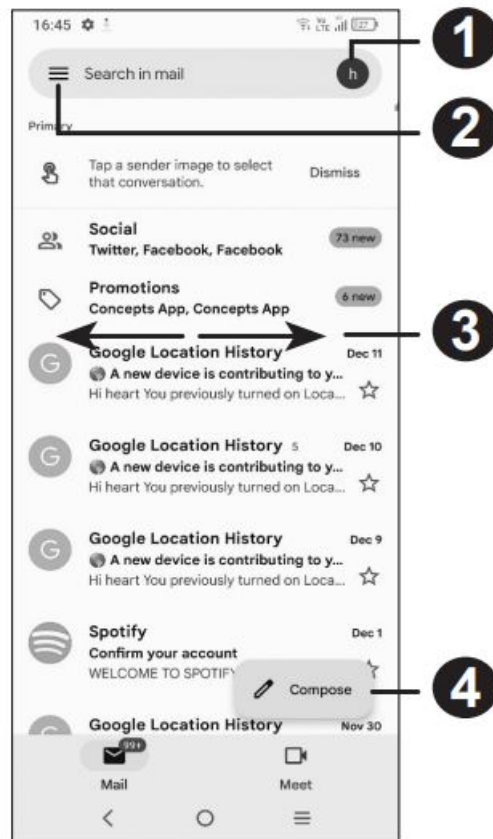

1. Account information
2. See options and settings
3. Swipe right or left to archive the email
4. Create an email

Help

- Check out the TCL website at tclusa.com for tutorials and answers to frequently asked questions, and to download the User Manual.
- To get support for your phone, visit the TCL website: <https://www.tcl.com/mx/es.html>
- **Update your phone's software**
Go to Settings > System > System Update to check software updates.
- **Back up your personal data**
Go to Settings > System > Backup and turn it on.
- **Reset your phone**
Go to Settings > System > Reset > Erase all data (factory reset) > Erase all data.

General Information

- Visit the TCL website at <https://www.tcl.com/mx> for tutorials and answers to frequently asked questions, and to download the User Manual.
- To get support for your phone, visit the TCL website (<https://www.tcl.com/mx/es/service-support-mobile.html>), or dial the number listed below:

Documents / Resources

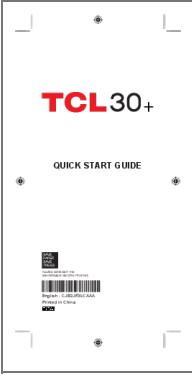
 The image shows the front cover of a 'TCL 30+ QUICK START GUIDE'. At the top, the 'TCL 30+' logo is printed in red. Below it, the words 'QUICK START GUIDE' are in a smaller, black, sans-serif font. At the bottom of the cover, there is a small black square with a white 'S' logo, a barcode, and some small, illegible text.	<p>TCL TCL30 Plus Smartphone [pdf] User Guide H157, 2ACCJH157, TCL30 Plus, Smartphone, TCL30 Plus Smartphone, Plus Smartphone</p>
--	---

References

- [TCL USA | Enjoy More](#)
- [TCL Electronics México](#)
- [TCL Electronics México](#)
- [TCL Mobile Service](#)