



TCL T671E Smartphone User Guide

[Home](#) » [TCL](#) » TCL T671E Smartphone User Guide 



20SE
QUICK START GUIDE

Your Mobile

Contents

- [1 Keys and connectors](#)
- [2 Getting started](#)
- [3 Home screen](#)
- [4 Contacts](#)
- [5 Messaging](#)
- [6 Gmail](#)
- [7 General Information](#)
- [8 Documents / Resources](#)
 - [8.1 References](#)
- [9 Related Posts](#)

Keys and connectors

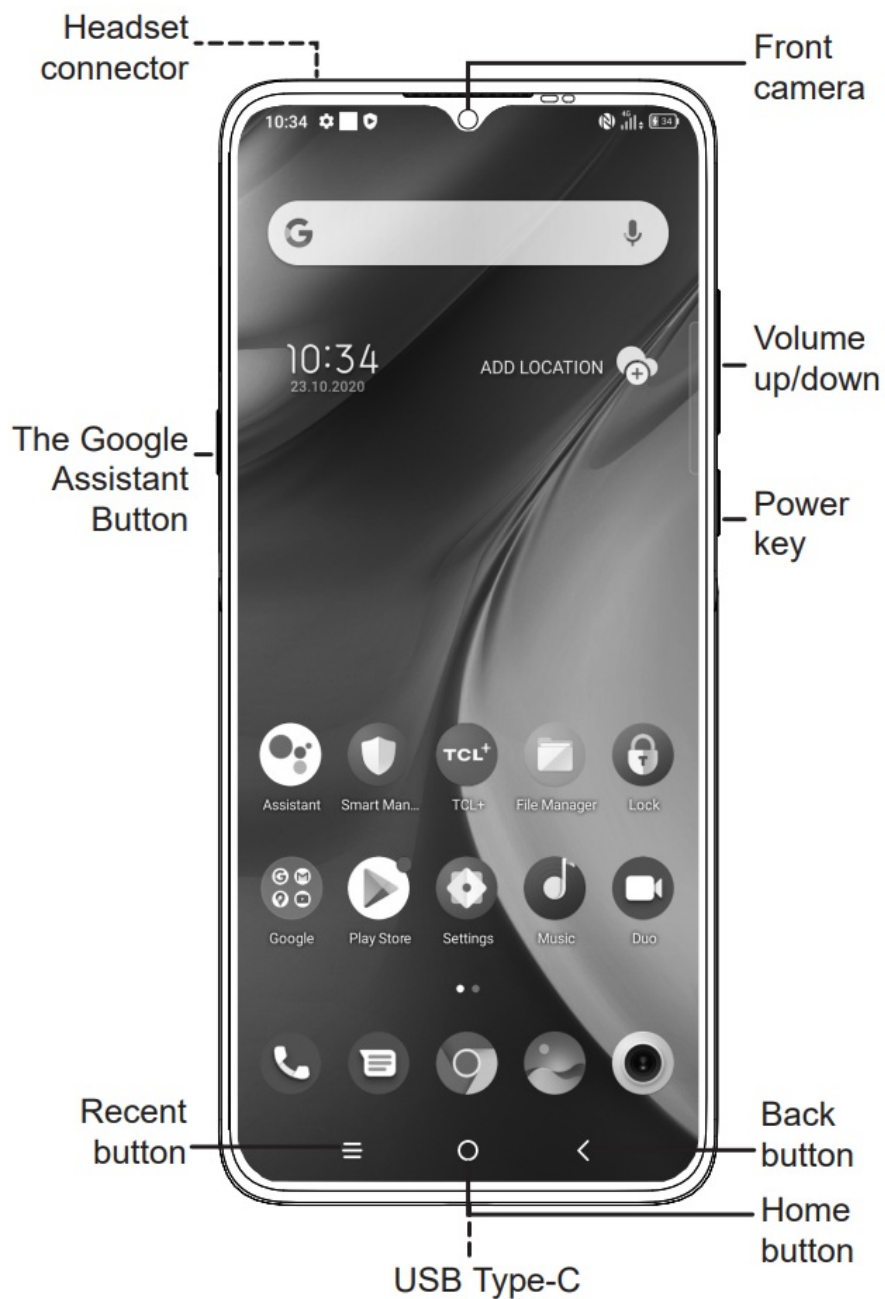

Right-hand mode:



Left-hand mode:



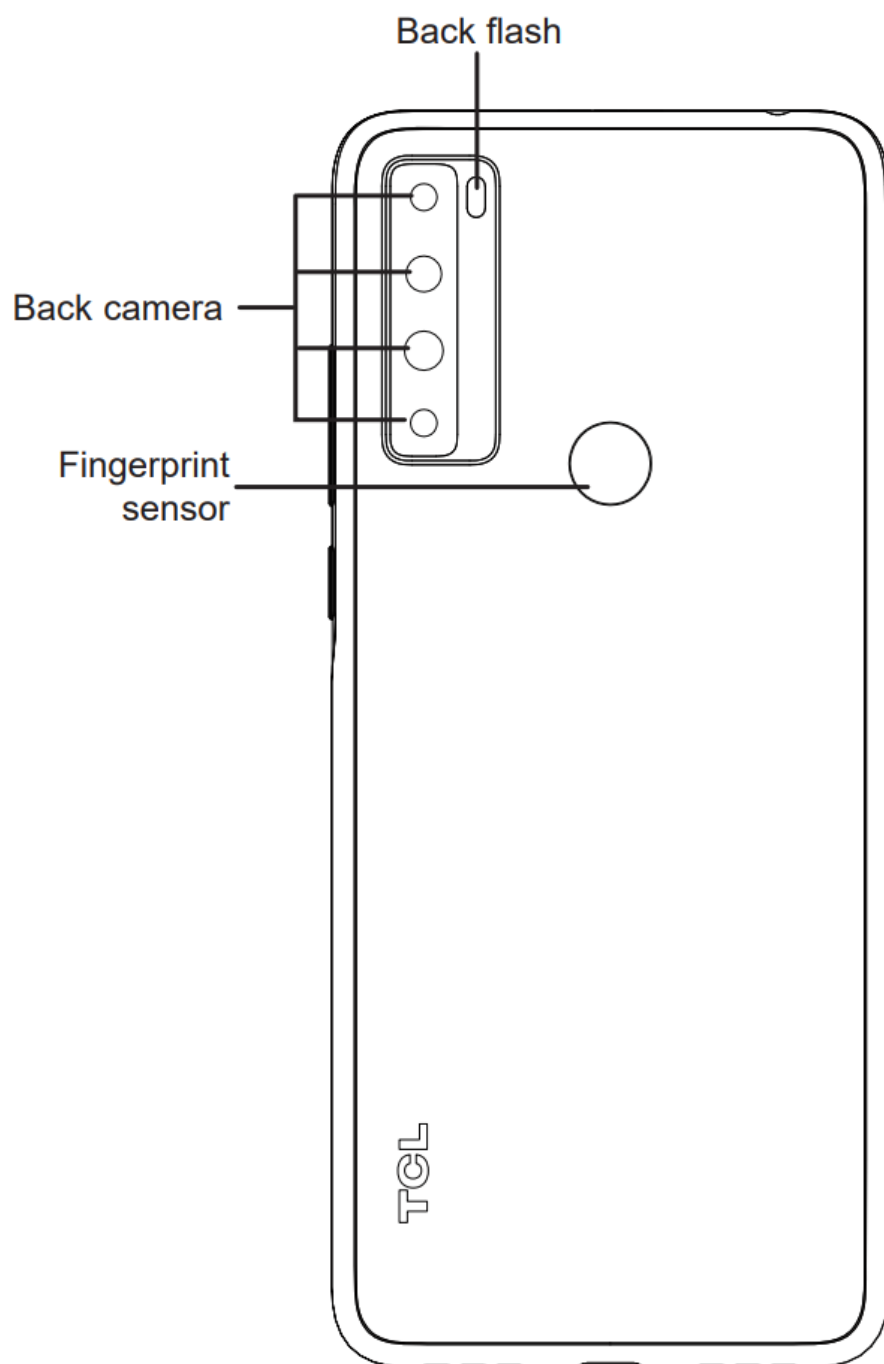

Getting started

1. Charge the battery

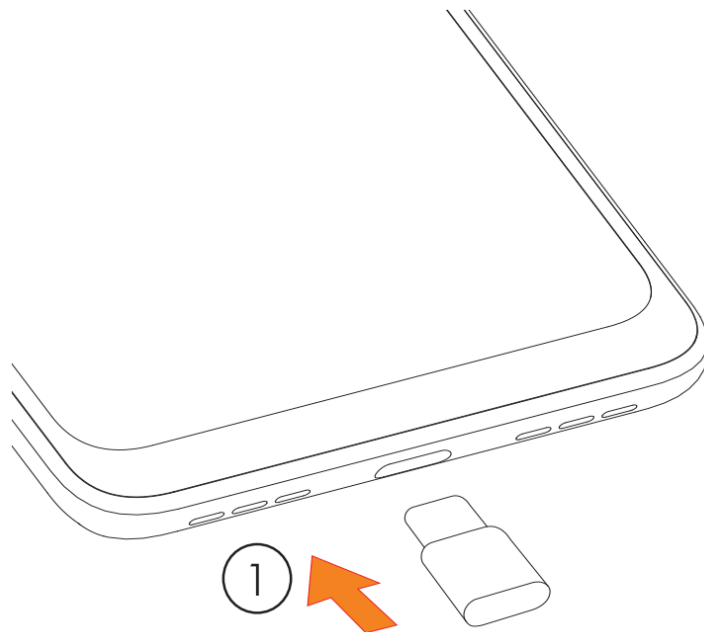

2. Insert or remove the microSD card.
3. Insert or remove the SIM card.

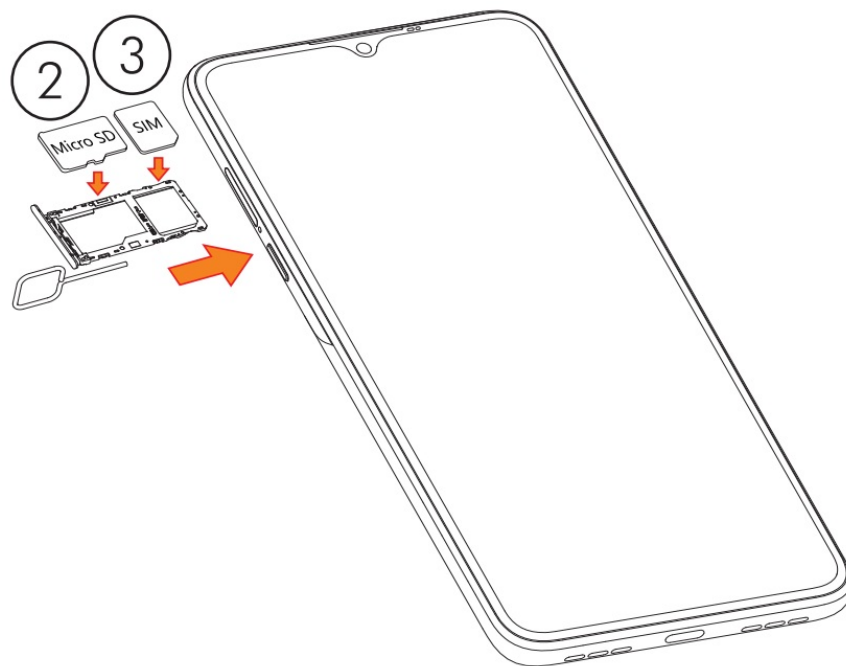

Home screen

You can bring all of the items (applications, shortcuts, folders) that you use most frequently to your Home screen for quick access.

Touching the Home button always takes you back to the main Home screen.

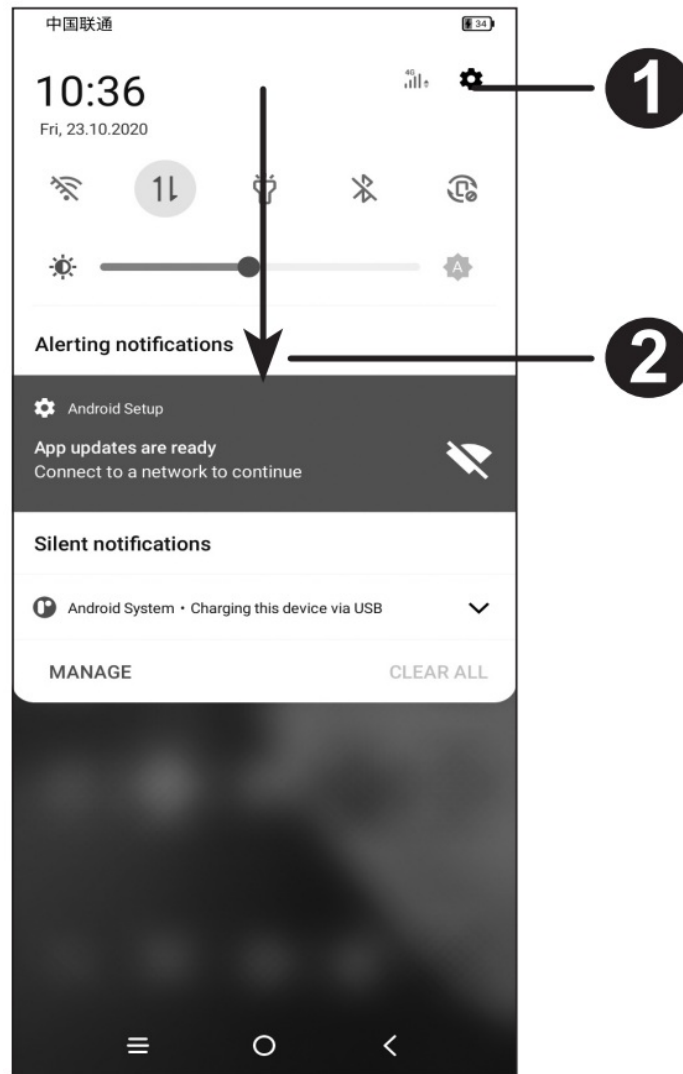

1. Open **Settings**, to view the full list of settings.
2. Touch and drag down to open the Notification panel.



Phone call

Making a call

Enter the desired number from the keyboard and touch  to make a call.

Answering a call

When you receive a call:

- Tap ANSWER, or swipe up  to answer;
- Tap DECLINE, or swipe down  to reject;
- Tap  Reply to reject the call by sending a preset message.

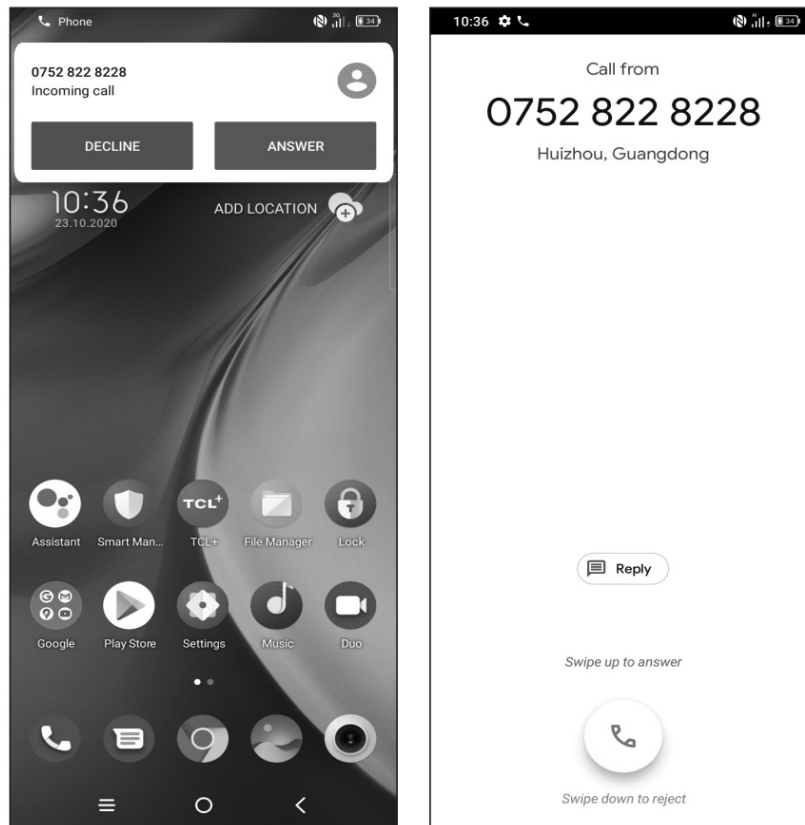

Contacts

You can view and create contacts on your phone and synchronize these with your Gmail contacts or other applications on the web or on your phone.

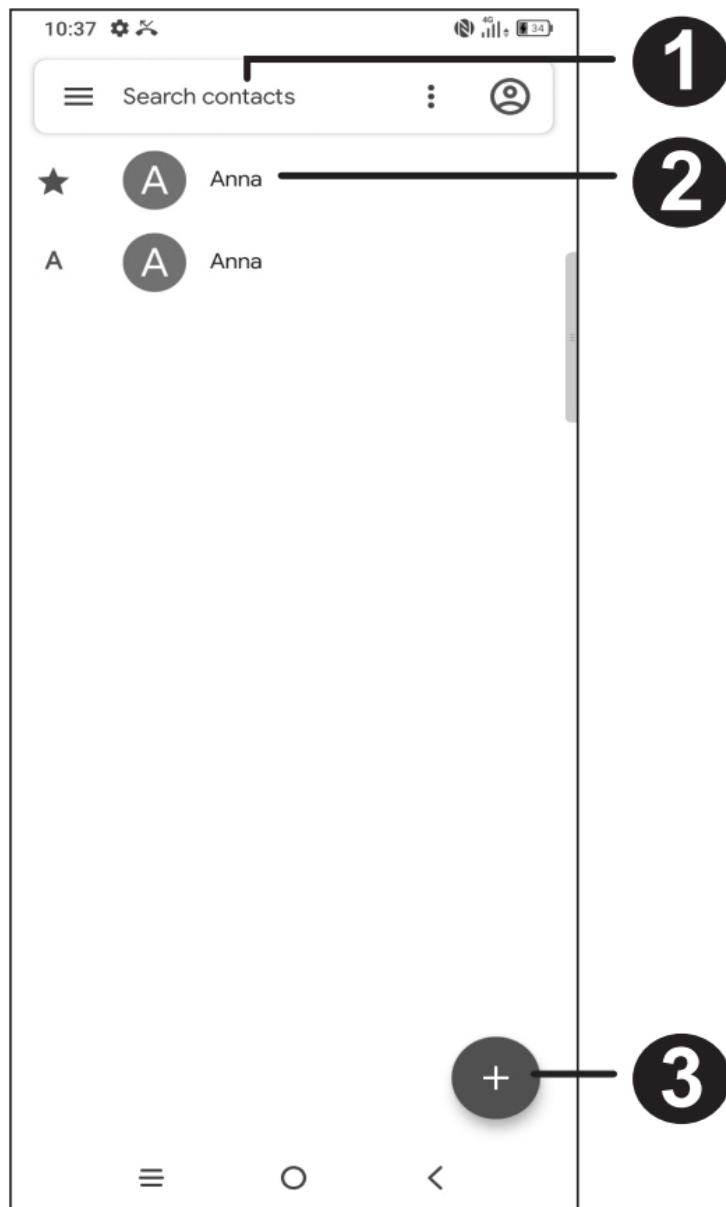

1. Search in **Contacts**
2. Open the Quick contact panel
Touch and hold to share or delete the selected contact
3. Add new contact

Messaging

You can create, edit, and receive SMS and MMS.

An SMS will be converted to MMS automatically when media files (image, video, audio, slides, etc.) are attached or subject or email addresses are added.

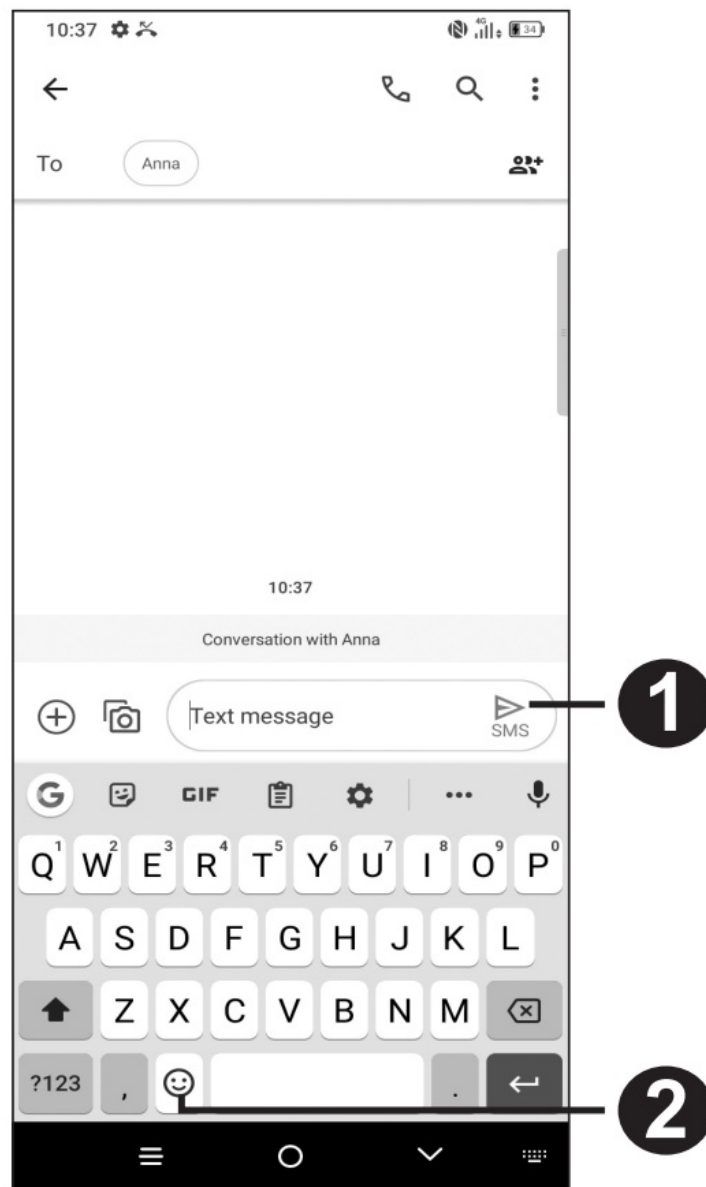

1. Send the text message
2. Insert emoticons

Gmail

The first time you set up your phone, you can select to use an existing Gmail account or to create a new one.

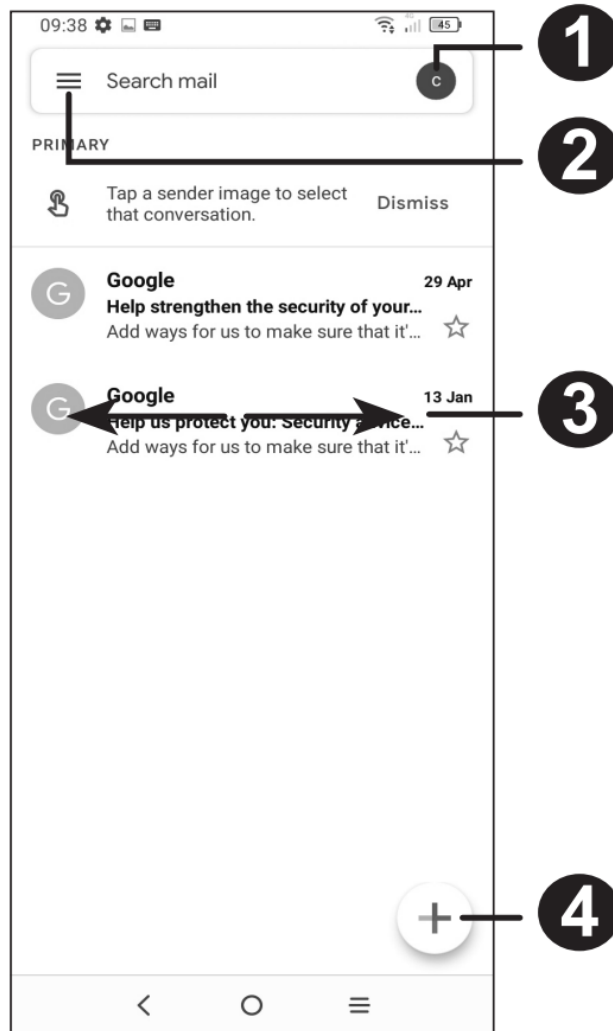

1. Account information
2. See options and settings
3. Swipe right or left to archive the email
4. Create an email

Help

- Check out the TCL website at tclusa.com for tutorials and answers to frequently asked questions, and to download the User Manual.
- To get support for your phone, visit the TCL website: <https://www.tcl.com/mx/es.html>
- Update your phone's software
Go to **Settings > System > System Update** to check software updates.
- Back up your personal data
Go to **Settings > System > Backup > Back up to Google Drive and turn it on.**
- Reset your phone
Go to **Settings > System > Reset > Factory data reset > RESET PHONE.**

General Information

- Visit the TCL website at <https://www.tcl.com/mx> for tutorials and answers to frequently asked questions, and to download the User Manual.

- To get support for your phone, visit the TCL website (<https://www.tcl.com/mx/es/service-support-mobile.html>), or dial the number listed below:

Argentina: 08001220682
Chile: 800000147
Colombia: 18009520823
Ecuador: 800000635
Mexico: 8008909908
Peru: 080000698
The Dominican Republic: 8887600164
Uruguay: 405296624
Venezuela: 08001005368

**SAVE
PAPER
SAVE
TREES**

PLEASE CONSIDER THE
ENVIRONMENT BEFORE PRINTING



CJB2GC2LCAAAA





Printed in China

T671E

Documents / Resources

 The image shows the front cover of a 'TCL 20SE QUICK START GUIDE'. It features the TCL logo, the model number 20SE, and a small barcode at the bottom.	TCL T671E Smartphone [pdf] User Guide T671E, Smartphone
--	--

References

-  [TCL USA | Enjoy More](#)
-  [TCL Electronics México](#)
-  [TCL Electronics México](#)
-  [Mobile Service](#)