



TCL T430M Smartphone User Guide

[Home](#) » [TCL](#) » TCL T430M Smartphone User Guide 

Contents

- [1 TCL T430M Smartphone](#)
- [2 Product Information](#)
- [3 Product Usage Instructions](#)
- [4 Welcome to TCL](#)
- [5 Your TCL phone](#)
- [6 Set up your TCL phone](#)
- [7 Home screen](#)
- [8 Messages](#)
- [9 Gmail](#)
- [10 Documents / Resources](#)
 - [10.1 References](#)
- [11 Related Posts](#)

TCL

TCL T430M Smartphone



Product Information

The TCL phone is a user-friendly device that allows you to stay connected and enjoy various features. It comes with a front camera, rear camera with flash, volume up/down keys, power/lock key, USB-C connector, and a headset connector. The phone supports Nano SIM cards and microSDTM cards for additional storage. It also has a partially charged battery that can be charged using the provided USB-C cable and charger.

Product Usage Instructions

1. Setting up your TCL phone:

1. Place the phone face down and gently remove the back cover by pulling up on the indentation at the bottom left of the cover.
2. Insert the battery into the device by aligning the gold contacts in the battery cavity.
3. Insert a Nano SIM card into the labeled SIM slot.
4. If needed, insert a microSDTM card into the labeled SD slot. Note that microSDTM cards are sold separately.

2. **Charging the battery:** Connect the provided USB-C cable to the phone's USB-C connector and connect the other end to a power source using the charger. The battery will begin charging.

3. **Using the Home screen:** Customize your Home screen by adding frequently used items like applications, folders, and widgets for quick access. Tapping the Home button will always take you back to the main Home screen.

4. Accessing notifications and settings:

1. Swipe down from the Status bar to view the Notification panel and access pending notifications. Tap on a notification to open the corresponding app.
2. Swipe down again to view Quick Access settings options. Tap to access the complete Settings menu.

5. **Sending messages:** Use the Messages app to create, edit, send, and receive text (SMS) and media (MMS) messages. Additional features include recording audio, switching language keyboards, attaching pictures or media files, and accessing keyboard settings and emojis.

6. **Using Gmail:** Utilize the Gmail app to create, send, and receive emails directly on your phone. You can add multiple email accounts and access various features such as email folders and settings.

Welcome to TCL

Check out the TCL website at www.tcl.com for tutorials and answers to frequently asked questions, and to download the User Manual.

CUSTOMER SUPPORT

United States & Canada

Phone: 1-855-224-4228

Web: <https://support.tcl.com>

Service Hours

- Mon-Friday 10am-11pm (EST)
- Saturday: 11am-10pm (EST)
- Closed on Sundays and US Federal Holidays

Update your phone's software

Go to Settings > System > System Update to check software updates.

Back up your personal data

Go to Settings > System > Backup > Back up to Google Drive and turn it on.

Reset your phone

Go to Settings > System > Reset > Erase all data (factory reset) > Erase all data.

Your TCL phone

Keys and connectors

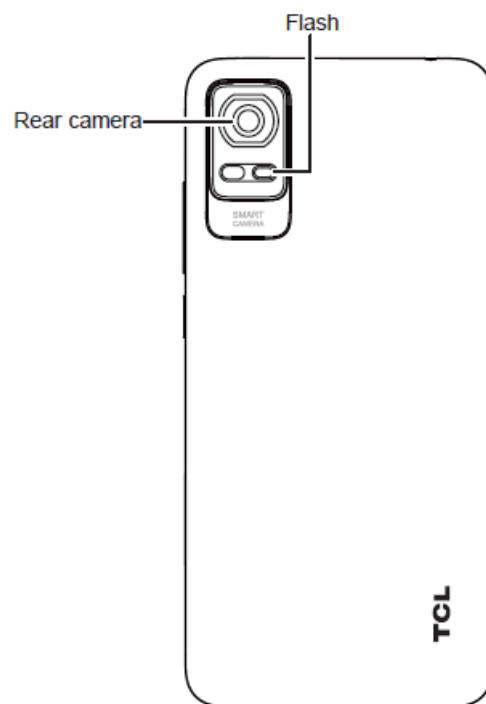
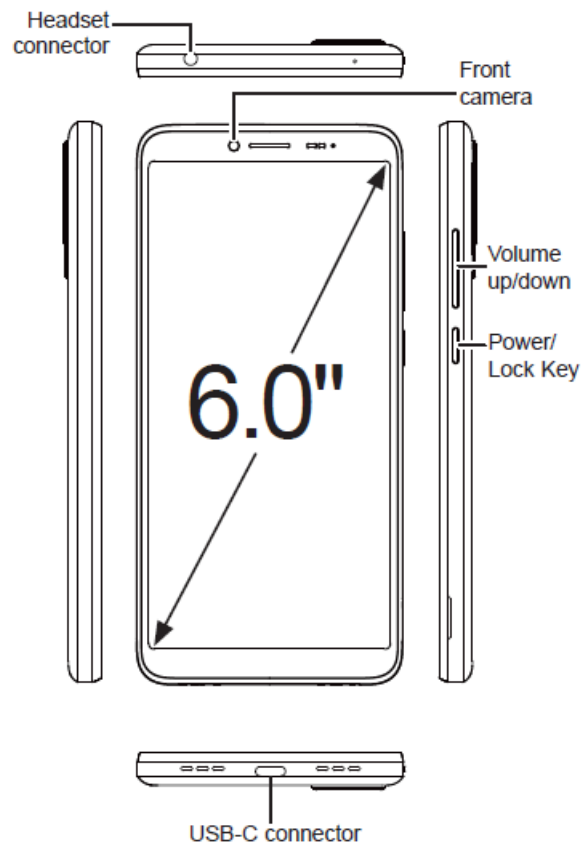

Set up your TCL phone

1. With the phone face down, remove the back cover by gently pulling up on the indentation on the bottom left of the cover.

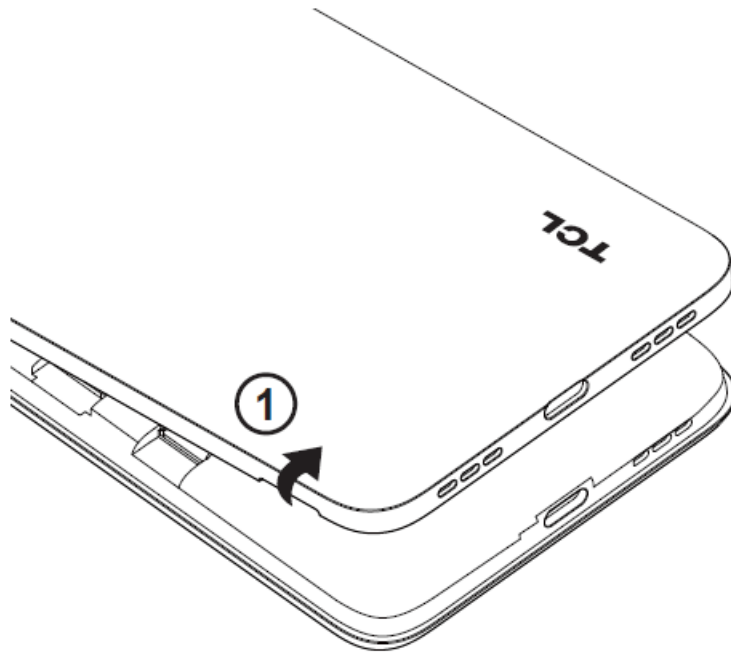

2. Insert the battery by connecting the gold contacts in the device battery cavity. The battery will only fit one way.

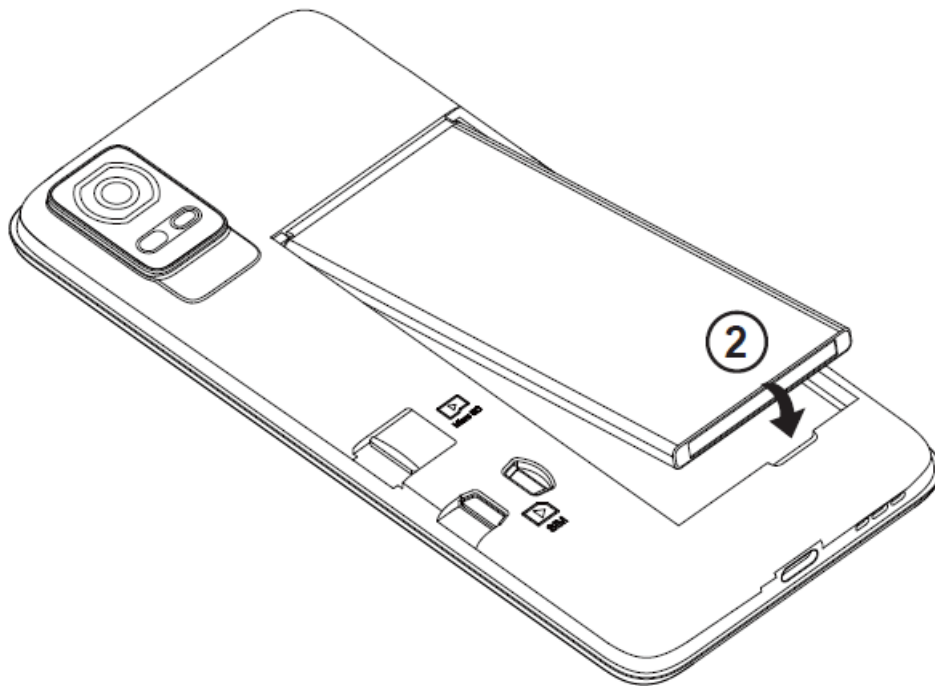

3. Place the Nano SIM card into the slot labeled "SIM".
4. If applicable, insert the microSD™ card into the slot labeled "SD".

Note: microSD™ cards are sold separately. Only use Nano SIM cards with your phone.

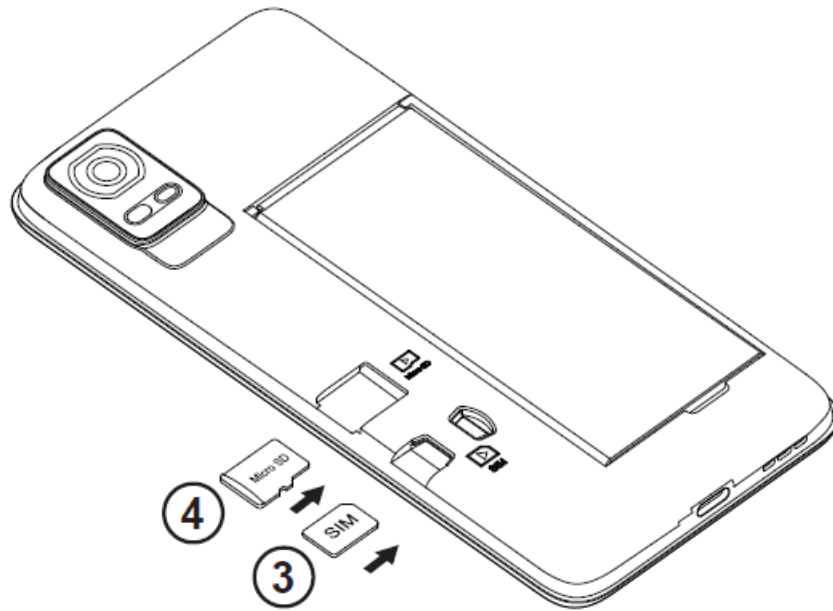

5. Your new phone is partially charged. Charge the battery by using the USB-C cable and charger provided.

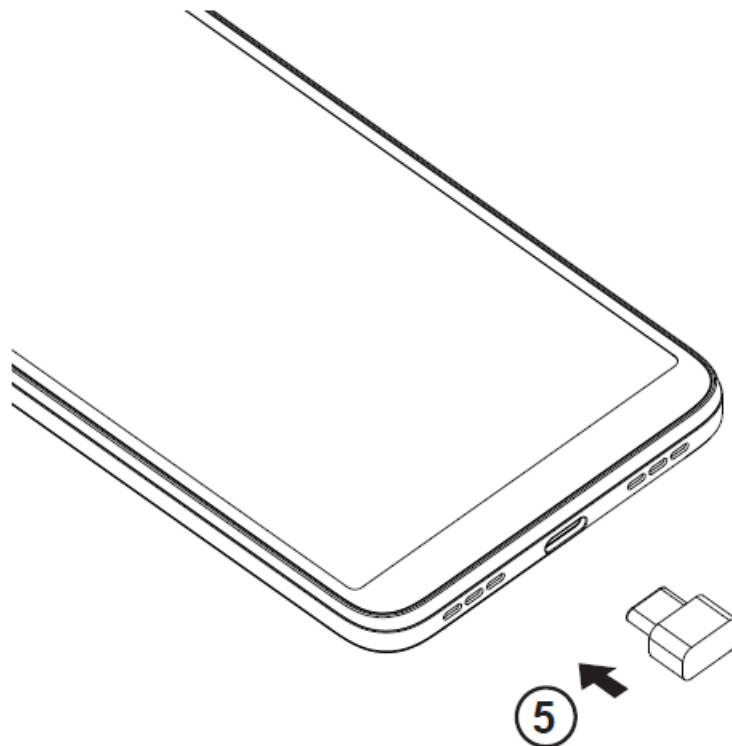

Home screen

You can bring all of the items that you use most frequently (applications, folders, widgets) to your Home screen for quick access.

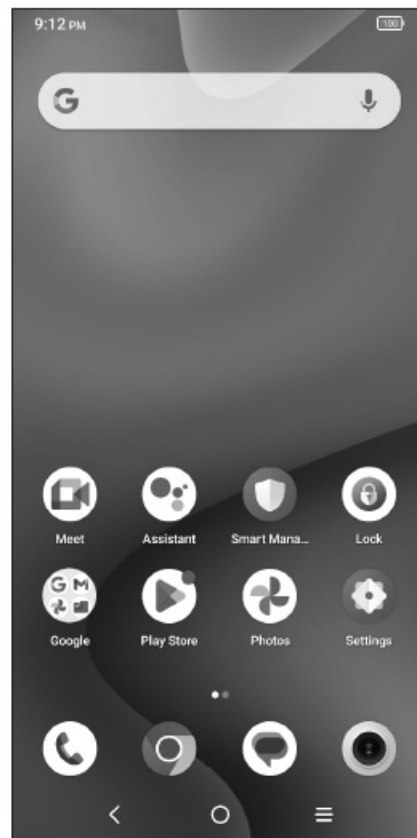

Tapping Home always takes you back to the main Home screen.

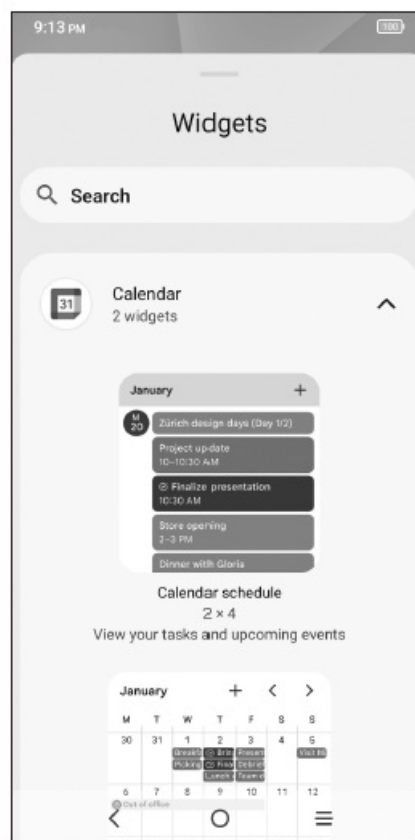

Expand your Home screen with widgets and more personalization.

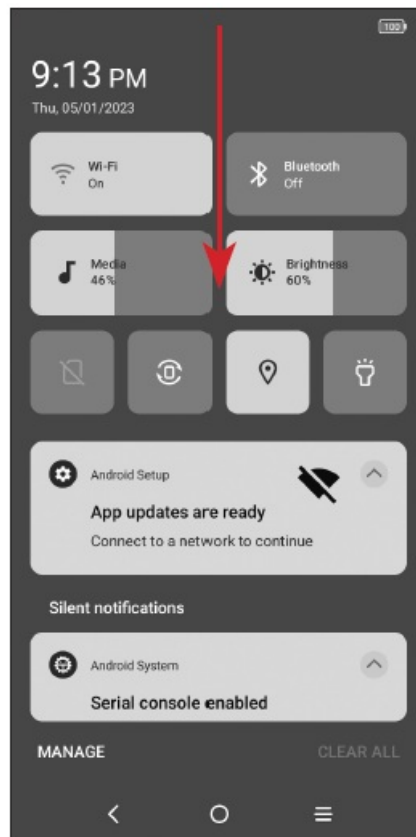

Swipe down from the Status bar to view the Notification panel and access all pending notifications. Tap on the Notification to open the App.

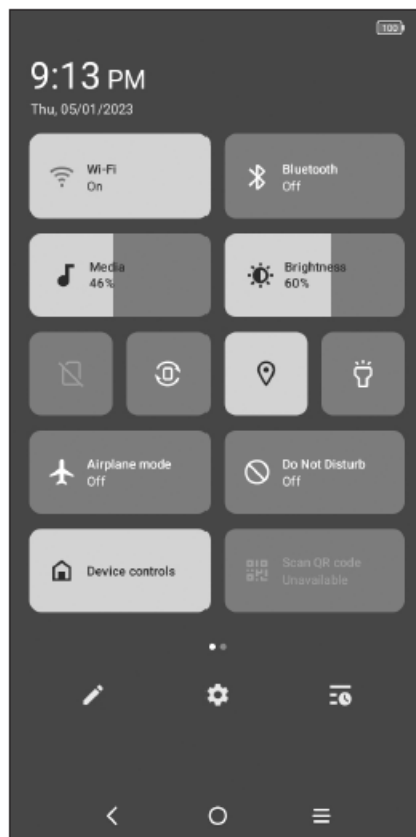

Swipe down again to view Quick Access settings options. Tap  to access the complete Settings menu.

Messages

Create, edit, send, and receive text (SMS) and media (MMS) messages.

A SMS will be converted to MMS automatically when media files (such as image, video, or audio) are attached, when a subject is added to the message, or an email address is used for a recipient.

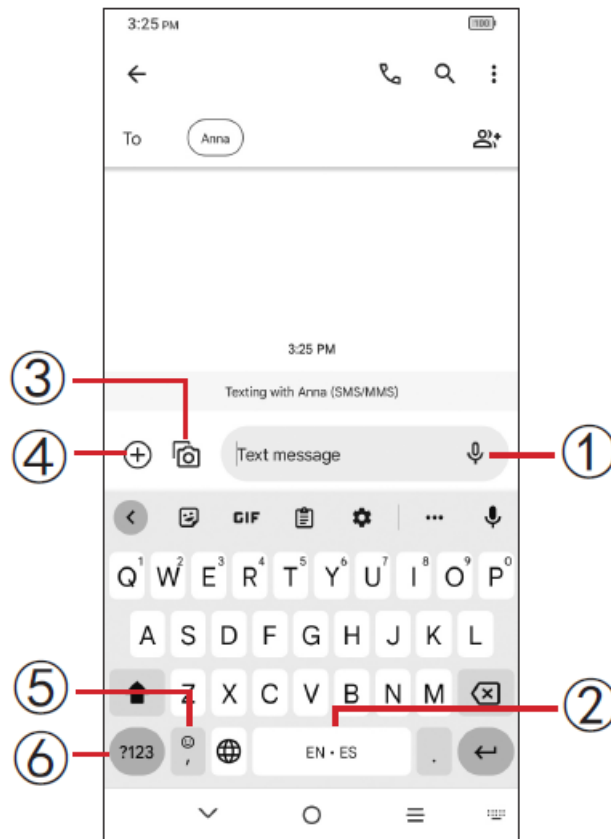

1. Touch and hold to record audio.
2. Touch and hold to switch language (if additional language keyboards are activated).
3. Attach a picture from the gallery or shoot one directly.
4. Insert a GIF, location, contact or other media file.
5. Tap to input a comma. Touch and hold to access keyboard settings, input an emoji, or enter left or right hand input mode.
6. Tap to access the symbols and numbers keyboards.

Gmail

Use Gmail to create, send, and receive emails directly on your phone. The Gmail app will allow you to add several email accounts.

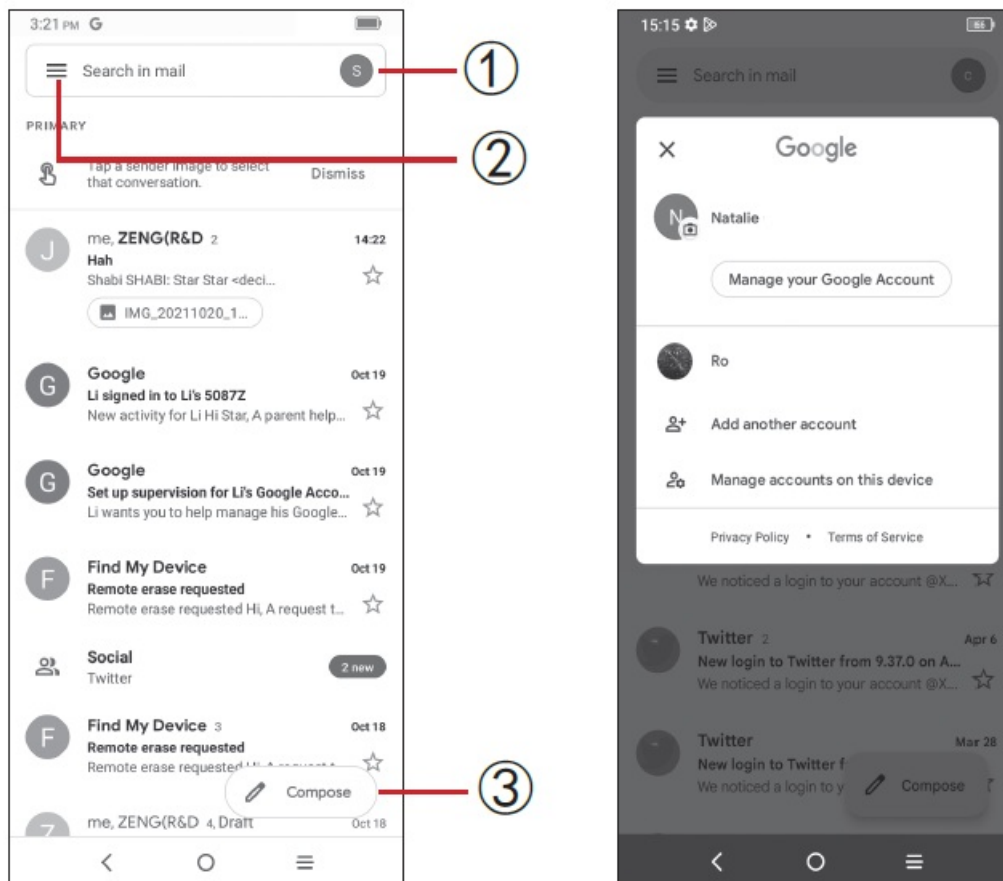

1. Tap to view the email accounts on your device.
2. Tap to access email folders, settings, and more.
3. Tap to create an email

Documents / Resources

	TCL T430M Smartphone [pdf] User Guide T430M Smartphone, T430M, Smartphone
---	--

References

- [TCL USA | TVs, Sound Bars, Phones, Appliances](#)
- [TCL Support](#)