

TCL S55H Channel Sound Bar



TCL S55H Channel Sound Bar User Guide

[Home](#) » [TCL](#) » TCL S55H Channel Sound Bar User Guide 

Contents

- 1 [TCL S55H Channel Sound Bar](#)
- 2 [Product Specifications](#)
- 3 [Product Usage Instructions](#)
- 4 [Frequently Asked Questions \(FAQ\)](#)
- 5 [BOX CONTENT](#)
- 6 [PRODUCT OVERVIEW](#)
- 7 [INSTALLATION INSTRUCTION](#)
- 8 [REMOTE CONTROLL](#)
- 9 [REMOTE FUNCTIONS](#)
- 10 [CABLE CONNECTION](#)
- 11 [TCL Home App](#)
- 12 [AI Sonic-Adaptation](#)
- 13 [UPDATE](#)
- 14 [Trademarks](#)
- 15 [SPECIFICATION](#)
- 16 [Documents / Resources](#)
 - 16.1 [References](#)

TCL

TCL S55H Channel Sound Bar



Product Specifications

- **Product Name:** S55H 2.1 Channel Dolby Atmos Soundbar with Wireless Subwoofer
- **Channels:** 2.1
- **Sound Technology:** Dolby Atmos
- **Subwoofer:** Wireless
- **Battery Type:** 1.5V AAA battery x 2

Product Usage Instructions

Safety Instructions:

Make sure to read all safety information before using this product.

Setup:

1. Place the soundbar and subwoofer in desired locations.
2. Connect the soundbar to a power source using the provided cables.
3. Pair the soundbar with your TV or other devices using Bluetooth or the available input sources.

Basic Functions:

- **Mute/Unmute:** Short press the designated button to mute or unmute the sound.
- **Bluetooth Pairing:** Long press the button to enter Bluetooth pairing mode.
- **LED Brightness:** Short press to change different LED brightness levels.
- **Night Mode:** Press to switch Night Mode ON or OFF.
- **Volume Control:** Use the volume buttons to increase or decrease volume.

Advanced Functions:

- **Voice Enhance Mode:** Short press to enter Voice Enhance Mode and adjust levels.

- **AI Sonic-Adaptation:** Short press to enter the menu and select different modes.
- **Surround Enhance Mode:** Short press to enter Surround Enhance Mode and adjust levels.
- **Input Sound Mode:** Short press to switch between different sound modes like Standard, Movie, Music, etc.

Additional Tips:

- Avoid exposing batteries to excessive heat or direct sunlight.
- Keep batteries away from children.
- For battery disposal or recycling, contact local authorities.

Frequently Asked Questions (FAQ)

- **How do I pair the soundbar with my TV?**

You can pair the soundbar with your TV using Bluetooth or by connecting through available input sources like HDMI eARC, Optical, AUX, or USB.

- **How do I adjust the bass and treble levels?**

Short press the designated buttons to adjust the bass and treble levels. Use the / buttons to increase or decrease the effects.

- **What is AI Sonic-Adaptation?**

AI Sonic-Adaptation offers different sound modes that you can select based on your preference, such as Default, Sonic 1, Sonic 2, Sonic 3.

BOX CONTENT

Make sure you read all the safety information before you use this product.

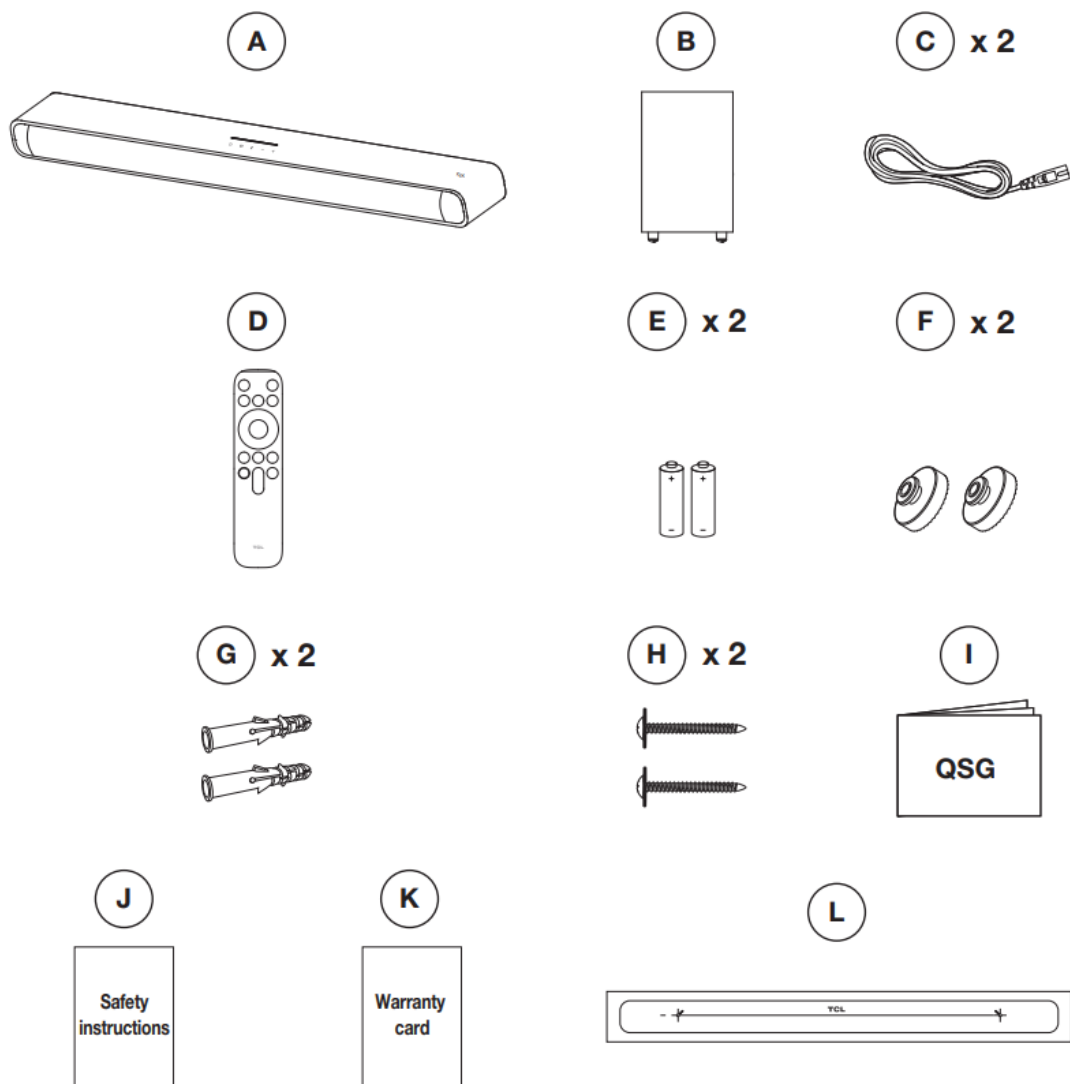

PRODUCT OVERVIEW



A

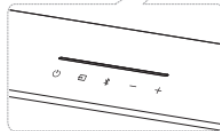
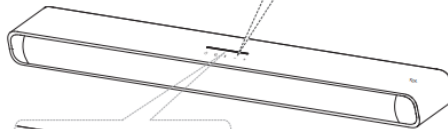
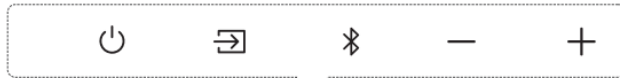
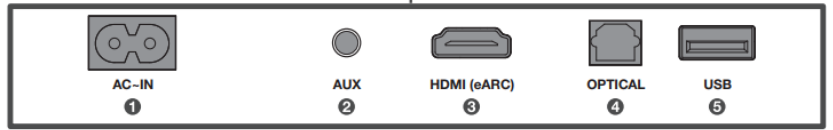
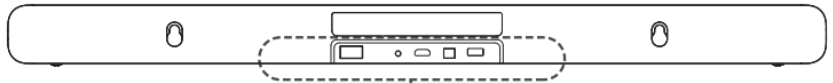

B

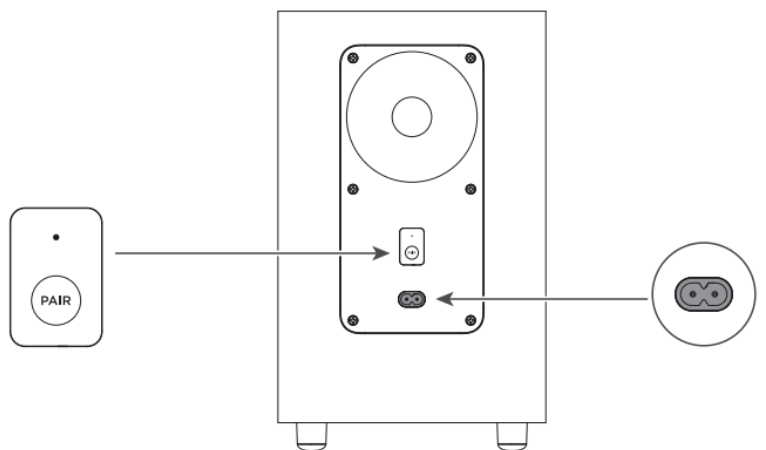

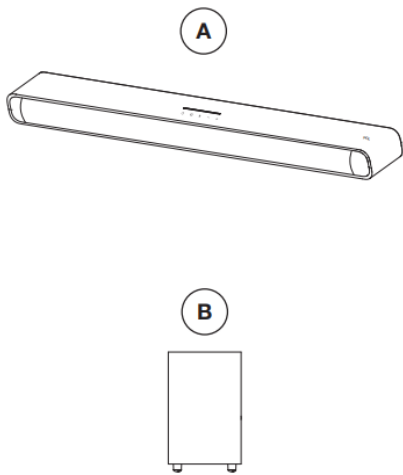

1

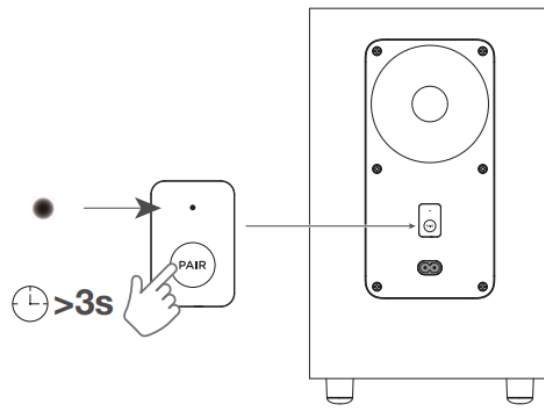

2

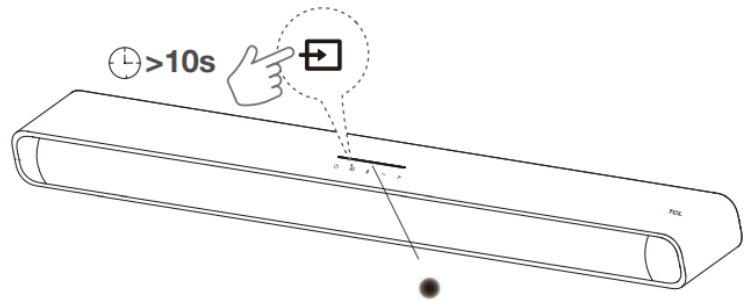

INSTALLATION INSTRUCTION

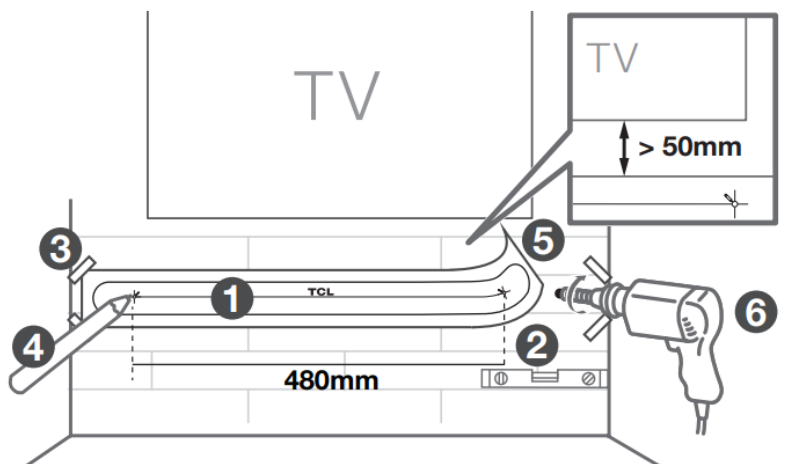
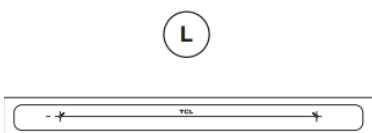
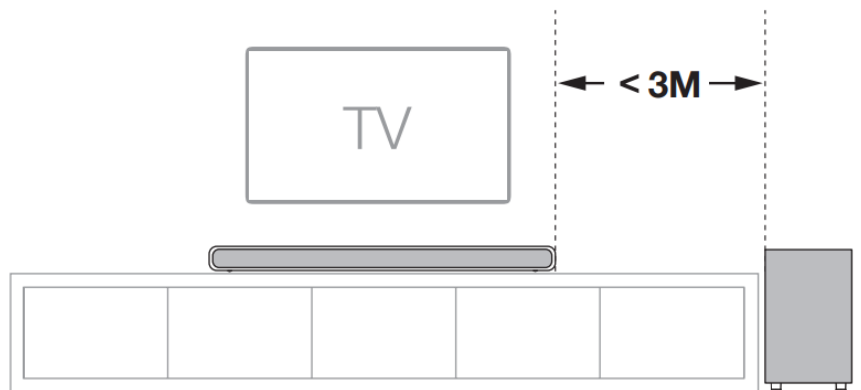
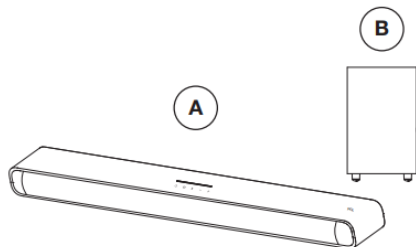



F x 2



G x 2



H x 2

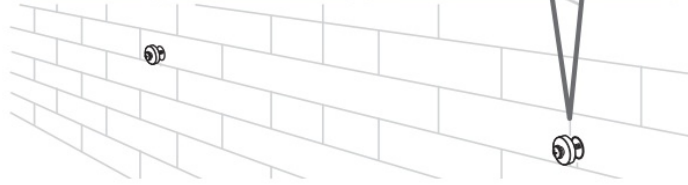
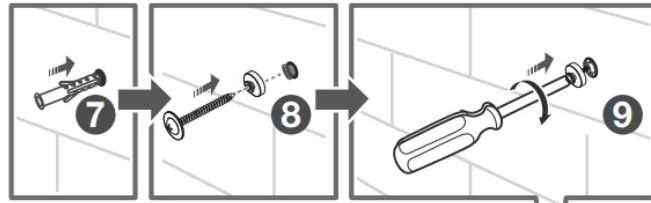

10

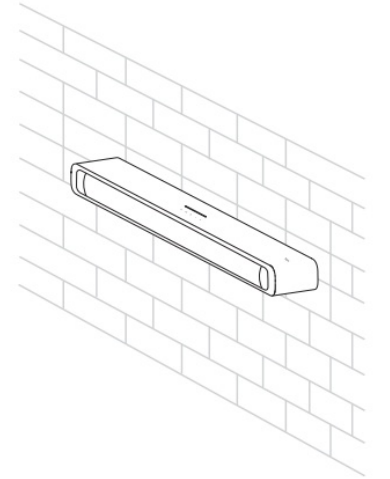
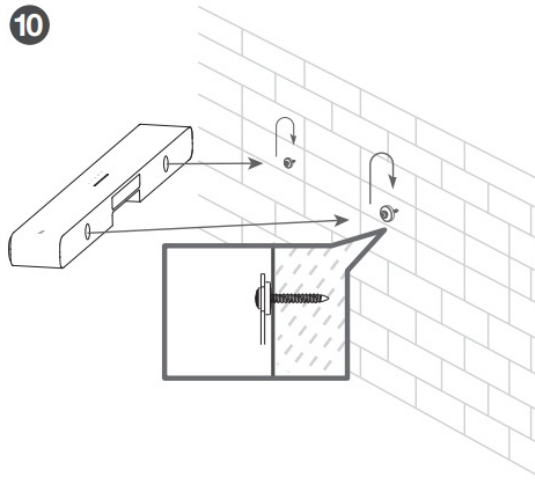

REMOTE CONTROLL

BATTERY INSTALLATION

Make sure you read all the safety information before you use this product.

D

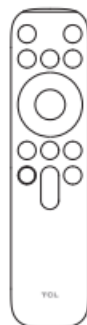

E x 2

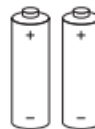

Warning: Do not expose batteries to excessive heat such as sunshine, fire, or the like. Keep new and used batteries away from children. For disposal or recycling information, please contact your local authorities.

CAUTION: Danger of explosion if the battery is incorrectly replaced. Replace only with the same or equivalent type.

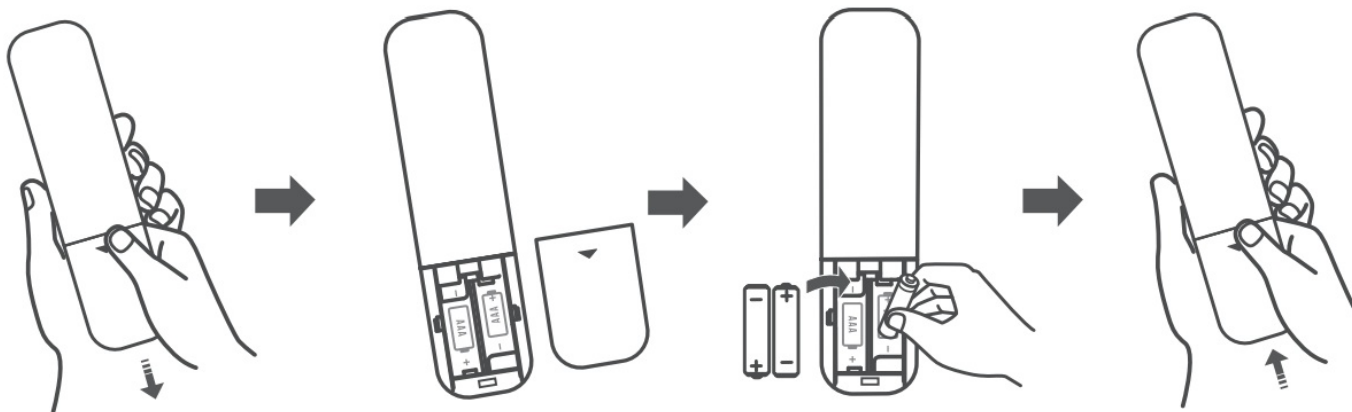

OVERVIEW

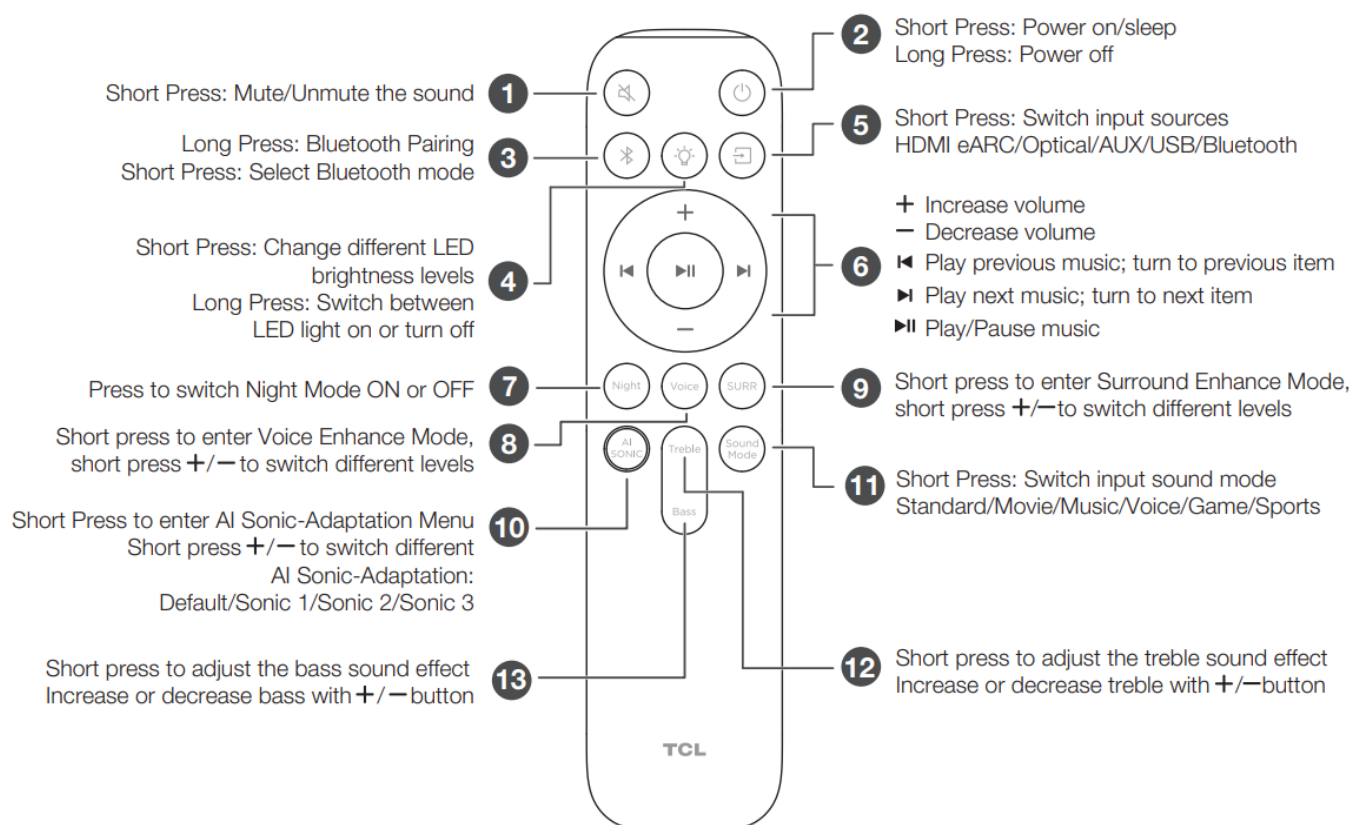

Combination keys:

1. Press both and simultaneously to activate or deactivate DTS TruVolume.

2. Press both and simultaneously to activate or deactivate DTS® Virtual:X™.

REMOTE FUNCTIONS

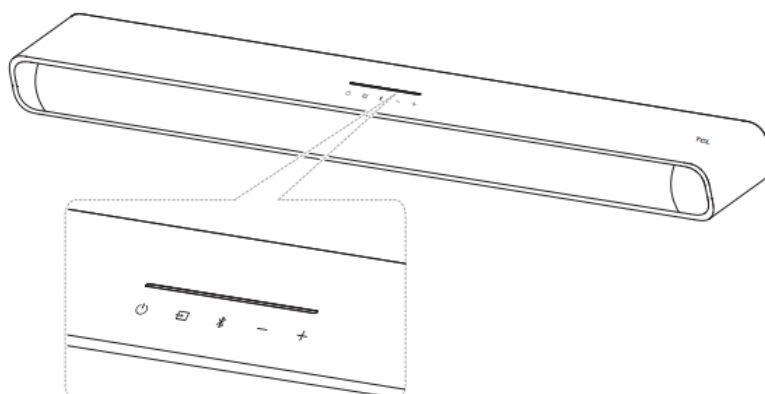

The LED display on the Soundbar gives you information about the LED Behavior on Soundbar.

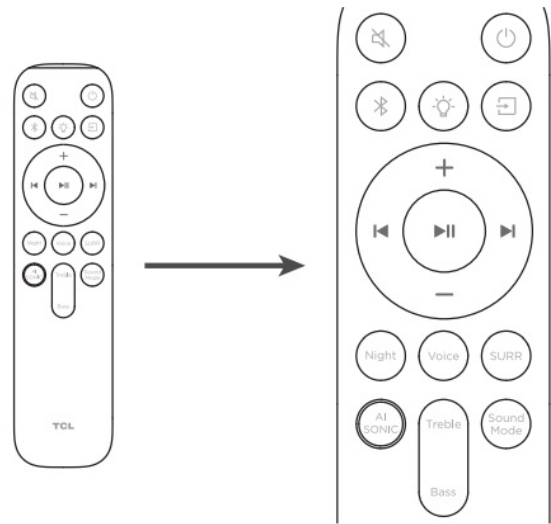

Remote Control	Soundbar Action	LED Behavior on Soundbar
	Power Off/Sleep Power On	Power Off: All LEDs light turn on and turn off from the sides to the center. Power On: LEDs will turn on from the center to the sides.
	Mute Sound	Mute On: Center LED will flash several times. Mute Off: Current Volume Level will be shown.
	Source	Input Source LED Indicator: HDMI eARC: Magenta Optical: Yellow Aux: Green USB: Cyan Bluetooth: Blue
	LED	Short Press: Change different LED brightness levels. Long Press: Switch between LED light on or turn off.
	Bluetooth Pairing	Blue LED will flash rapidly.
	Volume Up/Down Skip/Previous	Volume Up: LEDs will gradually turn on from the center to the sides. Volume Down: LEDs will gradually turn off from the sides to the center. Skip: LEDs move from the left to the right. Previous: LEDs move from the right to the left.
	Surround Enhance	Press to adjust four different surround sound levels.
	Voice Enhance	Short Press: Show the current Voice Enhance level. Use +/– keys to adjust four different levels.
	Night Mode	Night Mode on: LEDs will turn on from the center to the sides. Night Mode off: All LEDs light turn on and turn off from the sides to the center.
	Sound Mode	Press to switch sound mode in following order: Standard/Movie/Music/Voice/Game/Sports
	Treble Adjustment Bass Adjustment	Short Press: Show the current Treble level. Increase/Decrease using +/– keys to adjust thirteen different levels. Short Press: Show the current Bass level. Increase/Decrease using +/– keys to adjust thirteen different levels.
	Sonic Default/1/2/3	Short Press to enter AI Sonic-Adaptation Menu Short press +/– to switch different AI Sonic-Adaptation: Default/Sonic 1/Sonic 2/Sonic 3

CABLE CONNECTION

HDMI



This cable is sold separately.

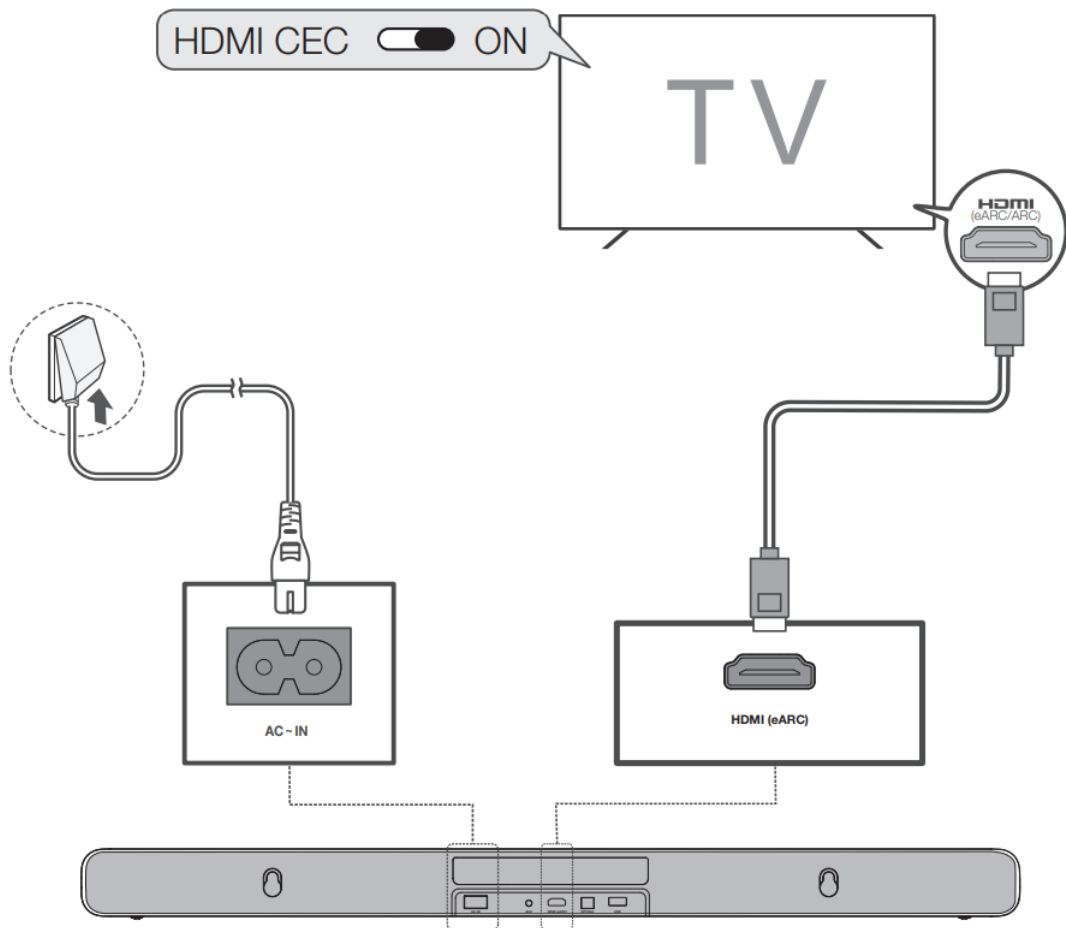

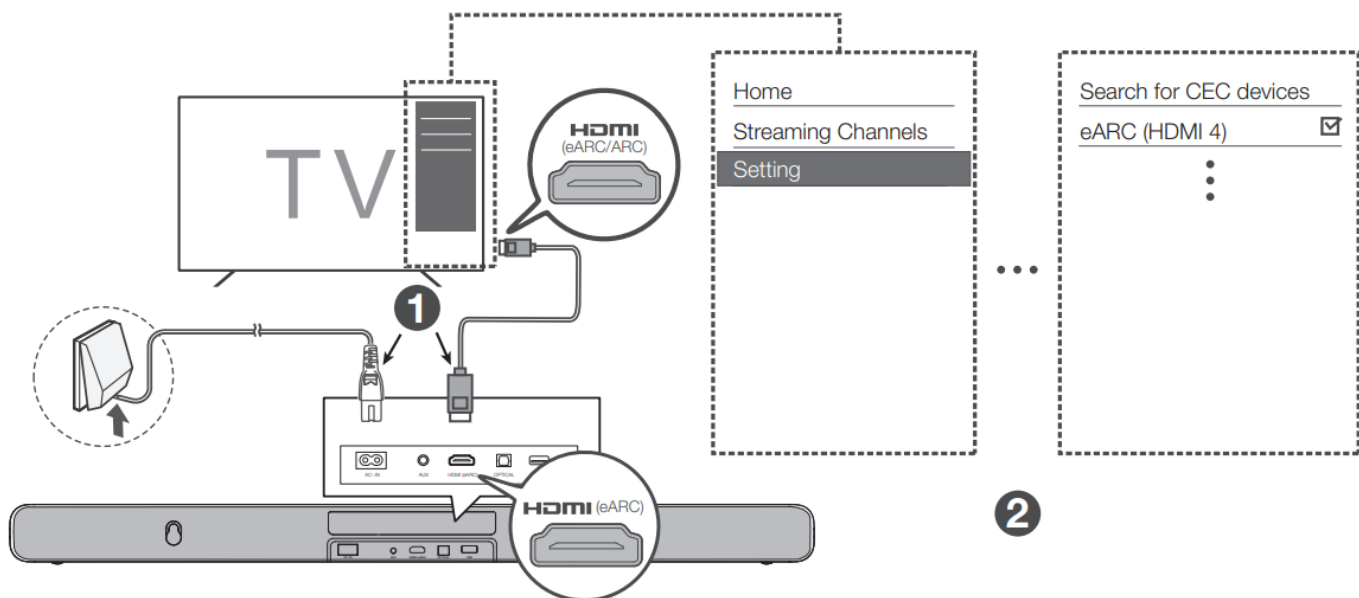
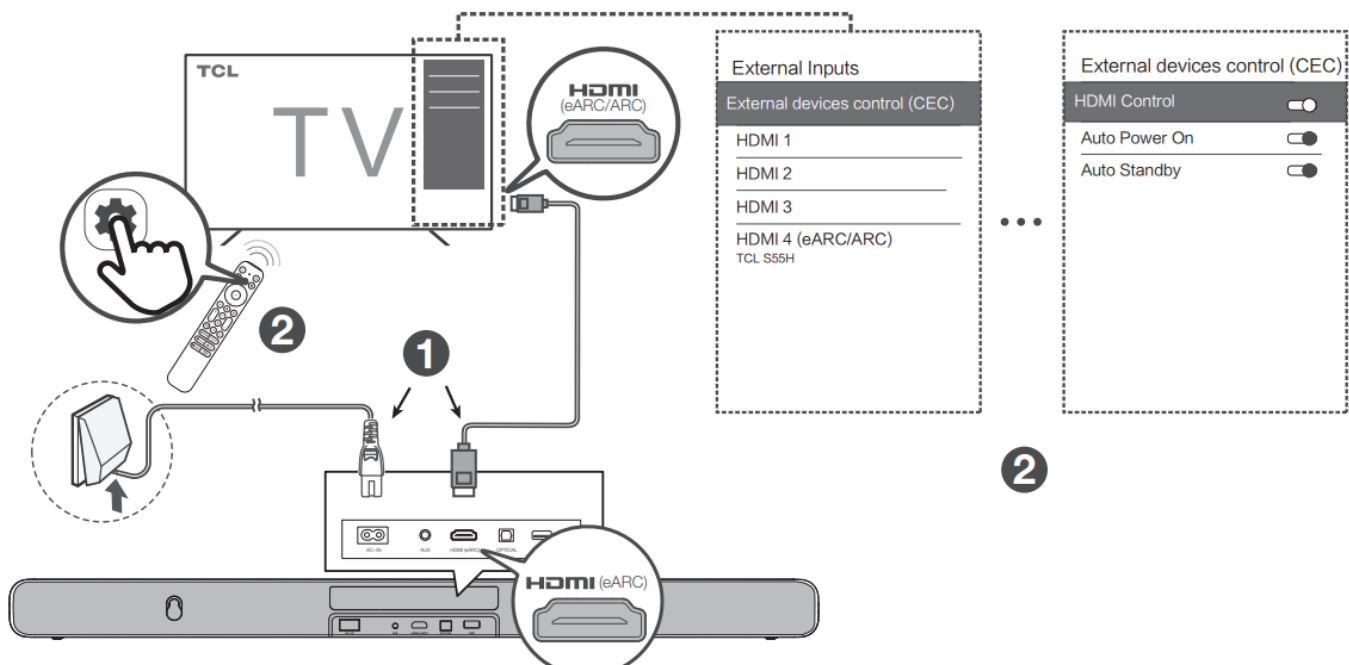

OPTICAL

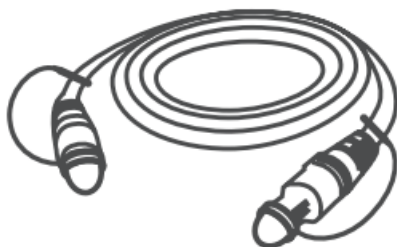

This cable is sold separately.

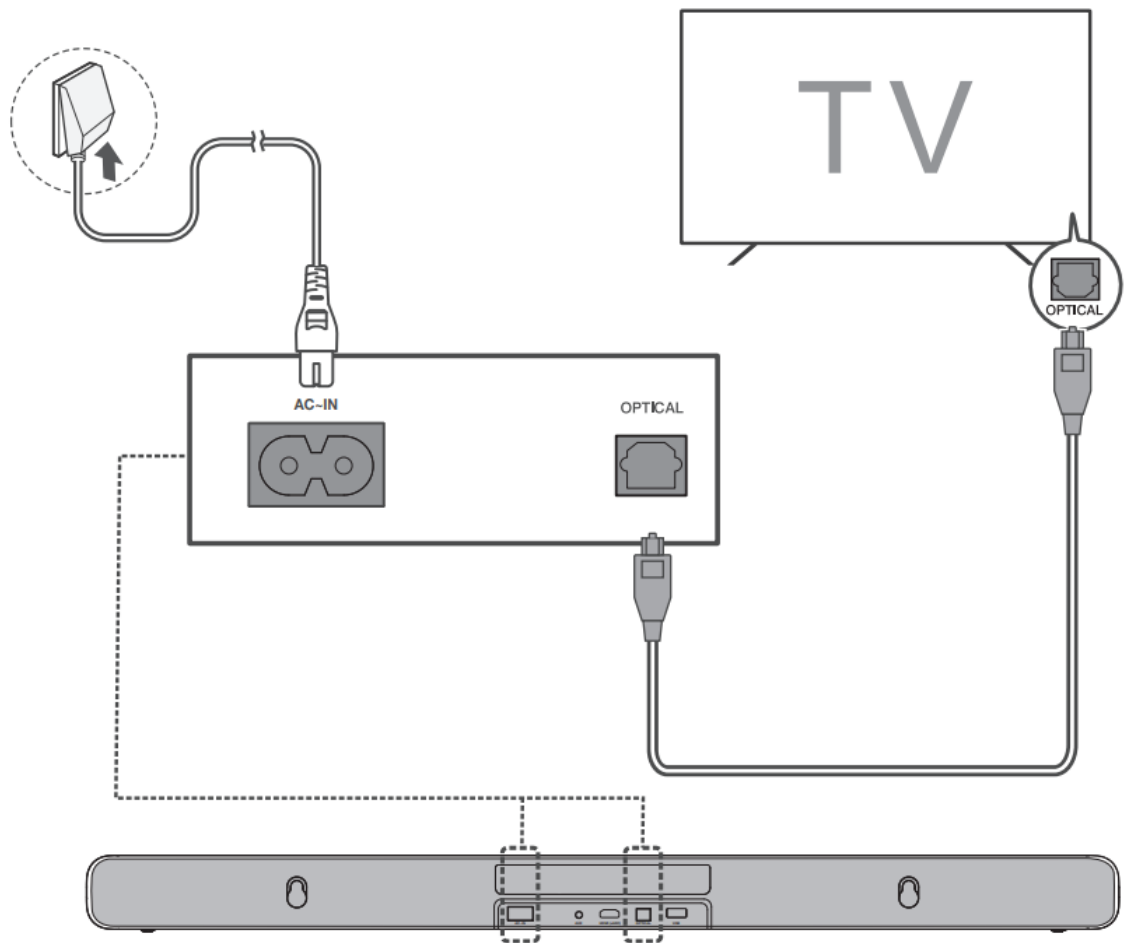

BLUETOOTH

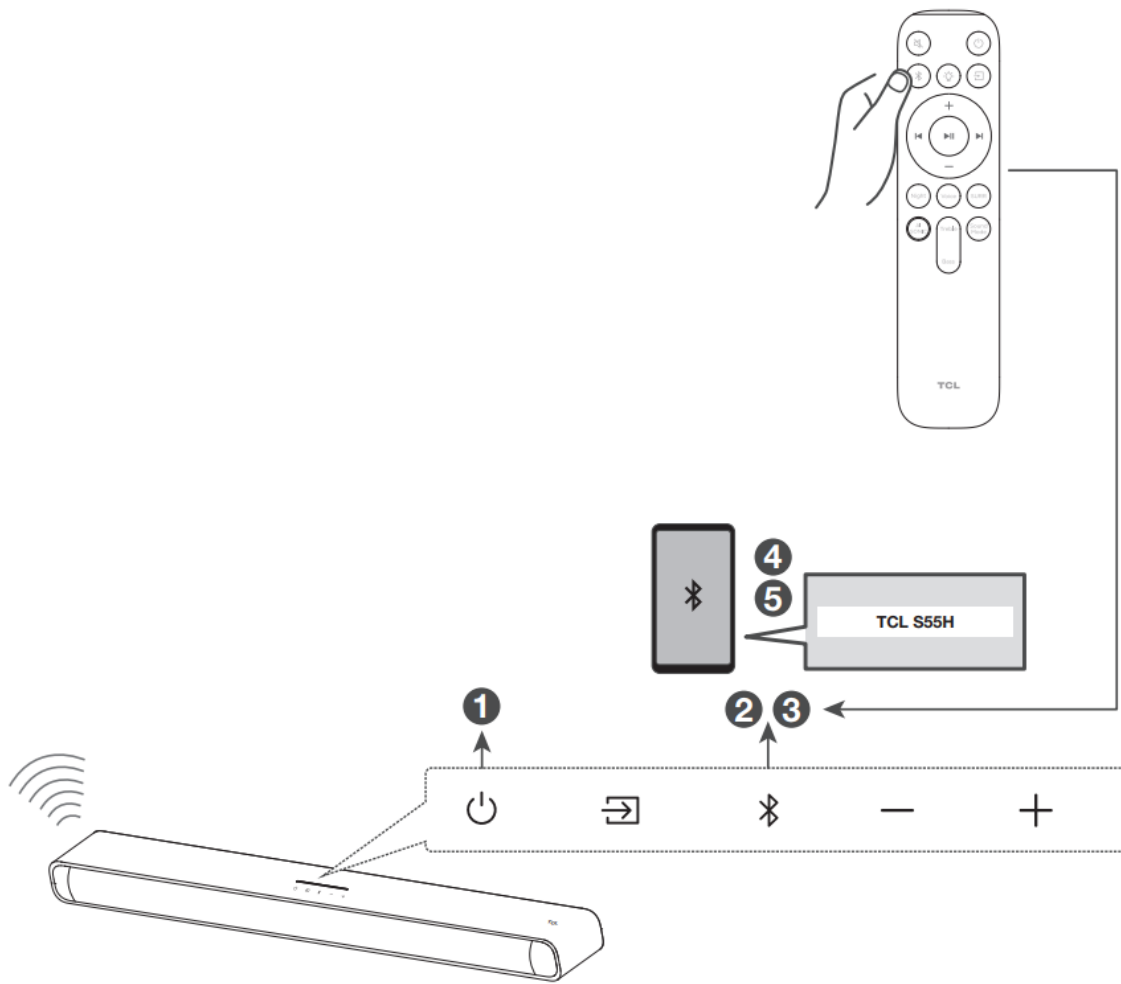

USB-A

Supported audio files: MP3, WMA, WAV, FLAC.

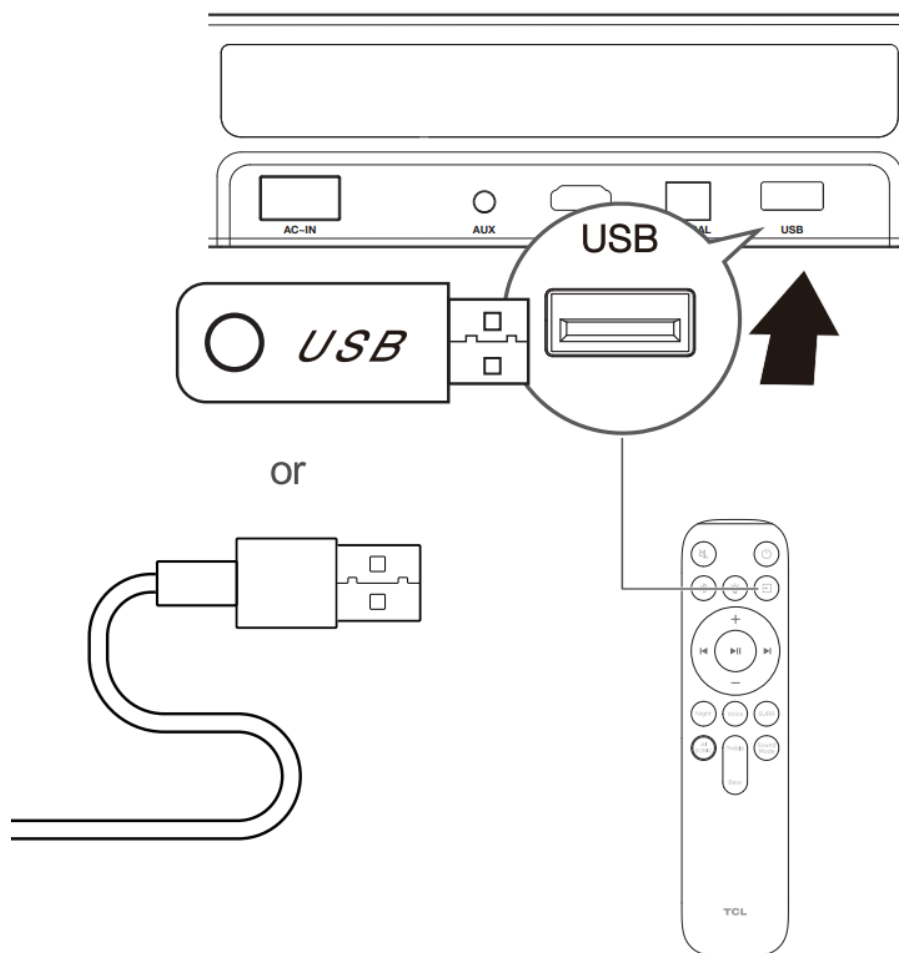

AUX

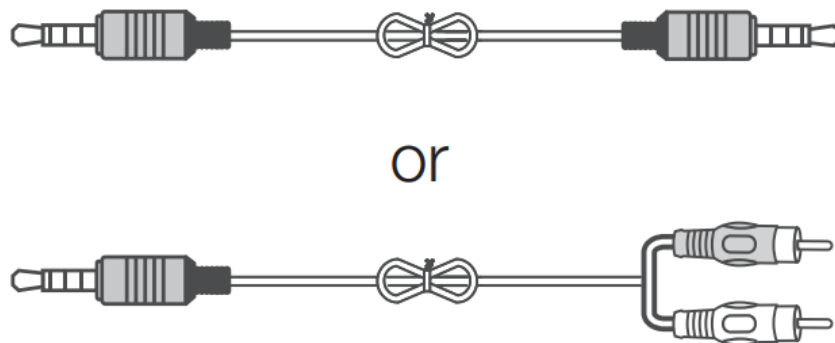

This cable is sold separately.

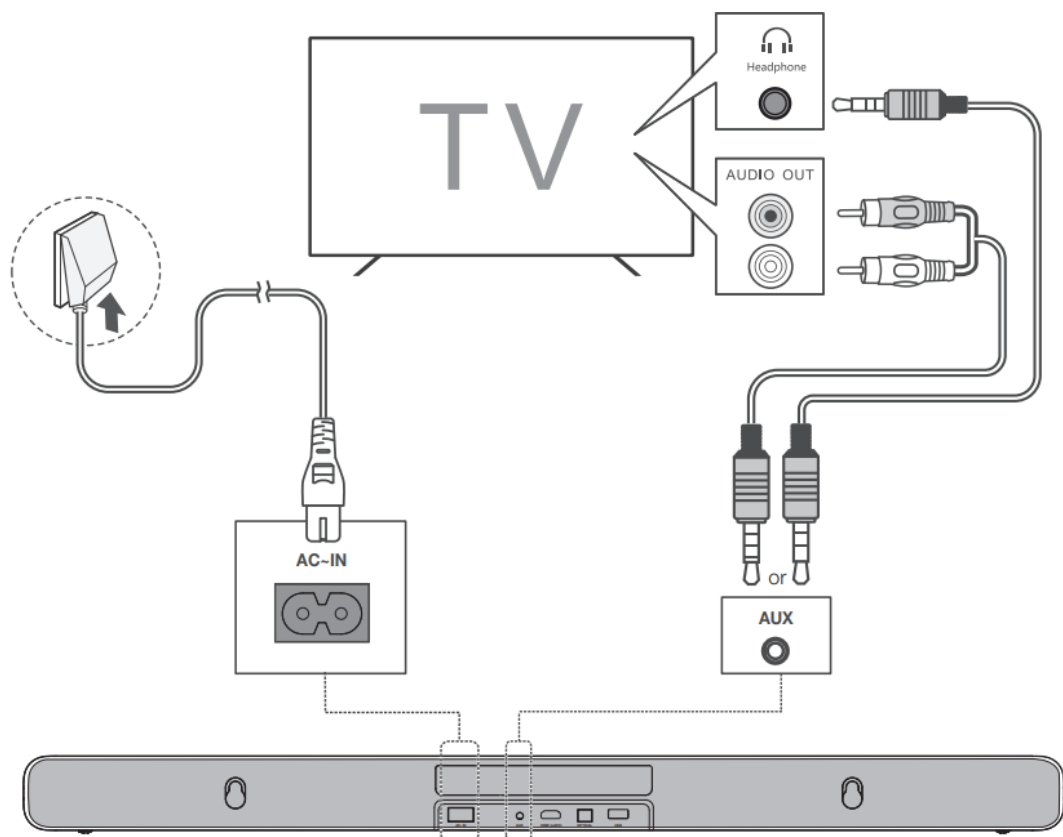

RCL TUTTI CHORAL

Settings → Display & Sound → Audio Output → Internal Speaker+Soundbar(HDMI)

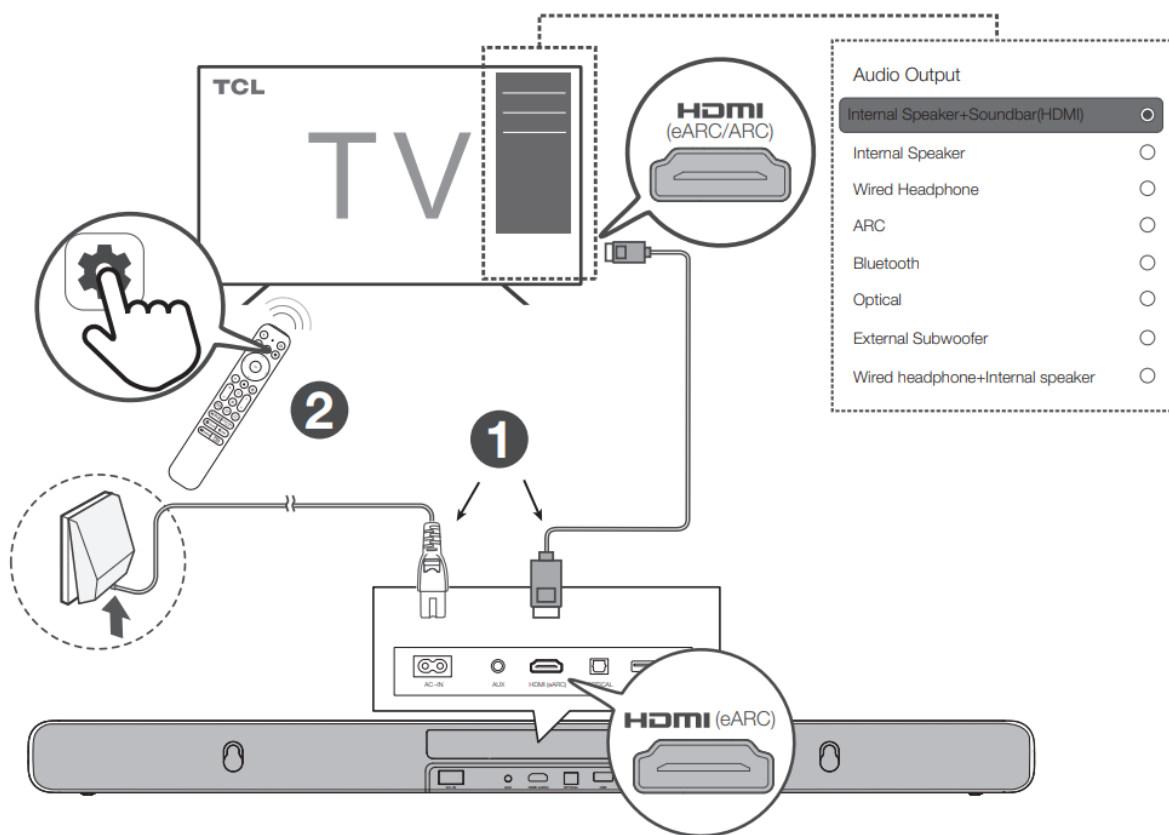

TCL Home App



TCL Home App
Your TCL Smart Hub.
Download Now!

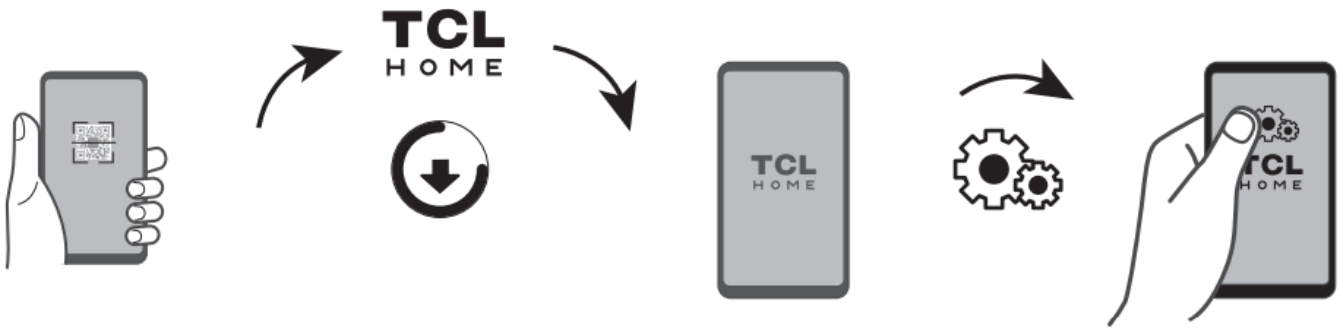

AI Sonic-Adaptation

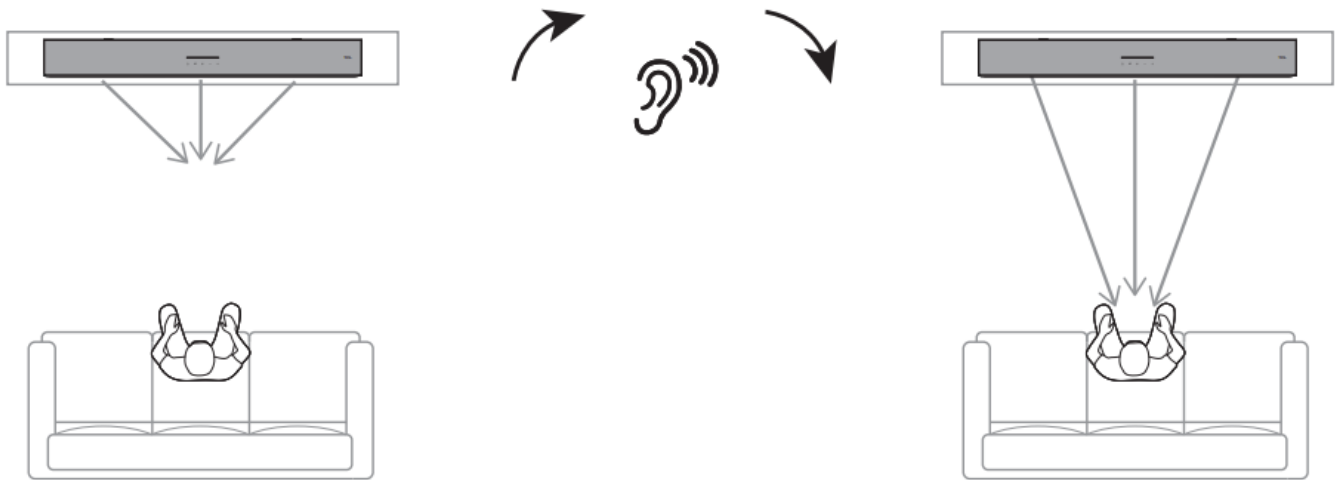

UPDATE



Trademarks

• DOLBY ATOMOS

- Dolby, Dolby Atmos, and the double-D symbol are registered trademarks of Dolby Laboratories Licensing Corporation. Manufactured under license from Dolby Laboratories.
- Confidential unpublished works. Copyright © 2012-2024 Dolby Laboratories. All rights reserved.

• Bluetooth

The Bluetooth® word mark and logos are registered trademarks owned by Bluetooth SIG, Inc. and any use of such marks by TTE Corporation is under license. Other trademarks and trade names are those of their respective owners.

• DTS

For DTS patents, see <http://patents.dts.com>. Manufactured under license from DTS, Inc. DTS, Digital Surround, Virtual:X, and the DTS logo are registered trademarks or trademarks of DTS, Inc. in the United States and other countries.

© 2024 DTS, Inc. ALL RIGHTS RESERVED

• HDMI

“The terms HDMI, HDMI High-Definition Multimedia Interface, HDMI trade dress and the HDMI Logos are trademarks or registered trademarks of HDMI Licensing Administrator, Inc.”

SPECIFICATION

• Radio information Soundbar

- **Frequency range:** 2402MHz~2480MHz
- **Maximum power (EIRP):** 9.024dBm

- **Radio information Subwoofer**
 - **Frequency range:** 2402MHz~2480MHz
 - **Maximum power (EIRP):** 7.91dBm

Documents / Resources

	TCL S55H Channel Sound Bar [pdf] User Guide S55H Channel Sound Bar, S55H, Channel Sound Bar, Sound Bar, Bar
---	--

References

- [🌐 Patents - DTS](#)
- [TCL USA | TVs, Sound Bars, Phones, Appliances](#)
- [User Manual](#)

[Manuals+](#), [Privacy Policy](#)

This website is an independent publication and is neither affiliated with nor endorsed by any of the trademark owners. The "Bluetooth®" word mark and logos are registered trademarks owned by Bluetooth SIG, Inc. The "Wi-Fi®" word mark and logos are registered trademarks owned by the Wi-Fi Alliance. Any use of these marks on this website does not imply any affiliation with or endorsement.