

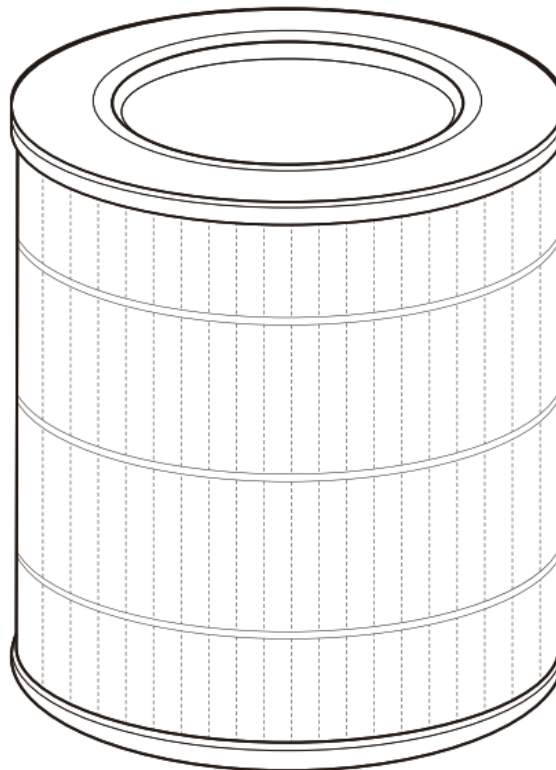

## TCL Breeva A2 Replacement Filter User Guide

[Home](#) » [TCL](#) » TCL Breeva A2 Replacement Filter User Guide

**Hi! Let's Get Started.**



Breeva A2 Replacement Filter  
Quick Start Guide

**Introduction Breeva 3-Stage Filter**

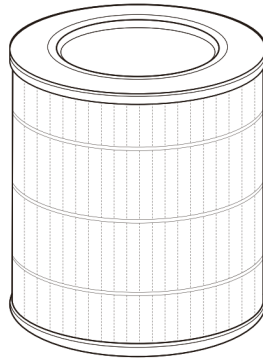

### Pre-Filter

Filters large airborne particles such as dust, pet hair, etc.

### True HEPA Filter

High-Efficiency HEPA Filter helps remove bacteria, pollen, allergens, PM2.5, and other fine particles.

### Activated Carbon Filter

Effectively absorbs and removes formaldehyde, toluene, volatile organic compounds (VOCs), other gaseous pollutants like smoke, and odors. Air Filter Indicator The air filter indicator is located on the air purifier device you originally purchased.

**White:** Status Good up to 2160 hours of filtration remaining

**Yellow:** Status Moderate up to 1920 hours of filtration remaining

**Red:** Status Poor the filter should be replaced. If flickering, the filter should be changed as soon as possible.

### Filter Duration

The 3-stage filter will last from 3-6 months depending on environmental factors.

#### Contents [ [hide](#)

[1 Quick & Easy Setup](#)

[2 Customer Support](#)

[3 Important Safety Information](#)

[4 Documents / Resources](#)

[5 Related Posts](#)

## Quick & Easy Setup

### Step 1:

Completely drain the water reservoir, unplug the air purifier, turn it over, and remove the filter cover.

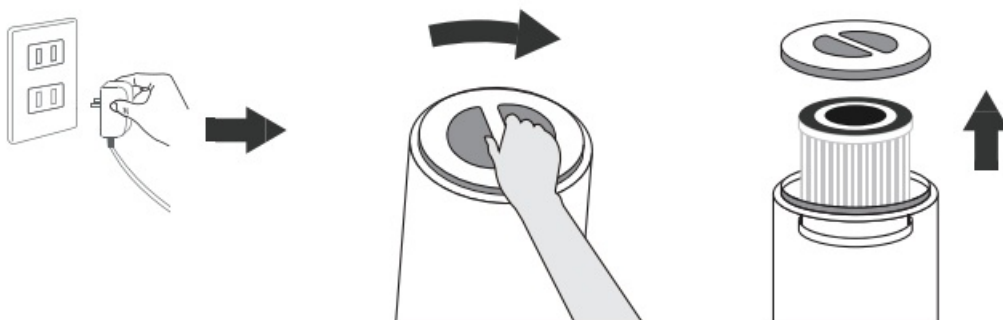

### Step 2:

Remove the old air filter and clean out any dust or debris remaining inside your air purifier (vacuum hose only, no water or liquids permitted).

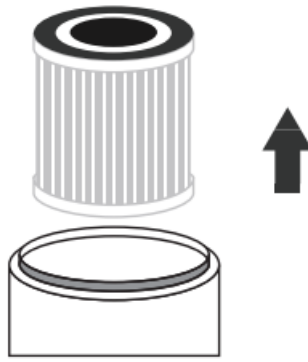
**Step 3:**

Unwrap the new filter from the plastic bag and insert it into the air purifier, then use the filter cover to close the device.

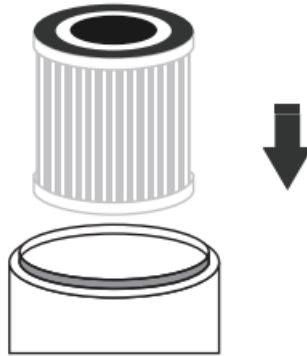
**Step 4:**

Press and hold the filter indicator button for at least 3 seconds until the indicator light resets and turns off.

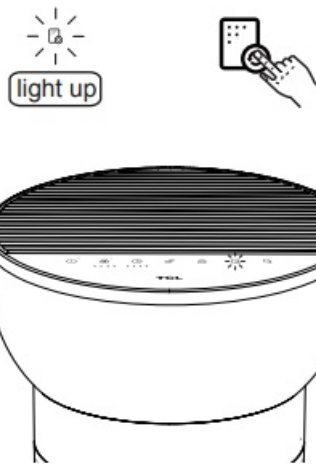
**Customer Support**

Should you have any questions regarding your new filter, please contact our support group at 877-300-9806.

TCL North America  
1860 Compton Ave  
Corona, CA 92881  
1-877-300-9806

[www.tcl.com](http://www.tcl.com)

**Important Safety Information**

1. Follow all safety guidelines. Read all instructions before using.

2. Make sure the air purifier is removed from power before changing the filter  
to avoid damage to the product and avoid any minor or serious injury to the person changing the filter.
3. Do not clean the filter with water or other liquids.
4. Completely remove packaging from the filter prior to use.
5. If your filter is damaged, do not use it and contact Customer Support.
6. After use, follow state/local disposal laws when discarding the filter.
7. Do not allow children to operate this device, or handle or replace the filter, without adult supervision

### Replacement Parts

Scan the QR code below using your phone's camera or type the link below into your browser's URL to purchase TCL genuine replacements parts for your device.

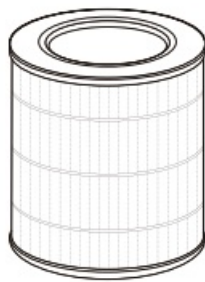

**Breeva A2**  
Air Filter Replacement

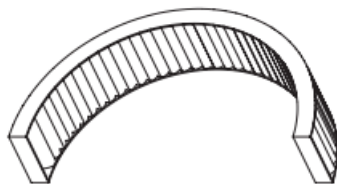

**Breeva A2**  
Humidifying Filter

### Documents / Resources

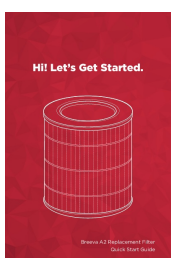

[TCL Breeva A2 Replacement Filter](#) [pdf] User Guide  
Breeva A2 Replacement Filter

