



TCL Breeva A1C Replacement Filter Air Purifier User Guide

[Home](#) » [TCL](#) » TCL Breeva A1C Replacement Filter Air Purifier User Guide

**TCL Breeva A1C Replacement Filter Air
Purifier User Guide**

Hi! Let's Get Started.

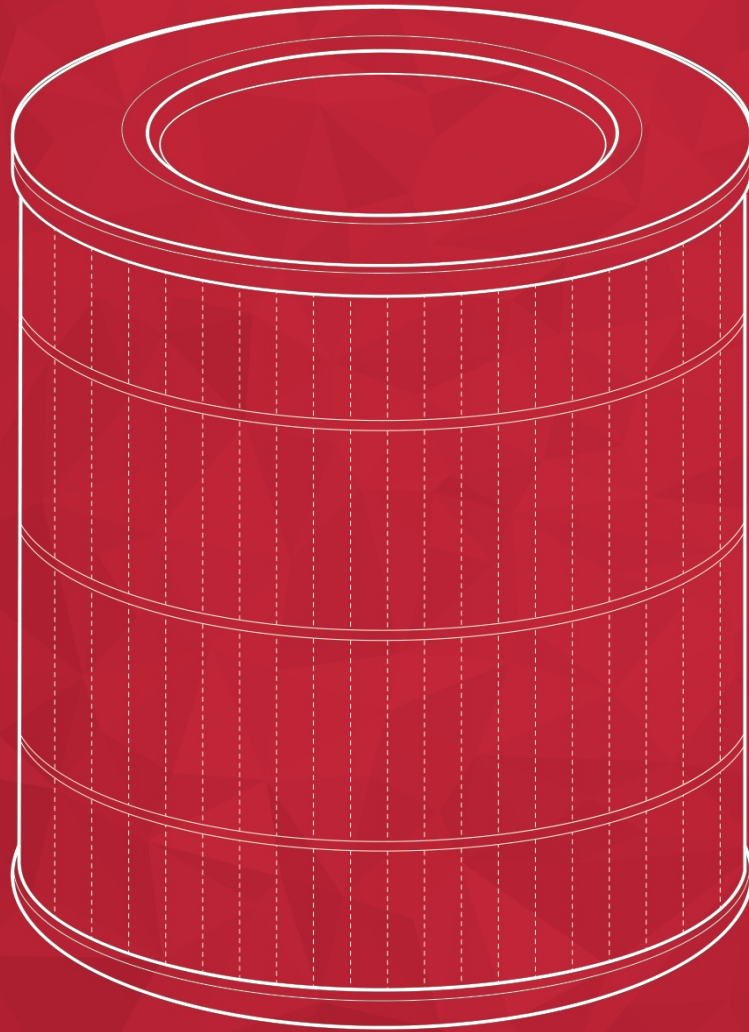

Breeva A1C Replacement Filter
Quick Start Guide

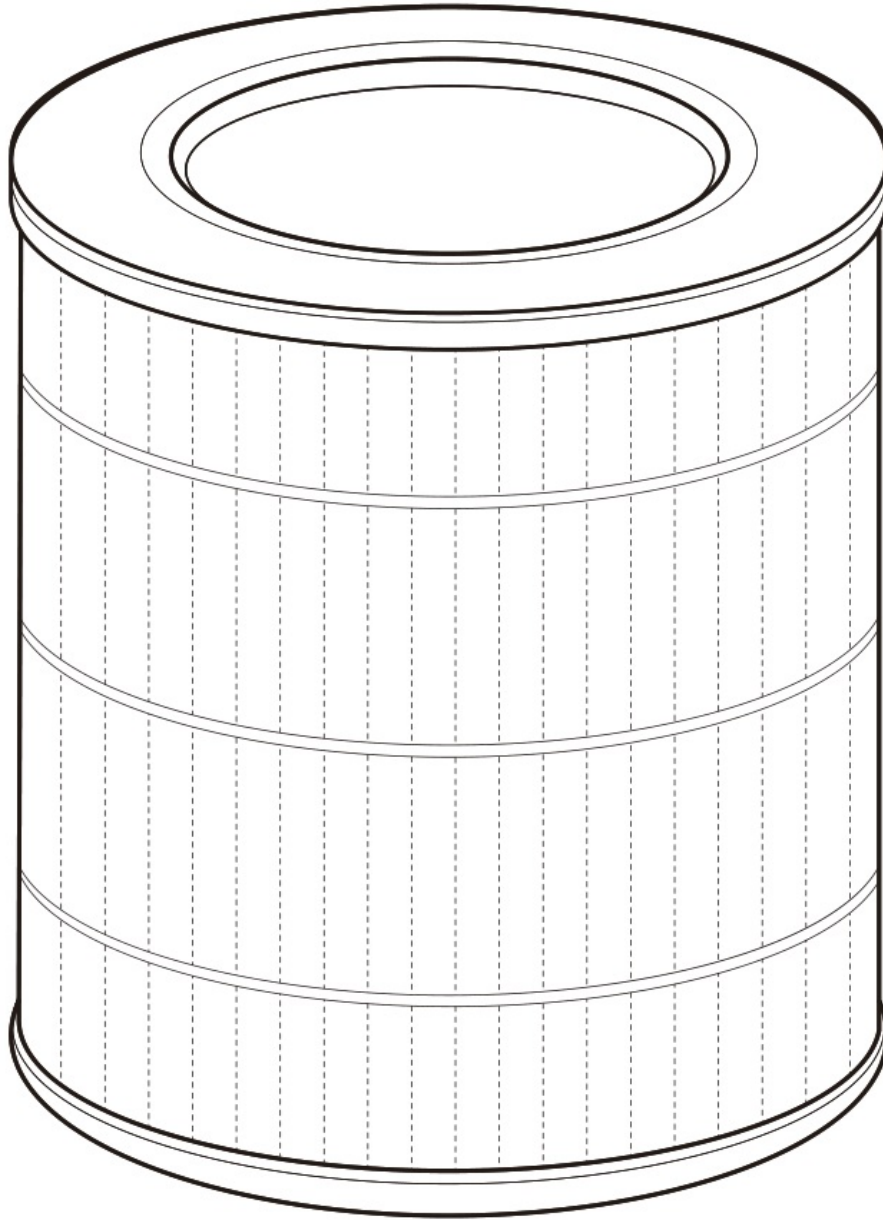

Pre-Filter

Filters large airborne particles such as dust, pet hair, etc.

True HEPA (H13) Filter

H13 High-Efficiency HEPA Filter helps remove bacteria, pollen, allergens, PM2.5, and other fine particles.

Activated Carbon Filter

Effectively absorbs and removes formaldehyde, toluene, volatile organic compounds (VOCs), other gaseous pollutants like smoke, and odors.

Air Filter Indicator

The air filter indicator is located on the air purifier device you originally purchased.

White: Status Good – up to 2160 hours of filtration remaining

Yellow: Status Moderate – up to 1920 hours of filtration remaining

Red: Status Poor – the filter should be replaced. If flickering, the filter should be changed as soon as possible.

Filter Duration

The 3-stage filter will last from 3-6 months depending on environmental factors.

Quick & Easy Setup

Step 1:

Unplug the air purifier, turn it over, and remove the filter cover.

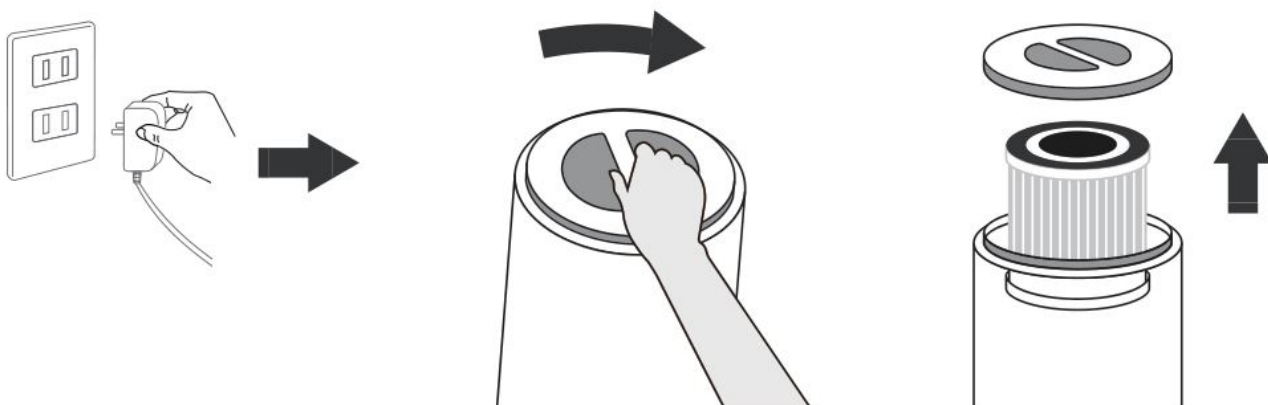

Step 2:

Remove the old air filter and clean out any dust or debris remaining inside your air purifier (vacuum hose only, no water or liquids permitted).

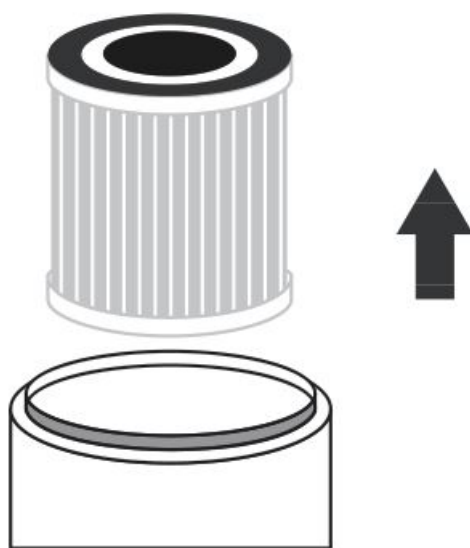

Step 3:

Unwrap the new filter from the plastic bag and insert into the air purifier, then use the filter cover to close the device.

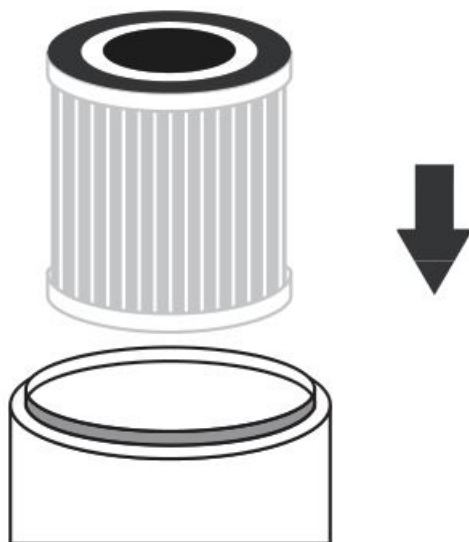

Step 4:

Press and hold the filter indicator button for at least 3 seconds until the indicator light resets and turns off.

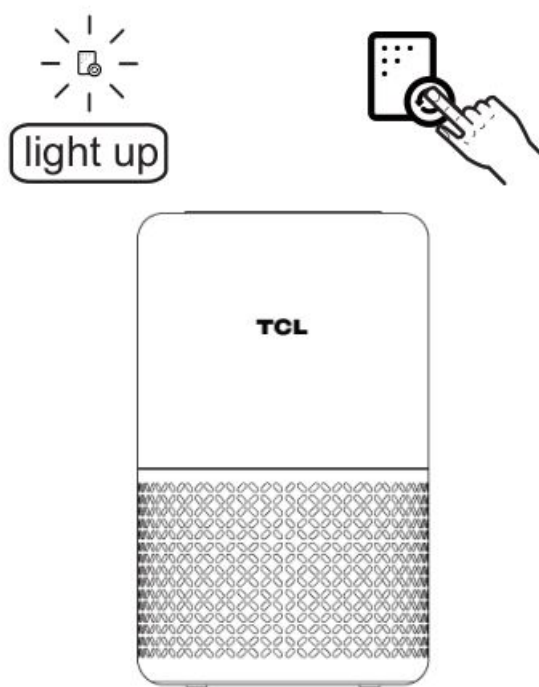

Customer Support

Should you have any questions regarding your new filter, please contact our support group at **877-300-9806**.

TCL North America
1860 Compton Ave
Corona, CA 92881
1-877-300-9806
www.tcl.com

Important Safety Information

- 1. **Follow all safety guidelines. Read all instructions before using.**
- 2. Make sure the air purifier is removed from power before changing the filter to avoid damage to the product and avoid any minor or serious injury to the person changing the filter.
- 3. **Do not** clean the filter with water or other liquids.
- 4. Completely remove packaging from the filter prior to use.
- 5. If your filter is damaged, do not use it and contact Customer Support.
- 6. After use, follow state/local disposal laws when discarding the filter.
- 7. Do not allow children to operate this device, or handle or replace the filter, without adult supervision

Contents [[hide](#)

[1 Documents / Resources](#)

[2 Related Posts](#)

Documents / Resources

	<p>TCL Breeva A1C Replacement Filter Air Purifier [pdf] User Guide Breeva A1C Replacement Filter, Air Purifier, Breeva A1C Replacement Filter Air Purifier</p>
--	--