



Taymor Exploded Drawing For Lever Trim With Escutcheon Plate Installation Guide

[Home](#) » [taymor](#) » Taymor Exploded Drawing For Lever Trim With Escutcheon Plate Installation Guide 

Taymor Exploded Drawing For Lever Trim With Escutcheon Plate



Contents

[1 EXPLODED DRAWING FOR LEVER TRIM WITH ESCUTCHEON PLATE](#)

[2 EXPLODED DRAWING FOR LEVER WITH ROSE TRIM](#)

[3 Documents / Resources](#)

[3.1 References](#)

[4 Related Posts](#)

EXPLODED DRAWING FOR LEVER TRIM WITH ESCUTCHEON PLATE

NOTE For proper installation, door must be professionally prepared using the install template provided. Suitable for 1-3/4" doors only.

- CYLINDER



- OUTSIDE LEVER AND ESCUTCHEON

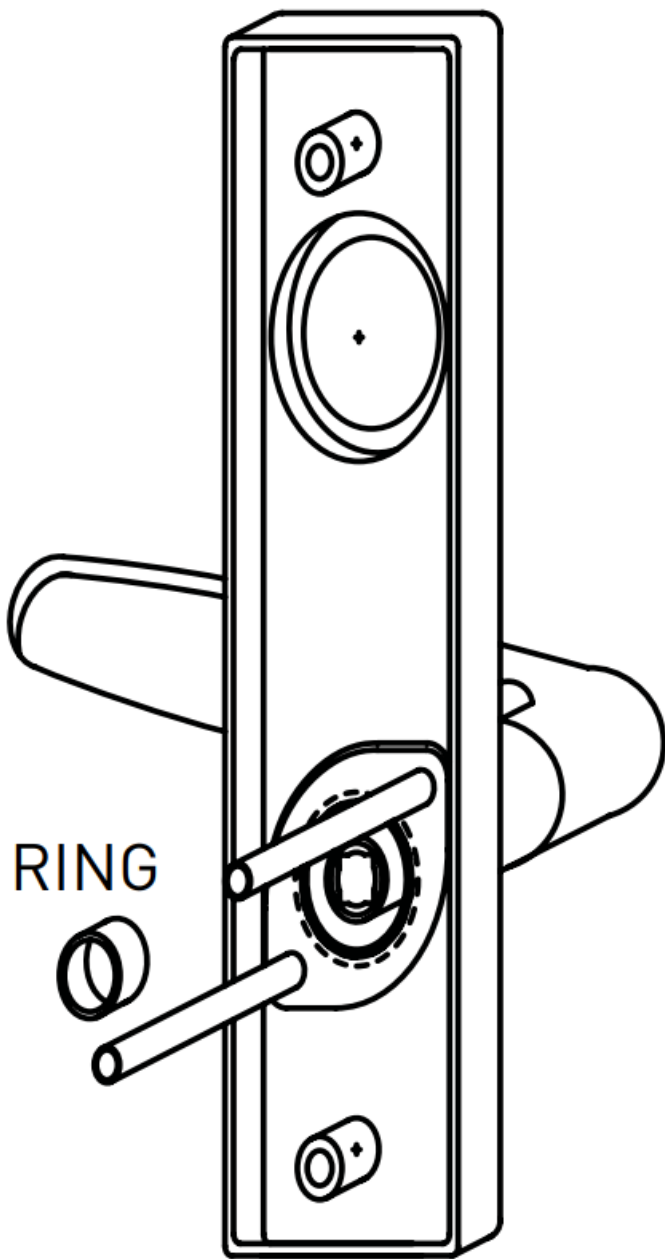

- SPRING



- SPRING CAGE

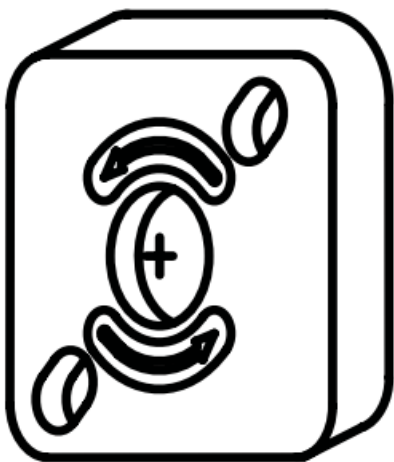

- SPINDLE

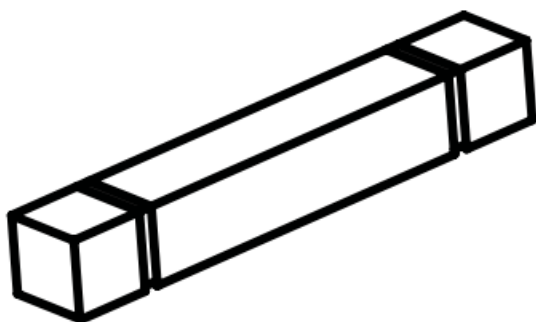

- FACEPLATE SCREWS



- FACEPLATE



- LOCK CASE

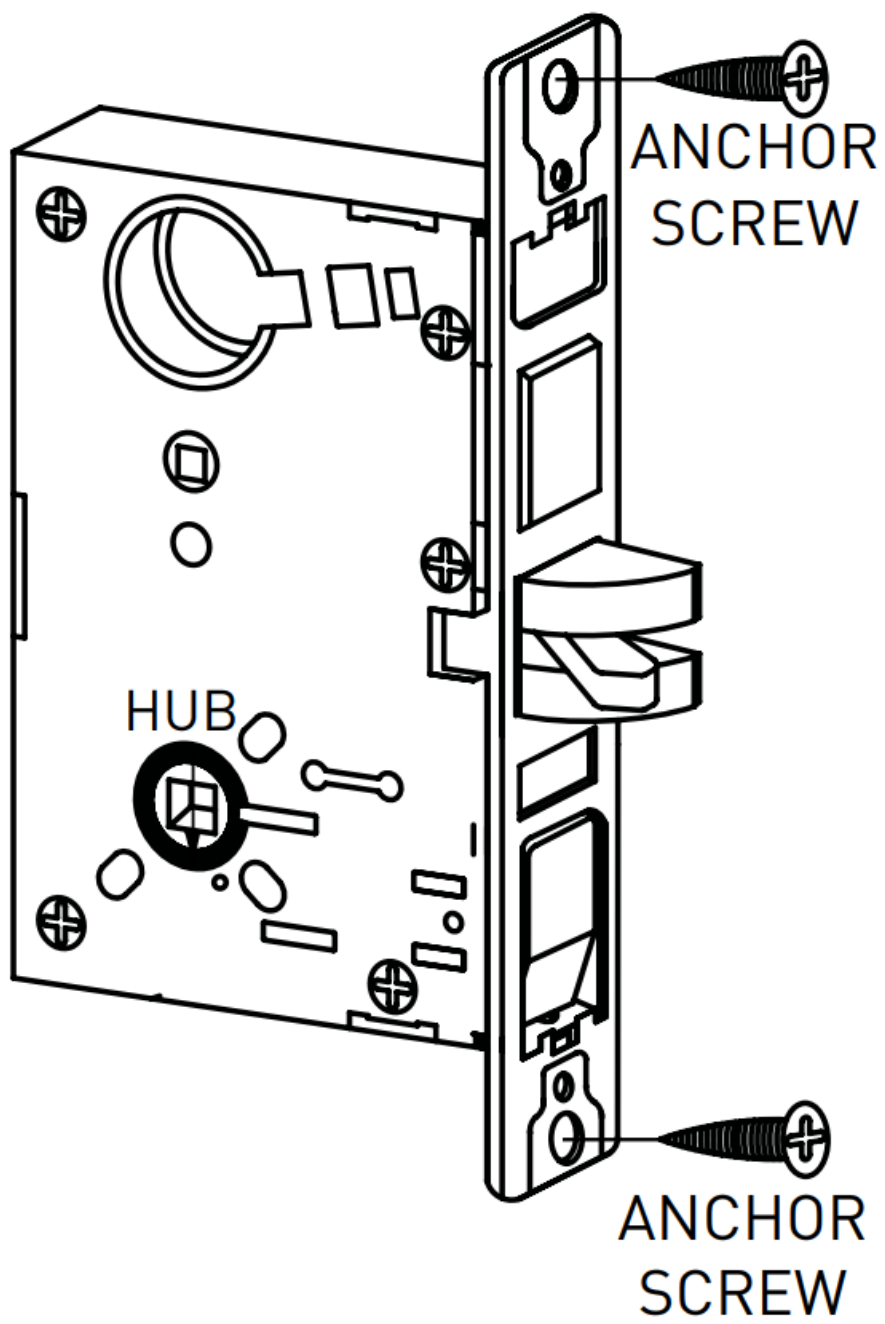

- MOUNTING PLATE

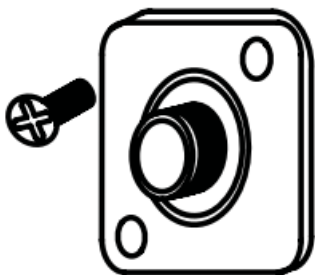

- MOUNTING SCREWS



- INSIDE ESCUTCHEON

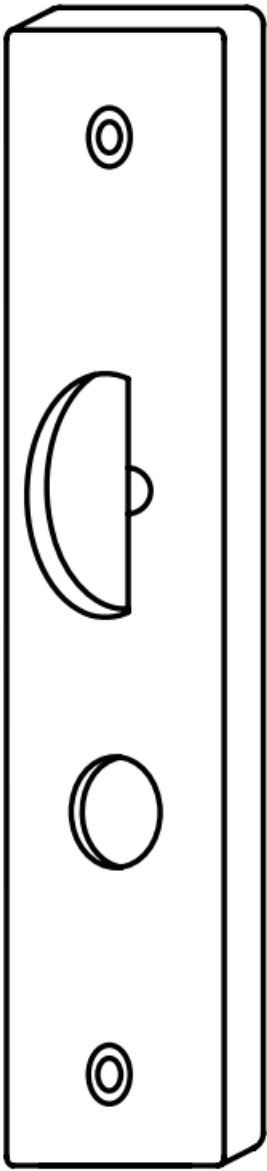

- ESCUTCHEON SCREWS

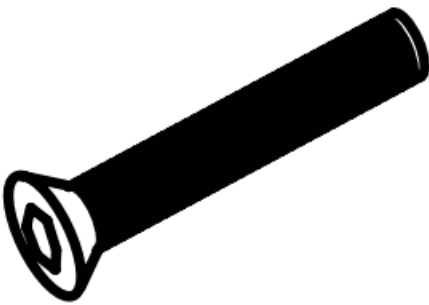

- INSIDE LEVER

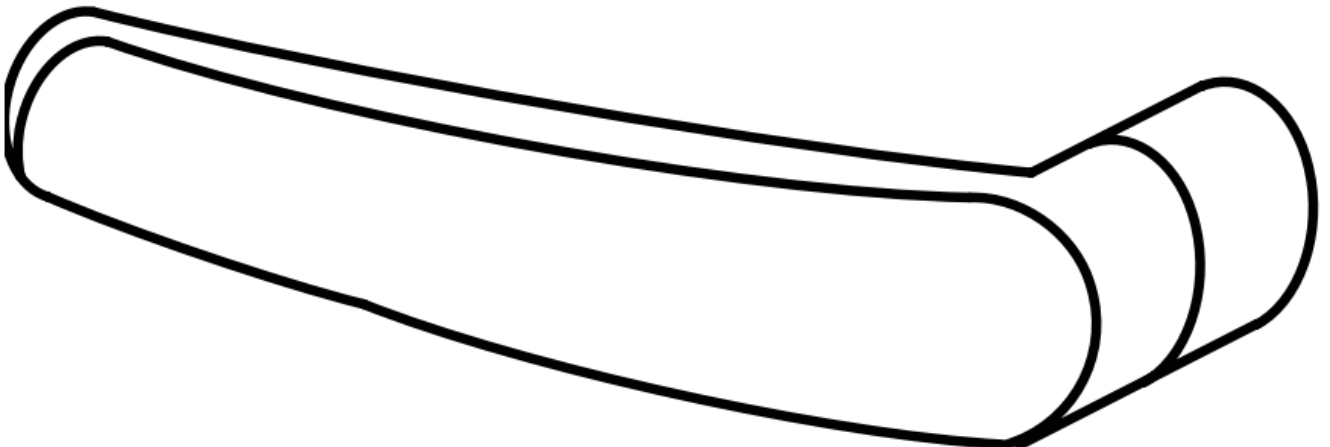

TOOLS REQUIRED FOR INSTALLATION

1. Flathead screwdriver



2. Phillips screwdriver



3. Spanner wrench

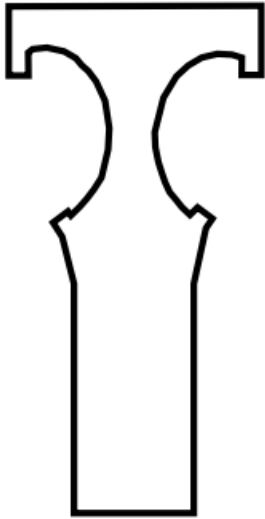

4. Allen key



HAND TOOLS RECOMMENDED

If using power tools, use lowest torque settings.

EXPLODED DRAWING FOR LEVER WITH ROSE TRIM

ROUND ROSE

- CYLINDER

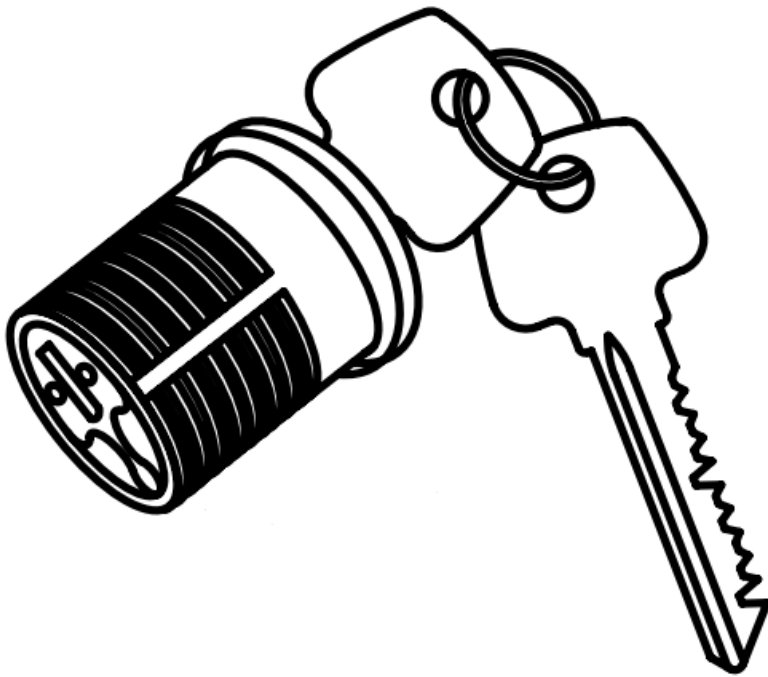

- CYLINDER SPRING

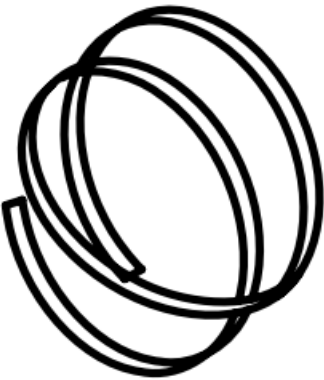

- SQUARE ROSE

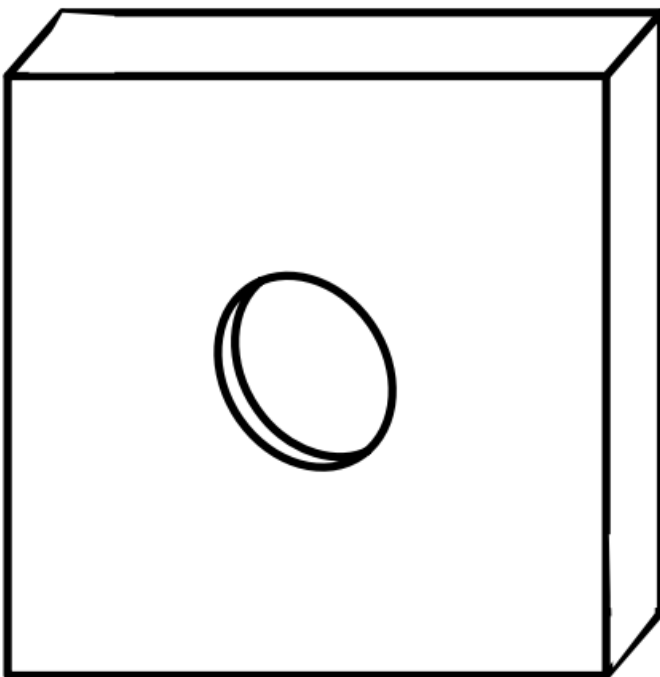

- SET SCREW



- CYLINDER COLLAR

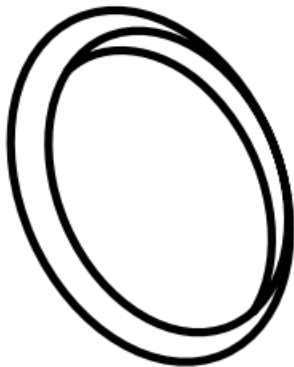

- OUTSIDE LEVER AND ROUND ROSE

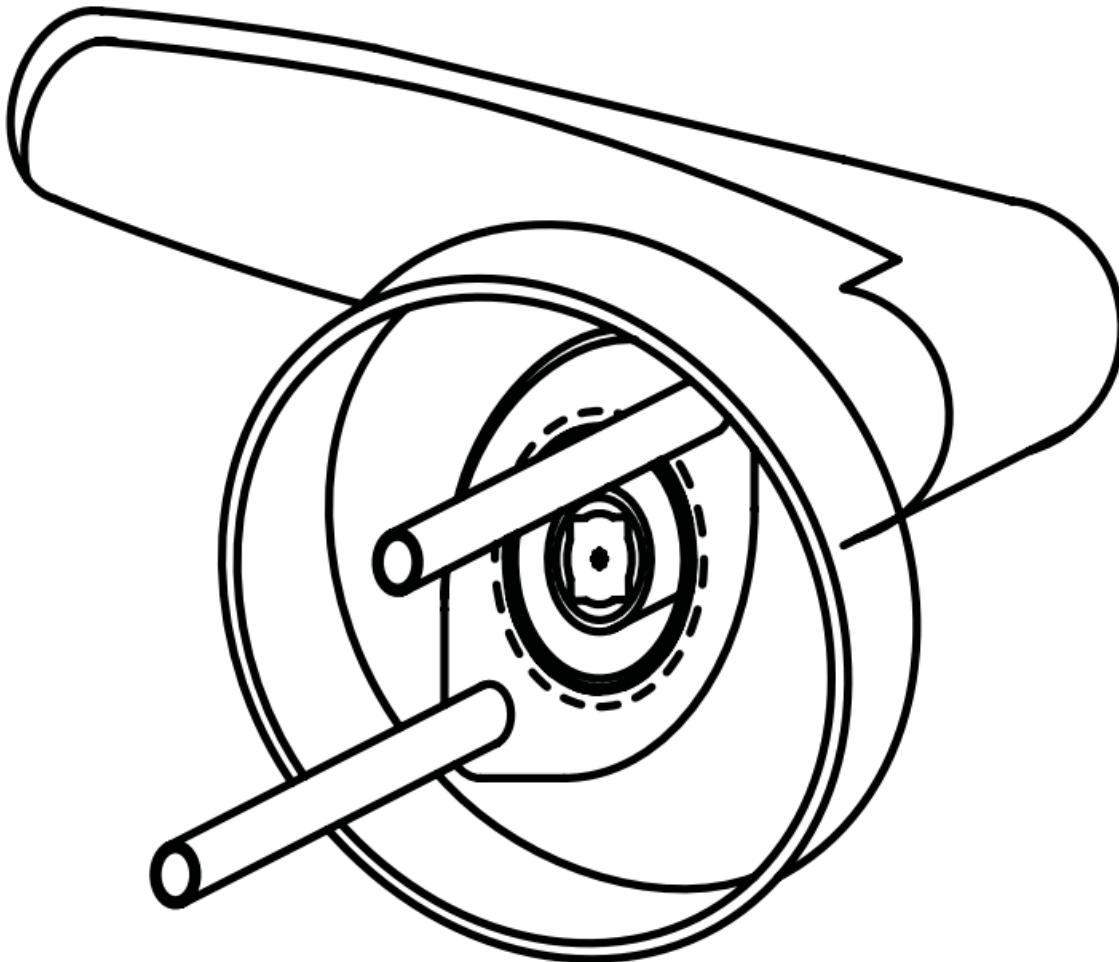

- RING



- SPRING

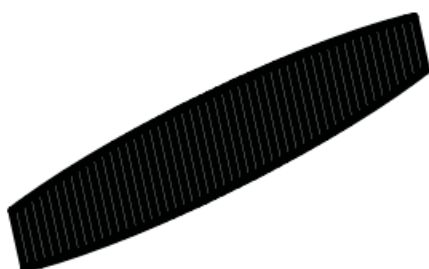

- SPRING CAGE

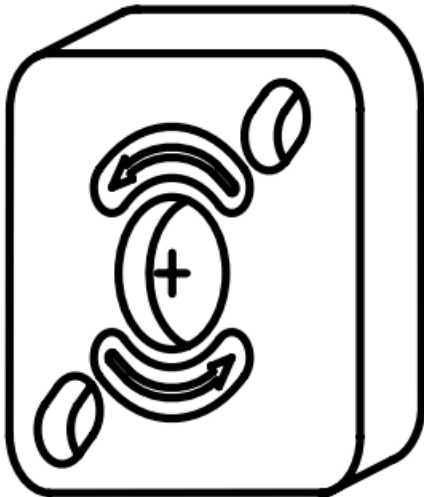

- SPINDLE

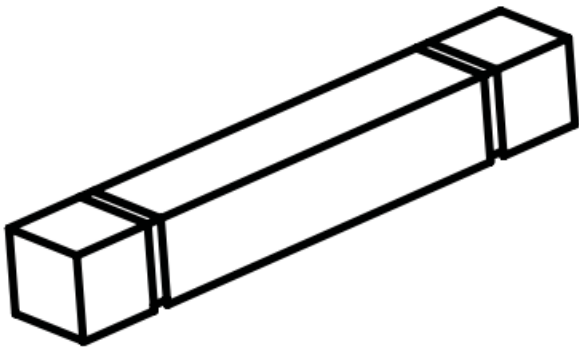

- FACEPLATE SCREWS



- FACEPLATE



- LOCK CASE

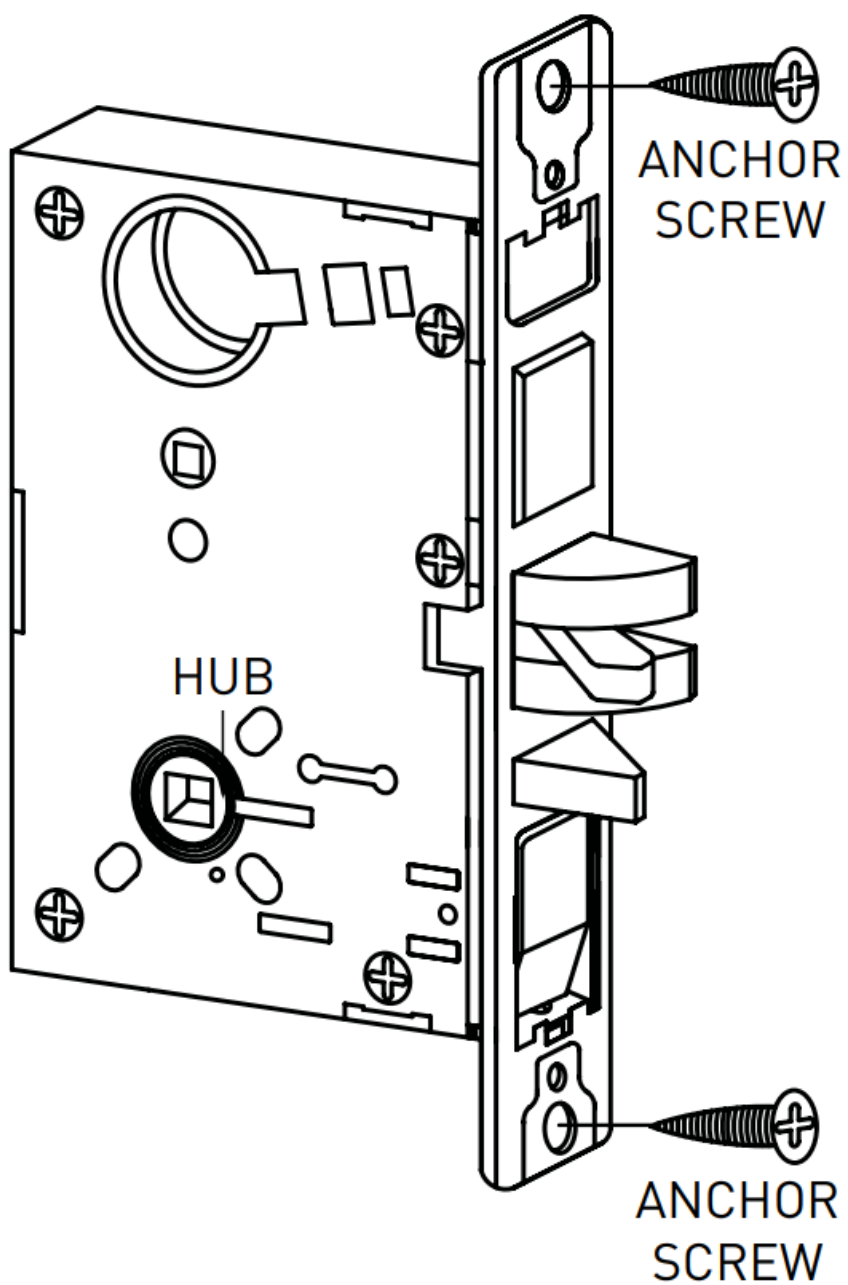

- MOUNTING PLATE

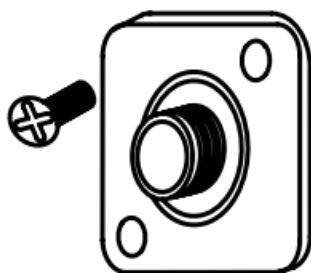

- MOUNTING SCREWS



- ROUND ROSES

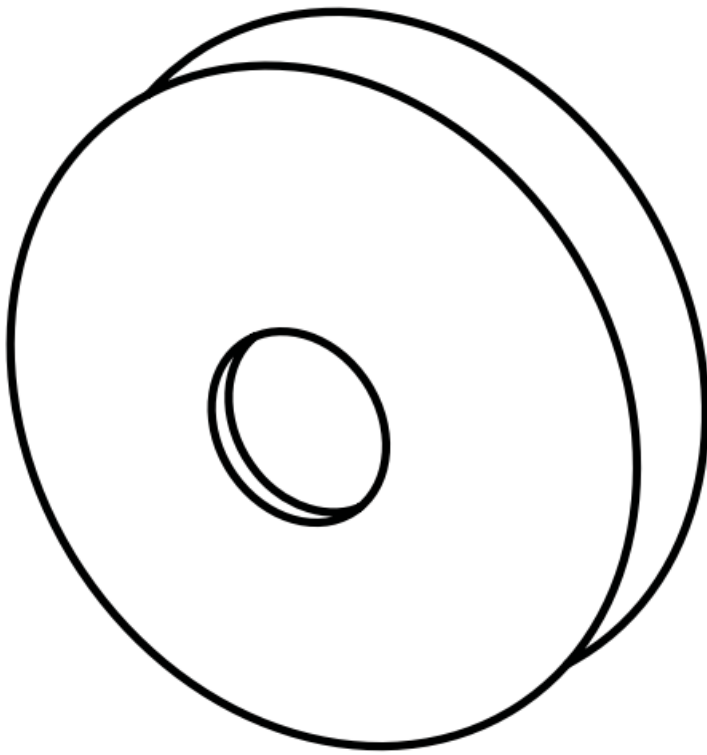

- INSIDE LEVER

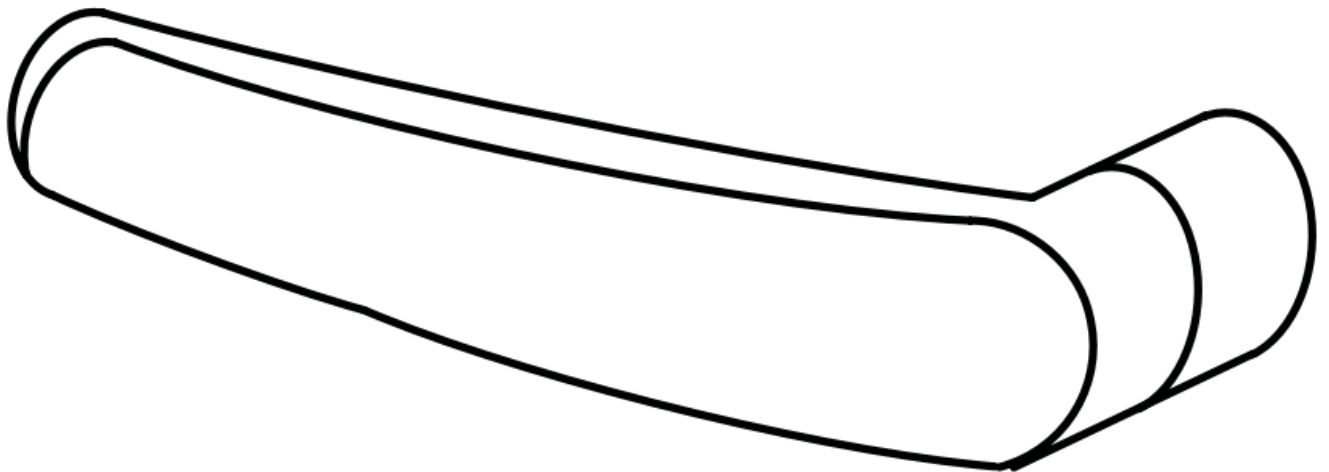

- THUMB TURN

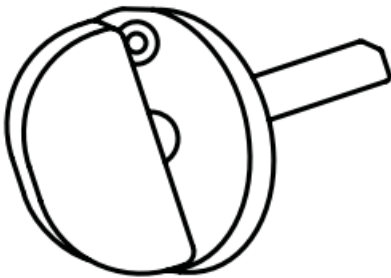

- THUMB TURN SCREWS



® REGISTERED TRADEMARK OF TAYMOR INDUSTRIES LTD.

www.taymor.com

Taymor

Documents / Resources

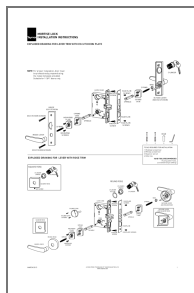

[Taymor Exploded Drawing For Lever Trim With Escutcheon Plate](#) [pdf] Installation Guide Exploded Drawing For Lever Trim With Escutcheon Plate, Drawing For Lever Trim With Escutcheon Plate, Lever Trim With Escutcheon Plate, Trim With Escutcheon Plate, Escutcheon Plate, Plate

References

-  [Taymor](#)
- [User Manual](#)

[Manuals+](#), [Privacy Policy](#)

This website is an independent publication and is neither affiliated with nor endorsed by any of the trademark owners. The "Bluetooth®" word mark and logos are registered trademarks owned by Bluetooth SIG, Inc. The "Wi-Fi®" word mark and logos are registered trademarks owned by the Wi-Fi Alliance. Any use of these marks on this website does not imply any affiliation with or endorsement.