



TASK power LP42HR21NDBBK40 Lighted Power Strip Instruction Manual

[Home](#) » [TASK power](#) » TASK power LP42HR21NDBBK40 Lighted Power Strip Instruction Manual 

Contents

- 1 [TASK power LP42HR21NDBBK40 Lighted Power Strip](#)
- 2 [Product Information](#)
- 3 [Product Usage Instructions](#)
- 4 [DV Series](#)
 - 4.1 [General Guidelines](#)
 - 4.2 [Wiring](#)
- 5 [RM Series](#)
 - 5.1 [General Guidelines](#)
 - 5.2 [Remote Power Supply](#)
- 6 [Documents / Resources](#)
 - 6.1 [References](#)



TASK power LP42HR21NDBBK40 Lighted Power Strip



Product Information

Specifications:

- Product Name: Lighted Power Strip DV Series
- Installation Date: January 2019
- Customer Service: 800-445-6404
- Design Services & Tech Support: 866-848-9094
- Website: www.TaskLighting.com

Product Usage Instructions

General Guidelines:

Turn off power at the panel before installation. Use the provided tool to carefully open each piece. Insert Romex connector into the knockout hole inside the back frame and pull wires into the LPS.

Wiring for Combined Light and Receptacle Circuit – Non Dimmable:

1. **Step 1:** Secure LPS to the wall by screwing into wall studs or use anchors provided. Connect BLACK Romex wire to BLACK wire from receptacles and switch. Connect WHITE Romex wire to WHITE wire from receptacles and driver. Ground all GREEN wires to PEM studs inside the back frame.
2. **Step 2:** When connecting 2 or more LPS fixtures, run Romex from fixture to fixture. Ground each section to the next.
3. **Step 3:** To terminate the last LPS, use wire nuts on ends of wires.
4. **Step 4:** Snap cover in place and turn power on.

Wiring for Separate Light and Receptacle Circuits:

1. **Step 1:** Secure LPS to the wall by screwing into wall studs or use anchors provided. If running two circuits, one for receptacles, one for lighting, connect fixture wires to appropriate Romex wires. BLACK to BLACK. WHITE to WHITE. Ground all GREEN wires to PEM studs inside the back frame.
2. **Step 2:** When connecting 2 or more LPS fixtures, run Romex from fixture to fixture. Ground each section to the next.
3. **Step 3:** To terminate the last LPS, use wire nuts on ends of wires.
4. **Step 4:** Snap cover in place and turn power on.

FAQ

- **Q: What should I do if I encounter difficulties during installation?**

A: If you encounter difficulties during installation, please contact our Customer Service team at 800-445-6404 for assistance.

DV Series

General Guidelines

- Power source MUST be a 20 amp branch circuit protected by a GFCI at the panel or GFCI prior to the connection at LPS.
- All wiring must meet NEC® and local codes.
- Light valance recommended.
- Firmly insert plug straight into receptacle, applying equal pressure to both blades at the same time. Gently rock plug, if needed.

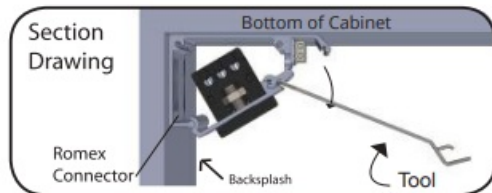

Turn power off at panel. **Carefully** pry open each piece with tool (provided). Insert Romex connector into knockout hole inside of back frame. Pull wires into LPS.

Wiring

Wiring for Combined Light and Receptacle Circuit – Non Dimmable

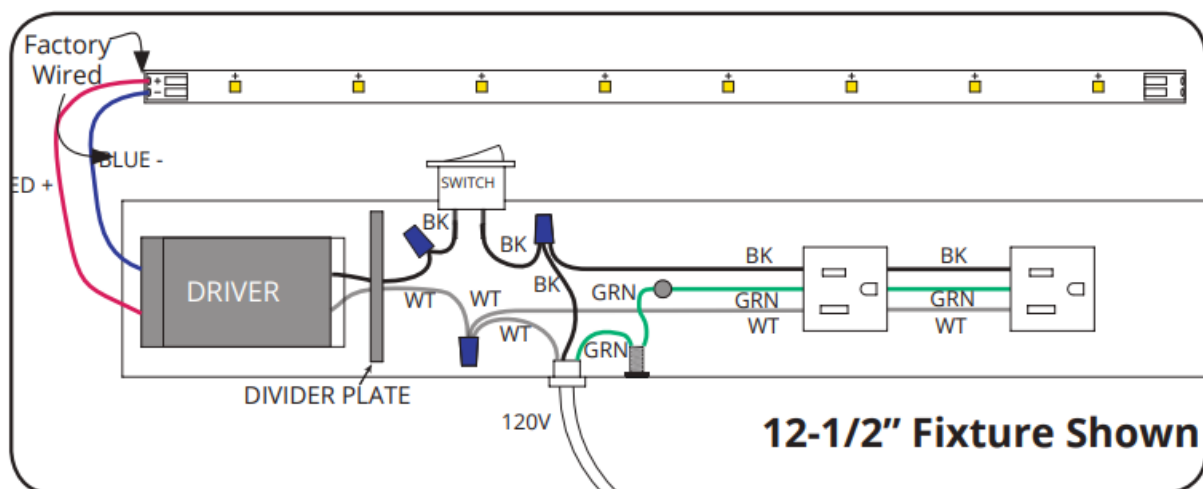

- **Step 1:** Secure LPS to wall by screwing into wall studs or use anchors provided. Connect BLACK Romex wire to BLACK wire from receptacles and switch. Connect WHITE Romex wire to WHITE wire from receptacles and driver. Ground all GREEN wires to PEM studs inside of back frame.
- **Step 2:** When connecting 2 or more LPS fixtures, run Romex from fixture to fixture. Ground each section to the next.
- **Step 3:** To terminate last LPS, use wire nuts on ends of wires.
- **Step 4:** Snap cover in place and turn power on.

Wiring for Separate Light and Receptacle Circuits

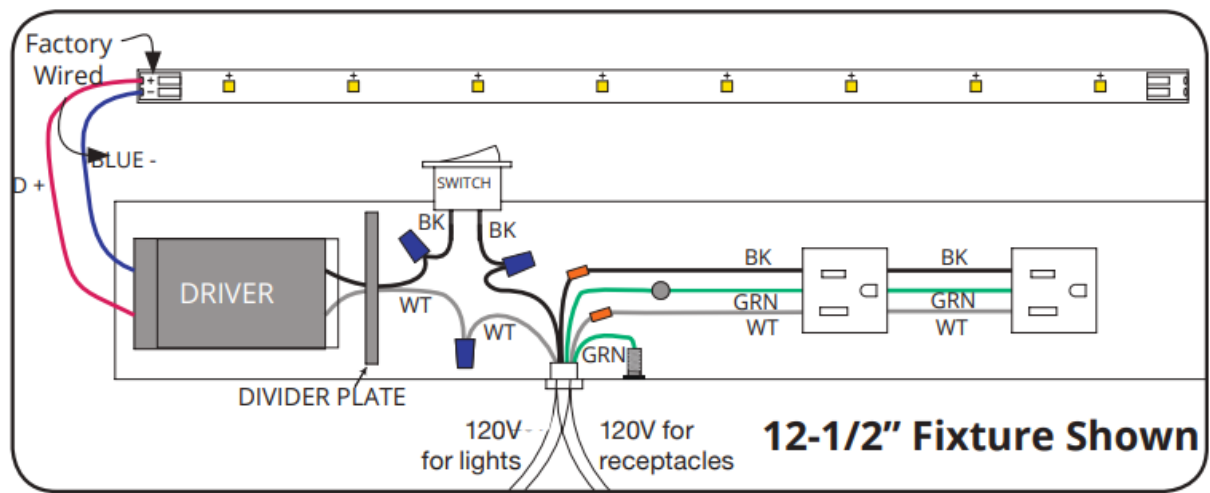

- **Step 1:** Secure LPS to wall by screwing into wall studs or use anchors provided. If running two circuits, one for receptacles, one for lighting, connect fixture wires to appropriate Romex wires. BLACK to BLACK. WHITE to WHITE. Ground all GREEN wires to PEM studs inside of back frame.
- **Step 2:** When connecting 2 or more LPS fixtures, run Romex from fixture to fixture. Ground each section to the next.
- **Step 3:** To terminate last LPS, use wire nuts on ends of wires.
- **Step 4:** Snap cover in place and turn power on.

Wiring Diagram for Combined Light & Receptacle Circuit – Non Dimmable

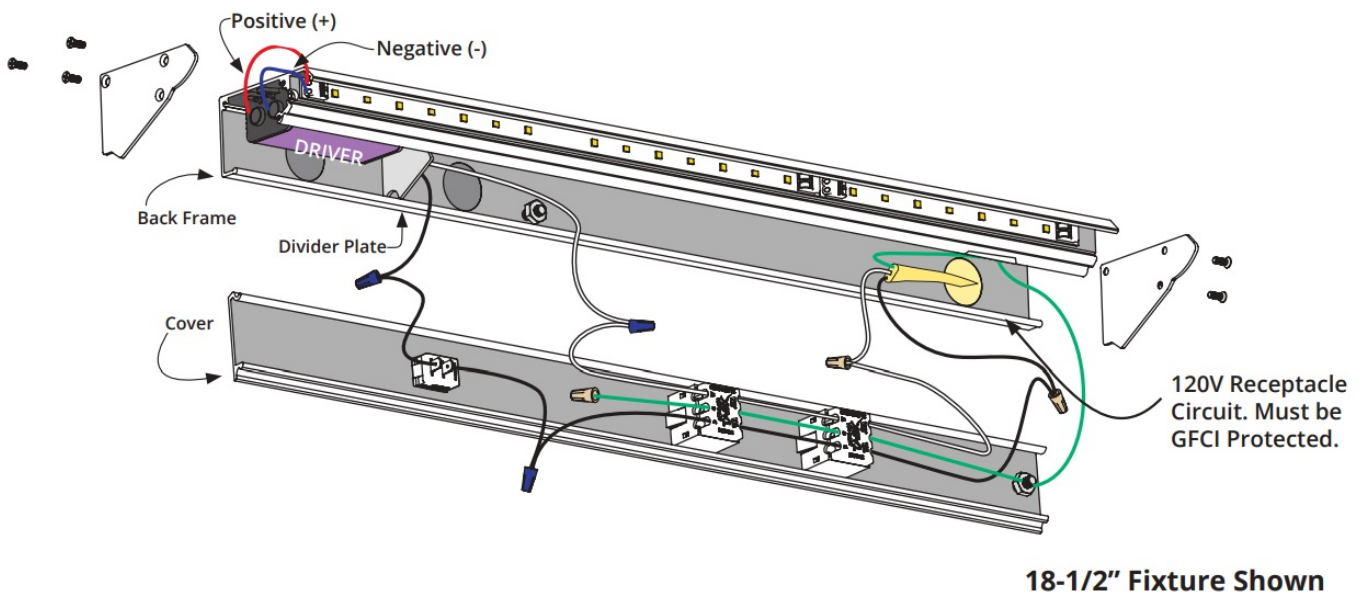

Wiring Diagram for Separate Light & Receptacle Circuits

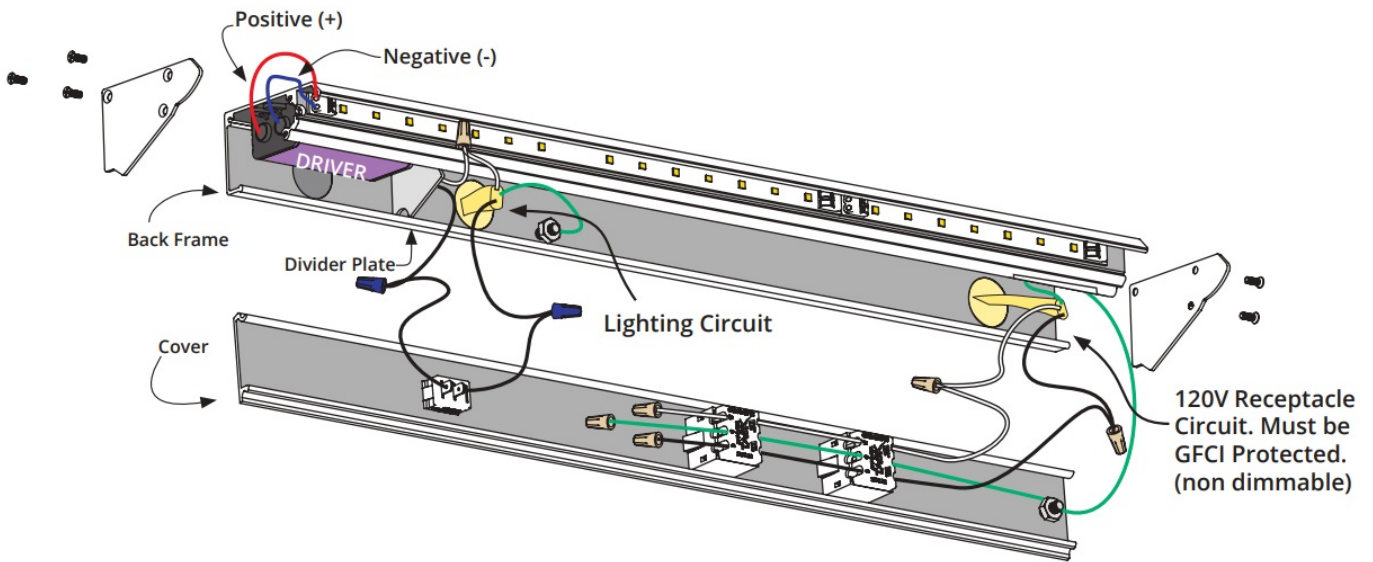

18-1/2" Fixture Shown

RM Series

General Guidelines

- Power source MUST be a 20 amp branch circuit protected by a GFCI at the panel or GFCI prior to the connection at LPS.
- All wiring must meet NEC® and local codes.
- Light valance recommended.
- Firmly insert plug straight into receptacle, applying equal pressure to both blades at the same time. Gently rock plug, if needed.

Turn power off at panel. Carefully pry open each piece with tool (provided). Insert Romex connector into knockout hole inside of back frame. Pull wires into LPS.

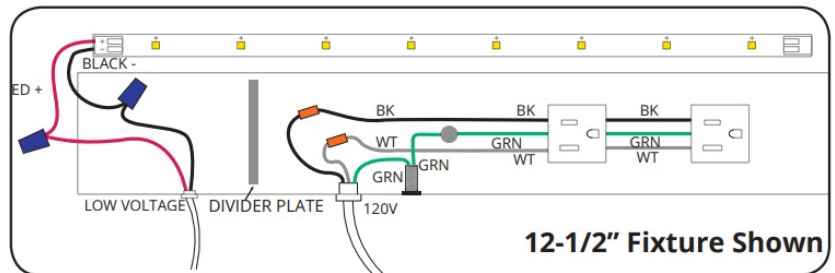
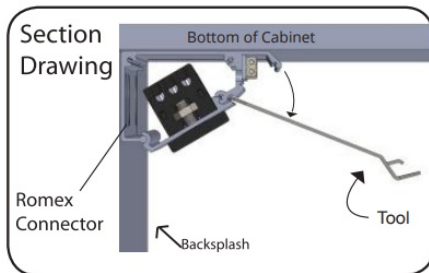

12-1/2" Fixture Shown

Remote Power Supply

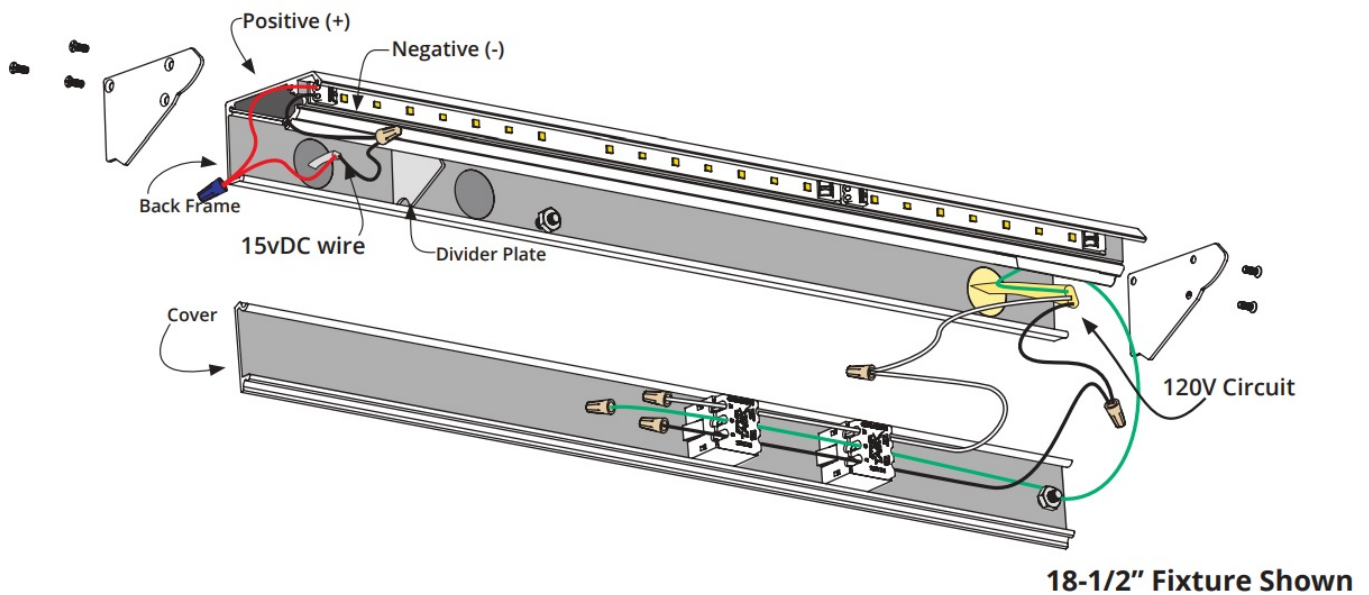

- **Step 1:** Secure LPS to wall by screwing into wall studs or use anchors provided. Connect BLACK to BLACK, WHITE to WHITE. Ground all GREEN wires to PEM studs inside of back frame.
- **Step 2:** When connecting two LPS, run Romex from fixture to fixture. Ground each section to the next.
- **Step 3:** To terminate last LPS, use wire nuts on ends of wires.
- **Step 4:** Using appropriate knockout hole, pull low voltage wire from remote power supply into the low voltage space, connect BLACK wire (negative) to BLACK wire from lights and RED wire (positive) to RED wire.
- **Step 5:** Snap cover in place and turn power on.

Customer Service: 800.445.6404

Design Services/Technical Support: 866.848.9094

TaskLighting.com

Documents / Resources

 <p>TASK power LIGHTED POWER STRIP installation instructions JANUARY 2016</p>	<p>TASK power LP42HR21NDBBK40 Lighted Power Strip [pdf] Instruction Manual LP42HR21NDBBK40 Lighted Power Strip, LP42HR21NDBBK40, Lighted Power Strip, Power S trip, Strip</p>
---	---

References

- [Task Lighting | Task Lighting Under Cabinet | Bathroom Lighting](#)
- [Task Lighting | Task Lighting Under Cabinet | Bathroom Lighting](#)
- [User Manual](#)

This website is an independent publication and is neither affiliated with nor endorsed by any of the trademark owners. The "Bluetooth®" word mark and logos are registered trademarks owned by Bluetooth SIG, Inc. The "Wi-Fi®" word mark and logos are registered trademarks owned by the Wi-Fi Alliance. Any use of these marks on this website does not imply any affiliation with or endorsement.