



Targus THZ621US VersaType 4-in-1 Keyboard Case User Manual

[Home](#) » [Targus](#) » Targus THZ621US VersaType 4-in-1 Keyboard Case User Manual 

Contents

- [1 Targus THZ621US VersaType 4-in-1 Keyboard Case](#)
- [2 Introduction](#)
- [3 Contents](#)
- [4 Touchpad Gesture Description](#)
- [5 Documents / Resources](#)
 - [5.1 References](#)
- [6 Related Posts](#)

Targus®

Targus THZ621US VersaType 4-in-1 Keyboard Case



Introduction

Thank you for purchasing the VersaType™ 4-in-1 Keyboard Case iPad Pro (12.9-inch) 3rd/ 4th Gen. The keyboard uses Bluetooth technology which provides a seamless connection. It's pivoting screen allows you to convert the case between four different function modes. The maximum working angle on the keyboard is 120 degrees.

Contents

1. VersaType™ 4-in-1 Keyboard Case
2. USB Charging Cable (for keyboard charging)
3. User Guide

System Requirements

iPad Pro (12.9-inch) 3rd/ 4th Gen

Establishing Connection with iPad

- Switch on the Bluetooth keyboard. (Turn on the power by sliding the On/Off Switch to the right). The Blue LED and Red LED will remain lit for 3 seconds.
- While the Blue LED is flashing, go to your iPad's Bluetooth settings and select "Targus THZ862 Keyboard".

- The Bluetooth keyboard is now connected to your iPad.
- If the pairing process takes longer than 3 seconds and the Blue LED turns off, reset the power switch (“OFF” and back “ON”) and follow step 2. Or manually press “fn” + “C”, wait for the Blue LED to flash
- Please ensure to configure your iPad to US language.

Remove the Device from the Case

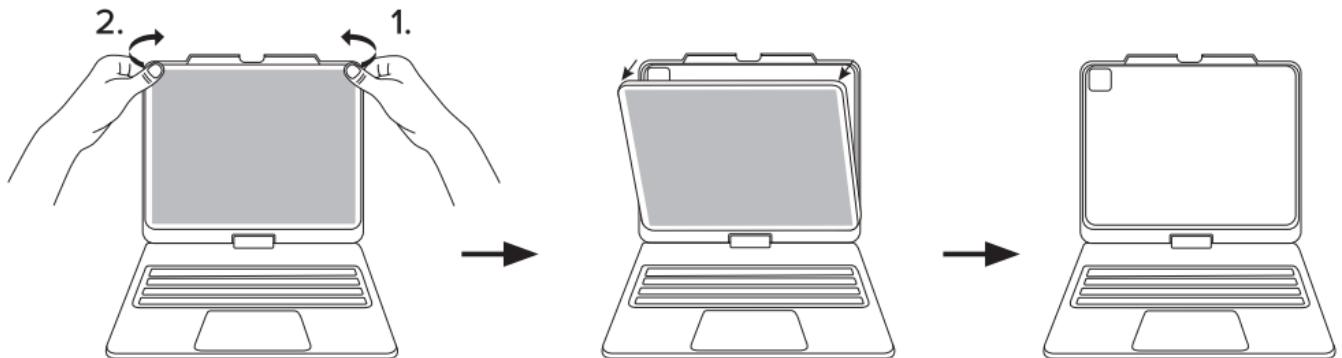

Touchpad Gesture Description

ONE FINGER

- Left-click (customizable): Tap with one finger to click
- Slide the pointer: Move with one finger
- Drag items: Tap twice with one finger, then hold and drag around

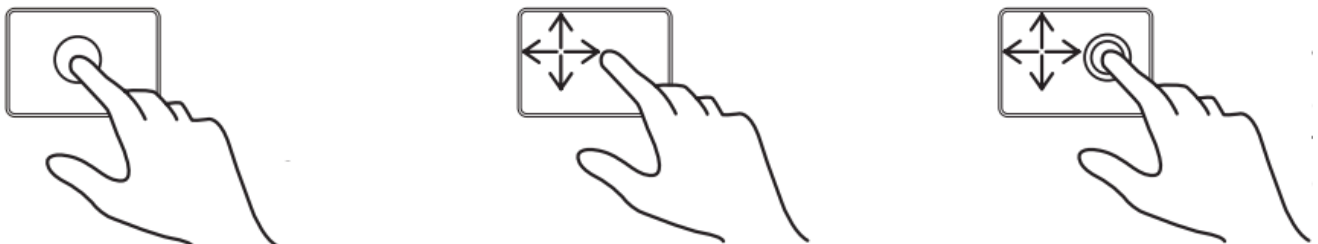

- Slide over switcher: Slide one finger down from the top edge of the screen to see all activer apps
- To see the dock while you're using an app: Slide one finger up from the bottom edge of the screen until the dock appears, then release



Two fingers

- Pay attention to: Slide your fingers from right to left
- Switch window to left Swipe from left to right with both fingers
- Right-click (customizable): Tap with two fingers to right-click

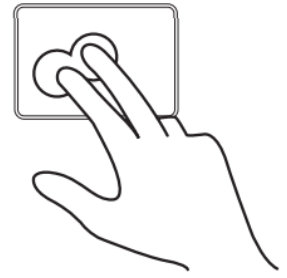
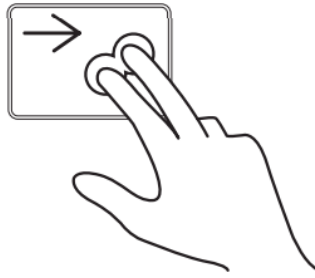
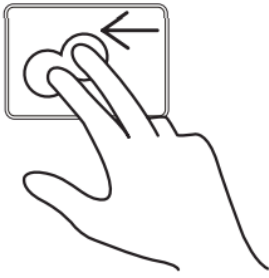

- Roller scroll: Swipe with two fingers to the left/ right or scroll up/ down
- Zoom in out

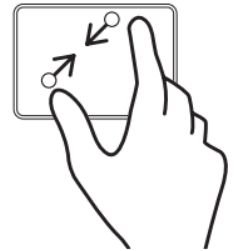
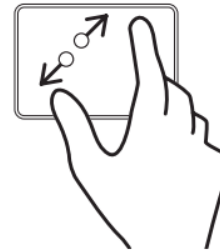
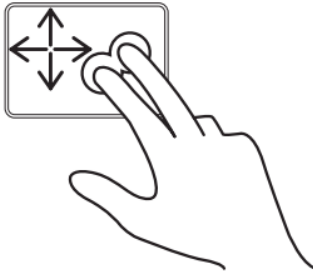

Three fingers

- Open the recently used window (Switch back to the previous application window): Three fingers moving down at the same time
- Return to the main interface: All three fingers moving up at the same time
- Active window (left/ right slide Switch): Slide three fingers simultaneously left and right

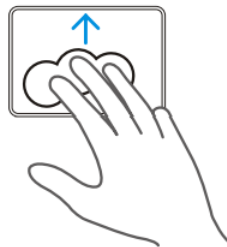

Four fingers



Screenshot: Tap with four fingers



Notice:

- Operating system: iOS 13.4 and above (equipment must support touch)
- Custom settings (when wireless pairing is successful): Setting AccessibilityTouch-Assistive Touch-Devices

Connected devices Customize additional buttons-Set the action on the touchpad Select instruction

-  +  Turn on / off touchpad function

Documents / Resources

	<p>Targus THZ621US VersaType 4-in-1 Keyboard Case [pdf] User Manual 000119, OXM000119, THZ621US, VersaType 4-in-1 Keyboard Case, THZ621US VersaType 4-in-1 Keyboard Case, 4-in-1 Keyboard Case, Keyboard Case</p>
---	---

References

-  [Targus | Backpacks, Docking Stations & Computer Accessories](#)