



# Target 121105 Corona Vision Dartboard Lighting Instruction Manual

[Home](#) » [Target](#) » Target 121105 Corona Vision Dartboard Lighting Instruction Manual 

## Contents

- [1 Target 121105 Corona Vision Dartboard Lighting](#)
- [2 INTRODUCTION](#)
- [3 SPECIFICATIONS](#)
- [4 WHAT'S IN THE BOX](#)
- [5 ASSEMBLY INSTRUCTIONS](#)
- [6 FEATURES](#)
- [7 SETUP GUIDE](#)
- [8 CARE & MAINTENANCE](#)
- [9 TROUBLESHOOTING](#)
- [10 PROS & CONS](#)
- [11 WARRANTY](#)
- [12 FREQUENTLY ASKED QUESTIONS](#)
- [13 VIDEO – PRODUCT OVERVIEW](#)
- [14 References](#)



**Target 121105 Corona Vision Dartboard Lighting**



## INTRODUCTION

For dart players who want to improve their gaming experience, the Target 121105 Corona Vision Dartboard Lighting system is an absolute need. With 123 integrated LED lights, this creative lighting system guarantees shadow-free illumination, creating a steady, bright, and high-end playing atmosphere. Without the need for extra equipment, users may quickly and easily attach the system to their dartboard thanks to the magnetic feet. Target Darts, a reputable brand in dart accessories, produces the well-made Target Corona Vision Lighting System, which retails for **\$57.99**. It was introduced in 2024 and is a versatile and necessary addition to any game room because it is made to work with all common dartboards. This robust yet lightweight system, which weighs 1.9 kg and has a width of 26.97 inches, provides excellent lighting performance for both amateur and professional players.

## SPECIFICATIONS

Price	\$57.99
Brand	TARGET
Color	Black with White LEDs
Product Dimensions	26.97" W x 2.36" H
Item Weight	1.9 Kilograms
Installation	Magnetic feet for quick and easy attachment; no additional tools required
Lighting System	360-degree LED illumination with 123 built-in LEDs; ensures shadowless lighting
Compatibility	Fits all dartboards, including cabinet sets, surrounds, and professional setups
Durability	Constructed with robust materials to withstand direct hits from stray darts
Warranty	12-month warranty covering issues or defects
Power Source	Requires 1 A battery (not included)
Item Thickness	2 inches
Model Number	121105

WHAT’S IN THE BOX

- 1X LIGHT RING
- 2X LEGS W/ CABLE CLIP (LEG A) 2X LEGS (LEG BI
- 4X PLUG ADAPTERS
- 1X TRANSFORMER

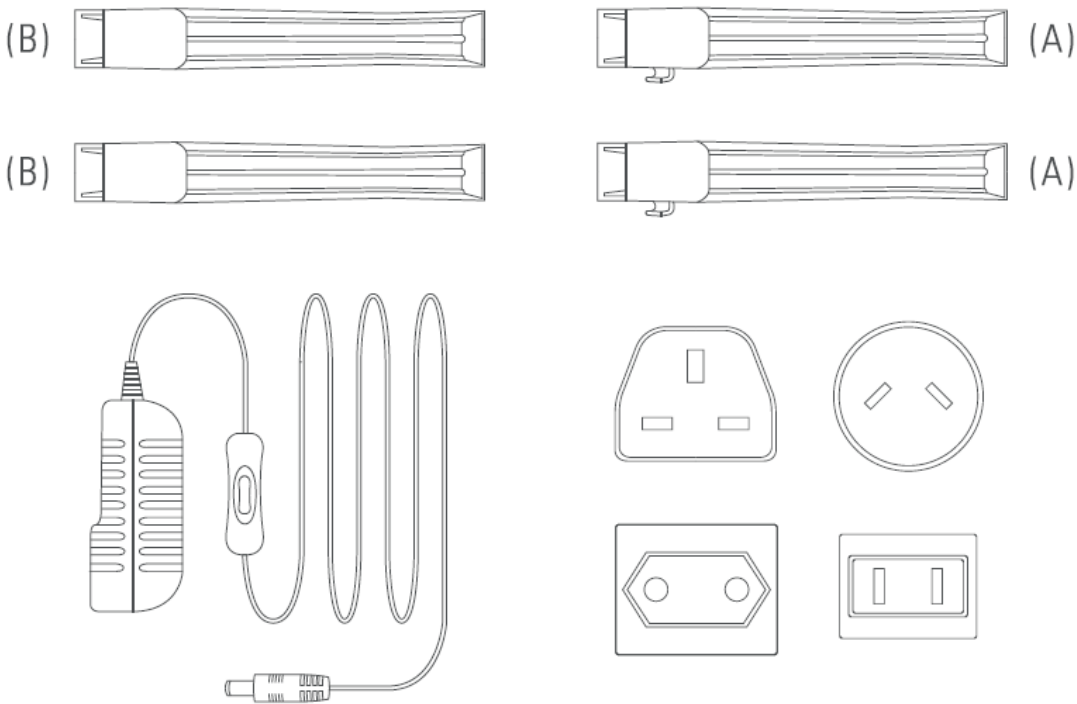

ASSEMBLY INSTRUCTIONS

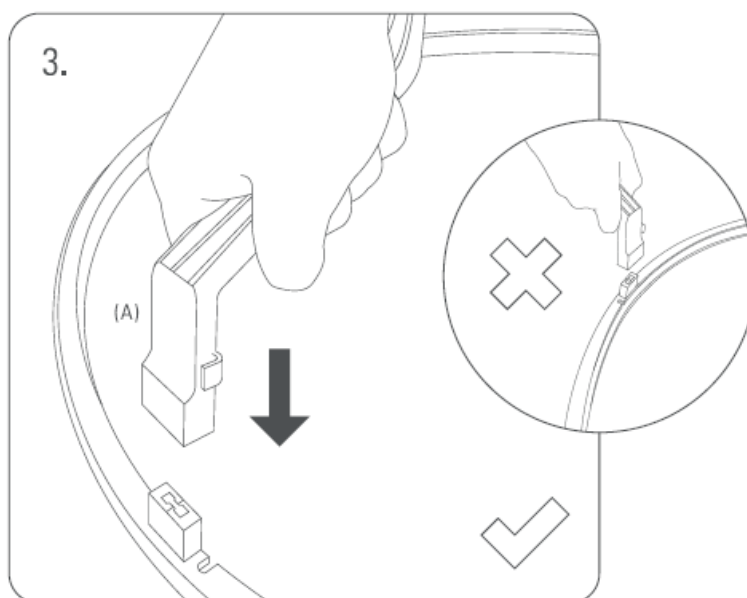
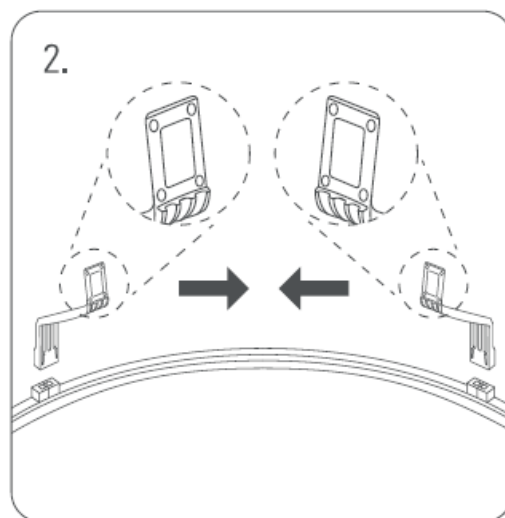
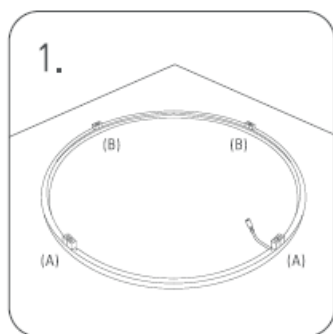

1. PLACE LIGHT RING ON A FLAT SURFACE
2. ENSURE MAGNETS FACE CENTER

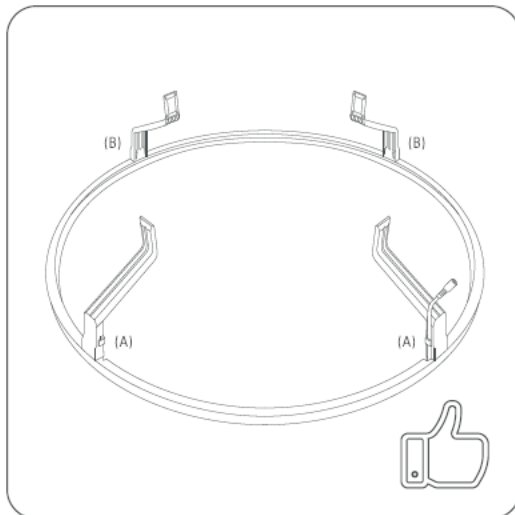
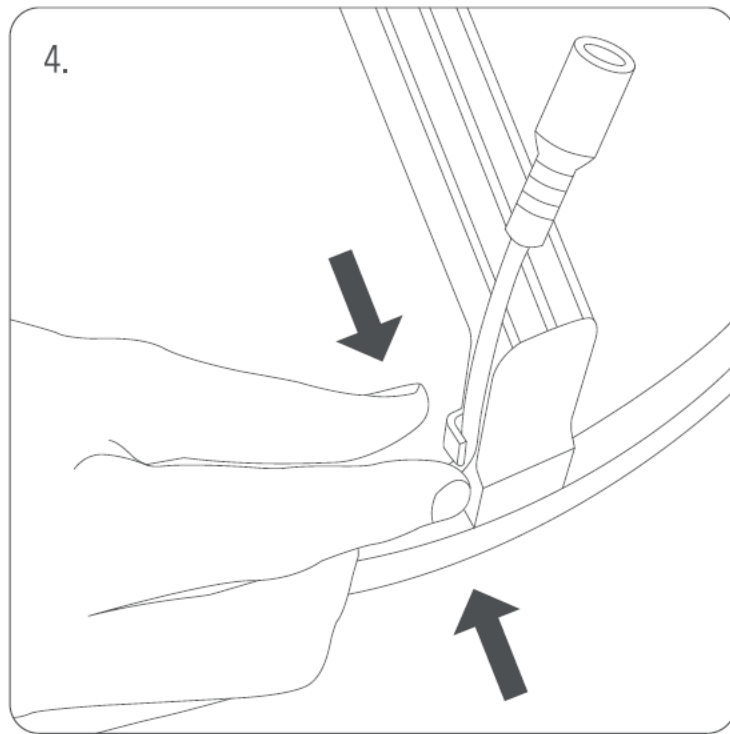

**WARNING!**

- DO NOT ATTEMPT TO REMOVE ONCE LOCKED

**For Use Without Surround**

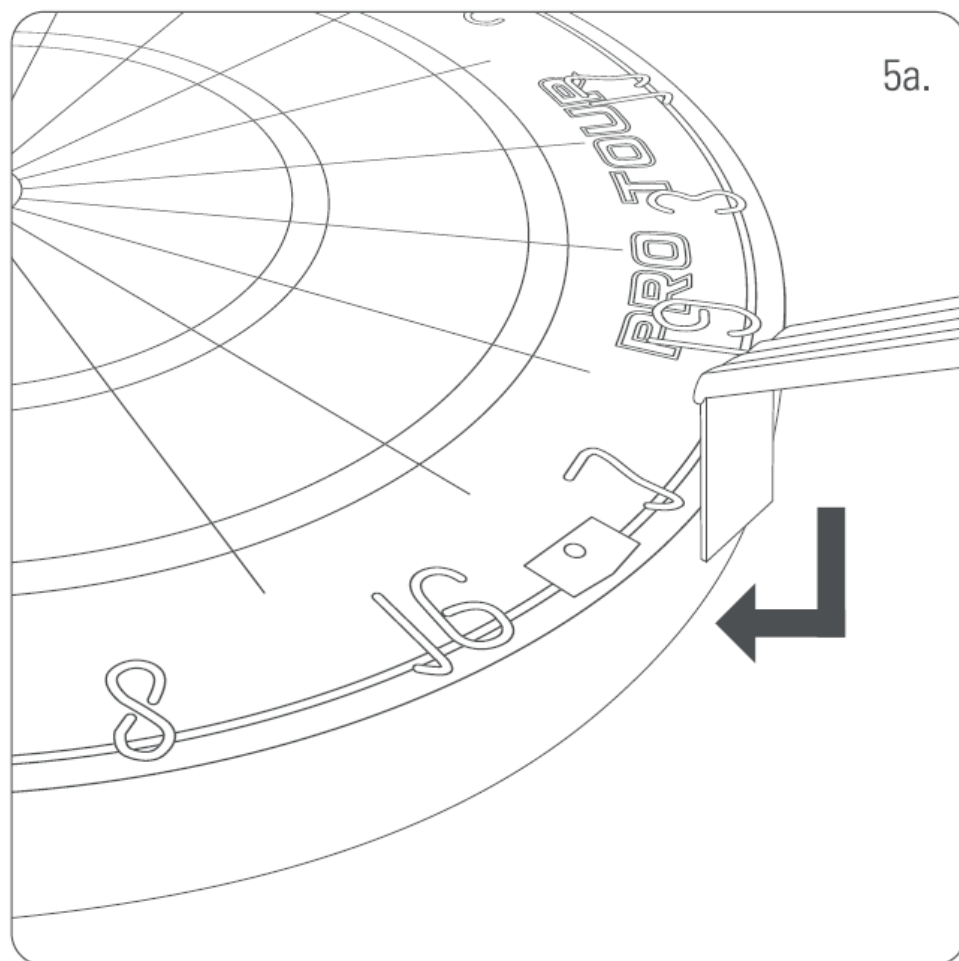
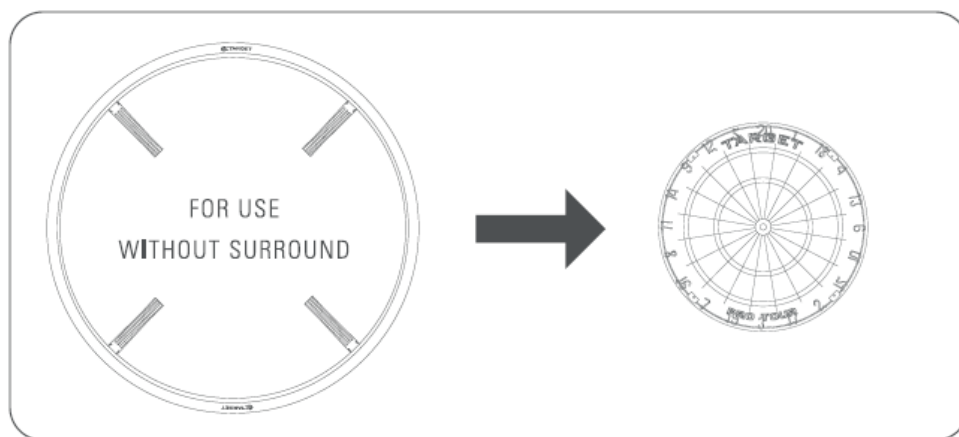

**For Use With Surround**

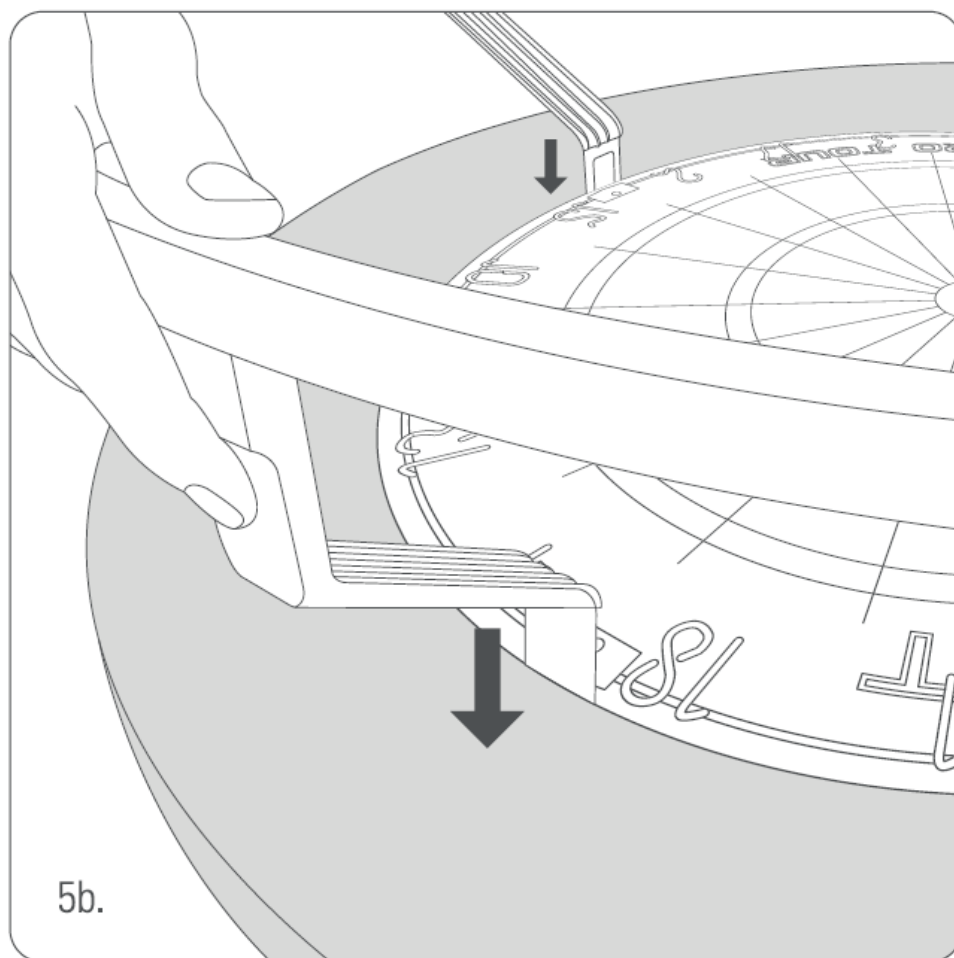
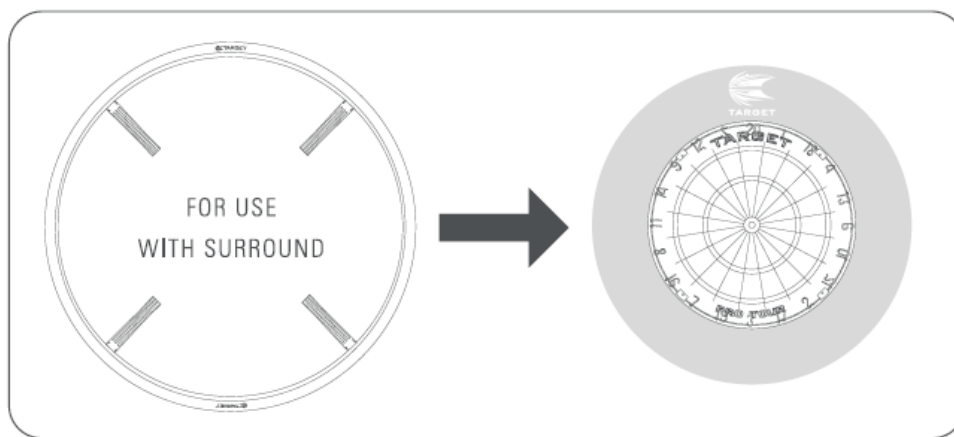

**Complete**

6.

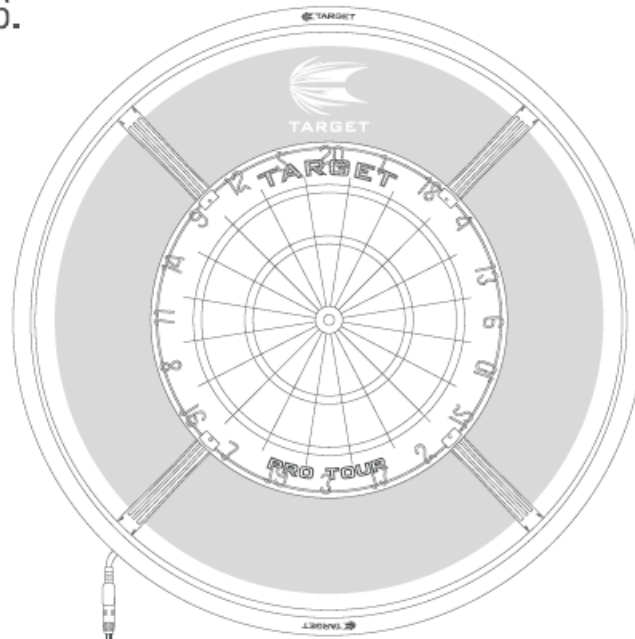

## FEATURES

- **123 Integrated LED Lights:** Provides shadowless illumination for improved vision.



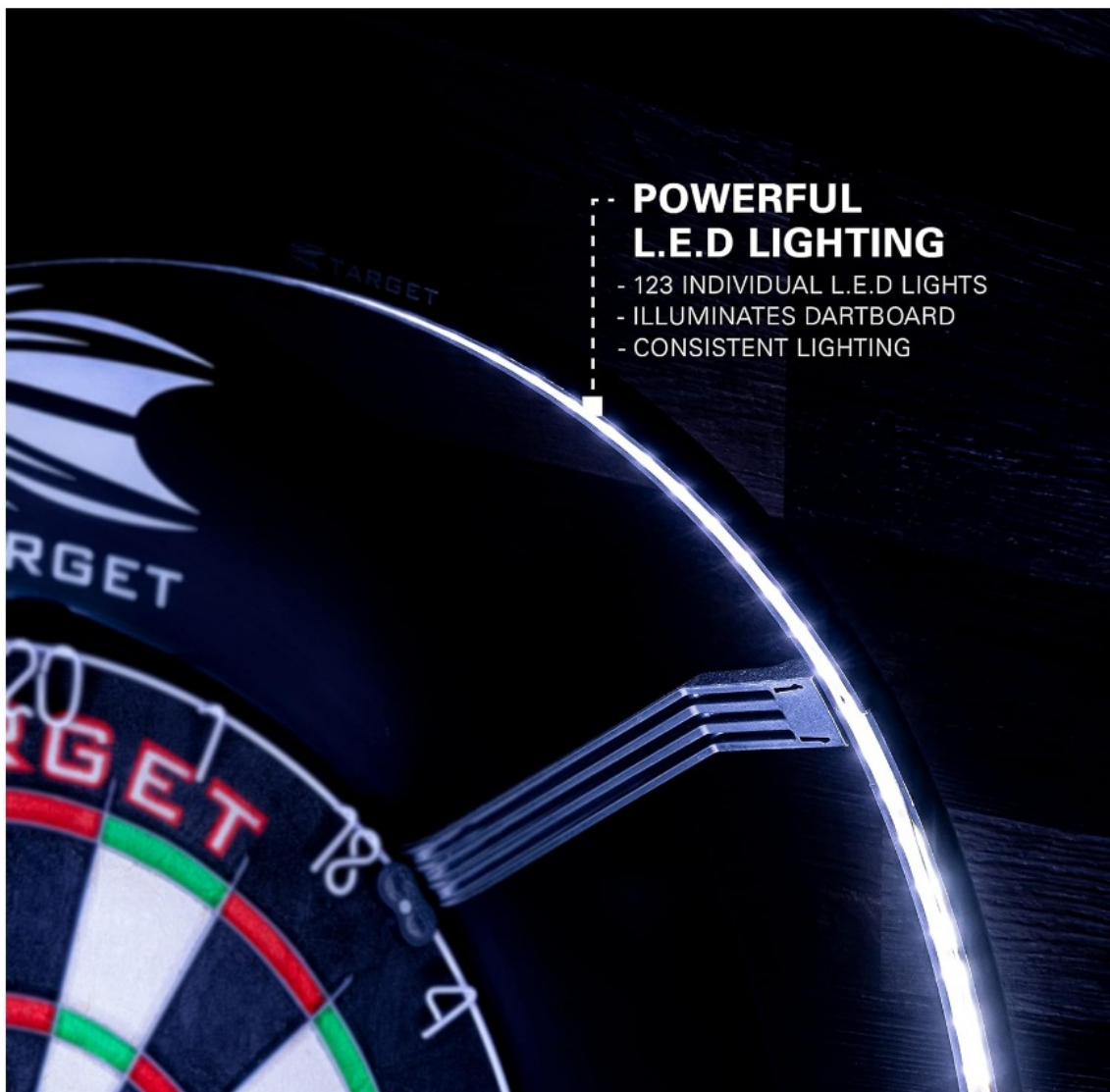

- **360° Consistent Lighting:** The dartboard's entire surface is evenly lit due to the circular LED design.
- **Magnetic Feet for Simple Attachment:** No extra tools needed, securely fastens to the dartboard in seconds.
- **Installation Without a Tool:** No difficult assembly or screws required.
- **Most Dartboards Can Use It:** It is Compatible with various electronic and bristle dartboards.
- **Strong and Lightweight:** It weighs 1.9 kg, ensuring durability and easy handling.
- **Sleek Black Design:** Enhances any dart setup with a stylish black frame and white LEDs.
- **Perfect for Any Type of Lighting:** Performs well in both well-lit and dim spaces.
- **Low Power Consumption:** Energy-efficient LEDs reduce electricity usage.
- **Compact Size:** Measures 26.97"W x 2.36"H, discreet yet functional.
- **2-Inch Thickness:** Modern, space-saving design.
- **Battery Operated Option:** Some features may require a single AA battery.
- **Professional Endorsements:** Used by players in professional dart tournaments.
- **Durable Build Quality:** High-quality materials ensure long-lasting performance.
- **12-Month Warranty:** Comes with a one-year warranty for added reliability and support.



## SETUP GUIDE

- **Unpack Carefully:** Remove the light ring and any attachments from the package.
- **Verify Every Component:** Ensure all parts are present and in good condition.
- **Select the Installation Location:** Position your dartboard in a stable area before installation.
- **Align the Magnetic Feet:** Place the lighting system's magnetic feet near the dartboard frame.
- **Attach to the Dartboard:** Gently press the Corona Vision light onto the dartboard frame for a snug fit.
- **Verify Correct Alignment:** Ensure the ring is evenly positioned for steady illumination.
- **Connect to Power:** Plug in the lighting system using the proper adapter if needed.
- **Turn on the LED Lights:** Check for issues or uneven brightness.
- **Adjust as Needed:** Slightly move the light ring to achieve the perfect illumination angle.
- **Verify Stability:** Ensure the magnetic attachment is firm to prevent movement during play.
- **Test Under Various Lighting Conditions:** Check visibility in both bright and dim environments.
- **Take a Few Test Throws:** Identify and eliminate any unwanted shadows.
- **Secure Any Loose Cables:** Arrange power cables to prevent trip hazards.
- **Verify Power Efficiency:** If using batteries, ensure they are fully charged or replace them as needed.
- **Experience Improved Gameplay:** Start playing darts with professional-grade lighting for better accuracy!

## CARE & MAINTENANCE

- **Clean Frequently:** Use a soft, dry cloth to remove dust and dirt from the LED ring.
- **Steer Clear of Harsh Chemicals:** Avoid strong cleaners that may damage the material.
- **Avoid Moisture:** Store in a dry place to prevent electrical damage.
- **Verify LED Function:** Regularly check each LED for uniform lighting.
- **Examine Magnetic Feet:** Ensure the magnetic attachment remains strong and intact.
- **Avoid Too Much Sunlight:** Prolonged direct sunlight can reduce LED lifespan.
- **Store Properly When Not in Use:** Keep in a protective case to prevent scratches.
- **Prevent Physical Damage:** Handle with care to avoid drops or collisions.
- **Ensure Secure Plug-In:** Power cords should be properly connected and undamaged.
- **Monitor Battery Health:** Replace weak or expired batteries promptly for optimal performance.
- **Never Use More Voltage Than Recommended:** Stick to a 5V power source if applicable.
- **Mount on a Secure Dartboard:** Avoid attaching to an unstable surface.
- **Check for Loose Parts:** Regularly inspect for any loose fittings or screws.
- **Turn Off When Not in Use:** Prolongs LED lifespan and conserves battery power.
- **Use Under Proper Conditions:** Maintain in a room with normal temperature and humidity.

## TROUBLESHOOTING

Issue	Possible Cause	Solution
Lights not turning on	Battery drained or not installed	Replace the battery and try again
Flickering lights	Loose connection or low power	Ensure a secure connection and use a fresh battery
Shadows appearing on board	Improper positioning	Adjust the angle for better illumination
LEDs not evenly bright	Dust accumulation on LEDs	Clean the LED surface with a dry cloth
Light turning off randomly	Auto shut-off feature triggered	Check user settings and adjust accordingly
Difficulty attaching to board	Misaligned magnetic feet	Realign and press firmly for secure attachment
Not bright enough	High room lighting interference	Use in a dimmer environment for best results
Mounting feels unstable	Weak magnetic grip	Ensure a flat surface and realign for stability
Buzzing sound from LEDs	Electrical interference	Try using a different power source or location
Remote control not responding	Weak remote battery	Replace remote battery and ensure direct line of sight

## PROS & CONS

### Pros:

1. **Quick & Easy Installation** – Magnetic feet ensure a hassle-free setup.
2. **Shadow-Free Lighting** – 123 LED lights provide consistent brightness.

3. **Professional Endorsement** – Used by competitive players.
4. **Durable & Lightweight** – Sturdy build without excessive weight.
5. **Universal Compatibility** – Works with most dartboards.

#### Cons:

1. **Requires Power Source** – Needs an A battery to operate.
2. **Not Wireless** – Must remain plugged in for continuous use.
3. **Fixed Light Color** – No RGB or customizable options.
4. **May Require Repositioning** – Some users might need to adjust placement for optimal lighting.
5. **Higher Price Tag** – More expensive than standard dartboard lights.

## WARRANTY

The Target 121105 Corona Vision Dartboard Lighting system comes with a **12-month** manufacturer warranty, covering defects and malfunctions. Warranty claims require proof of purchase and do not cover accidental damage, battery issues, or modifications. Customers can contact Target Darts support for assistance.

- TARGET SPORTS LTD. ELYSIAN HOUSE LOVET ROAD HARLOW CM19 5TB
- +44(0)1279 410155
- [INFO@TARGET-DARTS.CO.UK](mailto:INFO@TARGET-DARTS.CO.UK)
- [WWW.TARGET-DARTS.CO.UK](http://WWW.TARGET-DARTS.CO.UK)

## FREQUENTLY ASKED QUESTIONS

How does the Target 121105 Corona Vision Dartboard Lighting System attach to a dartboard?

The system uses magnetic feet for tool-free, hassle-free installation, allowing quick and secure attachment to your dartboard within seconds.

What is the weight and size of the Target 121105 Corona Vision Dartboard Lighting System?

The Corona Vision measures 26.97 wide and 2.36 high, with a weight of 1.9 kilograms, ensuring a stable and well-balanced setup.

What power source does the Target 121105 Corona Vision Dartboard Lighting System use?

It requires 1 A battery and also works with a power adapter for continuous operation.

Why is my Target 121105 Corona Vision Dartboard Lighting System not turning on?

Ensure the A battery is properly installed, or if using an adapter, check that the power connection is secure. Try replacing the battery or testing with a different power source.

Why is my Target 121105 Corona Vision Dartboard Lighting flickering?

Flickering can occur due to a low battery or power fluctuations. Try replacing the battery or using a different power source to see if the problem resolves.

How can I fix uneven lighting from the Target 121105 Corona Vision Dartboard Light?

Ensure the magnetic feet are securely attached and the ring is evenly aligned around the dartboard to provide proper shadowless illumination.

Can the Target 121105 Corona Vision Dartboard Lighting System be used with any dartboard?

The Corona Vision is compatible with most dartboards, including bristle and electronic boards, making it versatile for different setups.

## VIDEO – PRODUCT OVERVIEW

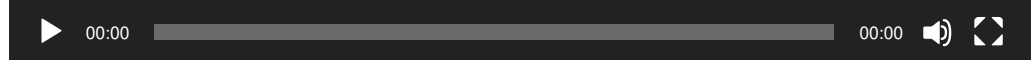

[Download the PDF link Target 121105 Corona Vision Dartboard Lighting Instruction Manual Vision-Dartboard-Lighting-Instruction-Manual.mp4](#)

## References

- [User Manual](#)

[Manuals+](#), [Privacy Policy](#)

This website is an independent publication and is neither affiliated with nor endorsed by any of the trademark owners. The "Bluetooth®" word mark and logos are registered trademarks owned by Bluetooth SIG, Inc. The "Wi-Fi®" word mark and logos are registered trademarks owned by the Wi-Fi Alliance. Any use of these marks on this website does not imply any affiliation with or endorsement.