

tapo
RV30 Max
Plus Robot
Vacuum
and Mop



tapo RV30 Max Plus Robot Vacuum and Mop User Manual

[Home](#) » [tapo](#) » tapo RV30 Max Plus Robot Vacuum and Mop User Manual 

Contents

- [1 tapo RV30 Max Plus Robot Vacuum and Mop](#)
- [2 Product Information](#)
- [3 Product Usage Instructions](#)
- [4 Overview](#)
- [5 HOW TO USE](#)
- [6 Connect to Wi-Fi](#)
- [7 Safety Information](#)
- [8 Documents / Resources](#)
 - [8.1 References](#)
- [9 Related Posts](#)

tapo

tapo RV30 Max Plus Robot Vacuum and Mop



Product Information

Specifications

- **Type:** Robot Vacuum & Mop
- **Brand:** Tapo
- **Power Source:** Dock
- **Connectivity:** Wi-Fi

Product Usage Instructions

Position the Dock

Place the dock on a level surface, flat against a wall, without obstacles within 1.5m (4.9ft) in front and 0.5m (1.6ft) on the left and right. Connect the power cord to the dock and power source. Keep the cable tidy.

Remove Protective Strip

Remove the protective strips on both sides of the front bumper.

Turn On Robot Vacuum

Press and hold for 3 seconds to turn on the robot vacuum. You will hear either “Turning On” or a beep, indicating a successful power-on.

Remove Protective Film

Remove the protective film on the front bumper.

Power On and Charge

Place the robot vacuum on the charging dock or tap to send it back to the dock to charge. It will return to the dock at the end of a cleaning job and whenever it needs to recharge.

Download the Tapo App and Connect to Wi-Fi

1. Download the Tapo app from the App Store or Google Play, then log in.
2. Open the Tapo app, tap the + icon, and select your model. Follow the step-by-step instructions to easily set up your robot vacuum.

Frequently Asked Questions (FAQ)

Q: Where can I find troubleshooting and voice prompts for issues?

A: You can find troubleshooting and voice prompts for issues at [thislink](#).

Need some help?

Visit www.tapo.com/support/ for technical support, user guides, FAQs, warranty & more



Setup Videos

Scan QR code or visit

<https://www.tp-link.com/support/setup-video/#robot-vacuum>



Overview

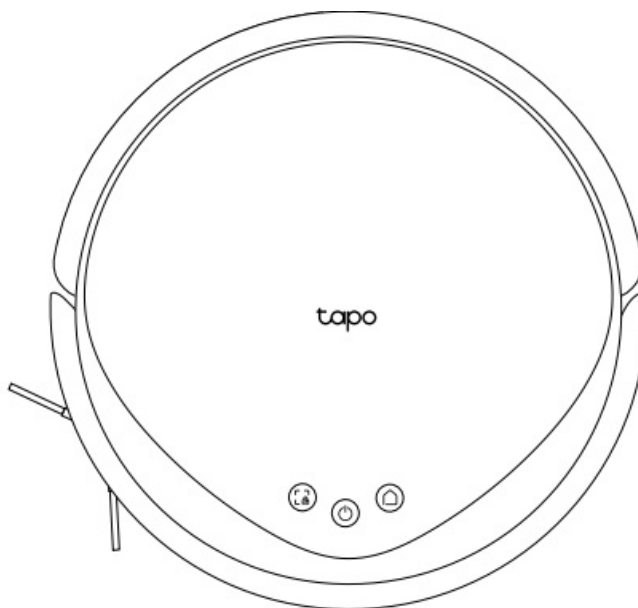

Power/Clean

- Press once: Start/pause cleaning.
- Press and hold for 3 seconds: Turn on/off the robot vacuum.



Dock

- Return to the dock to charge.

- (For Plus Series) Empty the bin when docked.



Spot Cleaning/Child Lock

- Press once: Start spot cleaning.
- Press and hold for 5 seconds: Turn on/off the child lock.

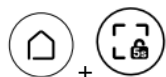

Combination Button

- Press and hold simultaneously for 5 seconds:
Enter setup mode to configure network.
- Press and hold simultaneously for 10 seconds:
Restore to factory default settings.



LED

- **Red:** Battery level < 20%; Error
- **Orange:** Battery level between 20% and 80%
- **Green:** Battery level > 80%

HOW TO USE

Position the Dock

Place the dock on a level surface, flat against a wall, without obstacles within 1.5m (4.9ft) in front and 0.5m (1.6ft) on left and right. Connect the power cord to the dock and power source. Keep the cable tidy.

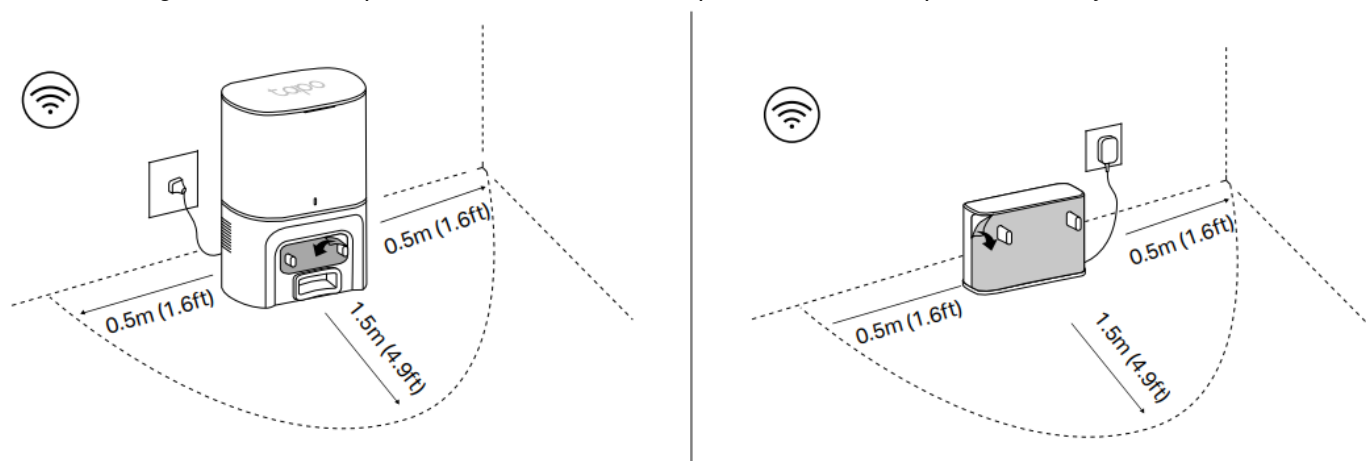

Notes

- To ensure a better user experience, make sure the area is with good Wi-Fi signal.
- Do not place it in direct sunlight. Ensure the area around the dock is free of clutter to improve docking performance.
- Always keep the dock powered on, otherwise the robot vacuum will not automatically return. And do not move

the dock frequently.

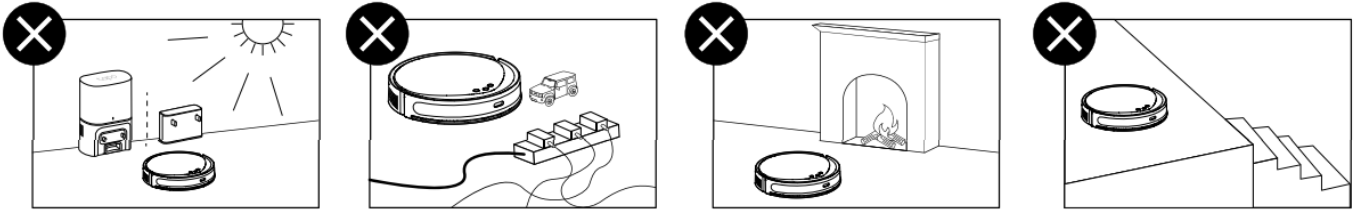

Remove Protective Strip

Remove the protective strips on both sides of the front bumper.

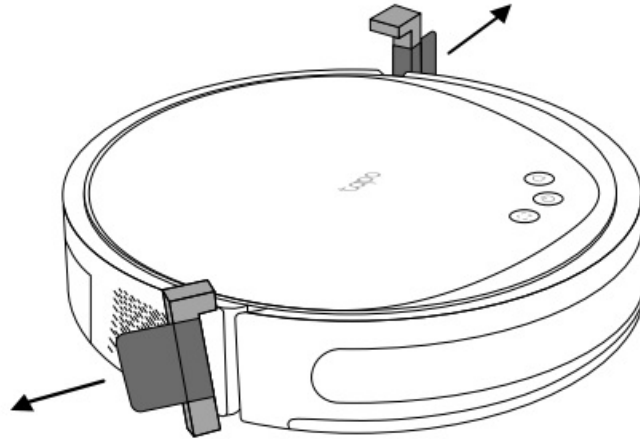

Remove Protective Film

Remove the protective film on the front bumper.

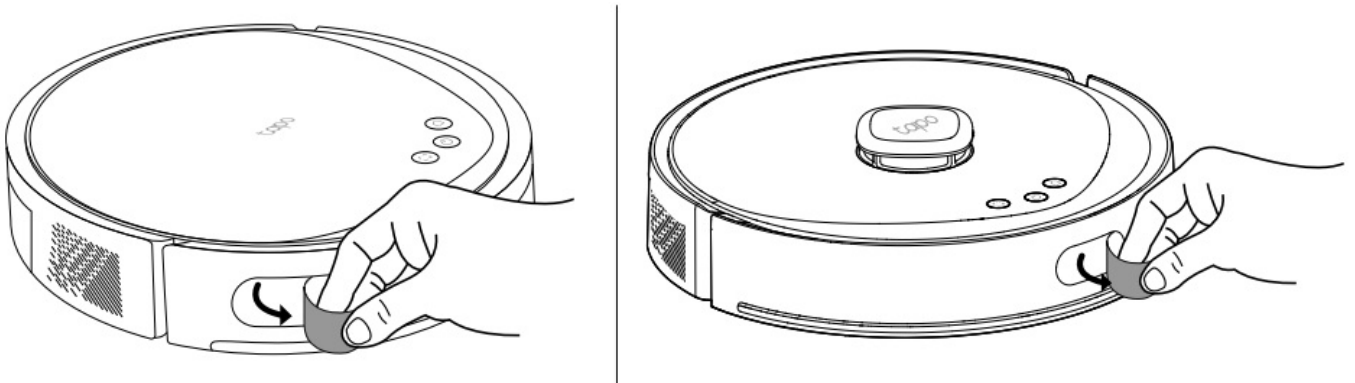

Turn On Robot Vacuum

Press and hold for 3 seconds to turn on the robot vacuum. You will hear either “Turning On” or a beep, indicating a successful power-on.

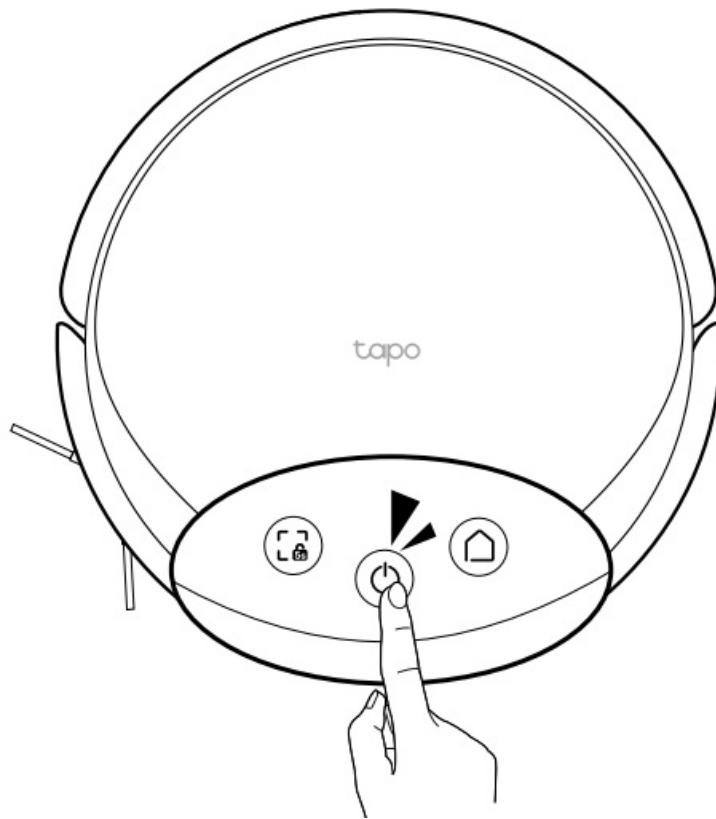

Power On and Charge

Place the robot vacuum on the charging dock or tap to send it back to the dock to charge. It will return to the dock at the end of a cleaning job and whenever it needs to recharge.

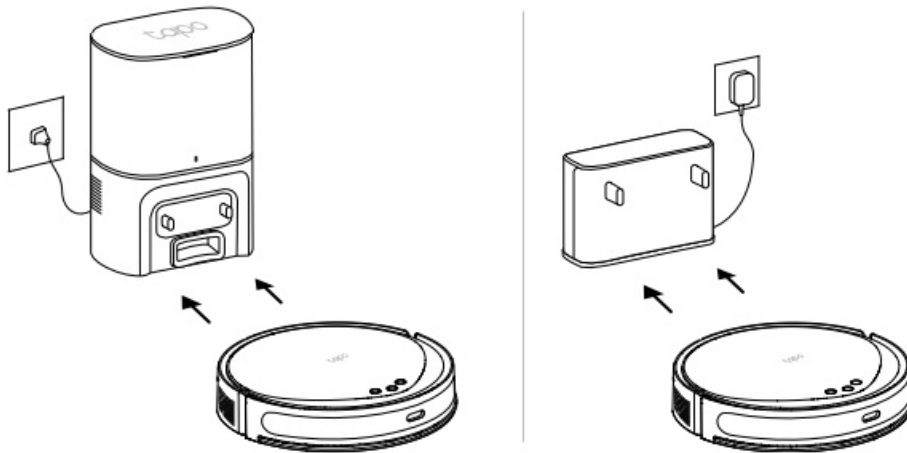

Notes

- When the LED of the charging dock flashes 3 times and then goes out, the charging will begin.
- We recommend that you charge the robot vacuum fully for about 4 hours prior to starting the first cleaning job.

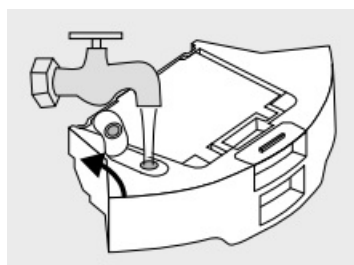

- To prevent corrosion, do NOT add any cleaning agents.
- WIPE the water tank dry after adding water.

Connect to Wi-Fi

Download the Tapo App and Connect to Wi-Fi

1. Download the Tapo app from the App Store or Google Play, then log in.



2. Open the Tapo app, tap + icon, and select your model.
Follow the step-by-step instructions to easily set up your robot vacuum.

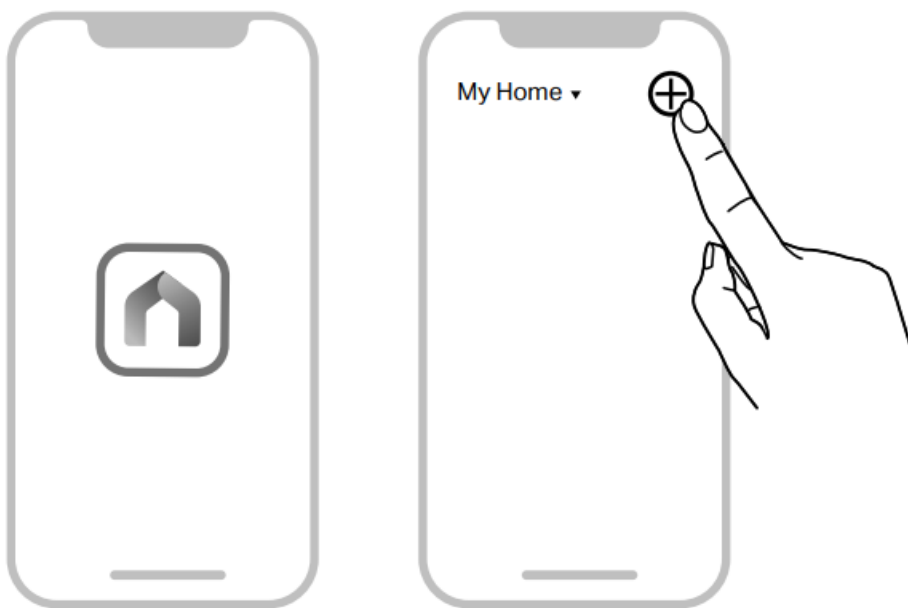

Troubleshooting & Voice Prompts for Issues:

<https://www.tp-link.com/support/faq/3525/>

For Robot Vacuum:

TP-Link hereby declares that the device is in compliance with the essential requirements and other relevant provisions of directives 2014/53/EU, 2009/125/EC, 2011/65/EU and (EU)2015/863.

The original EU Declaration of Conformity may be found at <https://www.tapo.com/support/ce/>.

TP-Link hereby declares that the device is in compliance with the essential requirements and other relevant provisions of the Radio Equipment Regulations 2017.

The original UK Declaration of Conformity may be found at <https://www.tapo.com/support/ukca/>

For Auto-Empty Dock / Battery:

TP-Link hereby declares that the device is in compliance with the essential requirements and other relevant provisions of directives 2014/30/EU, 2014/35/EU, 2009/125/EC, 2011/65/EU and (EU)2015/863. The original EU declaration of conformity may be found at <https://www.tapo.com/en/support/ce/>

TP-Link hereby declares that the device is in compliance with the essential requirements and other relevant

provisions of the Electromagnetic Compatibility Regulations 2016 and Electrical Equipment (Safety) Regulations 2016. The original UK declaration of conformity may be found at <https://www.tapo.com/support/ukca/>

Safety Information

- Keep the device away from water, fire, humidity or hot environments.
- Do not attempt to disassemble, repair, or modify the device. If you need service, please contact us.
- If the supply cord is damaged, it must be replaced by the manufacturer, its service agent or similarly qualified persons in order to avoid a hazard.

Warning

Avoid replacement of a battery with an incorrect type that can defeat a safeguard. Avoid disposal of a battery into fire or a hot oven, or mechanically crushing or cutting of a battery, that can result in an explosion. Do not leave a battery in an extremely high temperature surrounding environment that can result in an explosion or the leakage of flammable liquid or gas; Do not leave a battery subjected to extremely low air pressure that may result in an explosion or the leakage of flammable liquid or gas.

The instructions shall state the substance of the following:

This appliance is not intended for use by persons (including children) with reduced physical, sensory or mental capabilities, or lack of experience and knowledge, unless they have been given supervision or instruction concerning use of the appliance by a person responsible for their safety.

Children should be supervised to ensure that they do not play with the appliance.

The appliance is only to be used with the power supply unit provided with the appliance.

WARNING: For the purposes of recharging the battery, only use the detachable supply unit provided with this appliance.

The appliance contains a 2600mAh lithium-ion battery.

This appliance can be used by children aged from 8 years and above and persons with reduced physical, sensory or mental capabilities or lack of experience and knowledge if they have been given supervision or instruction concerning use of the appliance in a safe way and understand the hazards involved. Children shall not play with the appliance. Cleaning and user maintenance shall not be made by children without supervision.

Operating Frequency/max output power

No restrictions exist in the use of radio frequencies or frequency bands in all EU member states, EFTA countries, Northern Ireland and Great Britain.

Documents / Resources

	tapo RV30 Max Plus Robot Vacuum and Mop [pdf] User Manual RV30 Max Plus Robot Vacuum and Mop, RV30 Max Plus, Robot Vacuum and Mop, Vacuum and Mop, and Mop, Mop
---	--

References

-  [Anatel — Agência Nacional de Telecomunicações](#)
-  [Regulatory Compliance | Tapo](#)
-  [Regulatory Compliance | Tapo](#)
-  [UKCA | Tapo](#)
-  [Support Videos | TP-Link](#)

- [User Manual](#)

[Manuals+](#), [Privacy Policy](#)

This website is an independent publication and is neither affiliated with nor endorsed by any of the trademark owners. The "Bluetooth®" word mark and logos are registered trademarks owned by Bluetooth SIG, Inc. The "Wi-Fi®" word mark and logos are registered trademarks owned by the Wi-Fi Alliance. Any use of these marks on this website does not imply any affiliation with or endorsement.