



TAOTRONICS TT-DL038 LED Desk Lamp User Guide

[Home](#) » [TaoTronics](#) » TAOTRONICS TT-DL038 LED Desk Lamp User Guide 



MODEL: TT-DL038
LED DESK LAMP
User Guide

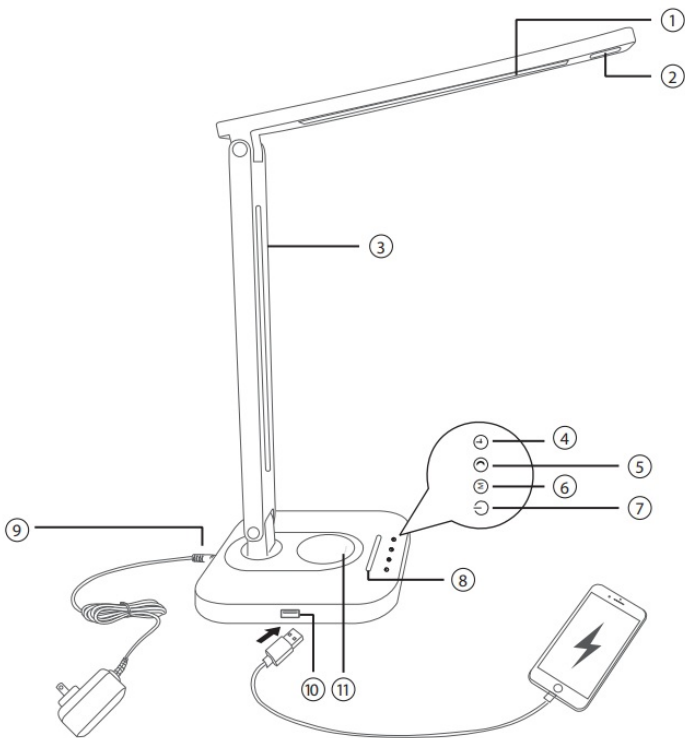

Contents

- [1 Product Diagram](#)
- [2 Specifications](#)
- [3 FCC Compliance](#)
- [4 Documents / Resources](#)
- [5 Related Posts](#)

Product Diagram

1. Main Light 2. Night Light 3. Lamp Arm 4. Timer Button 5. Night Light Button 6. Mode Button – Color Temperature	7. Power Button 8. Brightness Slider 9. Power Port 10. USB Output Port 11. Wireless Charger
--	---

Specifications

Model	TT-DL038
CRI	>80Ra
Operating Voltage	DC 10V/3A
Power(Only for the Light)	12W
USB Output	DC 5V/1A
Wireless Charger Output	10W Max
Lumens	400lm
Operating Temperature	-20°C— 40°C 1-4°F —104°F
Color Temperature	2700-3000K(1), 4000K±200K(2), 4500K±200K(3) 5000 K±300K(4) 6000-6500K(5)

How to Use

Use the included power adapter to connect to a power source, the lamp is now in standby mode and the Power Button indicator will light up.

Power On / Of the Main Light

- In standby mode, tap the Power Button once to turn on the main light. All the button indicators will light up.
- Tap again to turn off the main light, only the power indicator will remain on.

Adjust the Color Temperature

- The lamp will enter warm light mode by default when turned on. Tap the Mode Button to cycle through 5 color temperature modes.

Adjust the Brightness

- The lamp will enter the 3rd level brightness by default when turned on. Slide across the Brightness Slider to adjust the light brightness, the brightness indicator will light up accordingly.

Set the Timer

- Tap the Timer Button once to set a one-hour timer for the main light and night light, the timer indicator will blink to start the countdown. Tap again to exit the timer.

Night Light

- Tap the Night Light Button to activate the night light, the main light will turn off. All button indicators (except the night light and power indicator) will turn off.
- Tap one more time to turn off the night light.

Memory Function

- With power connected, the lamp will resume the color temperature and brightness of the last use when turned on.

Note: We suggest you set to a low brightness level before turning the lamp off to prevent glares when you turn the light on again.

USB Port

Charge your smartphone, tablet, e-reader, or any USB device through the 5V/1A USB port.

Wireless Charger

- Place your phone with Qi-BPP compatibility on the wireless charging station to automatically start charging.
- The charger supports 7.5W wireless charging for the newest iPhone X / 8 Plus / 8 in iOS 11.2 or above and 10W fast charging to selected Samsung Galaxy, Google Nexus, or Microsoft Lumia phones.

Note:

If charging does not occur, adjust the phone so its receiver can be detected. Please note that different model phones have their receivers in different positions.

Caution

- Please hold the lamp parts accordingly when adjusting the angle of the lamp head and arm.
- Please adjust the lamp within the allowed angle. Do not use excessive force to avoid damages to the product.

NOTE: This device complies with Part 15 &18 of the FCC Rules. Operation is subject to the following two conditions:

(1) This device may not cause harmful interference, and (2) This device must accept any interference received, including interference that may cause undesired operation.

However, there is no guarantee that interference will not occur in a particular installation. If this equipment does cause harmful interference to radio or television reception, which can be determined by turning the equipment off and on, the user is encouraged to try to correct the interference by one or more of the following measures:

- Reorient or relocate the receiving antenna.
- Increase the separation between the equipment and receiver.
- Connect the equipment into an outlet on a circuit different from that to which the receiver is connected.
- Consult the dealer or an experienced radio/TV technician for help

Changes or modifications not expressly approved by the party responsible for compliance could void the user's authority to operate the equipment. RF Exposure Warning Statements:

This equipment complies with FCC radiation exposure limits set forth for an uncontrolled environment. This equipment shall be installed and operated with a minimum distance of 20cm between the radiator & body.

FCC Compliance

This device complies with Part 15 &18 of the FCC Rules. Operation is subject to the following two conditions: (1) This device may not cause harmful interference, and (2) This device must accept any interference received, including interference that may cause undesired operation.

WEEE Compliance

Correct Disposal of This Product (Waste Electrical & Electronic Equipment) (Applicable in countries with separate collection systems) This marking on the product, accessories, or literature indicates that the product and its electronic accessories should not be disposed of with other household waste at the end of their working life. To prevent possible harm to the environment or human health from uncontrolled waste disposal, please separate these items from other types of waste and recycle them responsibly to promote the sustainable reuse of material resources. Household users should contact either the retailer where they purchased this product, or their local government office, for details of where and how they can take these items for environmentally safe recycling. Business users should contact their suppliers and check the terms and conditions of the purchase contract. This product and its electronic accessories should not be mixed with other commercial wastes for disposal.

Learn more about the EU Declaration of Conformity: <https://www.taotronics.com/downloads-TT-DL038-CE-Cert.html>



NORTH AMERICA

E-mail: support@taotronics.com(US)

support.ca@taotronics.com(CA)

Tel 03-5542-0238

US Distributor: SUNVALLEYTEK INTERNATIONAL INC.

Address:46724 Lakeview Blvd, Fremont, CA 94538

MANUFACTURER

Manufacturer: Shenzhen NearbyExpress Technology Development Co., Ltd.

Address: 333 Bulong Road, Shenzhen, China, 518129

MADE IN CHINA



Documents / Resources

	TAOTRONICS TT-DL038 LED Desk Lamp [pdf] User Guide TT-DL038 LED Desk Lamp, TT-DL038, LED Desk Lamp, Desk Lamp, LED Lamp
---	--