



## TALA TBL01 Multi Functional Table Lamp Instruction Manual

[Home](#) » [TALA](#) » TALA TBL01 Multi Functional Table Lamp Instruction Manual 

### Contents

- [1 TALA TBL01 Multi Functional Table Lamp](#)
- [2 Multi-functional Table Lamp Instruction Manual](#)
- [3 Specifications](#)
- [4 UNDERSTANDING THE PRODUCT](#)
- [5 TECHNICAL SUPPORT &WARRANTY](#)
- [6 Documents / Resources](#)
- [7 Related Posts](#)



## TALA TBL01 Multi Functional Table Lamp



### Multi-functional Table Lamp Instruction Manual

Thank you for purchasing the Multi-functional Table Lamp.

Your lamp comes with multiple functions. Please familiarize yourself with the features by reading the manual carefully.

#### **Important::**

1. Please read the user manual thoroughly before using your table lamp.
2. Please keep the user manual well for a good after-sale service.
3. Technical support and after-sales service contact Email: [lampsc1106@outlook.com](mailto:lampsc1106@outlook.com)

### Specifications

**Name:** Multi-functional Table Lamp

**Model:** TBL01

**Weight:** 950g

**Color:** Black

**Dimensions:** (L \*W\*H): 170\*170\*315mm

**Packing Dimensions(L \*W\*H):** 225\*198\*395mm

**Luminous Flux Range:** 30-600 l'm

**Color temperature Range:** 2700-6000K 7 modes

**Brightness Range:** 5%-100% 7 levels

**Color rendering index:** Ra>95

**Input Power:** LED 10w/Wireless charging 10w

**Adapter Input Voltage:** AC100-240V 50/60HZ

**Adapter Output :** DC 12V 2A

**Wireless charging standard:** Qi 2.0

**Wireless charger output:** 9V 1A Max

**Working temperature:** -25 – 65 'C

**Life Span:** 50000 h

#### **Package Content:**

Table lamp x1

Power adapterx1

Clean cloth x1

## UNDERSTANDING THE PRODUCT

1. Anti-glare honeycomb lampshade
2. Hidden LED Light
3. Wireless charging pad
4. Color/Brightness quick adjustment key
5. Wireless charging indicator light
6. Color temperature touch key
7. ON/OFF touch Key
8. Brightness touch Key

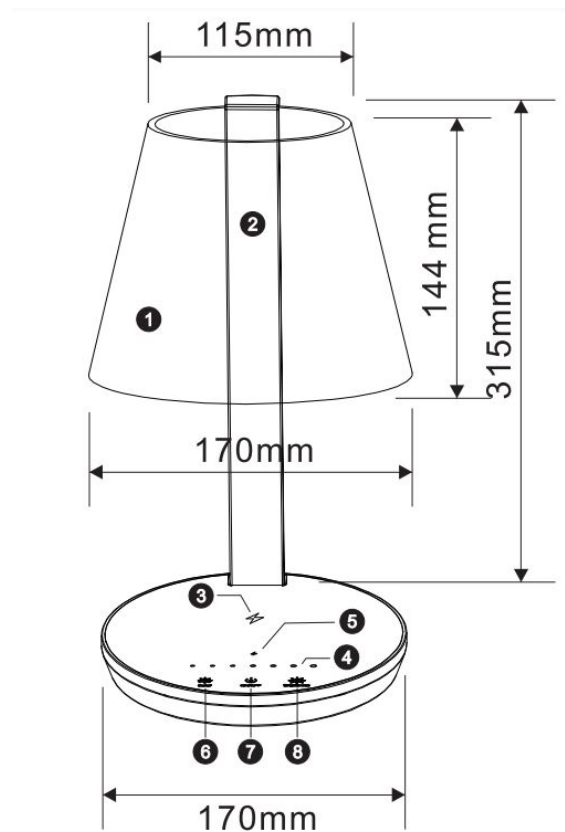

## HOW TO USE THE LAMP

1. Connect the power adapter interface

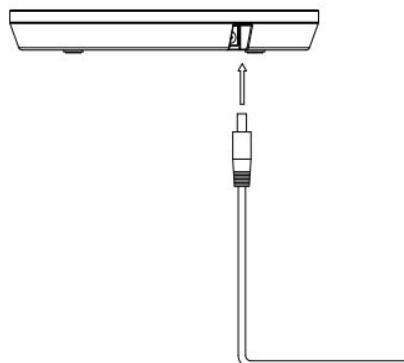

2. Turn on the lamp by touch key.

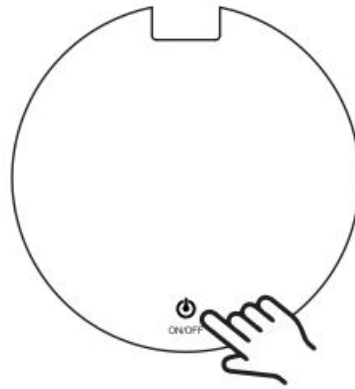

### 3. Color temperature and Brightness Adjustment

- Color temperature Adjustment: Touch the color temperature key, Indicator light up & light color temperature mode started up.
  - Quick adjustment: Touch key By adjusting the round dots, You can choose one of 7 color temperatures quickly
  - Gradually adjustment: touch: long press key gradual to 7 level color temperatures
- BrightnessAdjustment: Touch the brightness key, Indicator light up & brightness mode started up.
  - Quick adjustment: Touch key O " ..... " By adjusting the round dots, you can adjust the 7-level brightness quickly.
  - Gradually adjustment: Long press KeyQ "s" gradual to 7 levels brightness.

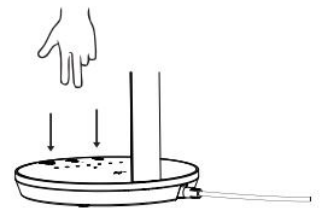
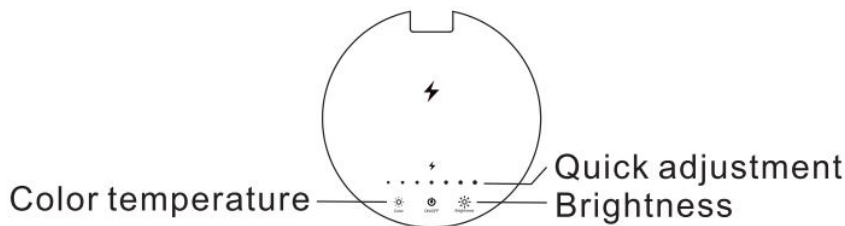

### 4. Wireless charging

Place your wireless charge compatible phone onto the glass of the wireless charging pad 3 to start charging your phone.

5 Indicator lights up start charging, the light goes out when charging finished

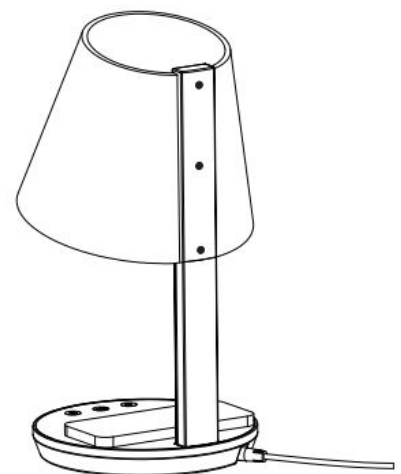
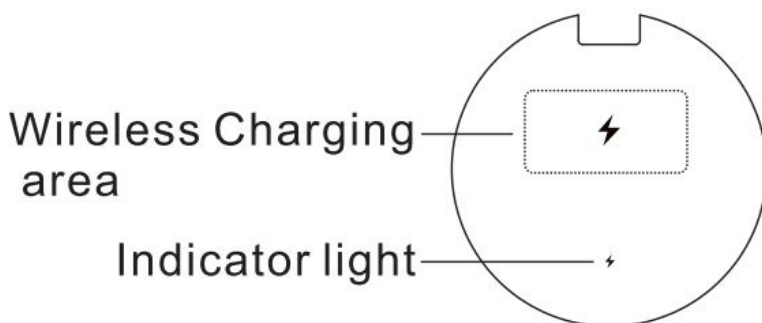

### 5. Memory function

The Table lamps keep memory for the brightness and light color used last time, to facilitate your usage habits.

### CAUTION

- Do not store the table lamp in a high-temperature environment or near a fire.
- Do not expose the table lamp to moisture or submerge it in liquid. Keep the table lamp dry at all times.
- Do not disassemble this table lamp or attempt to repair or modify it in any manner.
- If the product produces an abnormal smell or other anomalous change, stop using the product and contact us immediately.

## TECHNICAL SUPPORT &WARRANTY

### Hello, Thanks for your purchase

We strive to provide excellent customer service and want to ensure that you are completely satisfied. If you are satisfied with our services and products, would you mind sharing your happiness with others on Amazon? Your recognition will be greatly appreciated. Our products provide a 36-month warranty, if you are not satisfied with our products and services during the warranty period, please feel free to contact us, our service team will solve your confusion for you, we will try our best to make you satisfied, your satisfaction is our highest pursuit!

This device complies with part 15 of the FCC Rules. Operation is subject to the following two conditions:

1. this device may not cause harmful interference, and
  2. this device must accept any interference received, including interference that may cause undesired operation.
- Any changes or modifications not expressly approved by the party responsible for compliance could void the user's authority to operate the equipment.

**NOTE:** This equipment has been tested and found to comply with the limits for a Class B digital device, pursuant to Part 15 of the FCC Rules. These limits are designed to provide reasonable protection against harmful interference in a residential installation. This equipment generates, uses and can radiate radio frequency energy and, if not installed and used in accordance with the instructions, may cause harmful interference to radio communications. However, there is no guarantee that interference will not occur in a particular installation.

If this equipment does cause harmful interference to radio or television reception, which can be determined by turning the equipment off and on, the user is encouraged to try to correct the interference by one or more of the following measures:

- Reorient or relocate the receiving antenna.
- Increase the separation between the equipment and receiver.
- Connect the equipment into an outlet on a circuit different from that to which the receiver is connected.
- Consult the dealer or an experienced radio/TV technician for help.

To maintain compliance with FCC's RF exposure guidelines, This equipment should be installed and operated with a minimum distance of 20cm the radiator your body: Use only the supplied antenna.

## Documents / Resources

	<p><a href="#">TALA TBL01 Multi Functional Table Lamp</a> [pdf] Instruction Manual TBL01, 2A4PG-TBL01, 2A4PGTBL01, TBL01, Multi Functional Table Lamp</p>
---	---

