

Contents [[hide](#)]

- [1 Taiwan HCGA30CWB Bluetooth WiFi Gateway](#)
- [2 Package Contents](#)
- [3 Installation](#)
- [4 Operation](#)
- [5 Specification](#)
- [6 Troubleshooting](#)
- [7 FCC Regulation](#)
- [8 Warranty](#)
- [9 Documents / Resources](#)
 - [9.1 References](#)

Taiwan

Taiwan HCGA30CWB Bluetooth WiFi Gateway

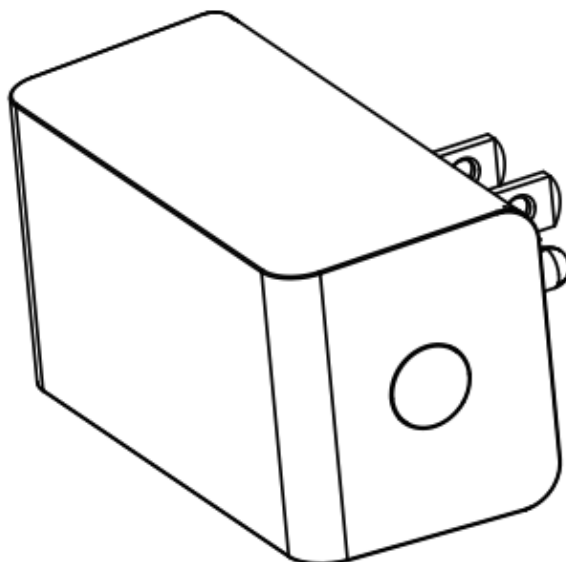

Package Contents

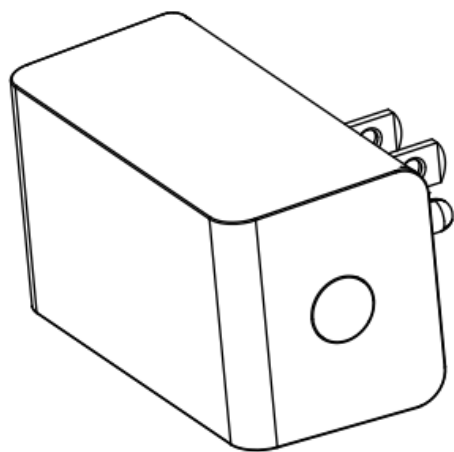

A



B

Part	Description	Quantity
A	Gateway	1
B	User Guide	1

Installation

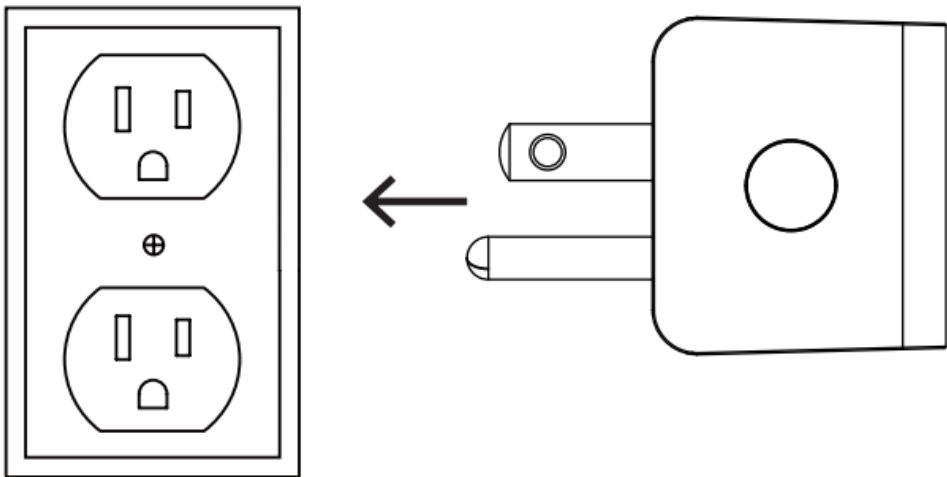

Insert the gateway into the socket. The gateway is now ready to use.

Operation

1. Download the iKey Connect app from the App Store or the Google Play Store.



2. Create an account to sign in or log in if you already have an account.
3. Connect your gateway to power and follow the Instructions on the app screen.



NOTE:

- This device requires a 2.4GHz Wi-Fi channel. The app only shows Wi-Fi networks that your device can use.
- If you do not see your Wi-Fi network name when you attempt to connect your devices, please check your router settings or move your product closer to your Wi-Fi router.

4. Tap the '+' button in the upper right corner to add your gateway.



NOTE: Bluetooth access is required for device setup.

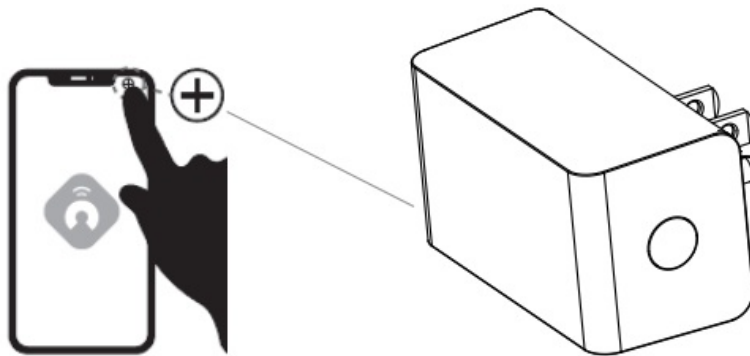

5. Scan the QR code on the door lock to set up a new door lock.

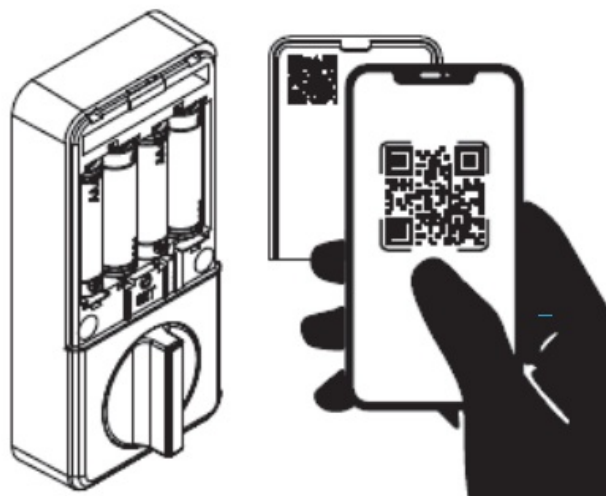

6. Follow the guided setup and scan the QR code on the gateway to add it to the newly added door lock.

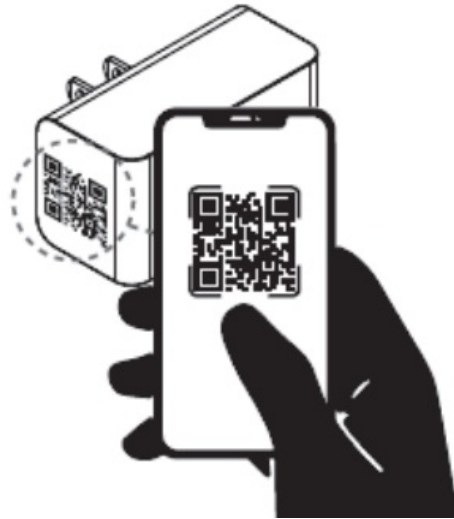

7. Set up your Voice Assistant

You can connect to Google Home and Alexa from the iKey Connect app. Or, you can sign in to Alexa app or Google Home and connect to your iKey Connect devices from there.

Specification

LED Indicator

LED State	Meaning	Action To Take
Solid red	The device is in factory condition (not yet paired)	Follow the instructions to set up the gateway.
Flashing red	Wi-Fi is disconnected	Check if your Wi-Fi Access Point allows the device to join the network. Or go to the device settings in the app and set up Wi-Fi again.
No light	Connected normally	No action required.
Red and green lights alternate	During the firmware update	Keep the app in the foreground until the update is completed.

Input	120VAC, 60Hz, FCC, ETL
Output	120VAC, 60Hz, 15A Maximum load, Resistive
Network Wireless Type	2.4GHz, IEEE 802.11b/g/n
Operating Temperature	32°–104° F
Operating Humidity	5-85% RH, Non-condensing
	FCC, ETL

Troubleshooting

Problem	Solution
My device is not connecting to Wi-Fi.	Make sure your device is connected to a power source. Your Internet connection or Wi-Fi network may be down.
My device cannot find any Wi-Fi networks.	Make sure you have a 2.4GHz-capable Wi-Fi network within range of the device you are trying to add.
I cannot find the QR code.	It is on the side of the gateway housing.
My device is offline for long periods.	Make sure your Wi-Fi signal strength is sufficient. You may need to move your router, use mesh Wi-Fi, or Wi-Fi extenders.
The device is on, and I scanned the QR code, but the app cannot connect to it.	Turn off Bluetooth on your phone and turn it back on. Then, scan the QR code. If the problem persists, turn your phone off and on, then try again.

Can I scan the same QR code to add multiple products?	No. Each product has a unique QR code.
---	--

Safety Information



WARNING: For indoor use only. Do not use in wet locations. The total current limit of the device is 15Amp. To avoid damage, do not exceed the 15-amp limit. If a direct short is created on the output, the Smart Plug will be damaged and no longer function. Do not disassemble the product or make repairs yourself. You run the risk of electric shock and voiding the limited warranty. If you need service, please contact the after-sales services. Make sure to use this product together with a 15a circuit breaker in the upstream.

FCC Regulation

Supplier's Declaration of Conformity

- Agent Company Name: Fu Hsing Americas, Inc
- Agent US Address: 1424 Buford Business Blvd Ste 100, 30518/Buford/GA
- Agent Contact Name: Mark Howell
- Agent Email Address: Markh@Fuhsing-usa.com
- Responsible Party
- Leedarson America, Inc. 300 Technology Court SE, Suite 100, Smyrna,
- GA 30082 1-[678-293-8382](tel:678-293-8382)

Unique Identifier

FCC ID: 03I-HCGA30CWB

This equipment complies with FCC radiation exposure limits set forth for an uncontrolled environment. This equipment should be installed and operated with a minimum distance of 20cm between the radiator and any part of your body.

This device complies with Part 15 of the FCC Rules. Operation is subject to the following two conditions: (1) this device may not cause harmful interference, and (2) this device must accept any interference received, including interference that may cause undesired operation.

Caution: The user is cautioned that changes or modifications not expressly approved by the party responsible for compliance could void the user's authority to operate the equipment.

Note: This equipment has been tested and found to comply with the limits for a Class B digital device, under part 15 of the FCC Rules. These limits are designed to provide reasonable protection against harmful interference in a residential installation.

This equipment generates and can radiate radio frequency energy and, if not installed and used according to the instructions, may cause harmful interference to radio communications. However, there is no guarantee that interference will not occur in a particular installation. If this equipment does cause harmful interference to radio or television reception, which can be determined by turning the equipment off and on, the user is encouraged to try to correct the interference by one or more of the following measures:

- Reorient or relocate the receiving antenna.
- Increase the separation between the equipment and receiver.
- Connect the equipment to an outlet on a circuit different from that to which the receiver is connected.
- Consult the dealer or an experienced radio/TV technician for help.

IC Regulation

This device contains licence-exempt transmitters/receivers that comply with Innovation, Science and Economic Development Canada's licence-exempt RSS(s). Operation is subject to the following two conditions:

1. This device may not cause interference.
2. This device must accept any interference, including interference that may cause undesired operation of the device.

This equipment complies with IC RSS-102 radiation exposure limits set forth for an uncontrolled environment. This equipment should be installed and operated with a minimum distance of 20cm between the radiator and any part of your body.

Wireless Protocol

Apple and the Apple logos are trademarks of Apple, Inc., registered in the U.S., and other countries. App Store is a service mark of Apple Inc. Google, Google Play and the Google Play logo are trademarks of Google LLC.

Warranty

1-YEAR LIMITED WARRANTY

This product is guaranteed to be free of defects in materials and workmanship for 1 year from the date of purchase. The guarantee does not include normal wear and tear, bulbs or batteries.

Documents / Resources

	Taiwan HCGA30CWB Bluetooth WiFi Gateway [pdf] User Guide HCGA30CWB Bluetooth WiFi Gateway, HCGA30CWB, Bluetooth WiFi Gateway, WiFi Gateway, Gateway
---	--

References

- 🌐 [USA Location information - USA.com](#)
- [User Manual](#)

📁 Taiwan

💎 Bluetooth WiFi Gateway, gateway, HCGA30CWB, HCGA30CWB Bluetooth WiFi Gateway, Taiwan, Wifi Gateway

—Previous Post

[Taiwan XV-2 Dual Cam Helmet Camera User Manual](#)

Leave a comment

Your email address will not be published. Required fields are marked *

Comment *

Name

Email

Website

☐ Save my name, email, and website in this browser for the next time I comment.

Post Comment

Search:

e.g. whirlpool wrf535swhz

Search

[Manuals+](#) | [Upload](#) | [Deep Search](#) | [Privacy Policy](#) | [@manuals.plus](#) | [YouTube](#)

This website is an independent publication and is neither affiliated with nor endorsed by any of the trademark owners. The "Bluetooth®" word mark and logos are registered trademarks owned by Bluetooth SIG, Inc. The "Wi-Fi®" word mark and logos are registered trademarks owned by the Wi-Fi Alliance. Any use of these marks on this website does not imply any affiliation with or endorsement.