



TAFFIO JP-X Series Automobile Intelligent Video Navigation System User Guide

[Home](#) » [TAFFIO](#) » TAFFIO JP-X Series Automobile Intelligent Video Navigation System User Guide 

Contents

- 1 [TAFFIO JP-X Series Automobile Intelligent Video Navigation System](#)
- 2 [Product Usage Instructions](#)
- 3 [INSTALLATION](#)
 - 3.1 [POWER CABLE OPTION](#)
 - 3.2 [Fibre Optic Cable](#)
 - 3.3 [Rear Camera Connection](#)
 - 3.4 [Sound Settings](#)
- 4 [Documents / Resources](#)



TAFFIO JP-X Series Automobile Intelligent Video Navigation System



Product Usage Instructions

1. **Power Cable Option:** Use Cable A if the vehicle does not have a sound system and Cable B if it does.
2. **Fibre Optic Cable:** Connect the fibre optic cable for proper data transfer and communication between different vehicle components.

3. **Canbus Connector:** Ensure that the Canbus Connector is plugged in correctly by referring to the picture in the user manual.
4. **Rear Camera Connection:** Connect a rear camera to the product for better visibility while reversing the vehicle.
5. **USB Connector:** Choose between the two options – either use the Android USB cable or use the USB adapter to continue using the original USB socket.
6. **Sound Settings:** Access the sound settings by going to System > Factory Settings and entering the code 7890. Scroll down to the end and select “Original with AMP”.

INSTALLATION

POWER CABLE OPTION

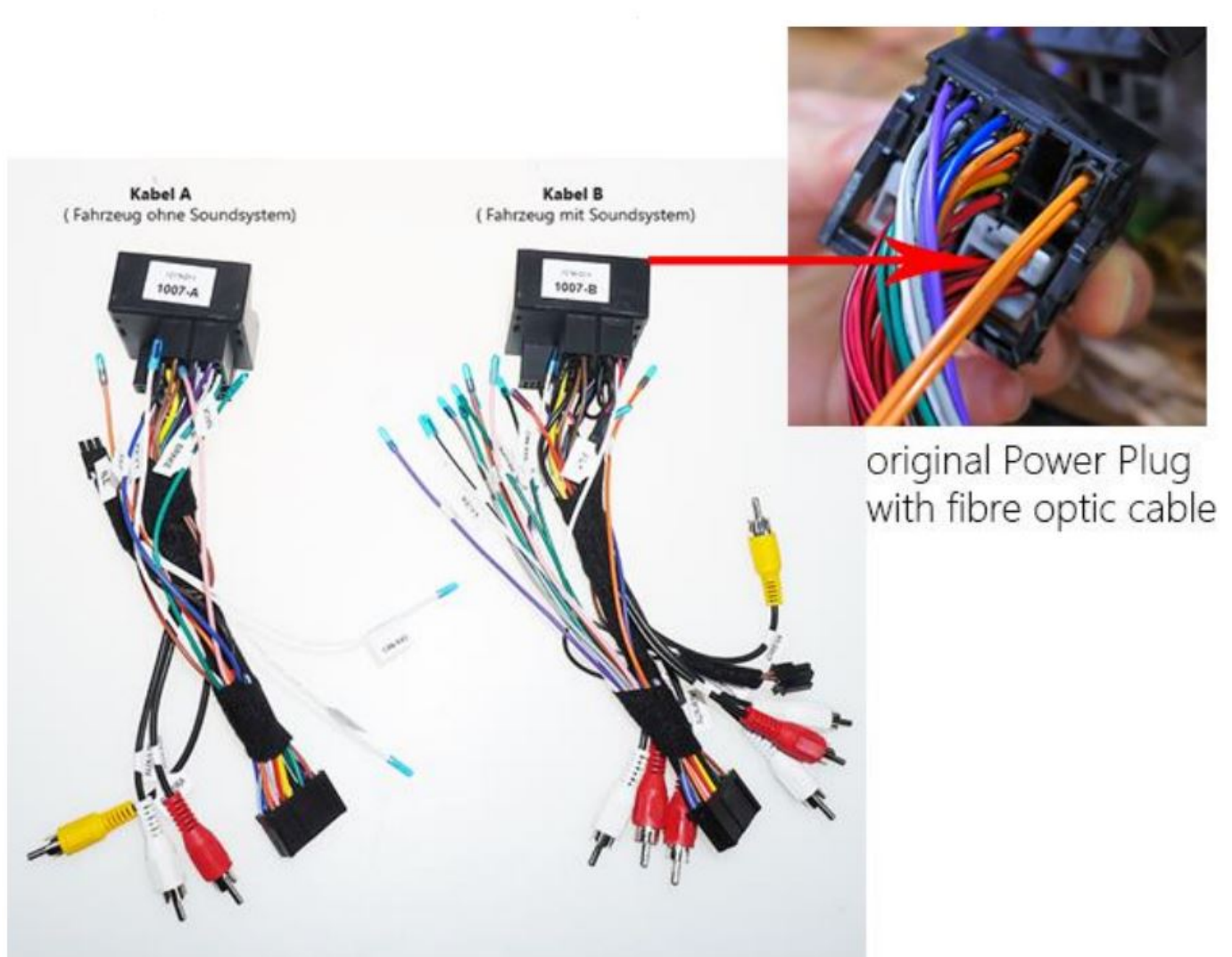

- Car without Soundsystem > Cable A
- Car with Soundsystem > Cable

Connection Cable A (Car without Soundsystem)

Fibre Optic Cable

Only for Car with Soundsystem ! Remove Fibre Optic Cable from Original Head Unit Plug and plugin to Android Head Unit.

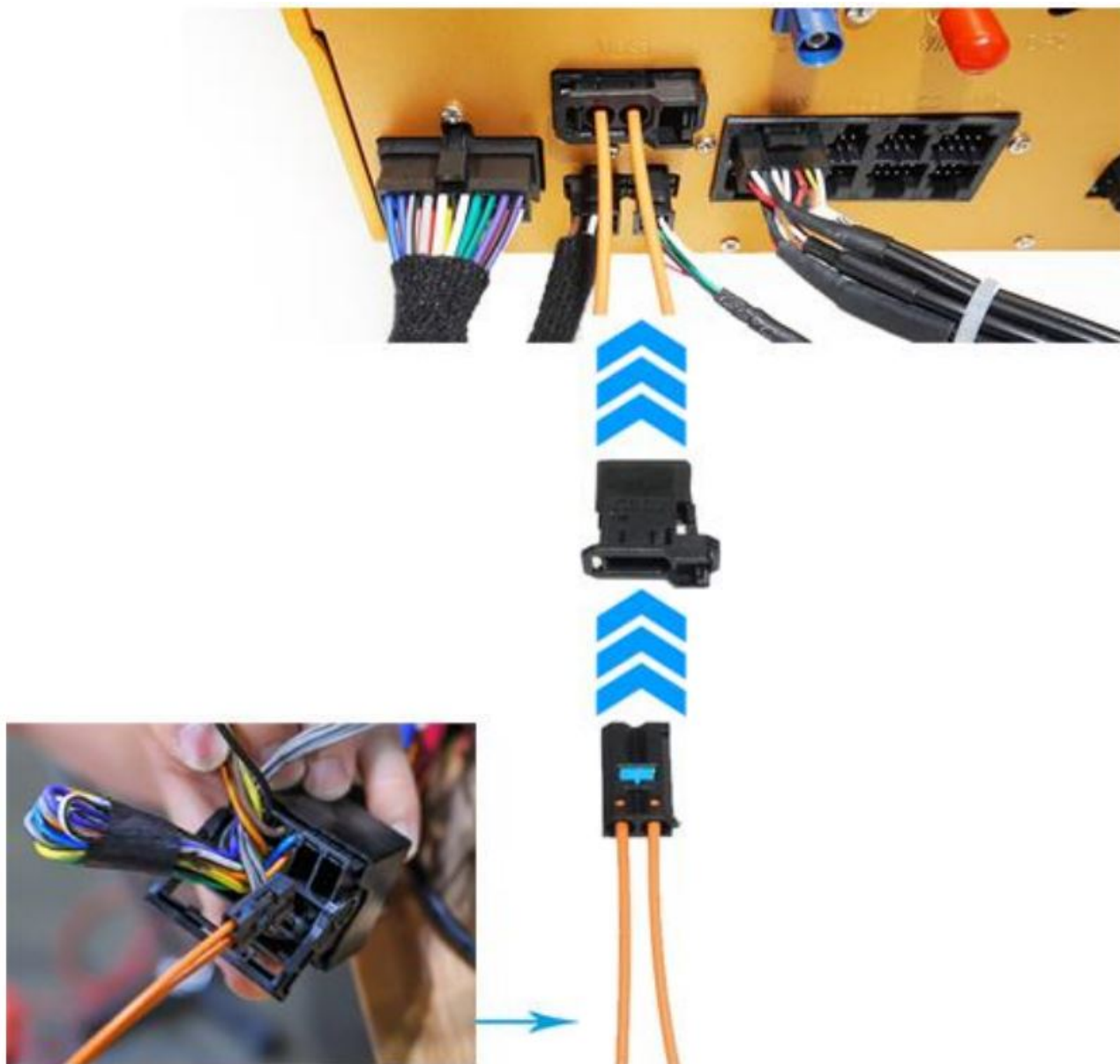

Canbus Connector

Please check if the Canbus Connector is plugged in correctly as in the picture below:



Rear Camera Connection

- for Aftermarket Camera connect Cinch Video Connector with Connector B
- for Factory Rear Camera please connect connector A with B

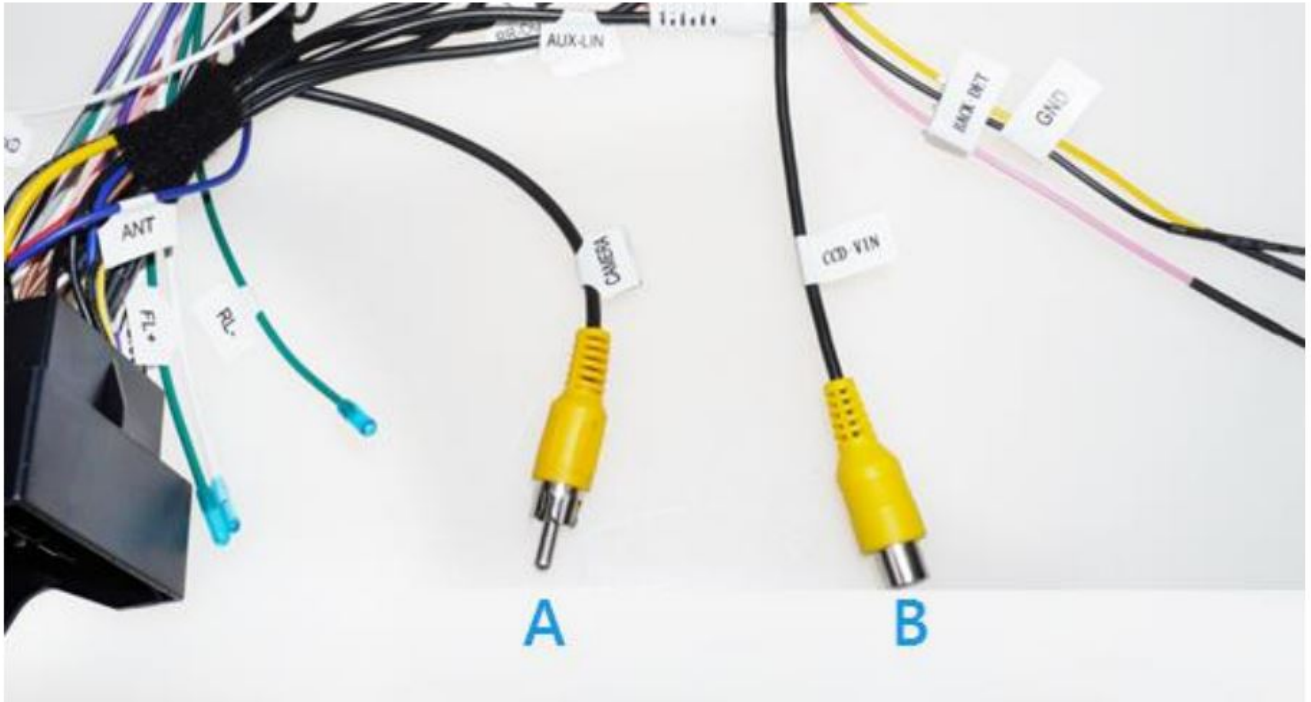

USB Connector

Choose whether you want to use the Android USB cable (option 2) or continue to use the original USB socket by using the USB adapter (option 1).



Option 1
(Adaptor for Original USB Slot)



Option 2
(Android USB Connector)



ORIGINAL USB SLOT CONNECTOR

Sound Settings

- Settings > System > Factory Settings > Code 7890

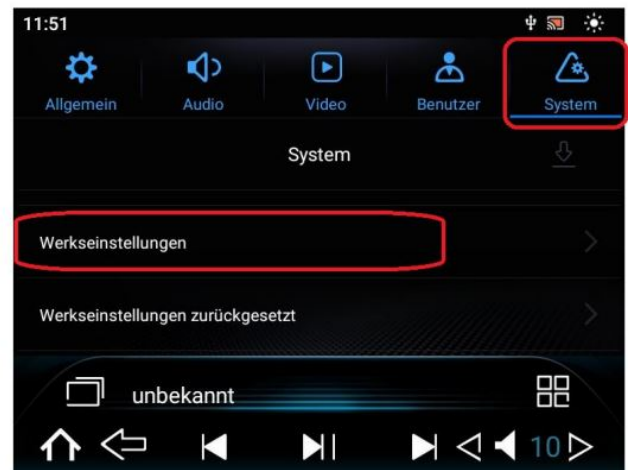
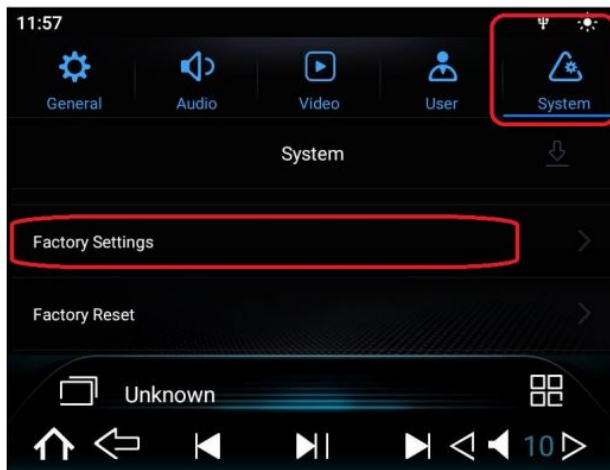

Scroll down till last options

Please set the option > Original with AMP:

| | | | |
|------------------|-----------------------------|------|-------|
| Factory settings | Set password(Only numbers): | Save | Clear |
| OneKey Install | can baudrate: | | |
| Touch key | Reverse with Protocol: | | |
| | Original with AMP: | | |
| | Rear climate: | | |
| | Reserve AC controller: | | |
| | Export Settings | | |
| | Save and reboot | | |

- For Car without Soundsystem (CABEL A) > OFF
- For Car with Soundsystem (CABEL B) > ON

Please tap now SAVE & REBOOT.

Documents / Resources

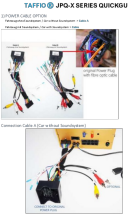
| | |
|---|---|
|  | <p>Taffio JP-X Series Automobile Intelligent Video Navigation System [pdf] User Guide JP-X Series, Automobile Intelligent Video Navigation System, JP-X Series Automobile Intelligent Video Navigation System, Intelligent Video Navigation System, Video Navigation System, Navigation System</p> |
|---|---|