



T nB Clavier Sans Fil Wireless Keyboard Instructions

[Home](#) » [T-nB](#) » T nB Clavier Sans Fil Wireless Keyboard Instructions 

Contents

- [1 T nB Clavier Sans Fil Wireless Keyboard](#)
- [2 IMPORTANT SAFETY INSTRUCTIONS](#)
- [3 Instructions](#)
- [4 FOR WIRELESS PRODUCTS](#)
- [5 Documents / Resources](#)



T nB Clavier Sans Fil Wireless Keyboard



Congratulations on your purchase and thank you for the trust you have placed in T'nB. Our products comply with the all relevant regulations and standards. Before using this equipment, we recommend that you read the instructions and safety instructions carefully and keep this manual for future reference.

IMPORTANT SAFETY INSTRUCTIONS

- No guarantee will apply in case of misuse.
- T'nB accepts no liability if the safety instructions are not respected.
- Handle the device with care.

- The power supply of your device must match the initially specified characteristics
- The socket Of the electrical equipment must be located near the said equipment and easy to get to.
- Keep the device away from flammable objects, explosive substances or dangerous objects.
- Use and store your device in an environment where the temperature is between 0°C and 40°C.
- Store your device out Of the reach Of children.
- This device is not designed to be used by persons (including children) whose physical, sensory or mental capacities are reduced, or persons without experience or knowledge, except if they are supervised or receive prior instruction on using the device by a person in charge Of their safety.
- Do not disassemble your device and do not attempt to repair or modify it yourself.
- Stop using your device if it has been hit or damaged.
- To avoid the risk Of electric shock, disconnect your device from the mains and from any Other device before cleaning it or when not in use.
- Only use the supplied accessories and connectors. The use Of any Other type Of accessory not intended for this purpose may irretrievably damage your device.
- Make sure the appliance is switched Off and cold before cleaning. Do not use any product or lubricant which may damage the appliance.
- T'nB accepts no liability for damage caused by misuse of the product or by use of an incompatible electrical device.
- Unless otherwise stated, never use your device in rain, in damp places or near a water source.
- Unless otherwise stated, this product is for indoor use only.
- Do not leave wireless products near credit cards or other data storage devices.
- Avoid using your wireless devices near sources of interference, such as power supply cables, microwave ovens, fluorescent lamps, wireless video cameras and wireless domestic telephones.
- To improve the quality and strength of the wireless signal, reduce the number of devices operating on the same wireless frequency.
- Do not leave the device on charge unattended. In the event of a short circuit or mechanical damage to the internal lithium battery, there is a risk of overheating or fire.
- **WARNING:** risk of explosion if the battery is replaced with an inappropriate model. Recycle used batteries in accordance with current regulations.

Instructions

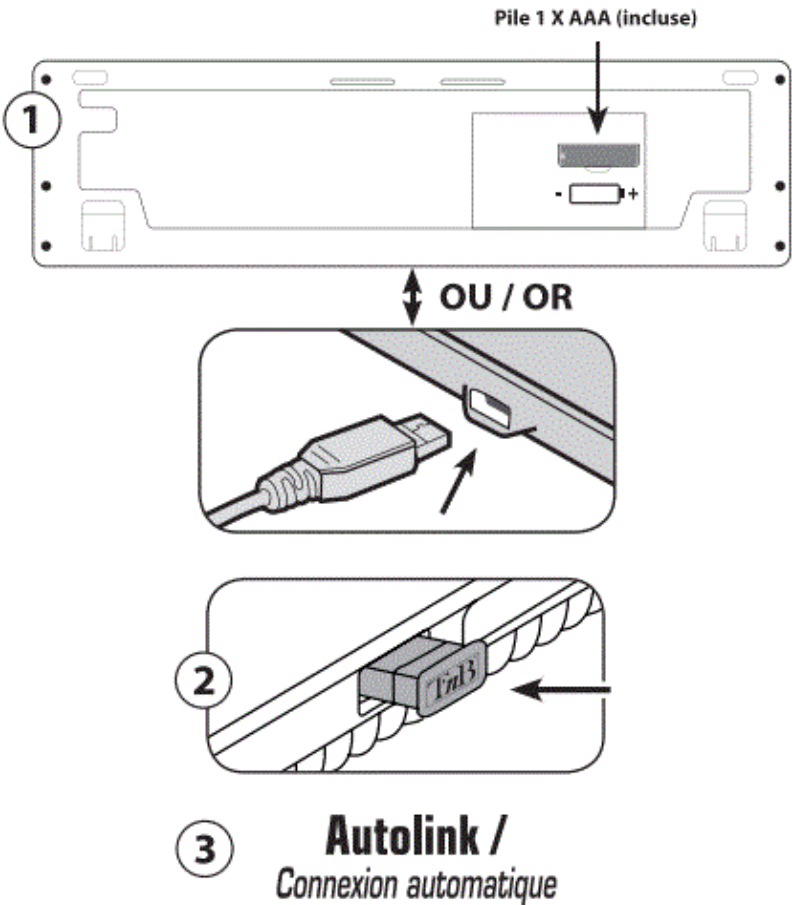

FOR WIRELESS PRODUCTS

- 1. Make sure the device you want to connect your new product to is on.
- 2. Insert the battery/batteries in the device and turn it on. If your device has a built-in battery, plug the supplied power cable into a USB port to charge it and turn it on.
- 3. Connect your new product to a USB port on your computer. The USB dongle is inside the device or the packaging.
- 4. Your new product is ready to use, no installation is required.

NEED HELP?

Concerned about the satisfaction of our customers, you can contact us at info@t-nb.com. For maintenance, troubleshooting, and miscellaneous information about this product, please visit our website: www.t-nb.com

| | |
|--|--|
| | Direct current To indicate on the rating plate that the equipment is suitable for direct current only; to identify relevant terminals. |
| | CE marking European Conformity, complies with EU requirements, such as EU directives and standards. |

Documents / Resources



[T nB Clavier Sans Fil Wireless Keyboard](#) [pdf] Instructions

Clavier Sans Fil Wireless Keyboard, Sans Fil Wireless Keyboard, Fil Wireless Keyboard, Wirele
ss Keyboard, Keyboard