

T J WF310400 Extendable Wood Dining Set For Small Spaces



# T J WF310400 Extendable Wood Dining Set For Small Spaces Installation Guide

[Home](#) » [T J](#) » T J WF310400 Extendable Wood Dining Set For Small Spaces Installation Guide 

## Contents

- [1 T J WF310400 Extendable Wood Dining Set For Small Spaces](#)
- [2 DESCRIPTION](#)
- [3 CARTON CONTENT](#)
- [4 TABLE PART LISTS](#)
- [5 INSTALLATION](#)
- [6 OVERVIEW](#)
- [7 CHAIR PART LISTS](#)
- [8 Documents / Resources](#)
  - [8.1 References](#)
- [9 Related Posts](#)

# T J

**T J WF310400 Extendable Wood Dining Set For Small Spaces**



### **Product Specifications**

- Product Name: Dining Table WF310399
- Table Dimensions: Standard dining table size
- Material: Wood/Metal
- Color: As per product image

### **Assembly Instructions for Dining Table WF310399**

#### **Step 1: Table Assembly**

1. Place all parts on a clean and smooth surface to avoid scratches.
2. Identify and lay out all the table parts as per the part list provided.
3. Assemble the table legs (R) and (L) to the tabletop using the provided hardware (A, B, C).
4. Attach the leaf and stretchers to complete the table structure.

#### **Step 2: Hardware Installation**

1. Use the hex comb to tighten the screws and bolts securely.
2. Ensure all parts are properly aligned before tightening any screws.

### **Assembly Instructions for Dining Chair WF310400**

#### **Step 1: Chair Assembly**

1. Place all chair parts on a clean and smooth surface to prevent damage.
2. Attach the back legs, front legs, seat, and box seat following the part list.

#### **Step 2: Hardware Installation**

1. Use the provided JCBC bolts, washers, and Allen key to secure the chair parts together.
2. Tighten all bolts gradually to ensure stability.

### **Frequently Asked Questions (FAQ)**

- Q: Can I use power tools for assembly?

A: It is recommended to assemble the product manually to prevent over-tightening or damaging the parts.

- Q: What should I do if a part is missing?

A: Contact customer support with your order details to request a replacement part.

- Q: How do I clean the dining set?

A: Use a soft cloth dampened with water to clean the surfaces. Avoid harsh chemicals that may damage the finish.

### **IMPORTANT NOTE:**

- PLACE ALL PARTS ON A CLEAN AND SMOOTH SURFACE SUCH AS A RUG OR CARPET TO AVOID THE PARTS FROM BEING SCRATCHED.
- BEFORE YOU BEGIN, KINDLY FOLLOW THE ASSEMBLY INSTRUCTIONS STEP BY STEP.
- DO NOT TIGHTEN ALL SCREWS AND BOLTS UNTIL THE TABLE IS FULLY SET-UP.

### **DESCRIPTION**

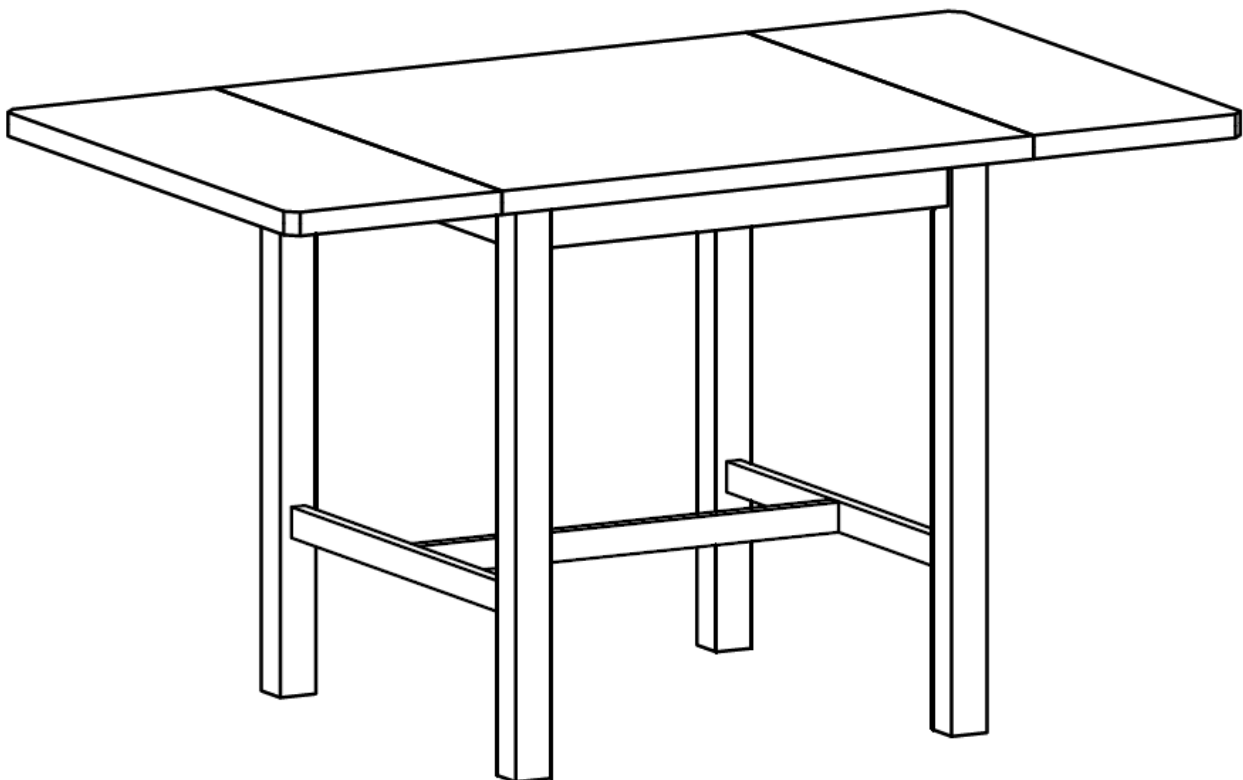

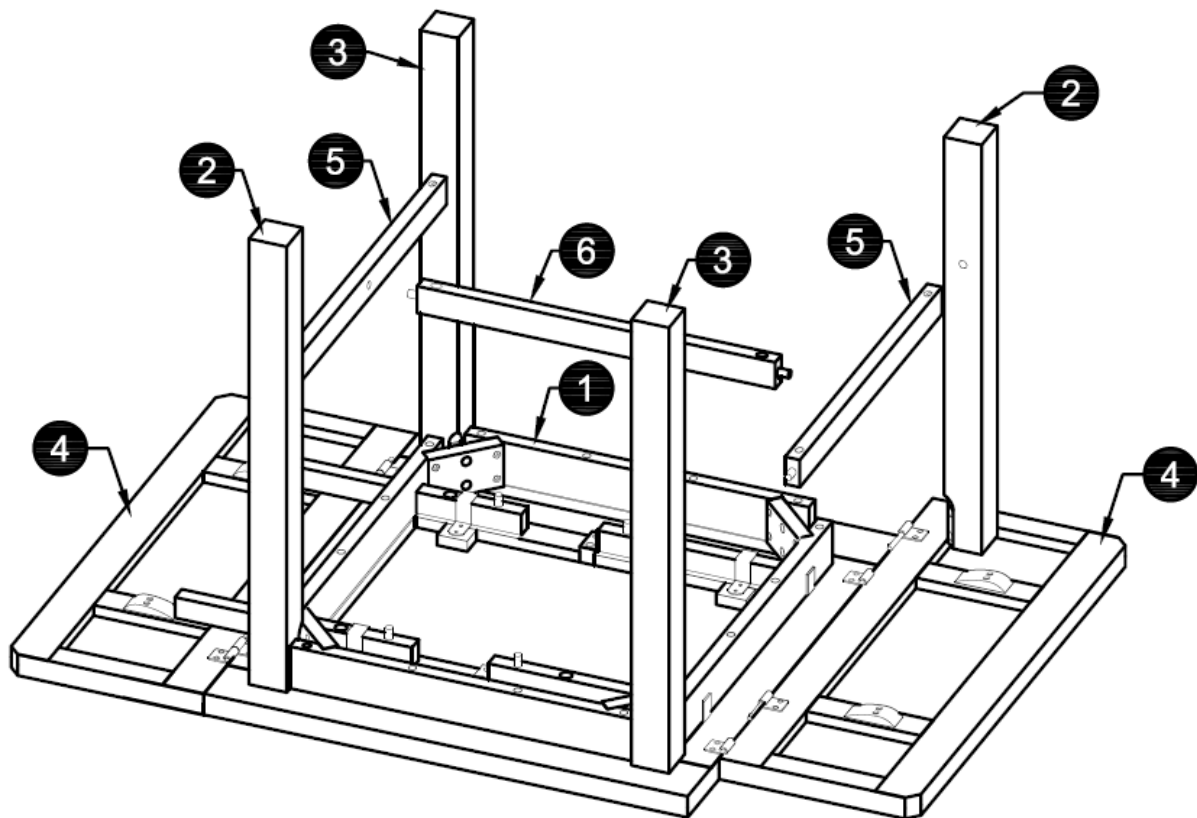

## CARTON CONTENT

WF310399 :

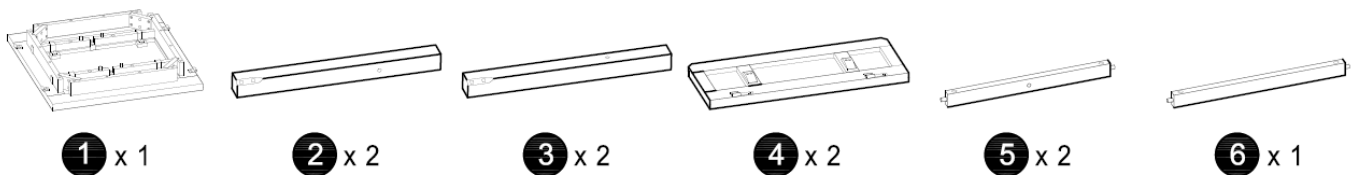

## TABLE PART LISTS

TABLE PART LISTS				TABLE HARDWARE LISTS			
NO.	DESCRIPTION	SKETCH	QTY	NO.	DESCRIPTION	SKETCH	QTY
1	TABLE TOP		1 PC	A	HEX COMB 5/16 x 2 1/2"		8 PCS
2	TABLE LEG (R)		2 PCS	B	SPRING WASHER 5/16"		8 PCS
3	TABLE LEG (L)		2 PCS	C	FLAT WASHER 5/16"		8 PCS
4	LEAF		2 PCS	D	SPANNER 1.28		1 PC
5	STRETCHER (S)		2 PCS	E	C/B SCREW M4 x 45mm		6 PCS
6	STRETCHER (L)		1 PC				

## INSTALLATION

STEP 1

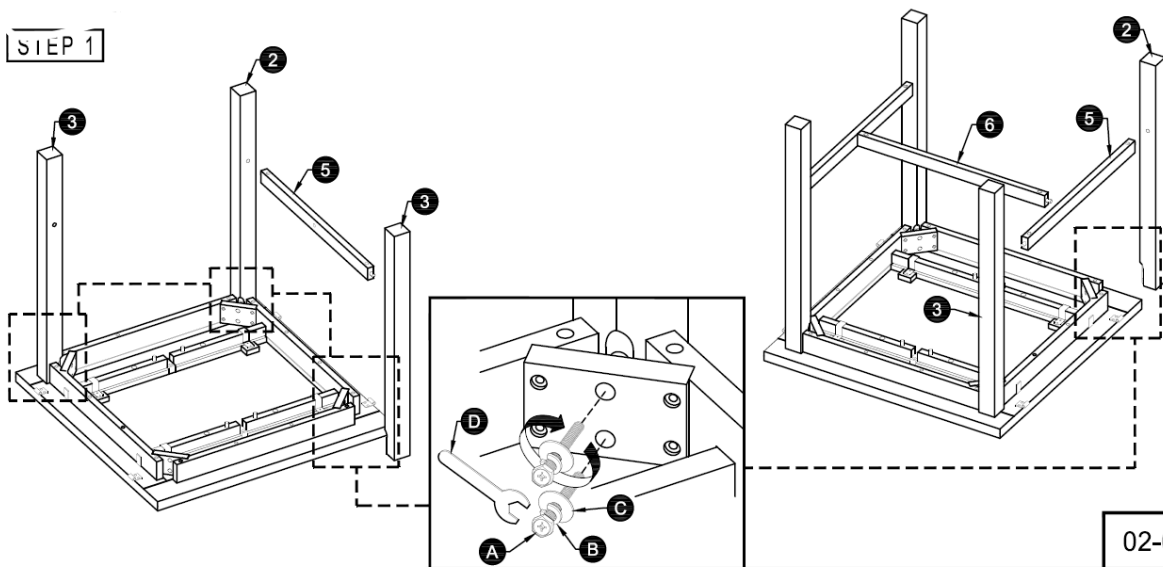

STEP 2

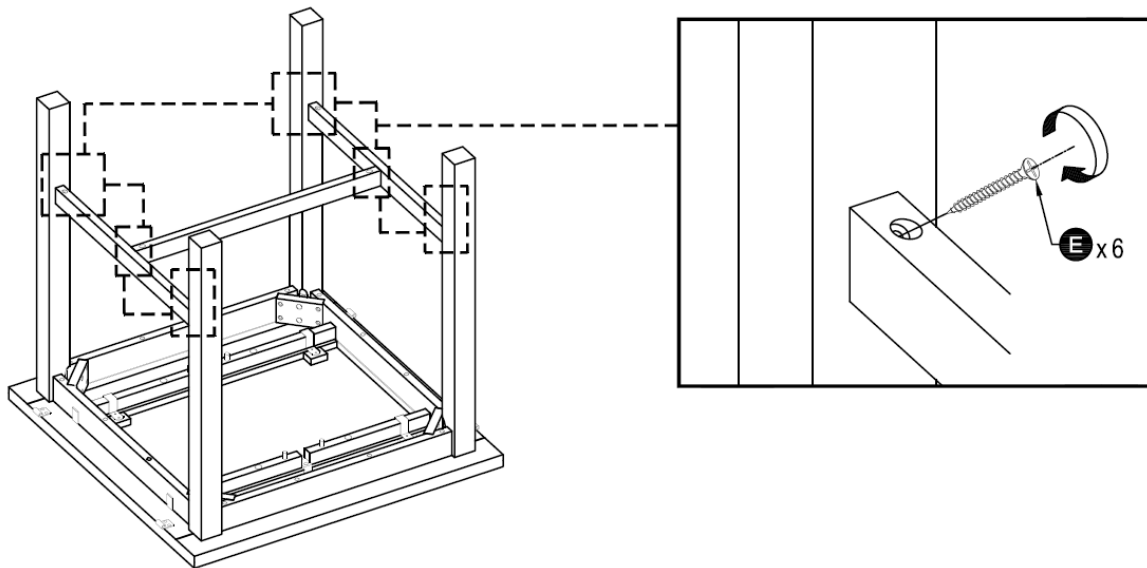

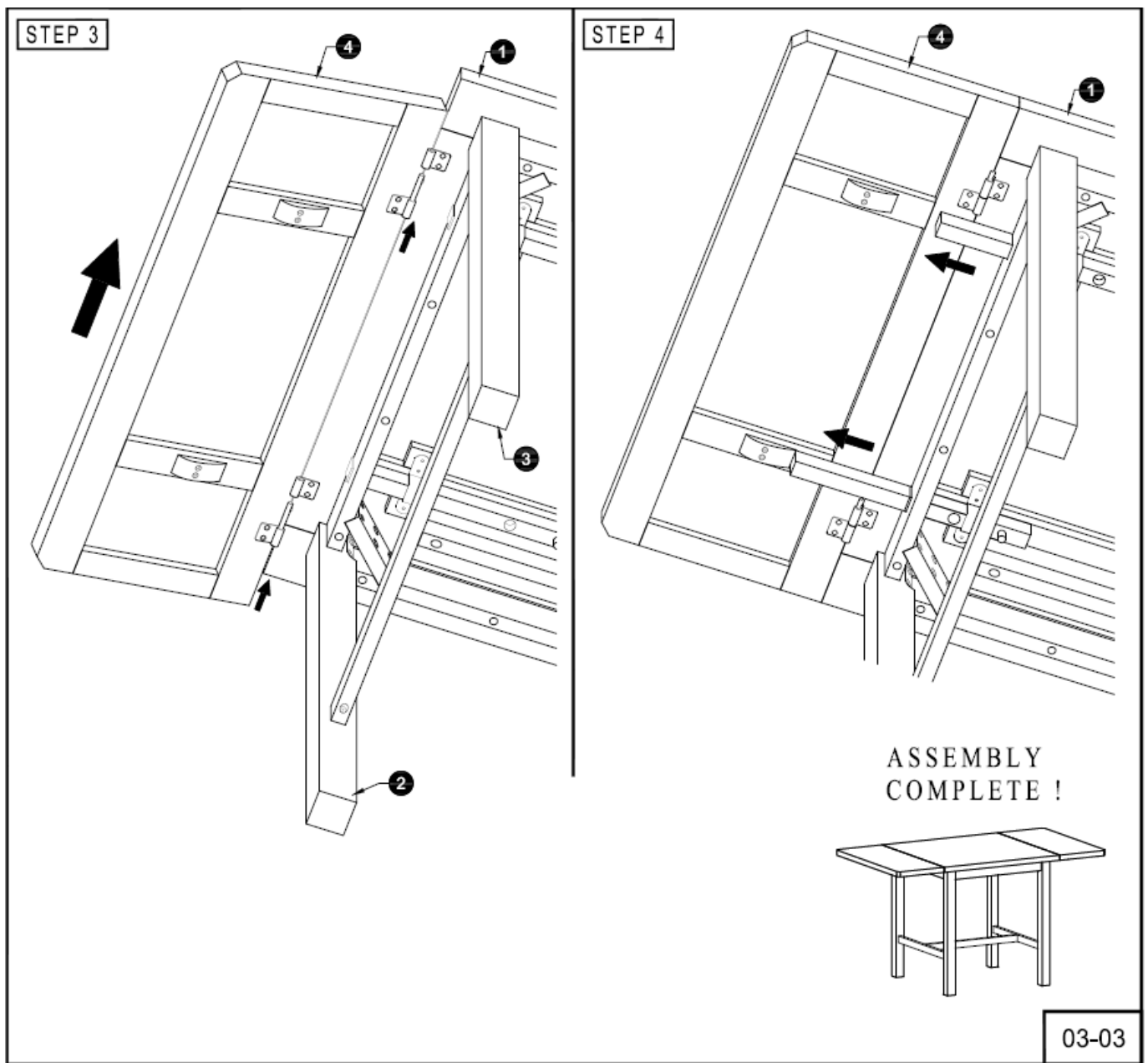

#### IMPORTANT NOTE:

- PLACE ALL PARTS ON A CLEAN AND SMOOTH SURFACE SUCH AS A RUG OR CARPET TO AVOID THE PARTS FROM BEING SCRATCHED.
- BEFORE YOU BEGIN, KINDLY FOLLOW THE ASSEMBLY INSTRUCTIONS STEP BY STEP.
- DO NOT TIGHTEN ALL SCREWS AND BOLTS UNTIL THE CHAIR IS FULLY SET-UP.

#### OVERVIEW

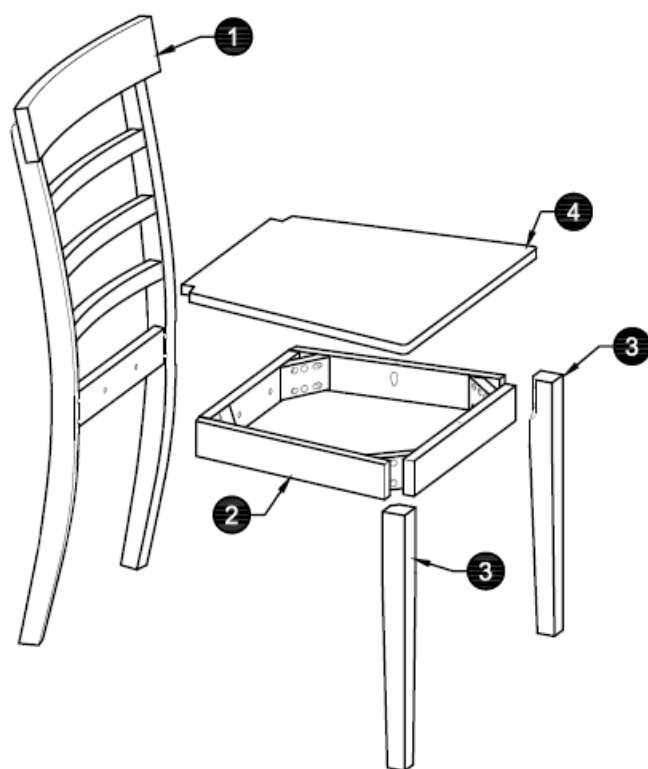
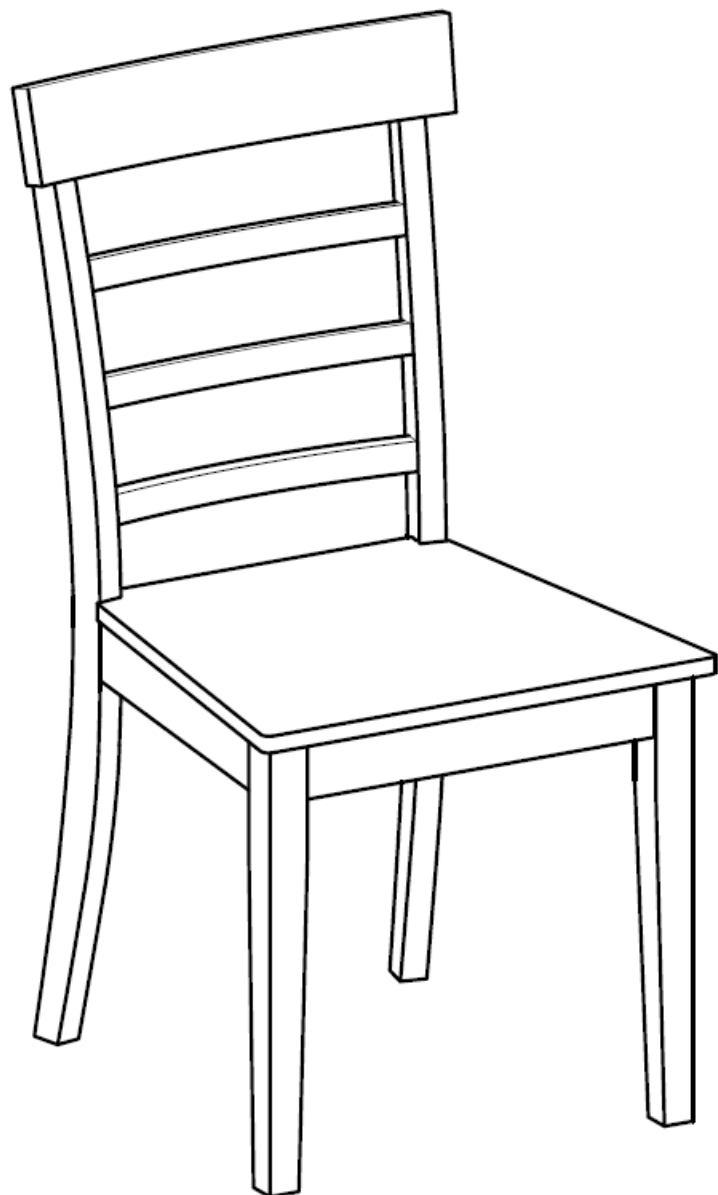

**CARTON CONTENT:**

WF310400 :

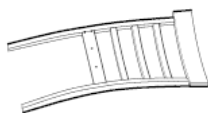

1 x 4

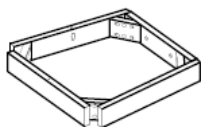

2 x 4



3 x 8

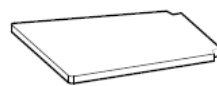

4 x 4

**CHAIR PART LISTS**

CHAIR PART LISTS				CHAIR HARDWARE LISTS			
NO.	DESCRIPTION	SKETCH	QTY	NO.	DESCRIPTION	SKETCH	QTY
1	BACK LEG		4 PCS	A	JCBC BOLT M6 x 35mm		8 PCS
2	BOX SEAT		4 PCS	B	JCBC BOLT M6 x 60mm		16 PCS
3	FRONT LEG		8 PCS	C	JCBC BOLT M6 x 80mm		16 PCS
4	SEAT		4 PCS	D	SPRING WASHER 1/4"		40 PCS
				E	FLAT WASHER 1/4"		40 PCS
				F	ALLEN KEY M4		1 PC
				G	C/B SCREW M4 x 30mm		12 PCS

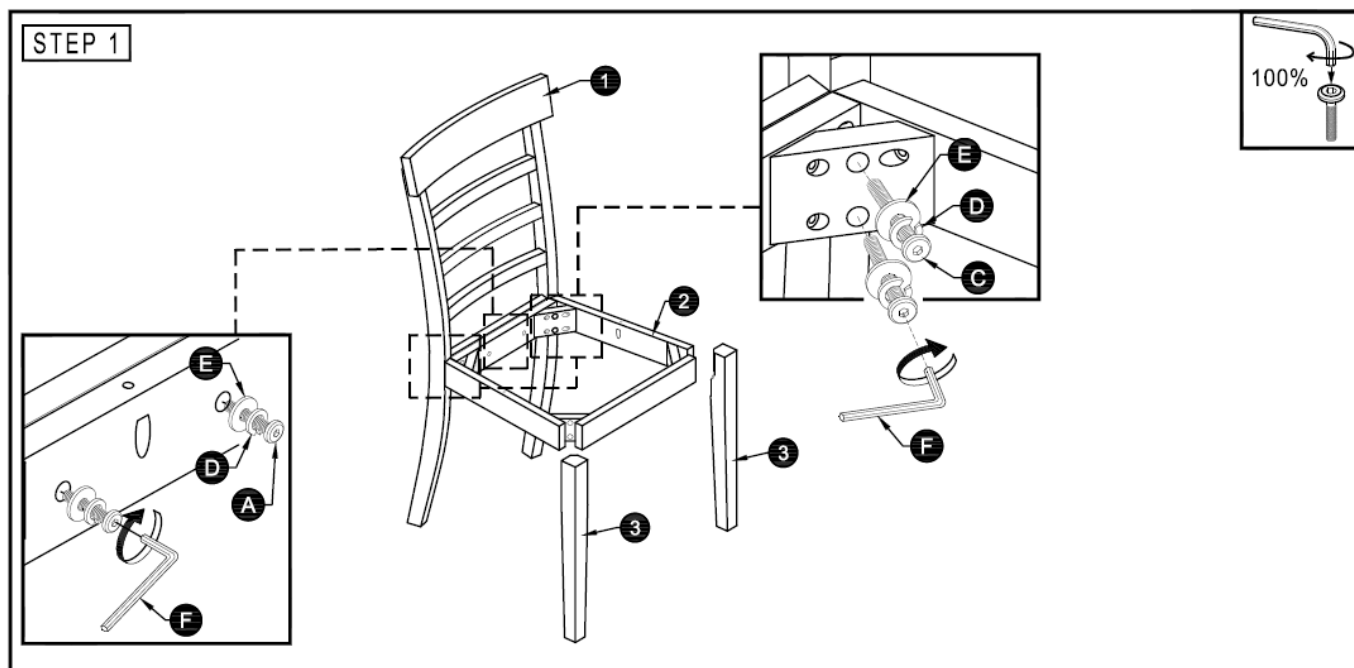
**INSTALLATION**



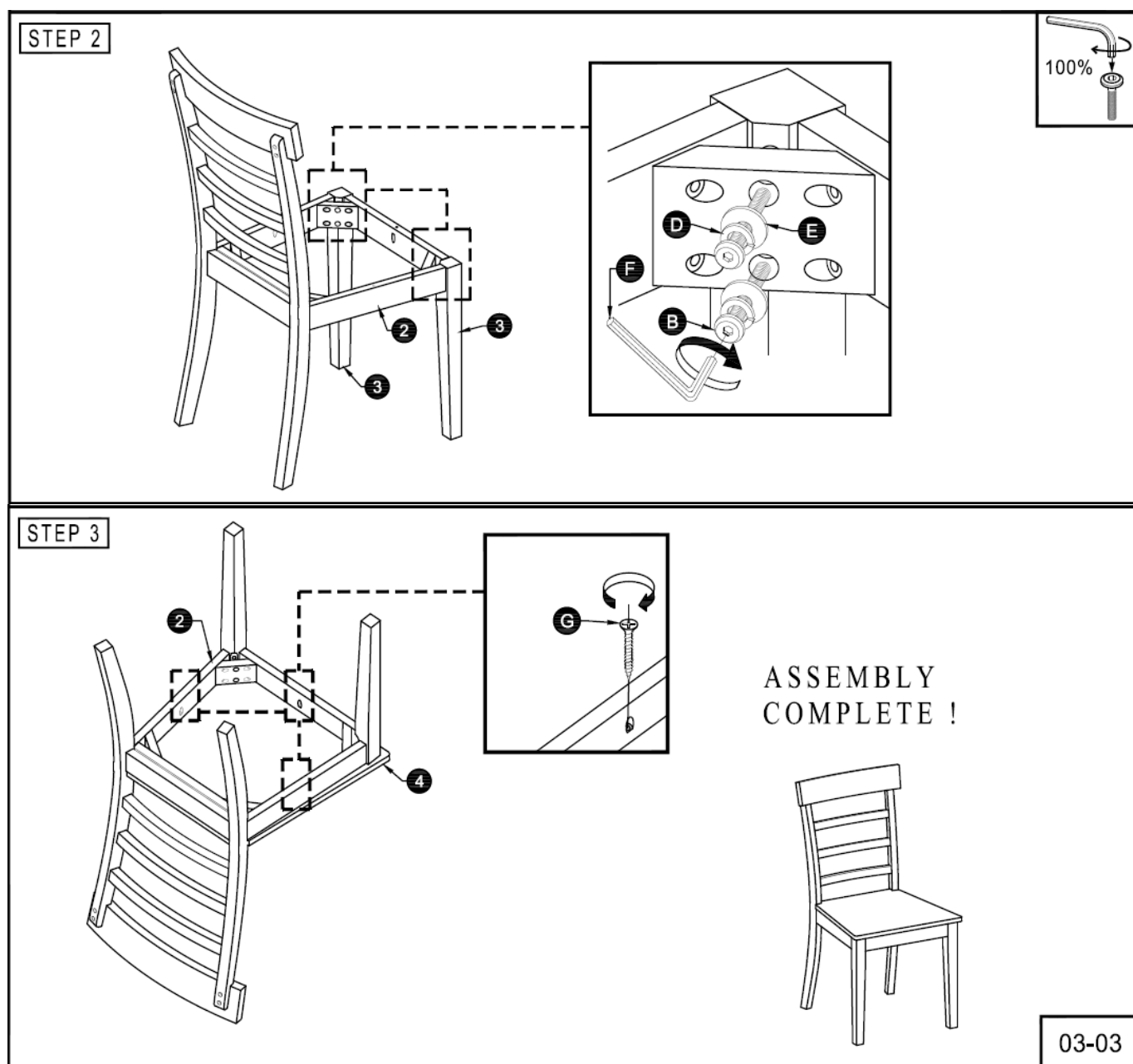

## Documents / Resources

ASSEMBLY INSTRUCTIONS

DINING TABLE

WF310399

IMPORTANT NOTE:

\* PLEASE READ ALL INSTRUCTIONS CAREFULLY BEFORE STARTING THE ASSEMBLY. THE INSTRUCTIONS ARE PROVIDED FOR YOUR REFERENCE ONLY. THE INSTRUCTIONS ARE NOT A SUBSTITUTE FOR THE INSTRUCTIONS PROVIDED BY THE MANUFACTURER.

**[T J WF310400 Extendable Wood Dining Set For Small Spaces](#) [pdf] Installation Guide**

WF310400 Extendable Wood Dining Set For Small Spaces, WF310400, Extendable Wood Dining Set For Small Spaces, Wood Dining Set For Small Spaces, Dining Set For Small Spaces, For Small Spaces, Spaces

## References

- [User Manual](#)

[Manuals+](#), [Privacy Policy](#)

This website is an independent publication and is neither affiliated with nor endorsed by any of the trademark owners. The "Bluetooth®" word mark and logos are registered trademarks owned by Bluetooth SIG, Inc. The "Wi-Fi®" word mark and logos are registered trademarks owned by the Wi-Fi Alliance. Any use of these marks on this website does not imply any affiliation with or endorsement.