



SYNCO Xtalk XPro Full Duplex Wireless Intercom Headset System User Manual

[Home](#) » [SYNCO](#) » SYNCO Xtalk XPro Full Duplex Wireless Intercom Headset System User Manual 



Xtalk XPro Full Duplex Wireless Intercom Headset System User Manual

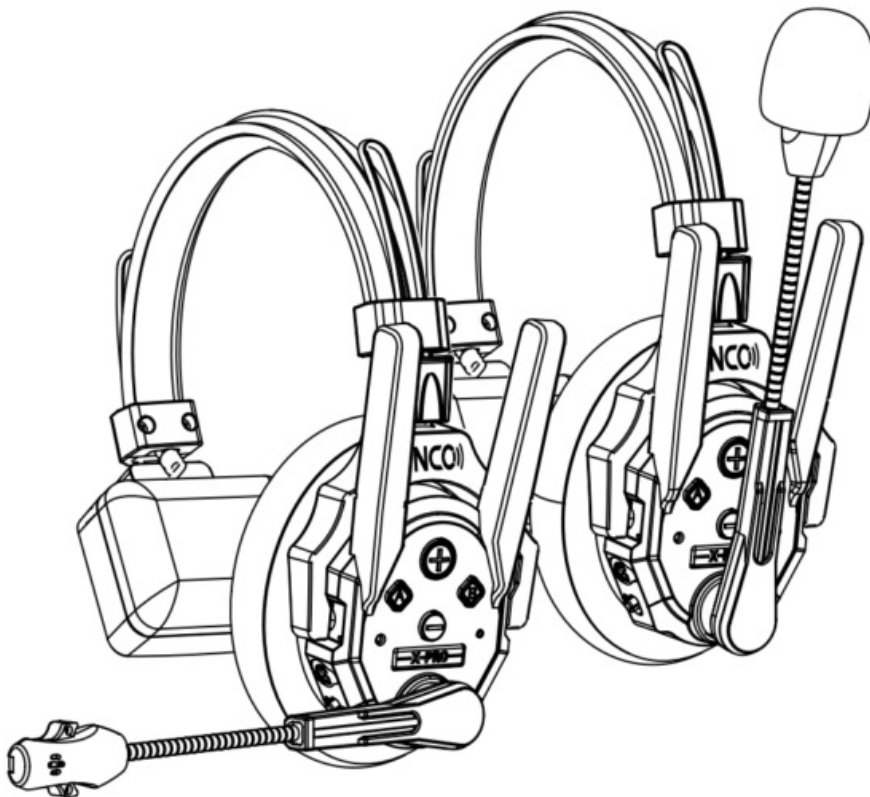

Thank you for choosing SYNCO product. Please read this manual carefully before use and follow all instructions mentioned herein.

Contents

- [1 Product Introduction](#)
- [2 Button Function](#)
- [3 Operations](#)
- [4 Specifications](#)
- [5 Packing List](#)
- [6 Caring For Your SYNCO Product](#)
- [7 WARRANTY](#)
- [8 Documents / Resources](#)
 - [8.1 References](#)
- [9 Related Posts](#)

Product Introduction

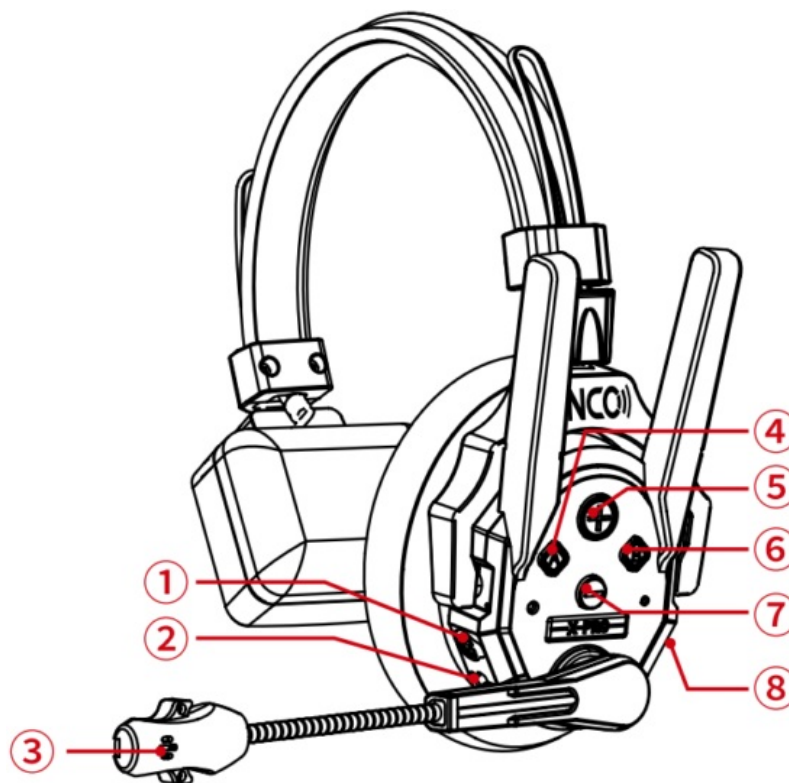

- 1. 3.5mm Mic In Port
- 2. Power On/Off Toggle
- 3. Indicator Light
- 4. Button A
- 5. Volume & Headset Settings Verification button
- 6. Button B
- 7. Volume
- 8. Type-C Port

Button Function

Button A

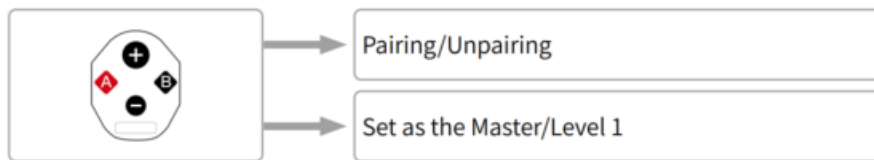

Button B

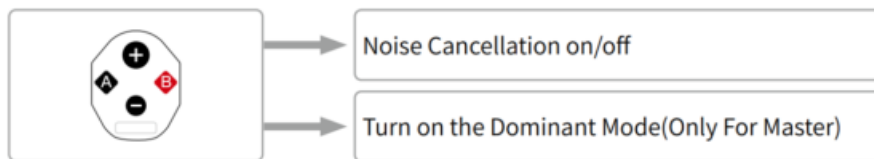

Volume

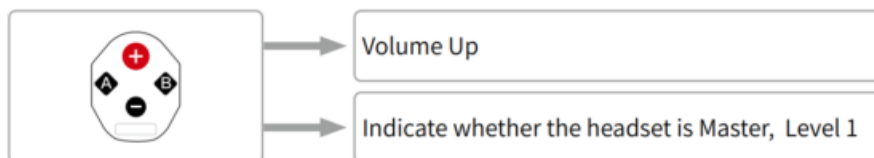

Volume

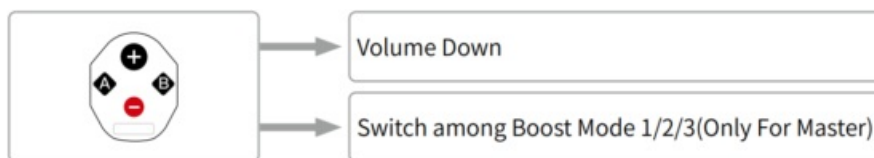

Operations

1. Power On/ Off

Power On: Push the power toggle switch upwards to turn it on.

Power Off: Push the power toggle switch downwards to turn it off.

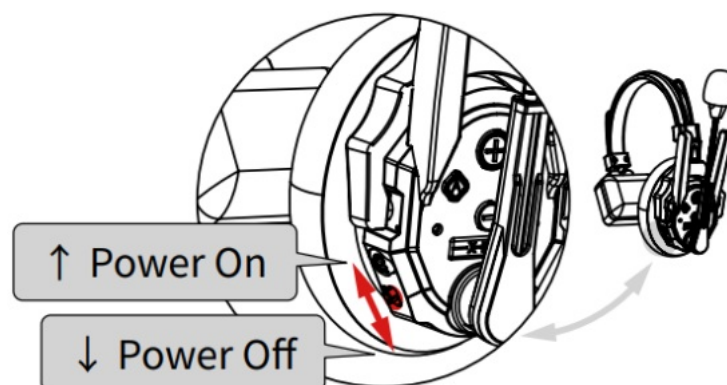

*Products are pre-paired from the factory (except X1) and ready to use

*To ensure a successful auto-reconnect, please turn on the headsets in the sequence of Master → Level 1.

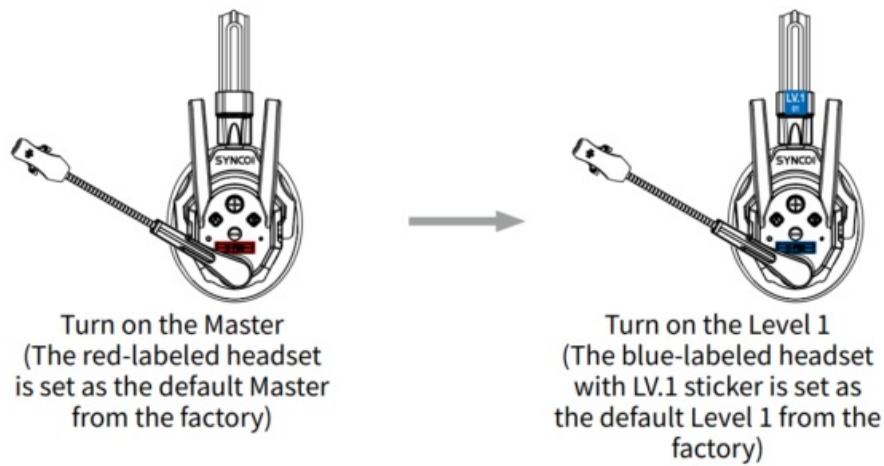

2. Master/Level 1 Settings

All headsets can be set as: Master/Level 1

Set as Master

Long press the button A, release after the 2nd “Beep” sound and hear “Master Mode”.



Set as Level 1

Long press the button A, release after the 3rd “Beep” sound and hear “Level 1 Pairing”.



3. Pairing/Unpairing

1. Set a Master and 1~4 Level 1.

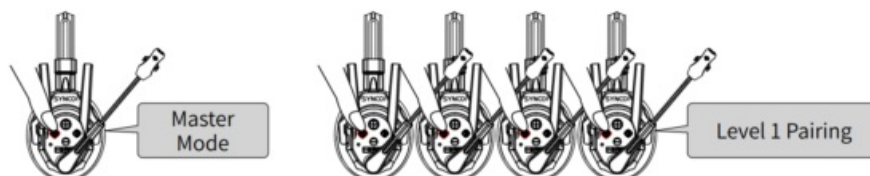

2. Long press the button A on all headsets in 1 min, release after the 1st “Beep” sound, and hear “Connecting and Pairing”.

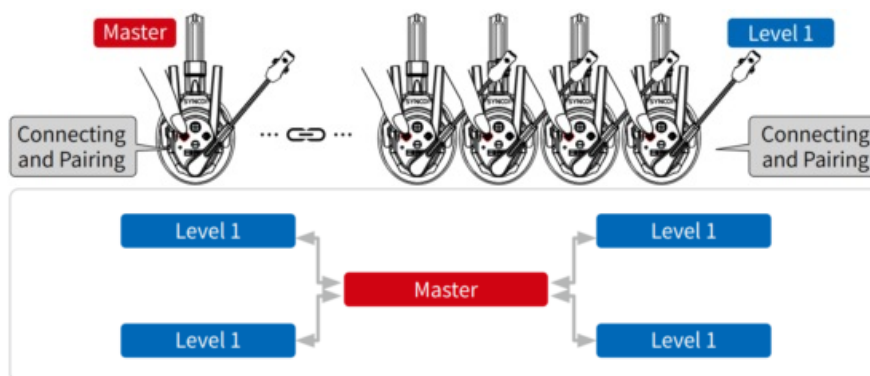

3. Restart all headsets to use.

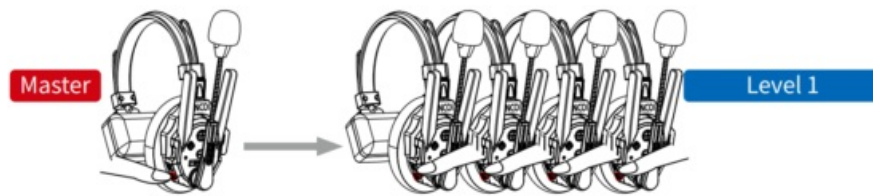

3.3 Unpairing

Long press the button A, release after the 1st “Beep” sound, and hear “Unpairing”.

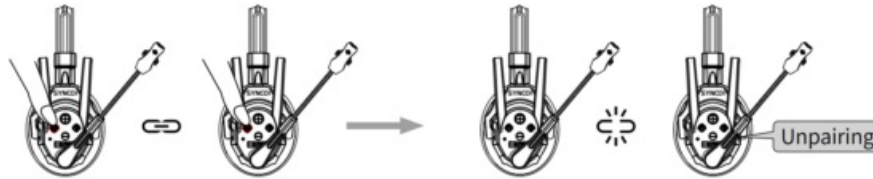

4. Group Management

You can divide an Xtalk system into independent groups or merge multiple groups into one single group.

4.1 Divide Into Groups

1. Set the required number of Master based on the planned group count (see 2. Master Settings).
2. Set the Level 1 for each group (see 2. Level 1 Settings).
3. Pair and restart each group one by one (see 3. Pairing/Unpairing).

EG. Divide XPro5 into 2 groups: 2-Person Group & 3-Person Group

1. Set 2 Masters, 4 Level 1.
2. Pairing (* Please pair and restart each group before pairing the next.).

2-Person Group

Long press the button A on a Master and a Level 1, release after the 1st “Beep” sound and hear “Connecting and Pairing”, then restart the headsets. (Power On Sequence: Master → Level 1)

3-Person Group

Long press the button A on a Master and 2 Level 1, release after the 1st “Beep” sound and hear “Connecting and Pairing”, then restart the headsets. (Power On Sequence: Master → Level 1)

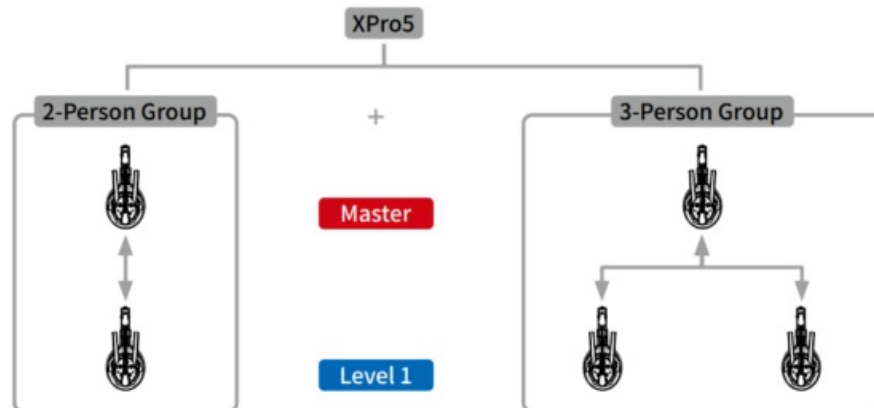

4.2 Combine Into One Group

1. Only keep one Master, and set the other headsets as Level 1 if needed. (See 2. Master/ Level 1 Settings).
2. Pair all headsets and restart (see 3. Pairing/Unpairing).

EG. Combine 2 groups(A 2-Person Group and A 3-Person Group) into 1 group

1. Keep 1 Master, set 4 Level 1 (See 2. Master/Level 1 Settings).
2. Pair headsets in sequence: Pair Master with Level 1 (See 3. Pairing/Unpairing).
3. Restart all headsets after successfully connecting(Power on sequence: Master → Level 1).

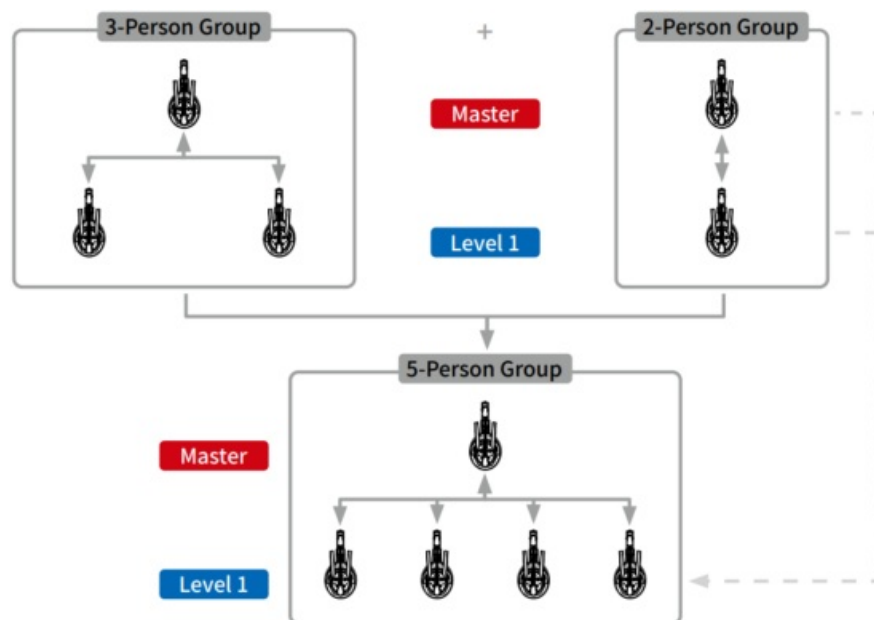

5. Volume Settings

Short press the volume up/down button to increase/decrease the volume.

6. Noise Cancellation

Short press the B button to turn on/off the noise cancellation feature.

7. Mute/Unmute

Rotate the boom arm up/down (see the picture below) to mute/unmute.

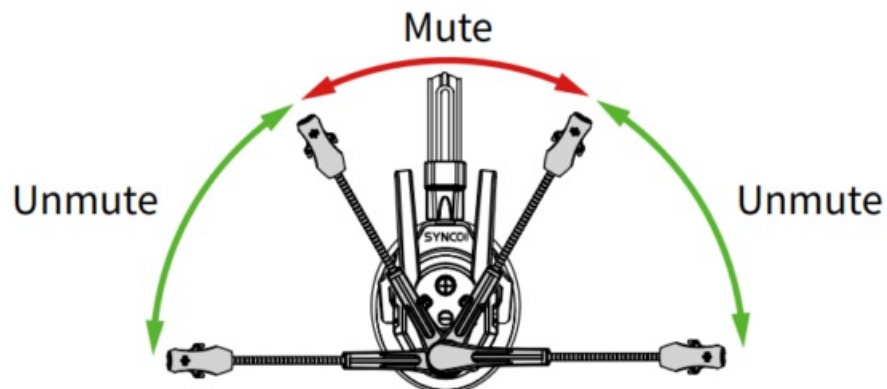

8. Dominant Mode

Press and hold the button B of Master to enter the dominant mode for muting other headsets. Other headsets are still available for listening and only the Master is available for speaking. Release the button B to exit dominant mode.

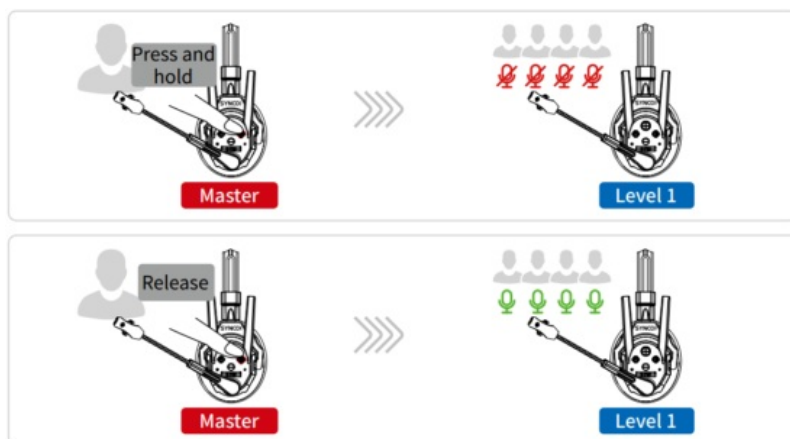

9. Boost Mode

When poor signal, switch the Boost Mode to amplify the signal, improving communication clarity and stability, and reducing interruptions and disconnections.

Long press the volume-, release after the 1st “Beep” sound to switch the mode and hear “Mode 1/Mode 2/Mode 3”.

*The operation is only available by Master.

* Mode 2 by default.

*After changing the Mode, if Level 1 is restarted, please pair it with the upper-level headset again to rejoin the communication group.



10. Real-Time Monitoring

Connect the device(Camera, Camcorder, etc.) with the Xtalk headset via 3.5mm TRS port for monitoring the audio from the device.

*This port is only for monitoring and is not the outputting port.

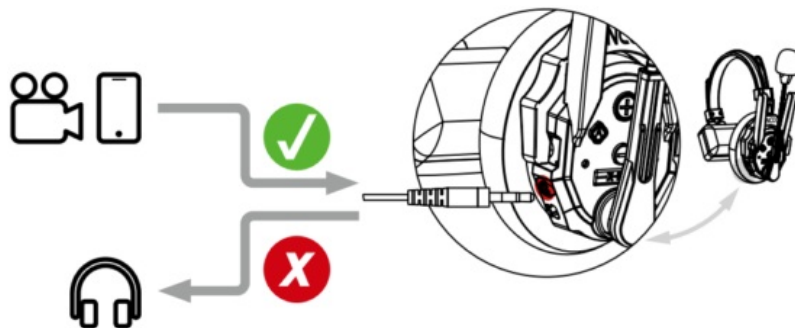

11. Powering

Via Replaceable Battery Power

Push down the toggle of the battery case then pull the case door outward to place/remove the battery.

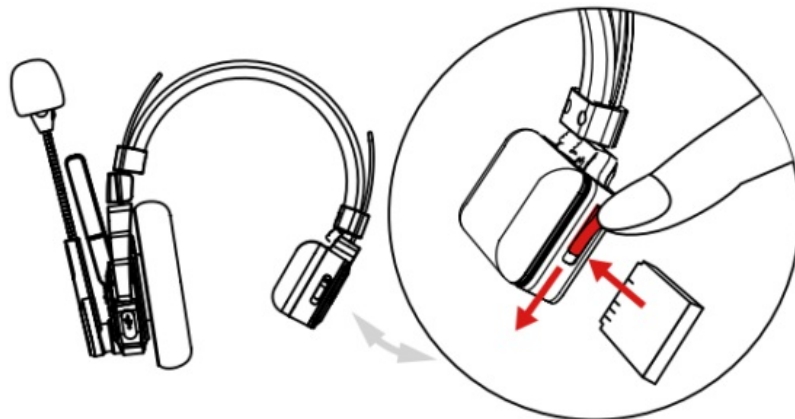

12. Indicator Light Status

Green Light Steady	Connection Successful
Green Light Flashing Slow	Not Connected
Green/Yellow Lights Alternating	Noise Cancellation Off
Red Light Flashing Slow	Low Battery
Red Light Steady	Charging

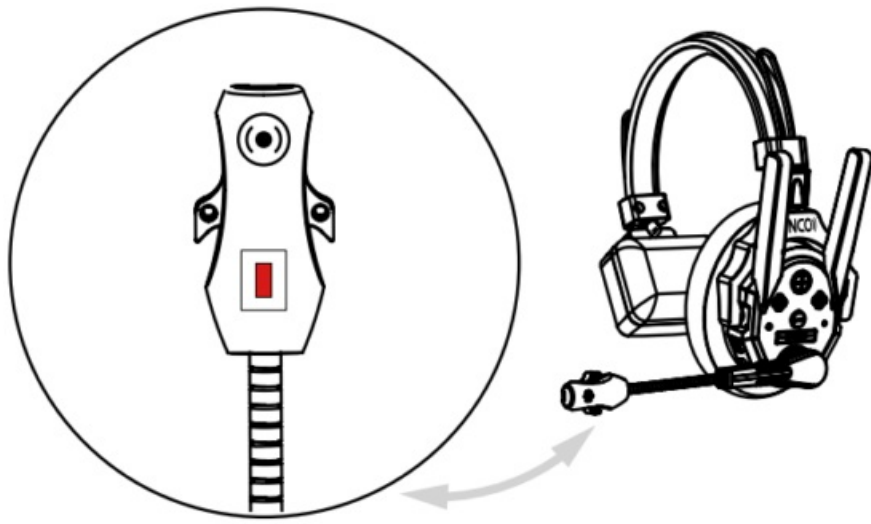

Specifications

Wireless Technology	Digital 2.4GHz
Transmission Mode	Full-Duplex
Operating Range	500m (LOS)
Frequency Band	2.4GHz
Latency	About 120ms
Approximate RF Sensitivity	<-90dBm
Radio Output Frequency	20dBm
Power	USB-C 5V
Battery Capacity	1050mAh Li-ion Battery
Working Time	24H
Charging Time	About 2.5H
Frequency Response	150Hz~7KHz
Signal-To-Noise Ratio	≥ 65dB
Distortion	<1 %
Microphone Type	Condenser Microphone
Max Input Sound Pressure Level	>115dBSPL
Output Sound Pressure Level	Typical 98+3dBSPL(at 94dBSPL 1KHz)
Weight	About 188g Battery Included
Temperature Range	0~+45° C(Working Status -20~+60° C(Storage Condition)

Packing List

XPro1



Headset x1

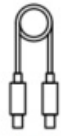

Charging Cable
x1



Carrying
Bagx1



Rechargeable
Battery x1



One-Ear Foam
Cushion x1



Mic Windshield
x1



Warranty
Card x1

XPro2



Headset x2

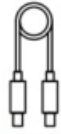

Charging Cable
x1



Carrying Bag
x2

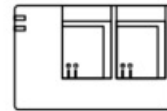

Charging
Station x1



One-Ear Foam
Cushion x2



Mic Windshield
x2



Rechargeable
Battery x2



Warranty Card
x1

XPro5



Headset x5



Storage Bag x1

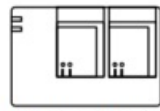

Charging Station
x3

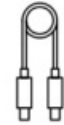

Charging
Cable x3



Carrying
Bag x5



Rechargeable
Battery x5



One-Ear Foam
Cushion x5



Mic Windshield
x5



Warranty
Card x1

Caring For Your SYNCO Product

- Please keep the product in a dry, clean, dust-free environment.
- Keep corrosive chemicals, liquids, and heat sources away from the product to prevent mechanical damage.
- Use only a soft and dry cloth for cleaning the product.
- Malfunction may be caused by dropping, the impact of external force.
- Do not attempt to disassemble the product. Doing so voids the warranty.
- Please have the product checked or repaired by authorized technicians if any malfunctions happen.
- Failure to follow all the instructions may result in mechanical damage.
- Warranty does not apply to human errors.

WARRANTY

Warranty Period

Thank you for purchasing SYNCO products.

1. Customers are entitled to free replacement or repair service in case of quality defect(s) found in the product

under normal use within 30 days upon receipt of the product.

2. Original SYNCO products are entitled to 12-month limited warranty service. The warranty period begins on the date of purchase of brand new, unused products by the first end-user.

Within the warranty period, if product defect or failure is attributable to material defection or technological problem, the defective product or defective part will be repaired or replaced without charge (service and materials fee).

Warranty Exclusions and Limitations

1. Faults resulted from inappropriate use of a product without following its operation specification
2. Artificial damage, e.g. crash, squeeze, scratch, or soaking
3. Modifications to a product by its user or a third party without prior written consent of SYNCO, e.g. replacement of element or circuit, label alteration
4. The code on product is inconsistent with that of warranty certificate, or the code on the product or warranty certificate is altered or torn off
5. All consumable accessory attached to a product, like cable, wind muff, battery
6. Faults as a result of force majeure, such as fire, flood, lightning, etc.

Warranty Claim Procedure

1. If failure or any problem occurs to your product after purchase, please contact a local agent for assistance, or you can always contact SYNCO's customer service through email at support@syncoaudio.com.
2. Please retain your sales receipt and warranty certificate as proof of purchase. If any of these documents is missing, only sales return or chargeable service will be provided.
3. If the SYNCO product is out of the warranty coverage, the service and the parts cost will be charged.

Guangzhou Zhiying Technology Co., Ltd

 Room 2401, 24 / F, South Tower, Lisheng Plaza,
No. 68 Huadi Avenue, Liwan District, Guangzhou,
China, 510000

 support@syncoaudio.com

 www.syncoaudio.com

 <https://www.facebook.com/syncomicrophones>

Documents / Resources

	<p>SYNCO Xtalk XPro Full Duplex Wireless Intercom Headset System [pdf] User Manual Xtalk XPro Full Duplex Wireless Intercom Headset System, Xtalk XPro, Full Duplex Wireless Intercom Headset System, Duplex Wireless Intercom Headset System, Wireless Intercom Headset System, Intercom Headset System, Headset System</p>
---	--

References

-  [SYNCO | Branded Microphone Manufacturer](#)
- [User Manual](#)

[Manuals+](#), [Privacy Policy](#)

This website is an independent publication and is neither affiliated with nor endorsed by any of the trademark owners. The "Bluetooth®" word mark and logos are registered trademarks owned by Bluetooth SIG, Inc. The "Wi-Fi®" word mark and logos are registered trademarks owned by the Wi-Fi Alliance. Any use of these marks on this website does not imply any affiliation with or endorsement.