

SwitchBot

Robot Vacuum K20 Plus Combo User Manual

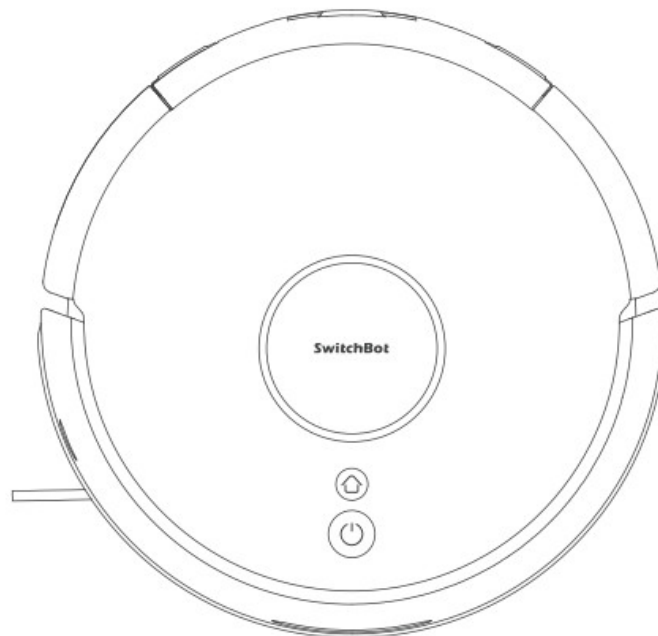

Please read this user manual carefully before using your device.

Contents [[hide](#)]

- 1 W3000320 K20 Plus Combo Robot Vacuum
- 2 Product Overview
- 3 Preparing for Use
- 4 Instructions for Use
- 5 Care and Maintenance
- 6 Troubleshooting
- 7 IMPORTANT SAFETY INSTRUCTIONS
- 8 Documents / Resources
 - 8.1 References

W3000320 K20 Plus Combo Robot Vacuum

Thank you for choosing SwitchBot!

This manual will guide you through a comprehensive understanding and quick installation of this product, and provide important information on product usage and maintenance to help you achieve the best product experience.

If you have any questions during use, please call the service hotline or contact the official email. Switch Bot technical support experts will answer your questions.

Setup and Troubleshooting: support.switch-bot.com

Customer Support: support@switch-bot.com



User Manual

<https://www.switch-bot.com/pages/switchbot-user-manual>

Product Overview

List of Components

Robot

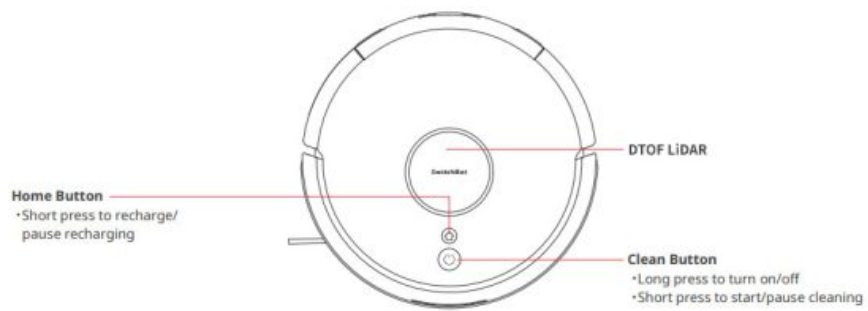

Robot Top View

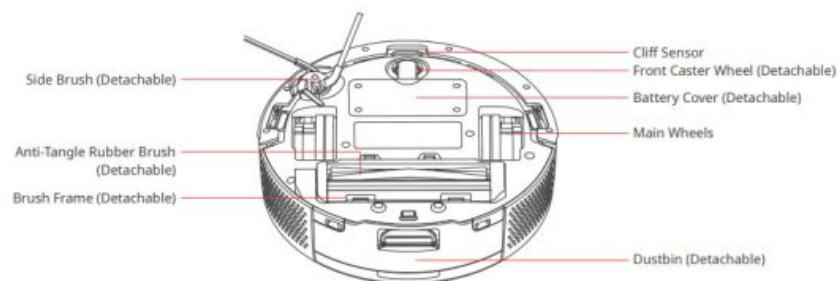
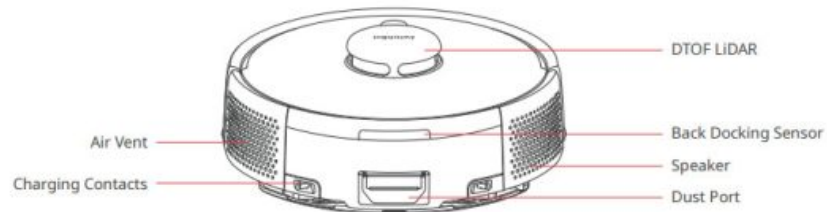

Robot Bottom View

Dustbin

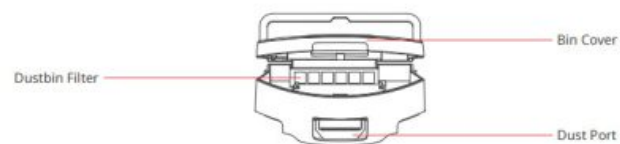

Dual Empty Station

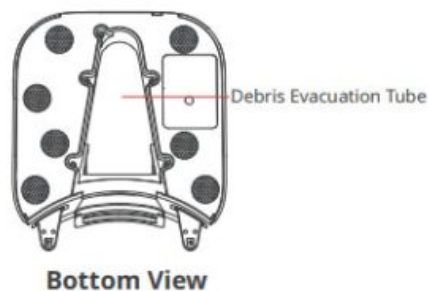
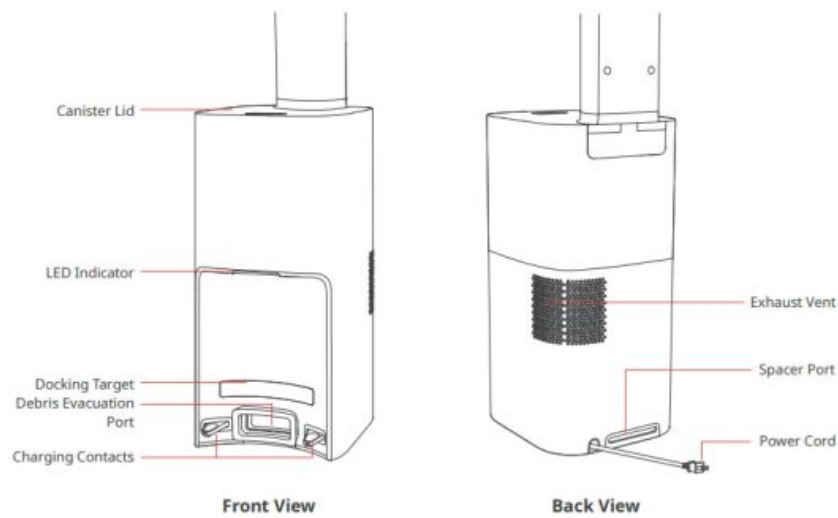

Preparing for Use

Decluttering

Before starting the robot, please check the floor and clean up any scattered items such as wires, socks, slippers, children's toys, etc. to improve the efficiency of the robot. Clear the floor of hard or sharp objects (e.g., nails, glass), and move away items that are fragile, valuable, or potentially dangerous to avoid being caught, tangled, or knocked over by the robot, causing personal injury or property damage.



Before cleaning, please use a physical barrier to avoid areas where robot may fall or get stuck, ensuring the safety and smooth operation of your robot.

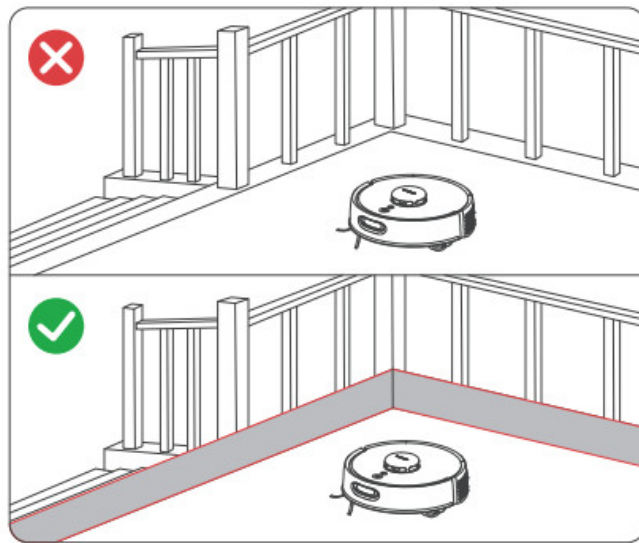

Open the doors of the rooms to be cleaned, arrange the furniture neatly, and try to clear a largest cleaning space.

Please avoid standing in front of your robot, doorways, or narrow passages in case your robot cannot detect the area to be cleaned.



1. When using the robot for the first time, follow it throughout its whole cleaning route and watch for potential problems. This will help you identify and resolve minor issues, ensuring a more efficient cleaning process in the future.
2. If the robot gets stuck under low furniture, you can try the following solutions:
 1. Block the bottom of the furniture;
 2. Set a virtual wall in the app to prevent the robot from entering;
 3. If possible, raise the furniture slightly.

Placing the Dual Empty Station

1. Place the Dual Empty Station on a hard, level surface (such as a floor or ceramic tile) against a wall, ensuring there is at least 1 m (3.3 ft.) of space in front and above, and 0.5 m (1.6 ft.) on both sides. Make sure the location has a good Wi-Fi signal to provide a better network connection and app user experience.
2. Plug the Dual Empty Station into an outlet, ensure the indicator light turns on.

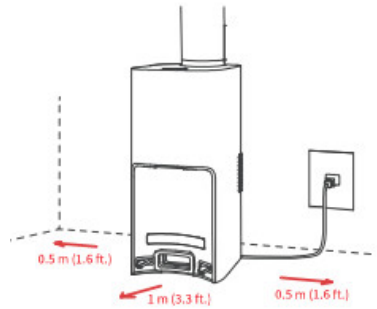

- The power cord may be dragged by the robot if hanging on the ground, causing the Dual Empty Station to move or disconnect from power.
- The indicator light on the Dual Empty Station will stay on when powered, and turn off when the robot is charging.
- If there is an issue with the Dual Empty Station, the indicator light will turn red and stay on as a reminder.
- Make sure to place the Dual Empty Station on a level indoor surface, away from open flames, heat sources, water, narrow spaces, or areas where the robot may fall.
- Placing the Dual Empty Station on non-hard surfaces (such as carpets, mats, etc.) poses a risk of tipping over, and the robot may not be able to leave the Dual Empty Station properly.
- Do not place the Dual Empty Station under direct sunlight or block its signal emitter area with any objects, as this may prevent the robot from returning automatically.
- Please maintain the Dual Empty Station according to the maintenance instructions and avoid using wet cloths or wipes for cleaning.

Preparing Your Robot

Removing the protective foam strips

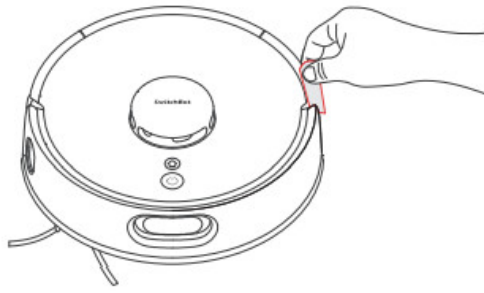

Installing the Side Brush

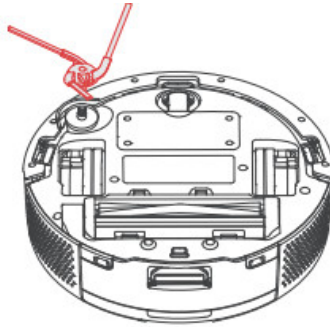

When you hear a clicking sound, it means the Side Brush has been properly installed.

Powering on and charging

1. Remove the faceplate as shown in the picture, and turn on the Power Switch. "I" means powered on, and "O" means powered off.

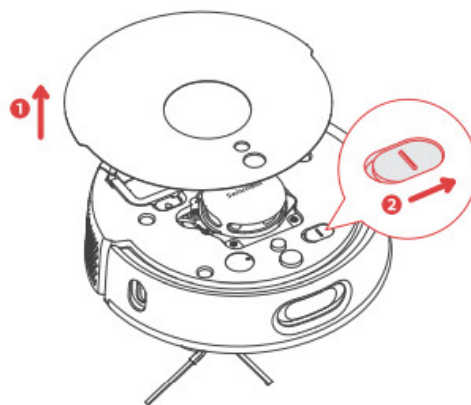

2. Wait for the indicator light on your robot to turn on, then manually dock your robot to the Dual Empty Station to charge, as shown in the picture. You will hear the voice prompt "Charging".

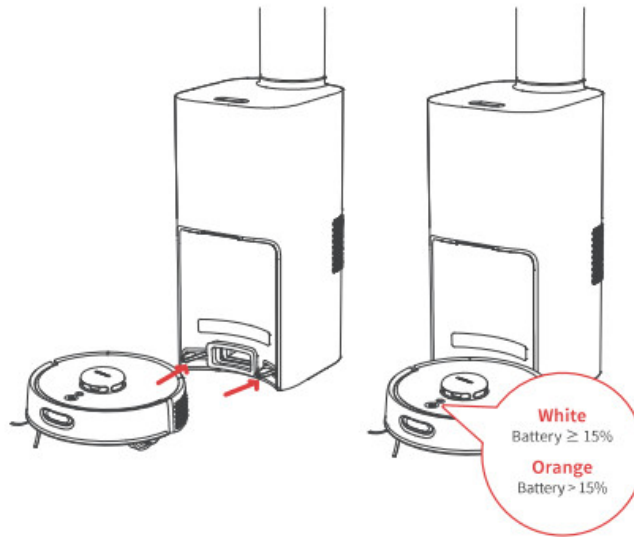

Before the initial use of the robot, it's advised to charge it for 3 to 4 hours. If it fails to turn on, it may be due to low battery. Please dock the robot directly to the Dual Empty Station.

Instructions for Use

Connecting to Our App

1. Download the SwitchBot app to experience more personalized settings and a better user experience.

You will need:

- A smartphone or tablet using Bluetooth 4.2 or later.
- The latest version of our app, downloadable via the Apple App Store or Google Play Store.
- A SwitchBot account, you can register via our app or sign in to your account directly if you already have one.



<https://apps.apple.com/cn/app/switchbot/id1087374760>

<https://play.google.com/store/apps/details?id=com.theswitchbot.switchbot&hl=en>

iOS and Android system requirements:

<https://support.switch-bot.com/hc/en-us/articles/12567397397271>



2. Open our app, tap the “+” icon at the right-hand corner of the home page, select Add Device.
3. Find the device icon and select, follow the instructions to add your device.

Starting Your Robot

Vacuuming

Press the  button to start cleaning, or control via our app.

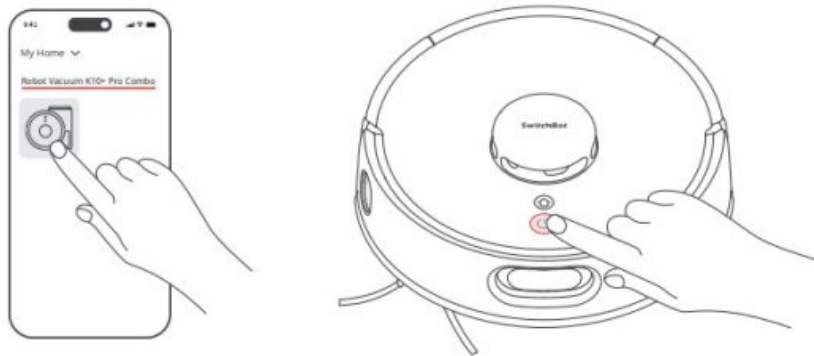

Mopping

1. Find the mopping pad plate in the package.

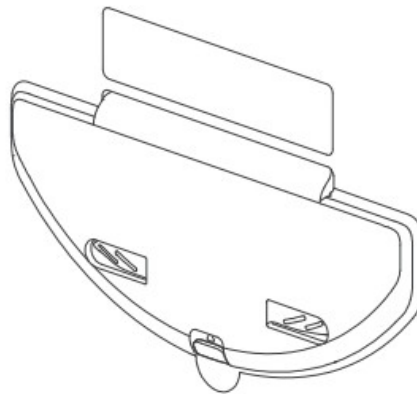

2. Attach a mopping cloth to the mopping pad plate.

Option 1: Use the original mopping cloth



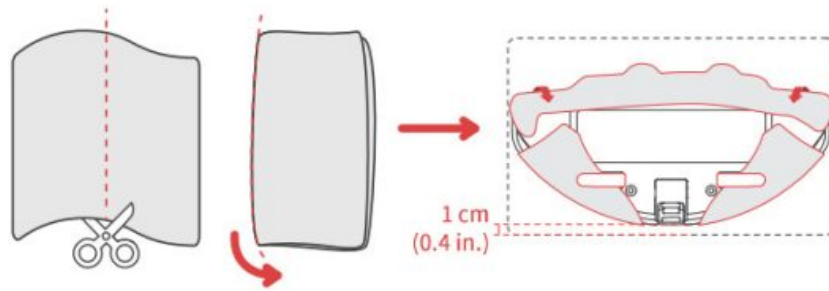

Option 2: Use a common mopping cloth

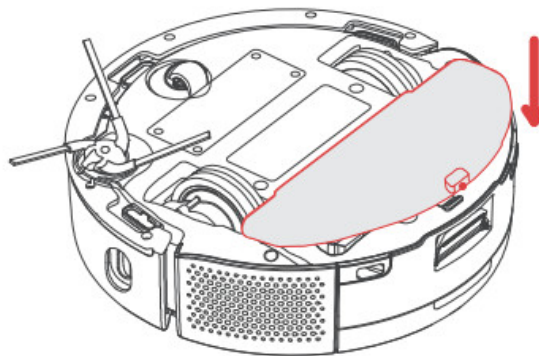

Dimensions of a common mopping cloth is usually approx. 30 × 20 cm (11.8 × 7.9 in.), while your robot's mopping pad plate is compatible with 20 × 15 cm (7.9 × 5.9 in.) cloth. If you use a common mopping cloth, fold or cut it in half before attaching to the mopping pad plate.

3. Cover the mopping pad plate on the Anti-Tangle Rubber Brush.



4. Press the  button to start mopping, or control via our app.



- 1 Set no-go zones in the app so your robot won't mop and wet areas like carpets.

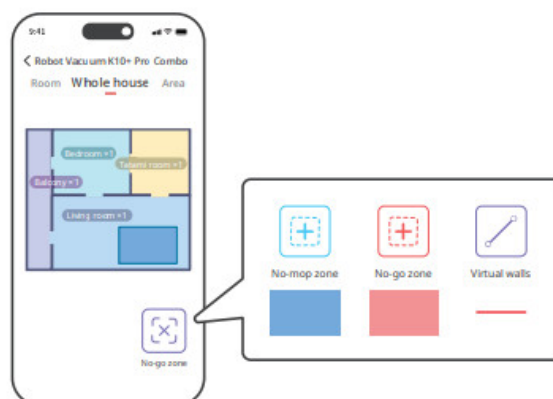

- 2 The mopping cloth will become dry after 20 or 30 minutes of use. It is recommended to only mop designated rooms or areas set in the app.

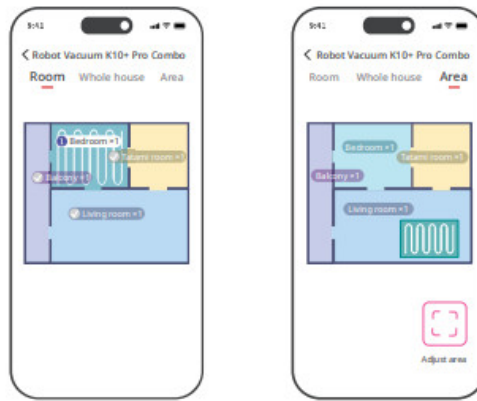

3 The dry mopping cloth can still wipe away some dust or hair, but it is not as effective as when it's wet. Please replace the dry mopping cloth in time when mopping.

Pausing Your Robot

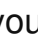
Press any button on your robot to stop it while working. When paused, tap the  button to resume the previous cleaning task, tap the  button to finish the task, and your robot will return to the Dual Empty Station to recharge.

Recharging

After finishing a cleaning task, your robot will automatically return to the Dual Empty Station to recharge. To manually send it back to recharge, press the  button on your robot. The indicator light will be pulsing when charging.



Note

If the robot cannot find the station, it will automatically return to the starting position. Please manually dock it to the station for charging.

Hibernation

If your robot is not operated for more than 10 minutes, it will automatically enter hibernation. Press any button to wake it up.



Note

The robot will not enter hibernation while charging.

Do Not Disturb Mode



The default setting for this mode is from 22:00 to 08:00, and you can modify or disable this function via our app. During the Do Not Disturb period, device button lights will stay

off, and your robot will not automatically resume cleaning or play voice prompts.

Child Lock

You can use the Child Lock function in our app to lock the robot buttons. You can remove this function via our app.

Restoring Factory Settings

Press and hold the  button,  button, and DTOF LiDAR for 6s at the same time until you hear the voice prompt.

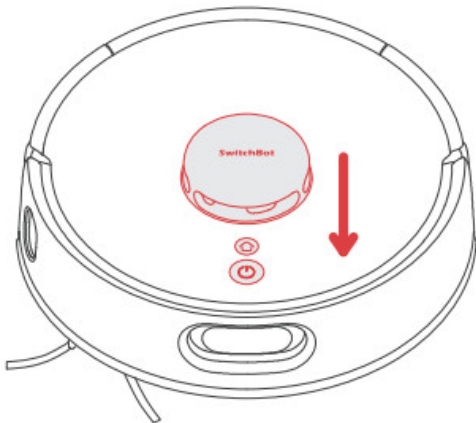

Care and Maintenance

To keep your robot running at peak performance, perform the procedures on the following pages.

If you notice the robot picking up less debris from your floor, empty the bin, clean the brushes, and clean or replace the filter if needed. Replace the dust bag in time when it is full.

Part	Care Frequency	Replacement Frequency
Dust Bag		Every 70 days
Bin	Wash bin as needed	
Cliff Sensor	Clean once a month or when prompted by the app	

Filter	Clean once a month or when prompted by the app	Every 2 or 3 months
Front Caster Wheel	Clean once a month. Clean more if your pet sheds a lot.	Every 12 months
Side Brush	Clean once a month. Clean more if your pet sheds a lot.	Every 12 months
Anti-Tangle Rubber Brush Brush	Clean once a month. Clean more if your pet sheds a lot.	Every 12 months

Replacement frequency may vary. Parts should be replaced if visible wear appears.

If you need to purchase accessory kits, please visit authorized channels or our official website www.switch-bot.com

Daily Maintenance (Robot)

Open the Canister Lid and find the cleaning tool.

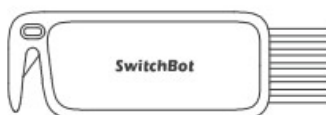

Cleaning the Bin and Filter

1. Open the faceplate and remove bin.

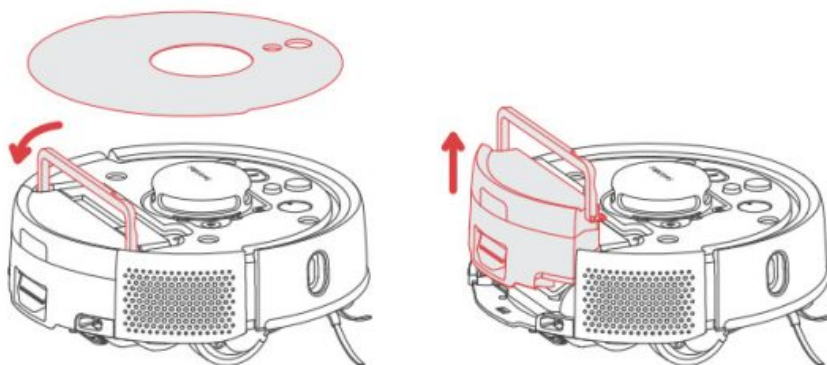

2. Press the red area (marked in the picture) to open and empty the bin.

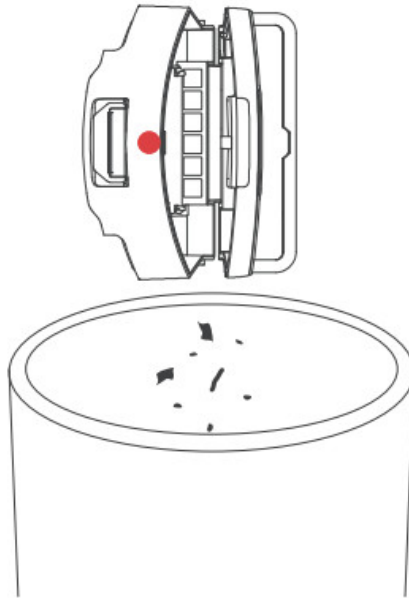

3. Remove the filter and tap to clean it.

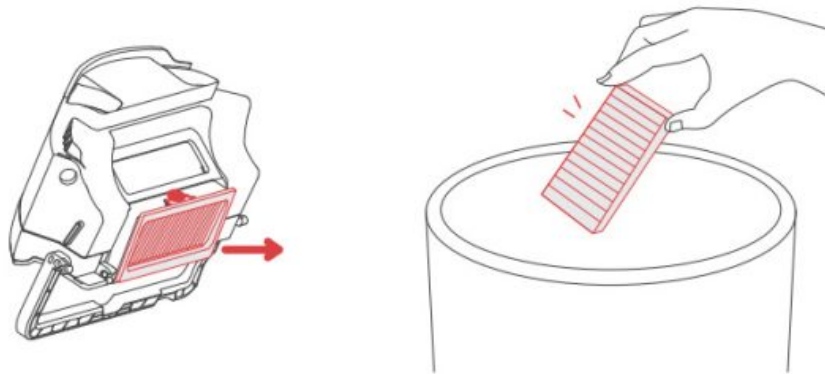

4. Rinse the bin and filter using warm water and completely dry them.

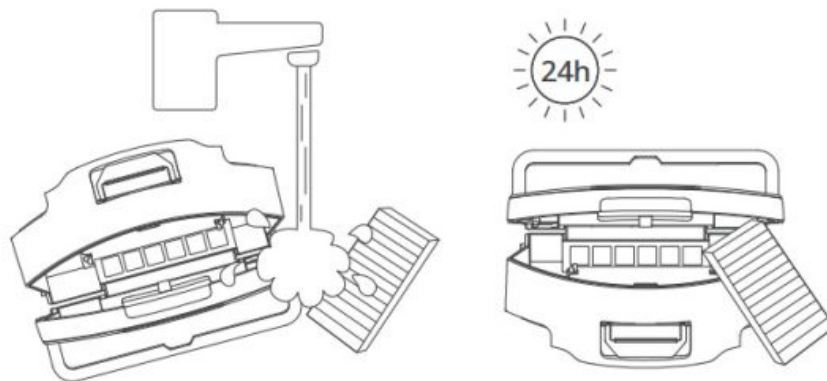

5. Reinstall the filter and bin back in the robot.

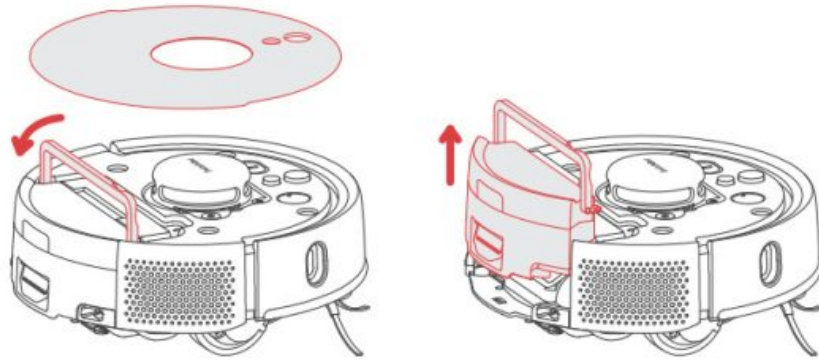

Cleaning the Mopping Pad Plate

1. Remove the mopping pad plate and throw away the disposable mopping cloth. Wash the pad plate with water.

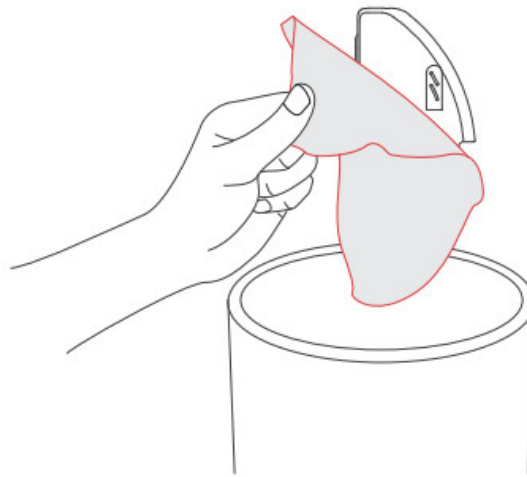

2. Place the Mopping Pad Plate on the Canister Lid.

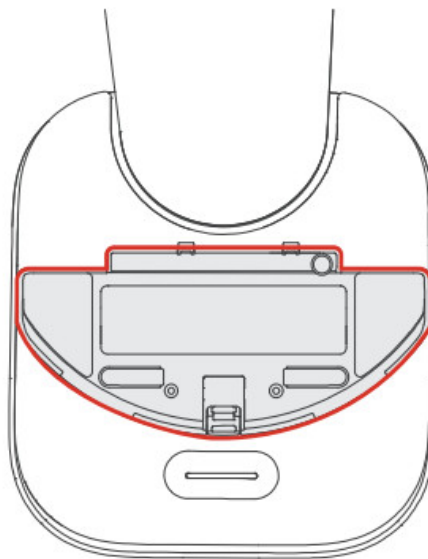

Cleaning the Side Brush

1. Pull to remove the Side Brush.

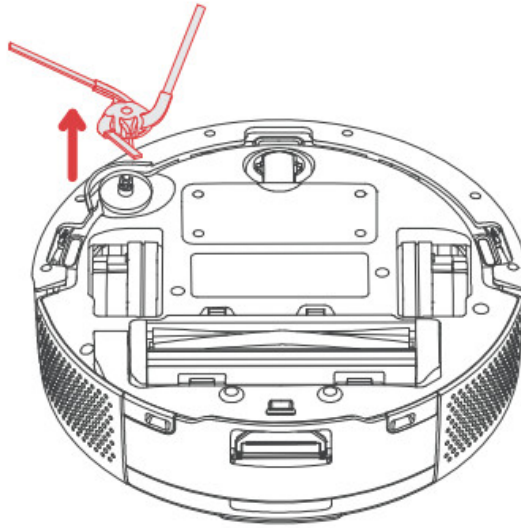

2. Remove any hair or debris and replace the brush.
3. Align and reinstall the brush.



Replace the Side Brush once every year.

Cleaning the Front Caster Wheel

1. Pull firmly on the front wheel to remove it from the robot.

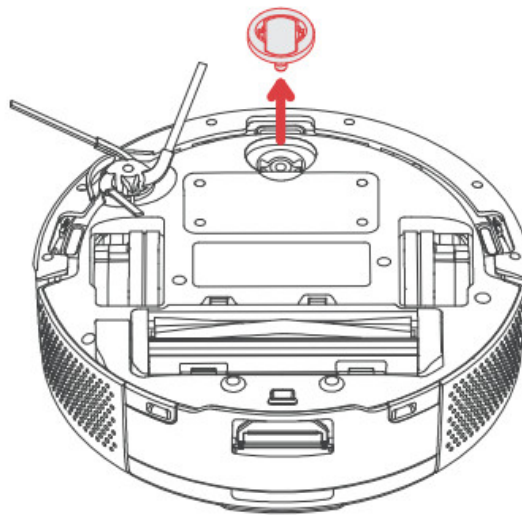

2. Remove any debris from inside the wheel cavity.
3. Reinstall the wheel. Make sure the wheel clicks into place.



Replace the Front Caster Wheel once every year.

Cleaning the Anti-Tangle Rubber Brush

1. Remove the brush frame and lift the brush from the left side.

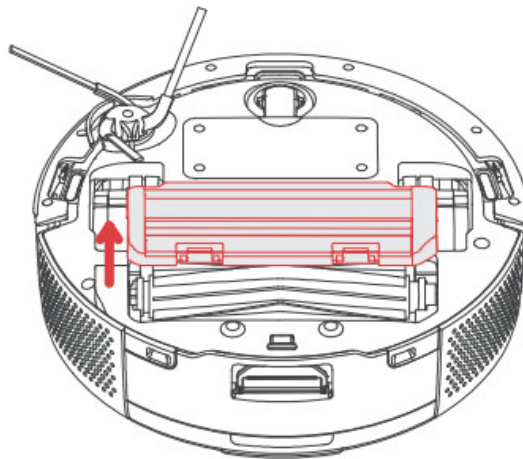

2. Remove and clean hair and debris from the brush caps. Remove hair from the brush.

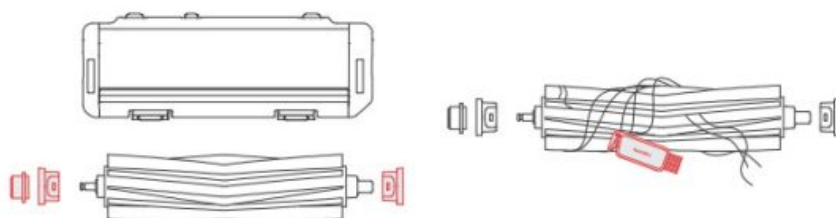

3. Reinstall the brush caps into place.



Replace the Anti-Tangle Rubber Brush every 12 months.

Cleaning Sensors and Charging Contacts

Wipe sensors and charging contacts with a clean, dry cloth.

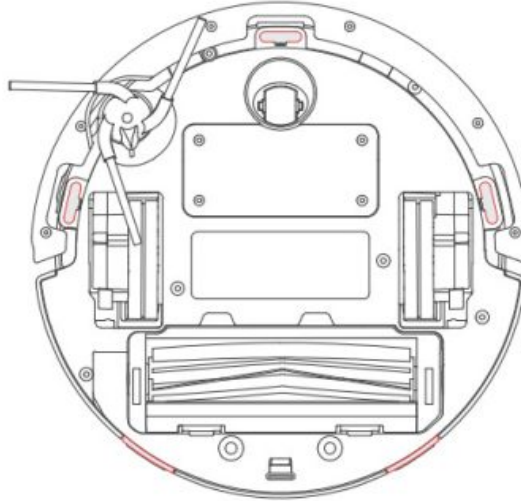
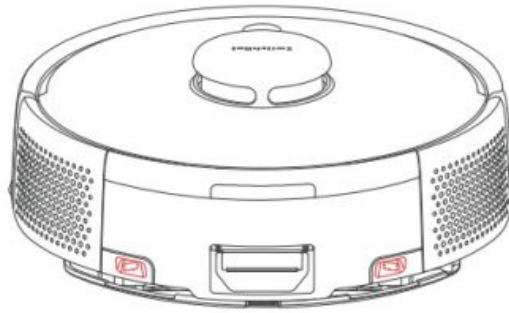

Note

Do not spray cleaning solution or water onto the sensors, sensor openings or charging contacts.

Replacing the Dust Bag

1. Lift up on the canister lid to open.
2. Pull up on the hard paper card to remove the bag from the canister.

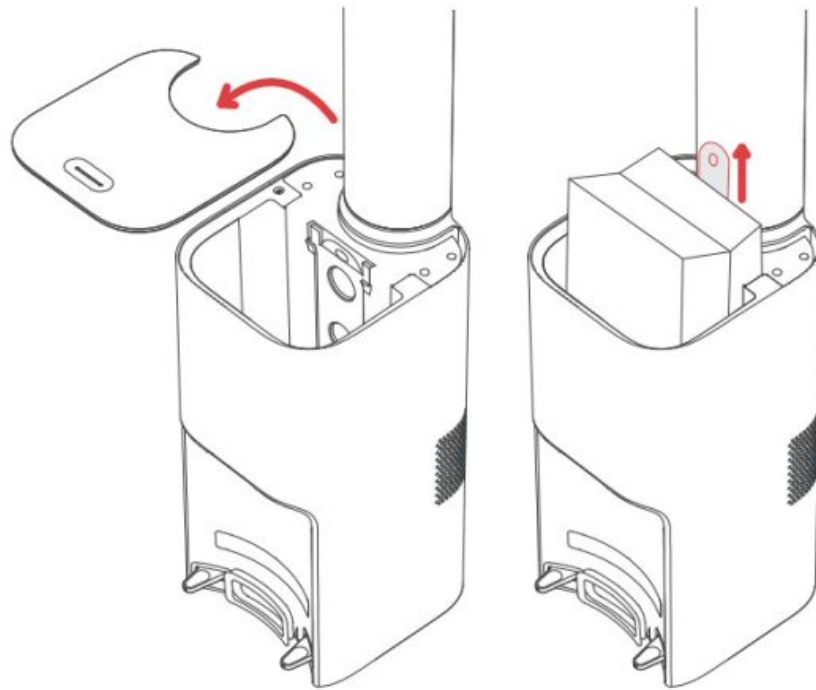

3. Discard the used bag.
4. Install a new bag, sliding the card into the guide rails. Press down on the lid, making sure it is completely closed.

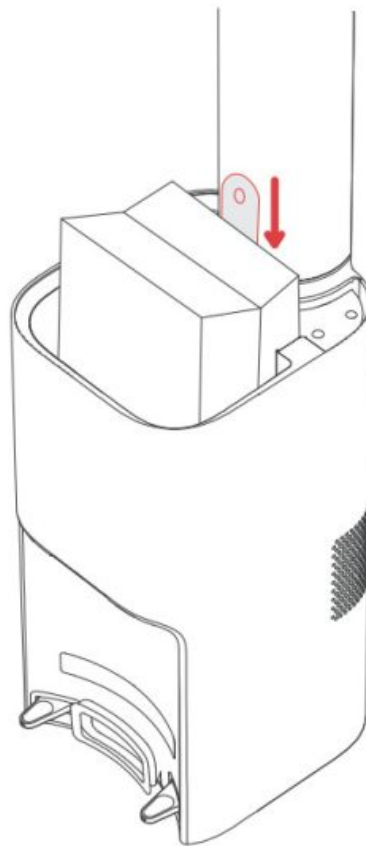

Troubleshooting

Common Issues

Unable to power on

- The battery level is low. Put the robot on the charging station and charge it before use.
- The ambient temperature is too low or too high. Only use the robot within the range of 4°C to 40°C (39°F to 104°F).

Unable to charge

- The station is not powered, please make sure both ends of the power cord are plugged in properly.
- Poor contact, please clean the charging contacts on the station, robot, and vacuum cleaner.

Network connection failure

- Incorrect Wi-Fi password, please enter the correct Wi-Fi password.
- Switch to a 2.4GHz network for pairing, as 5GHz networks and enterprise routers are not supported.
- Keep the robot within a range with good Wi-Fi signal strength.
- The robot may not be in the ready-to-configure state, exit the app and re-enter, then follow the pairing steps to try again.

Unable to create partition map in the app

- The robot needs to start mapping from the station, it is recommended to use the Fast Mapping feature.
- Do not move the robot during the first mapping process to avoid locating failure.
- If the robot does not return to the station after completing the first mapping task, check and remove any obstacles on the ground.

Cannot locate the station, unable to return

- The station is powered off or the robot was moved.
- The charging route is blocked, such as by a closed door.
- Too many obstacles near the station, please place it in an open area.
- After moving the robot, it will relocate itself. If locating fails, it will generate a new map. If the Dual Empty Station is too far away, it may not be able to recharge, please

manually dock the robot to charge.

- Wipe the signal emission area of the station in case there is dust or dirt.
- Gently wipe the Front Docking Sensor of the robot with a soft, dry cloth and keep the lens clean and unobstructed.

Slow charging speed

- The robot takes about 6 hours to charge from low to full battery.
- In high or low-temperature environments, the robot will automatically reduce charging speed to extend battery life.
- The charging contact area may be dirty, please wipe it with a dry cloth.

Abnormal behavior

- Please turn off and restart the robot.

Side Brush fell off

- Please reinstall the Side Brush, making sure to hear a “click” to indicate it is in place.
- The Side Brush may have fallen off due to tangled wires. Please clear wires on the floor before use.

Ground not cleaned up

- The dustbin is full. Please empty it.
- The filter may be clogged with dust. Please check and clean as necessary.
- The filter is not dry after cleaning. Please let it air dry before using.

Dust leaked while working

- Remove the Anti-Tangle Rubber Brush and dustbin, and clear any debris near the Anti-Tangle Rubber Brush.

Loud operating noise

- The dustbin is full. Please empty it.

- Hard objects may be tangled in the Anti-Tangle Rubber Brush and dustbin. Please check and clean as necessary.
- The Side Brush and Anti-Tangle Rubber Brush may be tangled with debris. Please check and clean as necessary.
- You can lower the suction power of the robot to Quiet or Low if necessary.

Abnormal sound emitted while moving

- Rotate and press the wheels to check for any debris tangled or stuck. Clean the debris or contact customer service if the issue persists.

Random movement path

- Loose wires, slippers, and other objects on the floor may affect the robot's normal operation. Please tidy up before use.
- Working on wet and slippery floors may cause the wheels to slip. Please manually wipe or air dry the floor before using.

Stopped due to being stuck

- The robot may be stuck under furniture of a similar height. Consider raising the furniture, manually blocking or using our app to set a virtual wall to avoid the area.
- Check the corresponding area for any wires, curtains, or carpet edges that may be tangled with or obstructing the robot. Manually remove any obstructions for smooth operation.

Missed cleaning some rooms

- Please ensure all room doors are fully opened.
- Check if there is a doorsill higher than 1.8 cm (0.7 in.) at the entrance of the room.
- If the entrance is slippery, causing the robot to skid and malfunction, it is recommended to manually clean up the water on the floor.

Frequently entered No-go Zones or passed Virtual Walls

- Check the app to see if the current map is abnormal. You can restore the map in Maps via our app.
- When setting virtual walls or No-go Zones, adjust the boundaries according to the home environment, making sure to include areas where the robot may get stuck (such as sunken steps, furniture bottoms, etc.).

Ongoing cleaning task interrupted

- When the robot's battery is depleted, it will automatically shut down.

Note: If the robot cannot be charged by the Dual Empty Station, the possible cause is that the station is not connected to power or there is poor contact between the robot and the station. Please check if the power supply is connected properly.

Didn't resume cleaning after being fully charged

- Make sure the robot is not in Do Not Disturb mode, as it will not resume cleaning in this mode.
- If the robot is manually docked to the station or is sent to the station by pressing the  button, it will not resume cleaning after being fully charged.

Scheduled cleaning not performed

- The cleaning will only start when the remaining battery is more than 20%.

Didn't empty dust after returning

- The robot will not empty dust during the Do Not Disturb time period.
- Please check if the dust bag is full. Replace the dust bag in a timely manner, preferably every 1 to 2 months.
- If the dust bag is not full, check for blockages in the Debris Evacuation Port and the bottom Debris Evacuation Tube of the station. Remove any blockages before using.

LED Indicator on the Dual Empty Station stays orange



- The dust bag is not in position. Please check and install it correctly.

- The dust bag is full. Please check and replace with a new dust bag.
- The canister lid of the Dual Empty Station is not closed. Please check and close it tightly.

LED Indicator Light Status

LED Indicator Light	Descriptions
Solid White	The robot is fully charged or cleaning properly.
Slowly Flashing White	The robot is charging.
Blinking White	The robot is ready to configure Wi-Fi.
Solid Orange	Low battery.
Blinking Orange	The robot has run out of power or an error occurred.

Network Reconfiguration

Press and hold the  and  buttons for 3 seconds to reconfigure your Wi-Fi network.

Firmware Upgrades

In order to improve user experience, we will regularly release firmware updates to introduce new functions and solve any software defects that may occur during usage. When a new firmware version is available, we will send an upgrade notification to your account via our app. When upgrading, please make sure your product has sufficient battery or stay powered on and make sure your smartphone is within range to prevent interference.

Specifications

Robot Vacuum

Material: ABS

Size: 248 x 248 x 92 mm (9.8 x 9.8 x 3.6 in.)

Weight: Approx. 2.3 kg (81.1 oz.)

Rated Power: 40 W

Battery Voltage: 14.4 V

Battery Capacity: 3200 mAh

Operating Temperature: 0 °C to 30 °C (32 °F to 86 °F)

Connectivity: 2.4 GHz Wi-Fi, Bluetooth 4.2 or later

Dual Empty Station

Size: 195 x 297 x 410 mm (7.7 x 11.7x 16.1 in.)

Rated Input: 24 V-2.86 A

Rated Power (Charging): 75 W

Rated Power (Emptying Dust): 650 W

CE Warning

For SwitchBot Vacuum Cleaner and SwitchBot Robot Vacuum Dual Empty Station

To comply with RF exposure requirements, a minimum separation distance of 20 cm must be maintained between the user's body and the device, including the antenna. Use only the supplied or an approved antenna. This device is in compliance with the essential requirements and other relevant provisions of directive 2014/53/EU. All essential radio test suites have been carried out.

For SwitchBot Cordless Vacuum Cleaner

RF exposure information: The EIRP power of the device at maximal case is below the exempt condition, 20mW specified in EN 62479: 2010. RF exposure assessment has been performed to prove that this unit will not generate the harmful EM emission above the reference level as specified in EC Council Recommendation(1999/519/EC).

CE DOC

Hereby, Woan Technology (Shenzhen) Co., Ltd. declares that the radio equipment type is in compliance with Directive 2014/53/EU. The full text of the EU declaration of conformity is available at the following internet address: support.switch-bot.com

This product can be used in EU member states and UK. Manufacturer: Woan Technology (Shenzhen) Co., Ltd.

Address: Room 1101, Qiancheng Commercial Center, No. 5 Haicheng Road, Mabu Community, Xixiang Subdistrict, Bao'an District, Shenzhen, Guangdong, P.R.China, 518100
CE representative: XDH Tech
Address: 2 Rue Coysevox Bureau 3, Lyon, France
Operation frequency (Max power) Wi-Fi: 2412 MHz to 2472 MHz (< 20 dBm) BLE: 2402 MHz to 2480 MHz (< 10 dBm) Operation temperature: 4 °C to 35 °C (39 °F to 95 °F)

FCC Warning

This device complies with Part 15 of the FCC Rules. Operation is subject to the following two conditions:(1) This device may not cause harmful interference.(2) This device must accept any interference received, including interference that may cause undesired operation.

NOTE: This equipment has been tested and found to comply with the limits for a Class B digitadevice, pursuant to part 15 of the FCC Rules. These limits are designed to provide reasonableprotection against harmful interference in a residential installation.

This equipment generates uses and can radiate radio frequency energy and, if not installed andused in accordance with the instructions, may cause harmful interference to radio communicationsHowever, there is no guarantee that interference will not occur in a particular installation. If this equipment does cause harmful interference to radio or television reception, which can be determined by turning the equipment off and on, the user is encouraged to try to correct the interference by one or more of the following measures:

- Reorient or relocate the receiving antenna.
- Increase the separation between the equipment and receiver.
- Connect the equipment into an outlet on a circuit different from that to which the receiver is connected.
- Consult the dealer or an experienced radio/TV technician for help.

NOTE: The manufacturer is not responsible for any radio or TV interference caused by unauthorized modifications to this equipment. Such modifications could void the user's authority to operate the equipment.

FCC Radiation Exposure Statement

For SwitchBot Vacuum Cleaner and SwitchBot Robot Vacuum Dual Empty Station

This equipment complies with FCC radiation exposure limits set forth for an uncontrolled environment. This equipment should be installed and operated with minimum distance 20 cm between the radiator & your body.

For SwitchBot Cordless Vacuum Cleaner

The device has been evaluated to meet general RF exposure requirement. The device can be used inportable exposure condition without restriction.

IC Warning

This device contains license-exempt transmitter(s)/receiver(s) that comply with Innovation, Science and Economic Development Canada’s license-exempt RSS(s). Operation is subject to the following two conditions: (1) This device may not cause interference.(2) This device must accept any interference, including interference that may cause undesired operation of the device.







IC Radiation Exposure Statement



For SwitchBot Vacuum Cleaner and SwitchBot Robot Vacuum Dual Empty StationThis equipment complies with the IC radiation exposure limits established for uncontrolled environment. This equipment must be installed and operate at least 20 cm from a radiator or your body.



For SwitchBot Cordless Vacuum Cleaner

This equipment complies with the limits of exposure to IC radiation defined for an uncontrolled environment.Cet équipement est conforme aux limites d’exposition aux radiations de la IC définies pour un environnement non contrôlé.

READ ALL INSTRUCTIONS BEFORE USING

	WARNING: You must read all safety warnings and instructions. Failure to follow the warnings and instructions set out below may result in electric shock, fire and/or serious injury.
	This is the safety alert symbol. It is used to alert you to potential physical injury hazards. Obey all safety messages that follow this symbol to avoid possible injury or death.
	Risk of electric shock
	Risk of fire
	Class II appliance
	Keep out of reach of children
	For indoor use only

	Read operator's manual
	Separate collection symbol

~ – ALTERNATING CURRENT symbol [symbol IEC 60417-5032 (2009-02)]  – DIRECT CURRENT symbol [symbol IEC 60417-5031 (2009-02)]  – PROTECTIVE EARTH (Protective Ground) symbol [symbol IEC 60417-5019 (2009-02)]

IMPORTANT SAFETY INSTRUCTIONS

When using an electrical appliance, basic precautions should always be followed, including the following:

READ ALL INSTRUCTIONS BEFORE USING ROBOTIC VACUUM CLEANER

Warning

To reduce the risk of fire, electric shock, or injury:

- Do not leave appliance when plugged in. Unplug from outlet when not in use and before servicing.
- Do not use outdoors or on wet surfaces
- Do not allow to be used as a toy. Close attention is necessary when used by or near children.
- Use only as described in this manual. Use only manufacturer's recommended attachments.
- For SwitchBot Robot Vacuum Dual Empty Station: Do not use with damaged cord or plug. If appliance is not working as it should, has been dropped, damaged, left outdoors, or dropped into water, return it to a service center.
- For SwitchBot Robot Vacuum Dual Empty Station: Do not pull or carry by cord, use cord as a handle, close a door on cord, or pull cord round sharp edges or corners. Do not run appliance over cord. Keep cord away from heated Surfaces.
- For SwitchBot Robot Vacuum Dual Empty Station: Do not unplug by pulling on cord. To unplug, grasp the plug, not the cord.
- Do not handle plug or appliance with wet hands.
- Do not put any object into openings. Do not use with any opening blocked; keep free of dust, lint, hair, and anything that may reduce air flow.

- Keep hair, loose clothing, fingers, and all parts of body away from openings and moving parts.
- Turn off all controls before unplugging.
- Do not use to pick up flammable or combustible liquids, such as gasoline, or use in areas where they may be present.
- Do not pick up anything that is burning or smoking, such as cigarettes, matches, or hot ashes.
- Do not use without dust bag and/or filters in place.
- Place the cords from other appliances out of the area to be cleaned.
- Do not operate the vacuum in a room where an infant or child is sleeping.
- Do not operate the vacuum in an area where there are lit candles or fragile objects on the floor to be cleaned.
- Do not operate the vacuum in a room that has lit candles on furniture that the vacuum may accidentally hit or bump into.
- Do not allow children to sit on the vacuum.
- Do not use the vacuum on a wet surface.”

For SwitchBot Cordless Vacuum Cleaner and SwitchBot Vacuum Cleaner

WARNING:

Read all safety warnings and instructions. Failure to follow the warnings and instructions may result in electric shock, fire and/or serious injury.

- Prevent unintentional starting. Ensure the switch is in the off-position before connecting to battery pack, picking up or carrying the appliance. Carrying the appliance with your finger on the switch or energizing appliance that have the switch on invites accidents.
- Recharge only with the charger specified by the manufacturer. A charger that is suitable for one type of battery pack may create a risk of fire when used with another battery pack.
- Use appliances only with specifically designated battery packs. Use of any other battery packs may create a risk of injury and fire.
- Under abusive conditions, liquid may be ejected from the battery; avoid contact. If contact accidentally occurs, flush with water. If liquid contacts eyes, additionally seek medical help. Liquid ejected from the battery may cause irritation or burns.

- Do not use a battery pack or appliance that is damaged or modified. Damaged or modified batteries may exhibit unpredictable behavior resulting in fire, explosion or risk of injury.
- Do not expose a battery pack or appliance to fire or excessive temperature. Exposure to fire or temperature above 130°C may cause explosion. The temperature of 130°C can be replaced by the temperature of 265°F.
- Follow all charging instructions and do not charge the battery pack or appliance outside of the temperature range specified in the instructions. Charging improperly or at temperatures outside of the specified range may damage the battery and increase the risk of fire.
- Have servicing performed by a qualified repair person using only identical replacement parts. This will ensure that the safety of the product is maintained.
- Do not modify or attempt to repair the appliance or the battery pack (as applicable) except as indicated in the instructions for use and care.
- For SwitchBot Cordless Vacuum Cleaner: When battery pack is not in use, keep it away from other metal objects, like paper clips, coins, keys, nails, screws or other small metal objects, that can make a connection from one terminal to another. Shorting the battery terminals together may cause burns or a fire.
- For SwitchBot Cordless Vacuum Cleaner: For use only with ICR18650 2200mAh 22ME Battery pack
- For use only with W3000320 SwitchBot Robot Vacuum Dual Empty Station.

WARNING

General



- This appliance can be used by children aged from 8 years and above and persons with reduced physical, sensory or mental capabilities or lack of experience and knowledge if they have been given supervision or instructions concerning use of the appliance in a safe way and understand the hazards involved. Children shall not play with the appliance. Cleaning and user maintenance shall not be undertaken by children without supervision.
- Your robot is designed to be plugged into a standard household AC power outlet only.
- Do not use the Dual Empty Station with a damaged cord or plug.

- Do not submerge your robot in water.
- Do not use outdoors or on wet surfaces.
- Use your robot indoors in a dry location only. Do not handle your robot or Auto-empty Station with wet hands due to risk of electric shock.
- Do not operate the robot in areas with exposed electrical outlets on the floor. Place cords of other appliances away from areas that need cleaning.
- Do not put any object into openings. Do not use with any opening blocked. Keep free of dust, lint, hair, and anything that may reduce air flow.
- Keep hair, loose clothing, fingers, and all parts of the body away from openings and moving parts.
- Use extra care when cleaning on stairs.
- Do not use to pick up flammable or combustible liquids, such as gasoline, or use in areas where they may be present. Do not use the robot to pick up anything that is burning or smoking, such as cigarettes, matches, or hot ashes.
- To avoid your robot falling downstairs, ensure that the Auto-empty Station is placed at least 4 feet (1.2 meters) away from stairs or suspended areas.
- If the room to be cleaned contains lit candles on furniture, or equipment, such as stoves, fans, or humidifiers, remove the equipment before operation. There is a risk of injury, accident or malfunction if the robot pushes or knocks over equipment.
- Clean the (edge detection or cliff) sensor lens and cover on the bottom of your robot for dust and dirt buildup as needed to ensure normal operation.
- Do not use without a dust bag and/or filters in place.
- This appliance is intended for household use only.
- Your robot is not a toy. Children and pets should be supervised when your robot is operating. Do not sit or stand on your robot or the Dual Empty Station.
- Keep the charging contacts dry and clean. Failure to maintain the cleanliness of the charging contacts could result in the loss of ability of your robot to charge its battery.
- Please test your robot on a small section of hard floor at home before you start cleaning to ensure that it is compatible and does not harm flooring. Using your robot on a hard floor that is not compatible may result in damage to your device or floor itself.
- Contact your hard floor manufacturer should you have questions with compatibility.
- Before running your robot on carpets or rugs, ensure that they are compatible with vacuums using bars or brushes. Using your robot on a carpet or rug that is not

compatible may result in damage. Contact your carpet or rug manufacturer to find out more.

- Should the robot malfunction, endure damage, or be dropped into water, please discontinue use, and locate a SwitchBot authorized service center.
- Use your robot and cleaner only with the Dual Empty Station (W3000320)

Dual Empty Station



- Do not use the Auto-empty Station with a damaged cord or plug. If the supply cord is damaged, it must be replaced by the manufacturer, its service agent or a similarly qualified person in order to avoid hazards.
- Always disconnect your robot from the Dual Empty Station before cleaning or maintaining it. Please unplug the Auto-empty Station from the outlet when not in use and before servicing.
- The plug must be removed from the socket outlet before cleaning or maintaining the appliance.
- Only use the provided power supply for charging the robot. The provided power supply delivers a safer extra-low voltage current corresponding to the input marking on the robot which is required to maintain safe operation.
- Only use the Auto-empty Station to charge your robot. Other types of charging may affect your robot's battery or cause injury. Please contact SwitchBot Customer Support should you wish to replace batteries or for other maintenance.
- Do not use the Auto-empty Station to charge non-rechargeable batteries.
- Do not pull or carry by cord, use cord as a handle, close a door on cord, or pull cord around sharp edges or corners. Do not run appliances over cord. Keep cord away from heated surfaces.
- If you live in an area prone to electrical storms, it is recommended that you use additional surge protection. Your Dual Empty Station may be protected with a surge protector in the event of severe electrical storms.

Cordless Vacuum Cleaner

- This appliance can be used by children aged from 8 years and above and persons with reduced physical, sensory or mental capabilities or lack of experience and knowledge if they have been given supervision or instruction concerning use of the appliance in a safe way and understand the hazards involved. Children shall not play with the appliance. Cleaning and user maintenance shall not be made by children without supervision.
- Use this product only on dry surfaces indoors. Avoid using it outdoors or on wet surfaces.
- Do not touch the plug or any part of the product with wet hands.
- Do not install, charge, or use the product outdoors, in bathrooms, or around swimming pools.
- Check the lithium battery for damage before use.
- Do not use the product if the battery is damaged to prevent fire, explosion, or injury.
- Inspect the cleaning area for large debris, sharp objects, or anything larger than the suction pipe's diameter. Remove these items before use to prevent blockages.
- Do not use this product to clean water, combustible or explosive liquids (such as gasoline), toxic solutions (like bleach or ammonia), lime, cement, gypsum powder, or smoking/burning materials.
- Keep the suction port clear of objects and do not use the product if any suction port is blocked. Regularly clean dust, hair, or other obstructions to maintain airflow.
- Keep airflow channels and moving parts away from hair, loose clothing, fingers, and other body parts. Avoid placing accessories near eyes, ears, or mouth.
- Exercise extra caution when using the product on stairs.
- Do not lean the product against unstable surfaces like chairs or tables. If the product is dropped or damaged, contact after-sales service for repair; do not attempt to disassemble it yourself.
- Charge the product only within a temperature range of 5°C to 40°C (41°F to 104°F). Charging outside this range may damage the battery.
- If the power adapter is damaged, replace it with a specialized component from the manufacturer or repair department.
- Do not immerse the main unit or live parts in water or other liquids.
- Always power off the product and remove the brush head before cleaning to avoid injury.
- Ensure all parts are thoroughly dry and properly reassembled before use. Do not use

the dust cup or filter until they are correctly installed.

- Fire hazard warning: Do not apply scented products to the filter, as the chemicals may be flammable and pose a fire risk. Under extreme use and temperature conditions, the battery may leak. In case of battery leakage, rinse affected skin with clean water immediately. If battery fluid gets in your eyes, seek medical attention immediately after rinsing.
- Unplug the product and turn off the main unit before long-term storage, maintenance, or repair.
- Use only accessories and replacements recommended by our company.
- This product is intended for home use only.
- Use only the manufacturer's charger for the supplied battery. Do not attempt to charge other types of batteries with this charger.
- Regularly inspect the extension rod and power cord. Do not use them if damaged.
- Do not operate the vacuum in a room where an infant or child is sleeping.
- Do not allow children to sit on the vacuum.
- Do not operate the vacuum in a room that has lit candles on furniture that the vacuum may accidentally hit or bump into.
- Have servicing performed by a qualified repair person using only identical replacement parts. This will ensure that the safety of the product is maintained.

Battery and Charging



- The Robot Vacuum contains 1 rechargeable lithium-ion battery with a rated capacity of 3200 mAh.
- The Vacuum Cordless Cleaner contains 1 rechargeable lithium-ion battery with a rated capacity of 2200 mAh.
- Do not expose a battery pack or appliance to fire or excessive temperature. Exposure to fire or temperature above 130 °C (265 °F) may cause explosion. Before using this product, make sure there are no cords present that may obstruct it.
- Do not open, crush, heat the battery above 80 °C (176 °F), or incinerate. Follow our user manual for proper use, maintenance, handling, and disposal.
- Do not use the robot when the surrounding temperature is higher than 40 °C (104 °F),

or lower than 4 °C (39 °F), or there is any liquid or sticky substance on the floor.

- Follow all charging instructions and do not charge the battery pack or appliance outside of the temperature range specified in the instructions. Charging improperly or at temperatures outside of the specified range may damage the battery and increase the risk of fire.
- Do not allow metal objects to contact battery terminals or immerse the battery in liquid, or the battery may short-circuit. Shorting the battery terminals together may cause burns or a fire. Do not subject batteries to mechanical shock.
- Check the battery pack for any sign of damage or leakage regularly. Do not charge damaged or leaking battery packs. Damaged or modified batteries may exhibit unpredictable behavior resulting in fire, explosion or risk of injury.
- Do not allow the battery liquid to come in contact with skin or eyes. If contact has been made, wash the affected area with plenty of water and seek medical attention. Seal the damaged battery in a plastic bag and recycle or dispose of safely according to local environmental regulations, or return it to your local authorized SwitchBot Service Center for disposal.
- Use the appliance only with specifically designated battery packs. Use of any other battery packs may create a risk of injury and fire.
- To prevent unintentional starting, ensure the switch is in the off-position before connecting the battery pack before picking up or carrying the appliance. Carrying the appliance with your finger on the switch may cause accidents.
- Do not modify or attempt to repair the appliance or the battery pack (as applicable) except as indicated in the instructions for use and care.
- Have servicing performed by a qualified repair person using only identical replacement parts. This will ensure that the safety of the product is maintained.
- This robotic vacuum cleaner contains batteries that are only replaceable by skilled persons.
- Battery usage by children should be supervised. Seek medical advice immediately if a cell or a battery has been swallowed.
- Lithium-ion batteries and products that contain lithium-ion batteries are subject to stringent transportation regulations. If you need to ship this product (with the battery included) for service, travel or any other reason, you must follow the Battery Recycling part of this user manual or contact the transportation agent for relevant instructions.
- If placing the robot into storage, charge it fully and turn it off, then place it in a cool dry

place. Recharge it at least every three months to prevent the battery from over-discharging.



[symbol IEC 60417-5957 (2004-12)] for indoor use only

[symbol ISO 7000-0790 (2004-01)] read operator's manual

Battery Recycling



This symbol on the battery indicates that the battery must not be disposed of with unsorted common municipal waste. As the end-user, it is your responsibility to dispose of the end-of-life battery in your appliance in an environmentally sensitive manner as follows:

- (1) Returning it to the distributor/dealer from whom you purchased the product or
- (2) Depositing it at a designated collection point

The separate collection and recycling of end-of-life batteries at the time of disposal will help to conserve natural resources and to ensure that it is recycled in a manner that protects human health and the environment. For more information, please contact your local recycling office or the dealer from whom you originally purchased the product. Failure to properly dispose of end-of-life batteries may result in negative potential effects on the environment and human health due to the substances in the batteries and accumulators.

Removing the battery

The information below is only applicable when disposing of or transporting the robot, not for daily operation instructions.

1. Let the robot run to a low battery level where it cannot clean, without attaching to the Dual Empty Station.
2. Turn off the robot.
3. Remove the screws from the bottom cover of the robot.
4. Remove the battery.
5. Press the buckle to pull out the battery connector plug and remove the battery.

Note:

- Make sure the battery is exhausted and the robot is disconnected from the Dual Empty Station when removing the battery.
- Please remove the entire battery pack together, do not damage the battery pack casing to avoid short circuits or leakage of hazardous substances.
- If the battery leaks and accidentally comes into contact, rinse with plenty of water and seek medical attention immediately.

SAVE THESE INSTRUCTIONS

CLASS 1 CONSUMER LASER PRODUCT

Invisible laser radiation

Laser energy –Exposure near aperture may cause burns

Wavelength: 775 nm-800 nm

Output power: 3.3 W×0.24 A

Frequency: 6Hz

Pulse duration: 3s

Laser of the vacuum cleaner complies with the standard for Class I laser products of EN 50689:2021 & EN 60825-1:2014+A11:2021.

www.switch-bot.com

V1.0-2408

Documents / Resources

	<p>SwitchBot W3000320 K20 Plus Combo Robot Vacuum [pdf] User Manual W3000320, 2AKXB-W3000320, 2AKXBW3000320, W3000320 K20 Plus Combo Robot Vacuum, K20 Plus Combo Robot Vacuum, Combo Robot Vacuum, Robot Vacuum</p>
---	--

References

- [Home | Toronto Region Board of Trade](#)
- [SwitchBot Help Center](#)
- [SwitchBot Official Website - Your Simple Switch to a Smart Home – SwitchBot](#)

[International](#)

- [📱 Phone Models Corresponding to the Device – SwitchBot Help Center](#)
- [User Manual](#)

📁 SwitchBot

🔍 2AKXB-W3000320, 2AKXBW3000320, Combo Robot Vacuum, K20 Plus Combo Robot Vacuum, Robot Vacuum, SwitchBot, W3000320, W3000320 K20 Plus Combo Robot Vacuum

—Previous Post

[SwitchBot W1702100 Floor Lamp User Manual](#)

Next Post—

[SwitchBot W3002500 K20 Plus Pro Combo User Manual](#)

Leave a comment

Your email address will not be published. Required fields are marked *

Comment *

Name

Email

Website

☐ Save my name, email, and website in this browser for the next time I comment.

Post Comment

Search:

e.g. whirlpool wrf535swhz

Search

[Manuals+](#) | [Upload](#) | [Deep Search](#) | [Privacy Policy](#) | [@manuals.plus](#) | [YouTube](#)

This website is an independent publication and is neither affiliated with nor endorsed by any of the trademark owners. The "Bluetooth®" word mark and logos are registered trademarks owned by Bluetooth SIG, Inc. The "Wi-Fi®" word mark and logos are registered trademarks owned by the Wi-Fi Alliance. Any use of these marks on this website does not imply any affiliation with or endorsement.