



SwitchBot Meter Plus Thermometer and Hygrometer User Manual

[Home](#) » [SwitchBot](#) » SwitchBot Meter Plus Thermometer and Hygrometer User Manual 

Contents

- [1 SwitchBot Meter Plus Thermometer and Hygrometer](#)
- [2 Package Contents](#)
- [3 List of Components](#)
- [4 Installation](#)
- [5 Add to SwitchBot Account](#)
- [6 Resetting Factory Settings](#)
- [7 Specifications](#)
- [8 Troubleshooting](#)
- [9 Warranty Conditions](#)
- [10 EU Declaration of Conformity](#)
- [11 Documents / Resources](#)
 - [11.1 References](#)
- [12 Related Posts](#)

SwitchBot

SwitchBot Meter Plus Thermometer and Hygrometer



The Thermometer and Hygrometer Plus is a device that measures the temperature and humidity of your surroundings. It comes with a built-in magnet, hanging hole, button, sensor, and 2-angle foldable stand for easy installation and usage. It can be connected to the SwitchBot app for remote monitoring and control.

Dear customer,

Thank you for purchasing our product. Please read the following instructions carefully before first use and keep this user manual for future reference. Pay particular attention to the safety instructions. If you have any questions or comments about the device, please contact the customer line.

www.alza.co.uk/kontakt

☎ +44 (0)203 514 4411

Importer Alza.cz a.s., Jankovcova 1522/53, Holešovice, 170 00 Praha 7, www.alza.cz

Package Contents



Thermometer and Hygrometer Plus
(Meter Plus) x 1

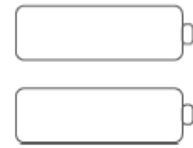

AAA Battery x 2
(Included)



Add-on 3M Metal Plate x 1



User Manual x 1

List of Components

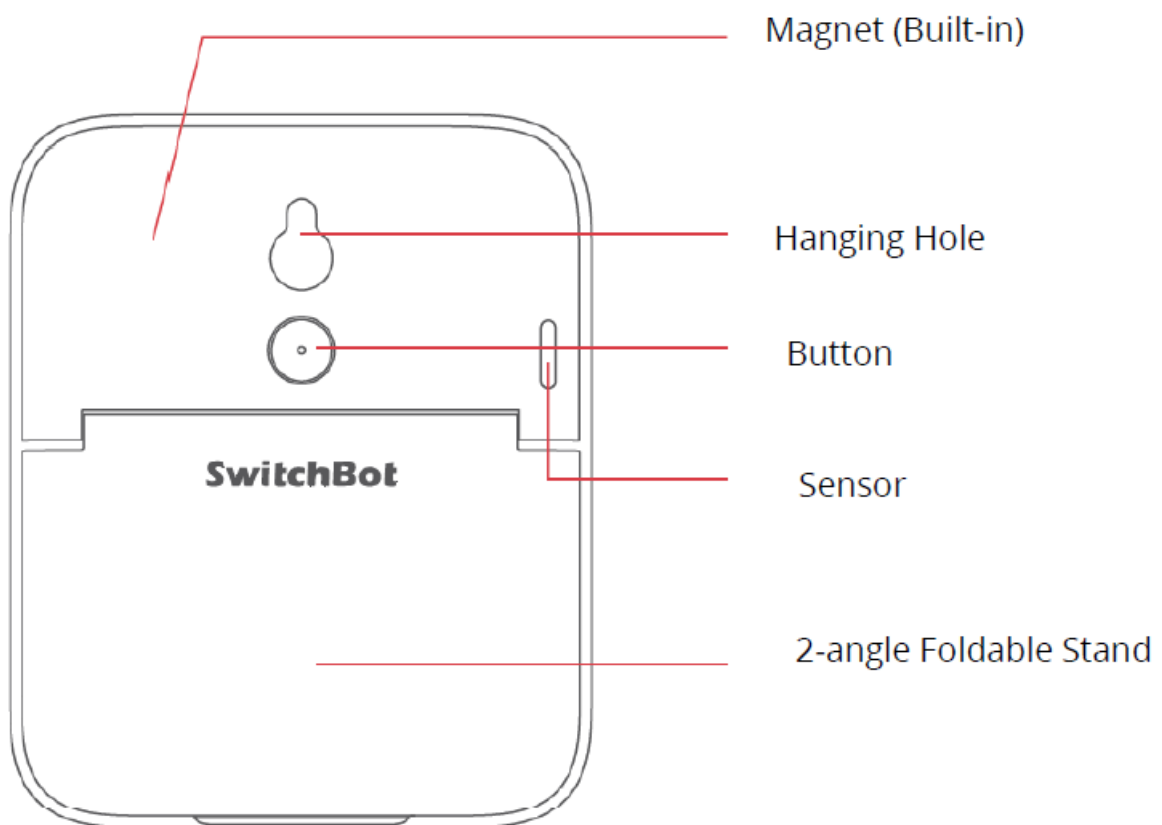

Installation

1. Pull out the insulation sheet from the battery case. The device will turn on automatically.

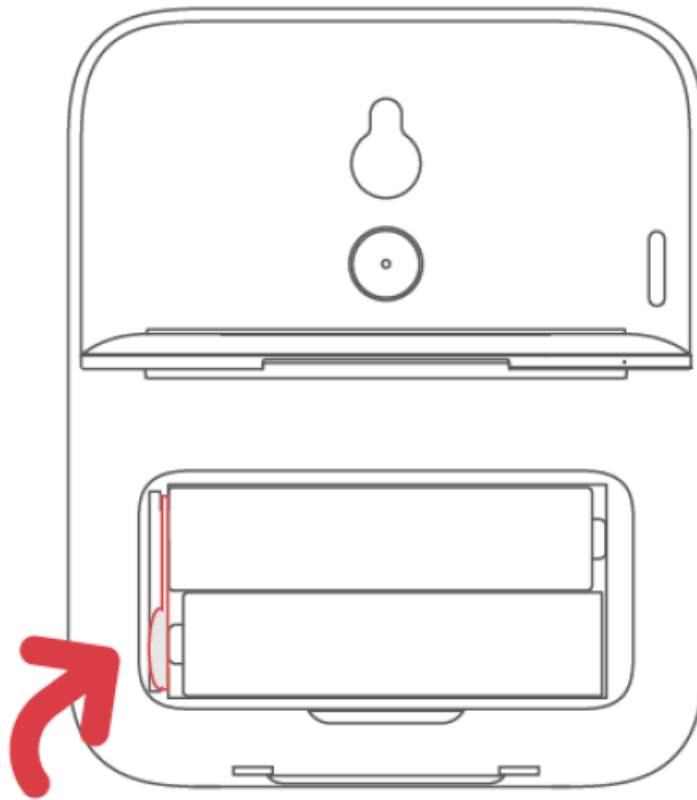

2. To install on a non-metal surface, peel off the tape liner from the back of the metal plate and stick it on the surface. Then, attach the device with its built-in magnet to the metal plate.

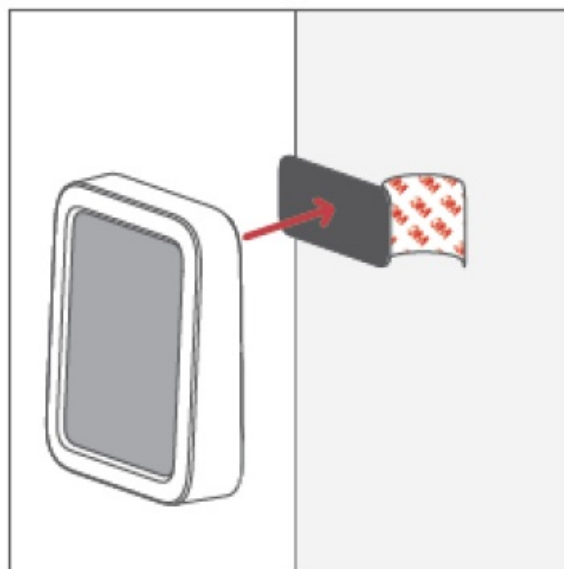

3. Download the SwitchBot app.



iOS 11.0+



Android OS 5.0+

Open our app, register an account or sign in to your account directly if you already have one, then add the device to your account.

Add to SwitchBot Account

Open our app, tap “+” at the top right of the Home page, find the Meter Plus icon and select. Long press the button on the back until the Bluetooth icon flashes on the screen. Now your Meter Plus is ready to be added.

Change the Temperature Unit

Press the button on the back of your Meter Plus once to change the temperature unit on the physical display.

Battery Replacement

Stretch the stand to its largest angle, then open the battery case cover. Take the batteries out, insert 2 AAA batteries as required and then put the battery case cover back.

Firmware Upgrades

In order to improve user experience, we will regularly release firmware updates to introduce new functions and solve any software defects that may occur during usage. When a new firmware version is available, we will send an upgrade notification to your account via our app. When upgrading, please make sure your product has sufficient battery and make sure your smartphone is within range to prevent interference.

Resetting Factory Settings

Press and hold the button on the back for 15 seconds to reset to factory settings.

Setting Alerts

You can set up temperature/humidity alerts in the app. You will receive notifications when within Bluetooth range.

Note: If you want to receive notifications remotely, you will need a SwitchBot Hub Mini (sold separately).

Comfort Settings

You can customize your comfort level in the app. Its default settings is human comfort.

Remote Access

If you have a SwitchBot Hub Mini (sold separately), you can monitor the device remotely. With the Hub Mini, history data will be synced to SwitchBot's server.

Note: Please turn on Cloud Services while with a Hub Mini.

Scenes

If you have a SwitchBot Hub Mini (sold separately), you can create Scenes with this device. For example, you can create a Scene to auto turn on/off your SwitchBot devices or appliances when the set temperature/ humidity is met.

Voice Control

If you have a SwitchBot Hub Mini (sold separately), you can monitor humidity/ temperature data via Amazon Alexa, Google Assistant, Siri Shortcuts or more.

Note: Turn on Cloud Services before using voice control.

Works with IFTTT

If you have a SwitchBot Hub Mini (sold separately), you can create an Applet in IFTTT to auto turn on/off your SwitchBot devices and appliances when the set temperature/ humidity is met.

History Data

On your Meter Plus' History Data page, you can view the temperature/humidity data in the interactive graphs. Tap on a specific point on the graph to see data at a specific moment.

Export Data

On History Page, tap Export Data below the graphs to save the data as a csv file.

Specifications

Model:	W2301500
Size:	79 × 65 × 22 mm (3.1 × 2.5 × 0.9 in.)
Weight:	64 g (2.3 oz.)
Material:	ABS
Color:	White
Network Connectivity:	BLE 4.2 or above
Transmission Range:	Up to 120 m (131.2 yd.)
System Requirements:	iOS 11.0+, Android OS 5.0+
Battery:	AAA × 2
Battery Life:	Approx. 1 year
Resolution:	0.1 °C / 0.1 °F, 1 % RH
Temperature Range:	-20 °C to 80 °C (-4 °F to 176 °F)
Humidity Range:	0 to 99 % RH
Temperature Accuracy:	-20 °C to 0 °C (-4 °F to 32 °F) [±0.4 °C / 0.7 °F] 0 °C to 65 °C (32 °F to 149 °F) [±0.2 °C / 0.4 °F] 65 °C to 80 °C (149 °F to 176 °F) [±0.3 °C / 0.5 °F]
Humidity Accuracy:	0 to 10 % RH (±4 % RH) 10 % to 90 % RH (±2 % RH) 90 % to 99 % RH (±4 % RH)

Troubleshooting

Please visit <https://support.switch-bot.com/hc/en-us/categories/1500002074102-meter> for more information, or scan the QR code below.



Warranty Conditions

A new product purchased in the Alza.cz sales network is guaranteed for 2 years. If you need repair or other services during the warranty period, contact the product seller directly, you must provide the original proof of purchase with the date of purchase. The following are considered to be a conflict with the warranty conditions, for which the claimed claim may not be recognized:

- Using the product for any purpose other than that for which the product is intended or failing to follow the instructions for maintenance, operation, and service of the product.
- Damage to the product by a natural disaster, the intervention of an unauthorized person or mechanically through the fault of the buyer (e.g., during transport, cleaning by inappropriate means, etc.).
- Natural wear and aging of consumables or components during use (such as batteries, etc.).
- Exposure to adverse external influences, such as sunlight and other radiation or electromagnetic fields, fluid intrusion, object intrusion, mains overvoltage, electrostatic discharge voltage (including lightning), faulty supply or input voltage and inappropriate polarity of this voltage, chemical processes such as used power supplies, etc.
- If anyone has made modifications, modifications, alterations to the design or adaptation to change or extend the functions of the product compared to the purchased design or use of non-original components.

EU Declaration of Conformity

Identification data of the manufacturer's / importer's authorized representative:

Importer: Alza.cz a.s.

Registered office: Jankovcova 1522/53, Holešovice, 170 00 Prague 7

CIN: 27082440

Subject of the declaration:

Title: Thermometer and Hygrometer

Model / Type: Switchbot Meter Plus

The above product has been tested in accordance with the standard(s) used to demonstrate compliance with the essential requirements laid down in the Directive(s):

Directive No. 2014/53/EU

Directive No. 2011/65/EU as amended 2015/863/EU

WEEE

This product must not be disposed of as normal household waste in accordance with the EU Directive on Waste Electrical and Electronic Equipment (WEEE – 2012/19 / EU). Instead, it shall be returned to the place of purchase

or handed over to a public collection point for the recyclable waste. By ensuring this product is disposed of correctly, you will help prevent potential negative consequences for the environment and human health, which could otherwise be caused by inappropriate waste handling of this product. Contact your local authority or the nearest collection point for further details. Improper disposal of this type of waste may result in fines in accordance with national regulations.

Documents / Resources

 <p>SwitchBot Thermometer and Hygrometer Plus Vysoká presnosť - jednoduché použitie - bezdrôtové pripojenie</p>	<p>SwitchBot Meter Plus Thermometer and Hygrometer [pdf] User Manual Meter Plus Thermometer and Hygrometer, Meter Plus, Thermometer and Hygrometer, Hygrometer, Thermometer</p>
--	---

References

- 🐻 [Alza.sk – rýchly a pohodlný nákup odkiaľkoľvek | alza.sk](#)
- 🐻 [alza.at](#)
- 🐻 [Alza | Alza.co.uk](#)
- 🐻 [alza.de](#)
- 🐻 [alza.hu](#)
- 🐻 [alza.sk](#)