



# SWITCH ON 374871-21-A-EU Multi-Function LED Light User Manual

[Home](#) » [SWITCH ON](#) » SWITCH ON 374871-21-A-EU Multi-Function LED Light User Manual 

## Contents

- 1 SWITCH ON 374871-21-A-EU Multi-Function LED Light
- 2 Introduction
- 3 Safety
  - 3.1 Intended use
- 4 Scope of delivery (Fig. A/B)
- 5 Technical specifications
- 6 Safety information
- 7 Safety instructions regarding rechargeable batteries
- 8 Start-up
- 9 Charging the battery
- 10 Operating the sensor functions
- 11 Operating the flashlight function
- 12 Operation of the power cut light function
- 13 Attach product e.g. to cabinet doors, applies only to version
- 14 Cleaning and care instructions
- 15 Conformity declaration
- 16 Disposal
- 17 Warranty
- 18 Documents / Resources
  - 18.1 References
- 19 Related Posts





## MULTI-FUNCTION LED LIGHT

Operation and safety notes

### Introduction

#### Congratulations!

With your purchase you have chosen a high-quality product. The operation and safety notes are an integral part of this product. They contain important information for safety, use and disposal. Familiarize yourself with all of the operation and safety notes before using the product. Use the product only as described and for the specific areas of application. Keep the operation and safety notes for future reference. Provide all of the documentation when passing the product on to third parties.

Hereinafter, the Multi-Function LED Light will be referred to as product.

#### Explanation of symbols

The following symbols and signal words are used in these operation and safety notes, on the product or on the packaging.

#### WARNING!

This signal symbol/word indicates a hazard with a high level of risk which, if not avoided, may result in death or serious injury.

#### CAUTION!

This signal symbol/word indicates a hazard with a low level of risk which, if not avoided, may result in minor or moderate injury.

#### NOTE!

This signal word warns of possible property damage or provides you with useful additional information regarding the use.



- This symbol indicates interior use only.



- This symbol indicates usage.



- This symbol indicates a risk of glaring.



- This symbol indicates the ON/OFF switch.



- This symbol indicates direct current.



- This symbol indicates alternating current.

- **IP20** This symbol provides information regarding the maximum illuminance.



- This symbol indicates Protection Class IP20.

(No protection against water, but against solid objects of more than 12.5 mm diameter. The product may only be used in a dry environment.)



- This symbol indicates protection class III. SELV: safety extra-low voltage. FOR LIGHT ONLY



- These symbols inform you about the disposal of the packaging and the product.



- Certified safety: Products marked with this symbol comply with the requirements of the German Product Safety Act (Prods).



- Conformity declaration (see chapter „14. Conformity declaration”): Products that are marked with this symbol fulfil all applicable Community regulations of the European Economic Area.

## Safety

### Intended use

#### WARNING!

Risk of injury!



The product may not be used near liquids or in damp spaces. There is a risk of injury from electric shock!

The product is not intended for commercial use. Different use or a modification to the product are not deemed as intended use and may lead to risks, such as injuries and damage. The distributor assumes no liability for damage that results from improper use.



- The product is exclusively suitable for interior use.



- The product is not suitable for household room lighting.

The product serves as a torch with flashing or as a night light with a twilight sensor and motion sensor or as an power cut light with AUTO-ON (switches on automatically in the event of a power failure).

### Scope of delivery (Fig. A/B)

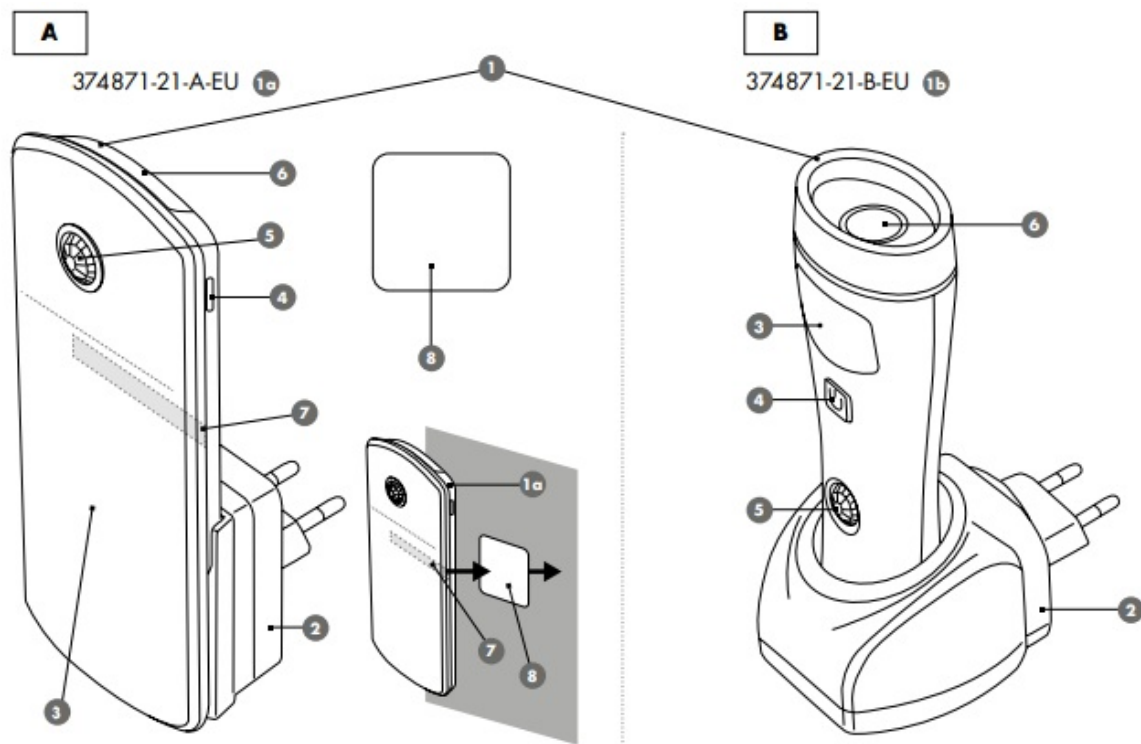

- 1 x Multi-Function LED Light 1
- **Fig. A** 374871-21-A-EU 1a
- 1 x Charging station 2
- 1 x metal plate 8 (with adhesive pad)
- 1 x Operation and safety notes (without fig.)
- **OR**
- **Fig. B** 374871-21-B-EU 1b
- 1 x Charging station 2
- 1 x Operation and safety notes (without fig.)



### Technical specifications

- **Type:** Multi-Function LED Light
- **IAN:** 365115-2204
- **Tradix Item No.:** 374871-21-A, -B-EU

Technical data for LED Multi-Function Light Night light function with

- 7 LEDs 374871-21-A-EU
- 5 LEDs 374871-21-B-EU

**Battery:**

- 374871-21-A-EU: , 500 mAh, Typ 303450
- 374871-21-B-EU: , 500 mAh, Typ 14430 Brightness when battery is fully charged:
- Night light 40 lm
- Flashlight 130 lm

#### Illumination time:

- Torch mode approx. 3 h according to ANSI
- Night light approx. 4.5 h according to ANSI
- Sensor range: approx. 3m
- Angle of detection: approx. 90°
- Illumination time with night light triggering: approx. 20s
- LED Multi-Function Light protection class: III

#### Technical data charging station:

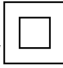
- Input voltage: 230 V , 50 Hz
- Charging station protection class: II/ 
- Production date: 08/2022
- Warranty: 3 years

#### Safety information

##### WARNING!

Risk of injury and suffocation!



If children play with the product or the packaging, they may injure themselves or suffocate!

- Do not let children play with the product or the packaging.
- Supervise children who are close to the product.
- Keep the product and the packaging out of the reach of children.

##### WARNING!

Risk of injury!



Not suitable for children under the age of 8! There is a risk of injury!



- Children from the age of 8, as well as people with impaired physical, sensory or mental capabilities or with a lack of experience and knowledge, must be supervised when using the product and/or be instructed regarding the safe use of the product and understand the resulting dangers.

- Children are not allowed to play with the product.
- Maintenance and/or cleaning of the product is not allowed to be performed by children.

Prevent the LED Multifunction light from being used by unauthorized individuals (especially children)!

- Keep the LED Multifunction light in a dry, high, safe place out of the reach of children.

### **Observe national regulations!**

- Observe the applicable national provisions and regulations for the use and disposal of the LED Multi-function light.

### **Using the LED Multifunction light/charging station**

- The LED Multifunction light may only be charged with the provided charging station.
- The charging station may only be used to charge the LED Multifunction light.
- The LED Multi-Function Light must not be submerged in the water.

### **WARNING!**

Risk of injury!



Do not use in an explosive environment! There is a risk of injury!

- The product is not allowed to be used in an explosive (Ex) environment.  
The product is not approved for an environment, in which flammable liquids, gases or dust are present.

### **WARNING!**

Risk of glaring!

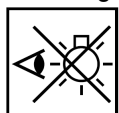

Do not look directly into the light of the lamp and do not point the lamp at other people's eyes. This can impair the eyesight.

### **WARNING!**

Risk of injury!

A defective product is not allowed to be used! There is a risk of injury!

- Do not use the product in the case of malfunctions, damage or defects.
- Significant danger can occur for the user in the case of improper repairs.
- If you find a defect in the product, have the product checked and repaired if necessary before putting it back into operation.
- The LEDs are not replaceable. If the LEDs are defective, the product must be disposed of.

### **WARNING!**

Risk of injury!



The product is not allowed to be manipulated!

### **There is a risk of injury from electric shock!**

- The casing must not be opened and the product must not be manipulated/modified under any circumstances. Manipulations/modifications can cause danger to life from electric shock. Manipulations/modifications are prohibited for approval reasons (CE).
- Check voltages! Make sure that the existing mains voltage corresponds to the specification on the rating plate. Failure to comply can lead to excessive heat development.
- Never touch the power plug with wet hands, if it is in operation.
- The product must not be covered up during use.
- The LED Multi-Function Light must not be connected to a power strip or to a multiple socket.

### **Safety instructions regarding rechargeable batteries**

#### **WARNING!**

Fire and explosion hazard!



- Keep the product away from heat sources and direct sunlight, the battery may explode if overheated. There is a risk of injury.



- Do not operate the product in its packaging! There is a risk of fire!

#### **WARNING!**

Risk of injury!



Do not touch leaked batteries with bare hands! There is a risk of injury!

- Leaked or damaged batteries may cause acid burns if they come into contact with skin. Do not touch leaked batteries with bare hands; therefore, ensure that you wear appropriate protective gloves in such a case!

#### **NOTE!**

- The product has a built-in rechargeable battery that cannot be replaced by the user. In order to avoid hazards, the battery may only be removed by the manufacturer or its service agent or by a similarly qualified individual.
- When disposing of the product, please note that the product contains a rechargeable battery.

#### **CAUTION!**

Danger of overheating!

Remove packaging prior to use.

### **Start-up**

1. Remove all packaging materials.
2. Check whether all parts are available and undamaged.

If this is not the case, notify the specified service address.

#### **NOTE!**

Before start-up

The battery must be charged for 24 hours before initial use.

### **Charging the battery**

Before you start the charging process, switch off the LED Multi-Function Light.

Plug the charging station into a suitable power outlet. Make sure that the charging station 2 is correctly aligned (see fig. A + B). Plug the LED Multi-Function Light 1 into the cradle 2. The battery should now be left to charge for 24 hours.

#### **NOTE!**

During further charging, the charging time (maximum 24 hours) will be shortened depending on the remaining battery capacity.

If the charging station 2 with the inserted LED Multi-Function Light 1 is connected to the power supply, the battery will be charged automatically without contact.

Overcharging the battery is prevented by the integrated charging control. The LED Multi-Function Light 1 can therefore remain permanently in the charging station 2.

### **Operating the sensor functions**

Connect the charging station 2 with the inserted LED Multi-Function Light 1 to the power supply.

If movement is detected by the sensor 5 in the dark within the range of approx. 3 meters, the night light 3 will switch on automatically.

As soon as no more movement is registered, the night light 3 switches off again after approx. 20 seconds.

#### **NOTE!**

The LED multi-function light 1 has an eco-mode function. When the LED multifunction light 1 is set to Eco mode, it illuminates with a reduced and power-saving brightness.

If the LED Multi-Function Light is in the charging station, you have the option of switching to Eco mode by briefly pressing the ON/OFF 4 switch for continuous operation of the night 3 light.

The night light 3 of the LED Multi-Function Light 1 now lights up permanently with reduced luminosity during the dark.

#### **NOTE!**

Continuous operation has no memory function. It must be reactivated in the event of a power failure or when the LED multifunction 1 light is removed from the charging station 2.

### **Operating the flashlight function**

If you remove the LED Multi-Function Light 1 from the charging station 2, the flashlight 6 automatically switches to eco mode.

If you press the ON/OFF switch 4 repeatedly, you can choose between the individual operating modes:



- Pressing 1x: 100% Flashlight on
- Pressing 2x: 100% night light on
- Pressing 3x: Flashlight in flashing mode
- Pressing 4x: off

## Operation of the power cut light function

Connect the charging station 2 with the inserted LED Multi-Function Light 1 to the power supply. In the event of a power failure, the flashlight 6 automatically illuminates as an power cut light in the Eco mode. Once the power supply is restored, the flashlight 6 automatically switches off again.

### NOTE!

- If the power supply is interrupted, the flashlight 6 remains illuminated until the battery is empty.
- When the battery level is low, the performance of the LED multifunction light is further reduced. This also happens in Eco mode .

## Attach product e.g. to cabinet doors, applies only to version

### 374871-21-A-EU

The LED multi-function light 1a has a magnet 7 built into the back of the lamp for fastening by means of the metal plate 8 to smooth surfaces, see Fig. A.

1. Clean the surface to be considered. Make sure that the area is large enough.
2. Remove the protective film from the adhesive pad on the back of the metal plate 8 .
3. Glue the metal plate 8 to the desired location and press it firmly into place.
4. Now you can attach the LED Multi-Function Light 1a to the metal plate 8 .

### NOTE!

If you mount the LED multifunctional light, 1a e.g. in a cabinet or fuse box, the night light 3 switches on automatically as soon as the LED Multi-Function Light 1a is moved by opening the door. When the sensor detects 5 no more movement, the night light 3 switches off automatically.

### For this function the sensor 5 must be activated as follows:

- **ACTIVATION:** Press the ON/OFF switch 4 for approx. 3s – the night light 3 flashes once briefly.
- **DEACTIVATION:** Press the ON/OFF switch 4 for another approx. 3s – the night light 3 flashes twice briefly.

### NOTE!

If you install the LED Multi-Function Light 1a permanently in the previously described manner, for example, in a cabinet, you must charge it regularly in the charging station 2 .

### NOTE!

Risk of damage to property!

- Do not stick the metal plate 8 to sensitive or high quality surfaces. They can be scratched by the use of the product or damaged if the metal plate 8 is removed later.
- If you attach the product directly to magnetic surfaces without the metal plate 8 , sensitive surfaces can be

scratched.

### **NOTE!**

When you put the LED Multi-Function Light 1a back into the charging station 2 , the normal mode is set as described in “9. Operating the sensor functions” is activated.

## **Cleaning and care instructions**

### **WARNING!**

Risk of injury!

The power plug must be disconnected before cleaning.

### **There is a risk of electric shock!**

- only clean with a dry cloth
- do not use any strong detergents and/or chemicals
- do not immerse in water
- store in a cool, dry place and protected from UV light

## **Conformity declaration**



This device complies with the fundamental requirements and other relevant regulations of the European Electromagnetic Compatibility Directive 2014/30/EU and the RoHS Directive 2011/65/EU. The complete original conformity declaration is available from the importer.

## **Disposal**

### **Disposal of the packaging**



The packaging and operating instructions are made of 100 % environmentally friendly materials, which you may dispose of at local recycling centers.

### **Disposal of the product**



■ The product may not be disposed of with normal household waste. For information on disposal options for the product, please contact your local council/municipality or your Kurland shop.

### **Disposal of the battery / rechargeable battery**



- Defective or used rechargeable batteries have to be recycled in accordance with Directive

2006/66/EC and its amendments.

- Batteries and disposable batteries are not permitted to be disposed of with household waste. They contain harmful heavy metals. Marking: Pb (= lead), Hg (= mercury), Cd (= cadmium). You are legally obligated to return used batteries and rechargeable batteries. After use, you can either return batteries to our point of sale or in the direct vicinity (e.g. with a retailer or in municipal collection centers) free of charge. Batteries and rechargeable batteries are marked with a crossed-out waste bin.
- Rechargeable batteries must only be disposed of when discharged. Discharge the battery by leaving the product switched on until it no longer lights up.

## **Warranty**

Dear customer, the warranty on this product is 3 years from the purchase date. In the event of defects in this product, you are entitled to exercise your statutory rights against the seller of the product. These statutory rights are not limited by our warranty described in the following.

### **Warranty conditions**

The warranty begins on the date of purchase. Please keep the original receipt. This document is required as verification of the purchase.

If a material or manufacturing defect arises within three years from the purchase date of this product, the product will be repaired or replaced, as per our choice, at no charge to you. This warranty service requires the submission of the purchase receipt and the defective product within the three-year period and a short written description of the defect and when it arose.

If the defect is covered by our warranty, the repaired or a new product will be returned to you. The warranty period does not restart with the repair or replacement of the product.

### **Guarantee period and statutory claims for defects**

- The guarantee period will not be extended by the warranty.
- This also applies to replaced and repaired parts.
- Damage and defects which may possibly already exist upon purchase must be reported immediately after unpacking.
- After the guarantee period has expired, required repairs shall be subject to a charge.

### **Scope of guarantee**

The device has been carefully produced under strict quality guidelines and conscientiously inspected prior to delivery. The guarantee service applies to material or manufacturing faults. This guarantee does not extend to product parts, which are exposed to normal wear and tear and can therefore be regarded as wearing parts or to damage to fragile parts, e.g. switches or which are made of glass.

This guarantee shall lapse, if the product is damaged, not used properly or maintained properly. For proper use of the product, all of the instructions in the operating instructions must be precisely complied with. Purposes and actions, which are dissuaded from or warned about in the operating instructions must be avoided.

The product is only intended for private and not commercial use. In the case of abusive and improper handling, use of force and with interventions, which are not performed by our authorized service branch, the guarantee shall lapse.

### **Processing in the case of a guarantee claim**

To ensure quick processing of your concern, please follow the instructions below:

- Please have the till receipt and article number available (IAN) 365115-2204 as proof of the purchase.
- You can find the article number on the rating plate on the product, as an engraving on the product, the title place of your instructions or the sticker on the back or underside of the product.
- If malfunctions or other defects occur, first contact the service department below by telephone or e-mail.
- You can then send a product that has been recorded as being defective, including the proof of purchase (till receipt) and stating what the defect is and when it occurred, postage-free to the service address provided to you.

On [www.kaufland.com/manual](http://www.kaufland.com/manual) you can download these and many other manuals.

#### **MANUFACTURER:**

TRADIX GmbH & Co. KG  
Schwanheimer Str. 132  
DE-64625 Bensheim,  
Deutschland, Německo, Nemecko, Германия,  
Germany

Country of origin: China

#### **SERVICE ADDRESS**

TRADIX SERVICE-CENTER  
c/o Teknihall Elektronik GmbH  
Assar-Gabrielsson-Str. 11-13  
DE-63128 Dietzenbach,  
Deutschland, Německo, Nemecko, Германия,  
Germany

**Hotline:** 00800 30012001 free of charge, mobile networks may vary)

- E-Mail: [tradix-de@teknihall.com](mailto:tradix-de@teknihall.com)
- E-Mail: [tradix-cz@teknihall.com](mailto:tradix-cz@teknihall.com)
- E-Mail: [tradix-sk@teknihall.com](mailto:tradix-sk@teknihall.com)
- E-Mail: [tradix-bg@teknihall.com](mailto:tradix-bg@teknihall.com)
- E-Mail: [tradix-gb@teknihall.com](mailto:tradix-gb@teknihall.com)

#### **Last update:**

08/2022

Tradix Art.-№: 374871-21-A, -B-EU

IAN 365115-2204

#### **Documents / Resources**



[SWITCH ON 374871-21-A-EU Multi-Function LED Light](#) [pdf] User Manual  
374871-21-A-EU Multi-Function LED Light, 374871-21-A-EU, Multi-Function LED Light, LED Light, Light

## References

-  [manual | Kaufland](#)
-  [Home | Kaufland](#)
-  [manual | Kaufland](#)

Manuals+.