

Swiitech T1 Wireless 2 In 1 Adapter



Swiitech T1 Wireless 2 In 1 Adapter User Guide

[Home](#) » [Swiitech](#) » **Swiitech T1 Wireless 2 In 1 Adapter User Guide** 

Contents

- [1 Swiitech T1 Wireless 2 In 1 Adapter](#)
- [2 Product Information](#)
- [3 Product Usage Instructions](#)
- [4 FAQ](#)
- [5 What's in the box?](#)
- [6 Package Contents](#)
- [7 Product Diagram](#)
- [8 Basic Operation](#)
- [9 Music Control](#)
- [10 LED Indicators](#)
- [11 Specifications](#)
- [12 Charging](#)
- [13 How to use-Pairing in RX mode](#)
- [14 How to use Pairina in TX mode](#)
- [15 PRECAUTIONS](#)
- [16 FCC Warning](#)
- [17 Documents / Resources](#)
 - [17.1 References](#)
- [18 Related Posts](#)



Swiitech T1 Wireless 2 In 1 Adapter



Product Information

Specifications

- **Compliance:** FCC Part 15, IC Licence-exempt RSS(s)
- **RF Exposure Compliance:** Mobile configurations only
- **Antenna Separation:** At least 20 cm from all persons

Product Usage Instructions

FCC Warning

This device complies with FCC Part 15 rules.

To ensure proper operation:

- Reorient or relocate the receiving antenna if needed.
- Increase the separation between the equipment and the receiver.
- Connect the equipment to a different circuit than the receiver.
- If experiencing issues, consult the dealer or a radio/TV technician for assistance.

IC Warning

This device contains license-exempt transmitter(s)/receiver(s) complying with IC's regulations.

Follow these guidelines:

- Avoid causing interference with other devices.
- Accept any interference received, even if it affects device operation.

Radiation Exposure Statement

- Use only in mobile configurations.
- Ensure antennas are at least 20 cm away from individuals.
- Do not co-locate with other antennas or transmitters.

FAQ

Q: What should I do if the device is causing interference?

A: If interference occurs, try reorienting the antenna, increasing separation, or consulting a professional for assistance.

Q: Can the device be used in non-mobile configurations?

A: No, to comply with RF exposure regulations, the device should only be used in mobile setups.

- Thank you for choosing the Swiitech 11 Wireless 2-in-1 Adapter.
- Please read this guide carefully and keep it in a safe place for future reference. If you need any further assistance, please contact our customer support team at info@swiitech.com

What's in the box?

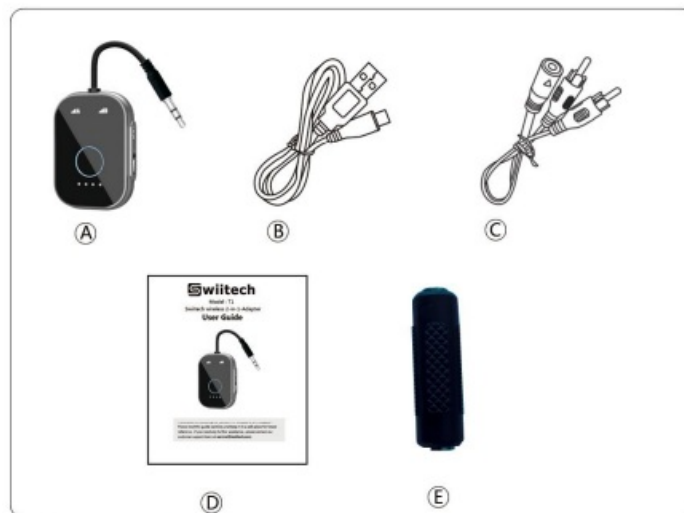

Package Contents

- **A** Wireless 2-in-1 Adapter x 1
- **B** Type-c Charging Cable x 1
- **C** 3.5mm Female to 2 RCA Male Cable x 1
- **D** User Guide x 1
- **E** 3.5mm Audio Plug x 1

Product Diagram

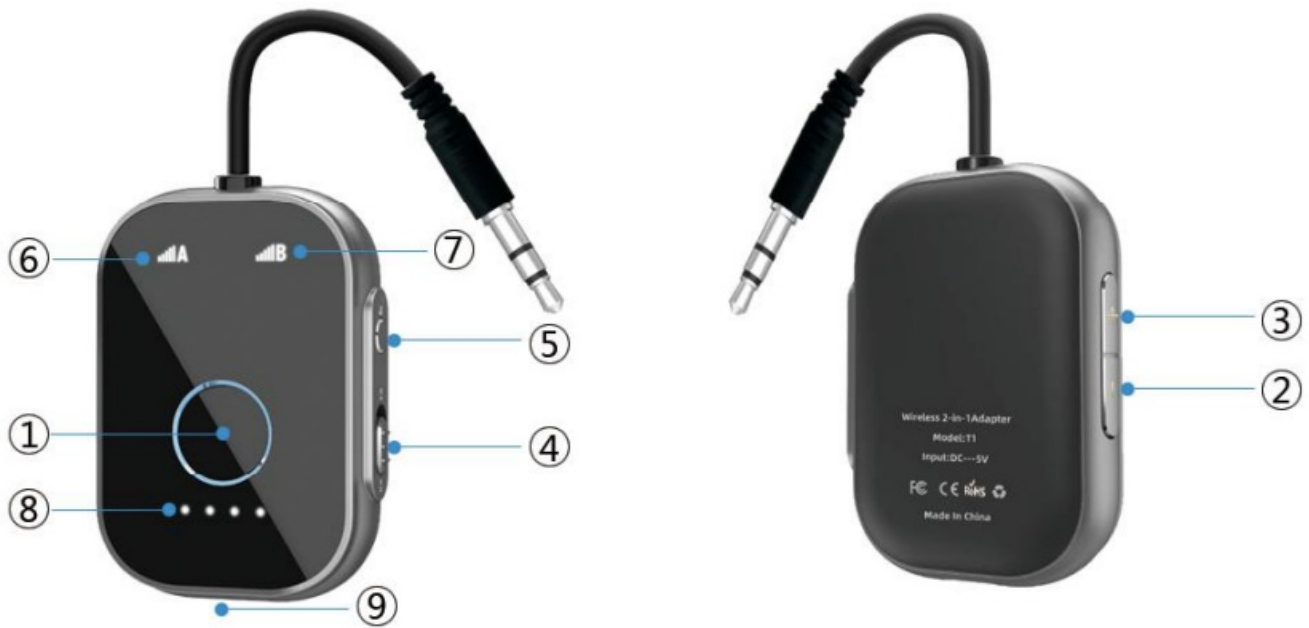

1. MFB(Multi-functional Button)
2. Volume-/ Previous Track
3. Volume +/Next Track
4. Mode Switch Button
5. Reset Button
6. LED Indicator A
7. LED Indicator B
8. Power LED Indicator
9. Charging Port

Basic Operation



Power On/Off :

Play/Pause :

- In RX/TX mode, press and hold "MFB" Single click "MFB" in RX mode (When playing music)

NOTE

Power on

- Press and hold the power button for 1 second. The adapter will automatically enter its pairing state. During this time, the LED Indicators A & B will alternately flash blue.
- If the adapter discovers a previously connected device, it will connect. If not, it will wait for a new device to try to

connect to. Within 3 minutes, If no connection is made after 3 minutes, the adapter will automatically shut down.

Power off

- Press and hold the power button for 5 seconds.



Music Control

Volume+/-	In RX mode, sigle click "volume+/-"
Next/Previous Track	In RX mode, press and hold "volume+/-" for 2s

NOTE: In TX mode, there are no Play/Pause, Volume+/-, or Next/Previous Track functions available.

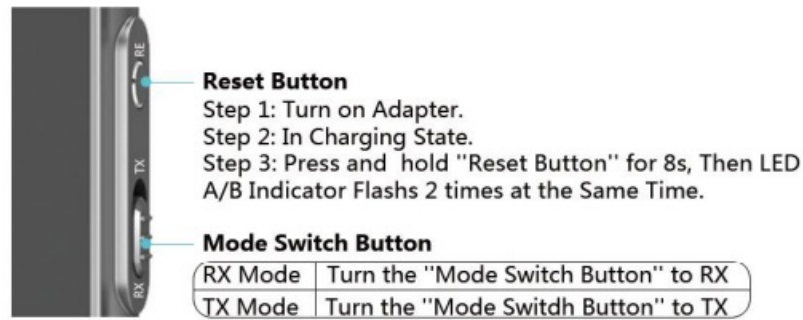

- **NOTE** In standby or connection mode, you can freely switch between TX and RX modes.
- After switching modes, the connected devices from the last mode will be disconnected and the adapter will enter its pairing state

LED Indicators

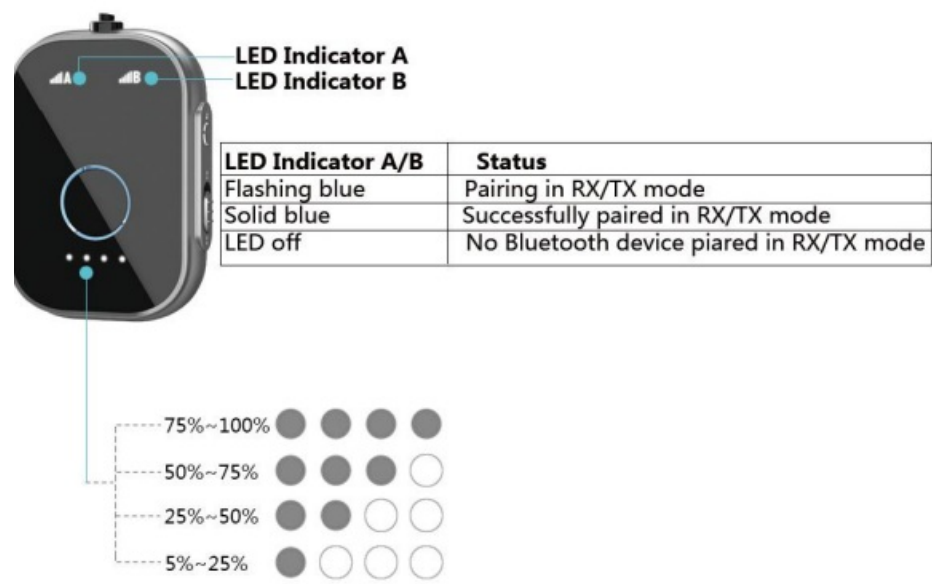

Specifications

Bluetooth Profile	A2DP/AVRCP
Audio Codec	SBC/aptX
Range	33ft/10m
Charging Power	DC 5V
Bateery Capacity	200mAh
Working Time	Approx.15hours
Charging Time	2 hours
Dimensious(L*W*H)	54*38*12mm
Weight	38g

Charging

1. Use a USB Type C cable and connect the adapter to any active Type C port.
2. The Power LED indicator will turn white and flash when an adapter is charging.

Notes:

- We recommend charging the unit for at least 2 hours before using it for the first time.
- When the adapter needs to be used continuously for longer than the battery lasts, it can be connected to a charging power supply while you are using it.
- It is not recommended that you use this function frequently, because it may affect the service life of the battery.

How to use-Pairing in RX mode



1. Set the adapter to RX mode and insert one end of a 3.5mm audio cable / plug into the audio port of the adapter. Insert the other end into your Non-Bluetooth audio receiving device (speakers headset, etc.)
2. Press and hold the power button of the adapter for 1 second to turn it on and enter pairing mode. The LED indicator A and B of the adapter will alternately flash blue
3. Activate the Bluetooth function on your transmitting device (phone, tablet, etc.) and search for nearby Bluetooth devices.
4. Find " T1 " in the search results and tap on it to connect. Once connected, the LED indicator A on the adapter will be solid blue, and the LED indicator B will be off.

NOTES (In RX mode)

- In pairing mode, if there is no Bluetooth device connected to the adapter, the Bluetooth indicator light will flash

for 3 minutes and the adapter will shut down automatically.

- After the first successful connection, if the adapter and Bluetooth device are turned on again, the adapter and Bluetooth device will connect automatically.

How to pair with two Bluetooth devices at the same time RX mode

- In RX mode, the adapter can pair with two Bluetooth devices at the same time.
- Follow the previous instructions in the "How to use-pairing in RX mode" section to pair the adapter with your first device.
- Double click the adapter "MFB" button to enter pairing mode (The LED indicator A/B of the adapter will alternately flash blue).
- Turn on the second Bluetooth device. Find "T1" in the search results and tap on it to pair.
- After pairing is completed, the LED indicators A and B of the adapter will turn blue and remain on. At this time, the adapter has already connected to two Bluetooth devices simultaneously.

NOTES:

- Only one device can play music through the adapter at any time. You have to stop the music on one device to play on the other.
- When the adapter is paired with the second Bluetooth device, the first Bluetooth device will not disconnect from the adapter.
- If the adapter is already connected to two Bluetooth devices simultaneously, double-click the "MFB" button, and the adapter doesn't enter pairing mode.

How to use Pairina in TX mode



1. Set the adapter to TX and connect it to your Non-Bluetooth device (television, music player, etc.) Connect one end of a 3.5mm audio cable / plug into the audio port of the adapter, and the other end into the audio out jack of the Non-Bluetooth device.
2. Bring your Bluetooth audio receiving device (earphones, speakers, etc.) within a 3 feet / 1 meter range and power it on. Set it to pairing mode.
3. Press and hold the power button of the adapter for 1 second to turn it on and enter pairing mode, LED indicators A and B of the adapter will alternately flash blue. At this point, the nearby Bluetooth receiving device will automatically connect to the adapter, and then LED indicator A on the adapter becomes solid blue. The LED indicator B will be off.

NOTES(In TX mode)

- A 3.5mm female to 2 RCA male cable is suitable for connecting the adapter to a TV without a 3.5mm audio output jack. This cable is included in the package.
- In pairing mode, if there is no Bluetooth device connected to the adapter, the Bluetooth indicator light will flash for 3 minutes and the adapter will automatically shut down.
- After the first successful connection, if the adapter and Bluetooth device are turned on again, the adapter and Bluetooth device will automatically connect.

How to pair with two Bluetooth devices at the same time TX mode

In TX mode, the adapter can pair with two Bluetooth stereo earphones/speakers at the same time.

1. Follow the previous instructions in the "How to use-pairing in TX mode" section to pair the adapter with your first device.
2. Double-click the adapter "MFB" button to enter pairing mode (The LED indicator A/B of the adapter will alternately flash blue).
3. Turn on the second Bluetooth device. Make sure this device is also in pairing mode.
4. Move the adapter and the second device close together and the pairing will be completed automatically.
5. After pairing is completed, the LED indicators A and B of the adapter will turn blue and remain on. At this time, the adapter has already connected to two Bluetooth devices simultaneously.

NOTES:

- To ensure that the adapter will successfully pair with the two Bluetooth devices you want to connect to, make sure there are no other Bluetooth devices within 10 meters of the adapter, especially those that have previously paired with your Bluetooth headset.
- When the adapter is paired with the second Bluetooth device, the first Bluetooth device will not disconnect from the adapter.
- When you pair with two devices, both can play music at the same time.

How to connect to your TV with a Bluetooth adapter?

Types 1–3.5mm Audio cable

- **Step 1:** Use the 3.5mm audio cable we provided to connect your TV to the adapter (In TX mode). Long press the power button of the adapter (In TX mode), then turn on your Bluetooth headset or other device and bring it close to the adapter.
- After the pairing is successful, you should be able to hear your TV through the headset.
- **Step 2:** If not, check your TV settings to make sure that the TV speaker has been set to the headset.



Types 2—RCA cable

- **Step 1:** For RCA this option, Please Only Use the port labeled “audio out”. Any other port will not work.



- **Step 2:** Connect the 3.5 mm audio cable to the RCA aux converter cable that we provided, then use this to connect your TV to the adapter (in TX mode).
- Turn on your Bluetooth headset or other device and move it near the adapter. After the pairing is successful, you should.



PRECAUTIONS

1. When power is low or the adapter is not used for a long time, it should be charged before use to prevent the product from working abnormally or receiving battery damage.
2. Bluetooth signals will be blocked and absorbed by surrounding objects. For the best sound quality, try to use the adapter in a direct line of sight with your connected device.
3. The adapter has a built-in lithium battery, please charge frequently when using it.
4. Please keep the adapter away from water or other liquids to avoid damage.
5. If you have any problems, please feel free to contact us at service@iswitech.com and we will be happy to help you.

Bluetooth ®

- The Bluetooth® word mark and logos are registered trademarks owned by Bluetooth SIG, Inc.
- Any use of such marks by Sunvalleytek International Inc. is under license. Other

FCC Warning

This device complies with part 15 of the FCC Rules. Operation is subject to the following two conditions:

1. This device may not cause harmful interference,
2. this device must accept any interference received, including interference that may cause undesired operation.

Any Changes or modifications not expressly approved by the party responsible for compliance could void the user's authority to operate the equipment.

Note: This equipment has been tested and found to comply with the limits for a Class B digital device, under part 15 of the FCC Rules. These limits are designed to provide reasonable protection against harmful interference in a residential installation. This equipment generates uses and can radiate radio frequency energy and, if not installed and used under the instructions, may cause harmful interference to radio communications. However, there is no guarantee that interference will not occur in a particular installation. If this equipment does cause harmful interference to radio or television reception, which can be determined by turning the equipment off and on, the user is encouraged to try to correct the interference by one or more of the following measures:

- Reorient or relocate the receiving antenna.
- Increase the separation between the equipment and the receiver.
- Connect the equipment to an outlet on a circuit different from that to which the receiver is connected.
- Consult the dealer or an experienced radio/TV technician for help.

Radiation Exposure Statement

To comply with FCC RF exposure compliance requirements, this grant applies to only mobile configurations. The antennas used for this transmitter must be installed to provide a separation distance of at least 20 cm from all persons and must not be co-located or operating in conjunction with any other antenna or transmitter.

IC Warning

This device contains license-exempt transmitters)/receivers) that comply with Innovation, Science, and Economic Development Canada's license-exempt RSS(s). Operation is subject to the following two conditions:

1. This device may not cause interference.
2. This device must accept any interference, including interference that may cause undesired operation of the device.

Radiation Exposure Statement

To comply with FCC RF exposure compliance requirements, this grant applies to only mobile configurations. The antennas used for this transmitter must be installed to provide a separation distance of at least 20 cm from all persons and must not be co-located or operating in conjunction with any other antenna or transmitter.

E-mail: info@iswiitech.com

Documents / Resources



[Swiitech T1 Wireless 2 In 1 Adapter](#) [pdf] User Guide
T1, T1 Wireless 2 In 1 Adapter, Wireless 2 In 1 Adapter, 2 In 1 Adapter, Adapter

References

- [User Manual](#)

Manuals+. Privacy Policy

This website is an independent publication and is neither affiliated with nor endorsed by any of the trademark owners. The "Bluetooth®" word mark and logos are registered trademarks owned by Bluetooth SIG, Inc. The "Wi-Fi®" word mark and logos are registered trademarks owned by the Wi-Fi Alliance. Any use of these marks on this website does not imply any affiliation with or endorsement.