

SWH CDL-OK104 Pendant Lamp



WARNING SHUT POWER OFF AT FUSE OR CIRCUIT BREAKER

Contents [[hide](#)]

[1 Product Description](#)

[2 Documents / Resources](#)

[2.1 References](#)

Product Description

Turn Off The Power

1. Spread the arm to the left and right on the lamp body and adjust it to be evenly

distributed.

2. Put the cover on the part and tighten it.
3. Pass the power cord through the iron pipe, and then screw the iron pipe into the connector on the lamp body in sequence.
4. Install the movable buckle on the chain to the ring on the lamp body, and pass the wire through the chain, movable buckle, ceiling ring and ceiling plate.
5. Install the ceiling plate on the junction box (J-BOX) using the mounting screws.
6. Connect the lamp power cord to the mains using a wiring cap, and connect the lamp ground wire to the house ground wire using a wiring cap.
7. Secure the ceiling plate to the ceiling plate using the ceiling ring.
8. Install a rated wattage bulb (bulb not included).

Turn on the power

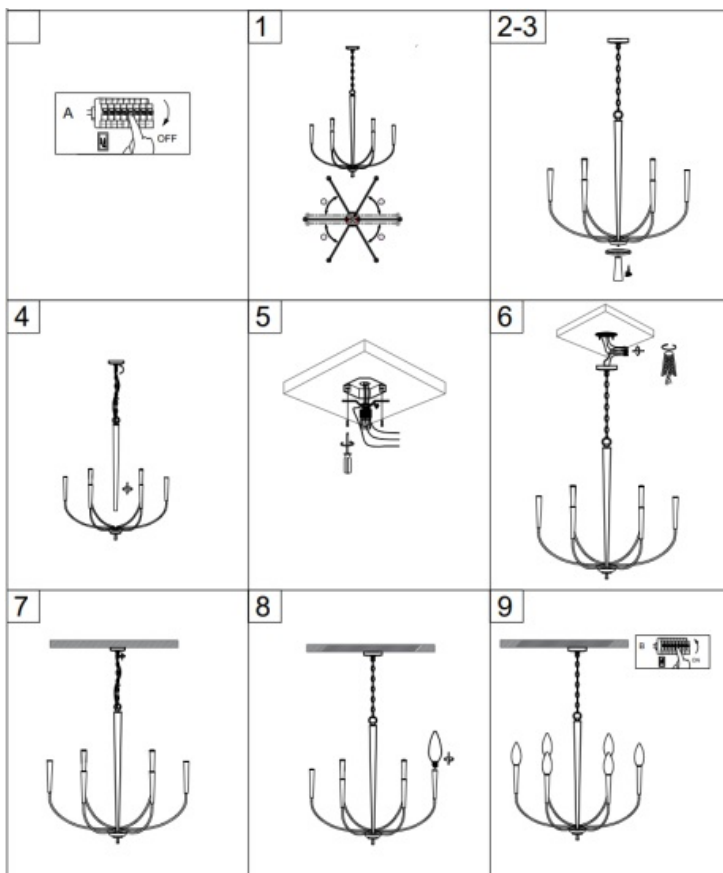

Please completely comply with this instructions and notes to ensure that the product is operated in a safe condition.

Documents / Resources

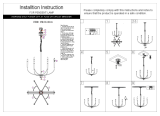

[SWH CDL-OK104 Pendant Lamp \[pdf\]](#) Instruction Manual

CDL-OK104 Pendant Lamp, CDL-OK104, Pendant Lamp, Lamp

References

- [User Manual](#)

SWH CDL-OK104, CDL-OK104 Pendant Lamp, lamp, Pendant Lamp, SWH

Leave a comment

Your email address will not be published. Required fields are marked *

Comment *

Name

Email

Website

☐ Save my name, email, and website in this browser for the next time I comment.

Post Comment

Search:

e.g. whirlpool wrf535swhz

Search

[Manuals+](#) | [Upload](#) | [Deep Search](#) | [Privacy Policy](#) | [@manuals.plus](#) | [YouTube](#)

This website is an independent publication and is neither affiliated with nor endorsed by any of the trademark owners. The "Bluetooth®" word mark and logos are registered trademarks owned by Bluetooth SIG, Inc. The "Wi-Fi®" word mark and logos are registered trademarks owned by the Wi-Fi Alliance. Any use of these marks on this website does not imply any affiliation with or endorsement.