



Swann 2KICAM 2K Indoor WiFi Security Camera User Guide

[Home](#) » [Swann](#) » Swann 2KICAM 2K Indoor WiFi Security Camera User Guide 

Swann 2KICAM 2K Indoor WiFi Security Camera User Guide



Contents

- [1 CAMERA OVERVIEW](#)
- [2 CONNECT THE CAMERA](#)
- [3 GET THE SWANN SECURITY APP](#)
- [4 SET UP THE CAMERA](#)
- [5 CAMERA PLACEMENT](#)
- [6 HELP AND RESOURCES](#)
- [7 FCC STATEMENT](#)
- [8 Documents / Resources](#)
- [9 Related Posts](#)

CAMERA OVERVIEW

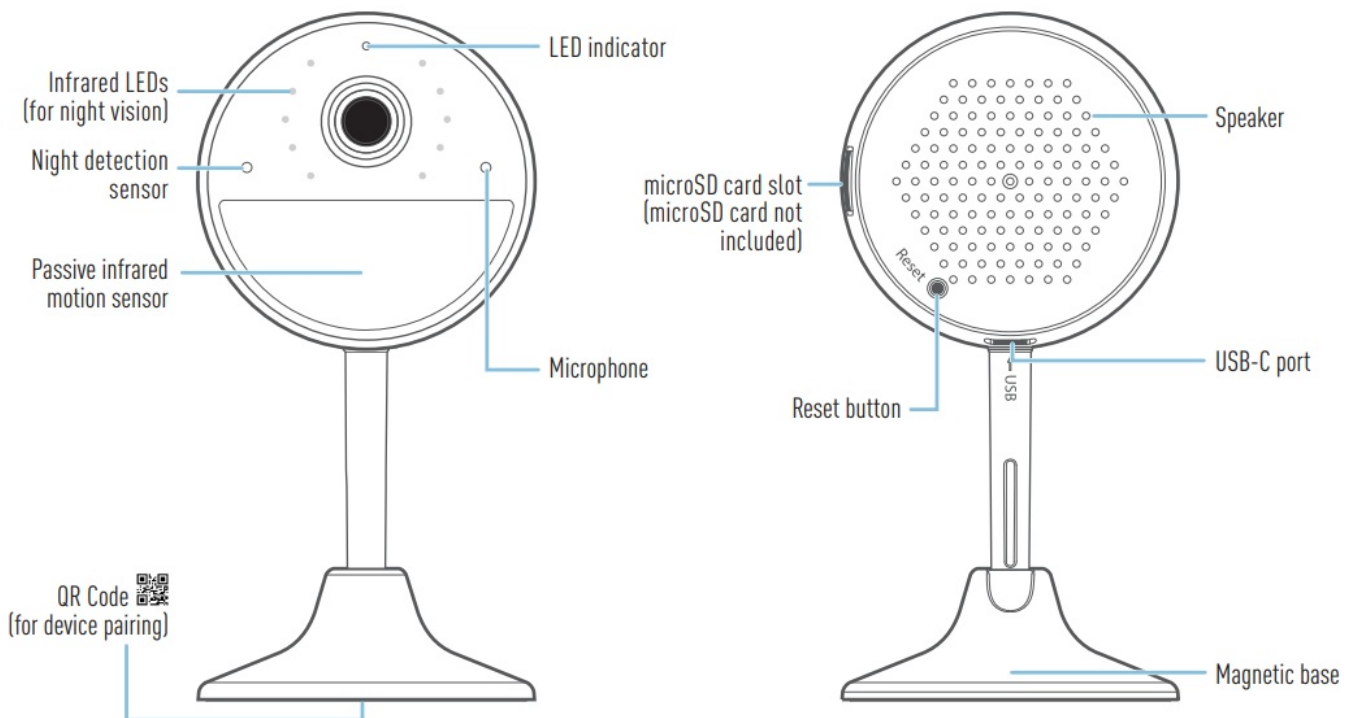

CONNECT THE CAMERA

1. Insert a microSD card (up to 128GB card supported, FAT32 file format) with gold contacts facing the back of the camera into the camera's microSD card slot. A microSD card is required for the camera to record motion events and perform firmware updates.
Note: It is recommended to format any microSD card that you are using for the first time in the camera. You can format the microSD card within the Swann Security app later after the camera has been set up. Go to Device Settings > [select your camera] > Advanced Settings and tap Format.
2. Insert the USB-C plug of the supplied power adapter into the USB-C port on the back of the camera.
3. Connect the power adapter to a wall outlet. Make sure the camera is within range of the Wi-Fi network to which you want to connect.

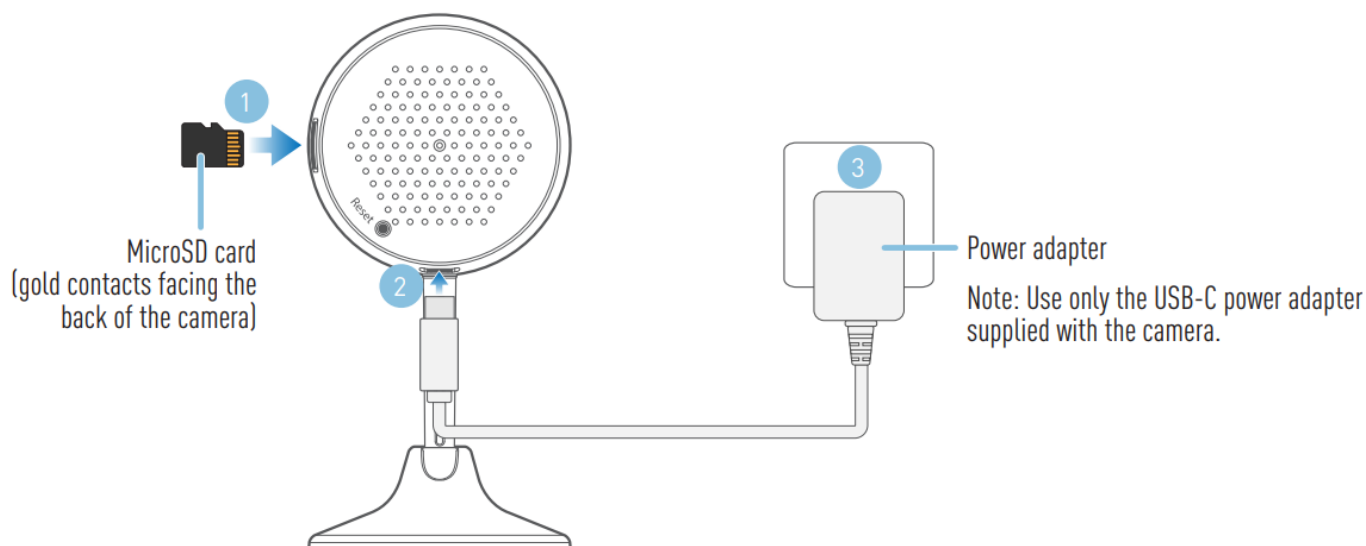

GET THE SWANN SECURITY APP

1. Download the latest version of the Swann Security  app from the Apple App Store® or Google Play™ Store on your iOS or Android device. Simply search for “Swann Security”.
2. Open the app and create your Swann Security account by tapping “Not yet registered? Sign Up” on the screen. Then, activate your Swann Security account by confirming the verification email that is sent to the registered email address.

Swann Security

Welcome to Swann

Your email address

Your password

[Forgot Password?](#)

SIGN IN

Not yet registered? **Sign Up**

By using this app you agree with the Terms of Service
Please read our Privacy Policy

< Sign Up

Let's get started.

First name

Last name

Enter your email address

Enter a password

Please confirm password

NEXT

SET UP THE CAMERA

Launch the Swann Security app and sign in. Tap the Pair Device button on the screen (or tap the menu icon  in the top left and select "Pair Device"). The app will now guide you through the pairing process to set up the camera with your Wi-Fi network.

Before you begin, have the camera powered close to your router and get your Wi-Fi network password ready. Please note that the camera is only compatible with the 2.4GHz network. If your router is using the 5GHz band, please ensure it is operating in mixed mode.

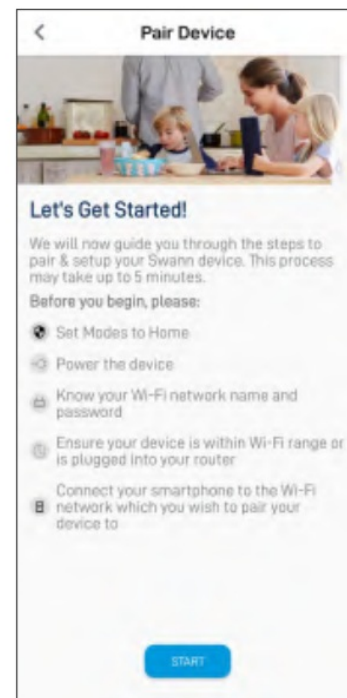
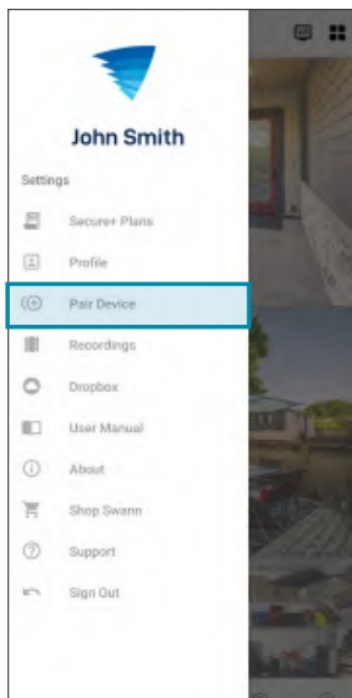

CAMERA PLACEMENT

- The camera can be conveniently placed on a table or shelf, or mounted on a flat surface using the included round metal plate which attaches to the magnetic base of the camera.
- Choose a location with strong, reliable Wi-Fi reception to ensure best video streaming performance. The easiest way to check is to use your smartphone. Connect your smartphone to your Wi-Fi network at the spot you have chosen and see if you get 2 bars of Wi-Fi signal or more.
- As a general rule, the nearer the camera is to your router, the better the wireless connection quality. If you're finding the Wi-Fi signal to be weak or out of range at the location where you intend to place the camera, consider installing a Wi-Fi range extender to boost the Wi-Fi coverage of your existing network.

Mounting the round metal plate (optional)

1. a If mounting to a wooden surface, screw the metal plate directly to the surface.
b If mounting to a masonry surface (brick, concrete), mark and drill a hole, insert the wall plug, and screw the metal plate to the surface.
2. Attach the camera to the metal plate which will provide a strong and secure hold.

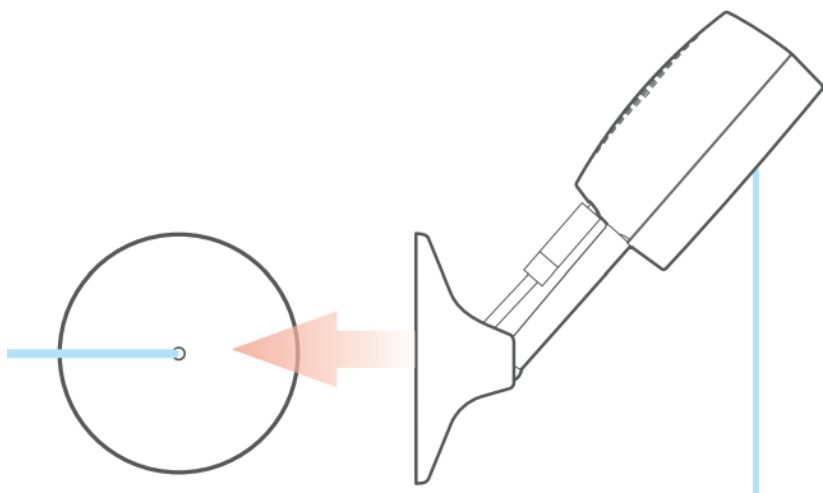

After installation, make sure to remove the protective film covering the camera lens.

HELP AND RESOURCES

Optimizing motion detection

The camera’s PIR motion sensor detects heat signatures of moving objects. You’ll generally get good detection results by pointing the camera downwards at an angle where people will be moving across the coverage area before heading directly towards the camera. The camera’s motion detection sensitivity settings can also be adjusted in the Swann Security app. As every home environment is unique, we recommend experimenting with the motion detection sensitivity levels to find out which works best for yours.

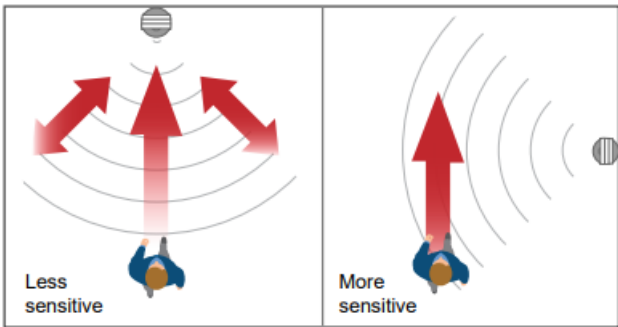

Slow Blinking Blue	Wi-Fi Pairing mode	Solid Red	Live streaming / Motion recording
Fast Blinking Blue	Connecting to Wi-F	Infrared LEDs Blinking	Firmware update in progress

Accessing the Swann Security app manual

To better understand the Swann Security App’s interface and features, download the app manual via Menu  > User Manual. You can learn about navigating the various app screens to view live camera stream, playback and download motion event recordings, adjust camera settings, and more.

Have questions?

Visit our Support Center at support.swann.com. You can register your product for dedicated technical support,

find troubleshooting articles, participate in the community forums, and more. You can also email us at: tech@swann.com

FCC STATEMENT

This equipment has been tested and found to comply with the limits for Class B digital device, pursuant to part 15 of the FCC Rules. These limits are designed to provide reasonable protection against harmful interference in a residential installation. This equipment generates, uses and can radiate radio frequency energy and, if not installed and used in accordance with the instructions, may cause harmful interference to radio communications. However, there is no guarantee that interference will not occur in a particular installation. If this equipment does cause harmful interference to radio or television reception, which can be determined by turning the equipment off and on, the user is encouraged to try to correct the interference by one or more of the following measures:

- Reorient or relocate the receiving antenna
- Increase the separation between the equipment and the receiver
- Connect the equipment into an outlet on a circuit different from that to which the receiver is connected
- Consult the dealer or an experienced radio/TV technician for help.

This device complies with Part 15 of the FCC Rules. Operation is subject to the following two conditions: (1) this device may not cause harmful interference, and (2) this device must accept any interference received, including interference that may cause undesired operation.

FCC RF Radiation Exposure Statement Caution: To maintain compliance with the FCC's RF exposure guidelines, place the product at least 20cm from nearby persons.

WARNING: Modifications not approved by the party responsible for compliance could void user's authority to operate the equipment.

IC STATEMENT

This device complies with Industry Canada license-exempt RSS standard(s). Operation is subject to the following two conditions:

1. this device may not cause interference, and
2. this device must accept any interference, including interference that may cause undesired operation of the device.

The device is compliance with RF field strength limits, users can obtain Canadian information on RF exposure and compliance.

This Class B digital apparatus complies with Canadian ICES-003. This equipment complies with IC radiation exposure limits set forth for an uncontrolled environment. This equipment should be installed and operated with minimum distance 20cm between the radiator & your body.

UK DECLARATION OF CONFORMITY

Hereby, Swann Communications declares that this product is in compliance with the requirements for UKCA marking.

The Declaration of Conformity can be obtained at uk.swann.com/compliance

IMPORTANT SAFETY WARNING — For pluggable equipment, the socket-outlet shall be installed near the equipment and shall be easily accessible.

CHILD SAFETY WARNING Strangulation Hazard — If product is used to monitor infants or small children, keep camera and USB power cable more than 1 metre (3ft) away out of their reach. Do not place camera or cord within a cot, playpen or near a bed.



Documents / Resources

	<p>Swann 2KICAM 2K Indoor WiFi Security Camera [pdf] User Guide</p> <p>2KICAM, VM12KICAM, 2K Indoor WiFi Security Camera, 2KICAM 2K Indoor WiFi Security Camera</p>
---	---