



## SW-MOTECH MSS.06.921.10000-B Engine Guard Instruction Manual

[Home](#) » [SW-MOTECH](#) » SW-MOTECH MSS.06.921.10000-B Engine Guard Instruction Manual 

### Contents

- [1 SW-MOTECH MSS.06.921.10000-B Engine Guard](#)
- [2 Engine guard](#)
  - [2.1 SAFETY ALERT SYMBOL](#)
- [3 PARTS LIST](#)
- [4 MOUNTING](#)
  - [4.1 PRODUCT SPECIFIC INFORMATION](#)
- [5 Documents / Resources](#)
- [6 Related Posts](#)



### SW-MOTECH MSS.06.921.10000-B Engine Guard



## READ AND SAVE THESE MOUNTING INSTRUCTIONS

### Engine guard

Thank you for choosing this premium product from SW-MOTECH. Please carefully read and understand all instructions, safety messages and warnings in this mounting instructions prior to installation and use of this product to avoid injury.

This product was developed for vehicles in their factory setting. Compatibility with original accessory parts or other manufacturers' accessory parts is not guaranteed. Visit our webshop for additional information, such as application charts and PDF mounting instructions. Any other documents that may be required (e.g. ABE certifications), are also available for download at our webshop. Keep these mounting instructions as reference. SW-MOTECH assumes no liability for damage caused by improper installation and/or maintenance work!

### SAFETY ALERT SYMBOL

A This safety alert symbol is used throughout these mounting instructions to warn of the possibility of death, bodily injury or other warnings. The words DANGER, WARNING and CAUTION are used with this safety alert symbol to convey important safety messages and information related to the installation and use of this product. These words along with the safety alert symbol mean:

**DANGER:** Indicates a hazardous situation that, if not avoided, will result in death or serious injury!

**WARNING:** Indicates a hazardous situation that, if not avoided, could result in death or serious injury!

**CAUTION:** Indicates a hazardous situation that, if not avoided, could result in minor or moderate injury!

**NOTICE:** Important information, but not death or injury related [property damage only]!

**WARNING:** The installation and/or maintenance of this product requires advanced mechanical skills, the proper tools, and a thorough understanding of tool use and torque specifications.

For your own safety, SW-MOTECH recommends having installation and/or maintenance carried out by a qualified and certified motorcycle mechanic.

**WARNING:** Should you choose to self-install this product, carefully and completely read all installation and safety instructions before installation and use, and follow all the directions and safety precautions given in the mounting instructions to avoid serious injury or death. Also pay attention to all relevant information in the vehicle manual during installation and use. IF YOU DO NOT UNDERSTAND ANY PART OF THESE INSTRUCTIONS, OR NEED CLARIFICATION OF ANY INSTRUCTION, DO NOT ATTEMPT TO MOUNT THIS PRODUCT WITHOUT CONTACTING SW-MOTECH FOR ASSISTANCE.

**PREPARATION:** Read the mounting instructions carefully and make sure that all items of the parts list are included.

**CAUTION:** Make sure that your vehicle is parked safely and cannot fall over. Turn off the engine and remove the ignition key. Let the engine/exhaust cool off if necessary. Disconnect the vehicle battery when working on the electrical system. Use appropriate tools and wear always safety glasses and hand protection. Have another person help you.

**MOUNTING:** All parts and connections removed from the vehicle must be reinstalled in accordance with the vehicle manufacturer specifications or replaced by parts and hardware delivered by SW-MOTECH.

**WARNING:** Secure all threads, unless otherwise specified, with mediumstrong strength liquid thread locker. Torque specifications undefined by SW-MOTECH must be obtained from the vehicle manufacturer or by a certified motorcycle workshop!

**FUNCTION CHECK:** After installation also make sure that no moving parts are obstructed, and function of the vehicle is not hindered in any way. Cables and hoses must not rub and/or be pinched.

**WARNING:** Before starting to ride, perform a comprehensive check of all functions. After the first 50 km and then at regular intervals, check the tightening torque of all connections and the proper fit of the product. Installed accessories can change driving behavior/stability of the vehicle.

### PARTS LIST

Schritt Step	Nr. No.	Art.-Nr. / Bezeichnung <sup>a</sup> Item No. / Description <sup>a</sup>	Artikel	Part	Anzahl <sup>b</sup> Quantity <sup>b</sup>	N·m <sup>c</sup>
<b>3</b>	(1)	MSS.06.921.003	Anbaublech; links	Mounting Bracket; left	1 / 1	
	(2)	M10 x 50; DIN 961	Sechskantschraube; Feingew.; schwarz	Hexagon Screw; fine thread; black	2 / 4	OEM
	(3)	ø 10,5; DIN 125	Unterlegscheibe; schwarz	Washer; black	2 / 4	
<b>5</b>	(4)	MSS.06.921.004	Anbaublech; vorn	Mounting Bracket; front	1 / 1	
	(5)	M8 x 30; DIN 912	Innensechskantschraube; schwarz	Hexagon Socket Screw; black	1 / 1	OEM
	(6)	ø 8,4; DIN 9021	Unterlegscheibe; schwarz	Washer; black	2 / 2	
	(7)	M8; DIN 985	Mutter, selbstsichernd	Lock Nut	1 / 1	
<b>7</b>	(8)	MSS.06.921.002	Anbaublech; rechts	Mounting Bracket; right	1 / 1	
	(9)	M10 x 50; DIN 961	Sechskantschraube; Feingew.; schwarz	Hexagon Screw; fine thread; black	2 / 4	OEM
	(10)	ø 10,5; DIN 125	Unterlegscheibe; schwarz	Washer; black	2 / 4	
	(11)	Ø 18 / ø 10,5 / h 14	Distanzbuchse; schwarz	Spacer; black	2 / 2	
<b>8</b>	(12)	MSS.06.921.900.01	Motorschutz; schwarz / silbern	Engine Guard; black / silver	1 / 1	
	(13)	M8 x 20; DIN 7991	Senkkopfschraube; schwarz	Countersunk Screw; black	1 / 1	18
	(14)	M8 x 25; DIN 7991	Senkkopfschraube; schwarz	Countersunk Screw; black	5 / 5	18
	(15)	ø 8,4	Senkscheibe; schwarz	Countersunk Washer; black	6 / 6	



## MOUNTING

### WARNING:

- Always wear eye and hand protection
- Always use the appropriate tools.

1. Remove the spring from the side stand and remove the screw from the gear lever

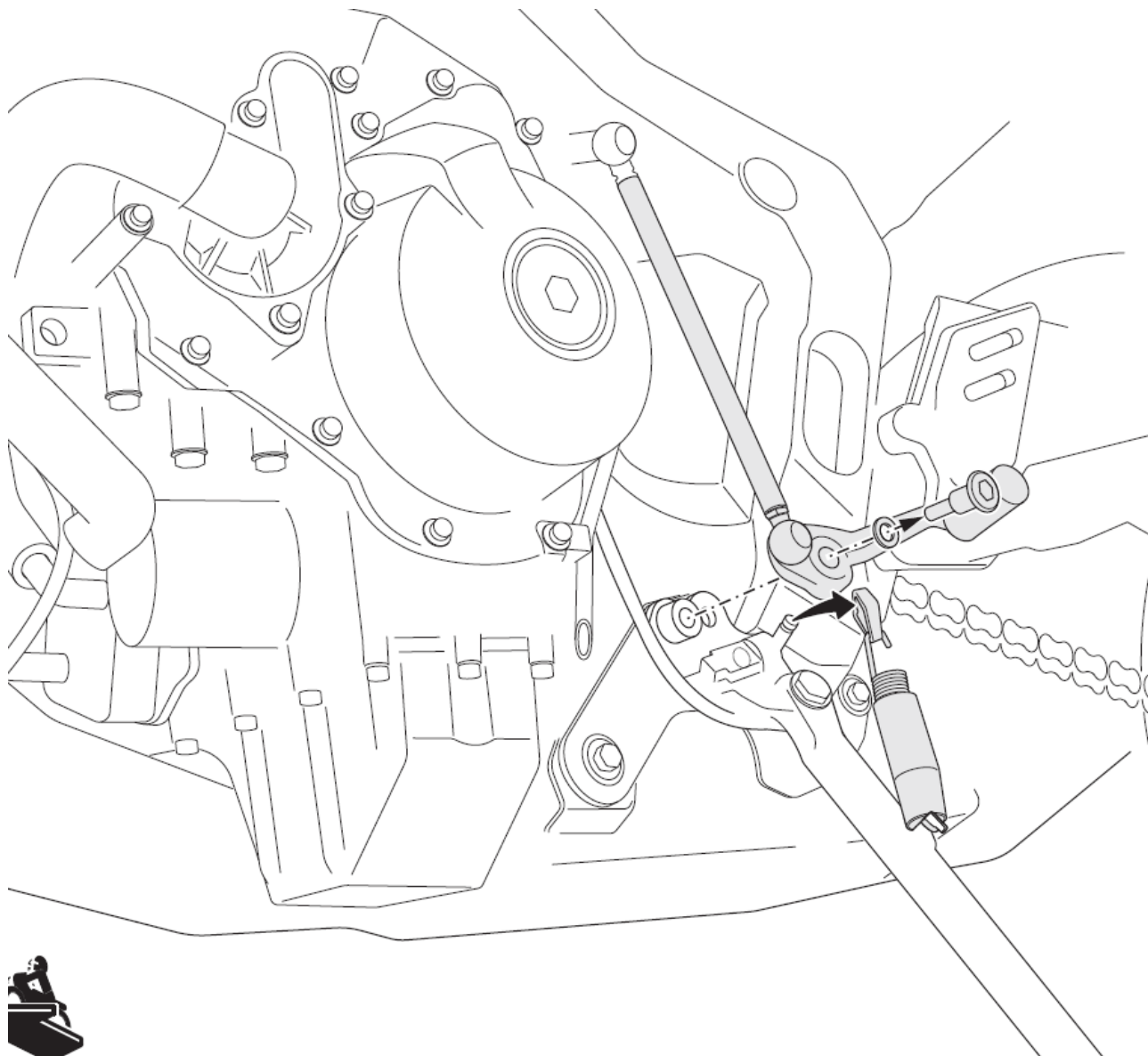

2. Remove the shown screw and take the SI "de stand from the mounting bracket.

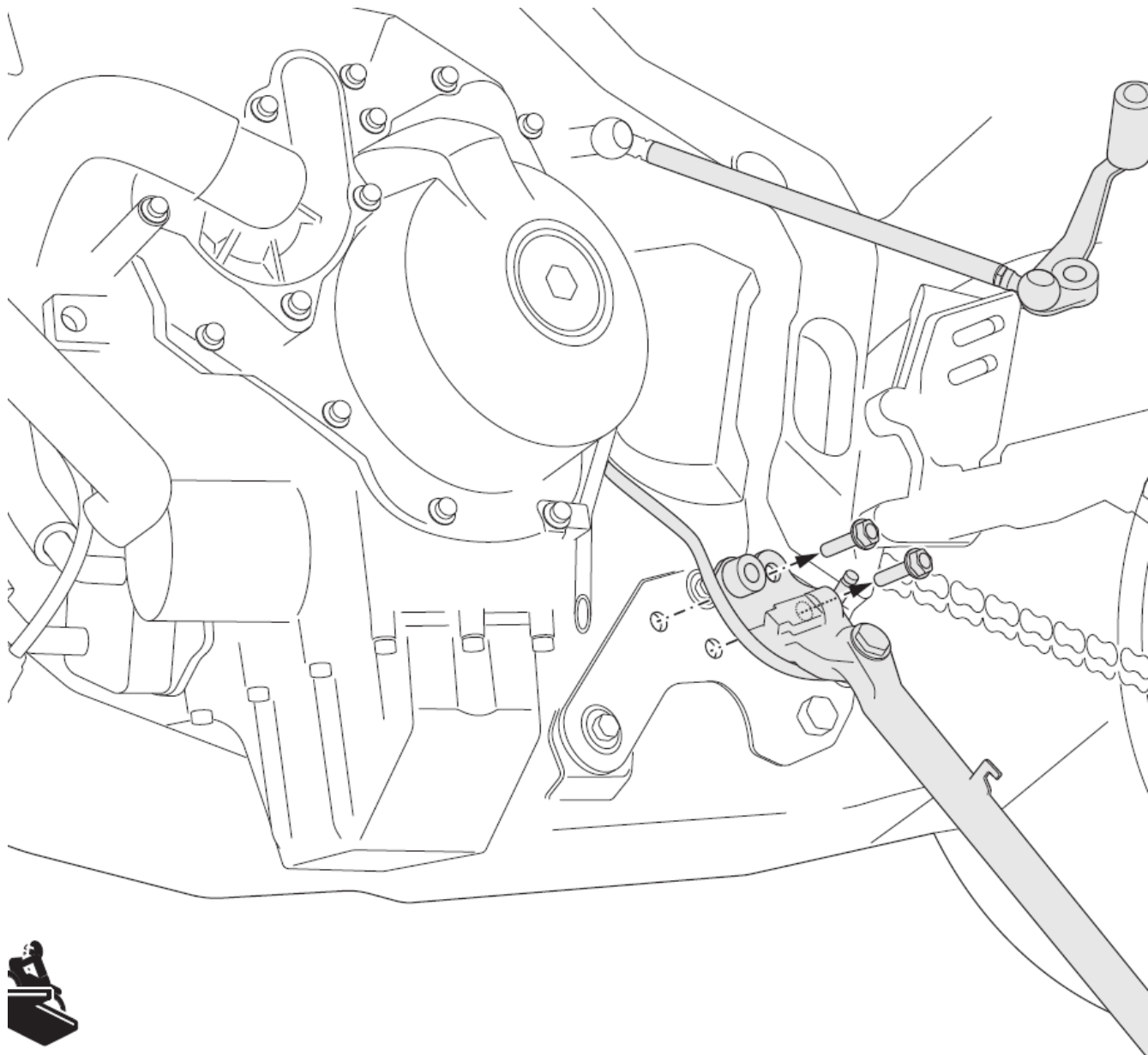

3.

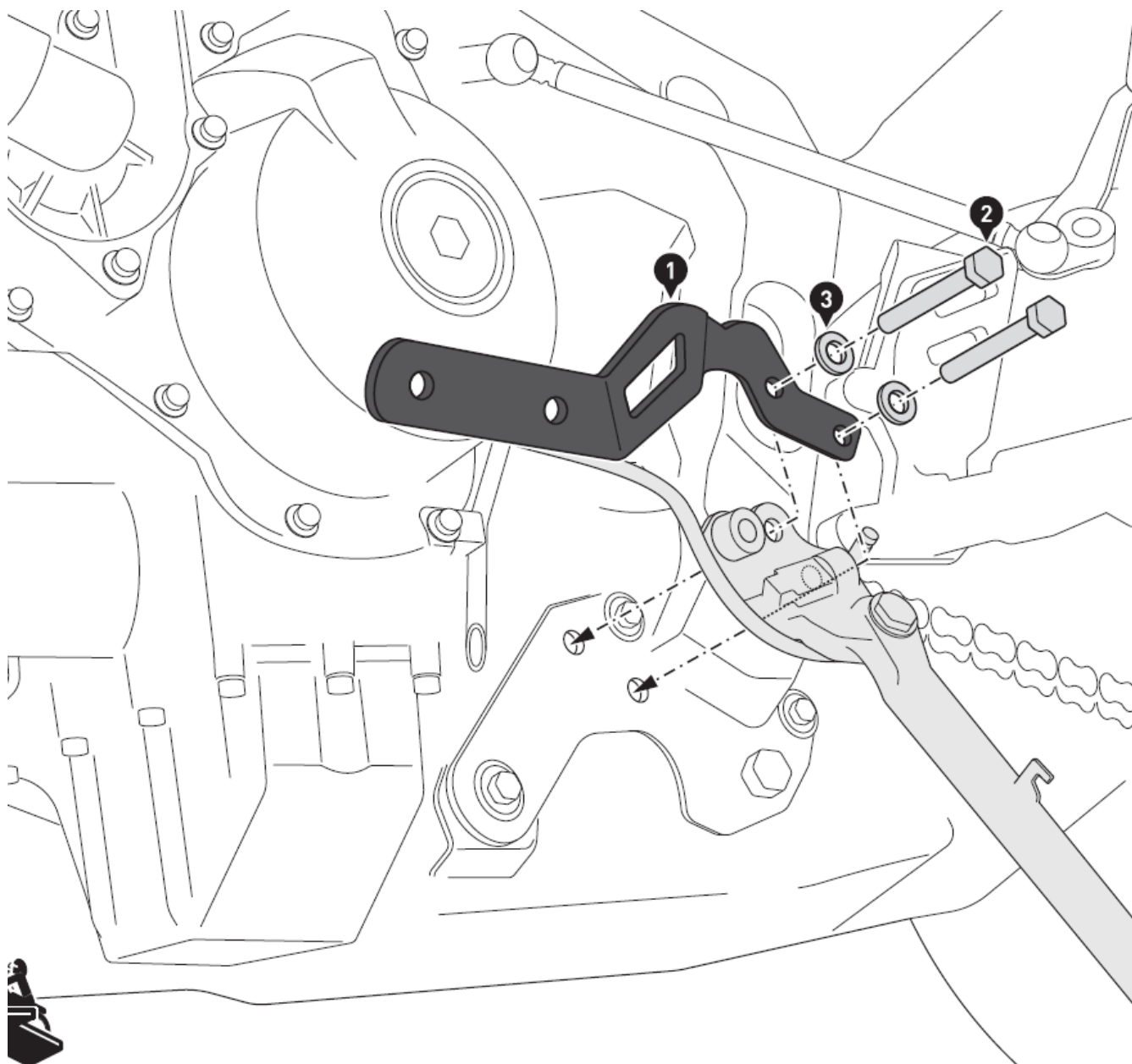

4. Hook the Original Spring on the side stand. Coat the shaft of the original screw (Orig.) original Reattach with the gear lever with the original screw to the vehicle Tighten the screw with the manufactures specified torque.

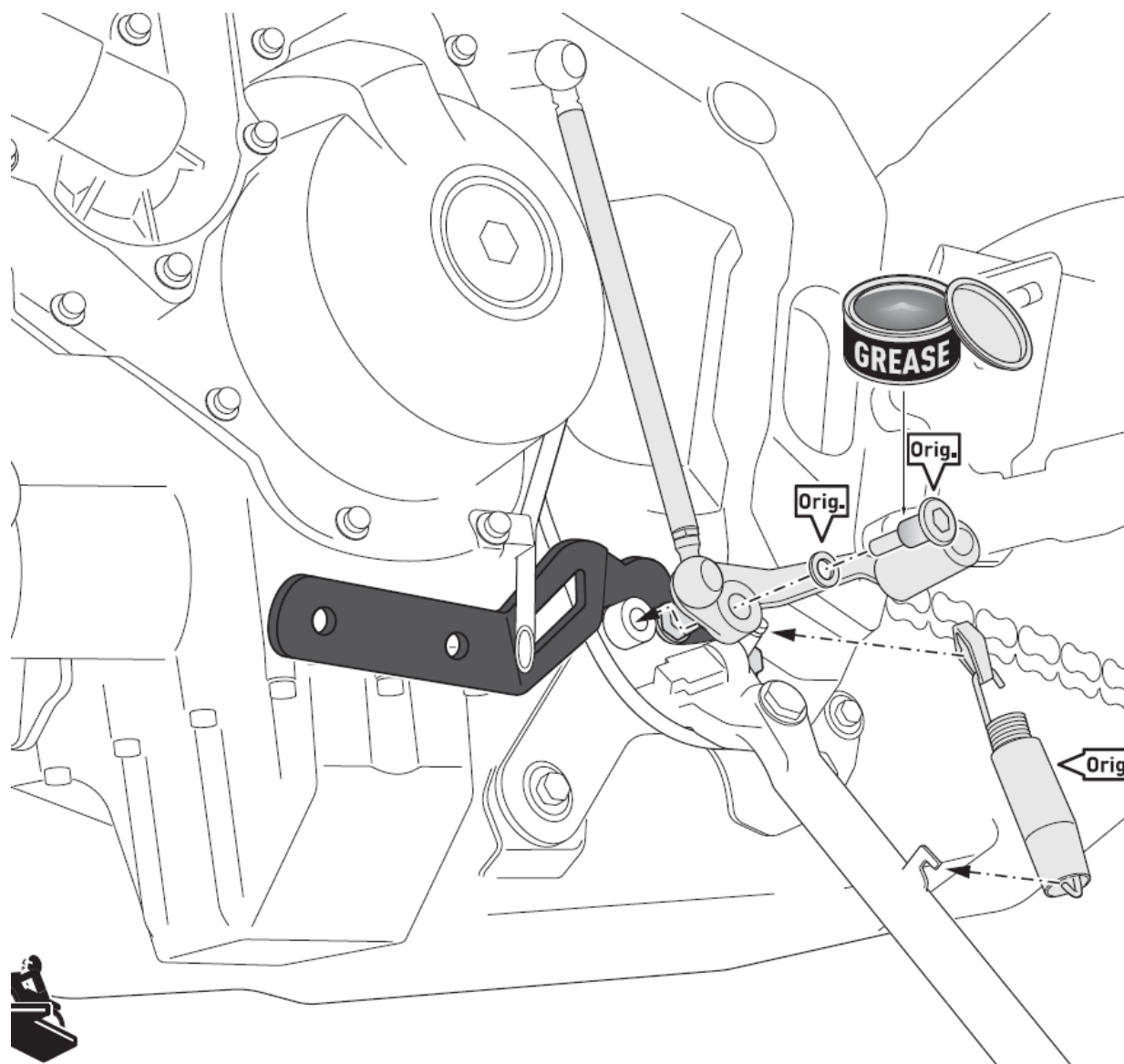

5. Attach the mounting bracket (4) on the left side to the vehicle.

**WARNING:** Use liquid thread locker! Do not fully tighten the screw yet.



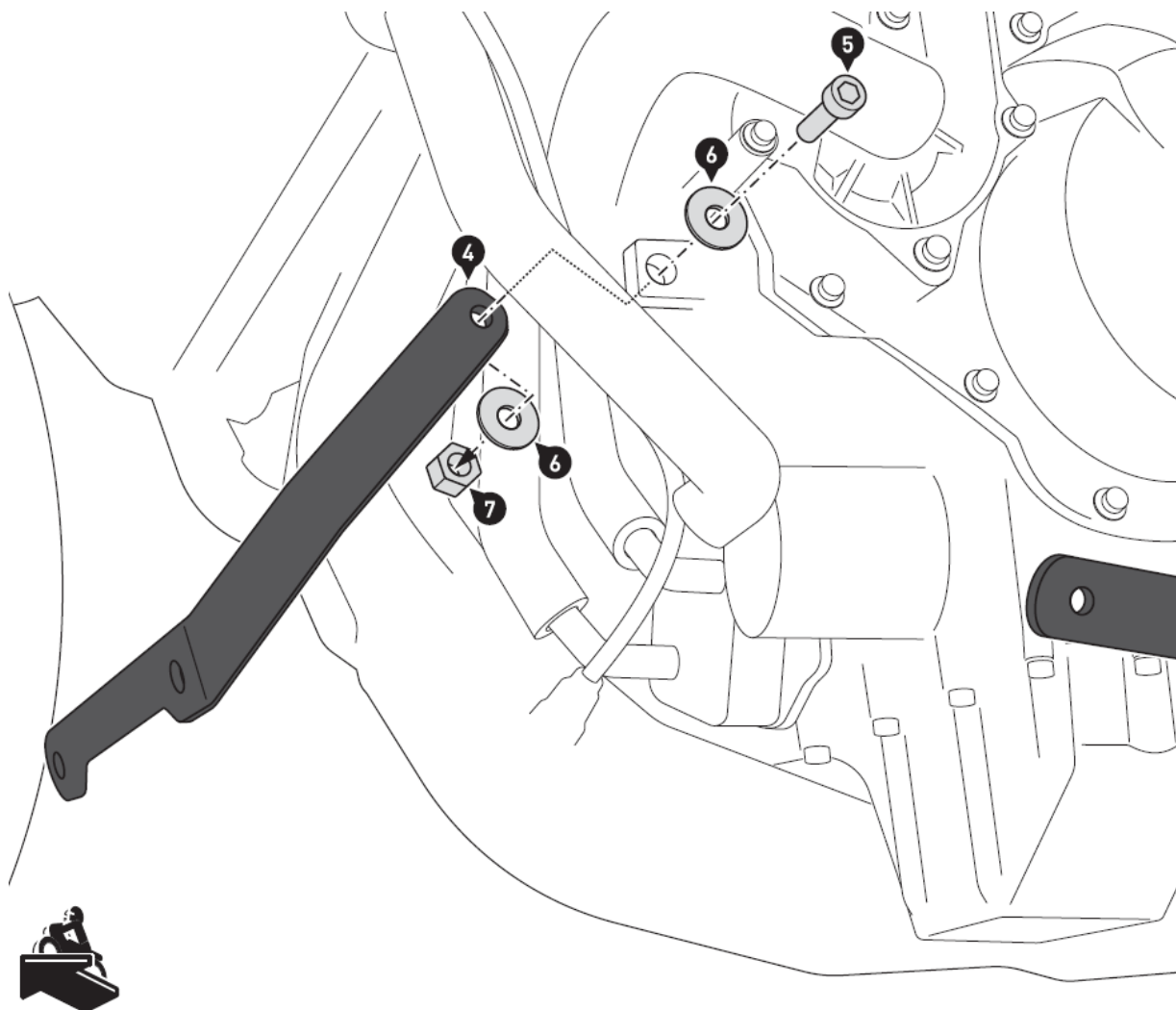

6. Remove on the right side of the vehicle the two screws, as shown in the drawing.



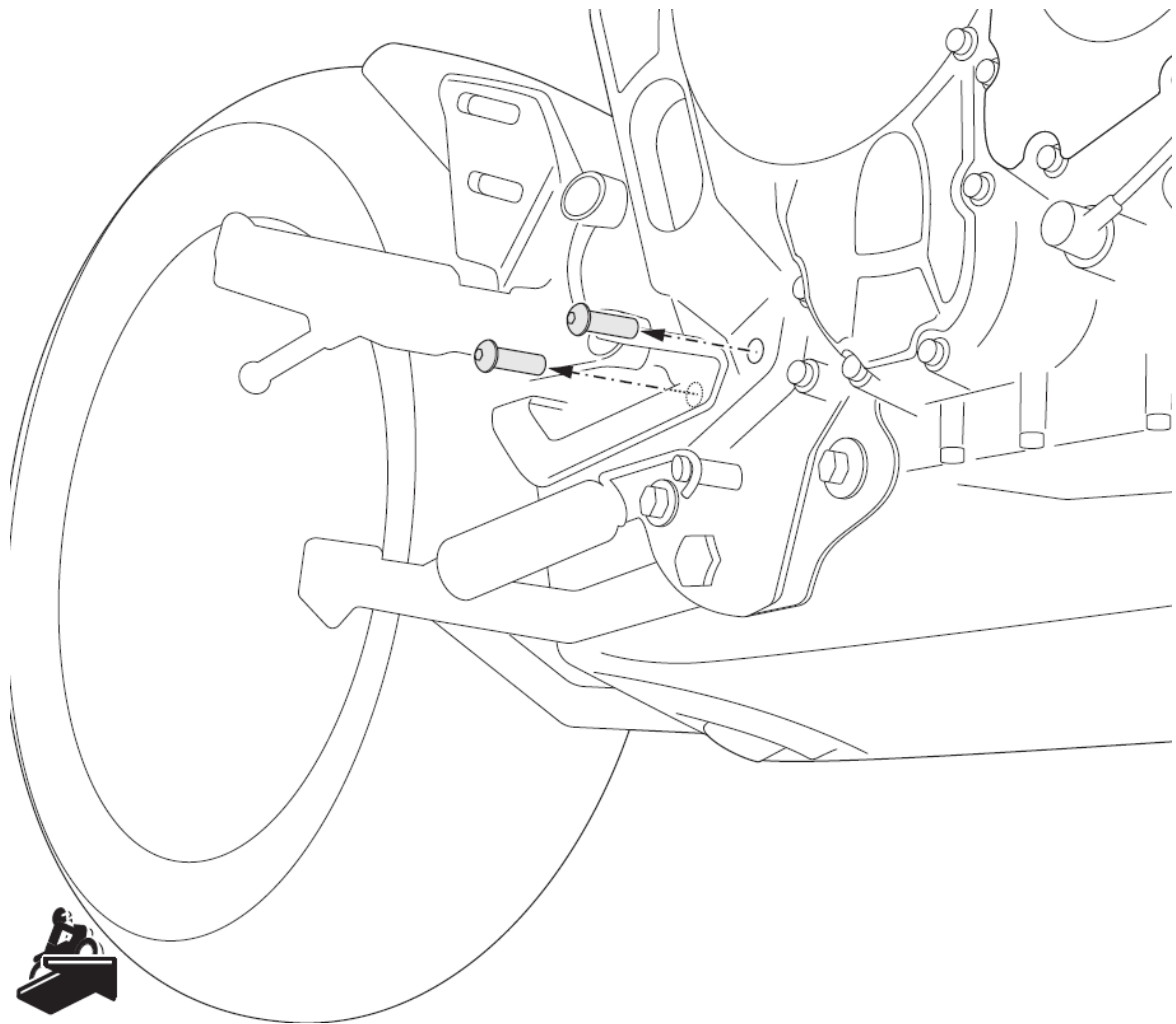

7. Attach the mounting bracket (8) on the right side Behind the break lever to the vehicle.

**WARNING:** Use liquid thread locker! Do not fully tighten the screws yet.

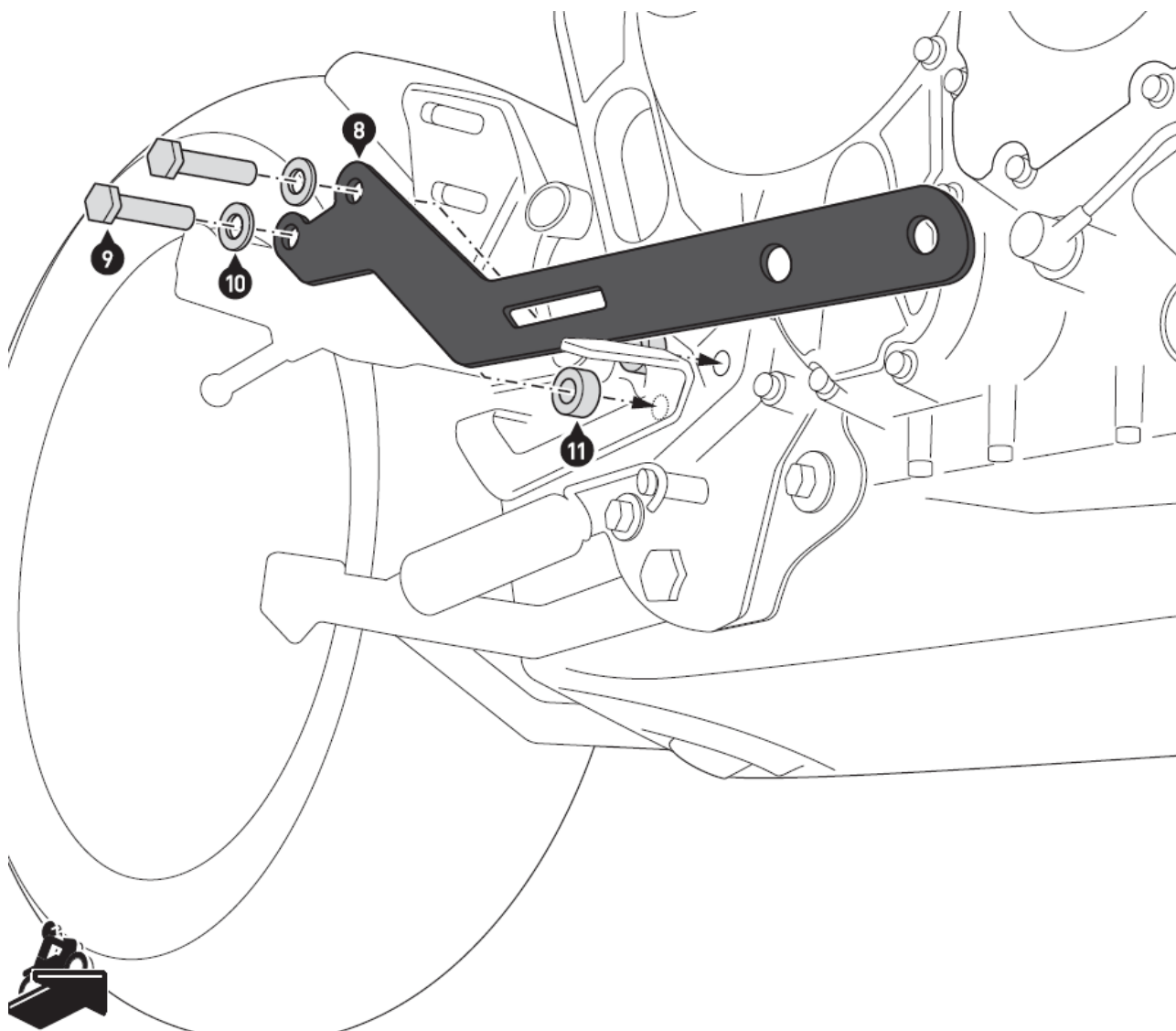







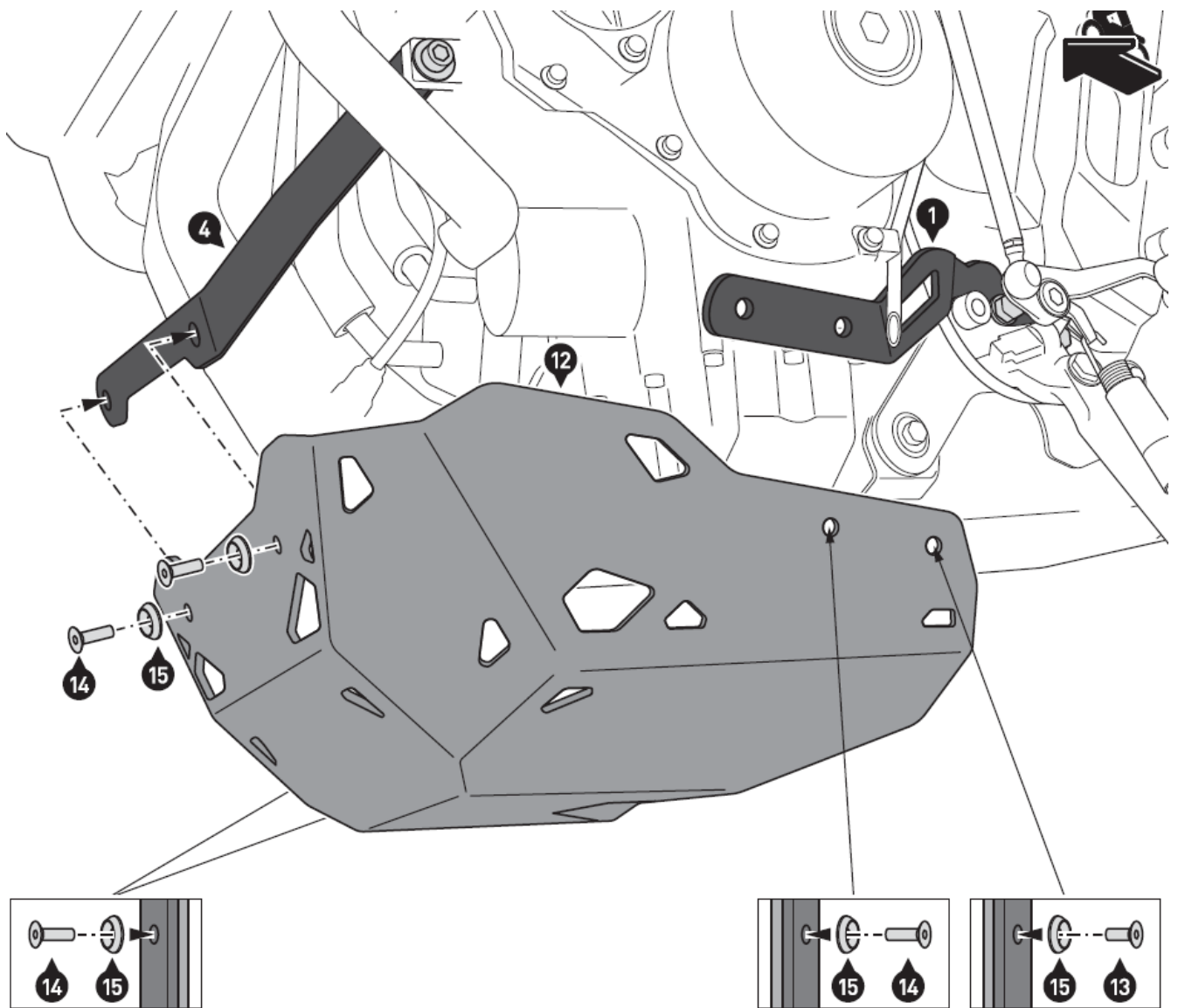

8. Attach the engine guard (12) to the mounting brackets (1), (4) and (8). Pay attention to the position of screw (13).

**WARNING:** Use liquid thread locker!

Once all parts are evenly positioned without excess tension, tighten the screws as specified.

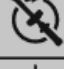

Tighten the screws (2), (5) and (9) with the manufacturers' specified torque.

<b>2</b>			<b>OEM</b>
<b>5</b>			<b>OEM</b>
<b>9</b>			<b>OEM</b>
<b>13</b>			<b>18 N·m</b>
<b>14</b>			<b>Medium</b>

#### PRODUCT SPECIFIC INFORMATION

#### WARNING:

- Ground clearance can be reduced by this product! Special care should be taken when cornering at extreme lean angles and / or riding on uneven surfaces (for example curbs and bumps)!

- All motorcycle exhaust pipes have large geometric tolerances. Make sure to double-check all part clearances in the affected areas!

## Documents / Resources

	<p><a href="#">SW-MOTEC MSS.06.921.10000-B Engine Guard</a> [pdf] Instruction Manual MSS.06.921.10000-B Engine Guard, MSS.06.921.10000-B, Engine Guard, Guard</p>
---	---