

 **SW-MOTECH®**
SW-MOTECH
GPT.04.790.65000-
B Top Case System



SW-MOTECH GPT.04.790.65000-B Top Case System Instruction Manual

[Home](#) » [SW-MOTECH](#) » SW-MOTECH GPT.04.790.65000-B Top Case System Instruction Manual 

Contents

- [1 SW-MOTECH GPT.04.790.65000-B Top Case System](#)
- [2 Product Usage Instructions](#)
- [3 MOUNTING INSTRUCTIONS](#)
- [4 PREPARATION](#)
- [5 PARTS LIST](#)
- [6 MOUNTING](#)
- [7 PRODUCT SPECIFIC INFORMATION](#)
- [8 Documents / Resources](#)
 - [8.1 References](#)
- [9 Related Posts](#)



SW-MOTECH GPT.04.790.65000-B Top Case System



Product Specifications

- Manufacturer: SW-MOTECH GmbH & Co. KG
- Model: GPT.04.790.65000/B
- Weight Capacity: Up to 5 KG (11 pounds)
- Speed Rating: Up to 130 km/h (80 mph)
- Material: Various components with stainless steel screws

Product Usage Instructions

General Information

This kit is designed for the ADVENTURE-RACK. Follow the instructions carefully to ensure proper installation and usage.

Installation Steps

1. Pull the cover limiters to secure them in place.
2. Insert the closing connector of the box and push it down until it clicks into place.
3. Screw the closing connector using the provided screws and the torx key. Hand-tighten the screws carefully.

Important Notes

Check the locking mechanism's functionality after installation.

Frequently Asked Questions (FAQ)

- **Q: What is the weight capacity of the product?**
 - A: The product can support weights up to 5 KG (11 pounds).
- **Q: What is the maximum speed rating for the product?**
 - A: The product is rated for speeds up to 130 km/h (80 mph).

ANBAUANLEITUNG

mounting instructions

contains

- GPT.04.790.19002/B
- GPT.00.152.36200/B
- HSK.00.745.11000/B
- LOC.00.745.10100

MOUNTING INSTRUCTIONS

READ AND SAVE THESE MOUNTING INSTRUCTIONS

Revision: 00 –

Datum / Date: 06 – 2022

ADVENTURE – RACK

Thank you for choosing this premium product from SW-MOTECH. Please carefully read and understand all instructions, safety messages and warnings in this mounting instructions prior to installation and use of this product to avoid injury.

This product was developed for vehicles in their factory setting. Compatibility with original accessory parts or other manufacturers' accessory parts is not guaranteed. Visit our webshop for additional information, such as application charts and PDF mounting instructions. Any other documents that may be required (e.g. ABE certifications), are also available for download at our webshop. Keep these mounting instructions as reference.

SW-MOTECH assumes no liability for damage caused by improper installation and/or maintenance work!

SAFETY ALERT SYMBOL

This safety alert symbol is used throughout these mounting instructions to warn of the possibility of death, bodily injury or other warnings. The words DANGER, WARNING and CAUTION are used with this safety alert symbol to convey important safety messages and information related to the installation and use of this product. These words along with the safety alert symbol mean:

- **DANGER:** Indicates a hazardous situation that, if not avoided, will result in death or serious injury!
- **WARNING:** Indicates a hazardous situation that, if not avoided, could result in death or serious injury!
- **CAUTION:** Indicates a hazardous situation that, if not avoided, could result in minor or moderate injury!
- **NOTICE:** Important information, but not death or injury related (property damage only)!
- **WARNING:** The installation and/or maintenance of this product requires advanced mechanical skills, the proper tools, and a thorough understanding of tool use and torque specifications.

For your own safety, SW-MOTECH recommends having installation and/or maintenance carried out by a qualified and certified motorcycle mechanic.

- **WARNING:** Should you choose to self-install this product, carefully and completely read all intallation and safety instructions before installation and use, and follow all the directions and safety precautions given in the mounting instructions to avoid serious injury or death. Also pay attention to all relevant information in the vehicle manual during intallation and use. IF YOU DO NOT UNDERSTAND ANY PART OF THESE INSTRUCTIONS, OR NEED CLARIFICATION OF ANY

INSTRUCTION, DO NOT ATTEMPT TO MOUNT THIS PRODUCT WITHOUT CONTACTING SW-MOTECH FOR ASSISTANCE.

PREPARATION

Read the mounting instructions carefully and make sure that all items of the parts list are included.

CAUTION: Make sure that your vehicle is parked safely and cannot fall over. Turn off the engine and remove the ignition key. Let the engine/exhaust cool off if necessary. Disconnect the vehicle battery when working on the electrical system. Use appropriate tools and wear always safety glasses and hand protection. Have another person help you.

MOUNTING: All parts and connections removed from the vehicle must be reinstalled in accordance with the vehicle manufacturer specifications or replaced by parts and hardware delivered by SW-MOTECH.

WARNING: Secure all threads, unless otherwise specified, with mediumstrong strength liquid thread locker. Torque specifications undefined by SW-MOTECH must be obtained from the vehicle manufacturer or by a certified motorcycle workshop!

FUNCTION CHECK: After installation also make sure that no moving parts are obstructed, and function of the vehicle is not hindered in any way. Cables and hoses must not rub and/or be pinched.

WARNING: Before starting to ride, perform a comprehensive check of all functions. After the first 50 km and then at regular intervals, check the tightening torque of all connections and the proper fit of the product. Installed accessories can change driving behavior/stability of the vehicle.

- Packed by
- Date of packaging

SW-MOTECH GmbH & Co. KG

- Ernteweg 7-10
- 35282 Rauschenberg Germany
- **Tel.** I phone + 49 (0)6425 / 8168 – 050
- **Fax/ fax+** 49 (0)6425 / 8168 – 10
- info@sw-motech.com
- www.sw-motech.com

PARTS LIST

READ AND SAVE THESE MOUNTING INSTRUCTIONS

Part	Anzahl ^b Quantity ^b	N·m ^c
Mounting Bracket; left / right	2 / 2	
Hexagon Socket Screw, short head; black	2 / 2	18
Washer; black	4 / 4	
Spacer; height 13 mm	2 / 2	
Hexagon Socket Screw, short head; black	2 / 2	18
Spacer; height 3 mm	2 / 2	
Hexagon Socket Screw, short head	2 / 2	18
Hexagon Socket Screw, short head	2 / 2	18
Spacer; height 23 mm	2 / 2	
Hexagon Socket Screw; black	2 / 2	18
Luggage Rack	1 / 1	
Lenshead Screw; black	4 / 4	9,6
Washer; black	4 / 4	
Lock Nut with Flange; black	4 / 4	

Note: a All measurements in millimeters. b The second number indicates the total quantity of the part in the delivery.

No torque specifications: Use the torque defined by vehicle manufacturer! The standard torque in this table can be used as long as it is within the vehicle manufacturer's specifications.

8.8	Coarse Thread Ø					
	Steel CL 8.8 N·m					
	M4	M5	M6	M8	M10	M12
	2,8	5,5	9,6	23	46	79

10.9	Coarse Thread Ø					
	Steel CL 10.9 N·m					
	M4	M5	M6	M8	M10	M12
	4,1	8,1	14	34	67	115

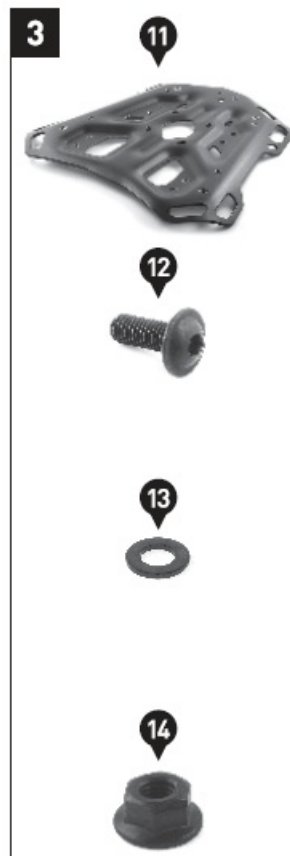

MOUNTING

READ AND SAVE THESE MOUNTING INSTRUCTIONS

WARNING: Always wear eye and hand protection!

WARNING: Always use appropriate tools!

Remove the luggage carrier and the passenger grips from the vehicle.

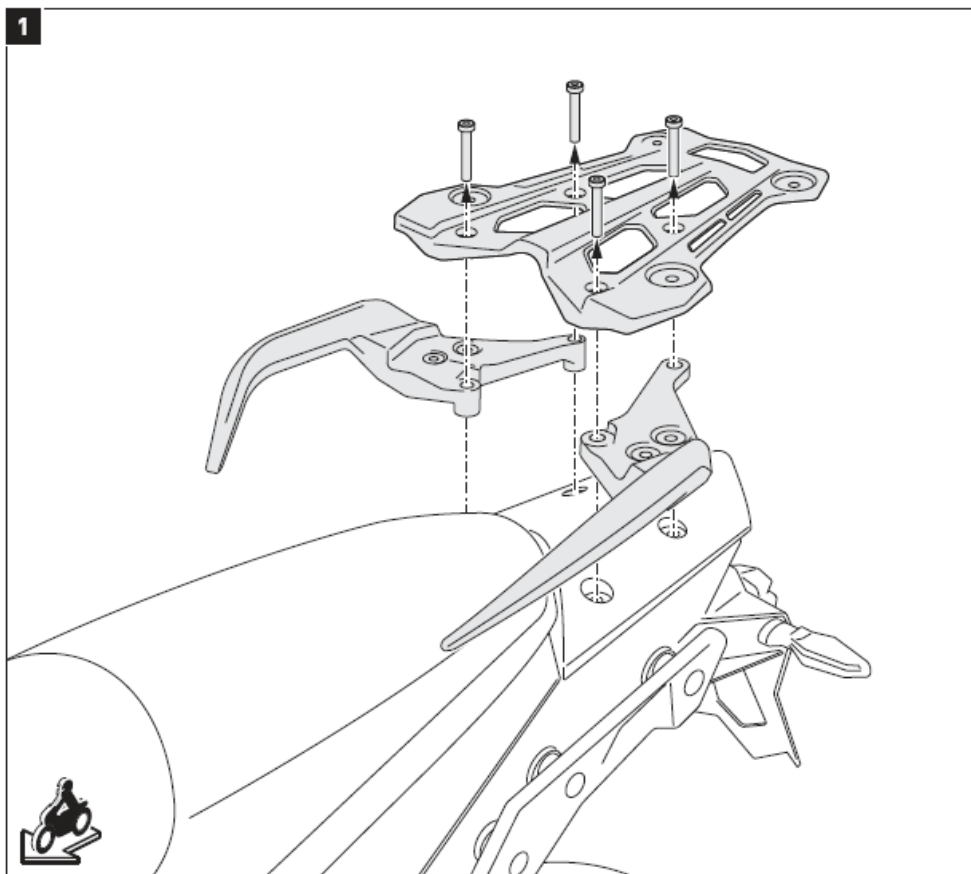

NOTICE: Use for mounting to the Duke 790 Adventure the screws (7) and (BJ instead of the screws (2) and (5). Attach the mounting brackets (1) with the passenger grips to the vehicle.

WARNING: Use liquid thread locker!
Do not fully tighten the screws yet.

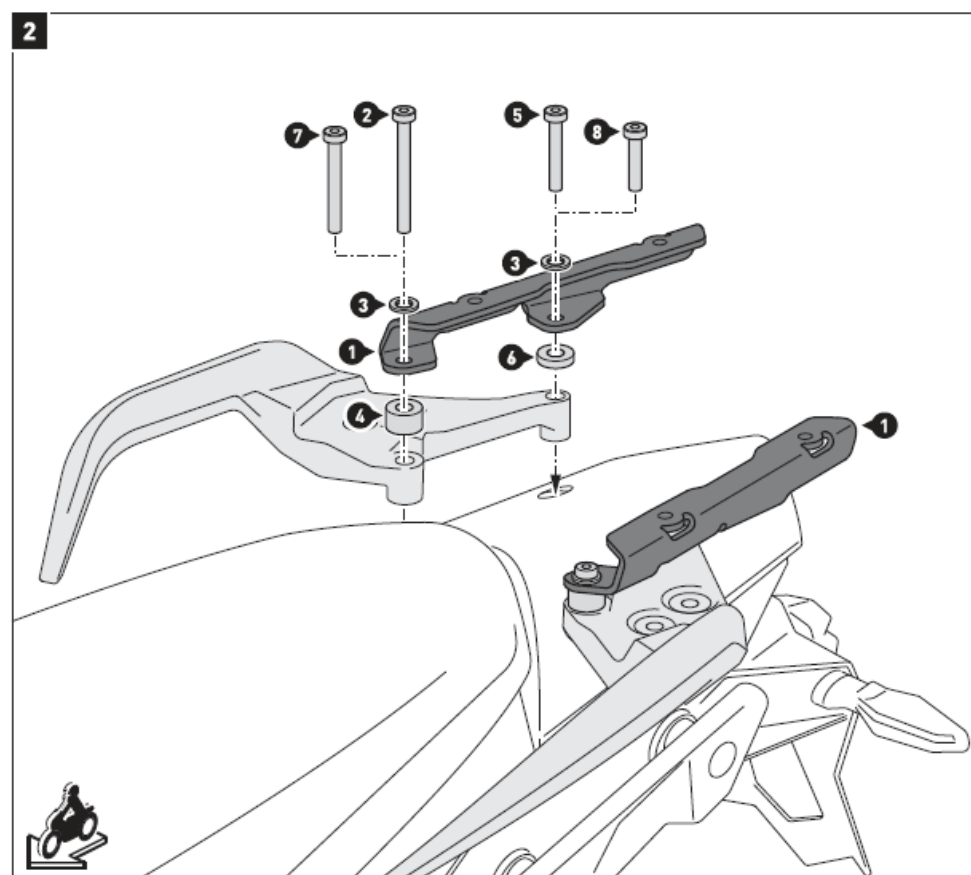

2		
5		Medium

7		
8		Medium

NOTICE: Use for mounting to the Husqvarna Norden additionally the spacer {6J at the rear mounting point. Attach the mounting brackets (1) to the vehicle, as shown in the drawing.

WARNING: Use liquid thread locker!
Do not fully tighten the screws yet.

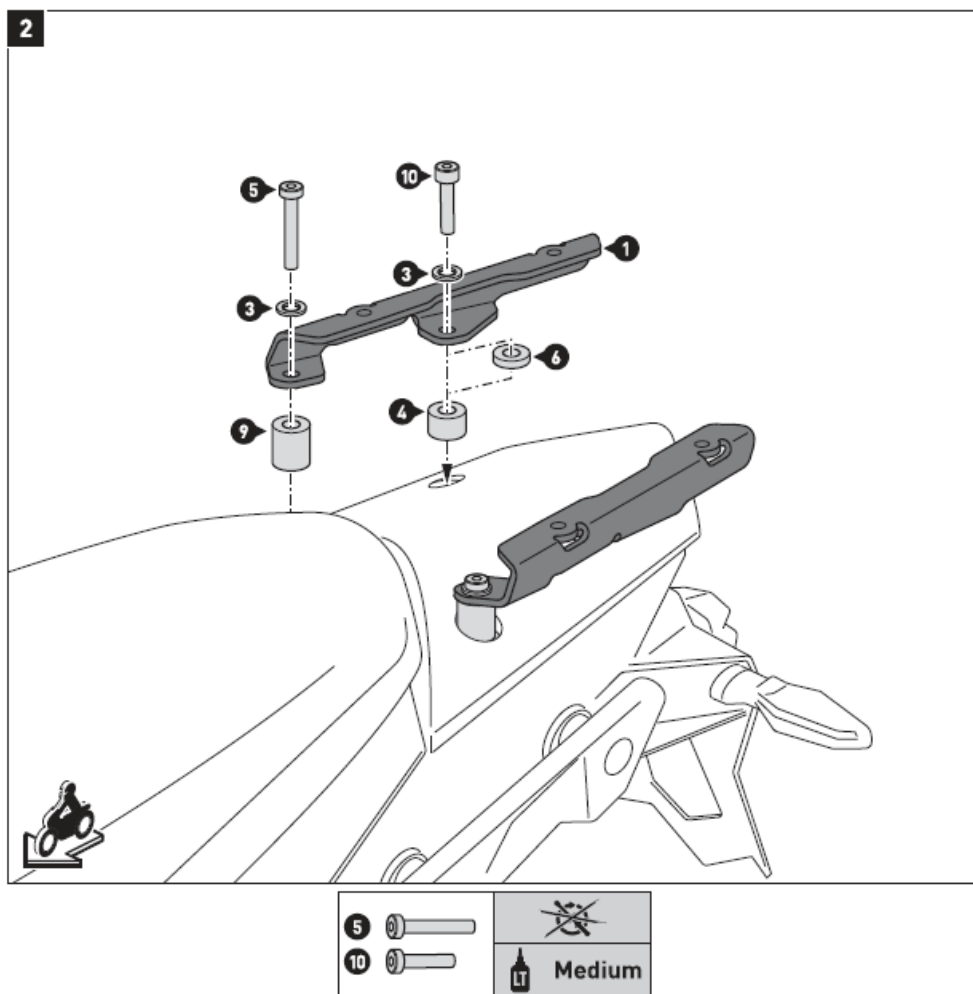

NOTICE: Choose the marked front or rear mounting position {A I BJ according to your preferences. If necessary remove the seat while mounting the luggage rack {11J.

- Attach the luggage rack (11) to the mounting brackets (1).
- Once all parts are evenly positioned without excess tension, tighten the screws as specified.

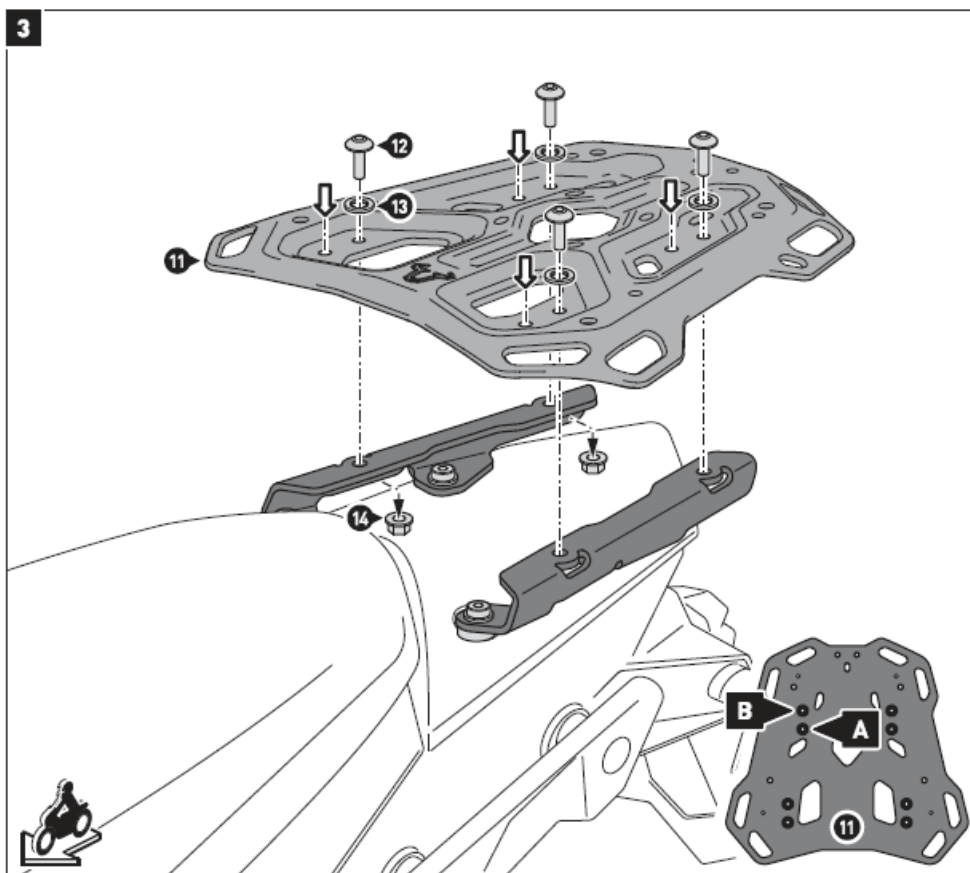

2 5 10	 18 N·m
7 8	 18 N·m
12	 9,6 N·m

PRODUCT SPECIFIC INFORMATION

Maximum Load	Maximum Speed
 12 KG (26,5 lbs)	 130 km/h (80 mph)

WARNING: The indicated maximum load is inclusive the weight of topcase/luggage and adapter kit! The maximum vehicle load specified by the manufacturer must not be exceeded!

NOTICE: Observe the country-specific regulations concerning vehicle registration/operation as well as TOV regulations if applicable. If required, register installed parts in the vehicle documents through an appropriate inspection authority.

Documents / Resources

<div><div>ANBAUANLEITUNG</div><div><div>GPT.04.790.65000-B</div><div><div>GPT.04.790.65000-B</div><div>GPT.04.790.65000-B</div><div>GPT.04.790.65000-B</div><div>GPT.04.790.65000-B</div></div></div><div></div></div>	<div><div>SW-MOTECH GPT.04.790.65000-B Top Case System [pdf] Instruction Manual</div><div>GPT.04.790.65000-B Top Case System, GPT.04.790.65000-B, Top Case System, Case System, System</div></div>
---	--

References

-  [Modesto Technologies](#)
- [User Manual](#)

[Manuals+](#), [Privacy Policy](#)

This website is an independent publication and is neither affiliated with nor endorsed by any of the trademark owners. The "Bluetooth®" word mark and logos are registered trademarks owned by Bluetooth SIG, Inc. The "Wi-Fi®" word mark and logos are registered trademarks owned by the Wi-Fi Alliance. Any use of these marks on this website does not imply any affiliation with or endorsement.