



SVEN GC-3050 Wireless Gamepad User Manual

[Home](#) » [SVEN](#) » SVEN GC-3050 Wireless Gamepad User Manual 

Contents

- [1 SVEN GC-3050 Wireless Gamepad](#)
- [2 Operation Manual](#)
- [3 SPECIAL FEATURES](#)
- [4 CONNECTION AND INSTALLATION](#)
- [5 TROUBLESHOOTING](#)
- [6 Documents / Resources](#)
- [7 Related Posts](#)

SVEN

SVEN GC-3050 Wireless Gamepad



Operation Manual

DESCRIPTION

GC-3050 wireless gamepad can be used in different games such as simulators, arcades, shooter games etc. Vibration feedback imparts a feeling of realistic experience during games. Rubber coating and ergonomic construction of GC-3050 enhance accuracy of its operation during games.

PACKAGE CONTENTS

- Gamepad — 1 pc
- 2.4GHz USB Nano-Receiver — 1 pc
- Power cable USB to micro USB — 1 pc
- Operation Manual — 1 pc
- Warranty card — 1 pc

SAFETY PRECAUTIONS

- Do not disassemble or repair the device on your own. Maintenance and repairs should be carried out by qualified service centre staff only.
- Protect the device from direct impact of high humidity, dust, strong magnetic fields, vibrations, high temperatures, toxic liquids and gases.
- Instructions for device maintenance: for cleaning the case of the device please use clean soft cloth.
- Do not use such solvents as gasoline or spirit for cleaning, since these solvents can damage the surface of the

device.

- Do not drop the device to avoid damaging it.

SPECIAL FEATURES

- The ergonomic design of the gamepad
- X-Input and Direct-Input modes support
- Supports Windows 7/8/10, PS3, Android*
- USB Interface
- Turbo function for continuous firing
- Built-in battery
- 4 axes, D-Pad, 2 mini joysticks and 13 buttons
- Soft-touch coverage for confident control while playing
- Digital and analog modes available

SYSTEM REQUIREMENTS

- USB port available
- Windows 7/8/10, PS3, Android* Operational System

* There may be an incompatibility with individual versions of Android and models of Android devices.

DESCRIPTION OF CONSTRUCTION

1. D-Pad
2. Button SELECT
3. Button TURBO
4. Button CLEAR
5. Button START
6. Buttons 1-4
7. Left joystick
8. Button HOME
9. Operation mode indicators
10. Right joystick
11. Button R1
12. Button L1
13. Button R2
14. Connector for charging
15. Button L2
16. Button RESET
17. USB nano-receiver



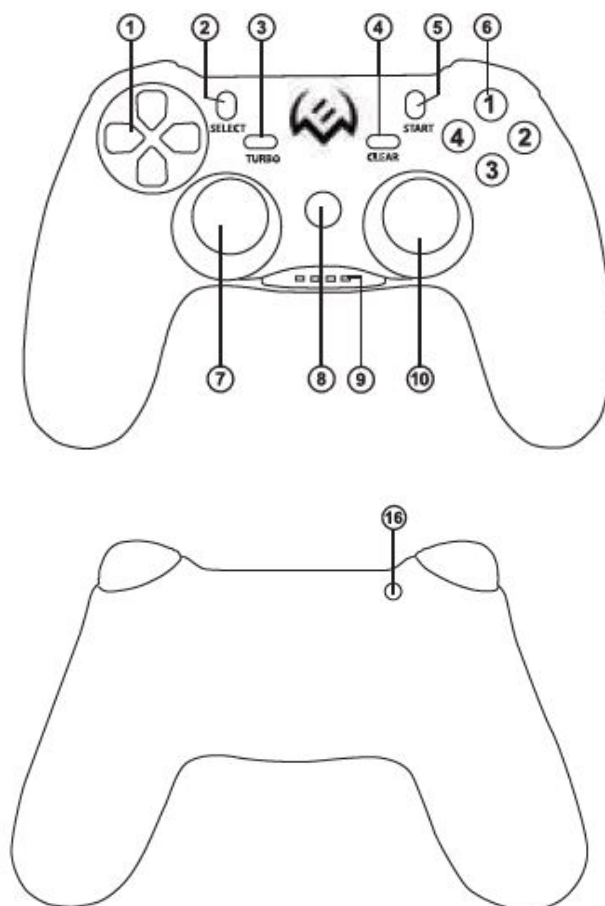

CONNECTION AND INSTALLATION

- Connect the USB receive to an available USB port on the computer.
- Download the software from the official site from the product page and run the program «SVEN Gamepad.exe».
- In order to test and configure the gamepad, choose «Control Panel» «Devices and Printers», in the Windows control panel (in the «XInput» mode, the gamepad is displayed as «Xbox 360 Controller for Windows», in the «DirectInput» – «PC / PS3 / PC360 / ANDROID»), then right-click on the device icon and select.
- Gaming device parameters (administrator rights may be required) (Fig.5,6).

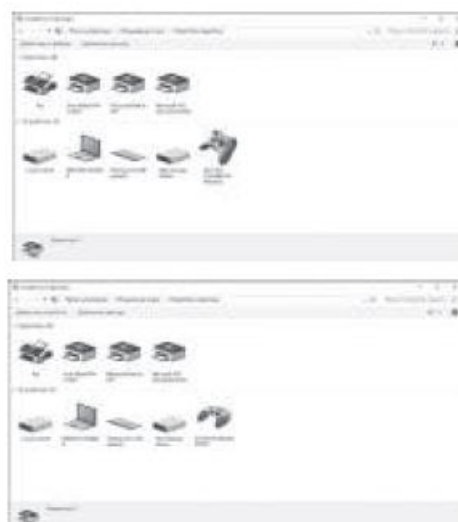

- The «Game devices» window will appear. In XInput mode, the gamepad is displayed as «Controller (XBOX 360 For Windows)» (Fig. 7).

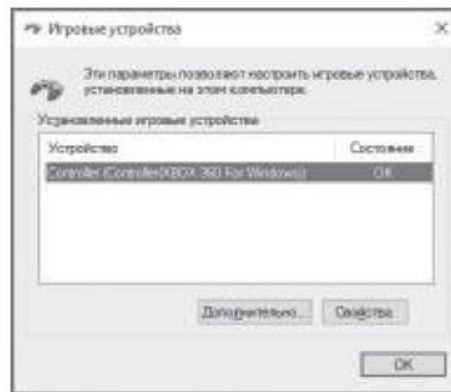

- In the «DirectInput» mode – «USB Vibration Joystick (BM)» (Fig.8).

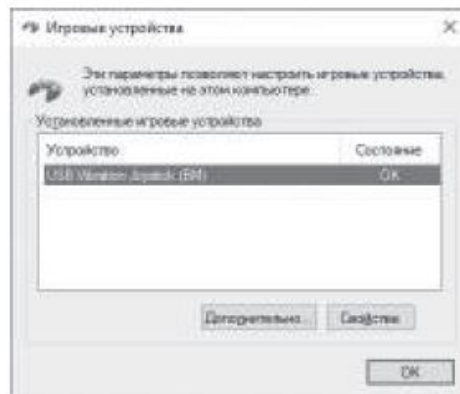

- To switch between the «DirectInput» and «XInput» modes, you must press the HOME button for 6 seconds.
- To check and configure in «XInput» mode, select «Properties» in the «Game devices» window, the «Properties: Controller (XBOX 36 ...» window will pop-up (Fig.9).

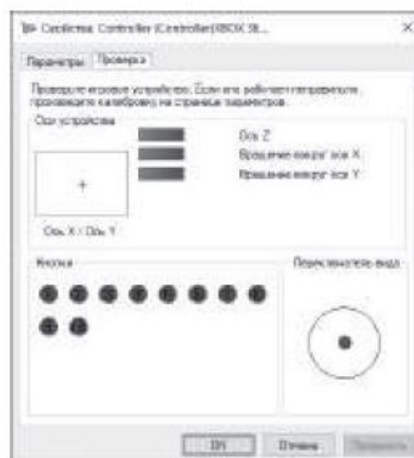

- In the «Verification» tab, you can check the execution of commands when you press the buttons and rotate the joystick. To calibrate the joystick, select the «Settings» tab, click «Calibrate» and follow the instructions.
- To check and configure in DirectInput mode, select Properties in the Game Devices window, and the Properties: USB Vibration Joystick (BM) window pops up. In the «Test» tab, you can check the execution of commands when you press the buttons and rotate the joysticks, and also check whether the joystick is connected to the PC in the «Connected State» line (Fig.10). In the «Calibration» tab, you can center the position of both joysticks (Fig. 10).

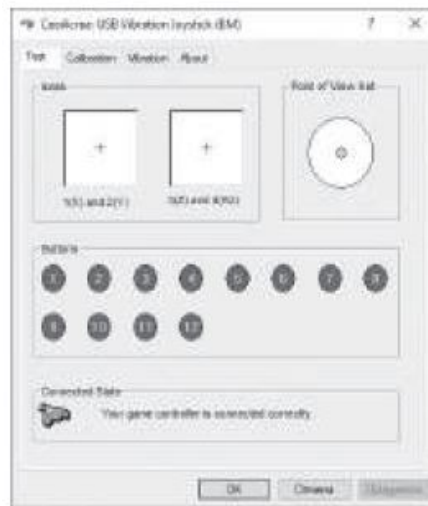

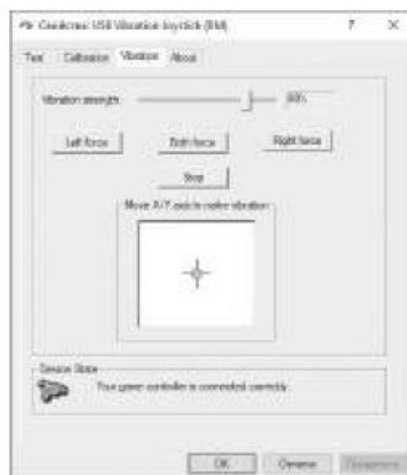
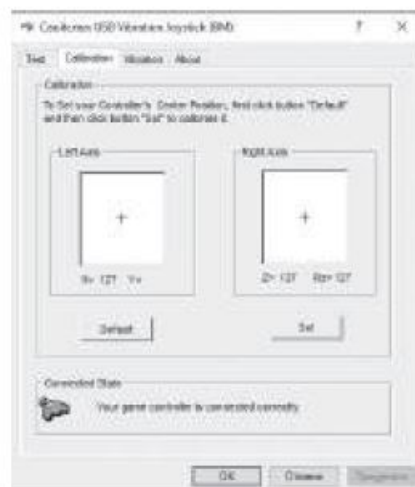

- To do this, you need to set them to the middle position, then click «Default» and «Set». After calibration, you must click «Accept» or «OK» on the bottom line of this window to save the changes.



TROUBLESHOOTING

Problem	Solution
After installation of the software, the game controller does not work normally.	<p>A. Check whether the link cable of the controller is strongly connected to the PC.</p> <p>B. Open the Properties window: Controller (Controller (XBOX 360 ...)) / Properties: USB Vibration Joystick (BM), and check that the gamepad is connected correctly.</p> <p>C. Press the RESET button to reset the connection.</p> <p>D. Restart your PC, if the controller still doesn't work normally.</p>
The analog axis worked automatically without the intervention of the player.	The manipulator calibration is not adjusted or confirmed after adjustment.
After starting the game, the vibro-feedback function is turned on without the player's intervention.	Enter the «Force Feedback» settings in the game, and calibrate the vibro-feedback function.
In the process of playing the vibration function is not enough.	Enter the «Force Feedback» settings in the game, and set the vibration strength.
The game controller that has been lying without work for a couple of days does not turn on.	Connect it to the power supply for 1-3 minutes. If after that it does not turn on, you need to charge it for a longer time.

Documents / Resources

	<p>SVEN GC-3050 Wireless Gamepad [pdf] User Manual GC-3050, Wireless Gamepad, GC-3050 Wireless Gamepad</p>
	<p>Sven GC-3050 Wireless Gamepad [pdf] User Manual GC-3050 Wireless Gamepad, GC-3050, Wireless Gamepad, Gamepad</p>