

Contents [[hide](#)]

- [1 SURESHADE MTX2 Center Line Width](#)
- [2 Product Information](#)
- [3 Product Usage Instructions](#)
- [4 SUMMARY](#)
- [5 MTX2 T-Top Shade Specifications](#)
- [6 FAQ](#)
- [7 Documents / Resources](#)
 - [7.1 References](#)



SURESHADE MTX2 Center Line Width



Product Information

Specifications

- **Shade Type:** MTX2 T-Top Shade
- **Extension Length:** Customizable based on measurements
- **Mounting Component:** Figure 8 Clamp
- **Mounting Placement:** Tube Mount Stationary

- **Canvas Color:** Customizable

Product Usage Instructions

- **Step 1: Determine Mounting Area**

Based on the MTX2 shade space requirements, mount the shade to two points on the tube 30-36 inches apart using figure 8 clamps. Ensure there is enough clearance for walking under the shade and reaching the pull bar.

- **Step 2: Determine Shade Width**

Measure the outside to outside tube dimension and tube diameter at each clamp position, ensuring an obstruction-free area of 30-36 inches.

- **Step 3: Determine Camber Height**

Determine if cambering is needed for the shade's cross-components to conform to the hardtop's curvature. Follow the specific instructions based on whether it is a bottom or top-mounted shade.

- **Step 4: Determine If Spacers Are Needed**

Check the available mount diameter sizes and consider if spacers are required based on your measurements.

SUMMARY

- **STEP 1:** Determine mounting area based on MTX2 shade space requirements
- **STEP 2:** Determine shade width and tube diameter
- **STEP 3:** Determine if a camber (curvature) to the shade's cross-components (crossbars and roller) is needed
- **STEP 4:** Determine if mounting spacers are required

STEP 1: DETERMINE MOUNTING AREA based on MTX2 shade space requirements

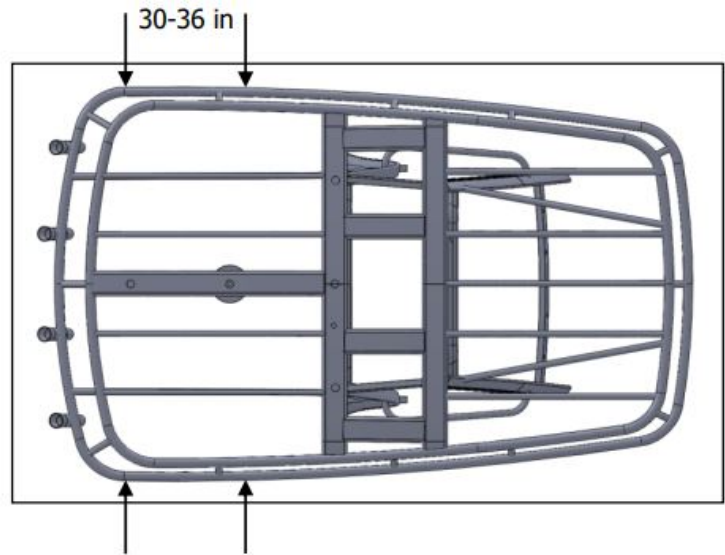
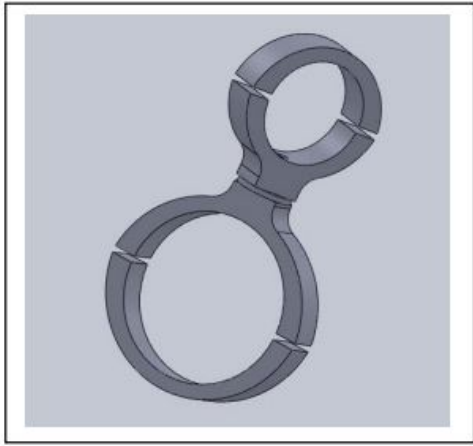

- On a T-Top frame, the MTX2 shade is mounted to two points on the tube 30-36 in (762-914 mm) apart with figure 8 clamps shown above. Determine where on the tube the clamps will be placed.
- Consider how high the shade will be. There should be enough room to walk under the shade without issue but not too much to where the pull bar is out of reach. There should be no more than 78 in (1981 mm) of space between the deck and the pull bar.

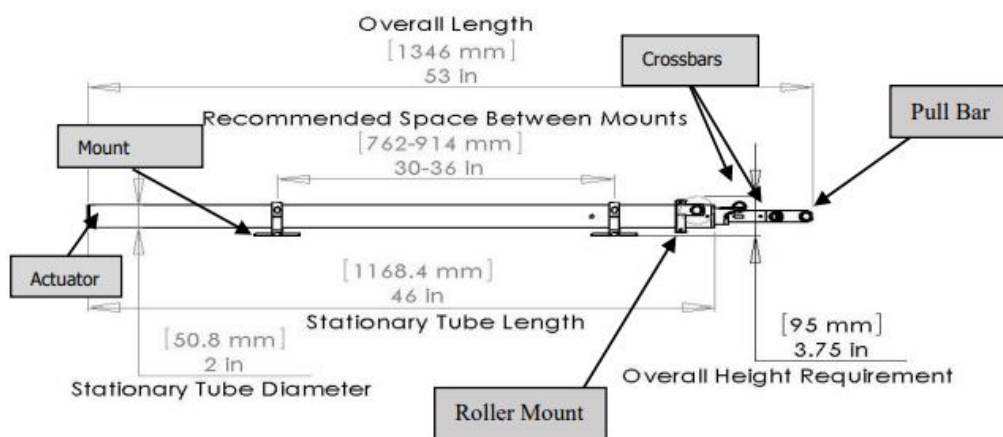

STEP 2: DETERMINE SHADE WIDTH. MTX2 framework (stationary actuator) and mounting clamps require an obstruction-free area shown below.

- MTX2 shade width is specified by the “outside to outside” tube dimension – outside of PORT actuator to outside of STBD actuator. The maximum possible width for an MTX2 shade is 78” (1981 mm). Framework must be parallel for proper operation.
- Once mounting area is determined for shade framework, measure and provide the OUTSIDE to OUTSIDE width dimension of both sections where the clamps will be placed. Also measure and provide the tube diameter of both sections.

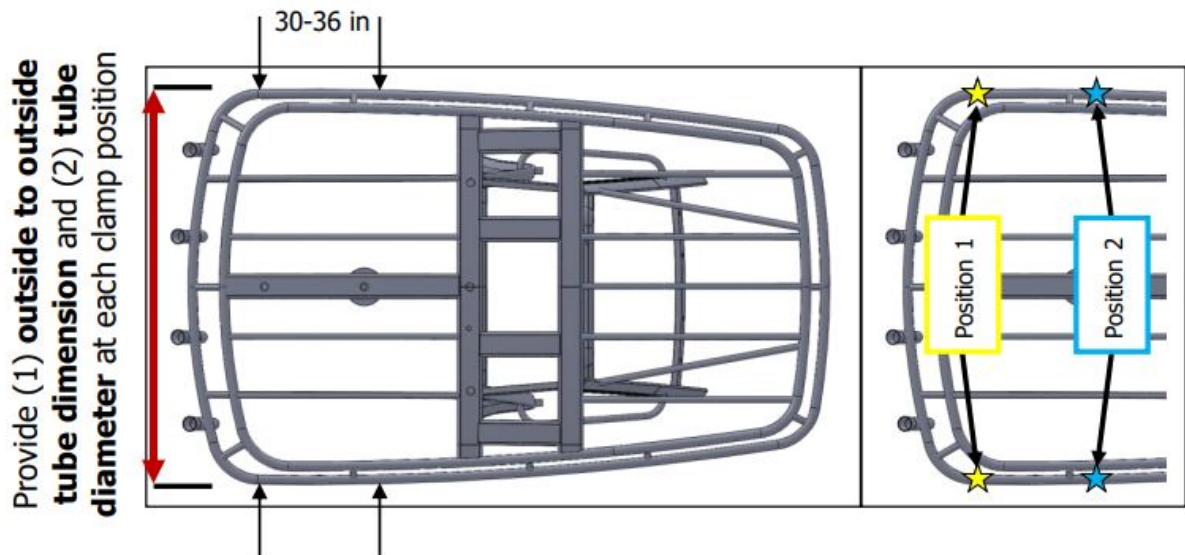

STEP 3: DETERMINE CAMBER HEIGHT. The MTX2 shade's cross-components—the outer crossbar, mid crossbar, and canvas roller—can be cambered (curved) to conform to the curvature of the hardtop. Determine if the hardtop has curvature and if camber is desired.

- For bottom mounted shades, once width is determined,
 1. Position a straight edge across the bottom of the hardtop.
 2. Measure straight up from the center of the determined width to underside of the hardtop.
 3. Provide the camber height dimension in inches or mm.

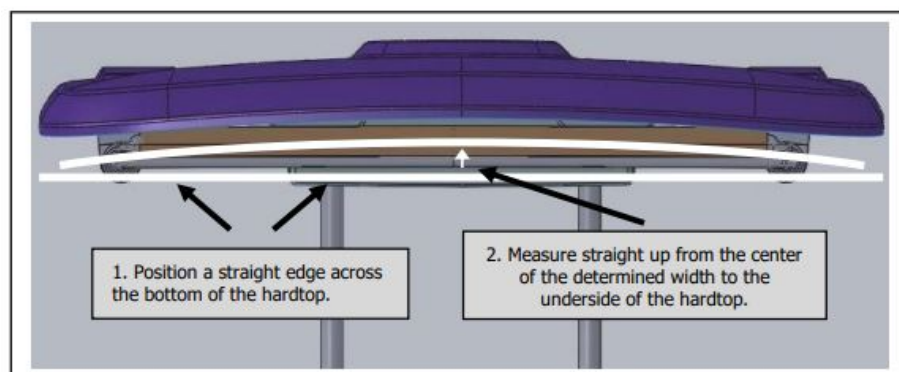

- For top mounted shades, once width is determined,
 1. Position a straight edge across the topside of the hardtop.
 2. Measure from the straight edge to where the actuator will mount.
 3. Provide the camber height dimension in inches or mm.

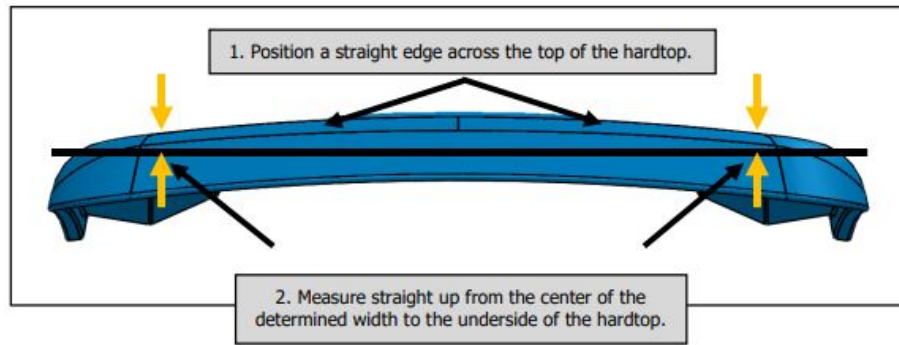

MOUNT DIAMETER SIZES AVAILABLE

- 1.375"
- 1.50"
- 2.00"
- 2.25"
- 2.50"
- 3.00"

Please note the Figure 8 Mounts are made of Anodized Aluminum while the actuators are made of Stainless Steel. Your kit will include rubber to be installed between the 2 metal parts. If you would prefer the mounts and tubes match, there is the option of wet painting the mounts and actuators tubes with additional cost of \$500.

MTX2 T-Top Shade Specifications

Boat YEAR/MAKE/MODEL	
Shade Type	MTX2 – Pull out
Extension Length	6 FT
Mounting Component	Figure 8 Clamp
Mounting Placement	Tube Mount
Roller Placement	Stationary
Canvas Color	

Position 1	Outside to Outside Tube Width (inches or mm)	
	Tube Diameter (inches or mm)	
Position 2	Outside to Outside Tube Width (inches or mm)	
	Tube Diameter (inches or mm)	
Camber Height (inches or mm)		
Measured Spacer Height (½ inch [12.7 mm] increment)		
Customer Details COMMERCIAL SHIP TO ADDRESS AND PHONE NUMBER		

If you have any questions please call [877-333-8323](tel:877-333-8323) or [215-673-2307](tel:215-673-2307)

DISCLAIMER: All shades are made to custom specifications. Ensure all measurements are accurate before sending them to your customer service representative. Any errors made by the customer are the customer's responsibility.

FAQ

- **Can I customize the canvas color?**

Yes, the canvas color is customizable based on your preference.

- **What materials are the Figure 8 Mounts and actuators made of?**

The Figure 8 Mounts are made of Anodized Aluminum, and the actuators are made of Stainless Steel. Rubber is included in the kit for installation between the two metals.

- **How can I submit my measurements?**

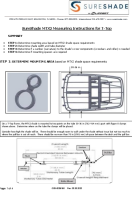

You can submit your measurements online at <https://www.sureshade.com/measure/> or email the completed sheet to sales@sureshade.com or your sales representative directly.

Documents / Resources

	SURESHADE MTX2 Center Line Width [pdf] Installation Guide MTX2 Center Line Width, MTX2, Center Line Width, Line Width
---	--

References

- [User Manual](#)

 SURESHADE  Center Line Width, Line Width, MTX2, MTX2 Center Line Width, SURESHADE

Leave a comment

Your email address will not be published. Required fields are marked *

Comment *

Name

Email

Website

☐ Save my name, email, and website in this browser for the next time I comment.

Post Comment

Search:

e.g. whirlpool wrf535swhz

Search

[Manuals+](#) | [Upload](#) | [Deep Search](#) | [Privacy Policy](#) | [@manuals.plus](#) | [YouTube](#)

This website is an independent publication and is neither affiliated with nor endorsed by any of the trademark owners. The "Bluetooth®" word mark and logos are registered trademarks owned by Bluetooth SIG, Inc. The "Wi-Fi®" word mark and logos are registered trademarks owned by the Wi-Fi Alliance. Any use of these marks on this website does not imply any affiliation with or endorsement.