



suprema FaceLite Compact Face Recognition Terminal Owner's Manual

[Home](#) » [suprema](#) » **suprema FaceLite Compact Face Recognition Terminal Owner's Manual** 

Contents

- [1 suprema FaceLite Compact Face Recognition Terminal](#)
- [2 Features](#)
 - [2.1 Ultra Performance](#)
 - [2.2 Ergonomics & User Convenience](#)
- [3 SPECIFICATIONS](#)
- [4 System Configurations](#)
- [5 Documents / Resources](#)
 - [5.1 References](#)
- [6 Related Posts](#)



suprema FaceLite Compact Face Recognition Terminal



Suprema FaceLite is the most compact face recognition terminal providing loads of the world's best features. Powered by Suprema's latest innovation in facial biometrics, FaceLite offers an unrivaled matching speed, accuracy, and level of security. With Suprema's patented optic engineering, Face Lite achieves up to 25,000 lx of operating illuminance which in turn, brings all-round confidence regardless of lighting conditions. Packed in a compact and ergonomically-designed structure, FaceLite provides exceptional performance and usability for diverse access control and time attendance sites, large or small.

Features



Ultra Performance

- **Matching Speed:** 1:4,000 match/sec
 - **Group Matching:** 1:5,000 match/sec
- **User Capacity:** Max 30,000 users (1:1), 4,000 users (1:N)



25,000 lx

Highest Operating Illuminance

- Operating illuminance from 0lx to 25,000lx
- Covers complete darkness to all indoor lighting conditions



Enhanced Security

- IR-based Live Face Detection (LFD); Prevent spoofing by printed images and LCDs
- Face template encryption
- Secured communication with TLS 12



Multi RFID Card Reading

- LF(125kHz), HF(13.56MHz) dual-band
- Reads all card types including Mobile Card (NFC and BLE)



Ergonomics & User Convenience

- **Extended height range:** 145cm – 210cm
- Improved face enrollment procedure

SPECIFICATIONS

Model Name	FL-DB
Biometric	Face
RF Options	125kHz EM & 13.56MHz MIFARE, MIFARE Plus, DESFire EV1/EV2*, FeliCa
Mobile Card	NFC, BLE
Max. User	30,000(1:1), 4,000(1:N)
Max. Log	5,000,000
Ethernet	10/100Mbps, auto MDI/MDI-X
RS-485	1ch Host or Slave (Selectable)
Wiegand	1ch Input or Output (Selectable)
TTL	2ch Inputs
Relay	1 Relay
Tamper	Supported
CPU	1.2GHz Quad Core
Memory	8GB Flash + 1GB RAM
Operating Temperature	-20°C ~ 50°C
Dimensions (WxHxD, mm)	80 x 170 x 76
Power	DC 24V
Certificates	CE, FCC, KC, RoHS, REACH, WEEE, BT SIG

DESFire EV2 cards are supported by having backward compatibility of DESFire EV1 cards. CSN and smart card functions are compatible with FaceLite.

System Configurations

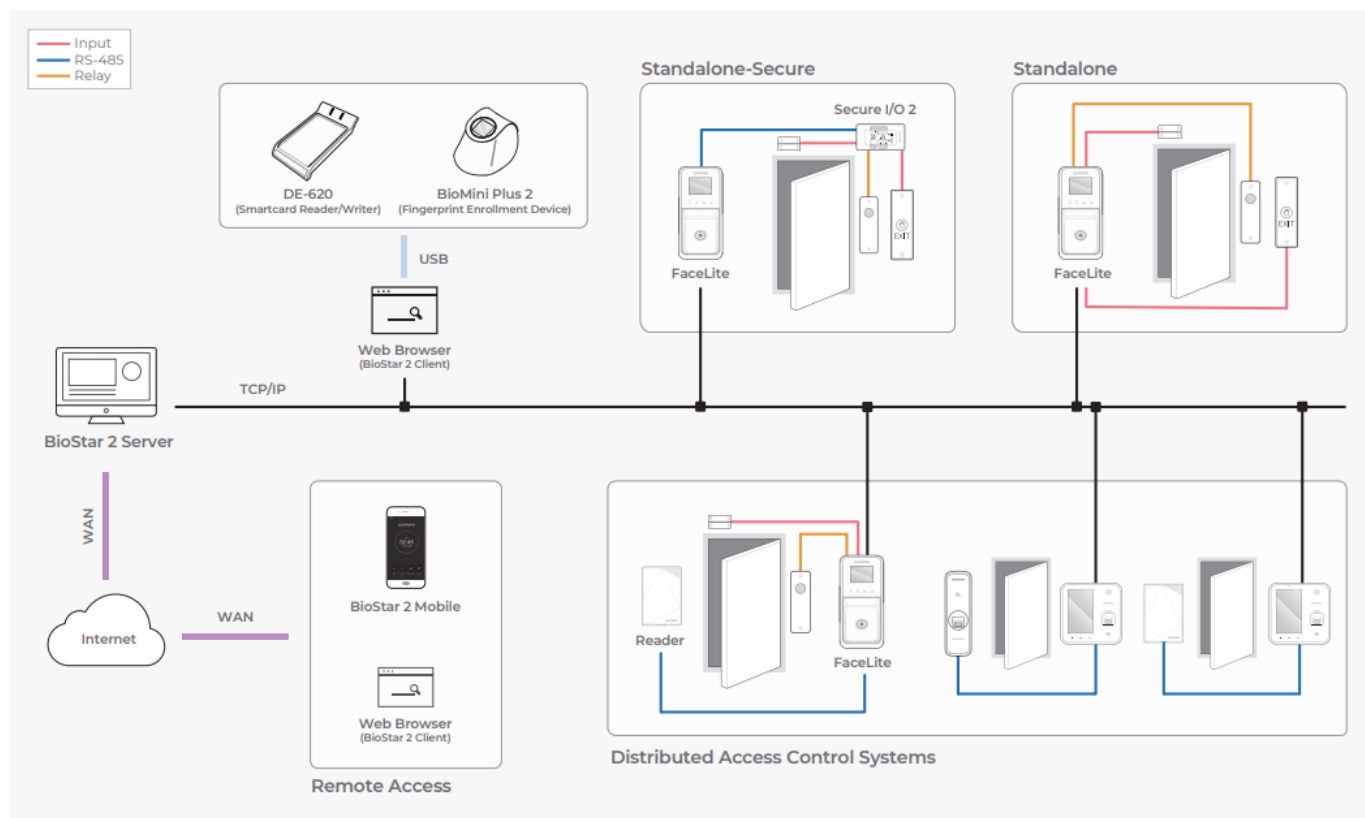

©2021 Suprema Inc. Suprema and identifying product names and numbers herein are registered trademarks or Suprema Inc. All non-suprema brands and product names are trademarks or registered trademarks of their respective companies. Product appearance, build status and/or specifications are subject to change without notice. SUPREMA-AHL-FL-EN-REV08

- DWG
- **ADDRESS:** 516-933-4900
- dwgdistribution.com

Documents / Resources

	<p>suprema FaceLite Compact Face Recognition Terminal [pdf] Owner's Manual FaceLite Compact Face Recognition Terminal, FaceLite, Compact Face Recognition Terminal, F ace Recognition Terminal, Face Recognition Compact Terminal, Compact Terminal</p>
---	---

References

- [DWG - wholesale distributor of security and video surveillance electronic equipment and supplies. - DWG](#)