

SUPERNOVA TL3Z High Performance Tail Light



SUPERNOVA TL3Z High Performance Tail Light User Manual

[Home](#) » [SUPERNOVA](#) » SUPERNOVA TL3Z High Performance Tail Light User Manual 

Contents

- [1 SUPERNOVA TL3Z High-Performance Tail Light](#)
- [2 PRODUCT CONTENT](#)
- [3 TECHNICAL DATA](#)
- [4 INSTALLATION](#)
- [5 GENERAL INFORMATION](#)
- [6 WARRANTY & SERVICE](#)
- [7 Documents / Resources](#)
 - [7.1 References](#)

SUPERNOVA

SUPERNOVA TL3Z High-Performance Tail Light

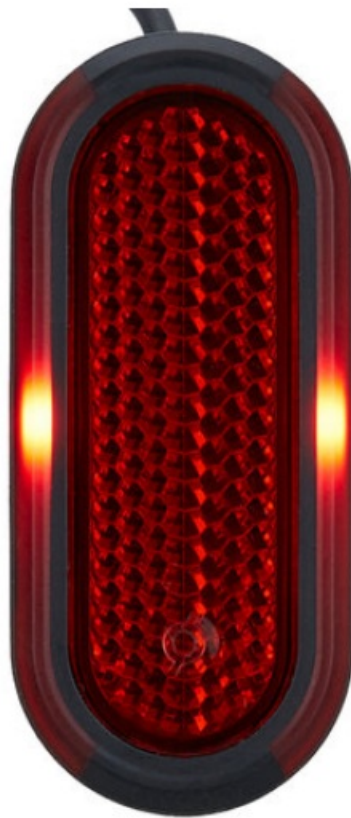

I am very happy that you have chosen this Supernova high-performance product! My development team has spared no effort and our product testers have ridden thousands of kilometres in adverse conditions to offer you a product you will enjoy for a long time. I wish you a great ride at all times!

PRODUCT CONTENT

TL 3 Z
Art. No: W-TL3Z

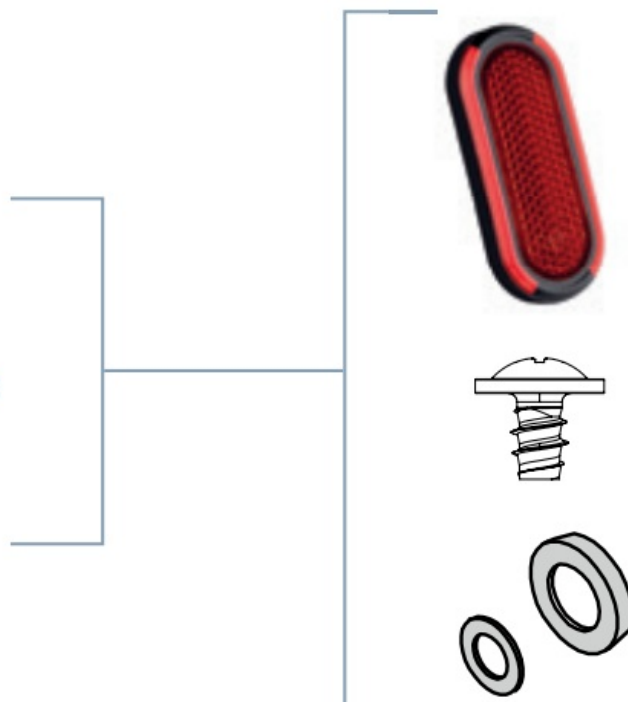

- Tail light with cable for 26-29 inch fender
- Installation screw 3,5 x 6 mm
- 1 x Lock washers, 1 x spacer

TECHNICAL DATA

- Housing material Plastic PC, ABS housing
- Weight 20 g
- Candela 4.7 cd
- L x W x H 71 x 9.5 x 31 mm
- Signalling LEDS 34 red high-power LEDs
- Cable length 1.400 mm
- Road approval K 2291
- Connection 2-wired
- Warranty 5 years

INSTALLATION

Power supply and failure

It is noted that use is only allowed on bicycles with electric pedal assistance (E-Bikes) if uninterrupted power supply to the lighting system for at least two hours is ensured after disconnection due to discharge of the assist drive, or if the drive motor can be temporarily used as a generator to continue supplying power to the lighting system. In case of a failure of any LED, the entire product must be replaced.

Mounting height and alignment

The lighting equipment must not be obstructed. The tail light must be mounted at a fixed height above the road surface of a minimum of 250 mm and a maximum of 1,200 mm at a $30^\circ \pm 2^\circ$ angle. WARNING! Mounting at a different angle does not meet the legal requirements for the rear light and integrated Z-reflector, and the function cannot be guaranteed.

Turning the tail light on and off

The tail light can be turned on and off through the vehicle display/handlebar control unit. Drawing of the fender with hole spacing ± 0.1 mm. The above-ground heights of the holes vary from fender to fender to the $30^\circ \pm 2^\circ$ installation angle.

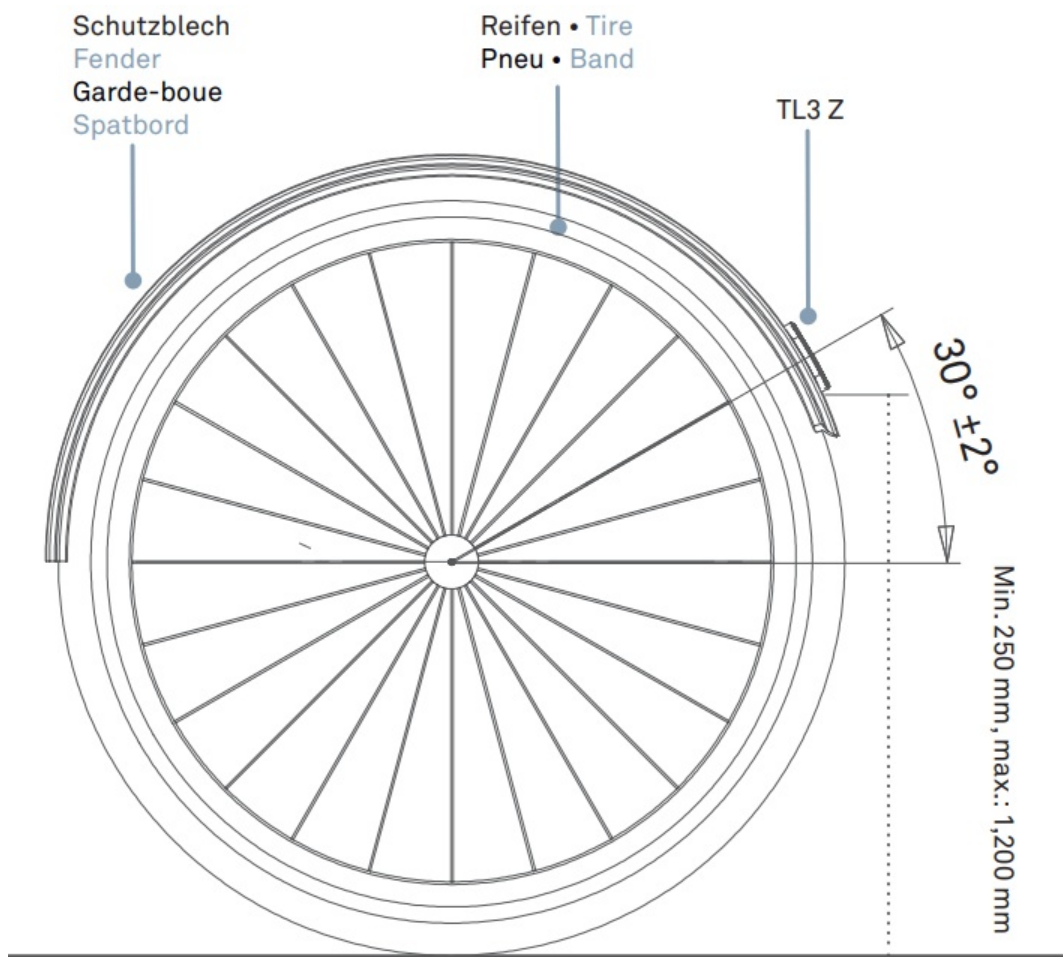

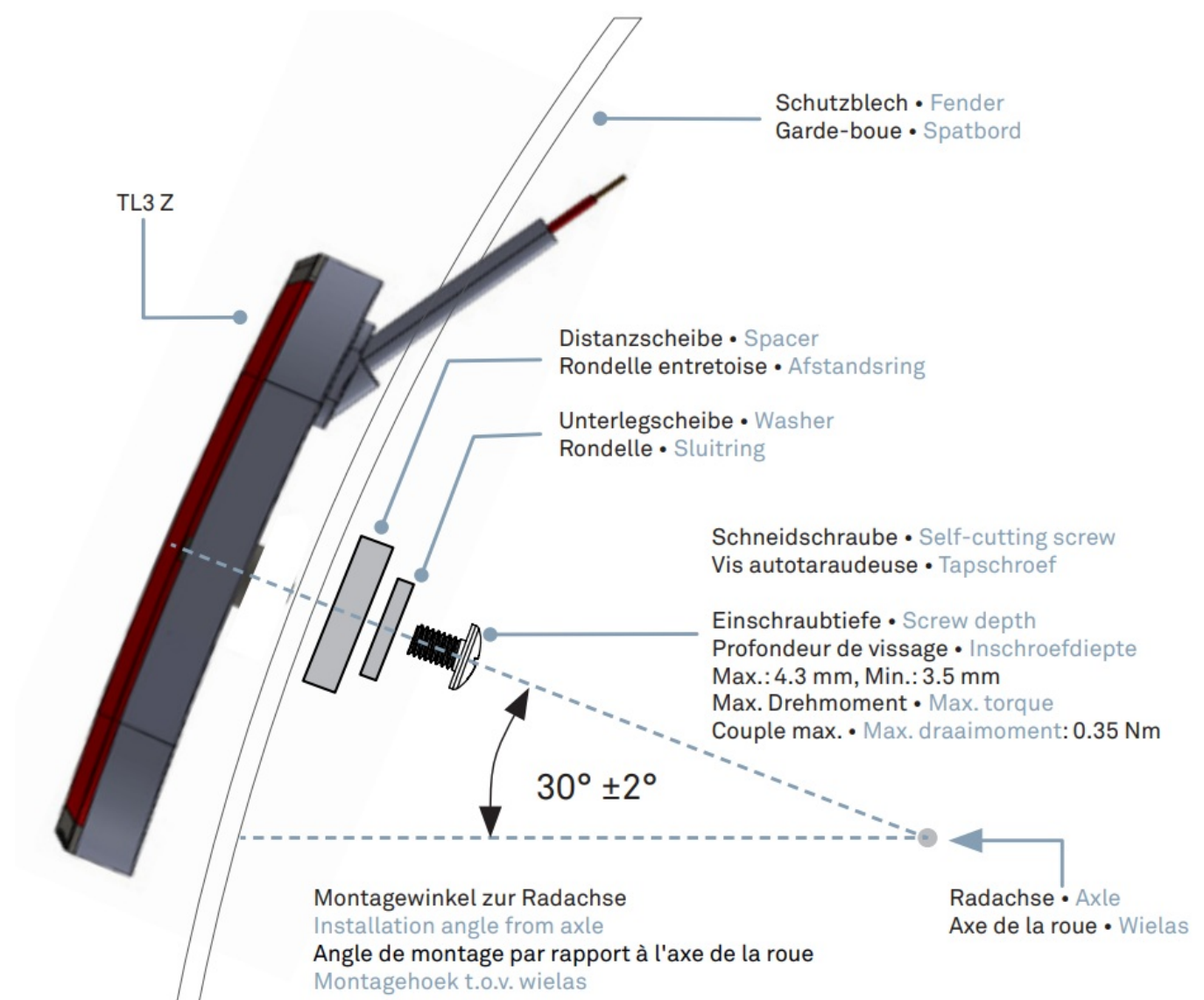

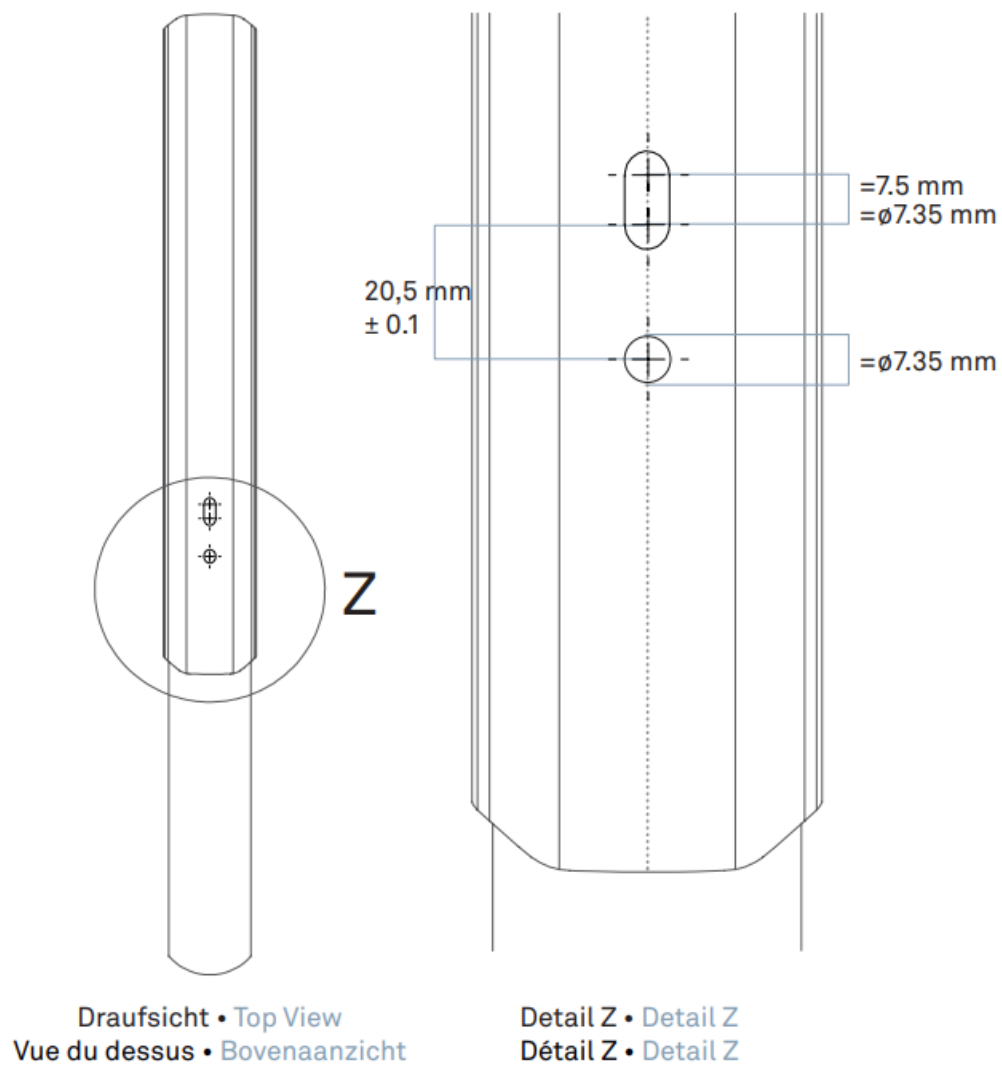

- Suitable for 26-29" wheels

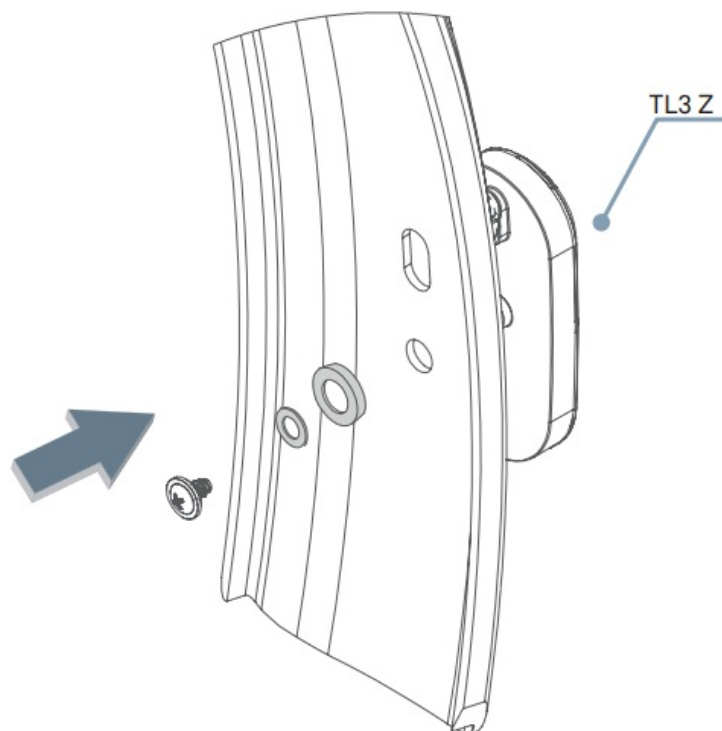

The cable outlet must point upwards during installation!

Art. No



Suitable accessories

20 20-inch adapter for gap-free mounting on 20-inch wheels.

TL3 Z
Art. No: W-TL3Z

⌚ 20 - 60 m

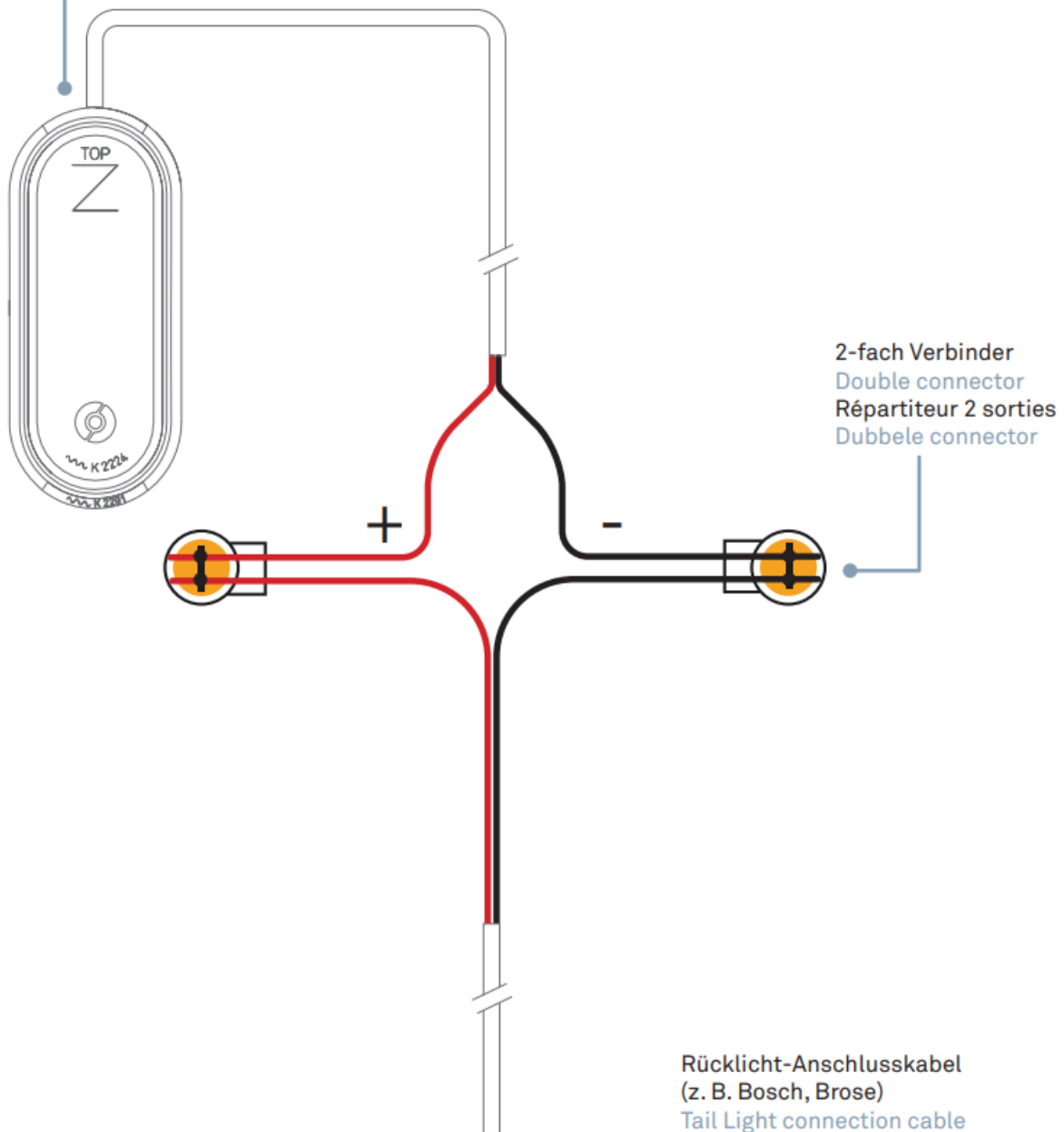

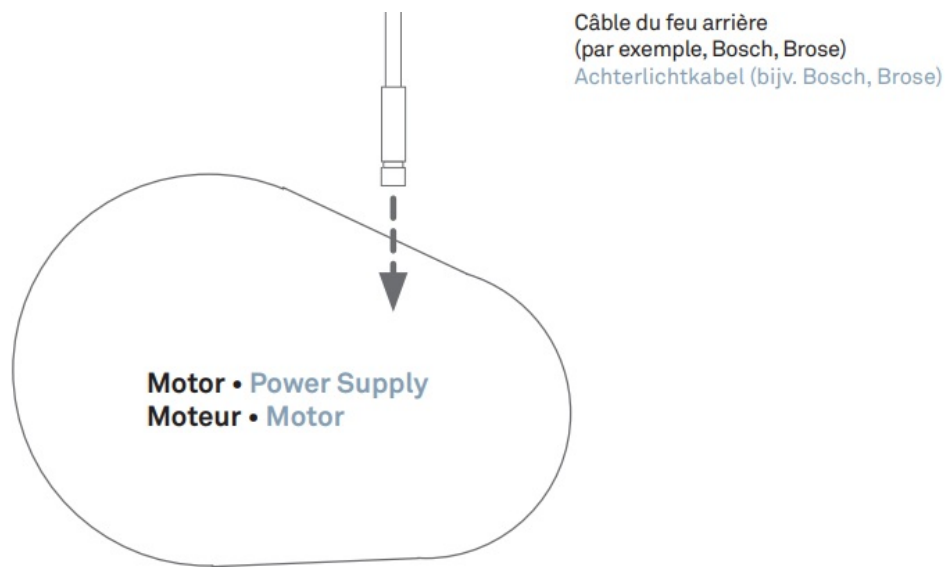

Note for all connectors of this type.



ATTENTION!

Insert the cable ends into the connector as far as possible and do not remove insulation.

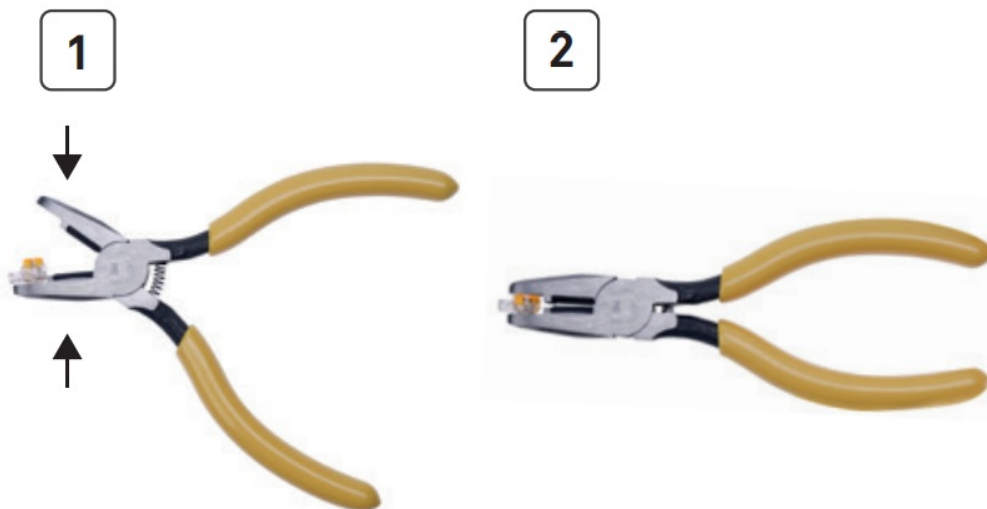

IMPORTANT!

Do not press the tap deeper than the edge of the housing! Requested tool: Scotchlok™ IDC crimping pliers (E-9Y)

GENERAL INFORMATION

WARRANTY & SERVICE

5 years warranty

The warranty is void if the housing is opened and in case of unqualified repairs. More and more drive manufacturers work with us to become Supernova-compatible. This means that we will regularly update this manual. Please compare the version number on the cover with the latest version on our website:



CARE INSTRUCTIONS

- Never use a high-pressure hose
 - Clean with water and a soft, clean cloth
 - Do not use aggressive cleaning agents (also no alcohol!)
 - Do not dispose of tail light in household waste!
-

Documents / Resources

	SUPERNOVA TL3Z High Performance Tail Light [pdf] User Manual TL3Z High Performance Tail Light, TL3Z, High Performance Tail Light, Performance Tail Light, Tail Light, Light
---	---

References

-  [Modern Light Fixtures and Home Decor | Lights.com](#)
-  [Supernova Shop](#)
- [User Manual](#)

[Manuals+.](#) [Privacy Policy](#)

This website is an independent publication and is neither affiliated with nor endorsed by any of the trademark owners. The "Bluetooth®" word mark and logos are registered trademarks owned by Bluetooth SIG, Inc. The "Wi-Fi®" word mark and logos are registered trademarks owned by the Wi-Fi Alliance. Any use of these marks on this website does not imply any affiliation with or endorsement.