



SUPERNOVA P-M99-E32-BLK M99 PRO Front Light Instruction Manual

[Home](#) » [SUPERNOVA](#) » SUPERNOVA P-M99-E32-BLK M99 PRO Front Light Instruction Manual 

V 02.20

Contents

- 1 M99 PRO
 - 1.1 MANUAL
 - 1.2 CONGRATULATIONS
 - 1.3 APPROVALS
 - 1.4 PRODUCT CONTENT
 - 1.5 TECHNICAL DATA
 - 1.6 COMPATIBILITY
 - 1.7 M99 PRO INSTALLATION
 - 1.8 M99 PRO & M99 TAIL LIGHT INSTALLATION
 - 1.8.1 BROSE 36 V
 - 1.9 UNIVERSAL HBM INSTALLATION
 - 1.9.1 SUPERNOVA UNIVERSAL HBM
 - 1.10 M99 BOSCH HBM ADAPTER INSTALLATION
 - 1.11 YAMAHA DISPLAY C ADAPTER INSTALLATION
 - 1.12 SPACER MOUNT INSTALLATION
 - 1.13 M99 CRC – MOUNT & CRC STEM INSTALLATION
 - 1.14 PROMAX DA-230 STEM INSTALLATION
 - 1.15 M99 PRO ADJUSTMENT
 - 1.16 GENERAL INFORMATION
- 2 Documents / Resources
 - 2.1 References
- 3 Related Posts

M99 PRO

MANUAL



CONGRATULATIONS

I am very happy that you have chosen this Supernova high performance product! My development team has spared no efforts and our product testers have ridden thousands of kilometres in adverse conditions to offer you a product you will enjoy for a long time. I wish you a great ride at all times!

A handwritten signature in black ink, appearing to read "Marcus Wallmeyer".

Marcus Wallmeyer, CEO & Chief Designer



These front lights have been developed for use on fast E-Bikes with speeds up to 45 km/h (S-Pedelecs). Also legal for motorbikes with up to 125 ccm or E-Bikes up to 4 KW. Two lights can be used for many faster vehicles.

APPROVALS

M99 PRO

Front light for fast E-Bikes up to 125 ccm and light motorcycles. ECE 113C compliant low beam, with ECE 87 daytime running light.

E-mark

014162

Daytime running light

004161

M99 Tail Light (12 V)

E-mark

004160

PRODUCT CONTENT

M99 PRO (45 km/h)

Art. No.: P-M99-E32-BLK

Incl.

1 x Front light

1 x Universal M99 PRO connector cable

4 x Tap connector size S (sealed, self-contacting)

1 x Supernova high beam switch, Magura MT compatible

1 x Autonomous 22 mm clamp

Optional accessories, depending on drive system and mounting position.

M99 Tail Light-45 (12 V)

12 V: Art. No: P-M99-TE12-BLK

incl.

2 x Double connector

1 x Triple connector

Universal HBM

Art. No: R-UHM31.8-BLK (ø 31.8 mm)

Art. No: R-UHM35-BLK (ø 35 mm)

M99 Bosch HBM Adapter

Art. No: P-M99-BHBM-BLK

Yamaha Display C Adapter

Art. No: R-YHBM-MBLK

M99 CRC – Mount

Art. No: P-M99-CRC-BLK

(for this mount you need a compatible stem.

For example the CRC STEM)

CRC Stem

60 mm: Art. No: P-CRCSTM-BLK-60

90 mm: Art. No: P-CRCSTM-BLK-90

Promax DA230 Stem

60 mm: Art. No: P-DA230STM-BLK-60

90 mm: Art. No: P-DA230STM-BLK-60

Spacer Mount

Art. No: R-SPMT-BLK

TECHNICAL DATA

M99 PRO



Art. No.: **P-M99-E32-BLK** (24-60 V DC, 75 V max.)

Low beam	1100 lm, 310 lx
Wattage low beam	8 – 16 W
High beam	1600 lm, 380 lx
Wattage high beam	27 W
Daytime Running Light	32 Power LEDs
Sensor-activated daytime running light	Yes
Wattage	4.5 W
Input voltage	24-60 V DC (75 V max.)
Communication	CAN, CANopen
Signal processing	High beam, brake light
Approvals	L-class, e.g. L1e
Illuminant	9 automotive LEDs
L x W x H	67 x 87 x 57.5 mm
Weight	220 g
Color	Polished black







M99_{TL}



Art. No: **P-M99-TE12-BLK** (12 V DC)

Housing material	6061 Aluminum
Weight	25 g
Candela	9 cd – 50 cd
L x W x H	22 x 61.5 x 11.6 mm
Power levels 12V version	0.4 W / 0.9 W (Brake light)
License plate illumination	White SMD LEDs
Signalling LEDs (red)	5 mm high power LEDs
Installation	50 mm distance / M4 thread
Waterproof level	IP67
ECE approval	L-class, e.g. L1e
Input voltage	12 V
Connection	3-wired

COMPATIBILITY

	PRODUCTS	Brose up to MY17 (C16162/C91143/ C79232/C97292)	Brose up to MY18 (C97272)	Continental 36	GO Swiss Drive (36V BikeBus / 36V CAN MY 18)	MP Drive (MP F 6, CAN)	Panasonic (X1 / X0)
		36V	36V	36V	36V	36V	36V
	M99 PRO A rt. No: P-M99- E32-BLK						

*** M99 PRO front lights are not approved for installation on Bosch drives!**

Such an installation voids the Bosch warranty as the installation is not approved by Bosch. However, this has expressly nothing to do with functional problems. Bosch recommends the 12 V or 6 V light port specially designed for the connection of front lights, for which Supernova offers suitable front lights such as the M99 MINI PRO. The M99 PRO front light fits systems from Brose, Continental, Panasonic, in special versions GoSwissdrive and Neodrives.

**M99 PRO
INSTALLATION**

Top view

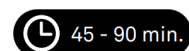

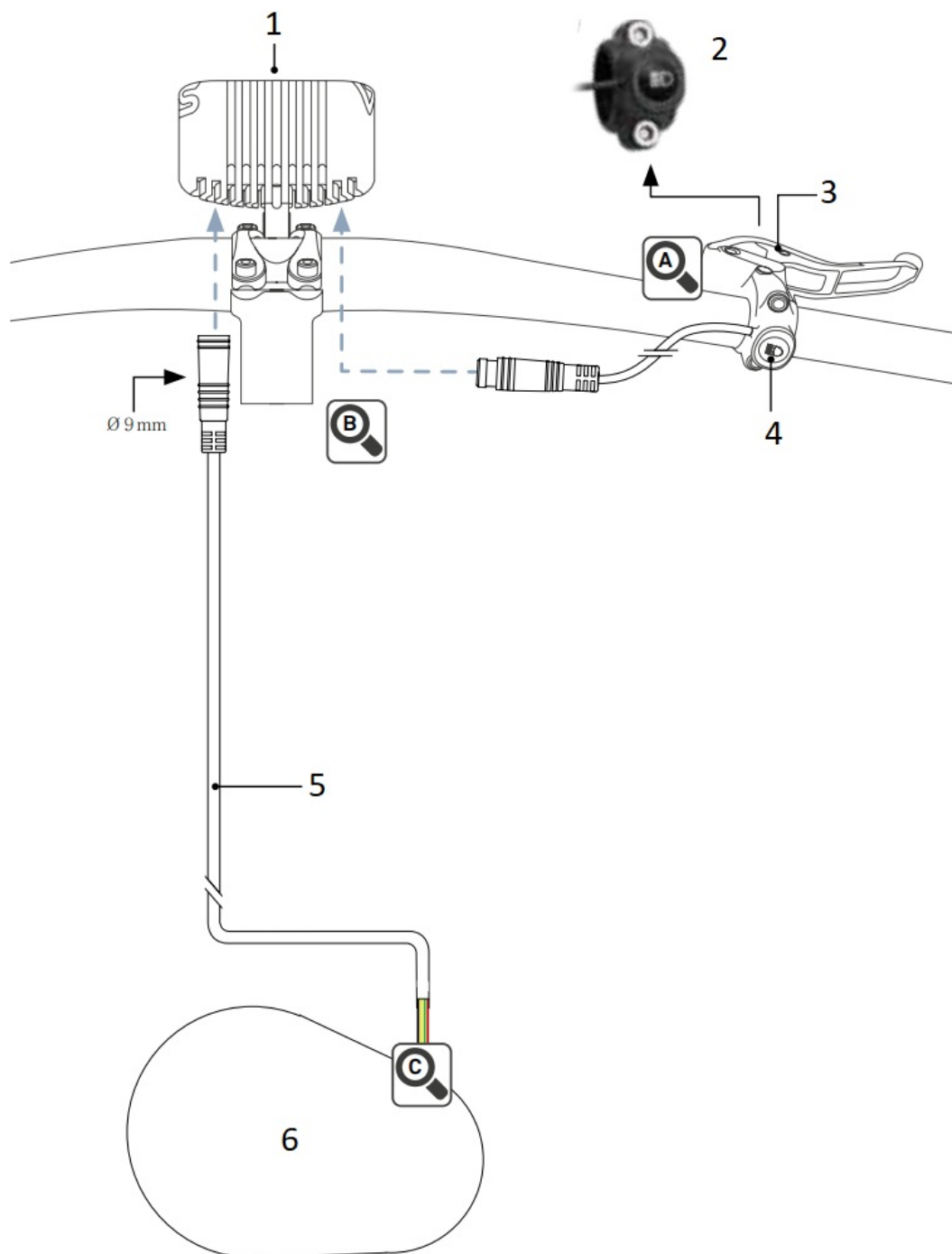

1. M99 PRO
2. High beam switch can also be installed autonomously
3. Magura MT
4. High beam switch
5. Universal M99 PRO connector cable for drives
6. **Power Supply**
24-60 V / 16-27 W



Bottom view

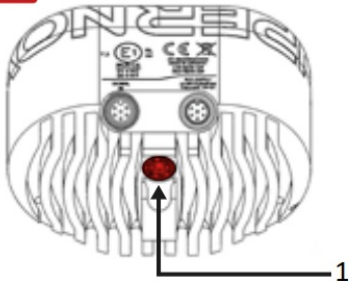

1. Do not open this service screw!

A special protective gas will escape and the warranty will be lost.

Service screw

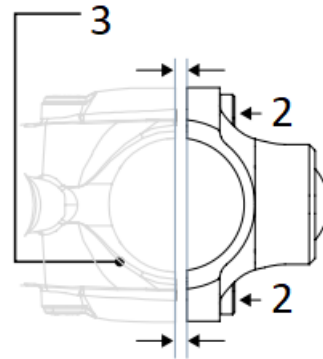
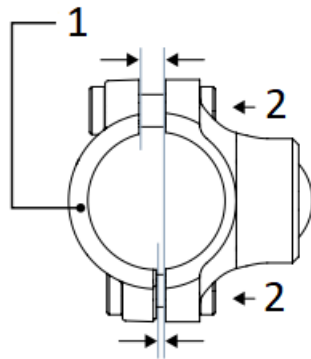

1. Autonomous Magura MT Clamp
2. max. 2 Nm*
3. Magura MT Brake

Please install the autonomous Magura MT clamp parallel to the surfaces. The asymmetrical shape of the clamp creates different gap widths. * To ensure that the maximum torque of 2 Nm (18 in-lbs) is not exceeded, please tighten the screws only as much, so that the brake levers can still be moved with some force.

Bottom view



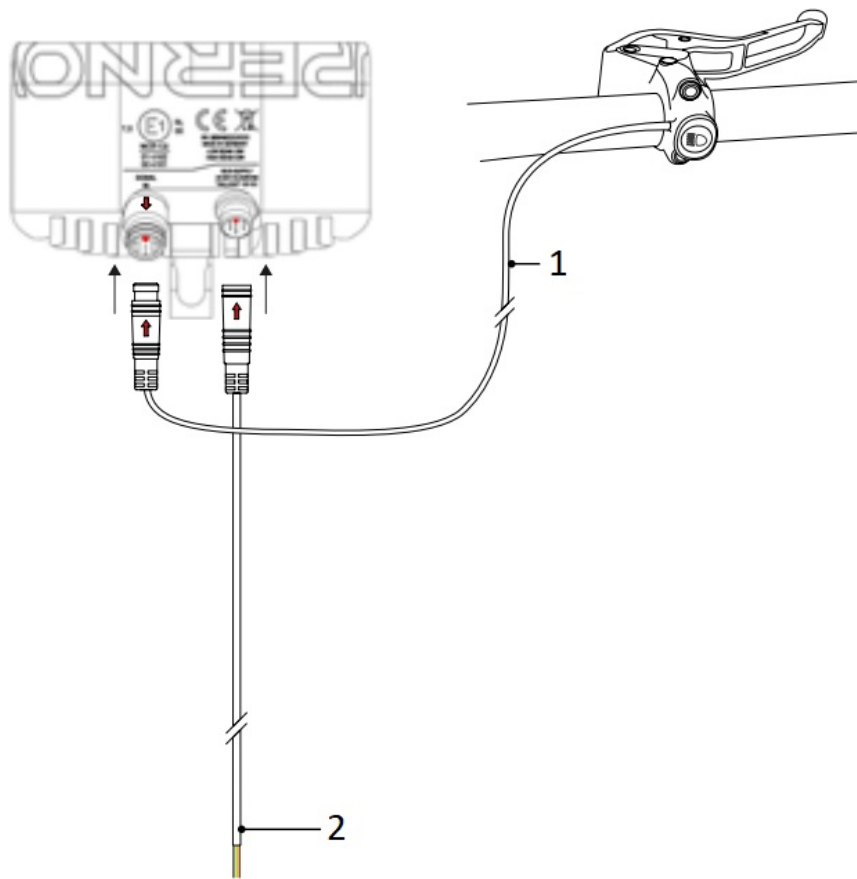

1. High beam switch cable
2. Universal M99 PRO connector cable for drives



Please align the arrows on the connectors.

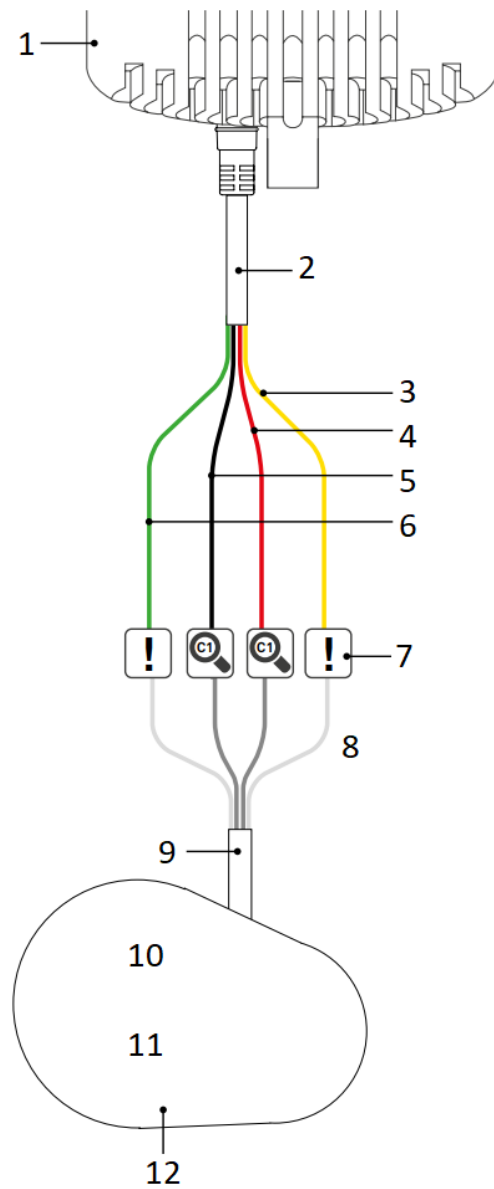

1. M99 PRO

2. Universal M99 PRO connector cable for drives

3. CAN low

4. +36 V

5. GND (-36V)

6. CAN high

7. Please see page 22

8. * Detailed connection diagram available as download for:

- Brose (C16162 / C91143 / C79232 / C97292)**

- Panasonic (X1/X0)**

** For installation on other motor systems, please get in contact with Supernova service.

9. Drive connection cable

10. **Power Supply**

11. Compatibility:

Brose*, Continental, GO Swiss Drive, MPFdrive, Panasonic*.

12. 24-60 V / 16-27 W



www.supernova-lights.com/service/downloads/

M99 PRO Front Light installation



CAN Compatibility:

- Brose (C16162 / C91143 / C79232 / C97292)
- Panasaonic (X1/X0)

CAN high / CAN low is used for communication between engine and front light. The front light can also be used without CAN. In this case the integrated vibration sensor regulates the switching on and off of the front light. In charging mode CAN ensures that the front light is switched off. Without CAN, the front light continues to glow for 5 minutes at a standstill until the vibration sensor no longer detects any movement.



1



2



IMPORTANT! Do not press the tap deeper than the edge of the housing!

Requested tool: Scotchlok™ IDC crimping pliers (E-9Y)



1. Power tap connector

Art.No. SCS1

2. max. \varnothing 1,52 mm

3. Double connector

Art.No. SCS2

4. max. \varnothing 2,08 mm

5. Triple-Connector

Art.No. SCS3



Connector for cable diameter of \varnothing 2.2-2.9 & 2.9 – 3.5 mm (e. g. Brose drive connection cable)

Supplied with Brose front light connection cable **R-BRC200F**.



2 x blaue Verbinder &
2 x rote Verbinder

Art.No. SCS4

Tap connector blue

Tap connector red

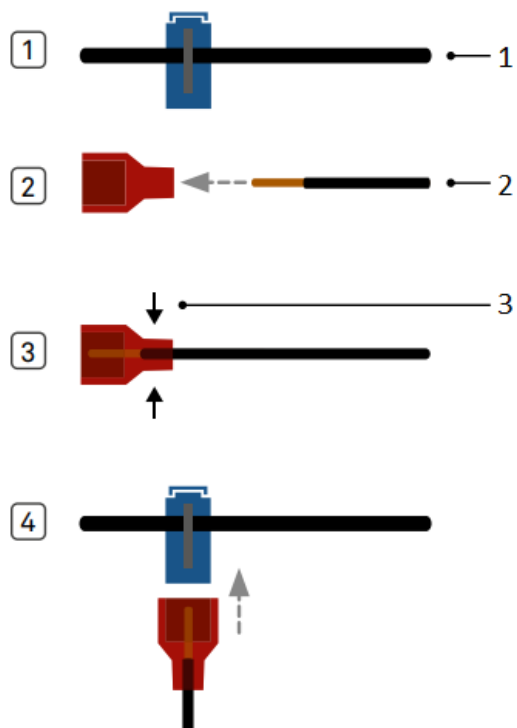
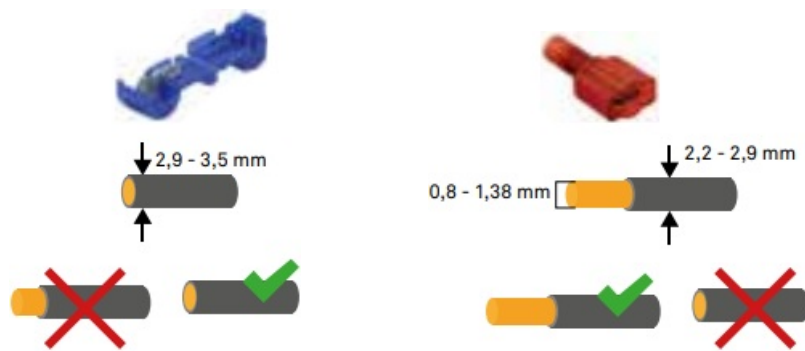

1. Drive connection cable \varnothing max. 1,6 mm (e. g. Brose)
2. Universal M99 PRO connector cable for drives
3. Crimp the sleeves with a crimping tool or with blunt pliers.



Crimping tool

M99 PRO & M99 TAIL LIGHT INSTALLATION

BROSE
36 V

Connecting Magura MTe brakes to the high beam switch and to the M99 PRO

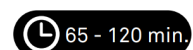

Top view

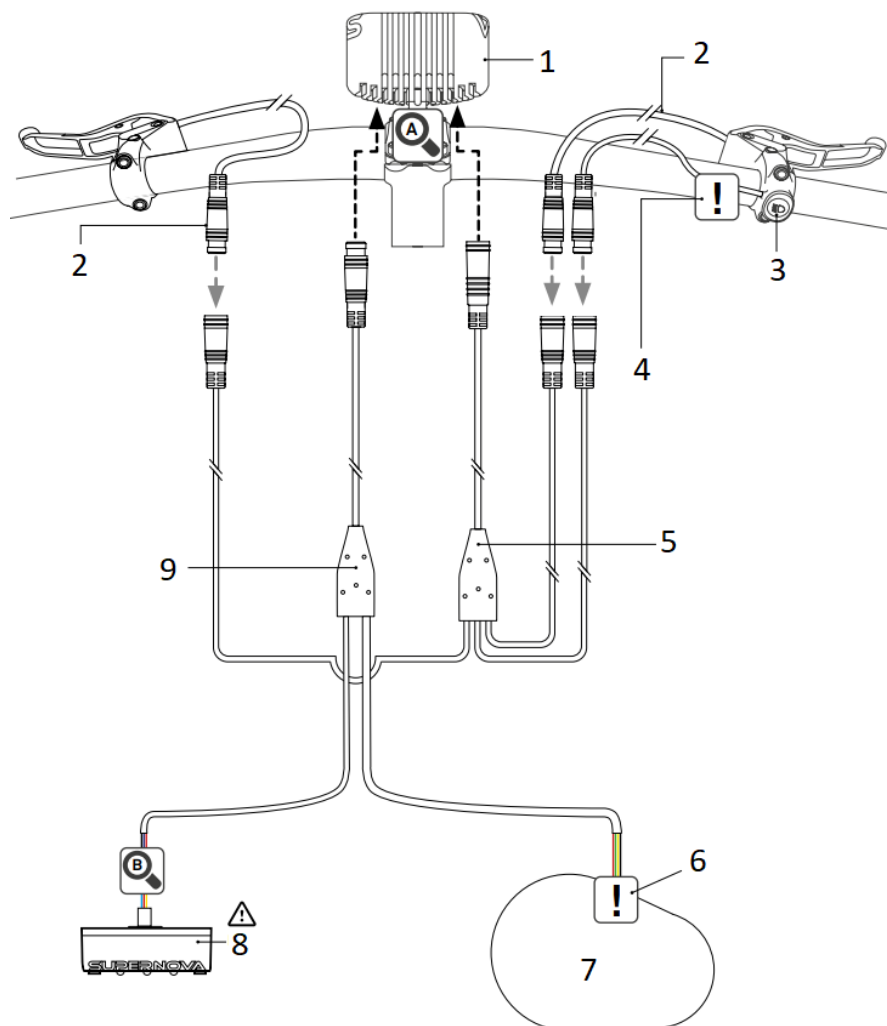

1. M99 PRO
2. Magura MTe brake signal cable
3. High beam switch
4. Please see page 16-18
5. M99 PRO connector cable for brake signal
Art. No: **Q-MTYBS-M99**
6. Please see page 20-25
7. **Power Supply**
24-60 V / 16-27 W
8. M99 Tail Light
(12 V DC)
Art. No: **P-M99-TE12-BLK**
9. Y-Connector cable for tail lights and power supply
Art. No: **Q-YBTC-M99**

Bottom view

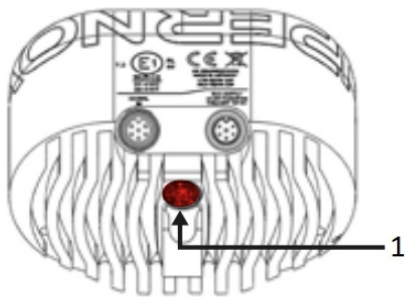

1.

Do not open this service screw!

A special protective gas will escape and the warranty will be lost.

Service screw



Please align the arrows on the connectors.

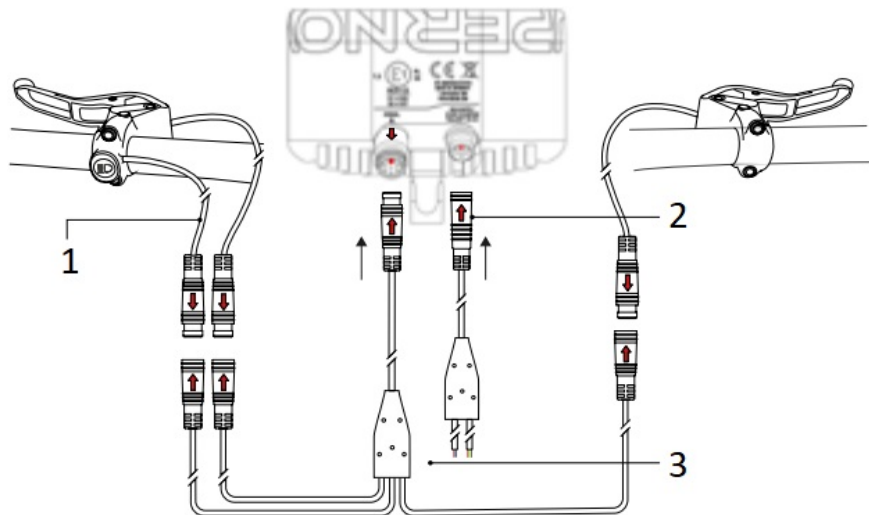

1. High beam switch cable

2. Y-Connector cable for tail lights and power supply

3. M99 PRO connector cable for brake signal

How to plug the high beam switch cable & brake signal cable



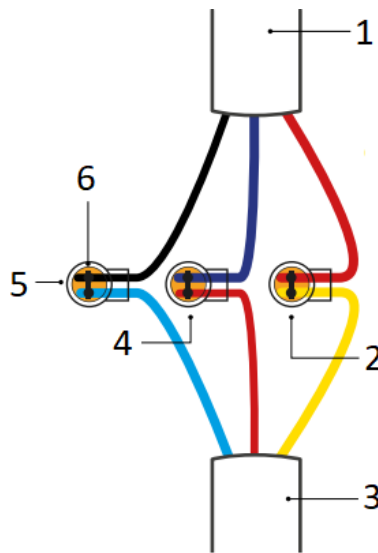

1. Y-Connector cable for tail lights and power supply
2. Brake light (+)
3. M99 Tail Light
(12 V DC)
4. Tail light (+)
5. GND
6. Double connector

ATTENTION! Do not remove insulation.

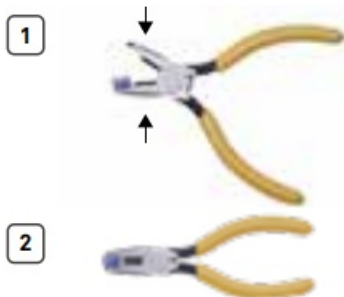

IMPORTANT! Do not press the tap deeper than the edge of the housing! Requested tool: Scotchlok™ krimptang (E-9Y)

M99 Tail Light installation

M99 PRO

MOUNTING OPTIONS

UNIVERSAL HBM INSTALLATION

SUPERNOVA UNIVERSAL HBM

- Fits 31.8 or 35 mm handlebars

- Incl. 2 spacer for different stem widths
- Works with all Supernova lights, except Airstream and HBM versions
- HBM variants can be opened for installation
- Can be installed on either left or right side of stem
- Maximum stem width 44 mm, 8 mm free clamping space required
- 5-year warranty

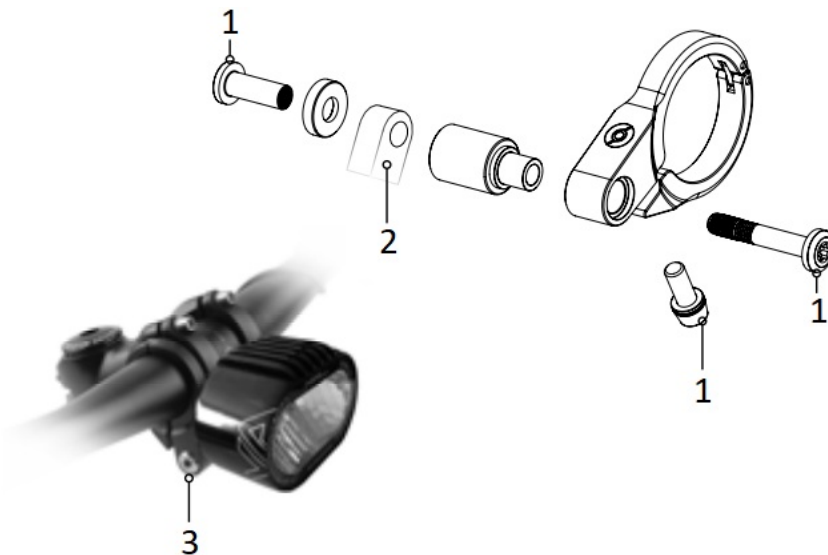

1. 4-5 Nm
2. Installation position front light
3. **SUPERNOVA UNIVERSAL HBM**
Art. No.: **R-UHM31.8-BLK** (ø 31.8 mm)
Art. No.: **R-UHM35-BLK** (ø 35 mm)

M99 BOSCH HBM ADAPTER INSTALLATION

- Place the light in front of BOSCH NYON & INTUVIA displays
- Replaces the lower part of the BOSCH bracket
- Stainless steel screw for mounting the light housing
- For 31.8 mm handlebars
- Compatible with Bosch adapters for 27.2 mm

IMPORTANT! When mounting the Supernova light holder, please use the existing screws and rubber inlays from the bracket being replaced. **Please take care to tighten the screws with the right torque:** 6 Nm for all stem screws and 2 Nm to lock the light in the chosen position.

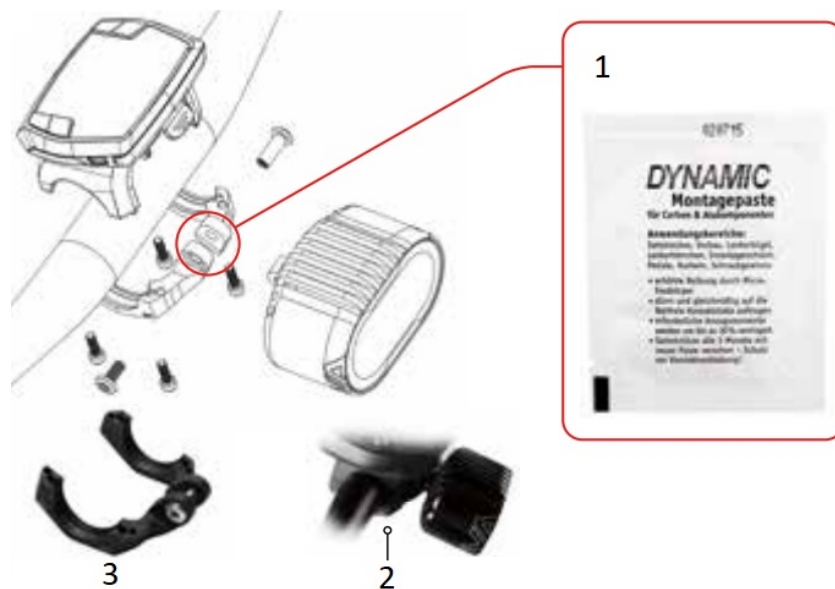

1. When installing the light, please apply the installation paste supplied here.

2. **M99 Bosch HBM Adapter**

3. **M99 Bosch HBM Adapter**

Art. No.: **P-M99-BHBM-BLK**

YAMAHA DISPLAY C ADAPTER INSTALLATION

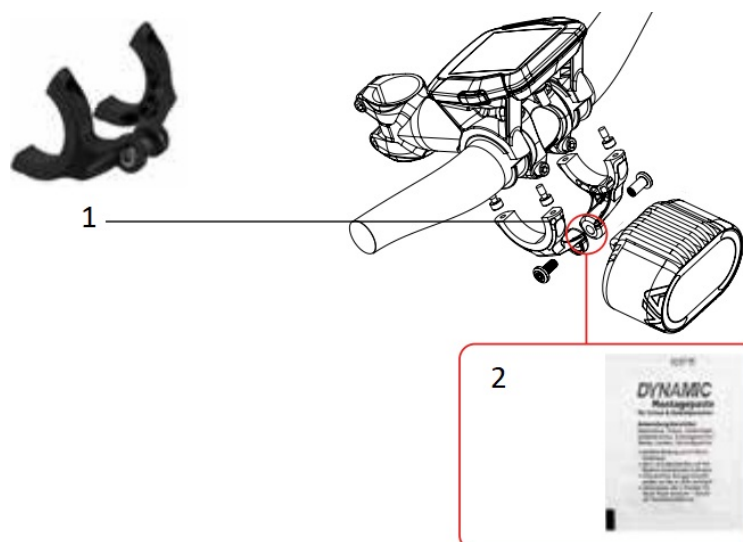

1. **Yamaha Display C Adapter**

Art. No.: **R-YHBM-BLK**

2. When installing the light, please apply the installation paste supplied here.

- Replaces the lower part of the Yamaha bracket
- Fibre reinforced plastics
- For 31.8 mm & 35 mm handlebars with stainless steel screws

SPACER MOUNT INSTALLATION

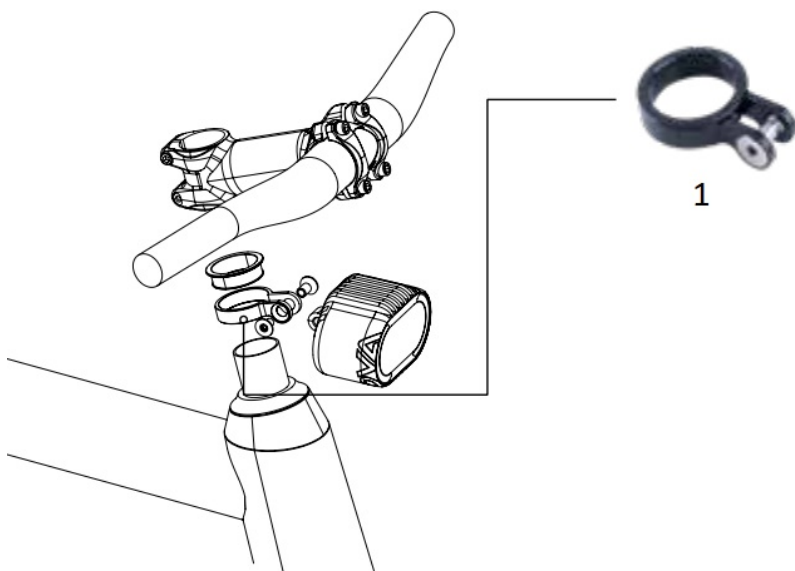

1. Spacer Mount

Art. No.: **R-SPMT-BLK**

- Front light installation on 1 1/8 inch forks
- Front light adjustment is still possible after installation

M99 CRC – MOUNT & CRC STEM INSTALLATION



M99 CRC – Mount

Art. No.: **P-M99-CRC-BLK**



CRC Stem

60 mm Art. No.: **P-CRCSTM-BLK-60**

90 mm Art. No.: **P-CRCSTM-BLK-90**



1. **CRC Stem**
2. **M99 CRC – Mount**

M99 CRC – MOUNT

- Places the light centrally on the handle bar
- Compatible with stems like JD ST95-A & Promax DA230
- Aluminum, with stainless steel screw
- For 31.8 mm handle bars

CRC STEM

- Stem that fits 31.8 mm handlebars
- For the Supernova CRC mounts, available in 60 & 90 mm length

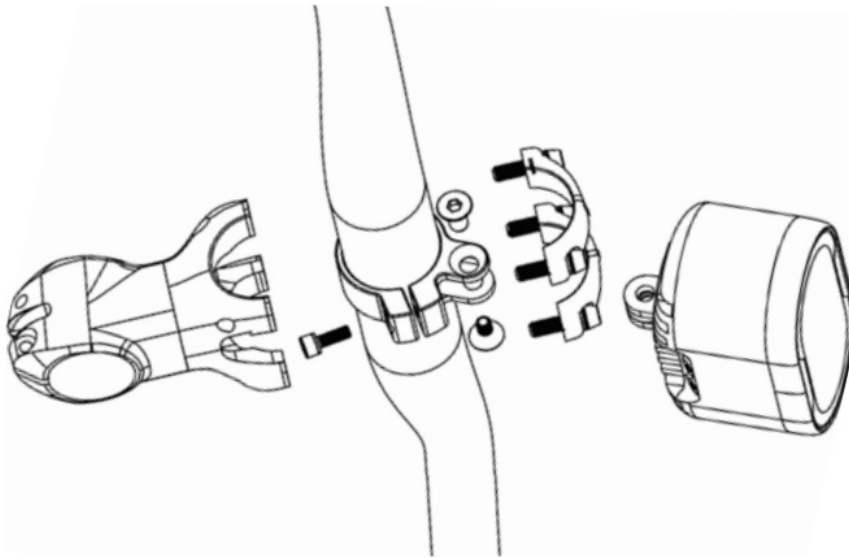

IMPORTANT!

Please take care to tighten the screws with the right torque. 6 Nm for all stem screws and 2 Nm to lock the light in the chosen position. First, make sure to tighten the stem cap screw enough so that the headset bearings have no play. Then, tighten the screws holding the stem to the steer tube with 6 Nm. The screw torque can vary in different carbon handlebars, please ask the distributor for an approval.

PROMAX DA-230 STEM INSTALLATION



Promax

Stem

60 mm Art. No.:
P-DA230STM-BLK-60

90 mm Art. No.:



1. Promax

Stem

PROMAX STEM

- Stem that fits 31.8 mm handlebars
- For the all M99 front lights available in 60 & 90 mm length

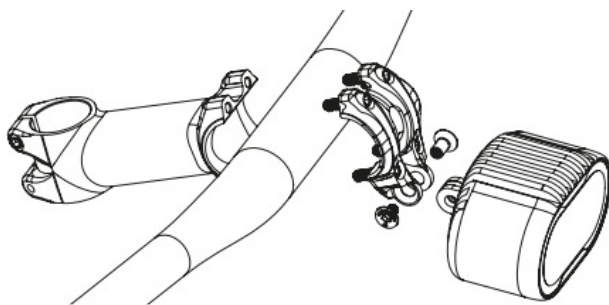

IMPORTANT! Please take care to tighten the screws with the right torque. 6 Nm for all stem screws and 2 Nm to lock the light in the chosen position. First, make sure to tighten the stem cap screw enough so that the headset bearings have no play. Then, tighten the screws holding the stem to the steer tube with 6 Nm. The screw torque can vary in different carbon handlebars, please ask the distributor for an approval.

M99 PRO ADJUSTMENT

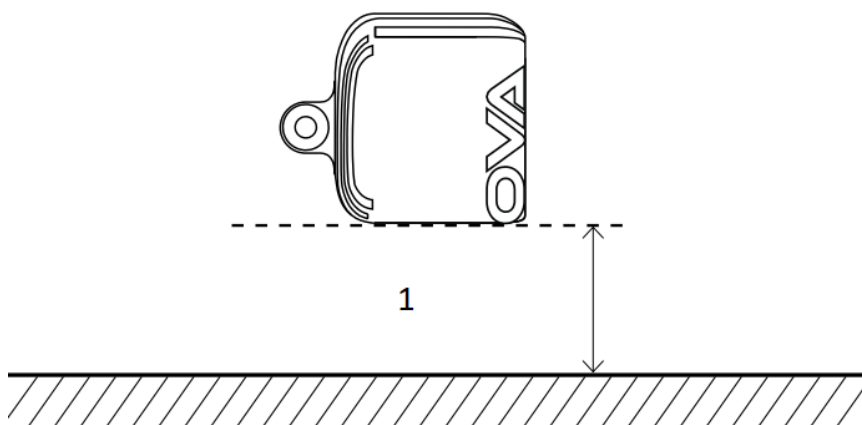

1. PARALLEL

IMPORTANT ! HORIZONTAL INSTALLATION

IMPORTANT! HORIZONTAL INSTALLATION:

The reflector is installed in the lamp body with a 1° downward angle, as required.

AUTOMATIC SENSOR-ACTIVATED DAYTIME RUNNING LIGHT

The switching between daytime running light and low beam takes place automatically via a light sensor, which is located between the cooling fins of the housing on the upper right side when viewed from behind. When entering a tunnel the low beam will immediately switch on. Upon exiting the tunnel the daytime running light will turn on after a several seconds.

GENERAL INFORMATION

CARE INSTRUCTIONS

- The connectors are made for 200 mating cycles and not intended to be disconnected daily. The daytime running light only consumes approximately 1% of the battery capacity.
- Never use a high-pressure hose
- Clean with water and a soft, clean cloth
- Do not use aggressive cleaning agents
(also no alcohol!)
- Check the mounting bolts from time to time

GARANTIE & SERVICE

3 year warranty

The warranty is void if the housing is opened and in case of unqualified repairs. Registration and information can be found at:

supernova-lights.com/register.

More and more drive manufacturers work with us to become Supernova-compatible. This means that we will regularly update this manual. Please compare the version number on the cover with the latest version on our website:

supernova-lights.com/en/service/downloads/.

*Register your Supernova product at www.supernova-lights.com/register and extend the standard 2-year warranty to 3 years!



SUPERNOVA DESIGN GmbH
Industriestr. 26 • 79194 Gundelfingen
Germany

+49 (0) 761 600 629 – 0
info@supernova-lights.com
www.supernova-lights.com

Documents / Resources



[SUPERNOVA P-M99-E32-BLK M99 PRO Front Light](#) [pdf] Instruction Manual
P-M99-E32-BLK M99 PRO Front Light, P-M99-E32-BLK, M99 PRO Front Light, Front Light, Light

References

-  [Modern Light Fixtures and Home Decor | Lights.com](#)
-  [Supernova Shop](#)