

super
lighting
LED FL02Z Series
Zigbee 3.0 RGB
CCT LED
Floodlight



Super Lighting LED FL02Z Series Zigbee 3.0 RGB CCT LED Floodlight Instruction Manual

[Home](#) » [Super Lighting LED](#) » Super Lighting LED FL02Z Series Zigbee 3.0 RGB CCT LED Floodlight Instruction Manual 

Contents

- 1 Super Lighting LED FL02Z Series Zigbee 3.0 RGB CCT LED Floodlight
- 2 Product Introduction
- 3 Technical Parameters
- 4 Dynamic Mode Sheet
- 5 Connection Diagram
- 6 Modes synchronization
- 7 Compatible Remote Control
- 8 Linking&Unlinking
- 9 Zigbee 3.0 APP Control Instruction
- 10 Documents / Resources
 - 10.1 References



Super Lighting LED FL02Z Series Zigbee 3.0 RGB CCT LED Floodlight



Product Introduction

This product is made of an aluminum alloy bottom case and imported material covers with fashionable appearance, waterproof and dustproof, energy saving and environmental protecting, etc features. Widely used on park, apartment, gardens, streets, etc.



- RGB+CCT 16 Millions of colors to choose



- Dimmable Saturation control



- Color temperature 2700~6500K



- Beam Angle 110°



- Waterproof and dustproof grade IP65



- 2.4G RF wireless transmission technology



- 100m super long distance signal transmitting&Mode Synchronization(Except 10W)



- Remote Control control distance 30m



- Smartphone APP control (Tuya Zigbee gateway is needed)



- Support third-party voice control (Tuya Zigbee gateway is needed)

Technical Parameters

FL02Z (20W)

- **Input Voltage:** AC100~240V 50/60Hz Power: 20W
- **Working Temperature:** -20~45°C
- **Color Temperature:** 2700K~6500K Luminous Flux: 2200LM
- **Light Efficiency:** 11 OLM/W
- **Standby Power Consumption:** 0.6W
- **CRI:** >80
- **PF:** >0.9
- **Beam Angle:** 110°
- **IP Rate:** IP65
- **RF:** 2.4GHz
- **Transmitting power:** 6dBm
- **Control Distance:** 30m
- **Lifespan:** 50000 hours

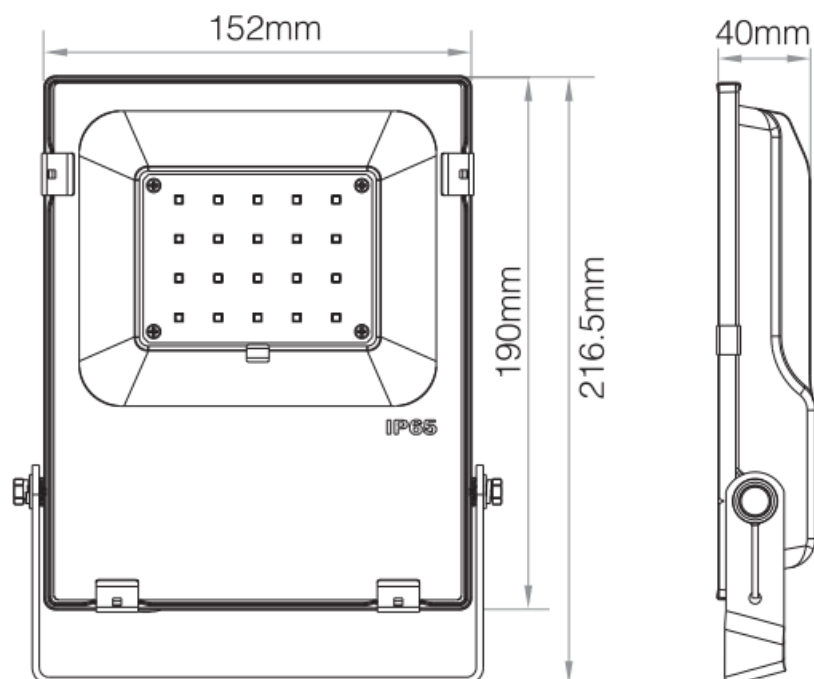

FL03Z (30W)

- **Input Voltage:** AC100~240V 50/60Hz
- **Power:** 30W
- **Working Temperature:** -20~45°C
- **Color Temperature:** 2700K-6500K
- **Luminous Flux:** 3300LM
- **Light Efficiency:** 11 OLM/W
- **Standby Power Consumption:** 0.6W
- **CRI:** >80
- **PF:** >0.9
- **Beam Angle:** 110°
- **IP Rate:** IP65
- **RF:** 2.4GHz
- **Transmitting power:** 6dBm
- **Control Distance:** 30m
- **Lifespan:** 50000 hours

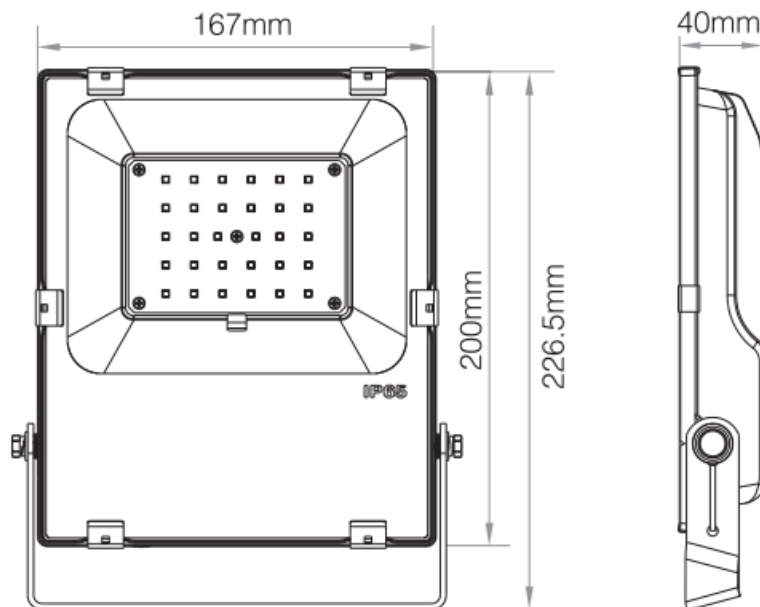

FL04Z (SOW)

- **Input Voltage:** AC100~240V 50/60Hz
- **Power:** 50W
- **Working Temperature:** -20~45°C
- **Color Temperature:** 2700K~6500K
- **Luminous Flux:** 5500LM
- **Light Efficiency:** 110LM/W
- **Standby Power Consumption:** 0.7W
- **CRI:** >80
- **PF:** >0.9
- **Beam Angle:** 110°
- **IP Rate:** IP65

- **RF:** 2.4GHz
- **Transmitting power:** 6dBm
- **Control Distance:** 30m
- **Lifespan:** 50000 hours

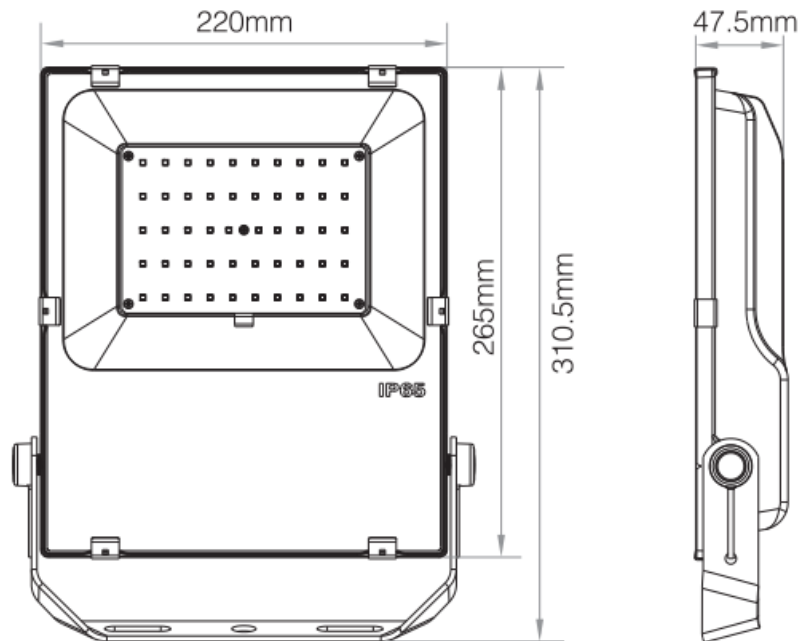

FLOSZ (1 OOW)

- **Input Voltage:** AC100~240V 50/60Hz
- **Power:** 100W
- **Working Temperature:** -20~45°C
- **Color Temperature:** 2700K~6500K
- **Luminous Flux:** 10500LM
- **Light Efficiency:** 105LM/W
- **Standby Power Consumption:** 0.65W
- **CRI:** >80
- **PF:** >0.9
- **Beam Angle:** 110°
- **IP Rate:** IP65
- **RF:** 2.4GHz
- **Transmitting power:** 6dBm
- **Control Distance:** 30m
- **Lifespan:** 50000 hours

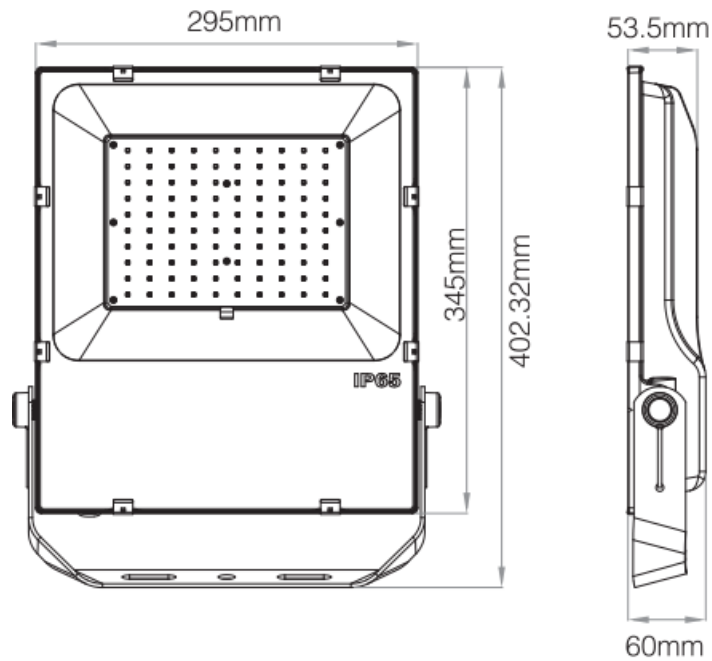

Dynamic Mode Sheet

Number	Dynamic Mode	Adjustable Settings
1	Riotous Profusion	Brightness / Saturation / Speed
2	Blue Sky	Brightness / Saturation / Speed
3	Gorgeous Color	Brightness / Saturation / Speed
4	Ocean	Brightness / Saturation / Speed
5	Dreamlike	Brightness / Saturation / Speed
6	Christmas	Brightness / Saturation / Speed
7	Forest	Brightness / Saturation / Speed
8	Birthday	Brightness / Saturation / Speed
9	Blooming	Brightness / Saturation / Speed

Connection Diagram

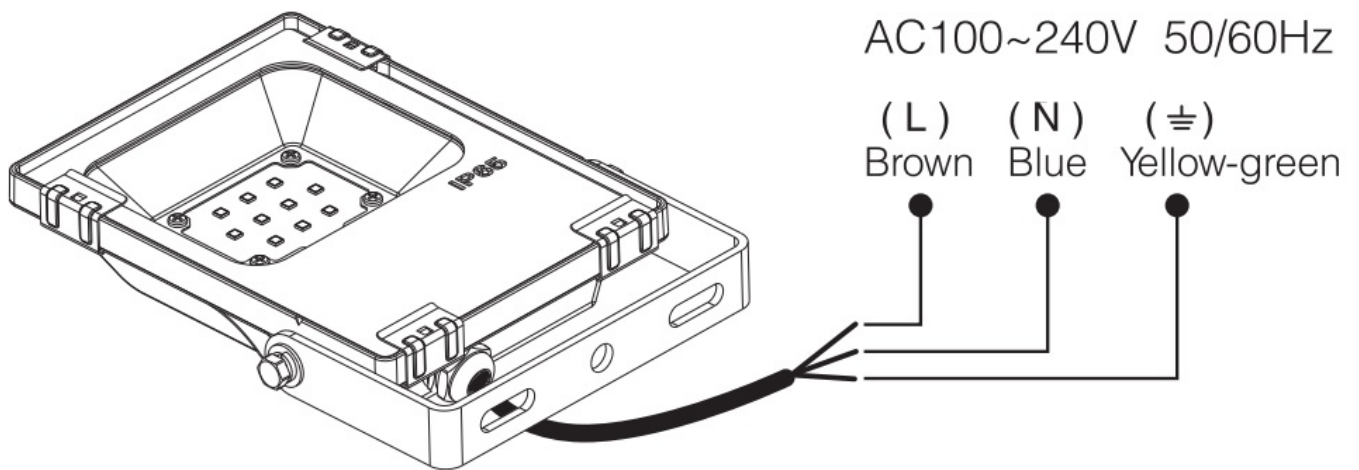

FL02Z/FL03Z/FL04Z/FL05Z

Super long-distance signal transmitting

One lighting fixture can transmit the signals from the remote control to another lighting fixture within 100m, as long as there is a lighting fixture within 30m, the remote control distance can be limitless.

Modes synchronization

Different lighting fixtures can work synchronously when they are started at different times, controlled by the same remote, under same dynamic mode and within a 100m distance.

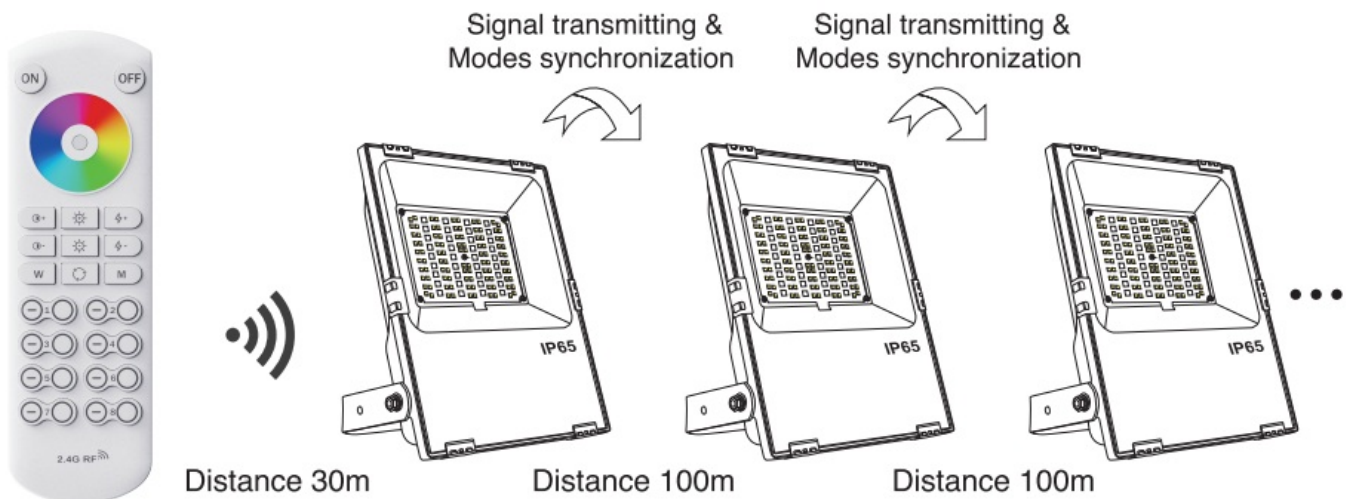

Compatible Remote Control

Compatible with these remote controls (Purchased separately)



RC04RF



RC04RFB



RC03RF



RC03RFB



LM091



LM096

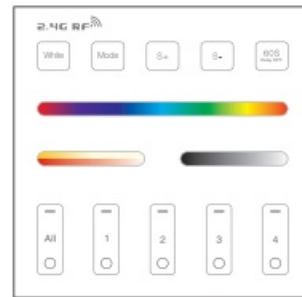

WR01RF

Linking&Unlinking

Remark: The light can be working after linking with the remote controller.

Linking Instructions

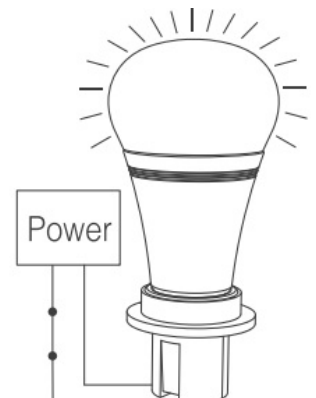
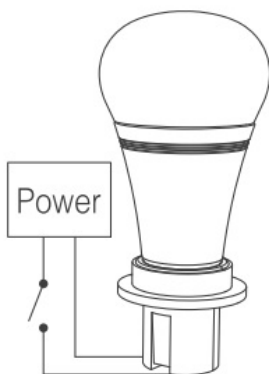

1. Switch off the light, after 10 seconds switch on again
2. When the light on, short press any zone of " " 3 times within 3 seconds
3. The light blink 3 times slowly means the linking is done successfully.

If the light not blink quickly. the unlink failed, pis switch off the light again, and follow the above steps to unlink

again.

NOTE:

Lighting can work after linking with remote; for more details, please read the remote instruction.

Attention

1. When install the lighting fixtures, please switch off the power to make sure the safety.
2. The working power is high voltage alternating current, so it must be far away from people and must with ground connection.
3. As the power is large, user must choose suitable power cable when connecting.
4. Non-professional user cannot dismantle the lighting fixtures directly, otherwise, it may cause fire and electric shock.
5. Please do not use lighting fixtures around the mental area and high magnetic field, otherwise, it will badly affect the control distance.
6. Users must be correct, strict and solid to install the lighting fixtures; do not use the lighting fixtures on strenuous vibration area.

Made in China

Zigbee 3.0 APP Control Instruction

Download and install [Tuya Smart] APP or [Smart Life] APP

Search for [Smart Life] in Apple or Google store or scan following QR code to download and install the app. Please click "Register" button to create account while using it in the first time, Log in directly if you already had account.



Connect to Smartphone

You must link the Tuya Zigbee 3.0 Gateway first to the smartphone, then add the Zigbee floodlight to zigbee gateway for smartphone control.

1. How to connect zigbee gateway to smartphone.

(Note: All Tuya Zigbee 3.0 gateway in market can work on our Zigbee floodlight controller; Here we use our Zigbee 3.0 gateway for example).

1. First, Power the zigbee gateway, and long press the "SET" button until the red indicating lamp blinking.



2. Second, when the red indicating lamp blink, open the Smart Life APP, and press “Add Device”. It will discover the new device automatically, then Press “Add” to complete the linking.

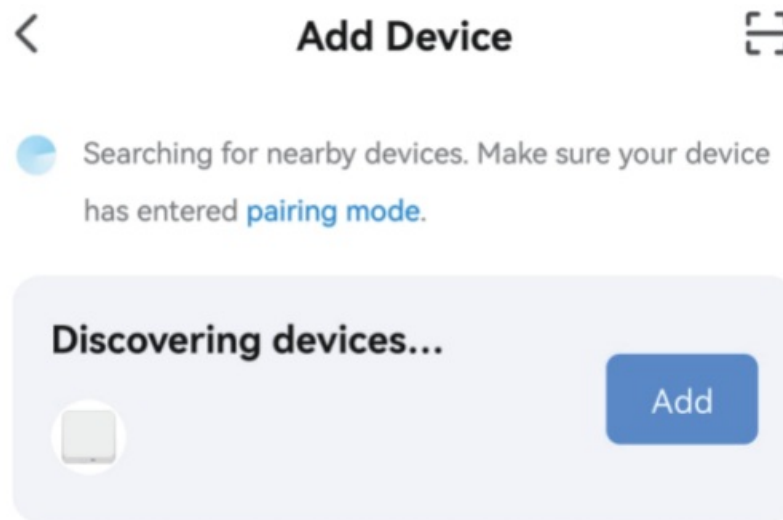

2. Add the Zigbee floodlight to the linked zigbee gateway.
 1. First, power ON-OFF 3 times(ON-OFF-ON-OFF-ON), when the purple light blinking 3 times means the Zigbee floodlight come into smart link mode.
(Note: when the Zigbee floodlight on the smart link mode, please finish the linking within 3 minutes, after 3 minutes the Zigbee floodlight will stop smart link mode, you need to do the above steps again).
 2. Second, Press “Add new devices” on the APP, it will automatically find the zigbee device, then complete the linking. Added device will be displayed on the homepage after added successfully, then Click device you want to control to enter the control interface.

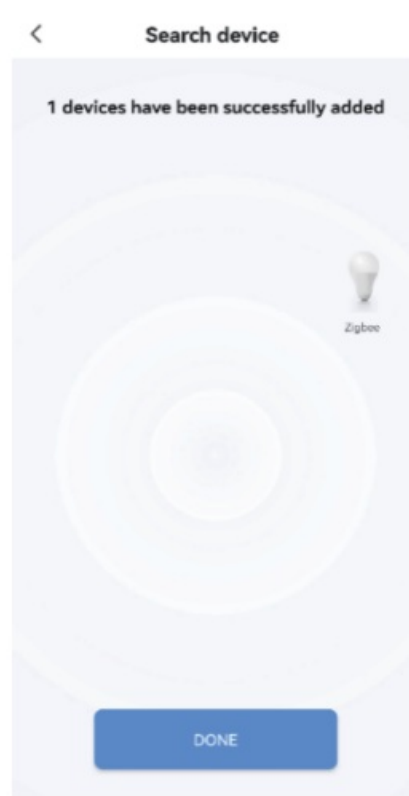
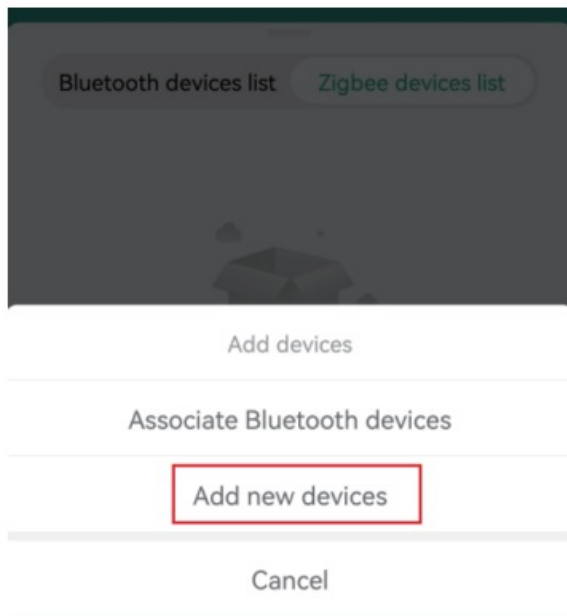

Note: Our Zigbee floodlight also works on Philips Hue Bridge and Samsung Smartthings gateway for smartphone control.

Documents / Resources

	<p>Super Lighting LED FL02Z Series Zigbee 3.0 RGB CCT LED Floodlight [pdf] Instruction Manual</p> <p>20W, 30W, FL02Z Series Zigbee 3.0 RGB CCT LED Floodlight, FL02Z Series, Zigbee 3.0 RGB CCT LED Floodlight, RGB CCT LED Floodlight, CCT LED Floodlight, LED Floodlight</p>
---	--

References

- [User Manual](#)

[Manuals+](#), [Privacy Policy](#)

This website is an independent publication and is neither affiliated with nor endorsed by any of the trademark owners. The "Bluetooth®" word mark and logos are registered trademarks owned by Bluetooth SIG, Inc. The "Wi-Fi®" word mark and logos are registered trademarks owned by the Wi-Fi Alliance. Any use of these marks on this website does not imply any affiliation with or endorsement.