



Seam Guide Setter



Super Easy Seam Guide Setter User Guide

[Home](#) » [Super Easy](#) » Super Easy Seam Guide Setter User Guide 

Contents

- 1 Super Easy Seam Guide Setter
- 2 Documents / Resources
 - 2.1 References



Super Easy Seam Guide Setter



The Super Easy Way to Align a Seam Guide at a Scant $\frac{1}{4}$ " on Your Sewing Machine.

1. Peel off the backing paper & put a Guide in the slot.
2. Hook the Setter on your needle
3. Sew Precise Scant $\frac{1}{4}$ " Seam Allowances



4. Remove the Setter & sew a precise



Your finished seams will measure a full $\frac{1}{4}$ "

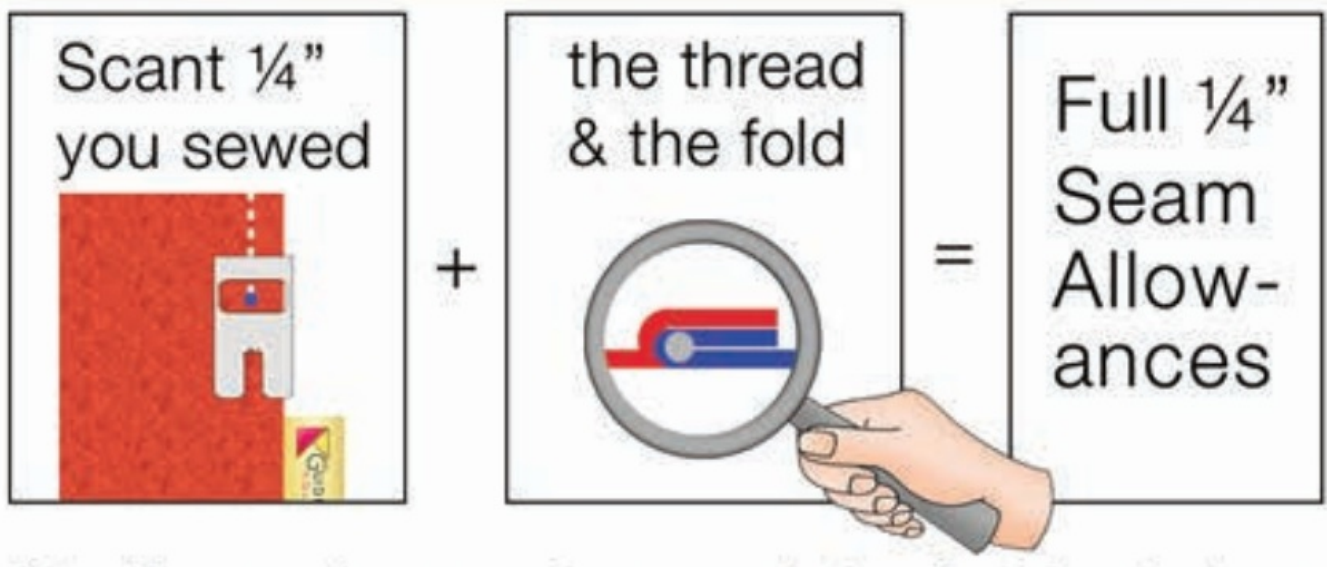

- You'll get sharp points and the finished sizes of your blocks & quilts will be accurate.
- More info & extra Seam Guides at GL4Q.com



- Put a Seam Guide in the slot, and peel off the backing paper.
- Hook the Setter on your needle, and press the Guide down in place.

- Guide your fabric at a scant $\frac{1}{4}$ " for perfect $\frac{1}{4}$ " seams.



You can split the Seam Guide for machines with top loading bobbins.

- Cut the Seam Guide right where the cover opens.



- You won't have to remove the Guide every time you reload your bobbin.

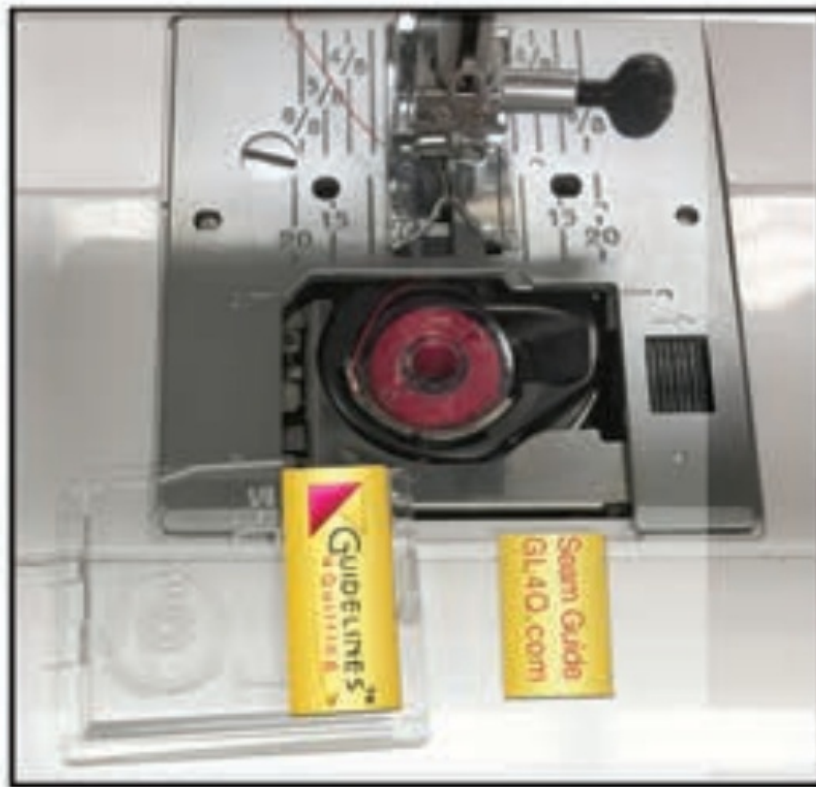

Make sure the cover is clean so the Guide will stick better.

Sometimes you need to mark a scant $\frac{1}{4}$ " before sewing.

- The Prep-Tool takes the guess- work out of accurately mark- ing seam lines!
- Available separately at GL4Q.com!



Documents / Resources



[Super Easy Seam Guide Setter](#) [pdf] User Guide
Seam Guide Setter, Seam Guide Setter, Guide Setter, Setter

References

- [User Manual](#)

Manuals+. Privacy Policy

This website is an independent publication and is neither affiliated with nor endorsed by any of the trademark owners. The "Bluetooth®" word mark and logos are registered trademarks owned by Bluetooth SIG, Inc. The "Wi-Fi®" word mark and logos are registered trademarks owned by the Wi-Fi Alliance. Any use of these marks on this website does not imply any affiliation with or endorsement.